

**Lane at Swainsea Lane
Pickering
North Yorkshire**

Desk Based Assessment

SE 7930 8490

Authorised by

Date:.....

© MAP Archaeological Consultancy Ltd.

October 2009

**Land at Swainsea Lane
Pickering
North Yorkshire**

**Desk Based Assessment
SE 7930 8490**

Contents	Page
Figure List	2
Plate List	3
Non Technical Summary	4
1. Introduction	4
2. Site Description	5
3. Aims and Objectives	5
4. Methodology	6
5. Historical, Cartographic and Archaeological Background	6
6. Site Walkover	14
7. Potential for Unrecorded Sites	14
8. Evidence of Previous Disturbance	14
9. Impact of the Development	14
10. Conclusions and Recommendations	16
11. References and Bibliography	17
12. List of Contributors	18

Figure List	Page
1. Site Location. Scale 1:50,000.	19
2. Area of Proposed Development. Scale 1:1,250.	20
3. Location of Designated Conservation Areas. Scale 1:10,000	21
4. Location of the Scheduled Monuments. Scale 1:10,000.	22
5. Sites and Finds on the North Yorkshire HER. Scale 1:10,000.	23
6. Archaeological Reports on the North Yorkshire HER. Scale 1:10,000.	24
7. Extract from the 1854 First Edition Ordnance Survey Map. Scale 1:10560.	25
8. Extract from the 1893 Edition Ordnance Survey Map. Scale 1:10,560.	26
9. Extract from the 1913 Edition Ordnance Survey Map. Scale 1:10,560.	27
10. Extract from the 1952 Edition Ordnance Survey Map. Scale 1:10560.	28

Plate List	Page
1. General View of Site, Facing North-west.	29
2. General View of Site, Facing North-west.	29
3. Swainsea Lane. Facing South.	30
4. Swainsea Lane. Facing North.	30
5. Proposed Site Entrance. Facing West.	31
6. Barn. Facing North.	31

**Land at Swainsea Lane
Pickering
North Yorkshire**

**Desk Based Assessment
SE 7930 8490**

Non Technical Summary

This report has been prepared by MAP Archaeological Consultancy Ltd under instruction from Bramhall Blenkarn Architects acting on behalf of Broadacres to assess the Historical and Archaeological background of, and the impact of a proposed residential development on land at Swainsea Lane, Pickering, North Yorkshire.

The site currently consists of 1.10 hectares of pasture farmland.

The Proposed Development Area is located north-west of the Medieval Town of Pickering.

Whilst archaeological deposits may survive it is unlikely that any nationally important archaeological remains are located on the site to prevent development.

1. Introduction

1.1 This Archaeological Assessment and report has been undertaken by MAP Archaeological Consultancy Ltd under instruction from Bramhall Blenkarn Architects acting on behalf of Broadacres, to evaluate the Historical and Archaeological background of, and assess the impact of a proposed residential development, on the land at Swainsea Lane, Pickering, North Yorkshire (SE 7930 8490: Figs. 1 & 2).

1.2 Archaeological, Historical and Architectural remains are protected by means of Statutory Instruments (including Scheduled Ancient Monument Legislation and the Draft PPS Planning for the Historic

Environment: Planning Policy Guidance 15 and Planning Policy Guidance 16), and by the Ryedale District Council Local Plan (2002: Chapter 9: Policies C1-C5; C7-C11, C13-C15).

1.3 There are no Scheduled Ancient Monuments, Listed Buildings, Registered Parks and Gardens or Registered Battlefields within the Proposed Development Area.

1.3 The Archaeological Assessment was funded by Broadacres.

1.4 All Maps within this report have been reproduced from the Ordnance Survey with the permission of the Controller of Her Majesty's Stationery Office, Crown Copyright, Licence No. AL50453A.

2. Site Description

2.1 The Proposed Development Area comprises c. 1.10 hectares (2.72 acres), and stands at heights of between 47m and 50m AOD (Fig. 2).

2.2 The Proposed Development Area is the site of the farmland located north-west of Swainsea Lane (Pls. 1-6). To the south of the Proposed Development Area is the Agricultural Centre and to the north is a barn.

2.3 The site lies on soils of the Rivington 1 Soil Association (541f), "*well drained coarse loamy soils over sandstone*" (Mackney *et al.* 1984).

3. Aims and Objectives

3.1 The aim of the Assessment is to:

- Identify recorded features of archaeological significance within the study area
- Establish the potential for hitherto unrecorded and unknown sites
- Assess the relative importance of the sites
- Assess the likely impact of the proposed development on the sites

- Make recommendations to mitigate the impact of the development on the sites

4. Methodology

4.1 The assessment comprised the evaluation of historical information derived from cartographic and pictorial documents, Tithe awards, Parish Registers, the Ordnance Survey and the Historic Environment Records, and secondly by consideration of previous Archaeological Excavations, Evaluations and Watching Briefs and covered an area of one kilometre from the centre of the proposed development area.

- National Archives
- National Monument Register
- North Yorkshire Record Office
- North Yorkshire Historic Environment Register
- Pickering Library Local Studies

4.2 Both primary and secondary sources were consulted and are referenced in the References and Bibliography (Section 12).

5. Historical, Cartographic and Archaeological Background

5.1 There no known archaeological sites known within the Proposed Development Area on the North Yorkshire Historic Environment Record. The Proposed Development Area lies to the north-west of Pickering Conservation Area (DNY1039: Fig. 3).

Table 1. Archaeological Sites within 1km of the Proposed Application Area on the North Yorkshire Historic Environment Record (Figs. 4, 5 and 6)

Monument No.	Grid Ref.	Description	Period
DNY551 SM 32662 (NY542) MNY3358 MNY21250	SE 792 844	Beacon Hill Ringwork Seige Castle and Royal Observer Corp Post Scheduled Ancient Monument	Medieval Modern
DNY15 SM 13301	SE 798 845	Pickering Castle: 11 th Century Motte and Bailey Castle and 13 th	Medieval

(NY244) MNY3338- MNY3357		Century Shell Keep Castle Scheduled Ancient Monument	
DNY870 SM35469	SE 784 846	St. Nicolas' Medieval Hospital located 550m east of Brick Yard Farm Scheduled Ancient Monument	Medieval
MNY3141	SE 790 860	Crook Lane Track: Medieval Turf Road to Cawthorn Moor (Maybe Roman in Origin)	Medieval
MNY3240	SE 7842 8519	Middleton Cruck House with Thatched Roof	Medieval
MNY3242	SE 7789 8501	Relict Strip Field System with Ridge and Furrow located south-west of Middleton Village	Medieval
MNY3263	SE 798 854	Early Bronze Age Urn with Cremation	Prehistoric
MNY3269	SE 80 50	Early Bronze Age Find Conical Stud Two cylindrical Beads and two Flat Dividing Plates with incised Saltire (At. Andrew's Cross)	Prehistoric
MNY3272	SE 7965 8595	Trackway bounded by Two Ditches Aerial Photographic Cropmark	Prehistoric
MNY3291	SE 7995 8548	Ditch/Field System. Ploughed remains of Medieval or Later Field System	Medieval
MNY3292	SE 7961 8537	Round Barrow or Pond Aerial Photographic Cropmark	Prehistoric
MNY3331	SE 785 845	Chapel Close Remains of Chapel Excavated in 1930's. Remains of two buildings and fragment of bell found.	Medieval
MNY3332	SE 785 845	Chapel Close Excavated Remains of Altar	Medieval
MNY3333	SE 7878 8431	Stray Find Medieval Pottery found during exaction of a Drain	Medieval
MNY3334	SE 7878 8431	Ramp of Rough Stones – Possibly Old Enclosure	Medieval
MNY3335	SE 7878 8431	Stray Find Flint Core	Prehistoric
MNY3359	SE 7930 8401	House with Thatch	Post-medieval
MNY3364	SE 80 85	Stray Find Early Bronze Age Dagger	Prehistoric
MNY3368	SE 80 85	Stray Find Saw	Prehistoric
MNY3369	SE 7866 8457	Stray Find Brow Tine	Prehistoric
MNY3371	SE 7893 8434	Site of Manor House Excavated by JHR (1970)	Medieval
MNY3383	SE 792 844	Stray Find from Swainsea Lane End Flint Artefact (Neolithic)	Prehistoric
MNY3393	SE 795 855	Bronze Age Round Barrow, Bist, Adult and Infant Inhumation Burials	Prehistoric
MNY3398	SE 795 855	Early Bronze Age Cairn with Cist	Prehistoric

		and Inhumation	
MNY3412	SE 80 85	Stray Find 211 Flint Artefacts found on Warren's Round, Pickering	Prehistoric
MNY3415	SE 80 85	Number of Tumuli (Round Barrows) excavated in the Pickering Area	Prehistoric
MNY3416	SE 80 85	Stray Finds from excavated Barrows in the Pickering Area	Prehistoric
MNY3417	SE 80 85	Stray Find Bronze Age Mace	Prehistoric
MNY12190	SE 801 855	Two Flexed Inhumation Burial found at Green Gate Hagg (Now Newbridge Quarry)	Prehistoric
MNY12196	SE 80119 85640	Newbridge Limestone Quarry – comprising extensive Workings	Modern
MNY12200	SE 801 854	Modern Limekilns at Newbridge	Modern
MNY16102	SE 80 85	Stray Find Neolithic/Early Bronze Age Stone Quartzite Axe Hammer	Prehistoric
MNY23522	SE 79622 84116	Pickering Bridge, Bridge Street, Pickering	Medieval- Modern
MNY23815 MNY24944	SE 79713 84419	High Mill, Pickering Watermill powered by two waterwheels and with two millstones	Post- medieval - Modern
MNY24072 ENY2488	SE 79624 84039	Site of Post-medieval Building from Watching Brief at Pickering Library On Site Archaeology 01/2005	Post- Medieval
MNY24363	SE 72167 84695	Parish Record for Pickering 3102	Medieval- Modern
ENY1497	SE 7965 8400	Pickering Link Road Desk Based Assessment undertaken in 1976 Mike Griffiths, NYCC	
ENY1541	SE 79559 85756	Areas A1 & B3, Newbridge Quarry, Pickering Excavation by MAP Archaeological Consultancy Ltd in 2003	
ENY1761	SE 796 840	Tyre Depot, Train Lane, Pickering Field Recording by Neil Campling NYCC in 1991	
ENY1953	SE 79636 84272	East of Wells Walk, Pickering, Pickering Flood Alleviation Scheme 2003 Written Scheme of Investigation	
ENY1955	79640 84275	Pickering Flood Alleviation Scheme 2003 Written Scheme of Investigation	
ENY2014	SE 79620 85788	Newbridge Quarry - Area C, Swainsea Lane Barn Area, Topsoil stripping MAP Archaeological Consultancy Assessment Report 2000	
ENY2015	SE 79613 85742	Newbridge Quarry - Area C, Swainsea Lane Evaluation Trenches MAP Archaeological Consultancy Assessment Report 2000	

ENY2021	SE 79568 85830	Newbridge Quarry, Pickering Area A1 & B3 (Zones 3,5,6,7) Archaeological Excavation West Yorkshire Archaeology Service 2003	
ENY2115	SE 79775 84050	White Swan Hotel, Market Place, Pickering MAP Archaeological Consultancy Watching Brief Report 2004	
ENY225	SE 79605 85707	Newbridge Quarry - Area C, Swainsea Barn Area, Excavation MAP Archaeological Consultancy Assessment Report 2000	
ENY3231	SE 79605 84222	Beck Isle Riding Stables, Well Walk, Pickering Written Scheme of Investigation	
ENY3815	SE 79398 83951	Land at Firthland Road, Pickering Watching Brief Notification	
ENY3922	SE 80035 86030	Newbridge Quarry Extension, Pickering. Desk Based Assessment Guildhouse Consultancy 1999	
ENY454	SE 79638 85597	Newbridge Quarry - Area C, Swainsea Barn Area Archaeological Recording Brief Guildhouse Consultancy 2001	
ENY4664	SE 7968 8418	Pickering Railway Station, Park Street, Pickering Watching Brief York Archaeological Trust	
ENY582	SE 79627 85839	Newbridge Quarry - Area B, Pickering Geophysical Survey Guildhouse Consultancy	
ENY595	79680 84130	Pickering Flood Alleviation Scheme, Pickering Cultural Heritage Assessment	
ENY2753	SE 79764 84066	Rear of 4 Market Place, Pickering Watching Brief MAP Archaeological Consultancy Ltd	

5.2 Prehistoric

5.2.1 There are no known prehistoric sites or finds from the Proposed Development Area.

5.2.2 There are sixteen sites and finds noted within one kilometre of the Proposed Development Area on the North Yorkshire Historic Environment Record (Table 1: Figs. 4, 5 and 6).

5.2.3 Thirteen references on the North Yorkshire HER relate to stray prehistoric artefacts and finds from excavated Round Barrows (MNY3263, MNY3269, MNY3335, MNY3364, MNY3368, MNY3369, MNY3393, MNY3398, MNY3412, MNY3415, MNY3416, MNY3417 and MNY16102). A Neolithic Flint Artefact was found at Swainsea Lane End (HER Ref.: MNY3383). Two sites relate to Aerial Photographic Cropmarks interpreted as a possible Round Barrow (HER Ref. MNY 3292) and a Track way (HER Ref. MNY3272).

5.2.4 Extensive Prehistoric Finds and Features have been found during a staged evaluation and excavations at Newbridge Quarry, and the work undertaken included a desk based assessment, geophysical survey, recording briefs, archaeological evaluations and excavations (HER Refs. ENY1541; ENY2014, ENY2015, ENY2021, ENY3922, ENY454. ENY582). An Inhumation was found at Green Hagg Howe, now part of Newbridge Quarry (HER Ref. MNY 12190)

Potential: HIGH

5.3 Roman

5.3.1 There are no known Roman sites or finds known within one kilometre of the Proposed Development Area.

Potential: LOW

5.4 Anglo-Saxon/Anglo-Scandinavian

5.4.1 The Manor of Pickering has a pre-Conquest foundation. Anglian cross shaft fragments found at the Parish church of St. Peter and Paul are noted in the Victoria County History (Page 1968, 471). In 1066, the Manor was held by Morcar, the Earl of Northumberland; and was valued at £88.

5.4.2 There are no Anglo-Saxon or Anglo-Scandinavian finds known from the proposed Development Area, or within one kilometre.

Potential: LOW

5.5 Medieval

5.5.1 Pickering is located in the District of Ryedale in County of North Yorkshire, which was formerly in the Wapentake of Pickering Lythe in the North Riding of the County of York.

5.5.2 There are three Scheduled Ancient Monuments within one kilometre of the Proposed Development Area (Table 1: Fig. 4). Pickering Castle, an eleventh century motte and bailey castle and a thirteenth century shell keep castle (SAM 13301), and is located 500m south-east of the Proposed Development Area. Beacon Hill (SM32662) is described as Medieval Ringwork Seige Castle, and is located 500m south of the Proposed Development Area. St. Nicolas' Hospital (SM35469) is a Medieval Hospital Site, dating to the fourteen century and dissolved in 1535, which is located 900m south-west of the Proposed Development Site.

5.5.3 There are eleven other Medieval sites noted within one kilometre of the Proposed Development Area (Table 1: Fig. 5). These include a Turf Road (MNY3141), a Cruck House (MNY3240), Field Systems (MNY3242 and MNY3291), a Trackway (MNY3272), Remains of a Chapel (MNY3331) with an Altar (MNY3332), a ramp of stones and Medieval Pottery (MNY3333 and MNY3334), a Medieval Manor House (MNY3371), a Medieval Bridge in Pickering (MNY23522), and the Parish of Pickering (MNY24363).

5.5.4 The Manor of Pickering is noted in the Domesday Book under land of the King in Yorkshire, "*In PICKERING there are 37 carucates of land to the geld (taxable), which twenty ploughs could plough. Morcar held this as one manor, with its Berewicks (outlying estate), Barton-le-Street, Newton-on-Rawcliffe, Blandsby, Easthorpe [in Appleton-le-Street]. Now the King has it. There is one plough; and 20 villans (villagers with six ploughs. [There is] meadow half an league long and as much broad. But all the woodland which belongs to the manor is sixteen leagues long and four broad. The manor was worth in the Reign of King Edward*

£88; now 20s 4d” Williams and Martin 1992, p. 787). And also “*In Pickering, Barton-le-Street, Newton-on-Rawcliffe and Easthorpe, the King has 37 carucates*” (ibid, p. 872).

- 5.5.5 The Place-name of Pickering derives from the old English Piceringas meaning ‘the settlement of Picer and his dependants’ (Smith 1979, p. 85). The Domesday Book, Medieval charters and documents record various derivations *Pichering(a)*, *Pic(h)rinch*, *Picaringes*, *Pikeringes* and *Pikering (a, e)* in the twelfth century and *Pekeryng* in 1579.
- 5.5.6 Pickering is listed as a Medieval Borough (Beresford and Finberg 1973, p. 187) with two entries. “King John orders (1200) that the men of Pickering shall have their customs as under Henry I and Henry II *Cal Rot Chart, 1199-1216, 41*” and “Tallage (tax) paid by the borough – *Pipe Roll Soc, NS, XX, 1942, 207*”. Pickering Castle was a royal residence in the twelfth, thirteenth and fourteenth centuries. Henry II granted a charter there in the twelfth century (Page 1968, p. 463), and King John issued a grant from Pickering in 1201. Edward I was in residence in 1280 and 1292. In the fourteenth century, Edward II and Edward III visited and in 1399 Richard II was confined in the castle. Tallage was paid in Pickering in 1187, 1189, 1195-1198, and in 1308 “an Inquiry was held into the Earl of Lancaster’s right to tallage from his tenants of Pickering, Scalby and Huby” (ibid, p. 467). In 1267, the Manor of Pickering was granted to Edmund of Lancaster by Henry III. Edmund’s son Thomas was beheaded at Pontefract in 1322 and his possessions forfeited. The Manor then passed to Henry Earl of Lancaster and through his daughters to John of Gaunt and his heir Henry, later King Henry IV and held as part of the Duchy of Lancaster land.
- 5.5.7 The Proposed Development Area was located in the open fields to the north-west of Pickering.

Potential: LOW

5.6 Post-medieval/Modern

- 5.6.1 There are three Post-medieval Sites on the North Yorkshire Historic Environment Record within one kilometre of the Proposed Development Area (Table 1: Figs. 5 and 6), and include High Mill (MNY 23815 and MNY24944), a Thatched House (MNY3359) and remains of a Post-medieval Building found at Pickering Library (MNY24072/ENY2488).
- 5.6.2 Within one kilometre there are three Modern Sites on The North Yorkshire Historic Environment Record (Table 1: Figs 4 and 5), including the Royal Observer Corps Observation Post (DNY551, SM 32662, MNY3358, MNY21250), Newbridge Quarry (MNY 12196) and Limekilns at Newbridge Quarry (MNY12200).
- 5.6.3 Leland visited Pickering around 1540 and described it as “*the toune of Pykering is large but not welle compact to gather. The greatest part of it with the paroch church and the castel is on the sout est part of the brooke renning through the toune, and standith on a great slaty hille. The other part of toune is not as big as this : the brooke rennith bytwixt them*” (Page 1968, 462). Leland also remarked on the route from Scarborough to Pickering as “most plentiful of corn and grass but little wood in sight”.
- 5.6.4 Pickering was affected by the northern rebellions during the reign of Henry VIII, various epidemics in the sixteenth and early seventeenth centuries; so by the time of the Civil War, and was regarded as too ruinous to garrison.
- 5.6.5 The 1854 First Edition Ordnance Survey map, the 1893 Edition Ordnance Survey map, the 1913 Edition Ordnance Survey map and the 1952 Edition Ordnance Survey map shows the Proposed Development Area as three fields (Fig. 5).

5.6.6 The Proposed Development Area lies to the north-west of Pickering Conservation Area (DNY1039).

5.6.7 There are no known sites or finds of Post-medieval and modern date listed on the Historic Environment Register within the Proposed Development Area.

Potential: LOW

5.7 Listed Buildings

5.7.1 There are 214 Listed Buildings in Pickering, on Burgate, Market Place, Beck Isle, Brant Hill, Potter Hill, Westgate, Train Lane, Castlegate and Keld Head.

5.7.2 There are no Listed Buildings on Swainsea Lane.

6. Site Walkover

6.1 The site was visited on the afternoon of Tuesday 6th October 2009. The site can be accessed from Swainsea Lane (Pls. 1-6). The site is currently pasture fields which are subdivided by mature trees and hawthorn hedges. Remains of possible earthworks are visible.

7. Potential for Unrecorded Sites

7.1 The potential for unrecorded sites is moderate, based on the evidence contained in the Desk Based Assessment.

8. Evidence of Previous Disturbance

8.1 The Proposed Development Area has been farmland throughout the Medieval and Post-medieval period and may be disturbed by field drainage.

9. Impact of the Development

9.1 The following potential impacts upon the archaeological resources are considered:

- Loss of, or damage to, archaeological sites and remains

- Settings and views of and from upstanding remains, Listed Buildings, Scheduled Monuments and other archaeological sites
- Changes to ground conditions as a result of changes to the drainage regime which could affect archaeological remains
- Loss of landscape features, structures and areas with historic and cultural heritage associations
- Other possible impacts such as noise, vibration, compressions and other changed ground conditions

9.2 Loss of, or damage to, archaeological sites and remains

9.2.1 The Proposed Development will require groundworks for the insertion of roads, services and foundations. These works may impact upon any buried archaeological deposits. Further Archaeological Evaluation is therefore recommended to assess the impact the proposed groundworks would have on any archaeological deposits and to ensure appropriate mitigation and to allow the appropriate level of recording for the archaeological resource.

9.3 Settings and views of and from upstanding remains, Listed Buildings, Scheduled Monuments and other archaeological sites

9.3.1 There are no Scheduled Monuments or Listed Buildings on or other archaeological sites bordering the Proposed Development Area.

9.4 Changes to ground conditions as a result of changes to the drainage regime which could affect archaeological remains

9.4.1 The Proposed Development could possibly have an effect on the prevailing local drainage conditions, although the impact of such a change on any buried archaeological deposits is not known and further evaluation should mitigate for this.

9.5 Loss of landscape features, structures and areas with historic and cultural heritage associations

9.5.1 The Proposed Development will impact on visible earthworks (possibly the remains of medieval ploughing).

9.6 Other possible impacts such as noise, vibration, compressions and other changed ground conditions

9.6.1 The groundworks and construction programme associated with the development proposals will have a short-term impact in terms of noise and vibration in the immediate environment of the application site. It is unlikely that these will have an impact on features of archaeological and historic environment importance.

10. Conclusions and Recommendations

10.1 The area of the Proposed Development is farmland, north-west of the town of Pickering.

10.2 There are no sites noted on the Historic Environment Register within the Proposed Development Area.

10.3 The walkover has shown that earthwork remains, which may relate to archaeological features, are present within the Proposed Development Area.

10.4 The assessment has shown no evidence of nationally important remains on the site that would prevent its redevelopment in line with PPG. 16. It is recommended that consideration be given to further evaluation by means of geophysical survey, earthwork survey and trial trenching in order to inform the archaeological curators of the presence, nature, condition, extent and date of any deposits and structures of archaeological significance. This information would enable an appropriate mitigation to be devised in line with Ryedale District Council's Policy C13.

11. References and Bibliography

11.1 Primary Sources

National Monument Register (www.pastscape.org.uk)

North Yorkshire Heritage and Environment Section – Historic Environment Register

Listed Building Register (www.imagesofengland.org.uk)

1854 First Edition Ordnance Survey Map Sheet 91. Scale 1:10560

1893 Second Edition Ordnance Survey Map Sheet 91NW. Scale 1:10560

1913 Ordnance Survey Map Sheets 91NW. Scale 1:10560

1952 Ordnance Survey Map Sheet 91NW. Scale 1:10560

11.2 Secondary Sources

Beresford, M. & Finberg, H. P. R. 1973 English Medieval Boroughs: A Handlist. David and Charles.

Howe, G. and Rushton, J. 1905 The Evolution of an English Town.

IFA 2001 Standard and Guidance for Archaeological Desk Based Assessments. Institute of Field Archaeologists.

Mackney, D et al 1983 Soils of England and Wales. Sheet 1. Northern England. Soils of England and Wales.

Page, W. (ed.) 1968 The Victoria History of the County of York North Riding. Volume 2. Institute of Historical Research. University of London.

Pevsner, N. 1981 The Buildings of England. Yorkshire The North Riding. Penguin.

Smith, A.H. 1979 The Placenames of the North Riding of Yorkshire. English Placename Society. Vol. 5. Cambridge University Press

Snowden, K. 1989 Pickering through the Ages. Castleden Publications.

Williams, A and Martin, G.H. 1992 Domesday Book A Complete Translation. Penguin Books

12. List of Contributors

Desk Based Assessment by Kelly Hunter and Paula Ware

Walkover: Paula Ware

Edited by Paula Ware and Charlotte Ware

Drawings by Kelly Hunter

Plates, administration, filing, copying and binding by Sophie Langford



With Permission of the Controller
of Her Majesty's Stationary Office
© Crown Copyright
License No. AL50453A

MAP

Archaeological Consultancy Ltd.

SITE: Land at Swainsea Lane, Pickering, North Yorkshire

CLIENT: Bramhall Blenkham Architects.

TITLE: Site Location.

Figure 1.

Scale: 1:50,000

DRAWING REF.:

DRAWN BY: KCH

REVISIONS:

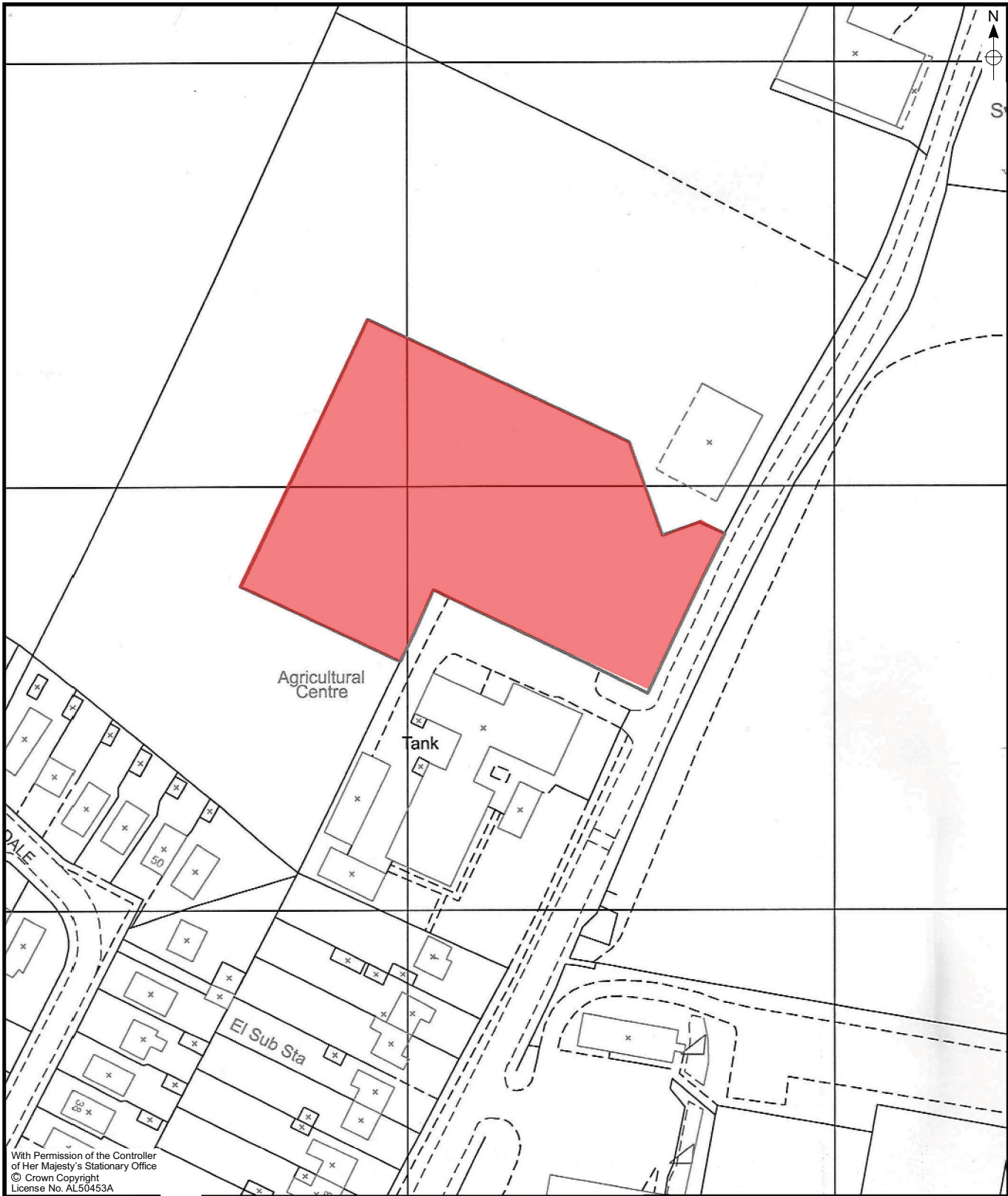

With Permission of the Controller
of Her Majesty's Stationary Office
© Crown Copyright
License No. AL50453A

MAP

Archaeological Consultancy Ltd.

SITE: Land at Swainsea Lane, Pickering, North Yorkshire

CLIENT: Bramhall Blenkham Architects.

TITLE: Proposed Development Area.

Figure 2.

Scale: 1:1,250

DRAWING REF.:

DRAWN BY: KCH

REVISIONS:

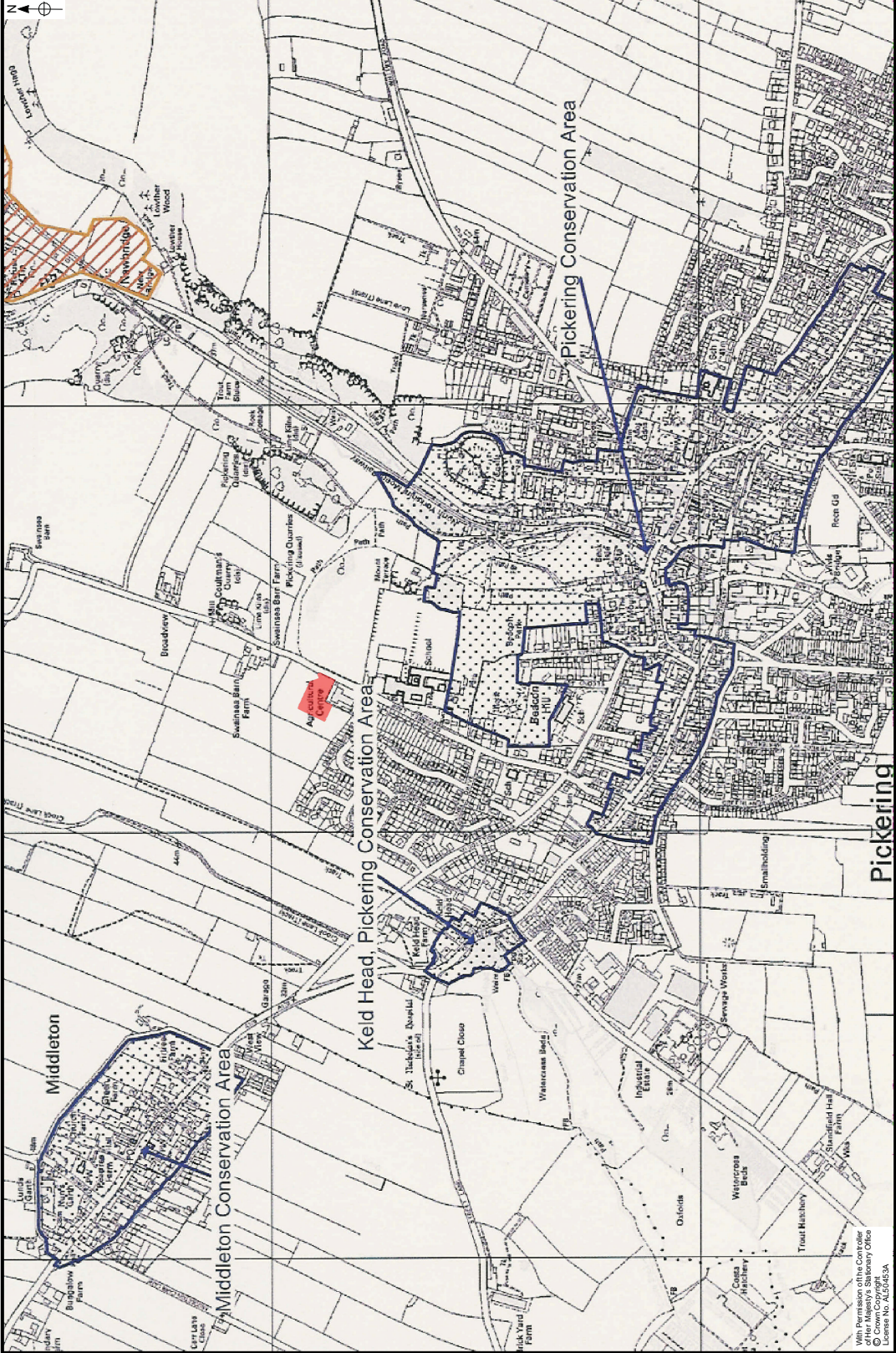

MAP

Archaeological Consultancy Ltd.

SITE: Land at Swainsea Lane, Pickering, North Yorkshire

CLIENT: Bramhall Blenkharn Architects.

TITLE: Location of the Designated Conservation Areas.

Figure 3.	Scale: 1:10,000
DRAWING REF.:	
DRAWN BY: KCH	
REVISIONS:	

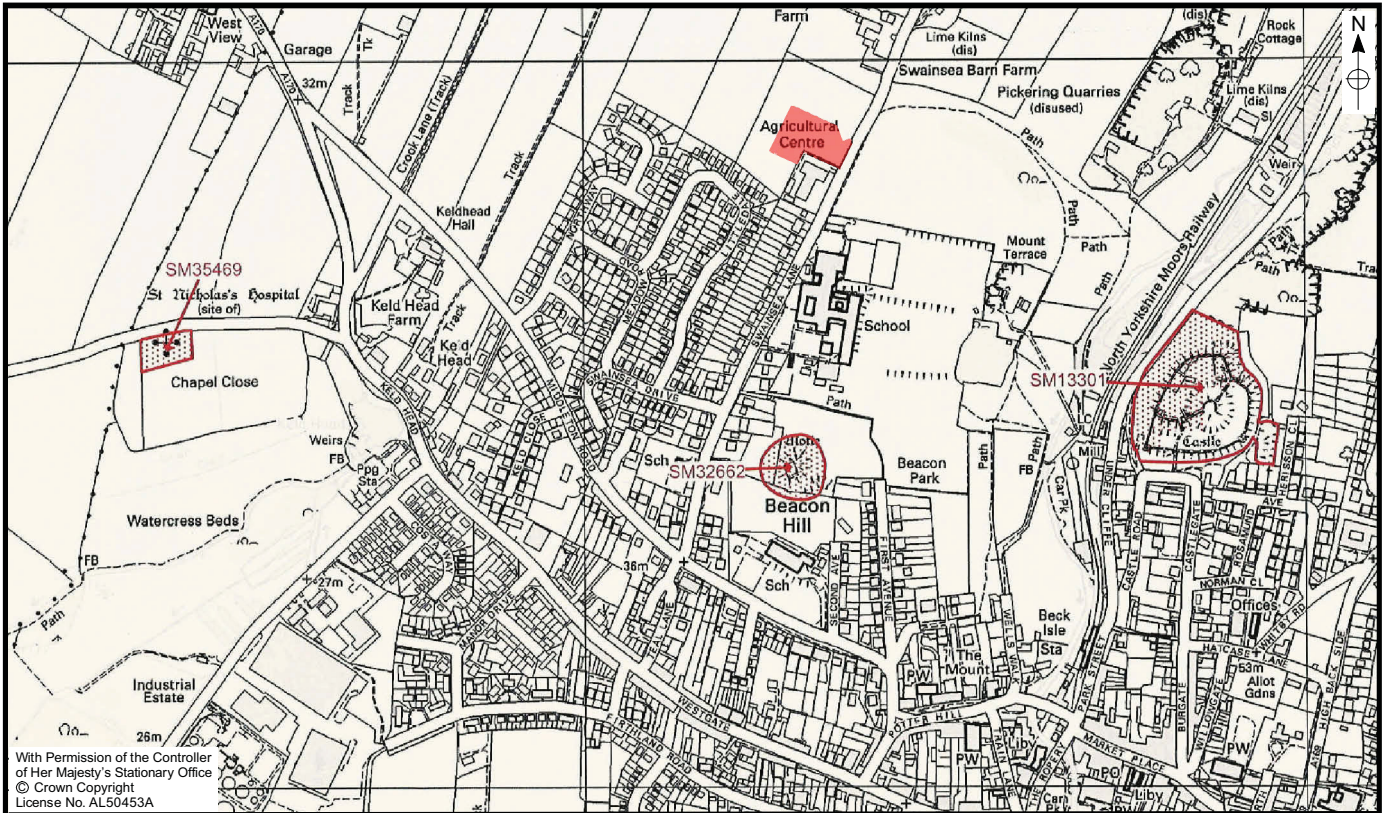

MAP

Archaeological Consultancy Ltd.

SITE: Land at Swainsea Lane, Pickering, North Yorkshire

CLIENT: Bramhall Blenkham Architects.

TITLE: Location of The Scheduled Monuments.

Figure 4.

Scale: 1:10,000

DRAWING REF.:

DRAWN BY: KCH

REVISIONS:

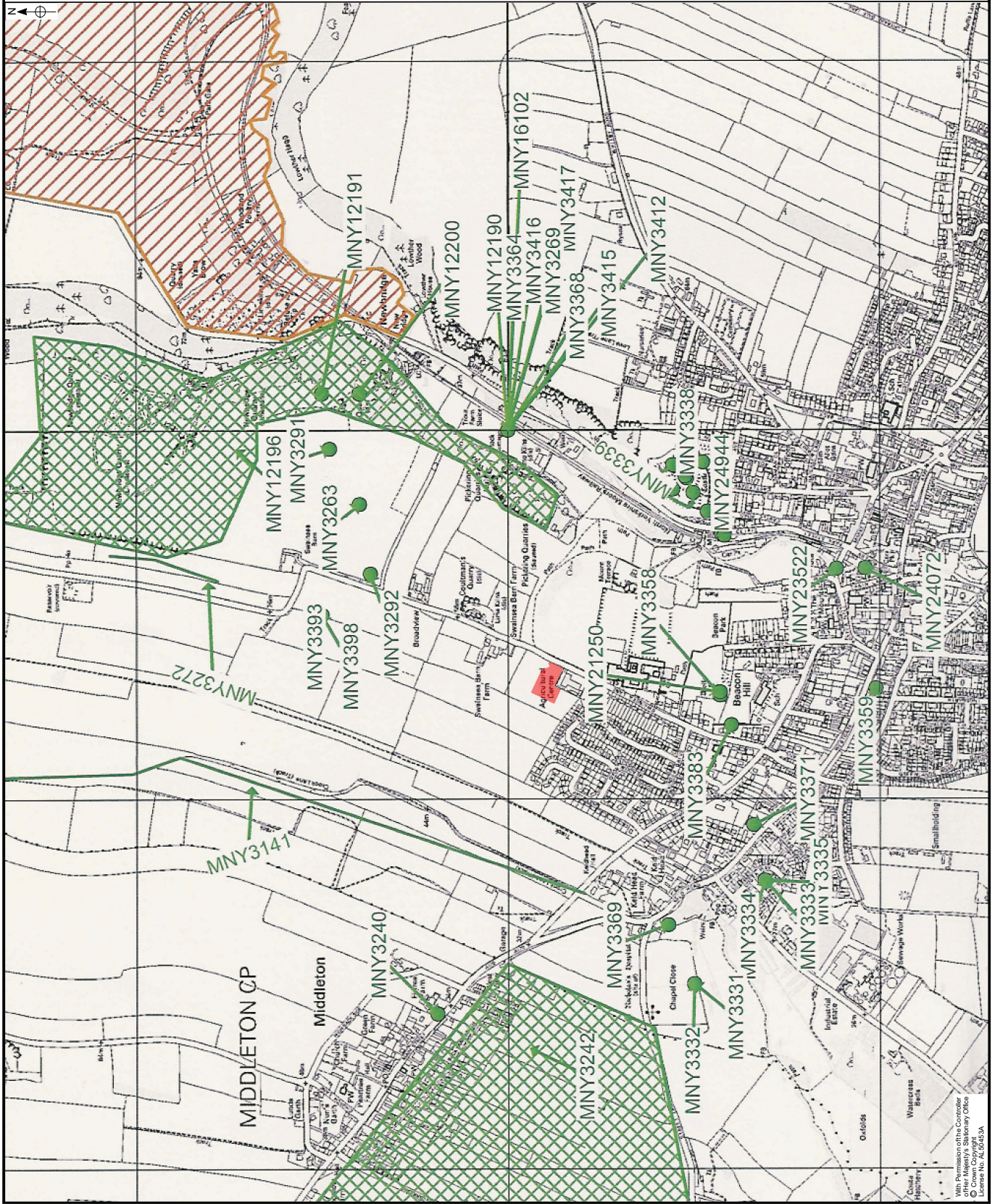

MAP

Archaeological Consultancy Ltd.

SITE: Land at Swainsea Lane, Pickering, North Yorkshire

CLIENT: Bramhall Blenkharn Architects.

TITLE: Sites and Finds on the North Yorkshire HER.

Figure 5. Scale: 1:10,000

DRAWING REF:

DRAWN BY: KOH

REVISIONS:

With Permission of the Controller
 of the Ordnance Survey
 © Crown Copyright
 License No. AL50453A

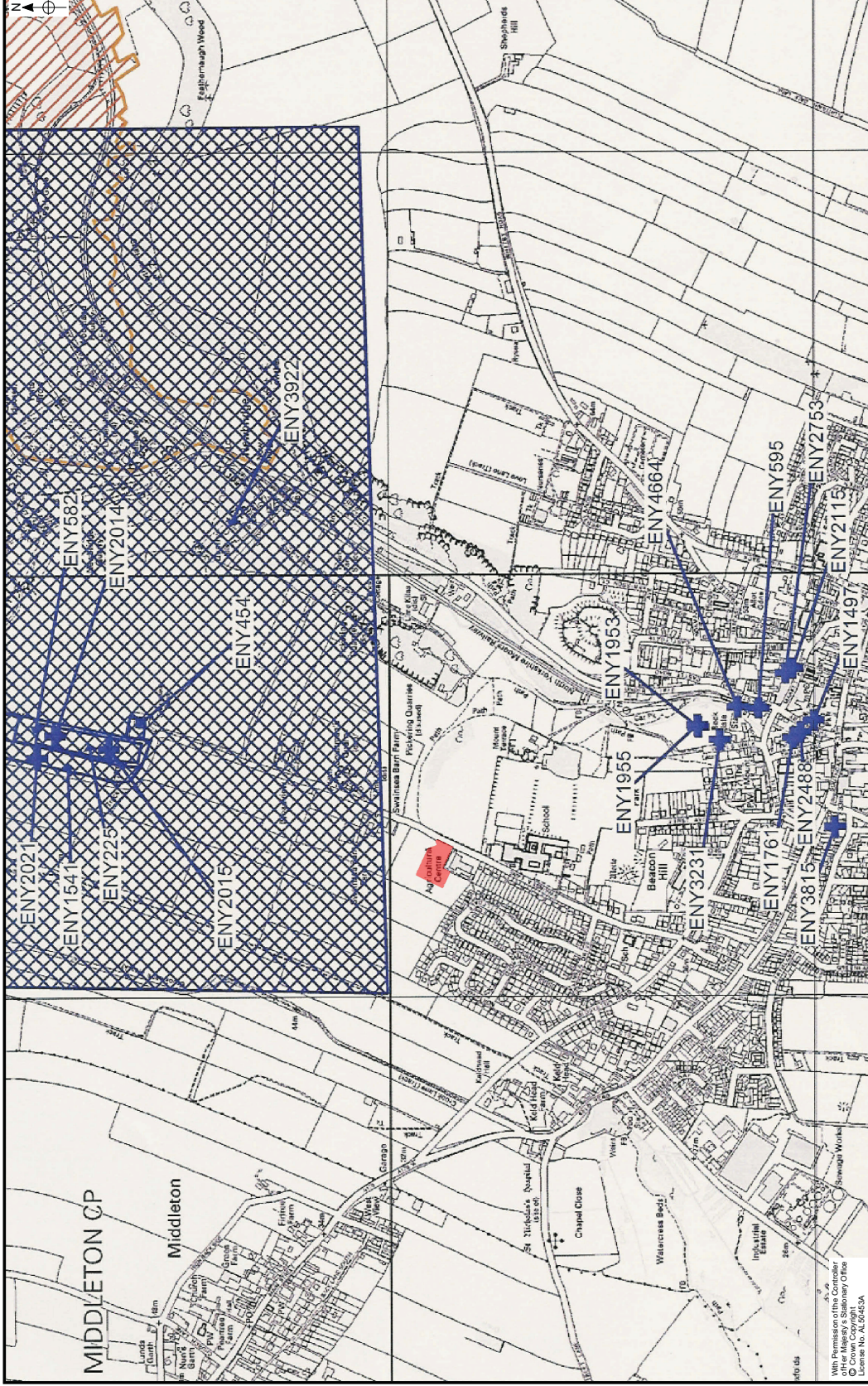

MAP

Archaeological Consultancy Ltd.

SITE: Land at Swainsea Lane, Pickering, North Yorkshire

CLIENT: Bramhall Blenkham Architects.

TITLE: Archaeological Reports on the North Yorkshire HER.

Figure 6. Scale: 1:10,000

DRAWING REF.:

DRAWN BY: KCH

REVISIONS:

With Permission of the Controller
 © Crown Copyright
 License No. AL 97453A

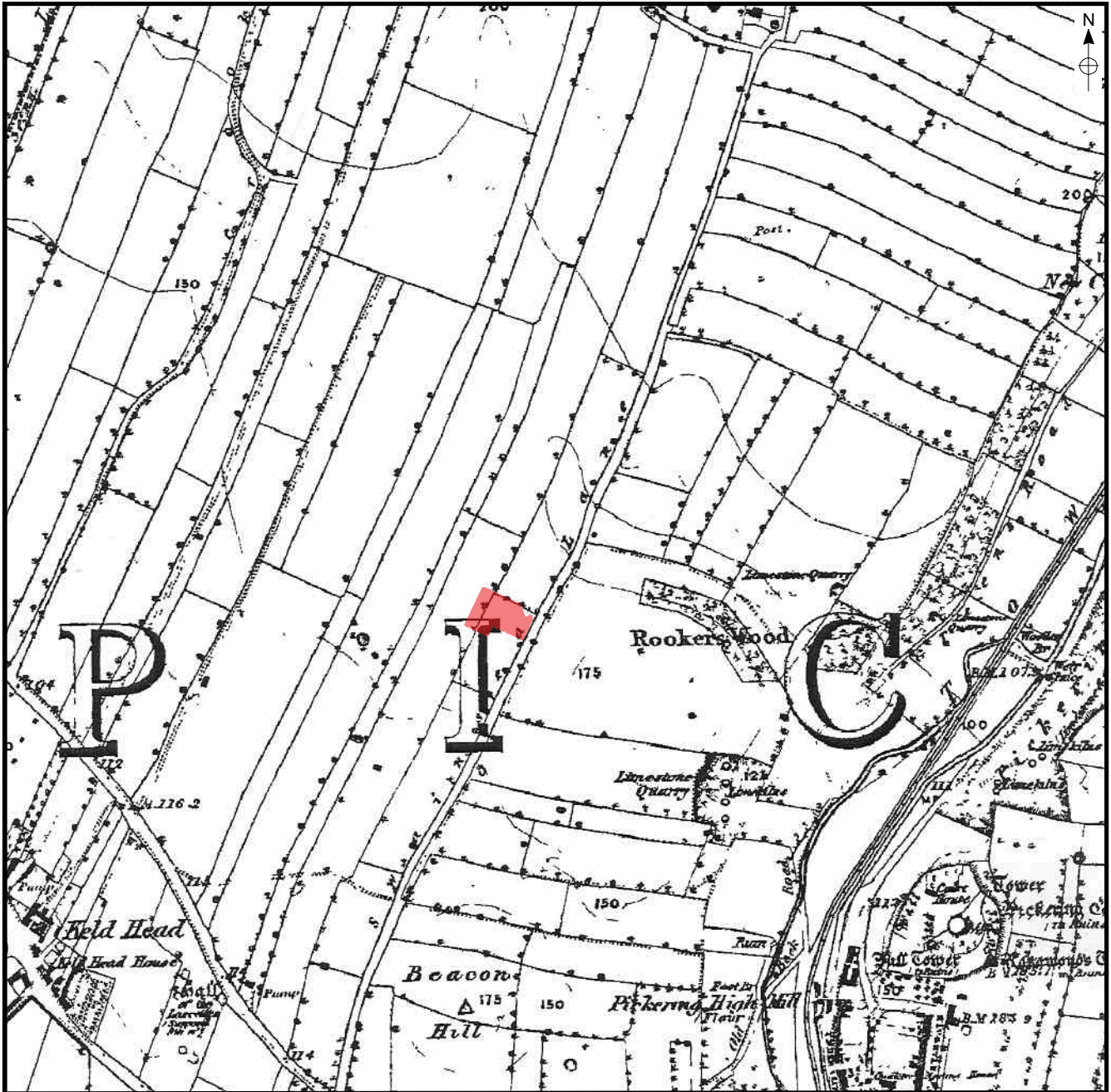

MAP

Archaeological Consultancy Ltd.

SITE: Land at Swainsea Lane, Pickering, North Yorkshire

CLIENT: Bramhal Blenkham Architects.

TITLE: Extract from the 1854 First Edition Ordnance Survey Map.

Figure 7.

Scale: 1:10,560

DRAWING REF.:

DRAWN BY: KCH

REVISIONS:



MAP

Archaeological Consultancy Ltd.

SITE: Land at Swainsea Lane, Pickering, North Yorkshire

CLIENT: Bramhal Blenkhams Architects.

TITLE: Extract from the 1893 Edition Ordnance Survey Map.

Figure 8.

Scale: 1:10,560

DRAWING REF.:

DRAWN BY: KCH

REVISIONS:



MAP

Archaeological Consultancy Ltd.

SITE: Land at Swainsea Lane, Pickering, North Yorkshire

CLIENT: Bramhal Blenkham Architects.

TITLE: Extract from the 1913 Edition Ordnance Survey Map.

Figure 9.

Scale: 1:10,560

DRAWING REF.:

DRAWN BY: KCH

REVISIONS:



MAP

Archaeological Consultancy Ltd.

SITE: Land at Swainsea Lane, Pickering, North Yorkshire

CLIENT: Bramhal Blenkhams Architects.

TITLE: Extract from the 1952 Edition Ordnance Survey Map.

Figure 10.

Scale: 1:10,560

DRAWING REF.:

DRAWN BY: KCH

REVISIONS:



Plate 1. General View of Site. Facing North-west.



Plate 2. General View of Site. Facing North-west.



Plate 3. Swainsea Lane. Facing South.



Plate 4. Swainsea Lane. Facing North.



Plate 5. Proposed Site Entrance. Facing West.



Plate 6. Barn. Facing North.