

Figure 26: SCA8: location of Iron Age features in the eastern part of the site

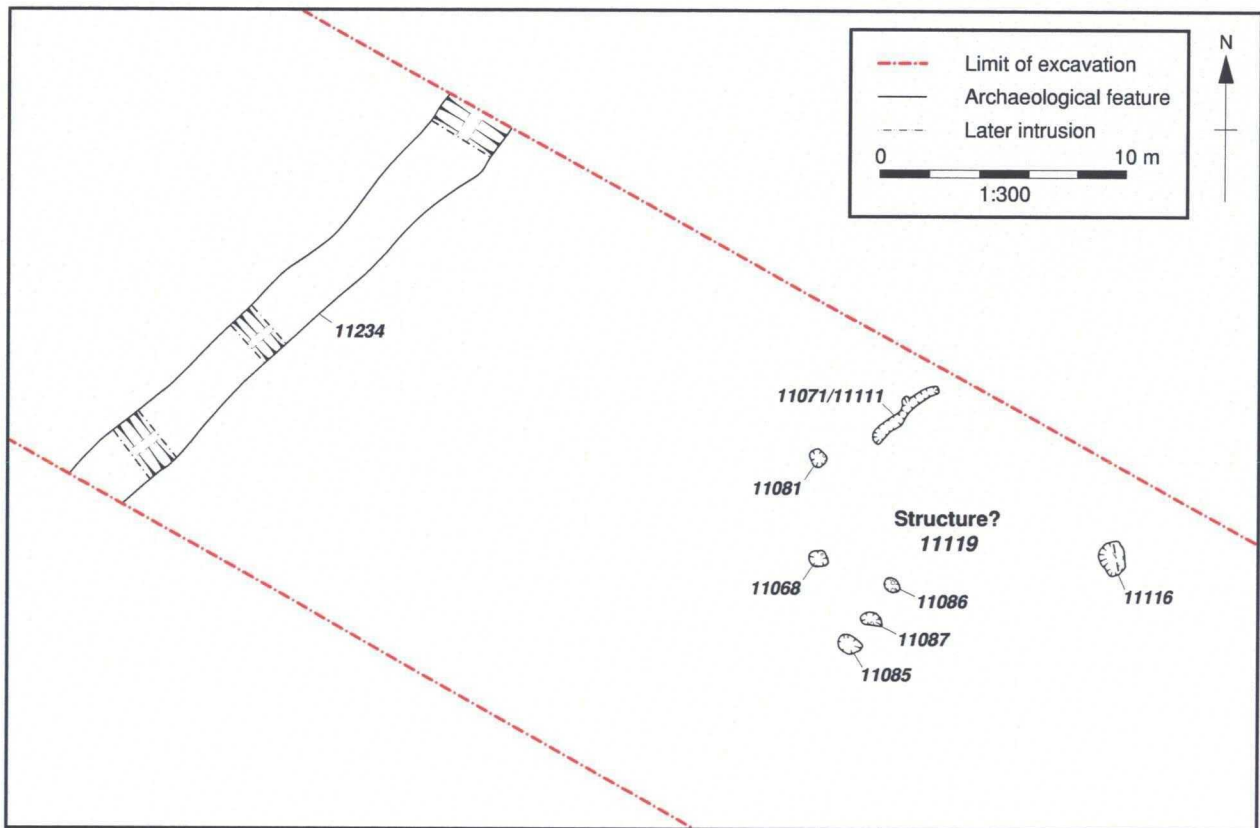

Figure 27: SCA8: ditch 11234 and possible Structure 11119 in the eastern part of the site

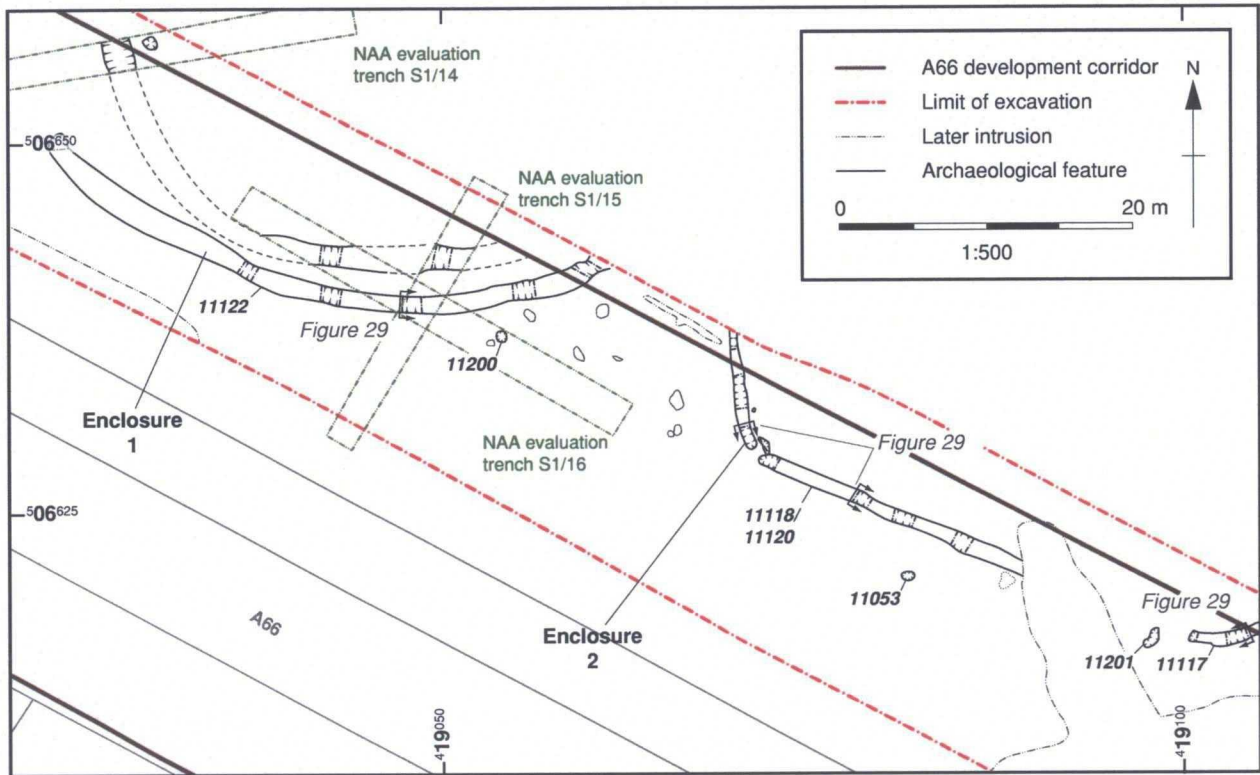

Figure 28: SCA8: Enclosures 1 and 2 and adjacent features at the eastern end of the site

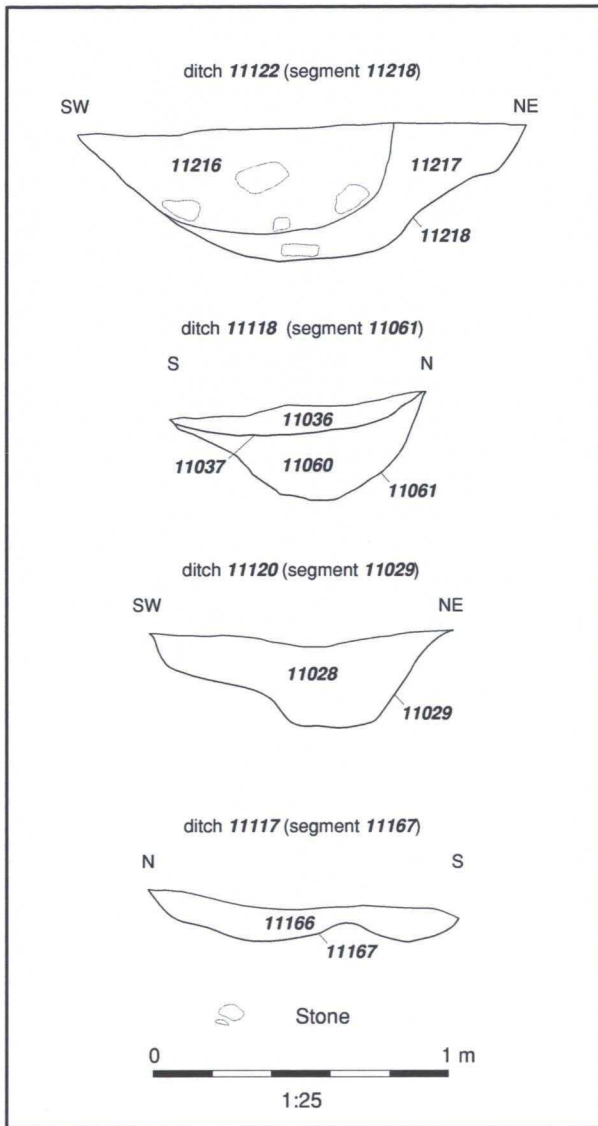

Figure 29: SCA8: Enclosures 1 and 2: sections through enclosure ditches 11118/11120, 11122, and 11117

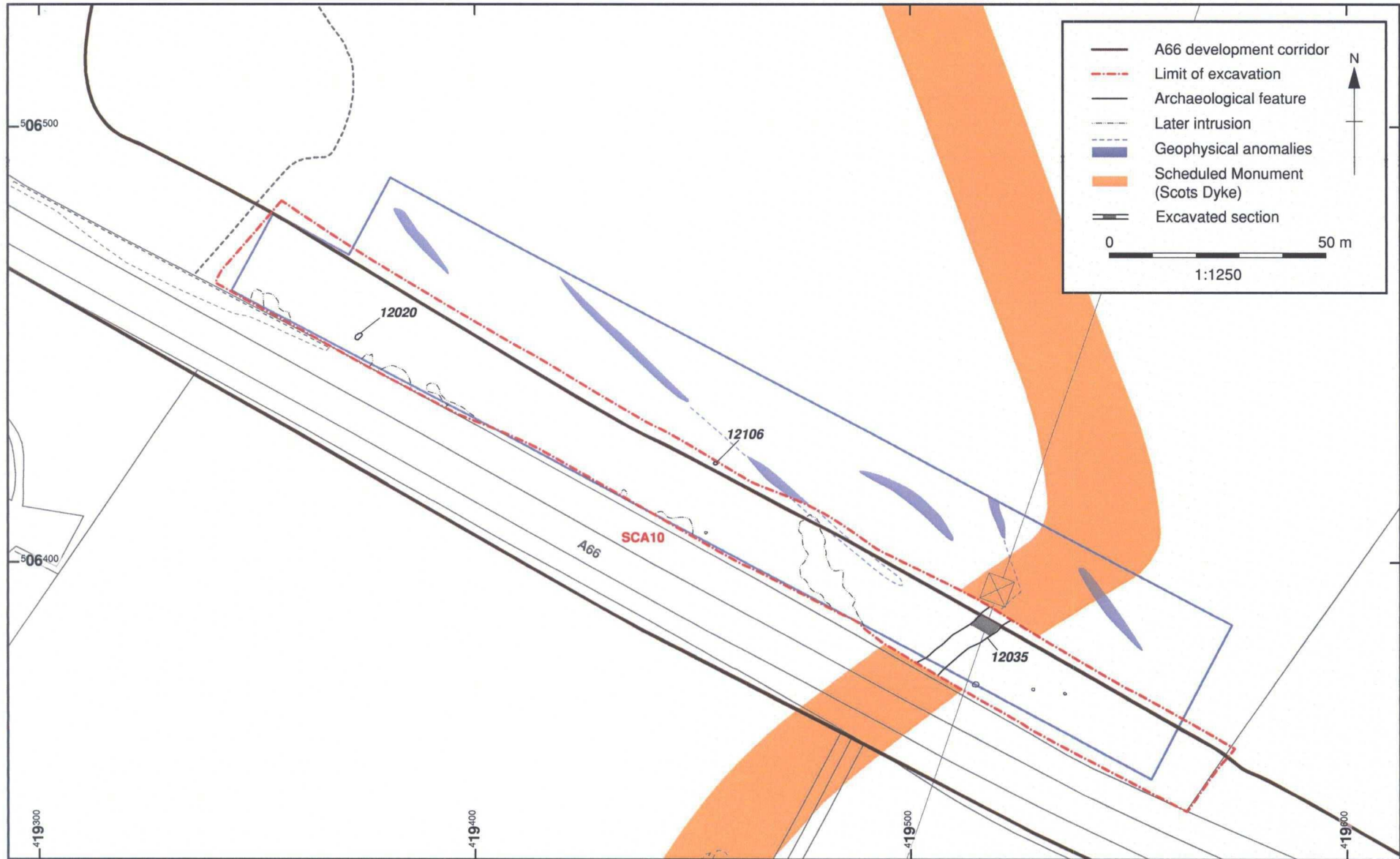

Figure 30: SCA10: location of Iron Age features, including the Scots Dyke ditch (12035)

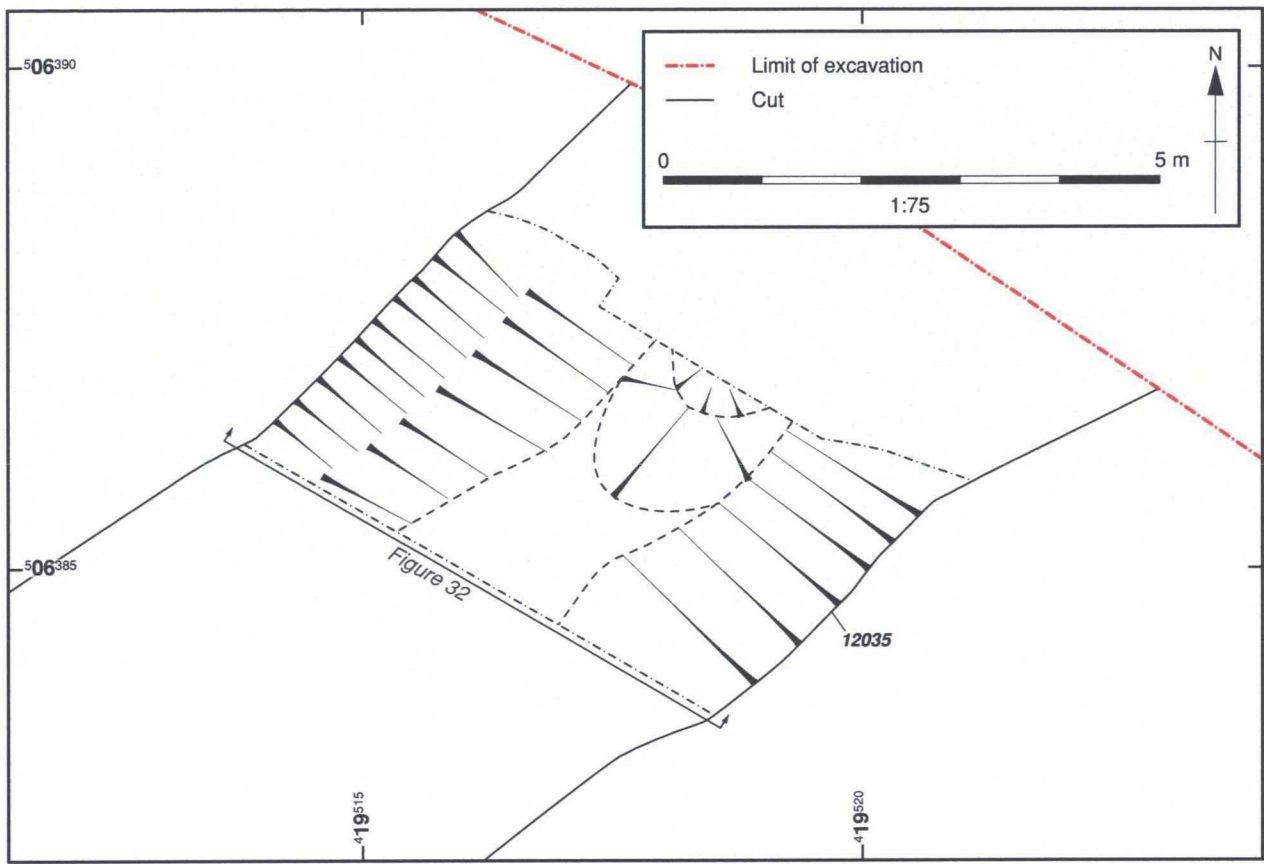

Figure 31: SCA10: the Scots Dyke ditch (12035)

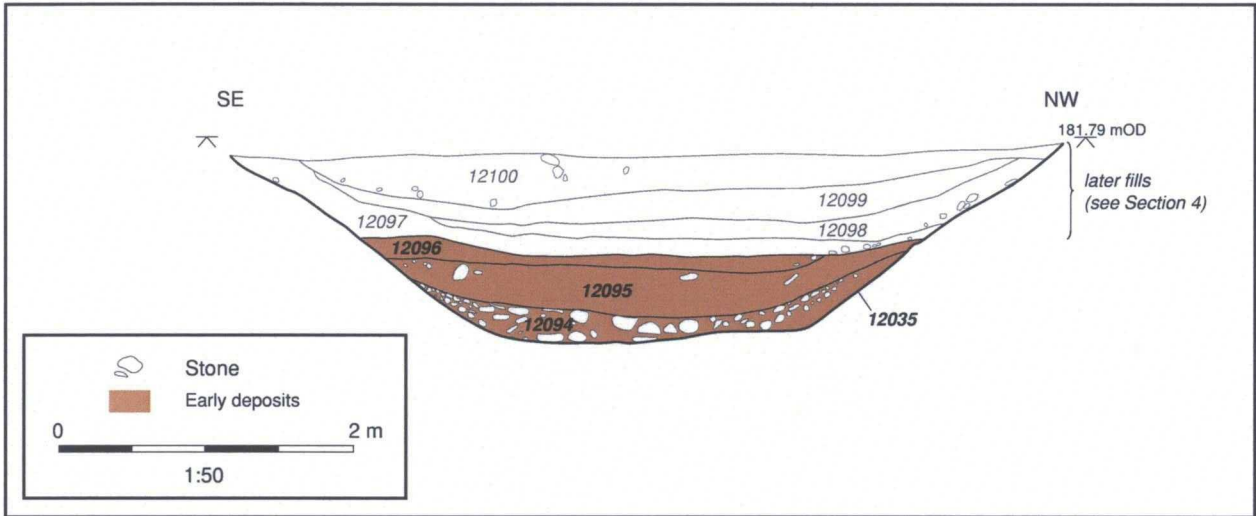

Figure 32: SCA10: section through the Scots Dyke ditch (12035), highlighting the lower fills

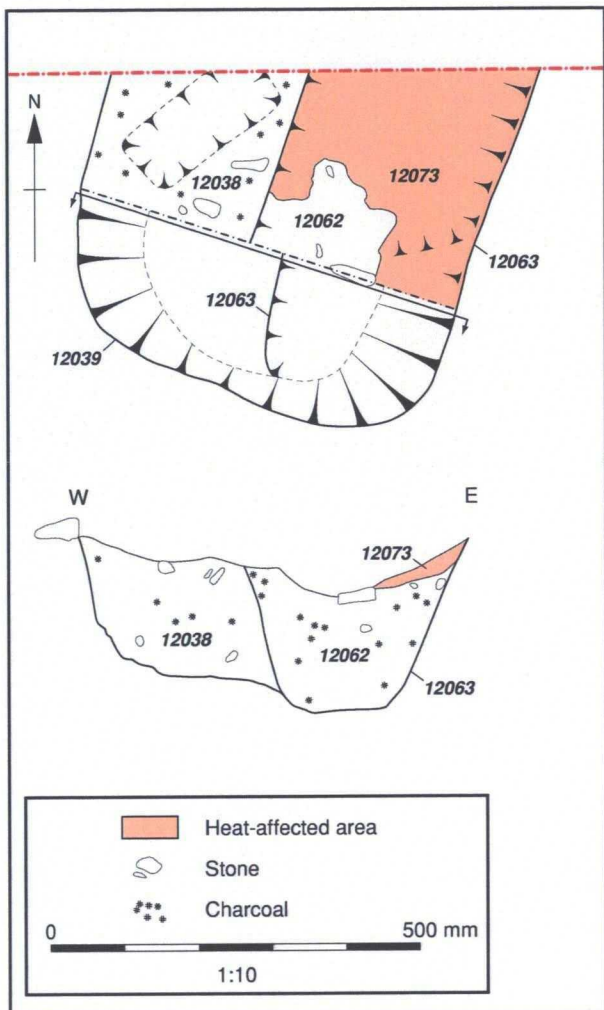

Figure 33: SCA10: probable metalworking hearth 12106



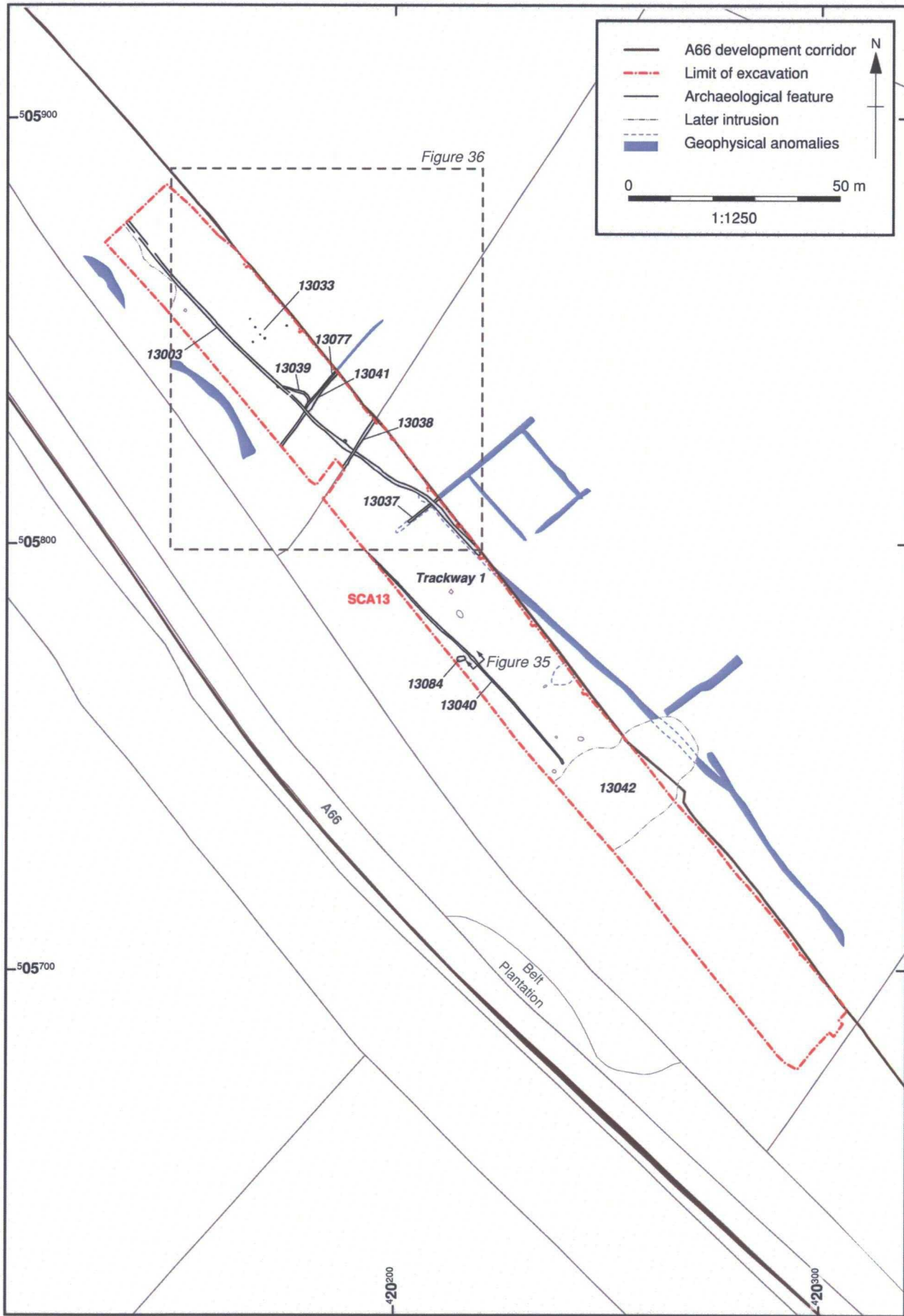

Figure 34: SCA13: location of possible and probable Iron Age features

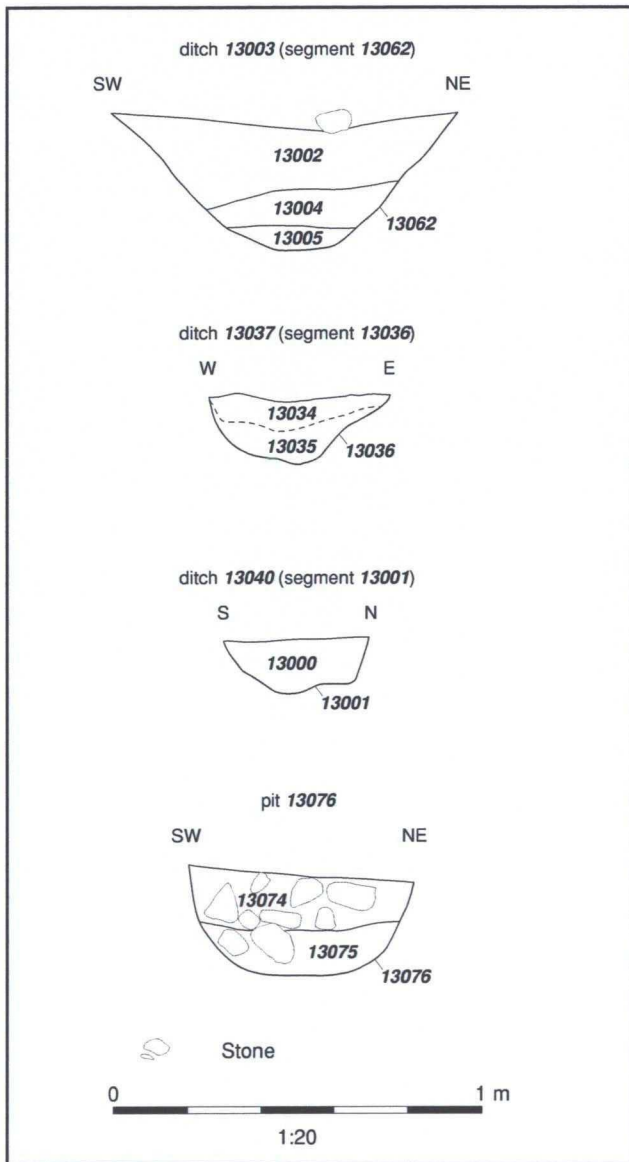

Figure 35: SCA13: sections of possible and probable Iron Age ditches 13003, 13037 and 13040, and pit 13076

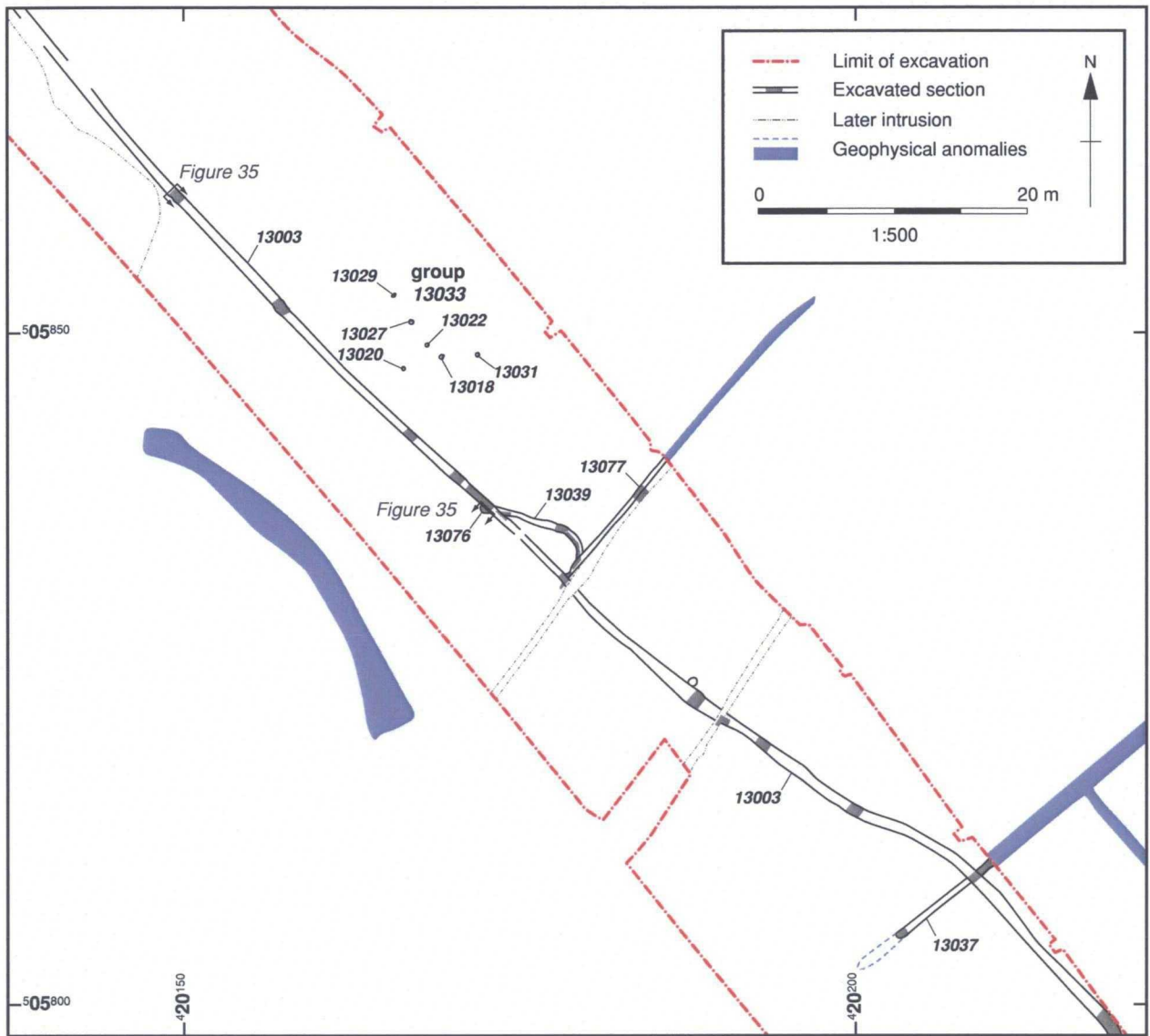

Figure 36: SCA13: the north-western end of the site, showing a concentration of features

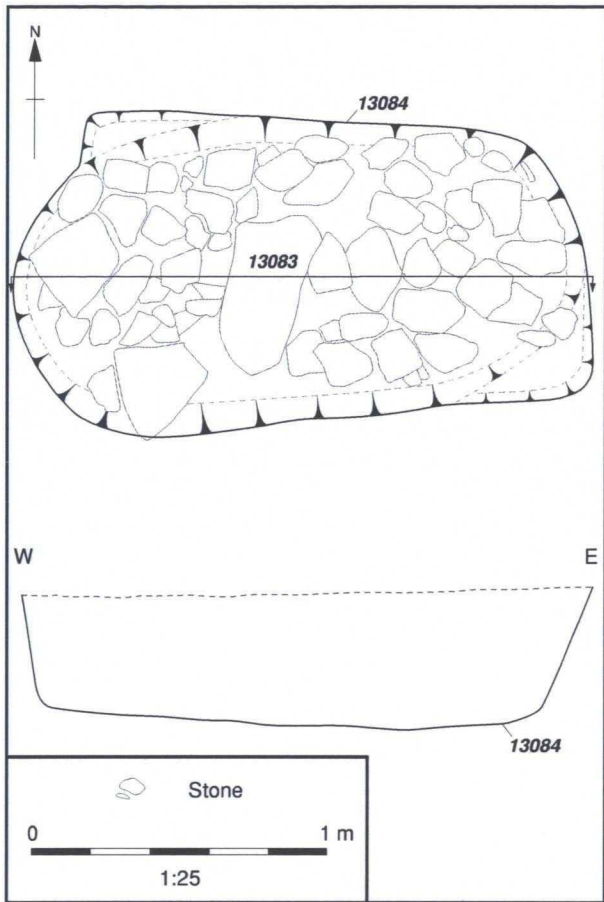

Figure 37: SCA13: stone-filled feature 13084

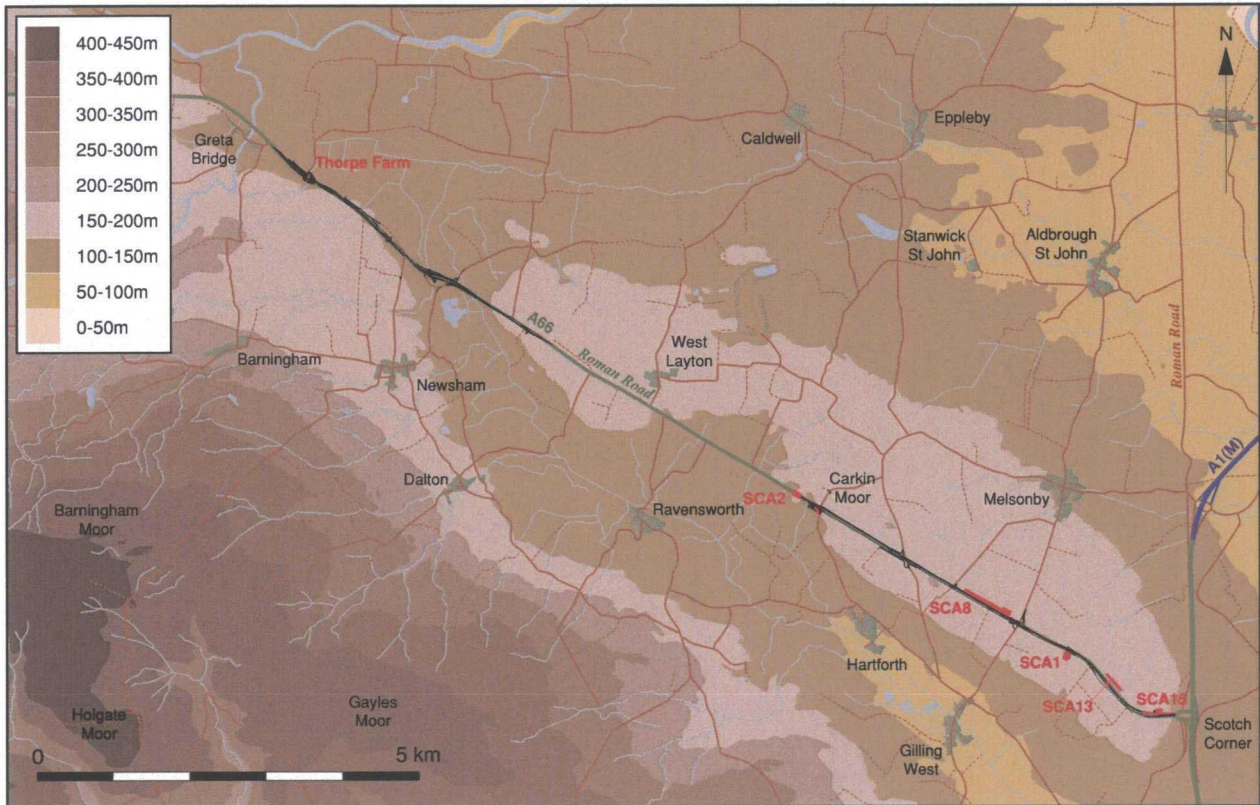

Figure 38: Location of late Iron Age/Romano-British sites

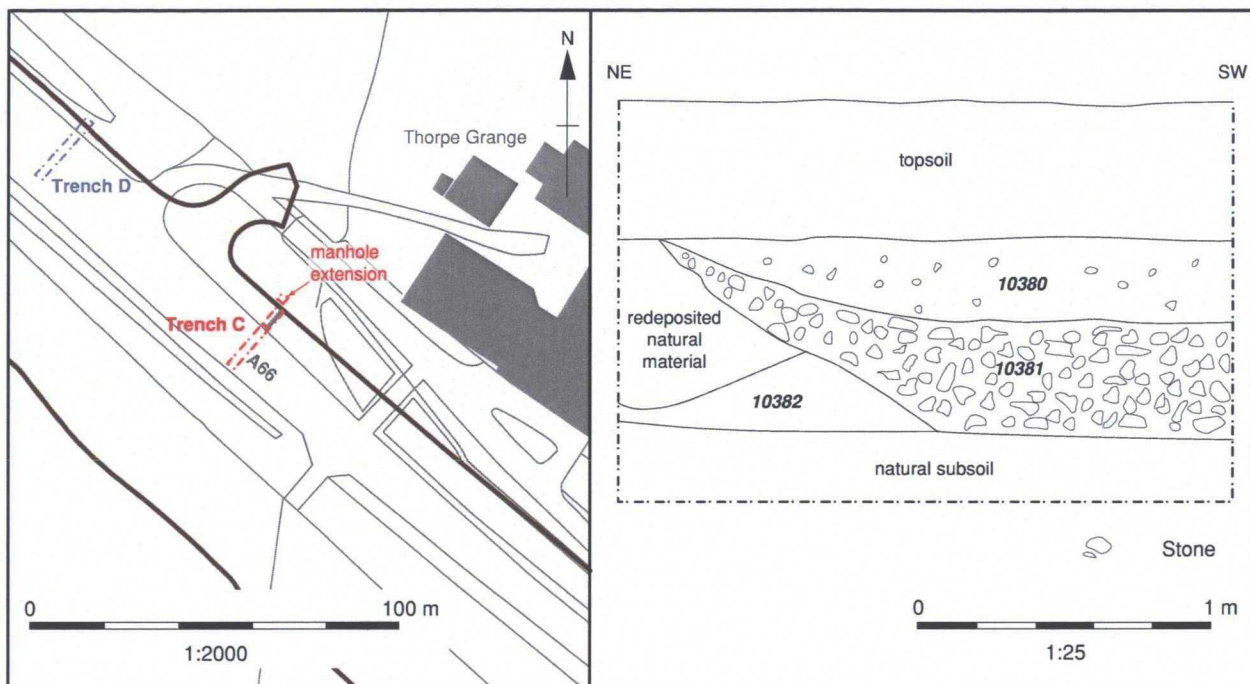

Figure 39: Thorpe Farm cross-carriageway trenches: section through possible Roman road deposits exposed in a manhole at the north end of Trench C

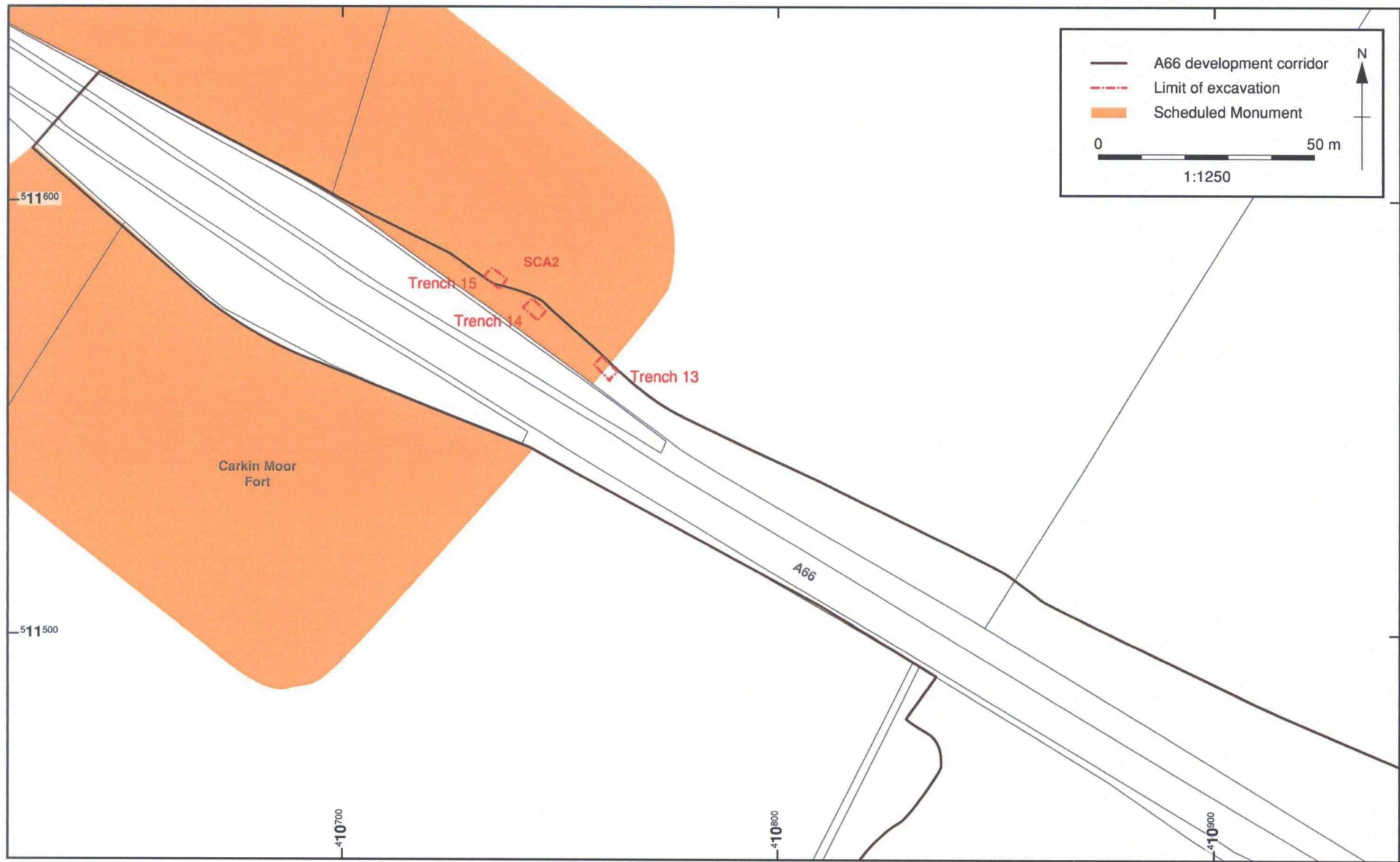

Figure 40: SCA2: location of Trenches 13, 14, and 15 relative to the Scheduled Monument of Carkin Moor fort

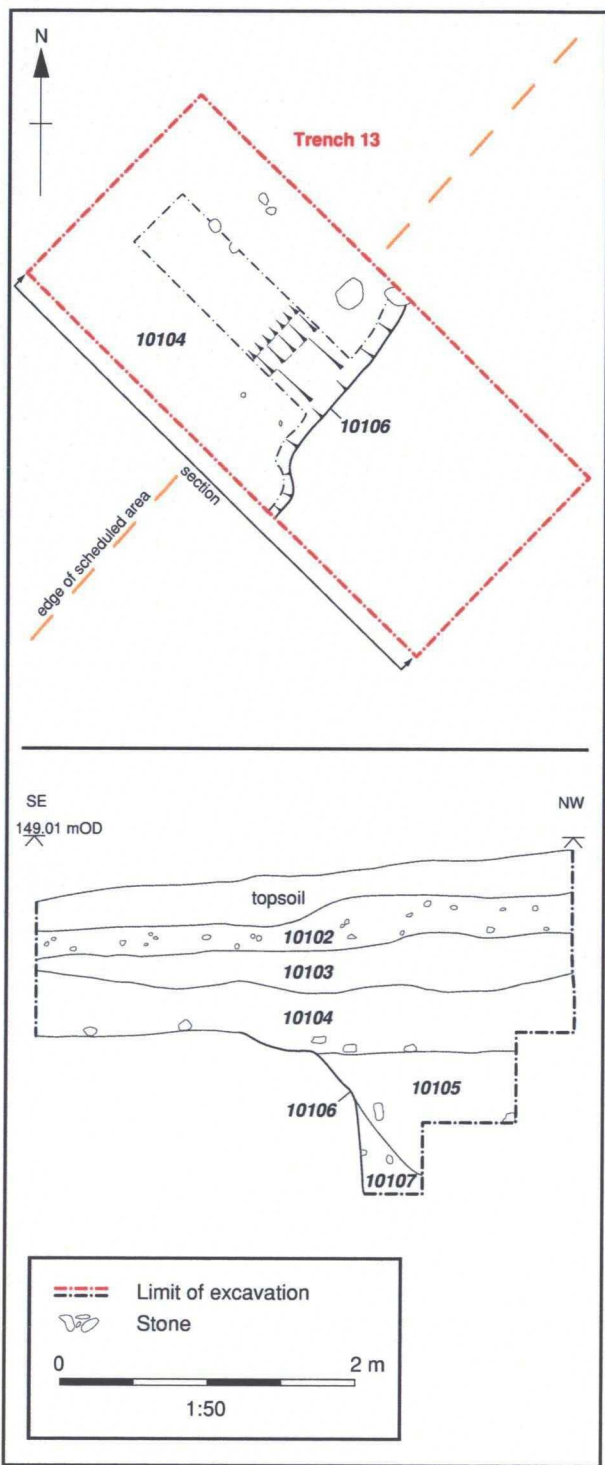

Figure 41: SCA2: Trench 13, plan and section of ditch 10106



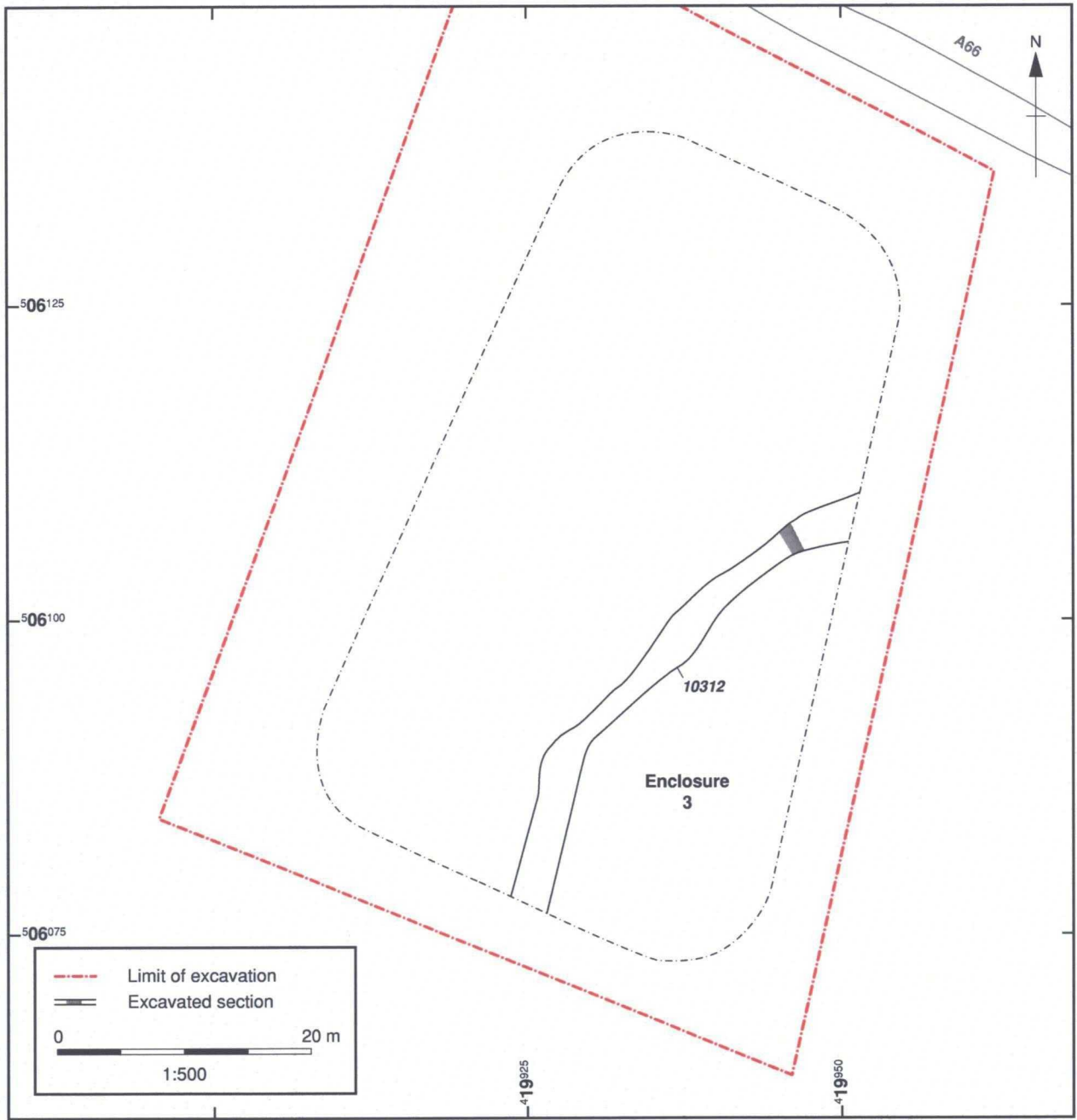

Figure 42: SCA1: Enclosure 3

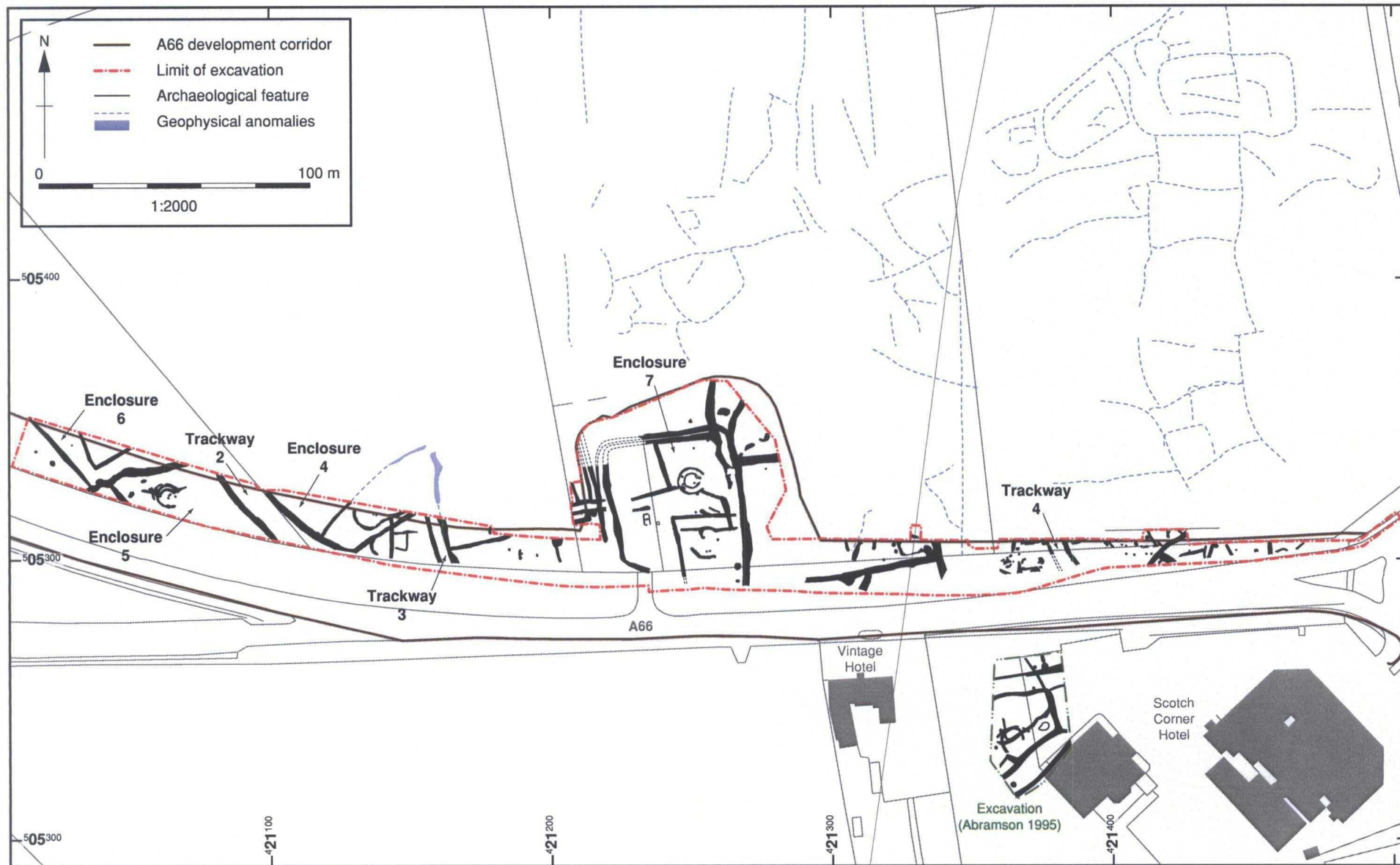

Figure 43: SCA15, showing the extent of excavated archaeological features

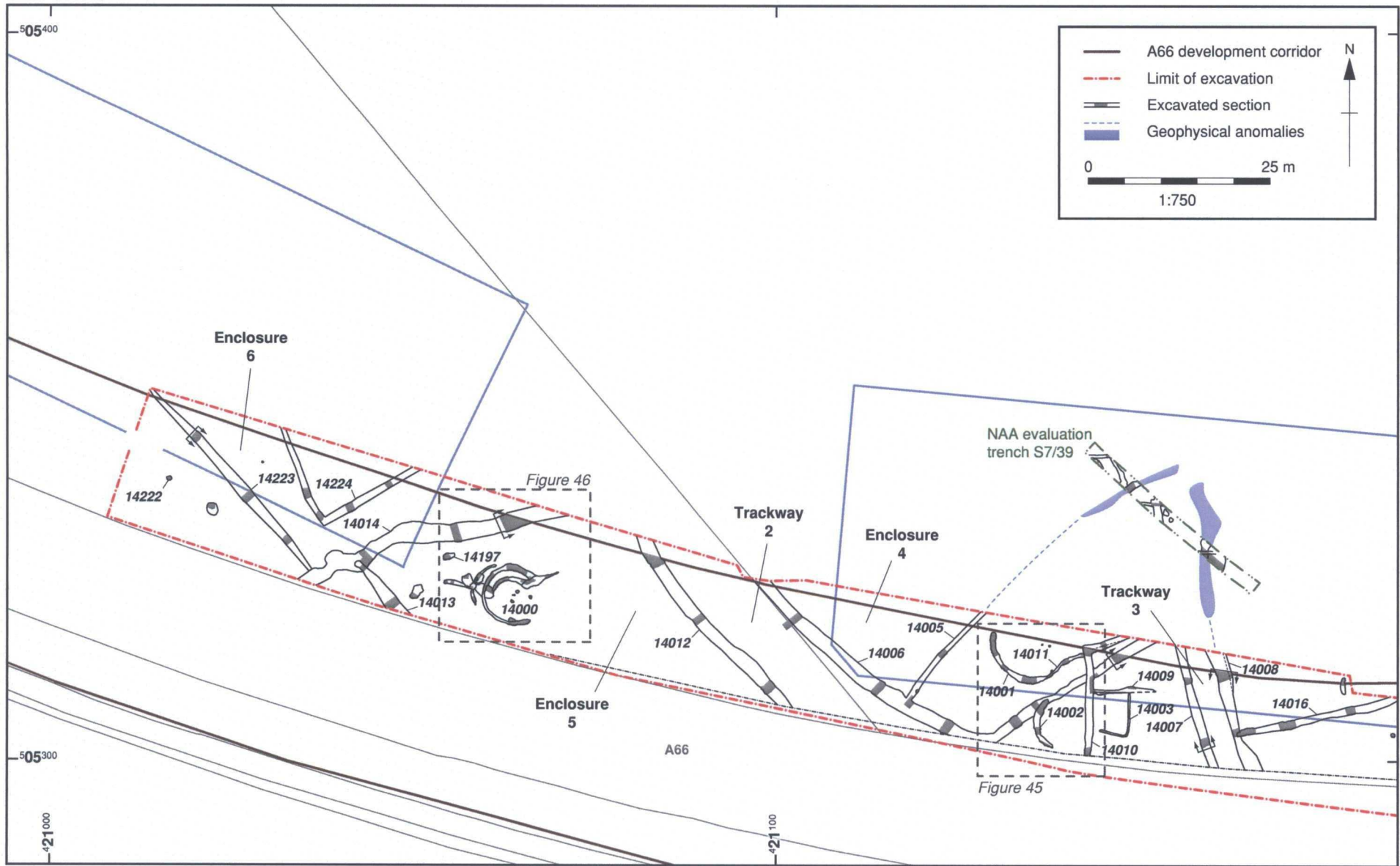

Figure 44: SCA15: the western part of the site

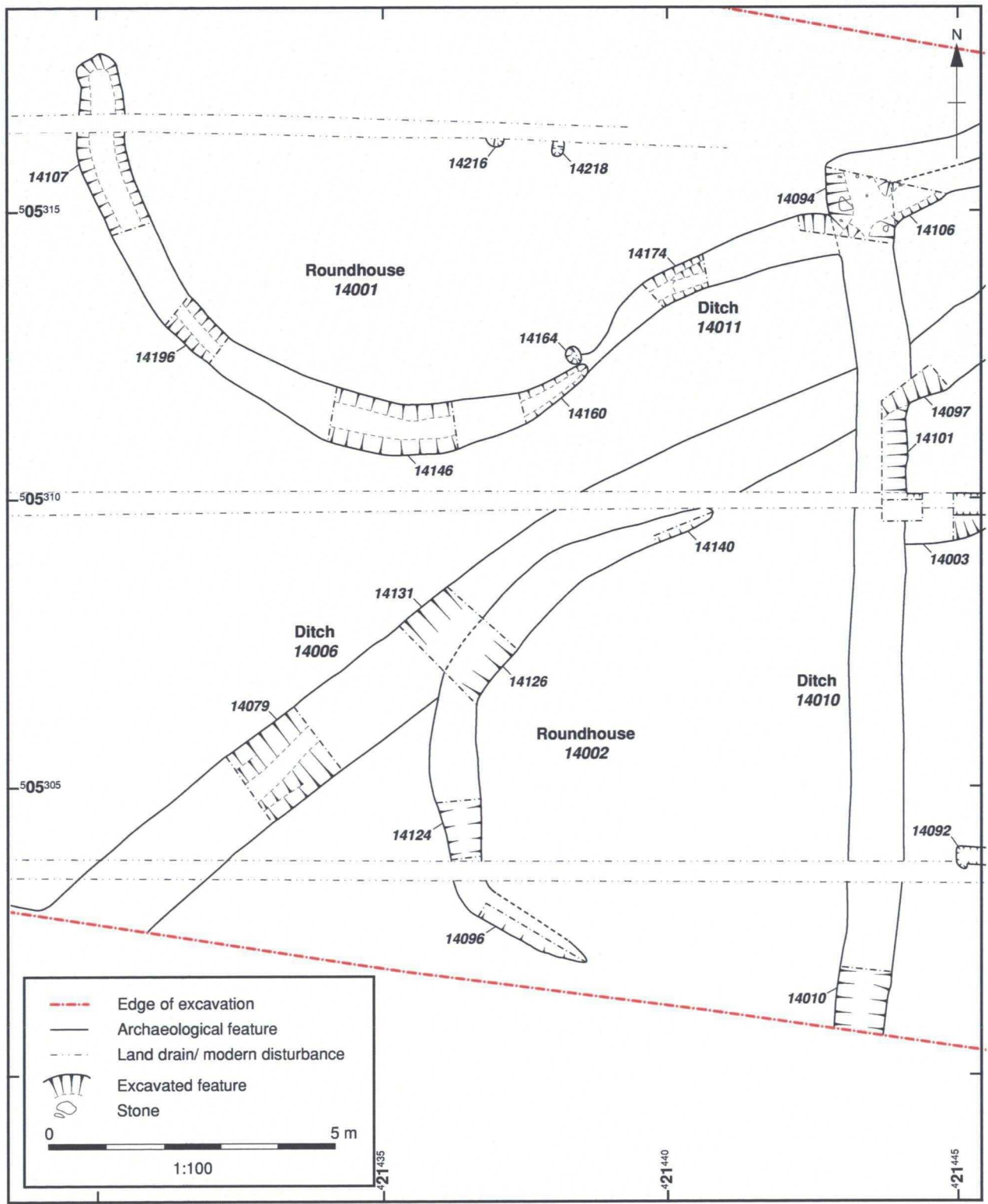

Figure 45: SCA15: roundhouses 14001 and 14002 and adjacent features

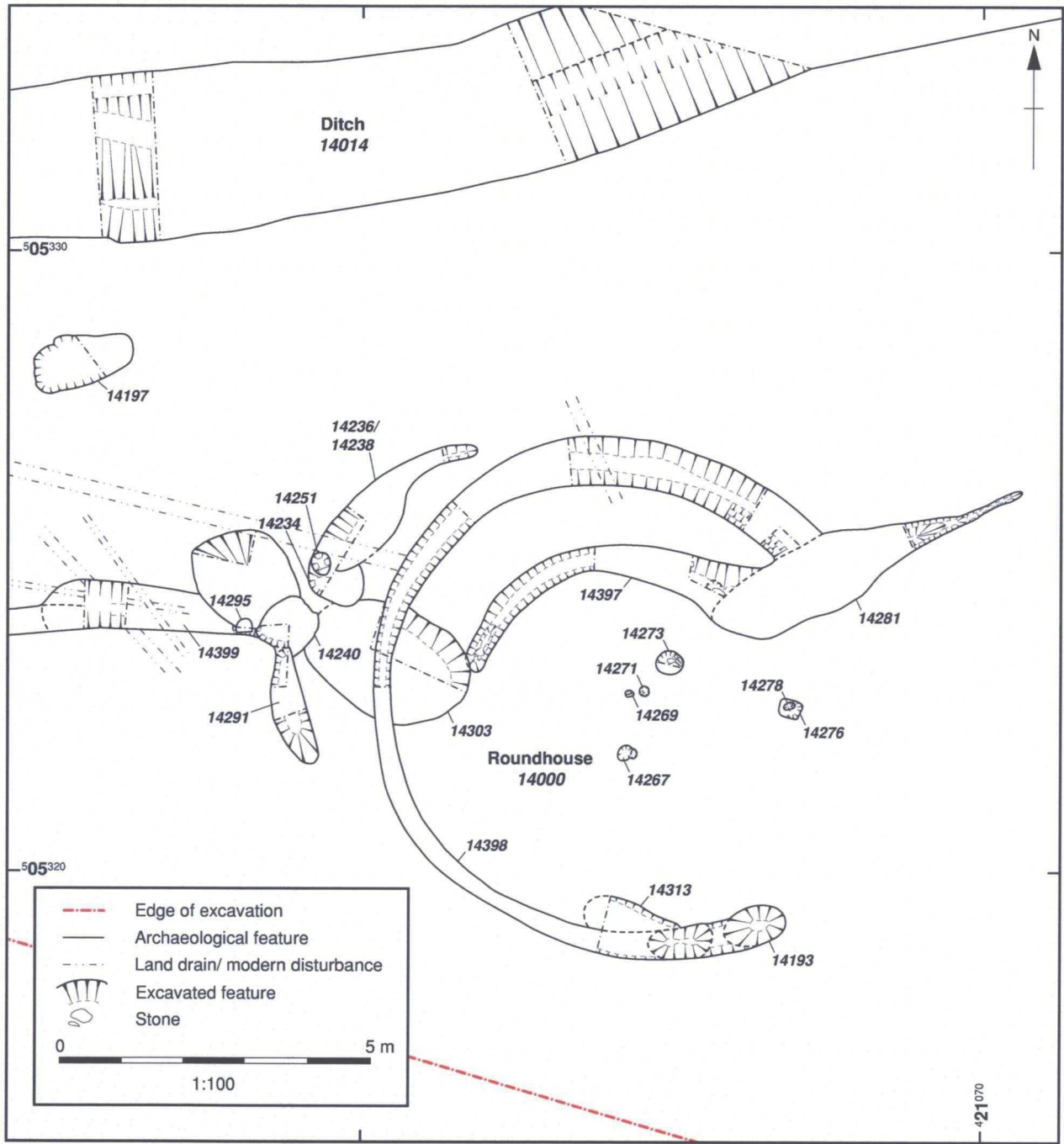

Figure 46: SCA15: roundhouse 14000 and adjacent features

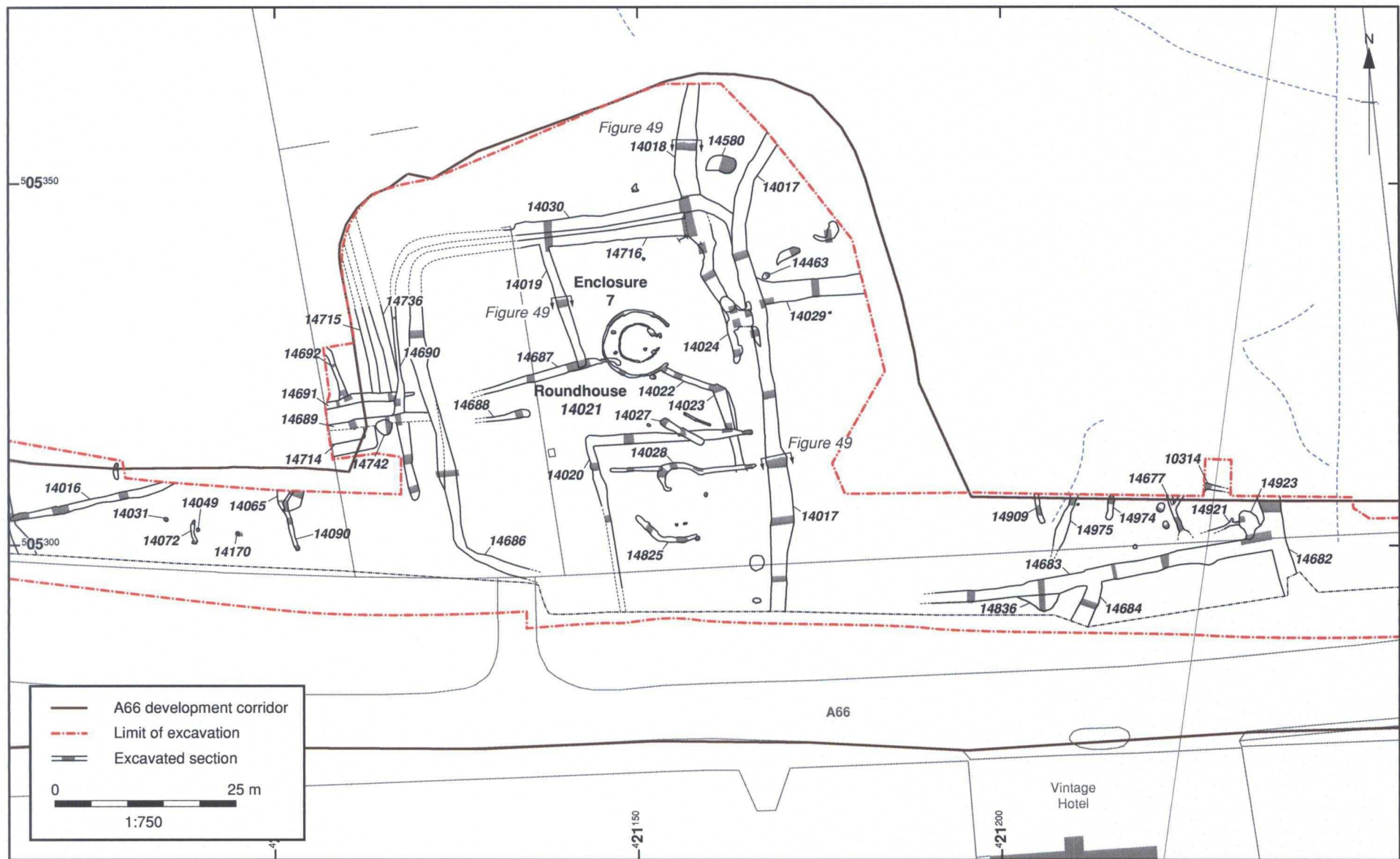

Figure 47: SCA15: Enclosure 7 and adjacent features

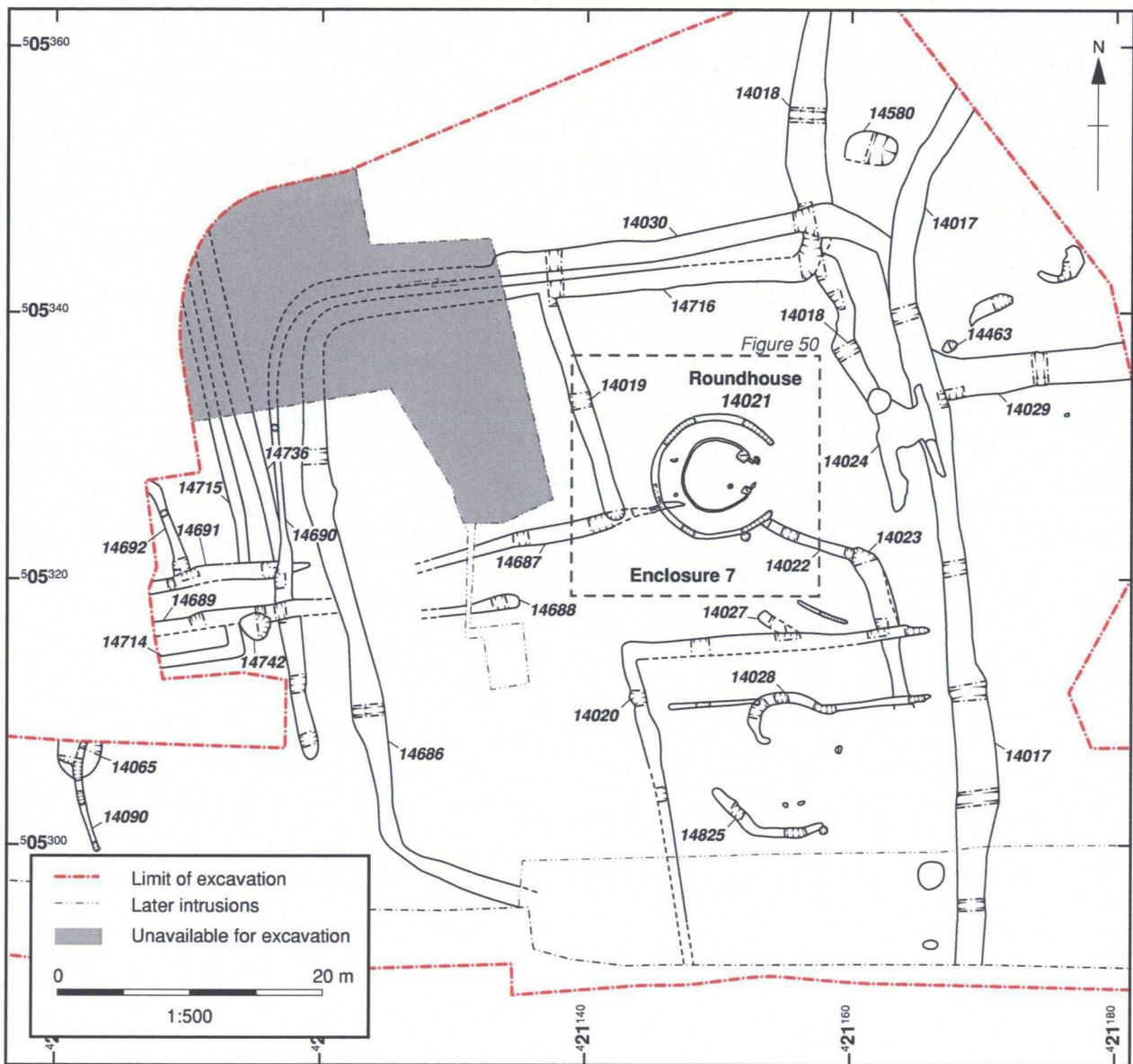

Figure 48: SCA15: detail of Enclosure 7

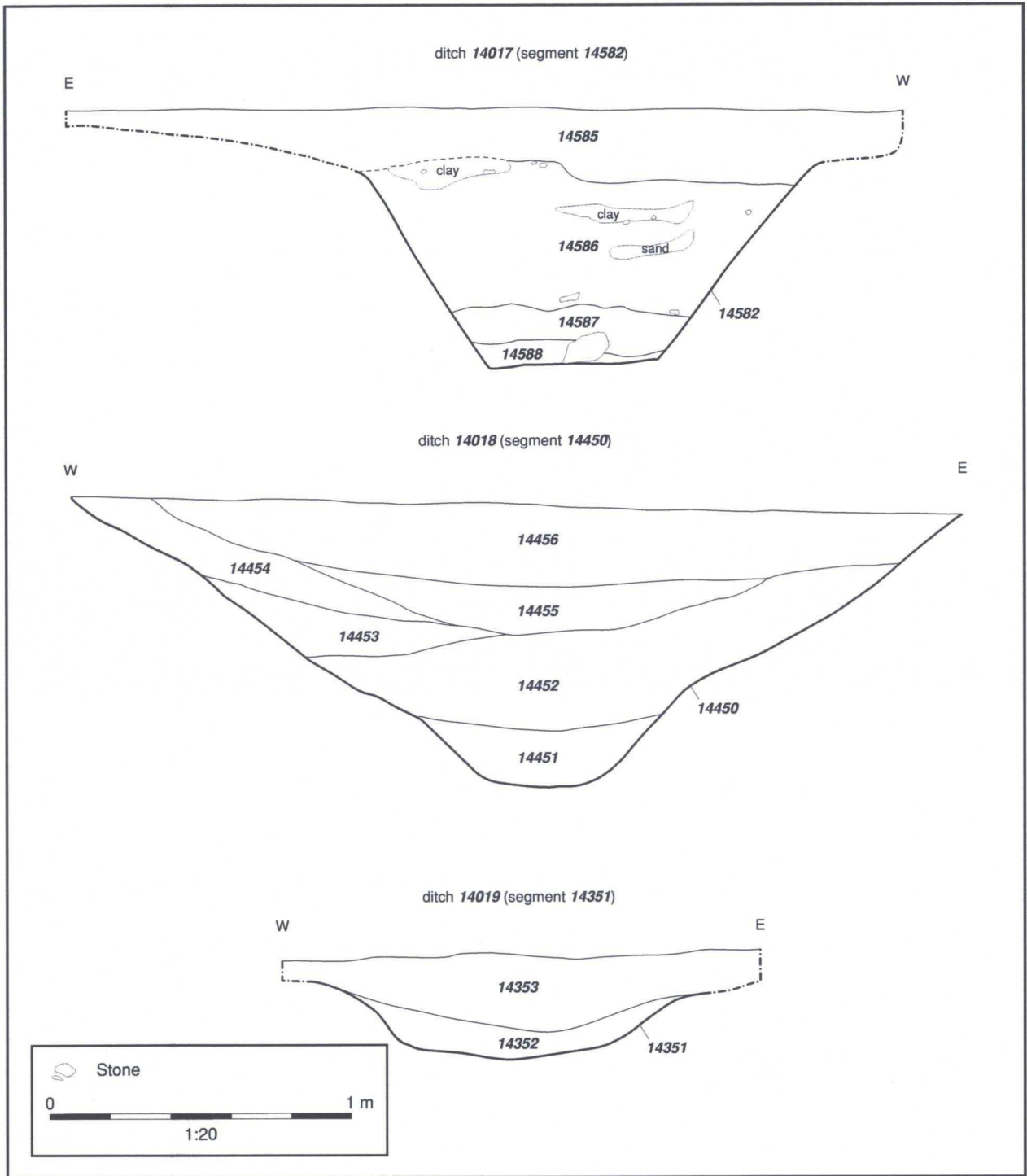

Figure 49: SCA15: Enclosure 7: sections through ditches 14017, 14018, and 14019



