

**Eskdale Park
Whitby
North Yorkshire**

**NZ 9012 9045
Desk Based Assessment**

Authorised by

Date:.....

**Eskdale Park
Whitby
North Yorkshire**

**NZ 9012 9045
Desk Based Assessment**

Contents	Page
Figure List	2
Plate List	3
Non Technical Summary	4
1. Introduction	4
2. Site Description	5
3. Planning Background	5
4. Aims and Objectives	6
5. Methodology	6
6. Results	7
7. Impact of the Development	16
8. Discussion and Conclusions	17
9. References and Bibliography	18
10. List of Contributors	19

Figure List	Page
1. Site Location. Scale 1:50,000.	20
2. Proposed Development Area. Scale 1:2500.	21
3. Monuments of the North Yorkshire HER	22
4. Listed Buildings.	23
5. Historic Landscape Characterisation.	24
6. Extract from the 1844 Tithe Map for Hawsker cum Stainacre.	25
7. Extract From the 1853 First Edition Ordnance Survey Map. Scale: 1:10,560.	26
8. Extract From the 1894 Edition Ordnance Survey Map. Scale: 1:2,500.	27
9. Extract From the 1913 Edition Ordnance Survey Map. Scale: 1:2,500.	28
10. Extract From the 1914 Edition Ordnance Survey Map. Scale: 10,560.	29
11. Extract From the 1928 Edition Ordnance Survey Map. Scale: 1:2,500.	30
12. Extract From the 1930 Edition Ordnance Survey Map. Scale: 10,560.	31
13. Extract From the 1938 Edition Ordnance Survey Map. Scale: 10,560.	32
14. Extract From the 1938 Edition Ordnance Survey Map. Scale: 2,500.	32
15. Location of Plates 1 - 12.	34

Plate List	Page
1. View of Larpool Lane. Facing North.	35
2. View of Larpool Lane and Larpool Drive. Facing South-west.	35
3. Proposed Development Area. Facing North-west.	36
4. Proposed Development Area. Facing South-west.	36
5. Proposed Development Area. Facing East.	37
6. Proposed Development Area. Facing North-east.	37
7. Proposed Development Area. Facing North.	38
8. Proposed Development Area. Facing East.	38
9. Larpool Hall. Facing South.	39
10. View from Larpool Drive. Facing West.	39
11. View from Larpool Drive. Facing West.	40
12. View of Larpool Hall Gardens. Facing West.	40

**Eskdale Park
Whitby
North Yorkshire**

**NZ 9012 9045
Desk Based Assessment**

Non Technical Summary

The Desk-based Assessment was commissioned by Barratt Homes Yorkshire East Division, and was undertaken by MAP Archaeological Consultancy Ltd to accompany a planning application for Proposed Residential development at Eskdale Park, Whitby.

There are no Scheduled Ancient Monuments, Registered Parks, Gardens or Battlefields within the proposed Development Area. There are no sites listed on the Historic Environment Register. There are no Listed Buildings or known Archaeological Sites within the Proposed Development Area, but there are two Grade II Listed Building located within 50m to the south-west of the Proposed Development Area and there is an Archaeological site and a Roman Coin noted on the North Yorkshire Historic Environment Record adjacent to the Proposed Development Area (an Iron Age and Romano-British Settlement) in the field to the south of the Proposed Development Area and to the east of Larpool Hall.

There are no nationally designated or undesignated archaeological sites that would preclude the site from development. A Programme of Archaeological Assessment including Geophysical Survey and Archaeological Trial Trench is needed to mitigate for any archaeological remains present on the site.

1. Introduction

- 1.1 A Desk-based Assessment was commissioned by Barratt Homes Yorkshire East Division, and was undertaken by MAP Archaeological Consultancy Ltd to

accompany a planning application for Proposed Residential Development at Eskdale Park, Whitby, North Yorkshire (Fig. 1).

- 1.2 Archaeological, Historical and Architectural remains are protected by means of Statutory Instruments (including Scheduled Ancient Monument Legislation and Planning Policy Statement 5), and by Scarborough Borough Council Local Plan (Policies E23 to E29).
- 1.3 There are no Scheduled Ancient Monuments, Registered Parks, Gardens or Battlefields within the Proposed Development Area. The site is not within the Whitby Designated Conservation Area. There is one site listed on the North Yorkshire Historic Environment Register to the south of the Proposed Development Area. There is one Grade II Listed Building adjacent to the south-west corner of the Proposed Development Area.
- 1.4 All work was funded by Barratt Homes Yorkshire East Division.
- 1.5 All Maps within this report have been reproduced from the Ordnance Survey with the permission of the Controller of Her Majesty's Stationery Office, Crown Copyright, Licence No. AL50453A.

2. Site Description

- 2.1 The Proposed Development Area is located east of Larpool Lane and Larpool Drive, north-east of Larpool Hall Hotel south and east of a recent residential development and north of agricultural fields (Figs. 1-2; Pls. 1- 12). The site is currently arable farmland.
- 2.4 The site is 9 Ha. in size and stands at heights of between 60-70m AOD.

3. Planning Background

- 3.1 There are no previous planning applications for the Proposed Development Area.

4. Aims and Objectives

4.1 The aim of the Assessment is to:

- Identify recorded features of archaeological significance within the study area
- Establish the potential for hitherto unrecorded and unknown sites
- Assess the relative importance of the sites
- Assess the likely impact of the proposed development on the sites
- Make recommendations to mitigate the impact of the development on the sites

5. Methodology

5.1 The Desk-based Assessment reviewed the following sources of information: -

- North Yorkshire Historic Environment Record (HER)
- National Monuments Record
- Listed Building/Conservation records.
- Aerial Photographs
- Scheduled Monuments and World Heritage Status
- English Heritage Register of Historic Parks and Gardens and Register of Battlefields
- Visual inspection of the site, including interiors and exteriors of the standing buildings & their setting.
- Plans and maps of the site and its environs, including historical pictorial and surveyed maps and including pre- and post war Ordnance Surveys up to the present day.
- Place and street name evidence
- Trade and Business Directories
- Historical documents and photographs
- Appropriate archaeological and historical journals and books

6. Results

6.1 The site is listed under the Historic Landscape Characterisation Record on the North Yorkshire Historic Environment Record, but there are no monuments, events or Listed Buildings within the Proposed Development Area. There are twenty-two HER sites within one kilometre of the Proposed Development Area and twenty-five Listed Buildings within a kilometre of the Proposed Development Area. Details of the Sites and Monuments and Listed Buildings located on the site are in Tables 1 and 2 and Figures 3, 4 and 5.

Table 1. Archaeological Sites on the North Yorkshire Historic Environment Record located within 1km of the site

North Yorkshire HER Reference	Grid Reference	Description	Period
MNY24738	NZ 89 10	Parish Record for Whitby 4035	Medieval-Modern
MNY23678	NZ 901 091	Romano-British Settlement East of Larpool Lane, Whitby Ditched Enclosure, Farmstead, Round House, Hearth and Rubbish Pit (NAA)	Roman
MNY8860	NZ 895 092	Larpool Mill Watermill - Long Disused. Wheel and Machinery Gone. Millhouse converted to Private Residence called "Glen Esk Cottage" Grade II Listed Building	Post-medieval
MNY8762	NZ 899 104	Ford - Boghall to Spital Bridge Ford, River Esk, Whitby Elgee refers to a paved ford of tree trunks laid side by side on the line of Wade's Causeway.	Undated
MNY24842	NZ 900 103	Former Whitehall Shipyard, Whitby Dry Dock, Shipyard and Timber Yard	Post-medieval
MNY8837	NZ 89 10	Findspot - Early Bronze Age Conical Example of a Pygmy Cup with Perforations below the Middle found in a Howe in Whitby Parish	Prehistoric
MNY8859	NZ 897 093	Findspot - Roman Coin found in Salvage Tip near Larpool Hall. Found in 4 pieces	Roman
MNY8821	NZ 895 102	St. Columban's. Grade II* Listed Building. Built in 1790-1792. 2 storey Ashlar Main Building with Gatepiers also listed (Grade II)	Post-medieval
MNY24843 ENY3419	NZ 901 104	River side remains at Abrahams Quay, Whitby Trial trenching revealed a retaining wall, timber jetty, and possible	Post-medieval

		timber quayside decking	
MNY8767	NZ 901 103	Spital Bridge - Medieval Hospital of St. Michael. Founded in 1109 at a Place granted by the Abbot to a Leper. 12th century to the late 16th century.	Medieval
MNY31752	NZ 900 100	An area of ridge and furrow cultivation to the east of Whitby High Level Bridge An extensive area of medieval ridge and furrow plotted from earthworks on 1972 Aerial Photographs, levelled later.	Medieval
MNY31610	NZ 905 103	An area of ridge and furrow cultivation north of the allotments An area of upstanding medieval/post medieval ridge and furrow plotted from 1946 Aerial Photographs, still upstanding by the date of the 1981 and later Ordnance Survey Aerial Photographs	Medieval
MNY31609	NZ 903 104	An area of ridge and furrow cultivation south of Green Lane An area of upstanding medieval/post medieval ridge and furrow plotted from 1946 Aerial Photographs, still upstanding by the date of the 1981 and later Ordnance Survey Aerial Photographs	Medieval
MNY31611	NZ 906 099	An area of ridge and furrow cultivation north of Lodge Farm An area of upstanding medieval/post medieval ridge and furrow plotted from the 2000/2001 Aerial Photographs, still upstanding	Medieval
MNY31586	NZ 904 104	World War 2 Home Guard Store Located 180m East of Green Lane	Modern
MNY31581 ENY4399	NZ 90152 10401	Location of 19th century Timber Yard	Post-medieval
MNY25202	NZ 898 102	Railway Turntable at Windsor Terrace, Whitby	Modern
MNY31596 ENY4399	NZ 8946 1022	Findspot Roman coin recorded in 1955. NMR29462. Rapid Coastal Zone Assessment	Roman
MNY8766	NZ 900 103	Medieval Hospital of St. John the Baptist, north of Whitehall Recorded in 1320 when the Hospital had a Warden with Brethern and Sisters Still in use in 1401 but not by 1407/8.	Medieval

HNY23463	NZ 897 094	<p>Historic Landscape Characterisation – Enclosed Land</p> <p>This is an area of unknown planned enclosure with fragmentary legibility being planned over an area of piecemeal enclosures since 1850. It is defined by regular external hedges and straight internal fenced boundaries. The fields have been planned within an area defined by Larpool Lane and the disused Scarborough to Whitby railway line. 5.48 Ha.</p>	
HNY23461	NZ 899 096	<p>Historic Landscape Characterisation – Enclosed Land</p> <p>This is an area of unknown planned enclosure with partial legibility and up to 50% boundary loss since 1850. It is defined by regular external hedges and straight internal dry stone walled boundaries. The northern part of the record has lost all of its boundaries and is not very recognisable as planned enclosure. The southern part of the record includes Larpool Hall Hotel and a few detached houses which are too small to have their own record, and the enclosure there seems to be associated with Larpool Hall. The southern edge of the fields has been truncated by the, now disused Scarborough to Whitby railway line. 11.38 Ha.</p>	
HNY21648	NZ 902 091	<p>Historic Landscape Characterisation – Enclosed Land</p> <p>An area of piecemeal enclosure consisting of medium sized fields in a semi-irregular pattern. It is defined by regular external and internal hedgerow boundaries and has partial legibility with up to 50% boundary loss since 1850. 43.70 Ha.</p>	
HNY23432	NZ 900 097	<p>Historic Landscape Characterisation – Settlement</p> <p>This is an area of modern expansion at Whitby consisting of low density housing in a cul-de-sac pattern. It has playing fields as public space, front and back gardens as private space and fragmentary legibility with a lot of change since 1850. The previous HLC was piecemeal enclosure, which is no longer visible in the area with only Stainsacre Lane and</p>	

		possibly one 18 th century farmhouse existing as on the 1st edition. The record includes two schools with their playing fields as well as public playing fields. 47.57 Ha.	
--	--	---	--

Table 2. Listed Buildings on the National Monument Record located within 1km of the site

Building Name	Grid Reference	Description	Grade
47 & 49 Mayfield Road, Whitby	NZ 88991 10251	No. 49 formerly shown as premises occupied by Hadley and E R Hunter. 18th century origin. Rendered on stone. 2 storeys. Pantile roof	Grade II
Ruswarp Station, Main Street, Ruswarp	NZ 89016 09150	Railway station. C 1850 Designed by G.T Andrews in the Tudor style. Coursed rubble and ashlar dressings. Slate roofs with over hanging eaves and decorative baroc boards with finials. Quorns. Built for the Yorkshire and North Midland Railway Company.	Grade II
15 Mayfield Road, Whitby	NZ 89134 10296	18th century. 2 storeys in brick. Pantile roof with stone kneelers.	Delisted
Barn at 15 Mayfield Road, Whitby	NZ 89139 10297	C18. One storey stone barn to left of No 15. Pantile roof. Plain door. Ventilation vents.	Delisted
Upper Bauldbyes, Prospect Hill, Whitby	NZ 89296 10313	House. Early 18th century, with 19th and 20th century alterations. Brick with ashlar dressings, now rendered and painted. Slate roofs with raised and coped gables. 5 brick stacks.	Grade II
St. Columbans, Waterstead Lane, Whitby	NZ 89543 10272	Built in 1790. 2 storeys, ashlar. 5 sash windows. First floor divided into bays by Ionic pilasters, the central bay having radiating rustication round an Ionic columned Venetian window - the architraves having pulvinated friezes and dentilled cornices. Round-headed recess. Other windows on first floor with caved architraves and sills with cornices. Ground floor has windows with square block rusticated architraves with triple keyblocks-Doric columns between outer windows with full entablature with triglyphs from these columns to porch. Patterned band at same level from columns to ends of elevation. Angle quoins. Central projecting C19 porch	Grade II*

		flanked by pair of Doric columns with similar full entablature. Recessed door with curved stone reveals, and openwork parapet. House crowned by dentilled parapet with pediment to centre containing oval window with ornamental glazing, architrave surround.	
Gatepiers to St. Columbans, Waterstead Lane, Whitby	NZ 89476 10369	Probably contemporary with the house. 6 stone piers comprise entrance to property. The 2 principal gate piers comprise a rusticated column on ashlar pedestal, the pier surmounted by stone urn. Secondary pair of piers are of similar design but lower in height. The outer piers are cylindrical in design with oval capping and are lower in height than the principal piers. The gates have been removed.	Grade II
Glen Esk Cottage, Glen Esk Road, Whitby	NZ 89527 09202	18th century. 2 storey whitened stone cottage of irregular plan. Pantile roof with one brick chimney stack.	Grade II
Viaduct at Larpool, Whitby	NZ 89620 09656	19th century. Brick round-arched viaduct of considerable height with tapering piers crossing the River Esk. 13 arches. Mentioned incidentally in 'Dracula' by Bram Stoker.	Grade II
Boghall, 10 Waterstead Lane, Whitby	NZ 89766 10336	Tablet over doorway dated "William and Anne Foster 1719". 2 storeys in stone. Pantile roof with stone capped gables and kneelers.	Grade II
Weighing Machine House, Whitby	NZ 89850 09810	Weighing Machine House building 1835; built for the Whitby-Scarborough Railway Co, engineer Robert Stephenson. Finely cut ashlar with ashlar dressings.	Grade II
Larpool Hall, Larpool Lane, Whitby	NZ 89904 09341	Late 18th century - created before 1790. 3 storeys in ashlar. 2-1-2 sashes, the centre with slight projection and small pediment in parapet. Quoins, bands between storeys and cill bands; band to parapet. Stone CI9 open arched porch in centre enclosing original doorway in stone with pediment, shaped and enriched frieze and 'Gothic' cluster half columns; door of 6 fielded panels. 2 storey wings of similar character with 2 windows, slightly set back from house, left hand one with 19th century stone bay windows.	Grade II
Gatepiers at Larpool Hall, Larpool Lane, Whitby	NZ 89975 09592	2 stone gate piers with pyramidal cap down drive from house.	Grade II

		Probably late 18th century	
The Shipyard Club, Spital Bridge, Whitby	NZ 90072 10397	Formerly an early 19th century warehouse. 3 storeys in stone. L-shaped. Welsh Slate Roof.	Grade II
White Hall, Spital Bridge Bank, Whitby	NZ 90088 10282	Late 18th century. Rendered. 2 storeys and basement. Old slate roof. 2 rendered chimneys at gable ends.	Grade II
Old Bridge to West of Spital Bridge, Whitby	NZ 90089 10404	18th century. Single round arched stone bridge with solid parapet.	Grade II
Whitby Cemetery Lodge, Larpool Lane, Whitby	NZ 90119 09784	1862 probably by Pritchett who designed the chapels. Gothicised coursed rubble lodge with ashlar dressings. 2 storeys steep porch slate roof, grouped chimneys.	Grade II
Whitby Cemetery Chapels, Larpool Lane, Whitby	NZ 90189 09783	1862 by Pritchett. Pair of chapels connected by pointed archway carrying broached lantern and steeple. Coursed stone rubble with ashlar dressings. Bold decorated details to steeple and to window tracery.	Grade II
1-6 Raft Yard, Spital Bridge Whitby	NZ 90154 10408	Late 18th century or early 19th century. 2 storeys in brick on stone base, river front rising from water. Pantile roof with 2 sloped dormers. Stone gable ends with kneelers. 4 brick chimneys.	Grade II
Wall to the Mount, Helredale Road, Whitby	NZ 90163 10123	Low brick wall to front of The Mount. Stone capping. 2 gate piers with pyramidal stone caps.	Grade II
The Mount, Helredale Road, Whitby	NZ 90179 10096	Mid 19th century. 2 storeys and basement. Roof of fish scale tiles. Left hand section has a 2-storey canted bay window of 3 lights with pyramidal roof with finial.	Grade II
Mount Farmhouse, Mount Pleasant, Whitby	NZ 90340 09648	Dated 1783 over door. 2 storeys, rendered. Replaced pantile roof. 2 brick chimneys at gable ends.	Delisted
Lodge Farmhouse, St. Peter's Road, Whitby	NZ 90634 09785	First half of C18. Square building of 2 storeys and attics in ashlar. Hipped slate roof with one dormer. Stone eaves cornice.	Grade II
Broomfield, Stainacre Lane, Whitby	NZ 90734 08816	Circa 1800. 3 storeys in ashlar, the top storey being a dummy with painted trompe l'oeil windows. 2 stone chimneys at gable ends. Slate-roof with capped gables with kneelers.	Grade II
The Garden Wall, New Garden, Green Lane, Whitby	NZ 90808 10387	Stone and brick garden wall bearing tablet inscribed:- "I, Sir Hugh Cholmely, Kt and Bart, and Elizabeth my dear wife (daughter to Sir Wm Twisden of Great Peckham in ye County of Kent Kt and Bart) built this wall and planted this orchard Anno Domini 1652". Then follows a shield of arms of Cholmley impaling Twisden and	Grade II

		"Our handy work like to the fruitful tree; O Lord let it not blasted be".	
--	--	---	--

6.2 Prehistoric

6.2.1 There are no Prehistoric Sites or Finds on the North Yorkshire Historic Environment Record (HER) within the Proposed Development Area.

6.2.2 Within one kilometre, a Late Bronze Age bi-conical pygmy cup was noted from a "howe" in Whitby Parish (MNY8837).

Potential: Low

6.3 Romano-British

6.3.1 There are no Roman Sites or Finds noted within the Proposed Development Area on the North Yorkshire HER.

6.3.2 In the adjacent field to the south of the Proposed Development Area, a Late Iron Age to Romano-British site comprising evidence of enclosures, settlements and hearth were noted on the North Yorkshire HER, and were found during excavation work for the Yorkshire Water Pipeline excavated by Northern Archaeological Associates in 1999 (MNY 23678).

6.3.3 There are two Roman Coins (MNY31581 and MNY8859) found within one kilometer of Eskdale Park, one (MNY8859) was found near Larpool Hall in four pieces.

6.3.4 An undated paved ford across the River Esk at Boghall and Spital Bridge (MNY8762) is possibly on the line of Wade's Causeway (a Roman Road).

Potential: High

6.4 Medieval

6.4.1 The Proposed Development Area was formerly in the Parish of Hawsker-cum-Stainsacre, in the Wapentake of Whitby Stand in the North Riding of Yorkshire. Whitby has its origins in the Saxon period with the origins of the town and the foundation of Whitby Abbey in the seventh century. Whitby was

noted in the Domesday Survey of 1086 as 'Witebi'. The Place name Whitby is derived from the Old English for 'Hviti's farmstead'.

6.4.2 There are no sites from the Medieval Period on the North Yorkshire HER from within the Proposed Development Area. There are six medieval sites within one kilometre of Eskdale Park. There are four areas of known Medieval Ridge and Furrow within one kilometre of Eskdale Park (MNY31752, MNY31609, MNY31610, MNY31611). There are two Medieval Hospitals known from documentary sources in Whitby, the Hospital of St. Michael (MNY8767) at Spital Bridge and the Hospital of St. John at Whitehall (MNY8766).

Potential: Low

6.5 Post-medieval/ Modern (AD 1500 – present)

6.5.1 There are no Post-medieval or Modern sites on the North Yorkshire HER within the Proposed Development Area. There are five Post-Medieval and two Modern sites within one kilometre on the North Yorkshire HER. The Post-medieval Sites include two shipyards (MNY24843 & MNY24843), a timber yard (MNY31581), St. Columban's house (MNY8821) and Larpool Mill (MNY8860). The two Modern Sites include a Railway turntable (MNY25202) and a World War Two Home Guard Store (MNY31586).

6.5.2 Historical Records located at North Yorkshire County Record Office reveal the Land ownership back to the early nineteenth century (1807-1922) for the Turton Family (NYCRO ZW 1-V). The leases and agreements relate to the holdings of the Turton Family but nothing specific to the site or Larpool Hall. Trade Directories and show Edmund Turton Esquire at Larpool Hall in 1829 (Pigot's Directory). In 1840, Edmund Turton and George Augustus Peters Esq. are listed at Larpool Hall. In 1890, the farmer at Larpool and Spital Bridge was Joseph Allan.

6.5.3 There is no Enclosure Award or Act for the Area of Hawsker-cum-Stainacre around Larpool Hall. The Historic Landscape Characterisation for the Proposed Development Area (HNY 21648) states "An area of piecemeal

enclosure consisting of medium sized fields in a semi-irregular pattern... defined by regular external and internal hedgerow boundaries and has partial legibility with up to 50% boundary loss since 1850".

6.5.4 The earliest map for the area around Larpool Hall was the 1844 Tithe Award Map for Hawsker-cum-Stainsacre (NYCRO ZW(M)1/53 MIC2134 510-535: Fig. 6). The Tithe Map shows six fields north-east of Larpool Hall which comprise the Proposed Development Area, numbered 32, 33, 34, 35, 36 and 37. The 1853 First Edition Ordnance Survey map of 1853 showed the Proposed Development Area as seven fields. The 1894 Edition Ordnance Survey Map shows the Proposed Development Area as two fields (Fig. 7: 2257 and 2202). The 1913 Edition Ordnance Survey Map showed the Proposed Development Area as two fields (Fig. 8: 709 and 687). There were no differences on the 1914 Edition Ordnance Survey Map (Fig. 9). The 1928 Edition Ordnance Survey Map showed the Proposed Development Area as three fields (Fig. 10: 709a, 709 and 687). There were no difference on the 1930 Edition Ordnance Survey Map or the 1938 Six inch to one mile edition Ordnance Survey Map (Figs. 11-13). The 1938 twenty five inch to one mile edition Ordnance Survey Map shows the Proposed Development Area as two fields with two electricity pylons on the western edge of the area (Fig. 14).

6.5.5 In 1907, Major Harry Trevor Trevor, late of the Indian Army was listed at Larpool Hall. By 1919, Larpool Hall had become a Children's Home, and recently the Hall was converted into a hotel.

Potential : Low

6.6 Potential for Unrecorded Sites

6.6.1 The potential for unrecorded sites is assessed as high due to the close proximity of known archaeology to the south. Archaeological Evaluation by Geophysical Survey and Targeted Trial Trenching should allow for an appropriate mitigation strategy to be developed in order that any unrecorded sites are located in advance of development.

6.7 Evidence of Previous Disturbance

6.7.1 The site has been disturbed by agricultural activity including ploughing and possibly drainage.

7. Impact of the Development

7.1 The following potential impacts upon the archaeological resource are considered:

- Loss of, or damage to, archaeological sites and remains
- Settings and views of and from upstanding remains, Listed Buildings, Scheduled Monuments and other archaeological sites
- Changes to ground conditions as a result of changes to the drainage regime which could affect archaeological remains
- Loss of landscape features, structures and areas with historic and cultural heritage associations
- Other possible impacts such as noise, vibration, compressions and other changed ground conditions

7.2 Loss of, or damage to, archaeological sites and remains

7.2.1 The proposed development will require groundworks for the insertion of roads, services and foundations. These works may impact on any buried archaeological deposits. Further evaluation is recommended prior to commencement of construction to assess the impact that the groundworks would have on any archaeological deposits and enable a suitable mitigation strategy to be developed that determines the appropriate level of recording for the archaeological resource.

7.3 Settings and views of and from upstanding remains, Listed Buildings, Scheduled Monuments and other archaeological sites

7.3.1 There are no Scheduled Monuments on or bordering the Proposed Development Area. There are two Grade II Listed Buildings approximately 50m outside of the Proposed Development Area. There are no sites on the Historic Environment Record but there are known Roman finds and a Roman-British Settlement within 50m of the Proposed Development Site.

7.4 Changes to ground conditions as a result of changes to the drainage regime which could affect archaeological remains

7.4.1 The proposed development could possibly have an effect on the prevailing local drainage conditions, although the impact of such a change on any buried archaeological deposits is not known and further evaluation should mitigate for this.

7.5 Loss of landscape features, structures and areas with historic and cultural heritage associations

7.5.1 The development should not impact on the Listed Buildings at Larpool Hall.

7.6 Other possible impacts such as noise, vibration, compressions and other changed ground conditions

7.6.1 The proposed groundworks and construction programme associated with the development proposals will have a short-term impact in terms of noise and vibration in the immediate environment of the application site. It is unlikely that these will have an impact on features of archaeological and historic environment importance.

8. Conclusions

8.1 The Desk Based Assessment has shown that the proposed development will not affect any nationally designated archaeological sites. There are no archaeological sites noted on the North Yorkshire HER within the Proposed Development Area, but to the south-west and west, there are two Listed Buildings within 50 m of the Proposed Development Site and to the south of the Proposed Development Area, there is a known Roman-British Settlement Site on the North Yorkshire HER. Romano-British features may be extending into the Proposed Development Area.

8.2 Further archaeological evaluation, by geophysical survey and targeted trial trenching, will mitigate any loss of archaeological features and should be undertaken in advance of any construction.

9. References

9.1 Primary Sources

North Yorkshire County Council
North Yorkshire County Record Office
National Monuments Record
North Yorkshire Historic Environment Record
www.heritage-gateway.org.uk
www.magic.gov.uk
www.imagesofengland.org.uk
www.pastscape.org.uk
www.a2a.org.uk

1844 Tithe Award Map for Hawsker cu Stainsacre (North Yorkshire County Record Office ZW (M) 293 1/53)

1853 First Edition Ordnance Survey Map Sheet 32. Scale 6 inches to 1 mile

1894 Edition Ordnance Survey Map Sheet 32/11. Scale 25 inches to 1 mile

1913 Edition Ordnance Survey Map Sheet 32/11. Scale 25 inches to 1 mile

1914 Edition Ordnance Survey Map Sheet 32SE. Scale 6 inches to 1 mile

1928 Edition Ordnance Survey Map Sheet 32/11. Scale 25 inches to 1 mile

1930 Edition Ordnance Survey Map Sheet 32SE. Scale 6 inches to 1 mile

1938 Edition Ordnance Survey Map Sheet 32SE. Scale 6 inches to 1 mile

1938 Edition Ordnance Survey Map Sheet 32/11. Scale 25 inches to 1 mile

9.2 Secondary Sources

Faull, M. and Stinson., M 1986 The Domesday Book: Yorkshire. Part One. Phillimore.

Mackney, D. et al. 1984 Soils of England and Wales . Sheet 1. Northern England. Soil Survey of England and Wales.

Page, W. 1923 A History of the County of York North Riding: Volume 2. Institute of Historical Research. University of London.

Smith, A.H. 1969 The Place-names of the North Riding of Yorkshire. Volume V. Place-name Society of England and Wales. Cambridge University Press.

10. List of Contributors

Desk Based Assessment by Zara Burn and Kelly Hunter

Site Walkover by Paula Ware

Edited by Paula Ware

Drawings and Plates by Kelly Hunter

Administration, filing, copying and binding by Sophie Langford



With Permission of the Controller
of Her Majesty's Stationary Office
© Crown Copyright
License No AL50453A

MAP

Archaeological Consultancy Ltd.

SITE: Eskdale Park, Whitby

CLIENT: Barratt Homes Ltd

TITLE: Site Location.

Figure 1.

DRAWING REF.:

DRAWN BY: KCH

REVISIONS:

Scale: 1:50,000

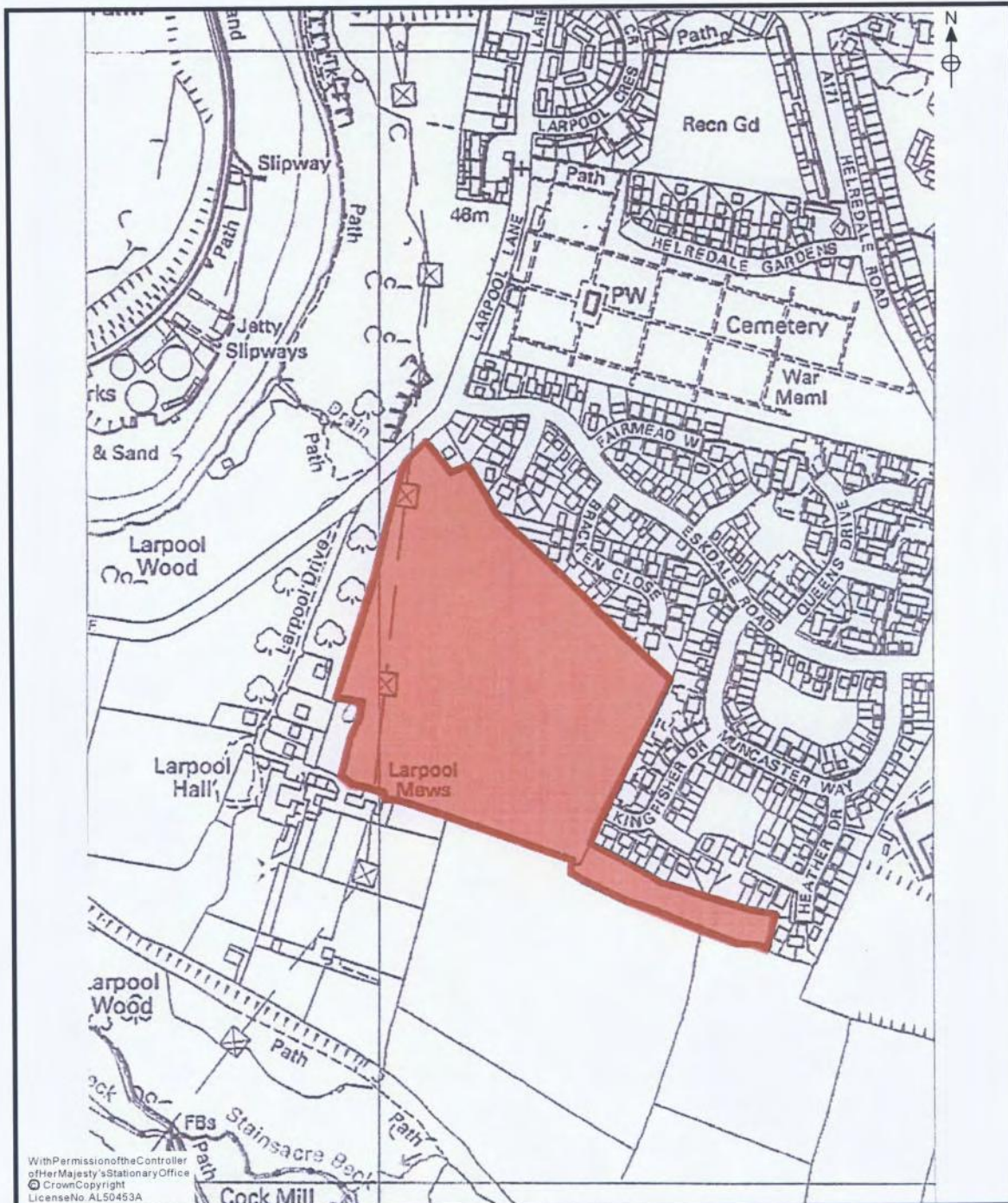

With Permission of the Controller
of Her Majesty's Stationary Office
© Crown Copyright
License No. AL50453A

MAP

Archaeological Consultancy Ltd.

SITE: Eskdale Park, Whitby

CLIENT: Barratt Homes Ltd

TITLE: Proposed Development Area.

Figure 2.

Scale: 1:5,000

DRAWING REF.:

DRAWN BY: KCH

REVISIONS:

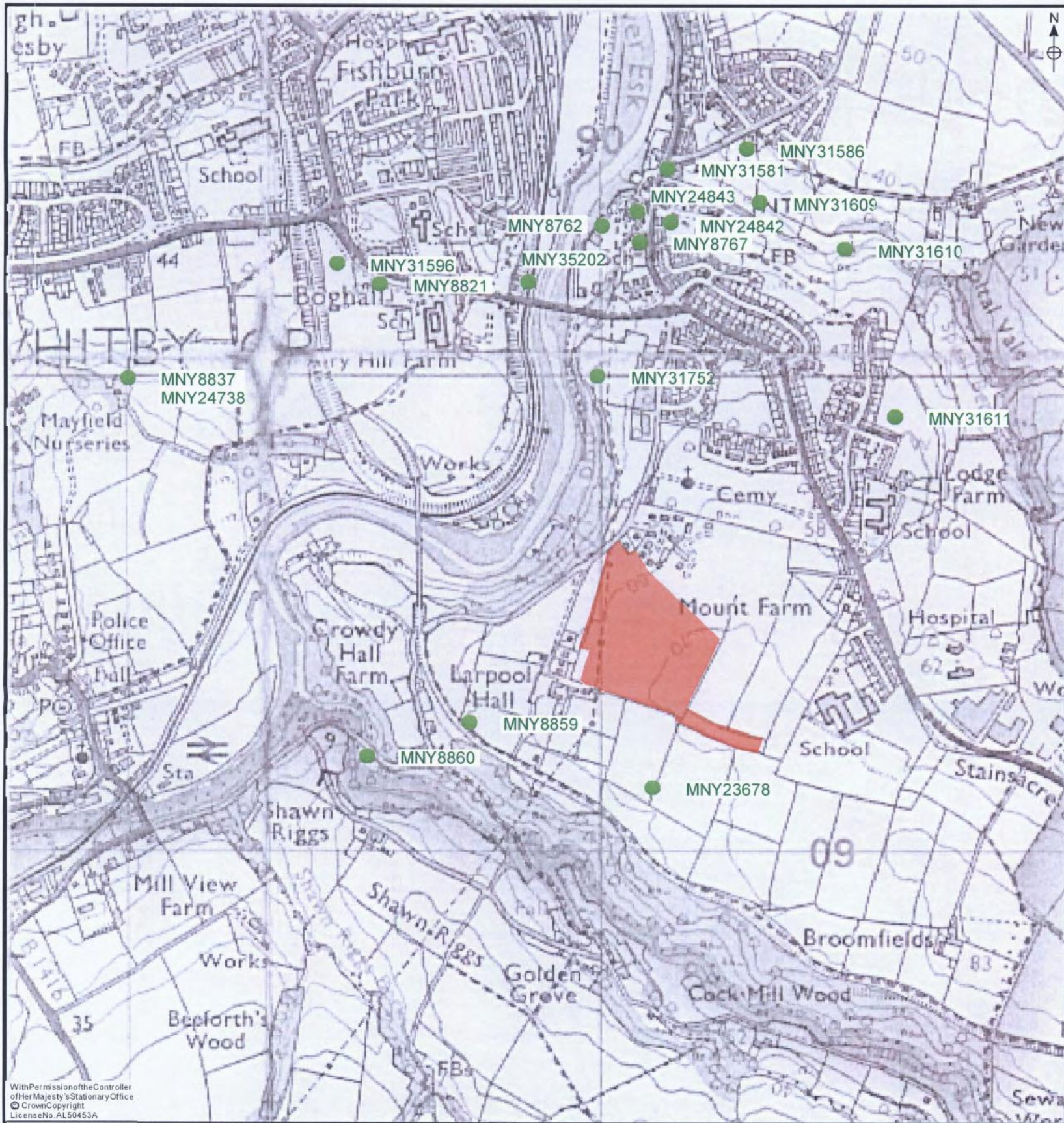

With Permission of the Controller
 of Her Majesty's Stationary Office
 © Crown Copyright
 License No. AL50453A

MAP

Archaeological Consultancy Ltd.

SITE: Eskdale Park, Whitby

CLIENT: Barratt Homes Ltd

TITLE: Archaeological and Historical Sites on the
 North Yorkshire Historic Environment Record.

Figure 3.

Scale: 1:10,000

DRAWING REF.:

DRAWN BY: KCH

REVISIONS:

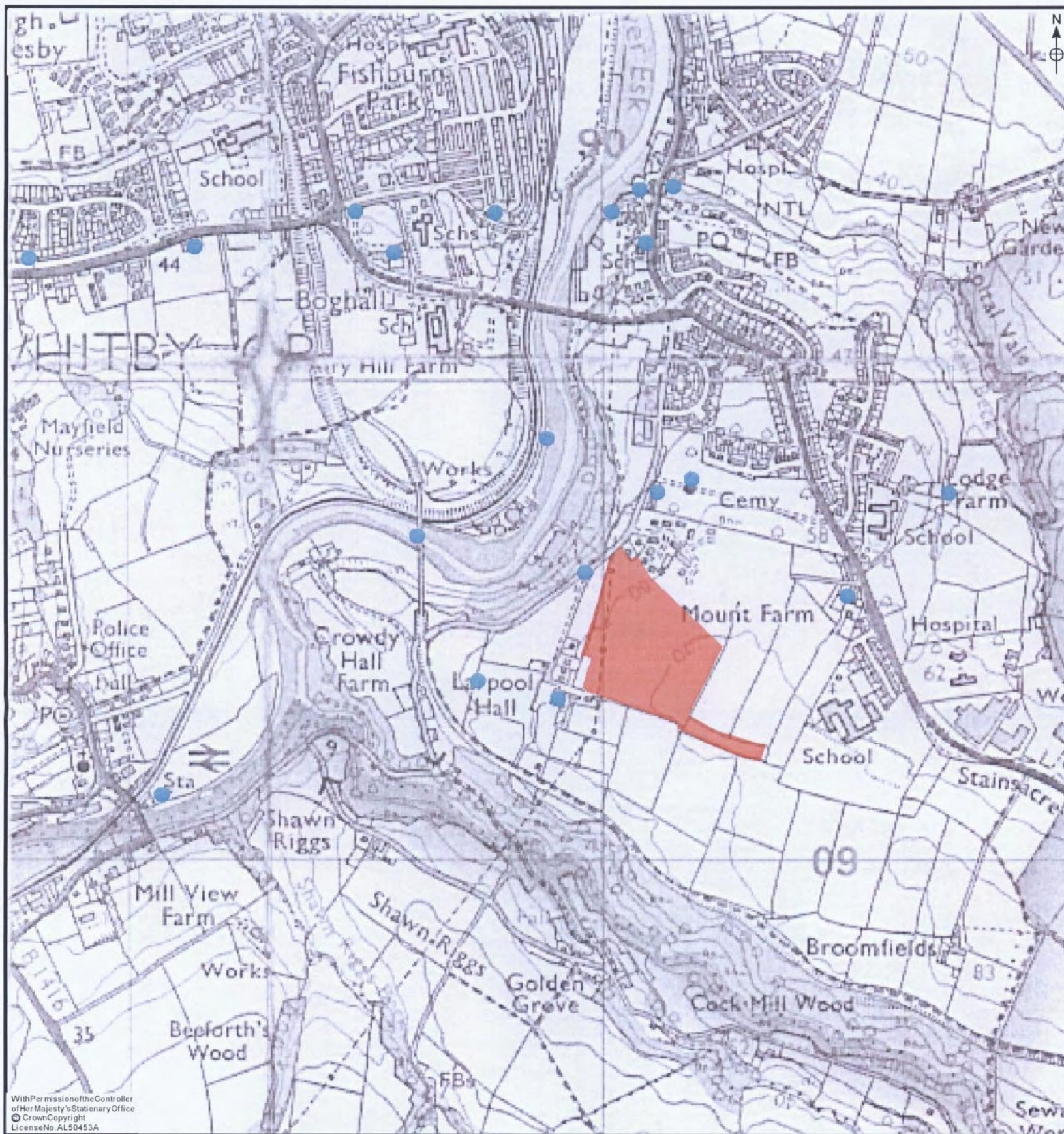

With Permission of the Controller
of Her Majesty's Stationary Office
© Crown Copyright
License No. AL50453A

MAP

Archaeological Consultancy Ltd.

SITE: Eskdale Park, Whitby

CLIENT: Barratt Homes Ltd

TITLE: Listed Buildings.

Figure 4.

Scale: 1:10,000

DRAWING REF.:

DRAWN BY: KCH

REVISIONS:

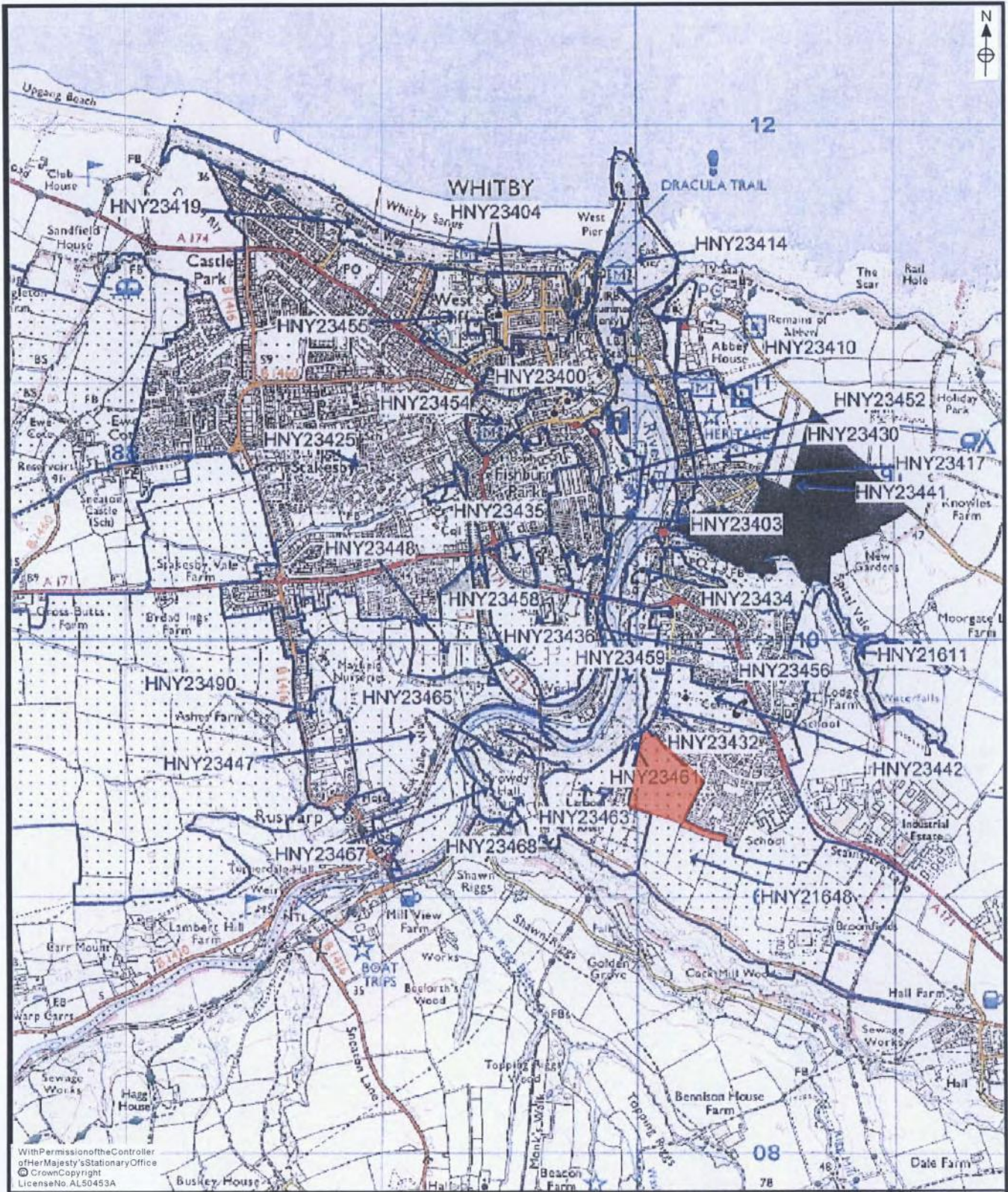

With permission of the Controller of Her Majesty's Stationary Office
 © Crown Copyright
 License No. AL50453A

MAP

Archaeological Consultancy Ltd.

SITE: Eskdale Park, Whitby

CLIENT: Barratt Homes Ltd

TITLE: Historic Landscape Characterisation (North Yorkshire HER).

Figure 5.

Scale: 1:10,00

DRAWING REF.:

DRAWN BY: TWS

REVISIONS:

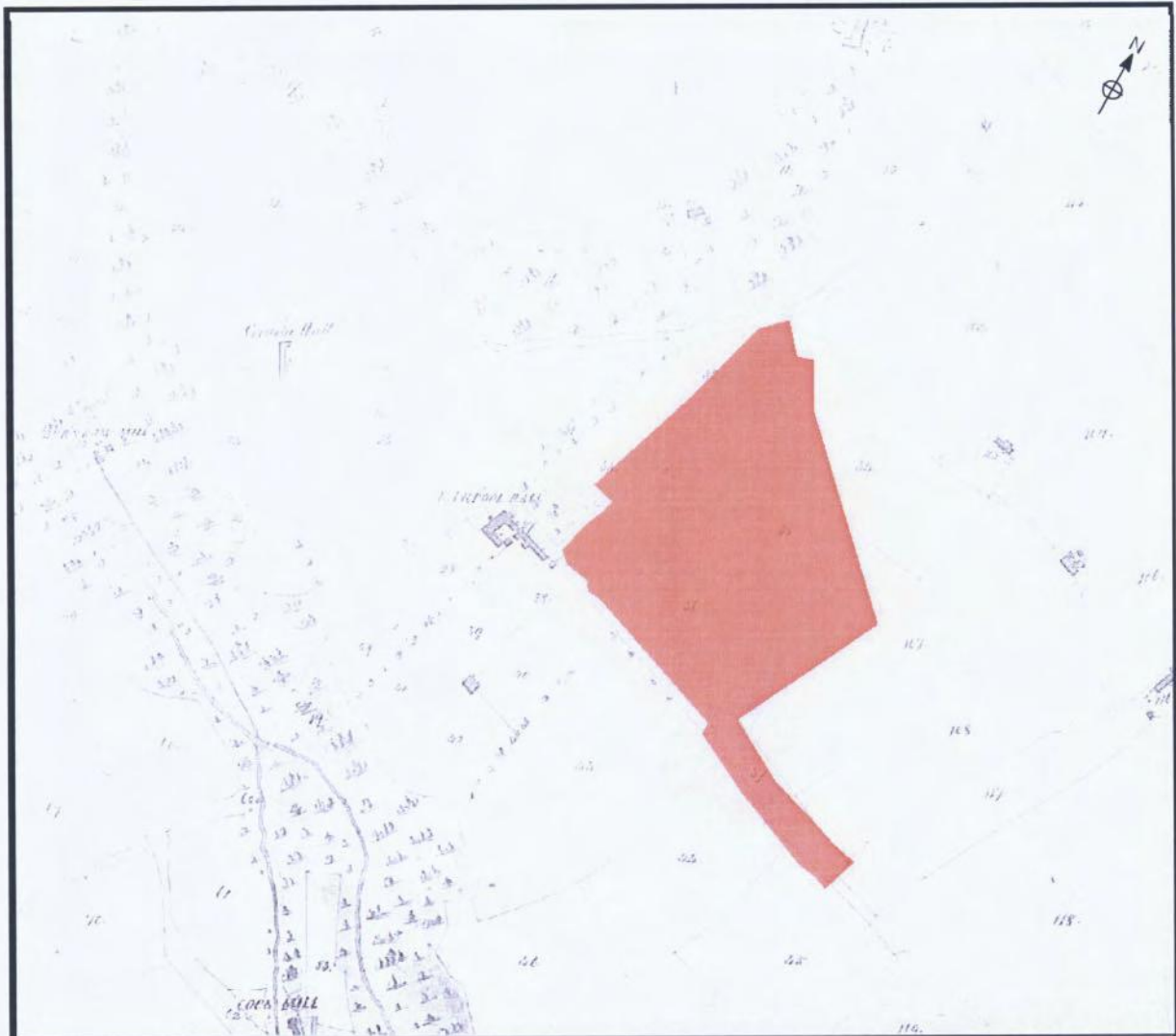

MAP
 Archaeological Consultancy Ltd.

SITE: Eskdale Park, Whitby

CLIENT: Barratt Homes Ltd

TITLE: Extract from the 1844 Tithe Map for
 Hawsker cum Stainsdale.

Figure 6.	NottoScale
DRAWING REF.:	
DRAWN BY: KCH	
REVISIONS:	

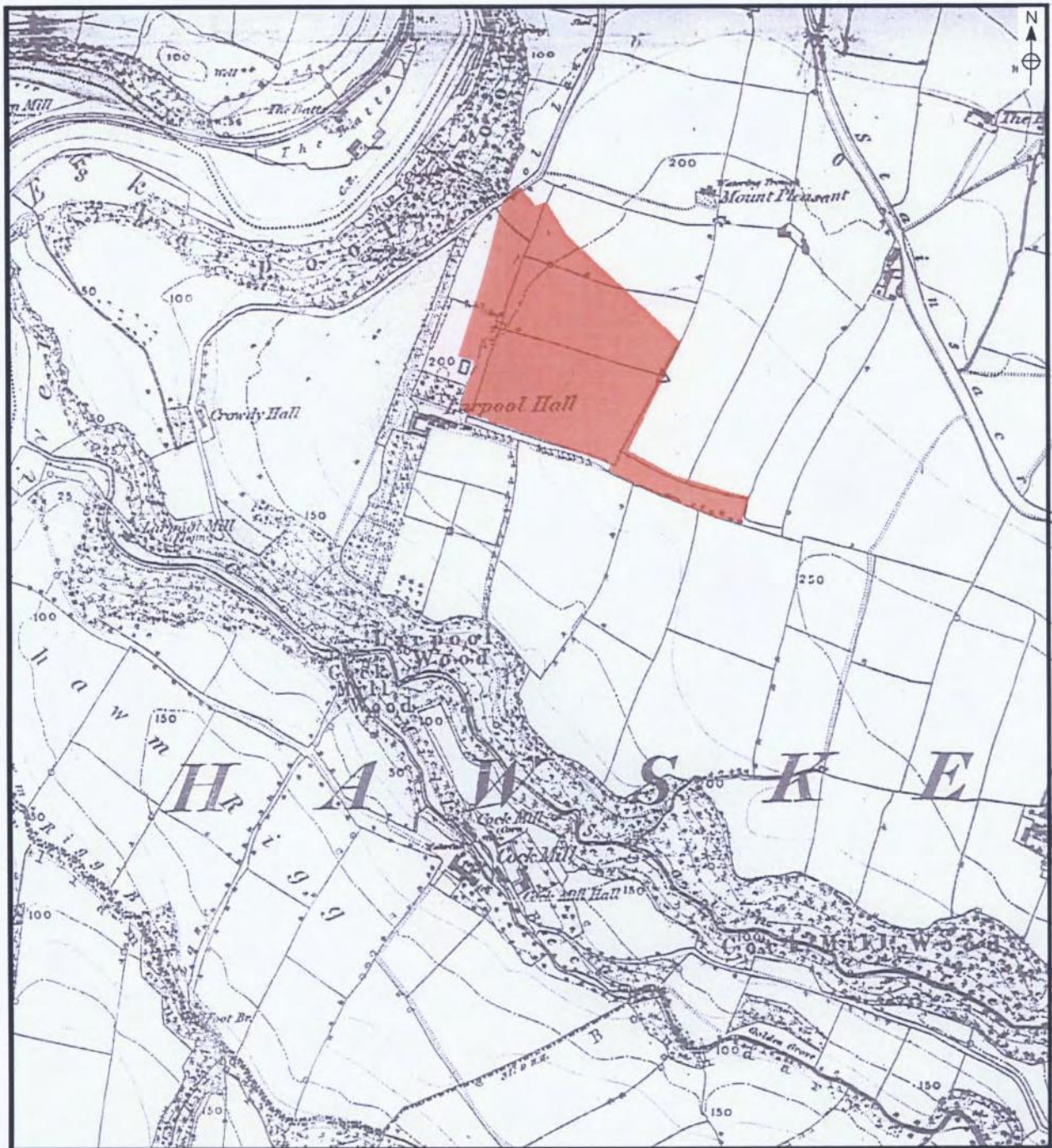

MAP

Archaeological Consultancy Ltd.

SITE: Eskdale Park, Whitby

CLIENT: Barratt Homes Ltd

TITLE: Extract from the 1853 First Edition
Ordnance Survey Map.

Figure 7.

Scale: 6 inches to 1 mile

DRAWING REF.:

DRAWN BY: KCH

REVISIONS:

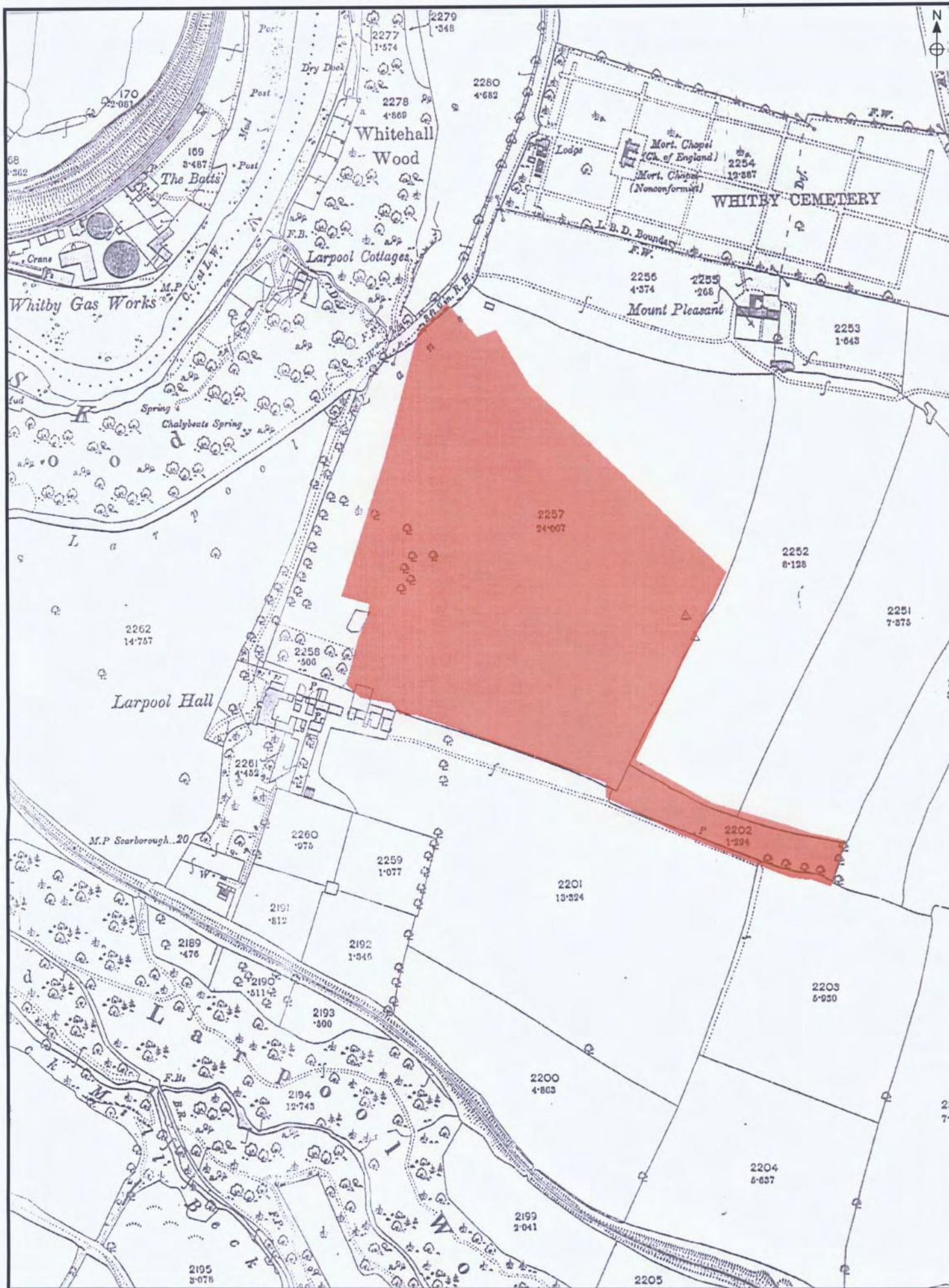

MAP

Archaeological Consultancy Ltd.

SITE: Eskdale Park, Whitby

CLIENT: Barratt Homes Ltd

TITLE: Extract from the 1894 Edition
Ordnance Survey Map.

Figure 8.

Scale: 25 inches to 1 mile

DRAWING REF:

DRAWN BY: KCH

REVISIONS:

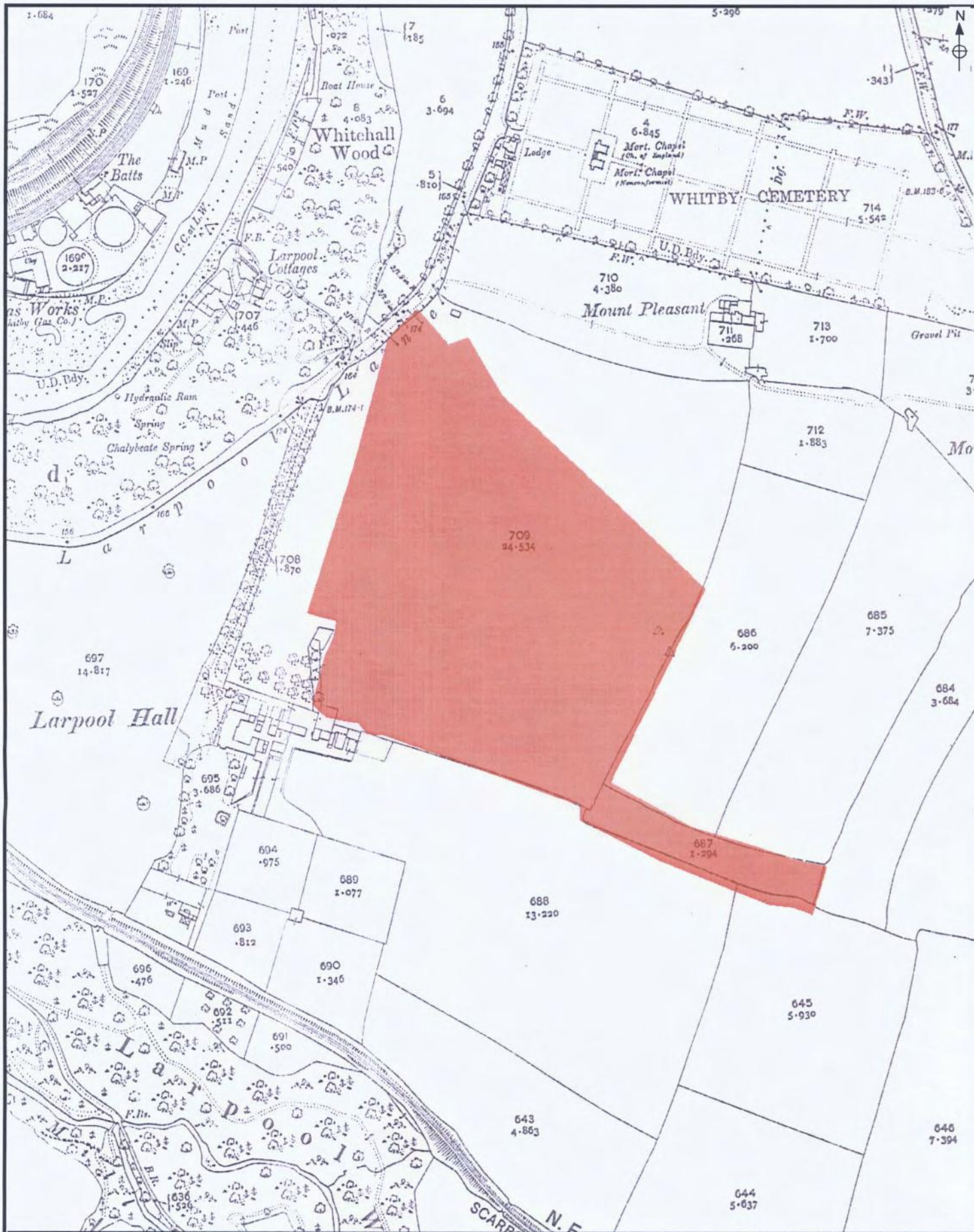

MAP

Archaeological Consultancy Ltd.

SITE: Eskdale Park, Whitby

CLIENT: Barratt Homes Ltd

TITLE: Extract from the 1913 Edition Ordnance Survey Map.

Figure 9.

Scale: 25 inches to 1 mile

DRAWING REF:

DRAWN BY: KCH

REVISIONS: