

Figure 1. Site Location.

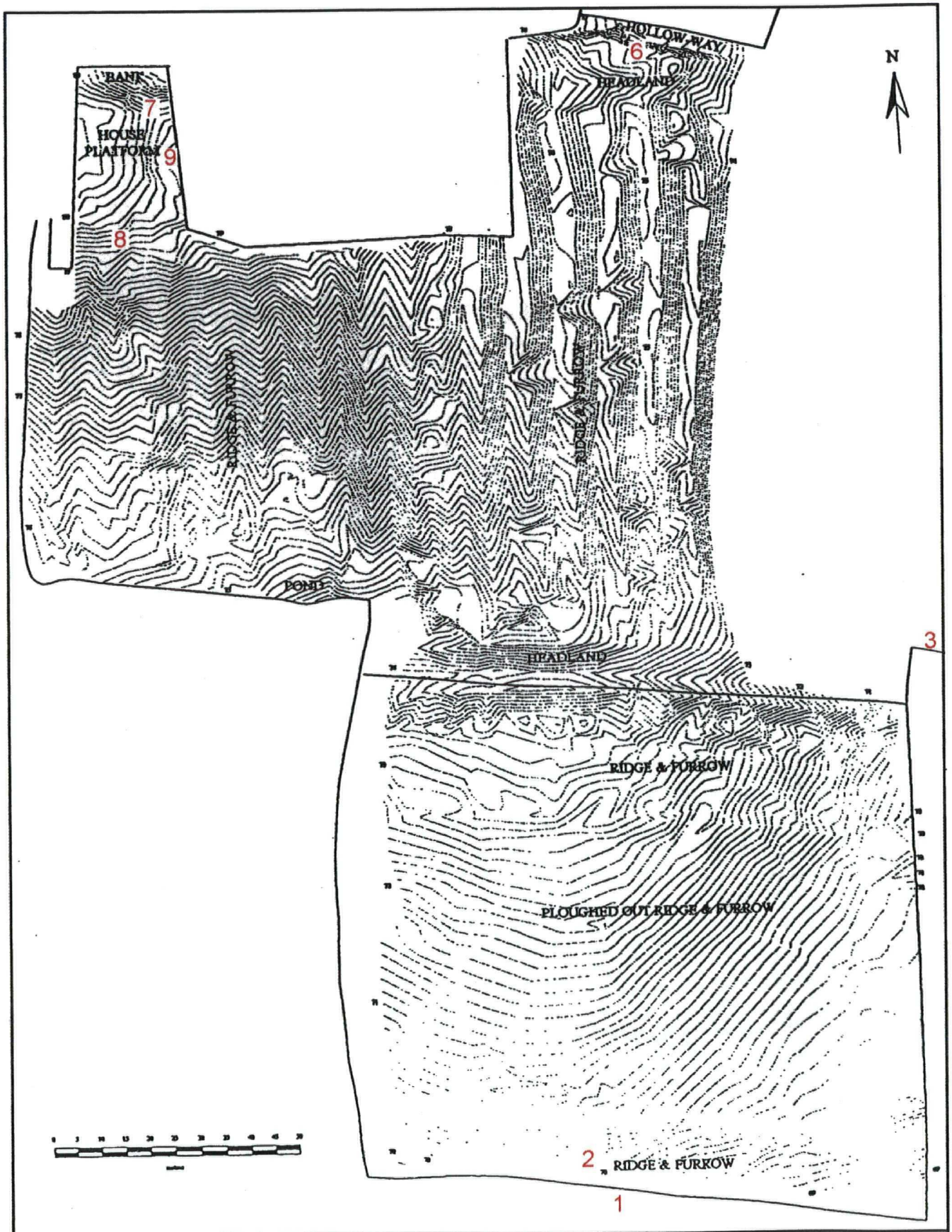

Figure 2. On-Site's Earthwork Survey.

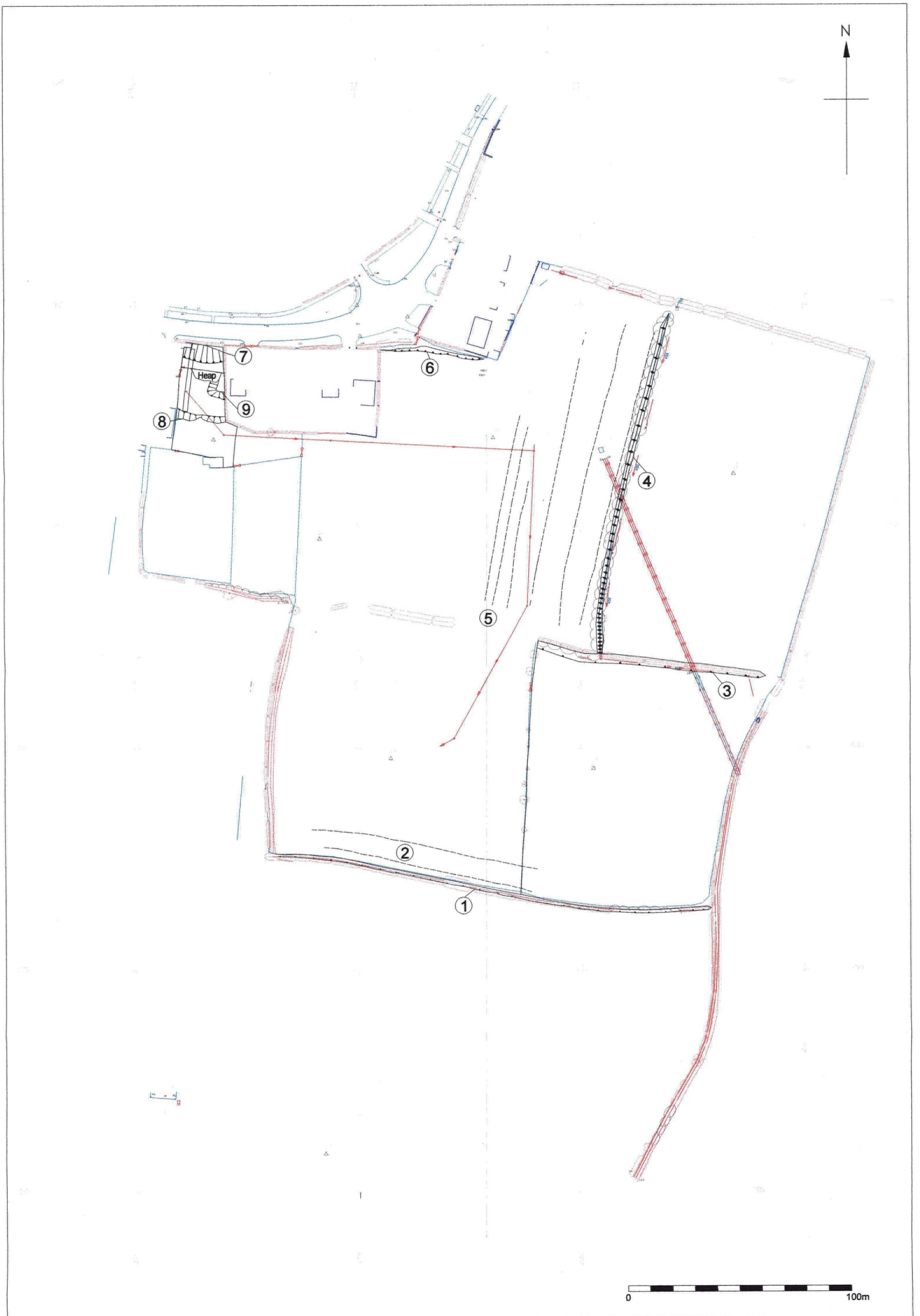

Figure 3. Earthwork Survey Results

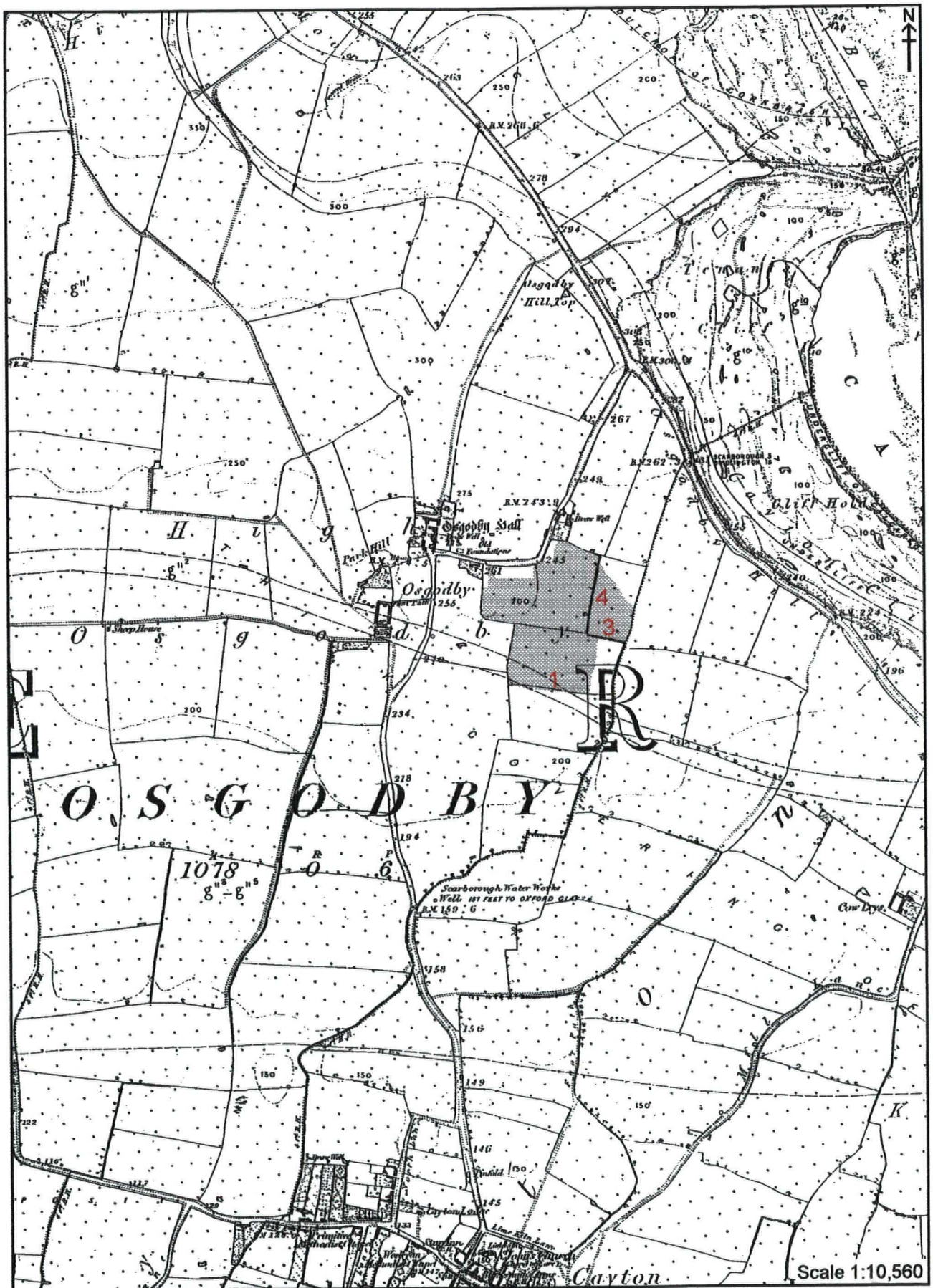

Figure 4. 1854 Ordnance Survey Map.



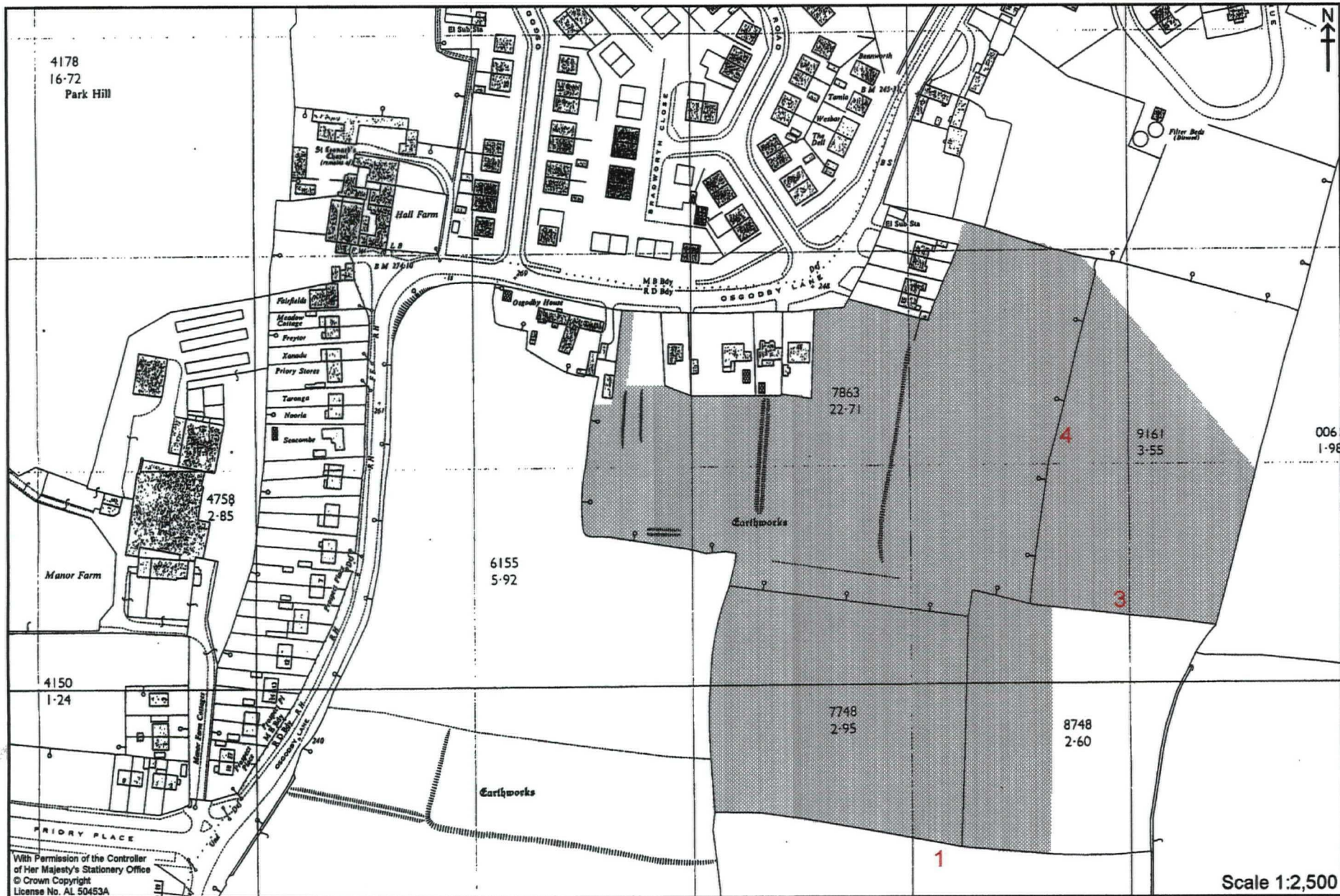

Figure 6. 1968 Ordnance Survey Map.



Plate 1. View of Rigg and Furrow. Features 4 and 5. Facing North-east.



Plate 2. View of Rigg and Furrow. Features 1 and 3. Facing South-east.



Plate 3. View of Ploughed out Rigg and Furrow. Feature 3. Facing South-east.



Plate 4. Feature 1. Facing East.





Plate 5. Feature 4. Facing North-west.



Plate 6. House Platform and Feature 7. Facing East.