

Figure 1. Site Location

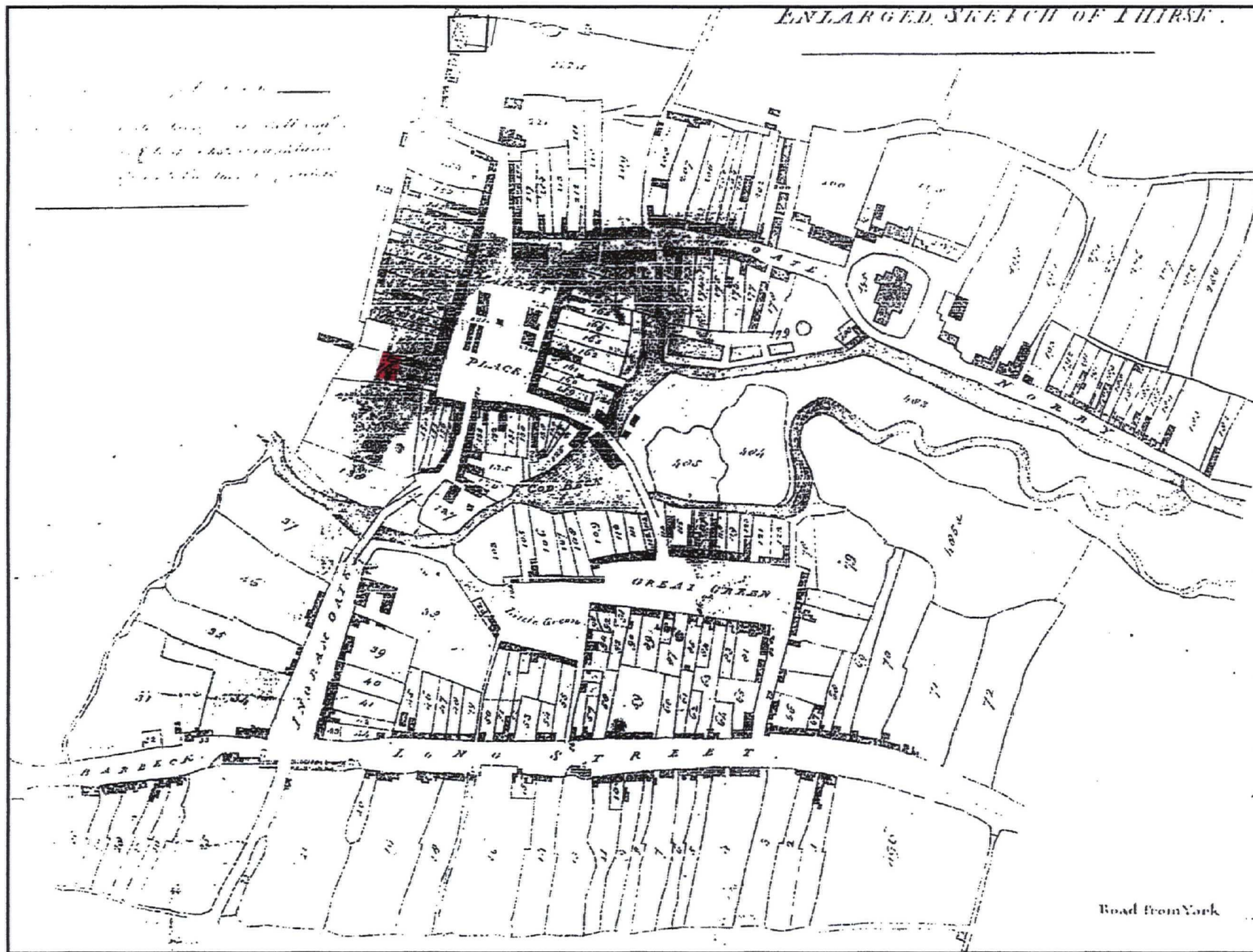

Figure 2. Extract from a 1796 Plan of Thirsk.

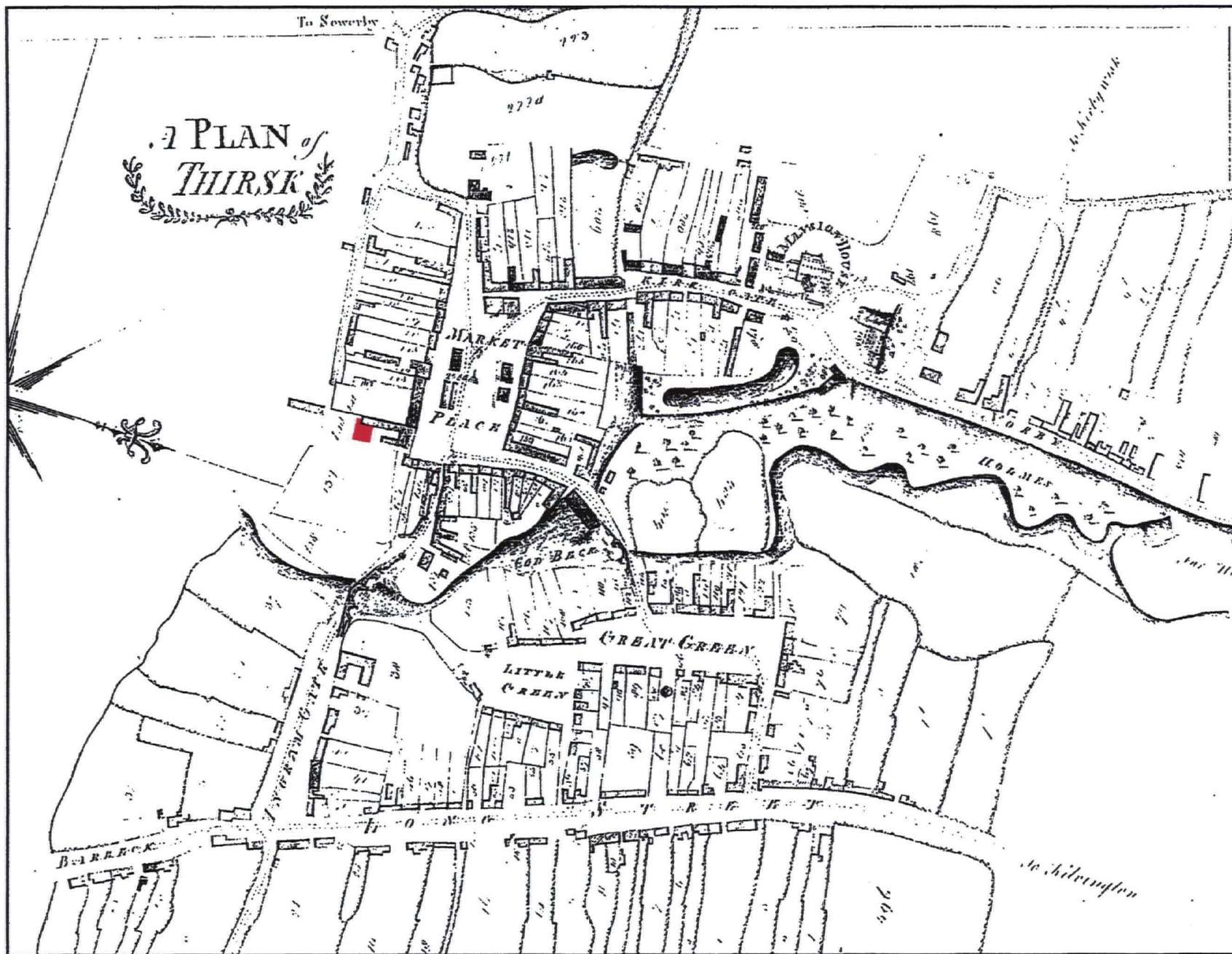

Figure 3. Extract from an 1803 Plan of Thirsk.



Figure 4. Extract from the 1843 Tithe Award Map.

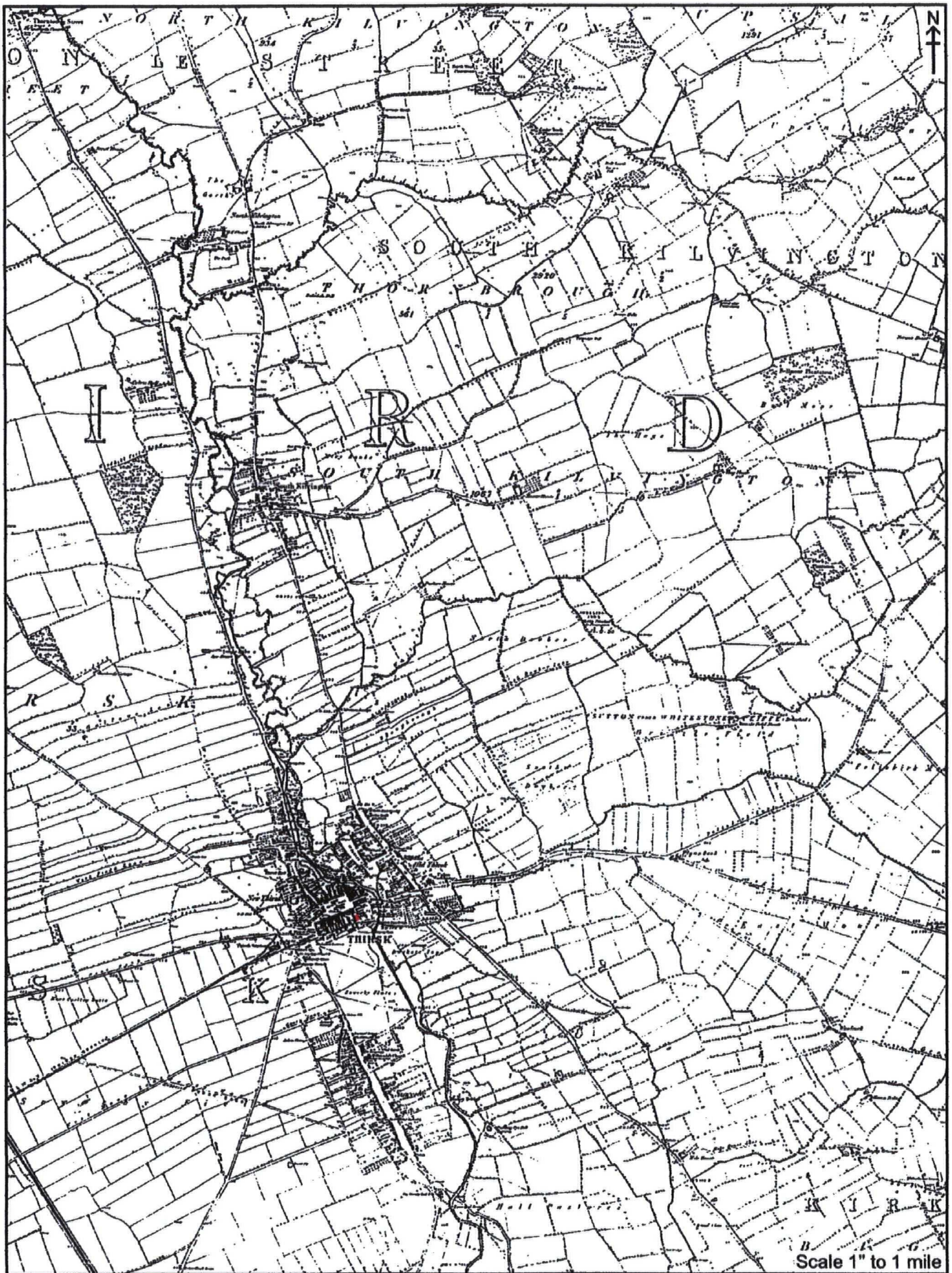

Figure 5. Extract from the 1856 Ordnance Survey First Edition Map.



Figure 6. Extract from the 1912 Ordnance Survey County Series Map.



Figure 7. Extract from the 1914 Ordnance Survey Map.



Figure 8. Extract from the 1972 Ordnance Survey Map.

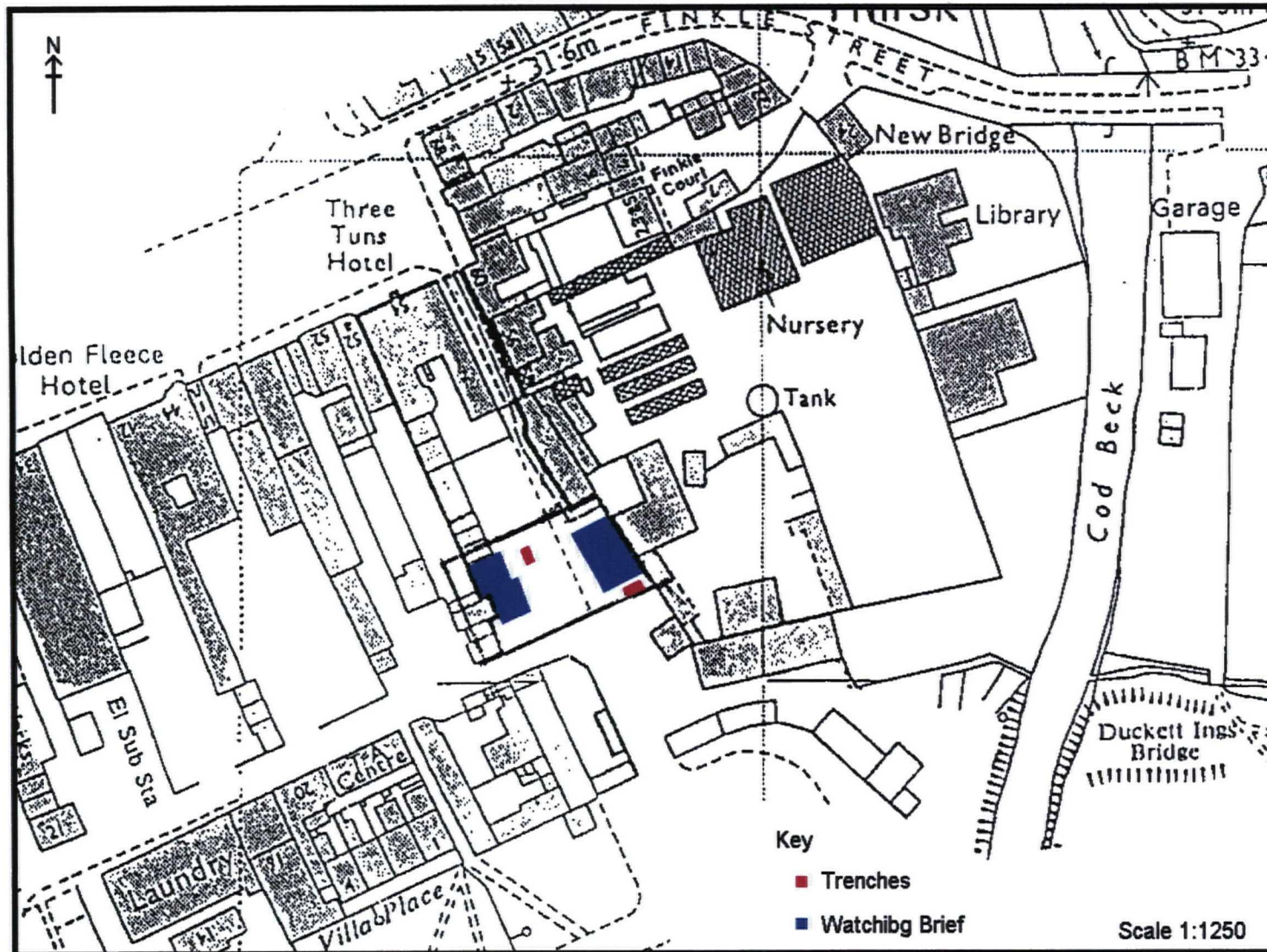

Figure 9. Trench and Watching Brief Location

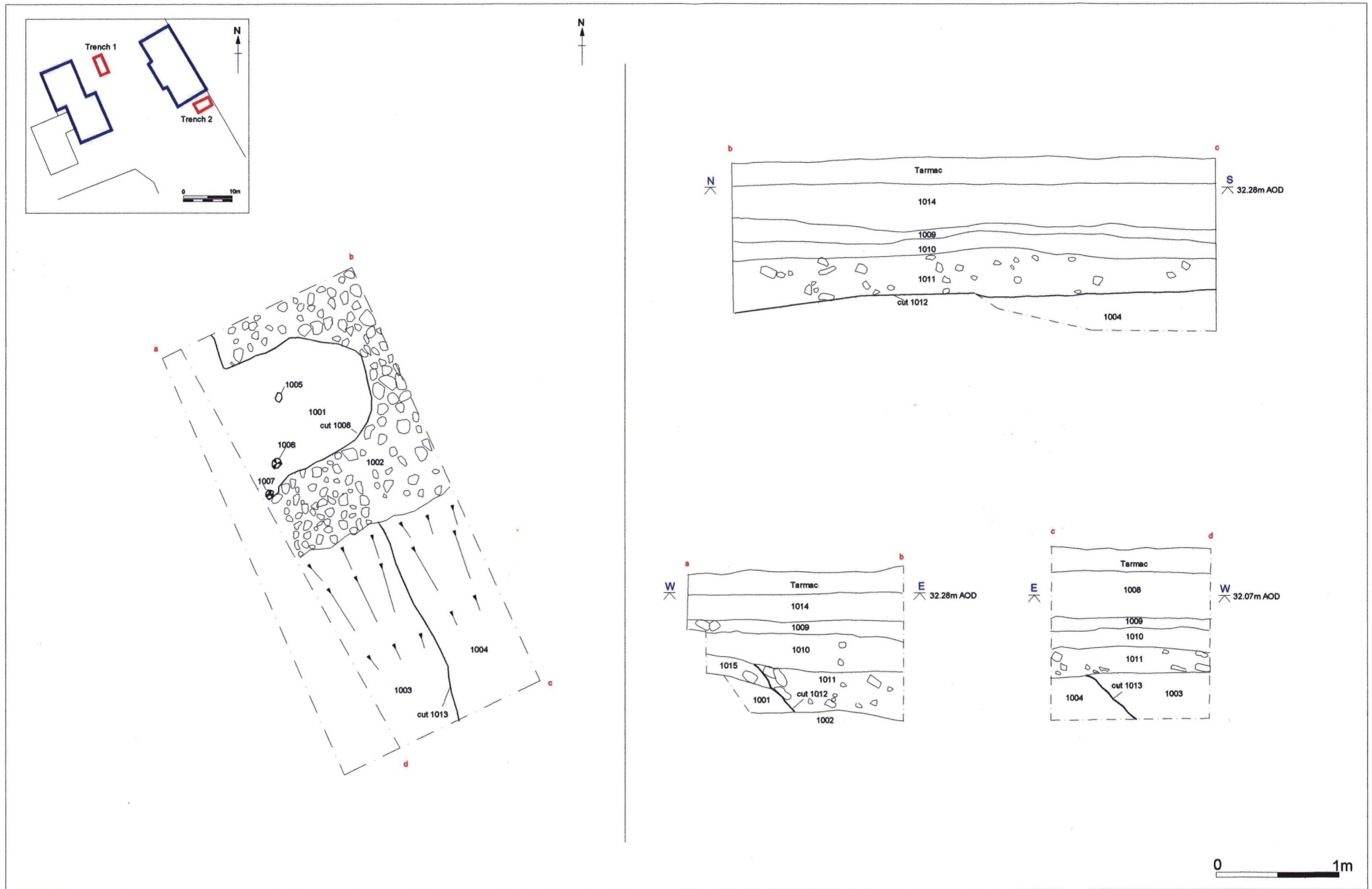

Figure 10. Trench 1 Plan & Section

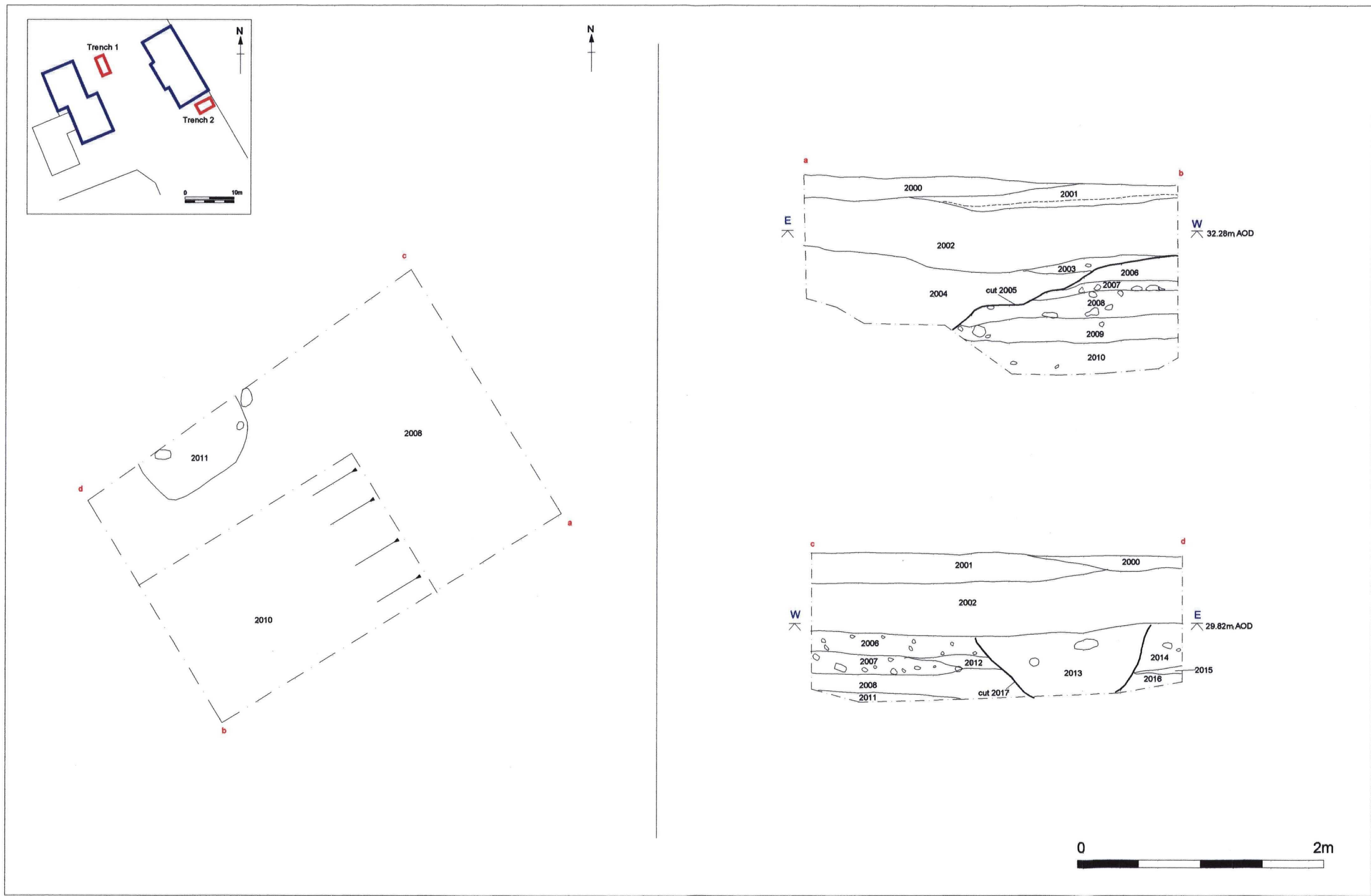

Figure 11. Trench 2 Plan & Section

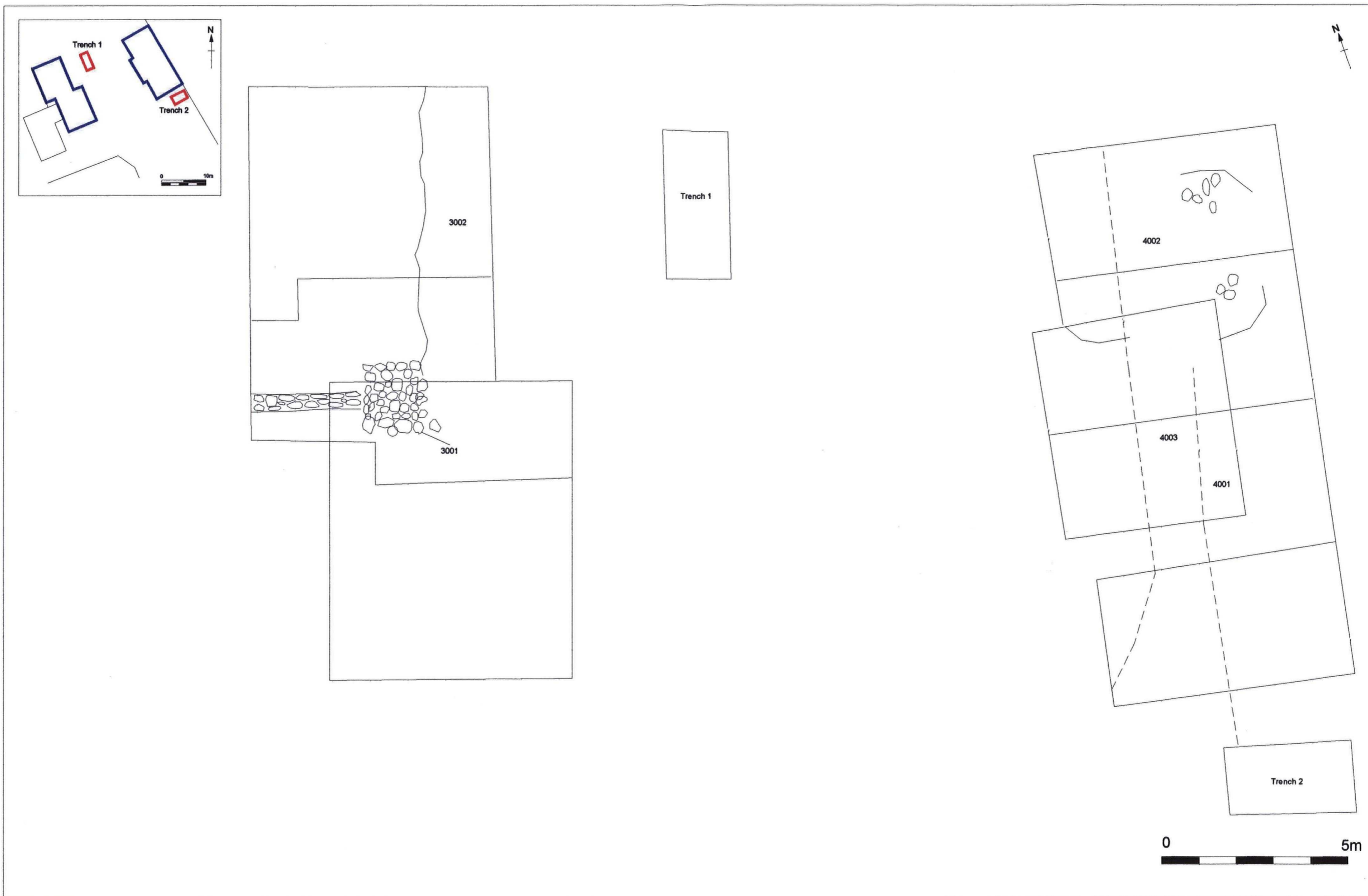

Figure 12. Watching Brief Results



Plate 1 . Trench 1. Facing south.



Plate 2. Trench 1. Facing north.



Plate 3. Trench 2. Facing south.



Plate 4. Trench 2. Facing north.

APPENDIX 1

Context	Description
Trench 1	
1001	Deposit, pit fill
1002	Deposit, yard surface or hard standing
1003	Deposit, plastic gritty silty clay, linear deposit
1004	Deposit, plastic silty clay, fill of large pit or organic river silt deposited
1005	Deposit
1006	Cut, stake hole unexcavated
1007	Cut, small unexcavated void, stake hole part of pit structure
1008	Cut, interface representing the abandonment and partial robbing of surface 1002 prior to deposition of context 1001
1009	Deposit, brownish grey, friable silty sand, thin band of material, probably bedding for a yard surface
1010	Deposit, leveling dump
1011	Deposit, deposit of clean demolition material within a cut feature
1012	Cut, cut feature seen as a steep edge in south facing section but also represented as an interface cobble surface
1013	Cut, linear cut feature, possible sub-rectangular pit or edge of larger pit feature
1014	Deposit, overburden deposit
1015	Deposit, very dark plastic silty clay
Trench 2	
2000	Deposit, concrete surface
2001	Deposit, soil surfacing
2002	Deposit, mid to dark friable sandy silt, even depth of cultivated or worked soil
2003	Deposit, possible substrake for surfacing
2004	Deposit, friable fine silty sand
2005	Cut, possible drainage ditch cut along line of back alley
2006	Deposit, friable sand/grit, possible surface of demolition material or demolition spread either way must have been the ground surface at some time
2008	Deposit, friable sandy silt, silty leveling or occupation deposit (flood or rubbish) overlying more structured represented by pit 2011
2009	Deposit, friable sandy grit, leveling dump possibly associated with pit phase of activity
2010	Deposit, friable silty sand
2011	Deposit, plastic clay
2012	Deposit, plastic silty clay
2013	Deposit, slightly plastic gritty silty clay, fill of ditch
2014	Deposit, slightly plastic silty clay
2015	Deposit, compact grit
2016	Deposit, very dark grey wet silt
2017	Cut, linear ditch cut, apparently following line of boundary possibly fill of town ditch
Watching Brief Area A	
3001	Cobble surface
3002	Silty clay and rubble deposit
Watching Brief Area B	
4001	Deposit, ditch deposit
4002	Deposit, silty clay with cobble inclusions
4003	Post medieval culvert

Appendix 2

Finds Listing

Context No	Description	Quantity	Date/type
1002	Pottery	2 sherds	Medieval, thirteenth to fourteenth century
2010	Pottery	2 sherds	Medieval, thirteenth to fourteenth century

APPENDIX 3

Archive Listing

Drawing No.	Scale	Description
1	01:20	Plan of deposits in trench 1 fully excavated
2	01:20	Plan of deposits in trench 2 fully excavated
3	01:10	North facing section trench 2
4	01:10	South facing section trench 1
5	01:10	North facing section trench 1
6	01:10	West facing section trench 1
7	01:10	South facing section trench 2

APPENDIX 4

Site Code: 01-05-02

Film No.443

Film Type:Colour slide

No	Context No	Scale	Facing	Comments/Identifier
1	Trench 1	2m/0.5m	E	Trench 1 west facing section
2	Trench 1	2m/0.5m	E	Trench 1 west facing section
3	Trench 1	2m/0.5m	N	Trench 1 south facing section
4	Trench 1	2m/0.5m	N	Trench 1 south facing section
5	Trench 1	2m/0.5m	S	Trench 1 north facing section
6	Trench 1	2m/0.5m	S	Trench 1 north facing section
7	Trench 1	2m/0.5m	W	Trench 1 general view showing western side of trench
8	Trench 1	2m/0.5m	SW	Trench 1 general view showing western side of trench
9	Trench 2	2m/0.5m	S	Trench 2 north facing section
10	Trench 2	2m/0.5m	S	Trench 2 north facing section
11	Trench 2	2m/0.5m	S	Trench 2 south facing section
12	Trench 2	2m/0.5m	S	Trench 2 south facing section