

Figure 1. Site Location.

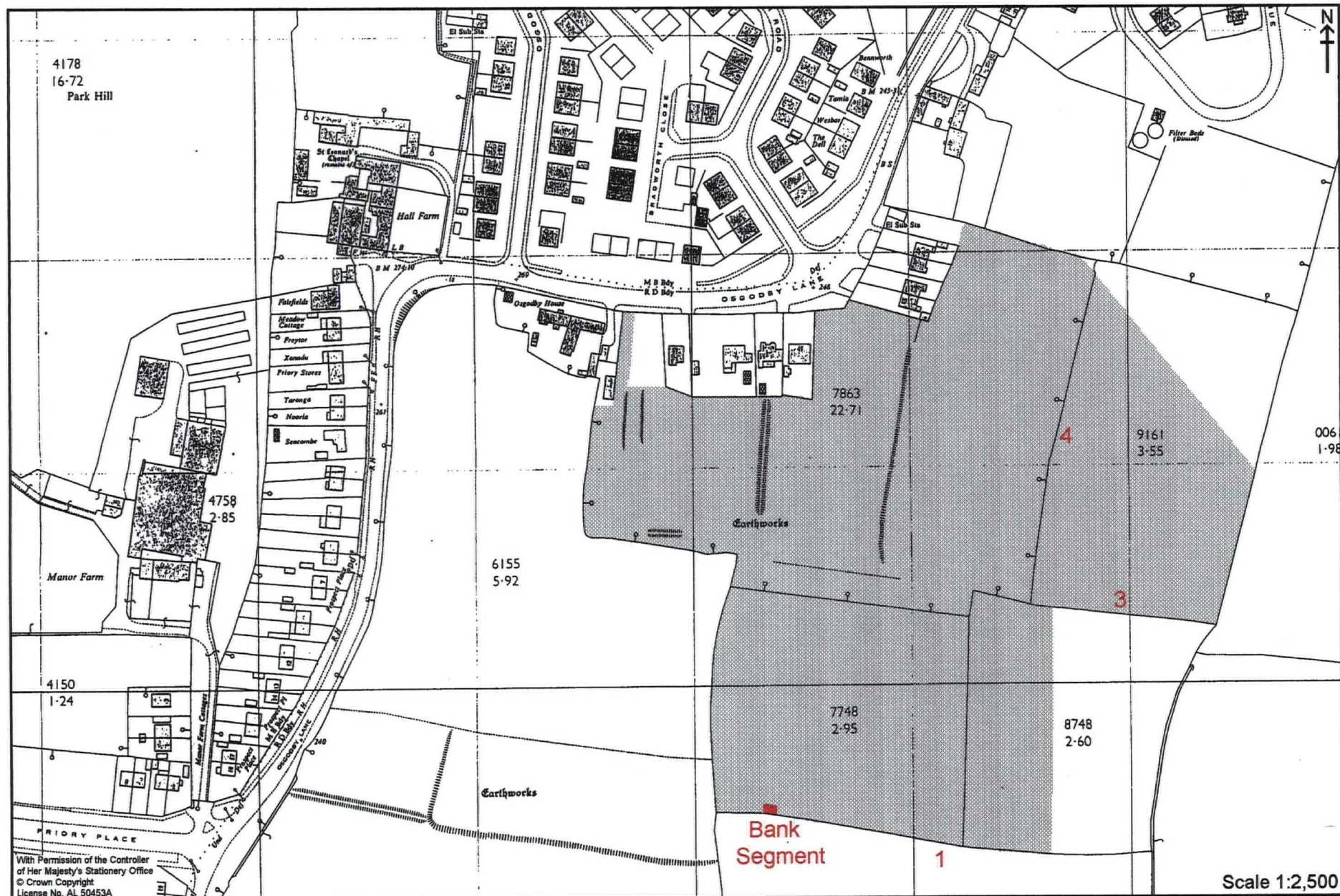

Figure 2. Location of Excavated Segment through Boundary Bank.

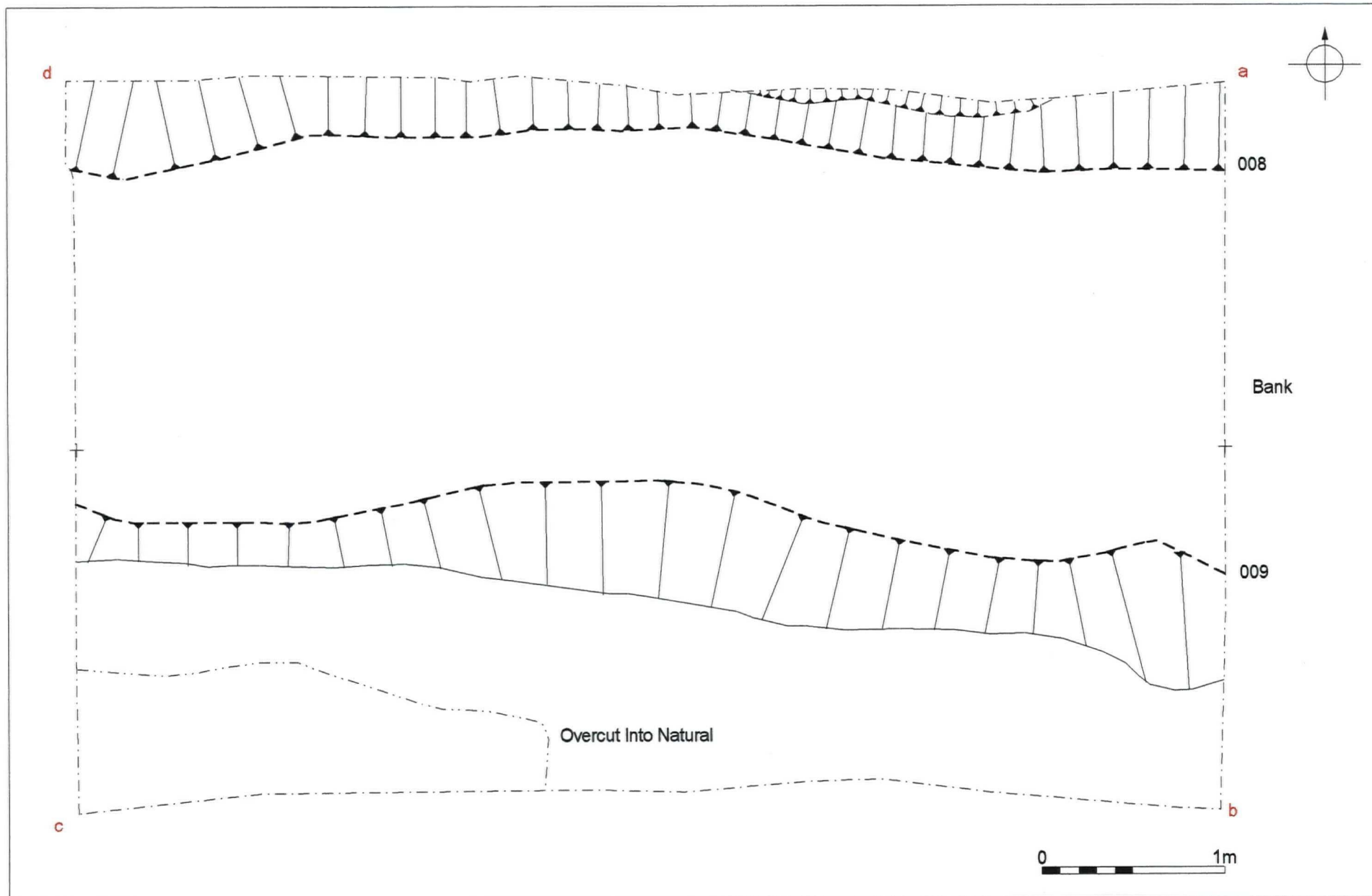

Figure 3. Post Excavation Plan of Segment Excavated through the Boundary Bank.

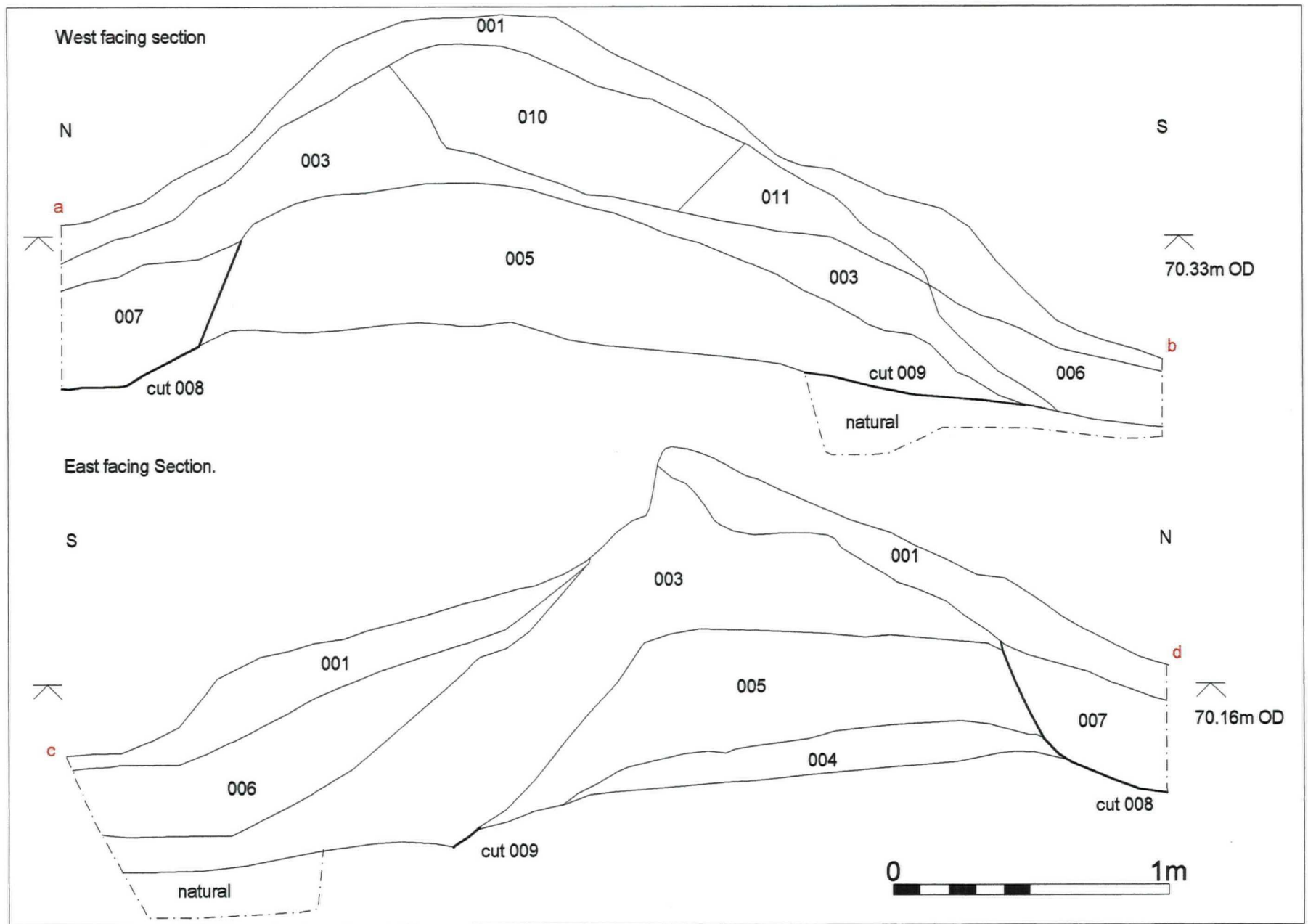

Figure 4. Sections of Segment Excavated through the Boundary Bank.



Plate 1. Boundary Bank after Removal of Hawthorne Hedge. Facing South-west.



Plate 2. West Facing Section of Boundary Bank. Facing East.



Plate 3. East Facing Section of Boundary Bank. Facing West.



Plate 4. Southern Side of Boundary Bank, Prior to Excavation. Facing West.



Plate 5. Cobble Revetting Wall 002. Facing North.



Plate 6. Base Course/Footing of Revetting Wall 002. Facing South.

APPENDIX 1

Context Listing

Context	Description
001	Deposit, top soil/turfline
002	Masonry, rough revetting wall
003	Deposit, friable sandy silt
004	Deposit, plastic slightly sandy clay
005	Deposit, plastic sandy clay
006	Deposit, slightly plastic clayey silt subsoil
007	Deposit, plastic sandy silty clay
008	Cut, interface with modern ploughing
009	Cut, interface with northern field
010	Deposit, fine slightly silty sandy clay
011	Deposit, plastic root disturbed silty sandy clay

APPENDIX 2

Finds Catalogue

Context	Type	Description	Weight	Spot Date
004	Ceramic	1 Gritty Ware 10 Staxton/Potter Brompton Ware 1 Scarborough Ware (Phase 1) 1 Scarborough Ware (Phase 2) 1 Humber Ware Rim	50g	14th/15th Century
	CBM	1 piece	15g	
	Flint	1 primary flint flake		

Lead Finds

Context	Size	Weight	Comments
004	20mm diameter	5g	Bale Seal

APPENDIX 3

Archive Listing

Plan No	Scale	Recorded By	Completed	Description
1	1:20	S.W.	13.02.01	Post excavation plan
Section No				
1	1:10	S.P.	13.02.01	West facing section of field bank
2	1:10	S.P.	13.02.01	East Facing Section of field bank

APPENDIX 4

**Osgodby
Photographic Listing
Film No. 141
Colour Print**

Neg. no.	Date	Context No	Scale	Facing	Comments/identifier
6	08/02/01	Boundary bank	1m	SW	Boundary bank after removal of hawthorne hedge
7	08/02/01	Boundary bank	1m	SW	Boundary bank after removal of hawthorne hedge
8	08/02/01	Revetting wall	2x1m	N	Full length of cobble revetting wall
9	08/02/01	context 002	2x1m	N	Full length of cobble revetting wall
10	08/02/01	context 002	2x1m	N	Full length of cobble revetting wall
11	08/02/01	context 002	2x1m	N	Full length of cobble revetting wall
12	08/02/01	Southern side of boundary bank	2m & 1m	W	Southern side of boundary bank de-turfed prior to excavation
13	08/02/01	Southern side of boundary bank	2m & 1m	W	Southern side of boundary bank de-turfed prior to excavation
14	Blank				
15	09/02/01	Base course of 002	1m	S	Base course/footing of revetting wall
16	09/02/01	Base course of 002	1m	S	Base course/footing of revetting wall
17	13/02/01	West facing section of bank	2mx1m	E	West facing section of boundary bank with scales
18	13/02/01	West facing section of bank	2mx1m	E	West facing section of boundary bank with scales
19	13/02/01	West facing section of bank	1m	E	West facing section of boundary bank without scales
20	13/02/01	West facing section of bank	1m	E	West facing section of boundary bank without scales
21	13/02/01	East facing section of bank	1m	W	East facing section of boundary bank without scales
22	13/02/01	East facing section of bank	2mx1m	W	East facing section of boundary bank without scales
23	13/02/01	East facing section of bank	2mx1m	W	East facing section of boundary bank with scales
24	13/02/01	East facing section of bank	2mx1m	W	East facing section of boundary bank with scales
25	13/02/01	Post excavation	2m	NW	North-west facing view of excavated ditch section
26	13/02/01	Post excavation	2m	NW	North-west facing view of excavated ditch section
27	13/02/01	Post excavation	2m	W	West facing view of excavated ditch section
28	13/02/01	Post excavation	2m	W	West facing view of excavated ditch section
29	13/02/01	General view	None	W	General view of site showing condition after excavation