

Figure 1. Site Location.

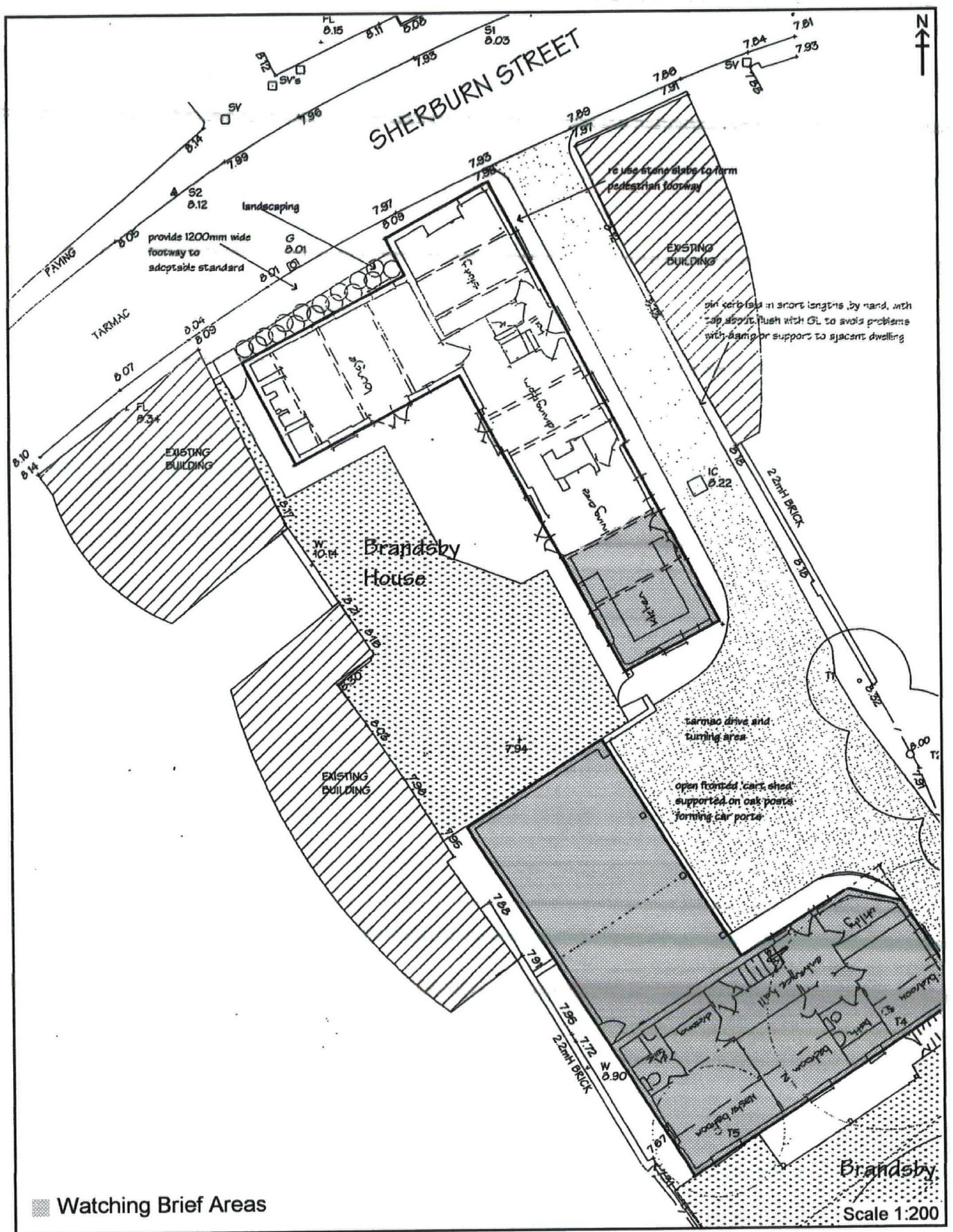

Figure 2. Redevelopment Plan.

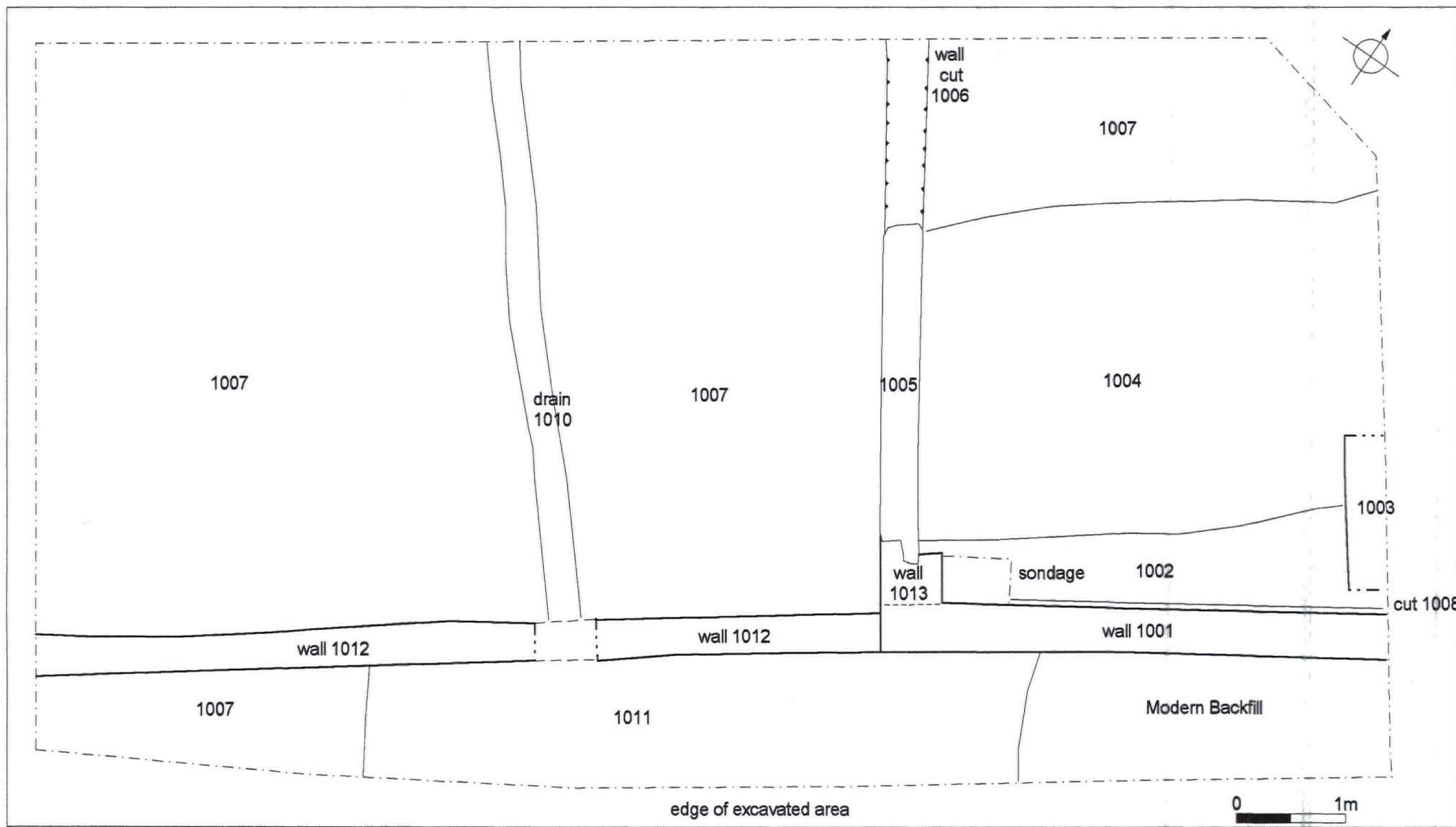

Figure 3. Plan of Watching Brief Area.



Plate 1. Wall 1001. Facing Southwest.

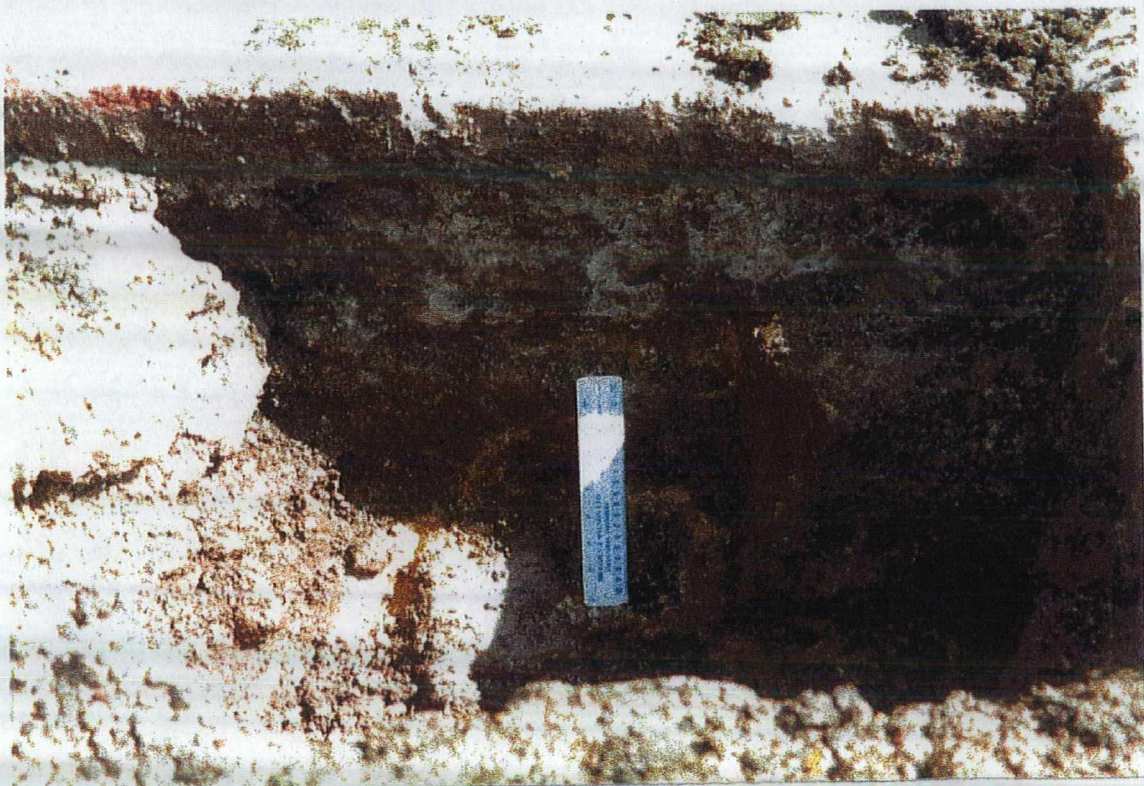

Plate 2. Detail of Wall 1001. Facing Southeast.



Plate 3. Wall 1012. Facing Southwest



Plate 4. Wall 1005, constructed on Wall 1013. Facing Northwest.



Plate 5. Dressed stone from Deposit 1000.



Plate 6. Building stone from Deposit 1000.



Plate 7. Rear of Brandsby House prior to Demolition. Facing South.



Plate 8. Nineteenth Century Copper in Scullery prior to Demolition. Facing South.

APPENDIX 1

Context Listing

Trench 1

Context	Description
1000	Deposit; Mid grey-brown clayey silt; modern made ground/backfill.
1001	Structure; Dressed limestone with cream-yellow sandy mortar, Wall.
1002	Deposit; Mid grey-brown silty gravel; Floor surface.
1003	Structure; Unbonded hand-moulded red brick; wall foundation.
1004	Deposit; mid brown-grey clayey silt; occupation layer.
1005	Structure; hand-moulded red brick with mid yellow-cream mortar; Wall.
1006	Cut; linear plan, flat bottom and vertical sides; foundation cut for Wall 1005.
1007	Deposit; Mid grey silty clay; subsoil.
1008	Cut; linear plan, unexcavated; foundation cut for wall 1001.
1009	Cut; linear plan; field drain cut filled by Drain 1010.
1010	Structure; unmortared unglazed terracotta pipe; Post-Medieval field drain.
1011	Deposit; dark grey-black ashy silt; Modern rubbish pit fill.
1012	Structure; roughly dressed limestone blocks; no mortar; wall.
1013	Structure; Roughly dressed limestone with cream-yellow sandy mortar; wall.
1014	Structure; Red brick with cream-yellow mortar: wall.

Trench 2

Context	Description
2000	Structure; concrete over mortared crushed brick; Modern floor.
2001	Deposit; Mid grey-brown clayey silt; modern made ground.
2002	Deposit; mid grey silty clay; subsoil.

APPENDIX 2

Finds Catalogue

Context	Description
1000	1 PGL 1 SG/RN (frilled base from jug/mug) 21 RW (2R, 2B) 1 Freschen Stoneware 1 RSL 9 BW (3 R) 7 STSLW (3 R) 1 NT 1 creamware 1 English Salt-Glazed Stoneware Plate Sherd 4 19th Century Sherds 2 Peg Tile fragments Date Range 15th-19th Century Spot date 19th-20th Century
1004	1 Staffs SL 1 NT

	Date Range	Mid-Late 18th Century		
	Spot Date	Late 17th Century		
1007		1 CT (Decorated Rim)		
		1 MN (Staffs Type)		
		2 Joining Sherds from a costrel, import?		
	Date Range	Late 15th-17th Century		
	Spot Date	Late 17th Century		
1010		1 RW Rim		
		1 BW Base		
		1 Pearlware		
	Date Range	Late 16th Century- Early 19th Century		
	Spot Date	Early 19th Century		
2002		1 Gritty Ware		
		1 Beverley Ware I		
	Date Range	12th Century		
	Spot Date	12th Century		
Context	Type	Amount	Weight	Spot Date
1000	Pottery	50 sherds	1.750kg	19th/20th
	Bone	3 pieces	355g	
	Clay Pipe	3 pieces	20g	
	Shell	2 pieces	10g	
	Lead		1.880kg	
1004	Pottery	2 sherds	75g	Late 18th
	Bone	1 piece	30g	
1007	Pottery	4 sherds	50g	Late 17th
1010	Pottery	3 sherds	115g	Early 19th
2002	Pottery	2 sherds	30g	12th century

APPENDIX 3

Archive Listing

Plan no.	Scale	Description
1.	1:50	Trench 1, plan of features visible at contractors excavation depth.

APPENDIX 4

Photographic Listing

Film no. 197

Colour print

Neg No.	Context	Scale	Facing	Description
1.	-	-	-	ID shot
2.	1012	1x1m	SE	Modern drain cut through wall 1012
3.	1012	1x1m	SE	Modern drain cut through wall 1012
4.	1001	1x1m	SW	Wall 1001
5.	1001	1x1m	SW	Wall 1001
6.	1005	1x1m	NW	Wall 1005 1013 and Wall 1013
7.	1005	1x1m	NW	Wall 1005 1013 and Wall 1013
8.	1001	1x1m	S	General view 1004, 1005
9.	1001	1x1m	S	General view 1004, 1005
10.	1000	1x1m	-	Dressed stone from Deposit 1000
11.	1000	1x1m	-	Dressed stone from Deposit 1000
12.	1001	1m	SE	Sondage cut showing Wall 1001
13.	1001	-	SE	Sondage cut showing Wall 1001
14.	1000	-	-	Building stone from Deposit 1000
15.	1000	-	-	Building stone from Deposit 1000
16.	1007	-	S	General view showing 1007
17.	1007	-	S	General view showing 1007
18.	1012	1x1m	SE	Wall 1012,1009 Field Drain 1009
19.	1012	1x1m	NE	Wall 1012
20.	1012	1x1m	NE	Wall 1012
21.	1012	1x1m	SW	Wall 1012
22.	1012	1x1m	SW	Wall 1012