

## THE BRIGANTIA ARCHAEOLOGICAL PRACTICE

BRITANNIA CHAMBERS  
18a HORSEMARKET  
BARNARD CASTLE  
Co DURHAM DL12 8LZ



NYE 1256  
NYS 7693

Tel/fax: 01833 630125 Email: enquiries@brigantiaarchaeology.co.uk

Gail Falkingham,  
Heritage Unit,  
North Yorkshire County Council,  
County Hall,  
Northallerton DL7 8AQ.

N.Y.C.C. ENVIRONMENTAL SERVICES	
Recd.	- 4 APR 2002
Pass to	JHE
Ackd.	
3 <sup>rd</sup> April 2002	

NYCC HER	
SNY	7693
ENY	1256
CNY	1173
Parish	1075
Rec'd	04/04/2002

Dear Gail,

### CHURCH VIEW, HORNBY

This is to confirm that on the 27<sup>th</sup> March I carried out an archaeological watching brief on behalf of Mr John Morris (of Northland Properties) at the rear of no 6, Church View, Hornby, where he is building a private double garage. Work was carried out in accordance with N.Y.C.C.'s standard W.S.I. for watching briefs. I enclose a location plan, supplied by Mr Morris, which shows the site on the western edge of the village.

SE 22179  
93701

Nothing of archaeological significance was discovered during the operation. The upper 30 cms were a loose dark topsoil, containing large amounts of stone and brick rubble and fragments of modern pantiles identical to those on adjacent buildings: this deposit cannot be earlier than the building work of the past few years. Below this layer was a light brown, sandy loam, also loose in texture and also with much stone (rounded cobbles and small boulders): there is no reason to consider this to be significantly earlier than the upper deposit, and both make sense as dumps of waste or spare stone left at the edge of the building plot. The natural, light brown sand lay at an average of 75 cms below the ambient surface. No object was found earlier in date than the twentieth century.

The field immediately west of the site has a number of earthworks, some of which seem to indicate an eastward creep of the village (presumably associated with the emparkment). Those banks at the western side of the field do appear to form rectilinear enclosures suggestive of mediaeval tofts (and they show clear signs of being turf-covered stone walls), but those further east are relatively formless, and look to me as if they might have been left by dumping or by small-scale 'borrow pit' extraction of sand and gravel. Matters are rather complicated a few metres west of the existing trackway by a series of hydraulic rams, created to meet the various needs of the Leeds estate and the explanation for at least some of these earthworks.

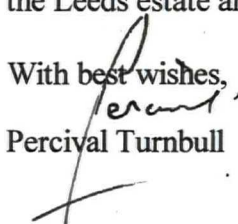
With best wishes,  
  
Percival Turnbull

cc. Mr John Morris

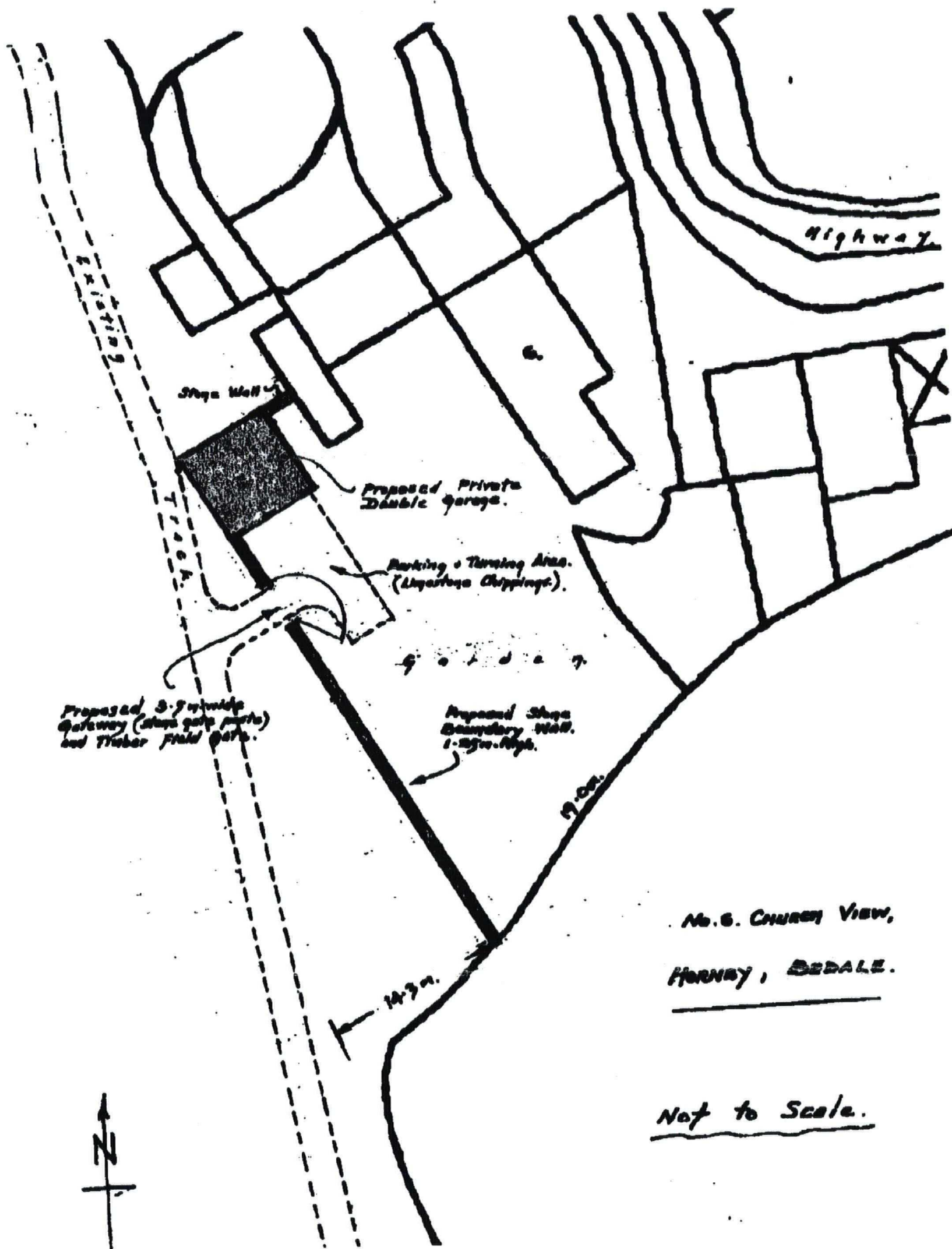

No. 6. Church View,  
Hornby, BEDALE.

Not to Scale.