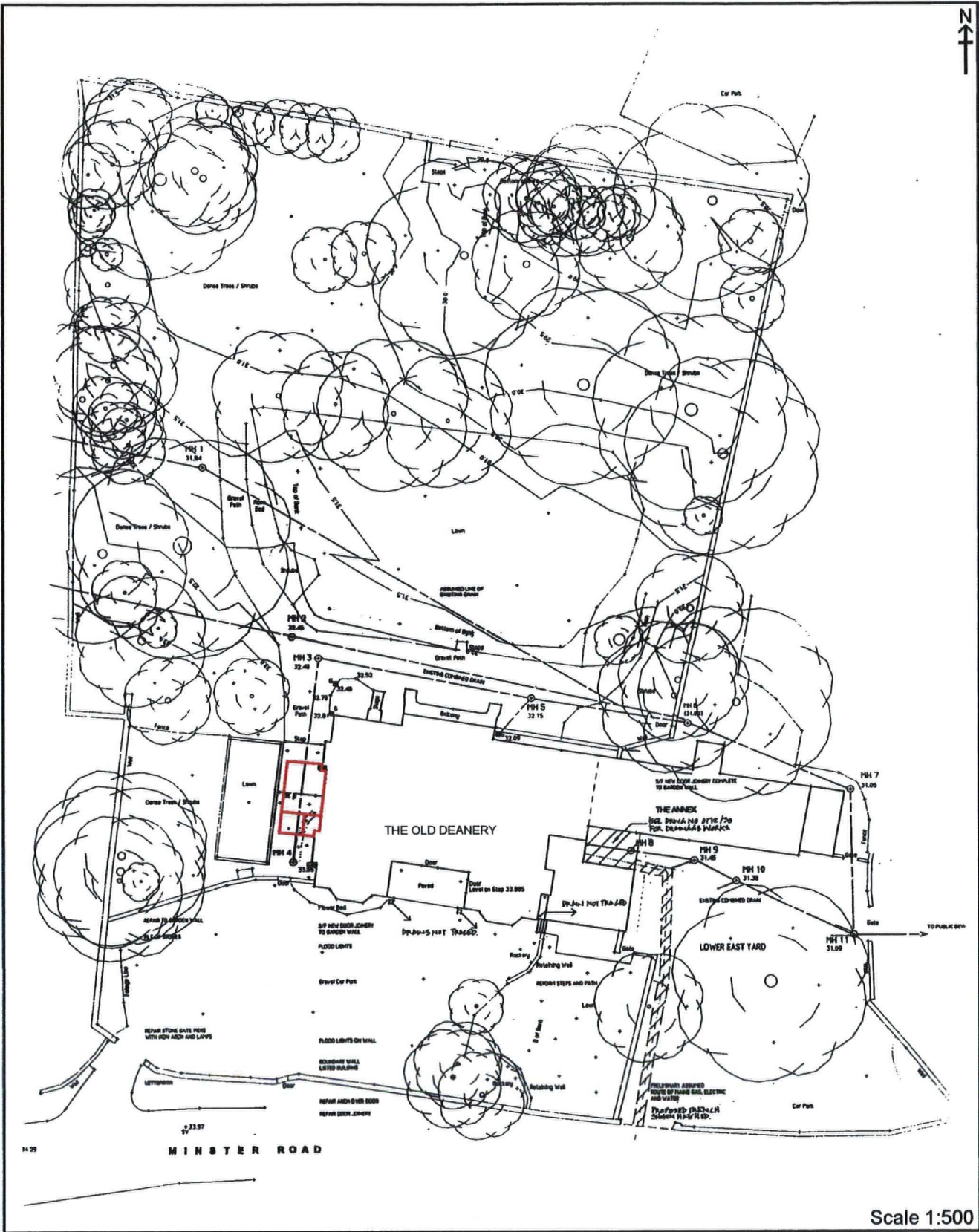

Figure 1. Location of Scheduled Ancient Monument NY 1282.



Scale 1:500

Figure 2. Proposed Development Area.

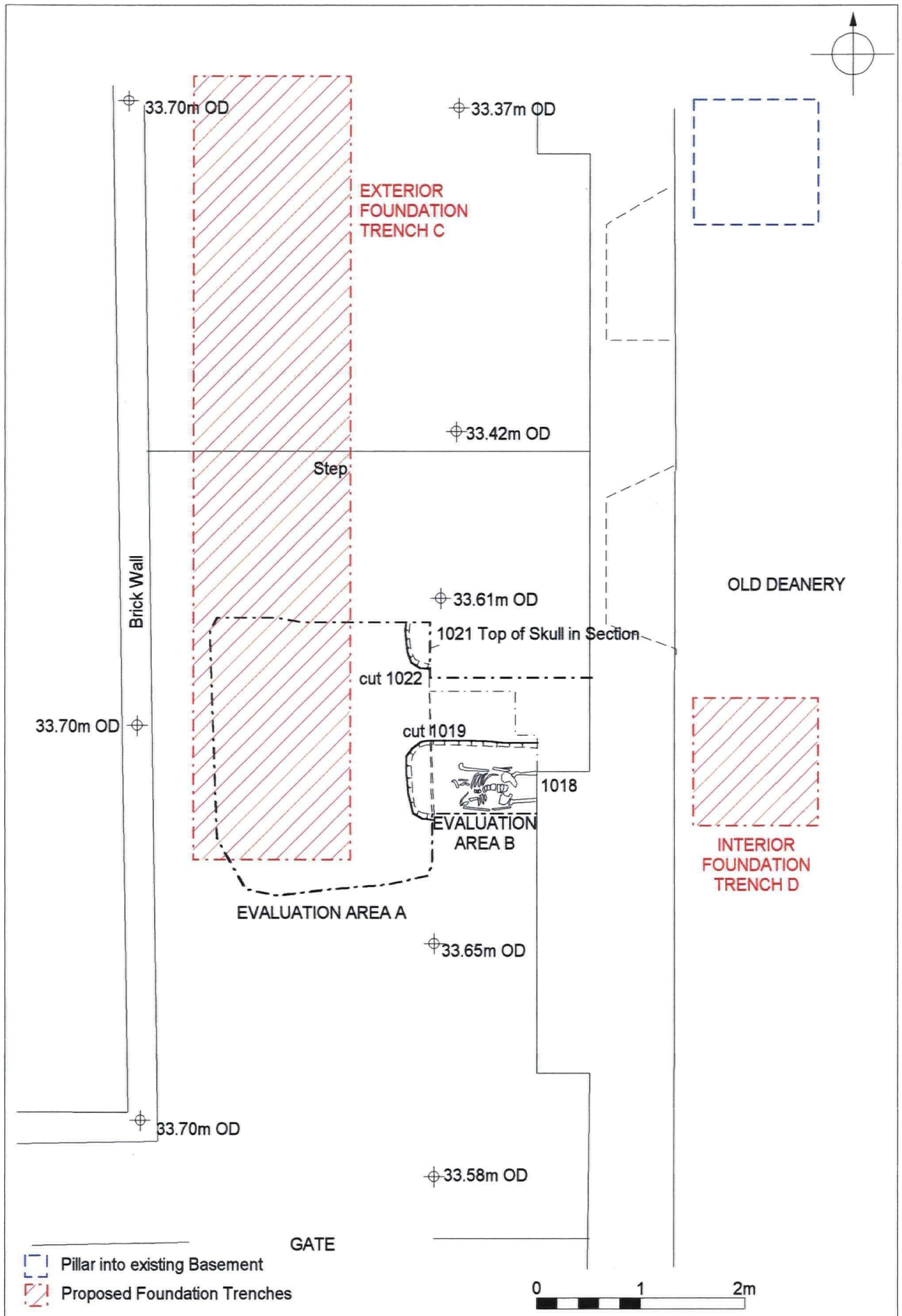

Figure 3. Excavation Areas C and D.

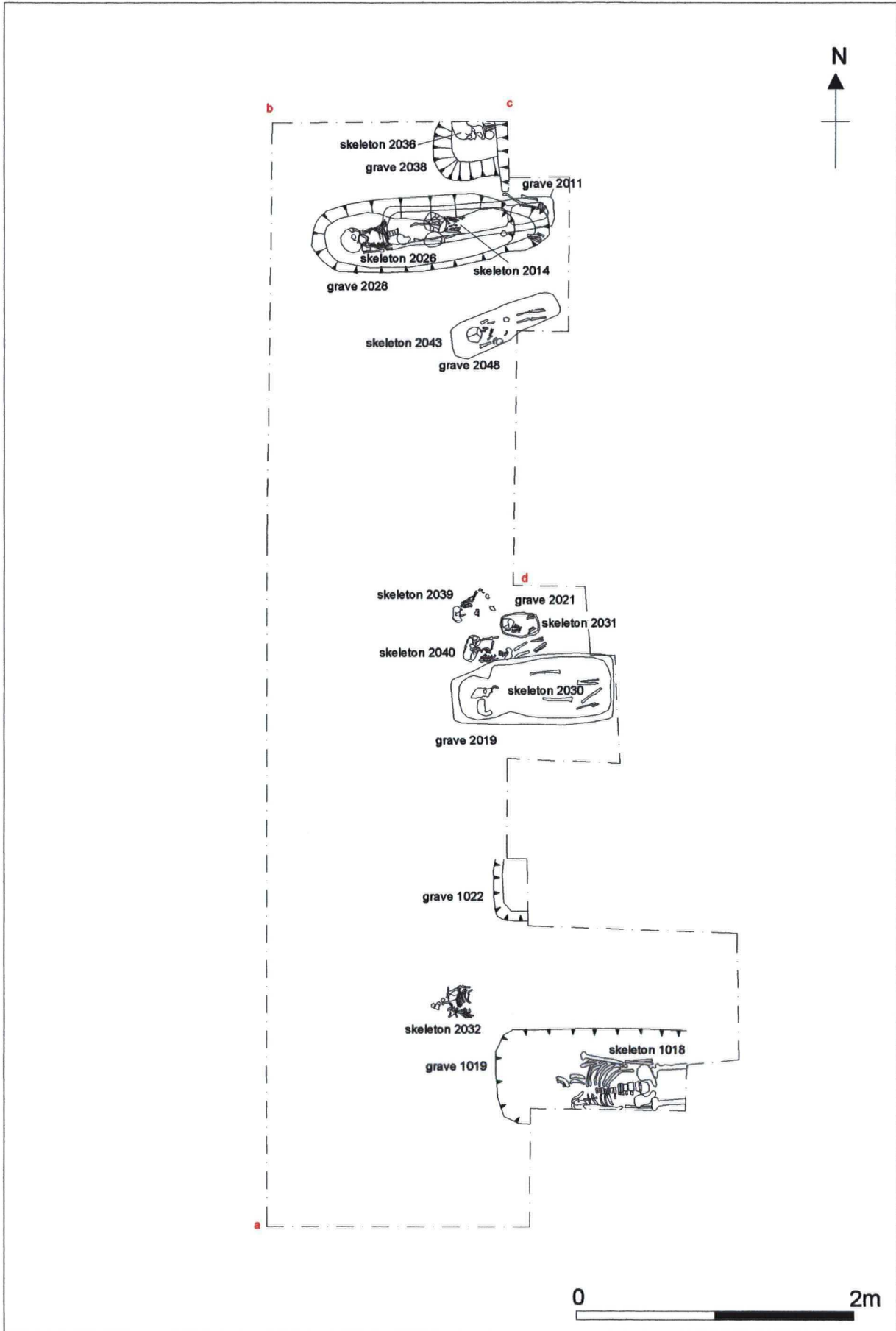

Figure 4. Plan of Burials 1014, 2026, 2030, 2031, 2032, 2936 & 2040

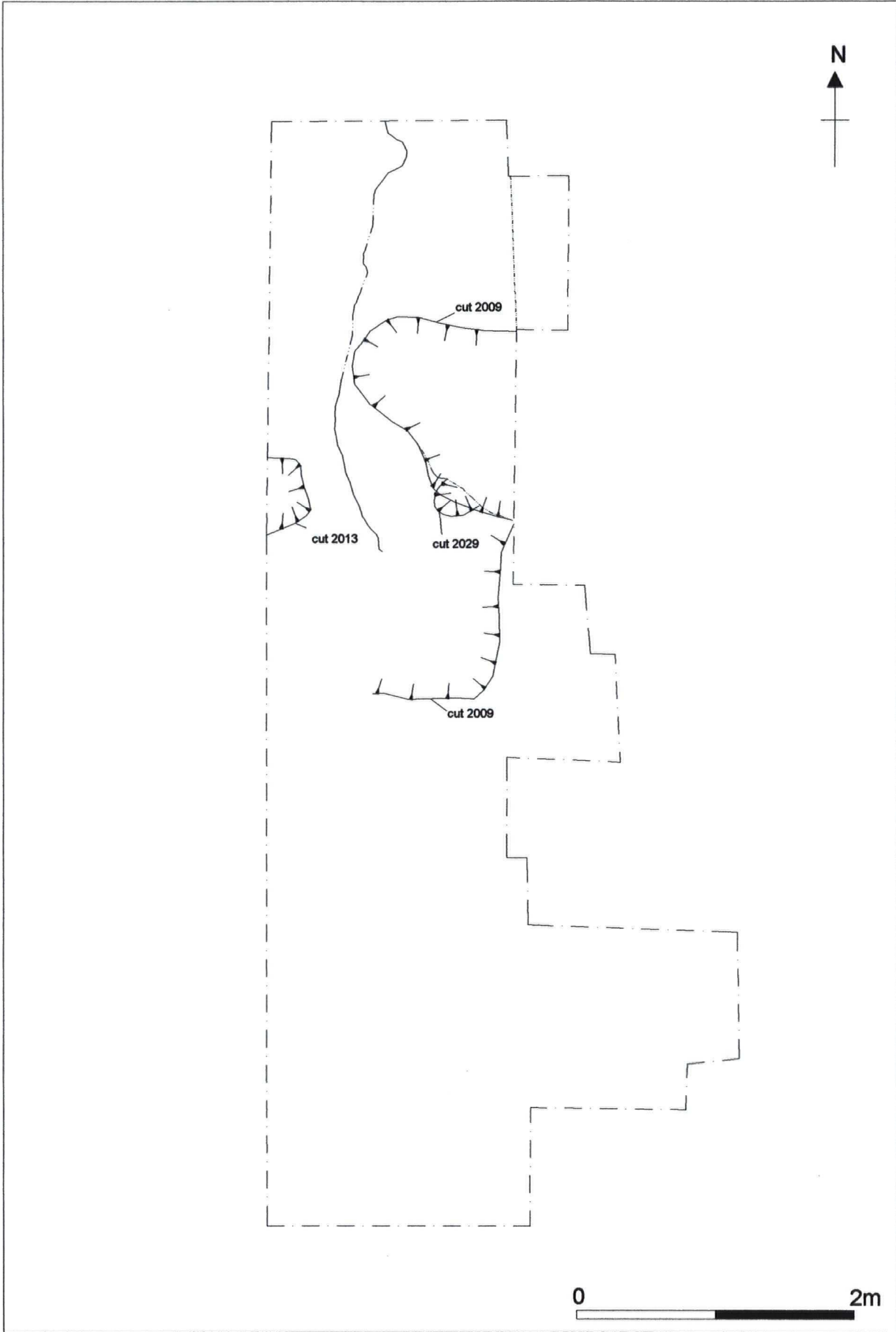

Figure 5. Plan of Foundation Cut 2009/2053 and Features 2013 & 2029

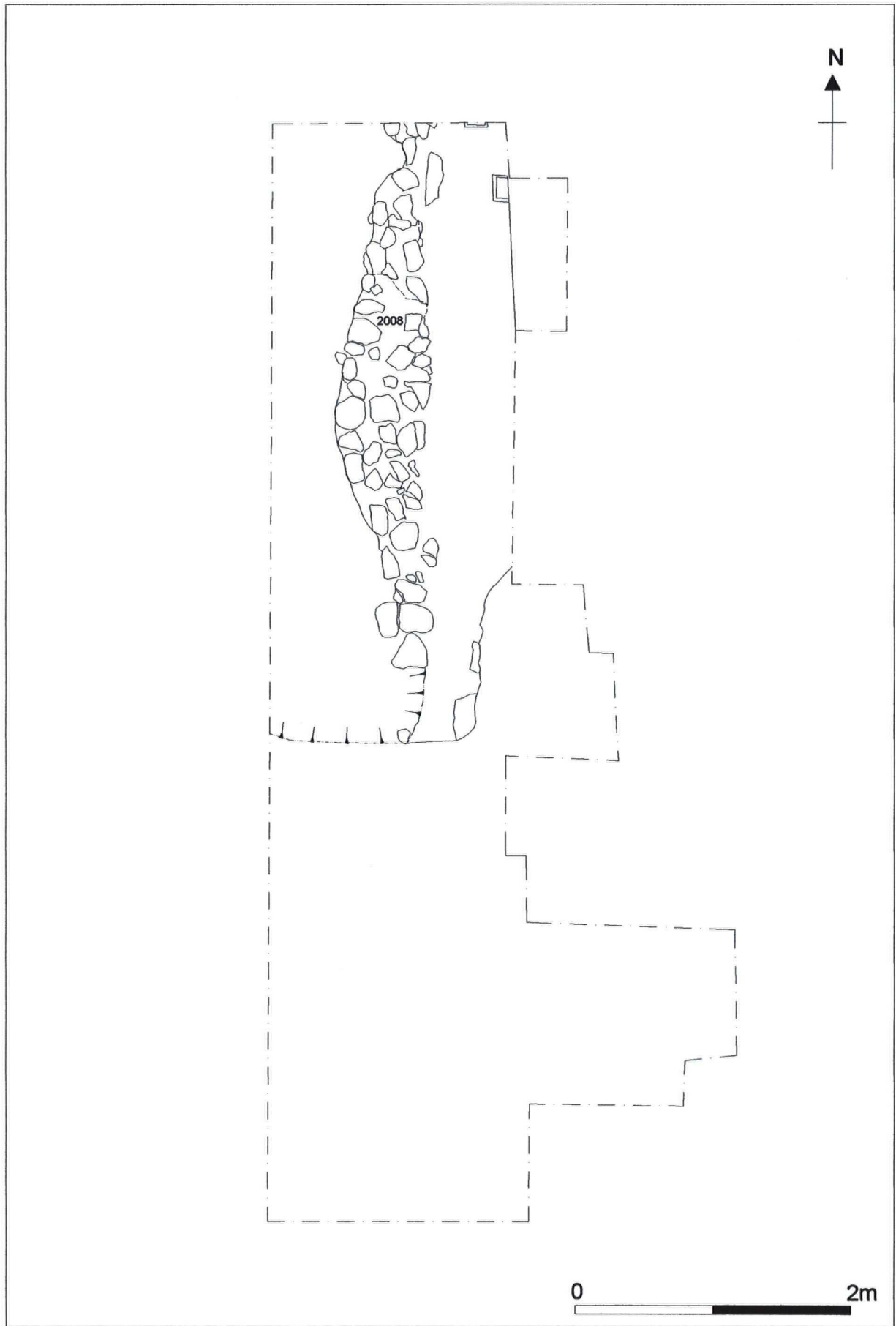

Figure 6. Plan of Cobble and Clay Structure 2008

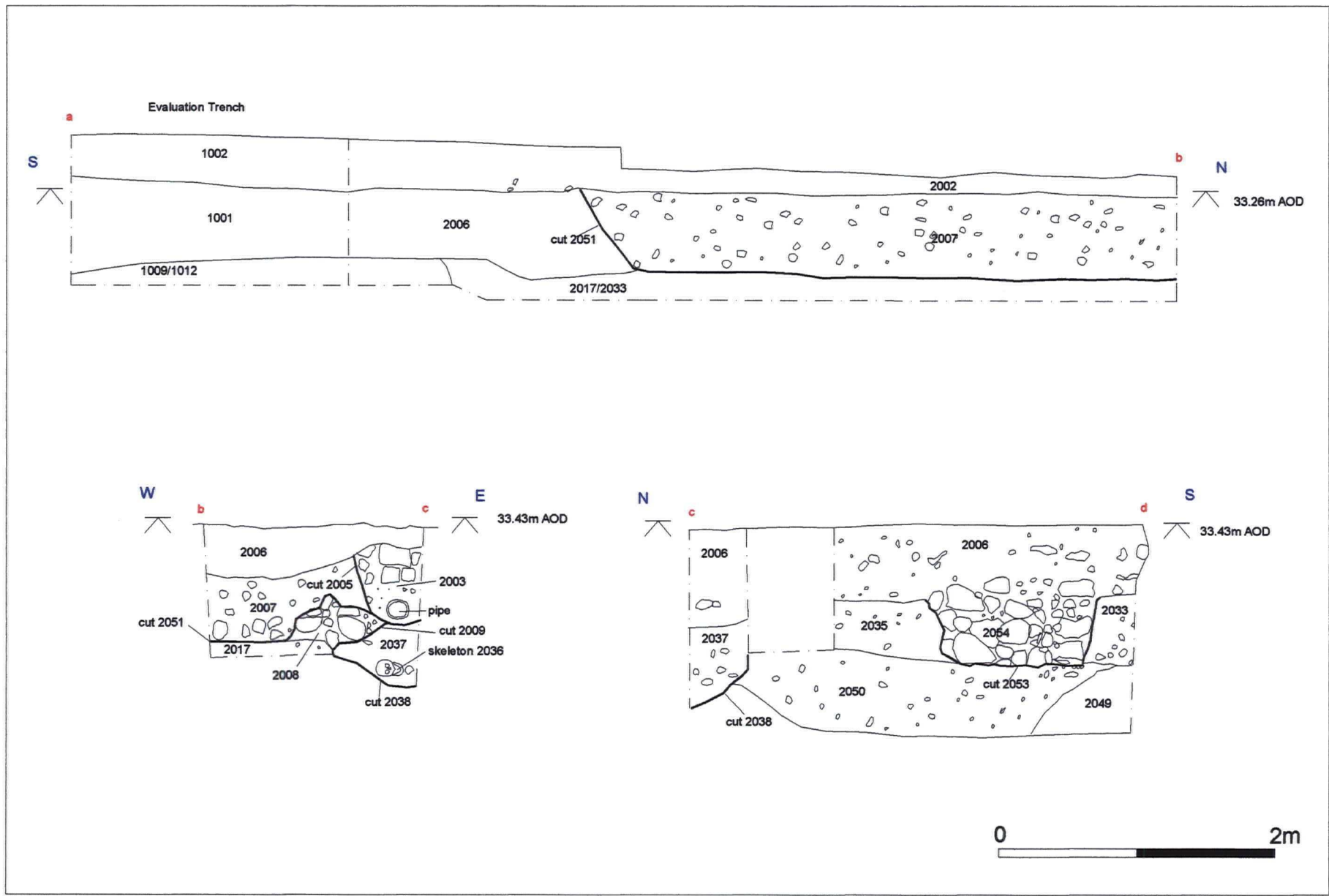

Figure 7. South, East and West Facing Sections



Plate 1. View of Burial 2036. Facing North.



Plate 2. View of Burial 2026. Facing South.



Plate 3. View of Burial 2014. Facing West.

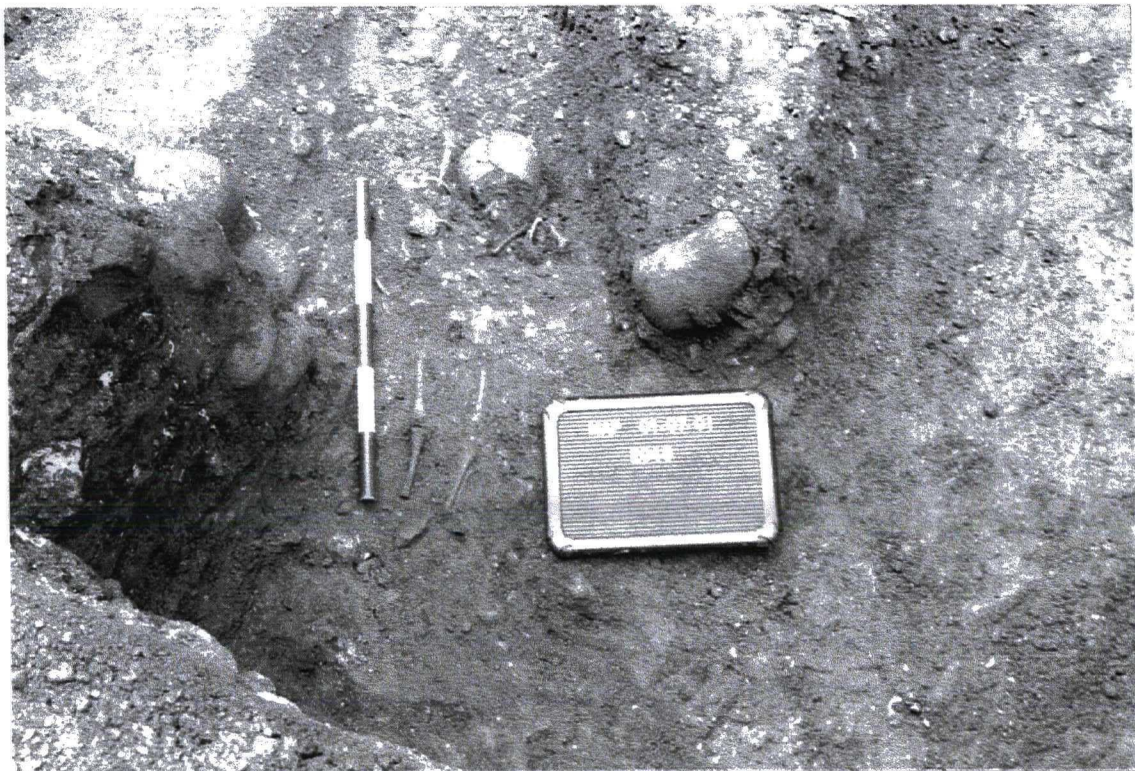

Plate 4. View of Burial 2043. Facing South-west.

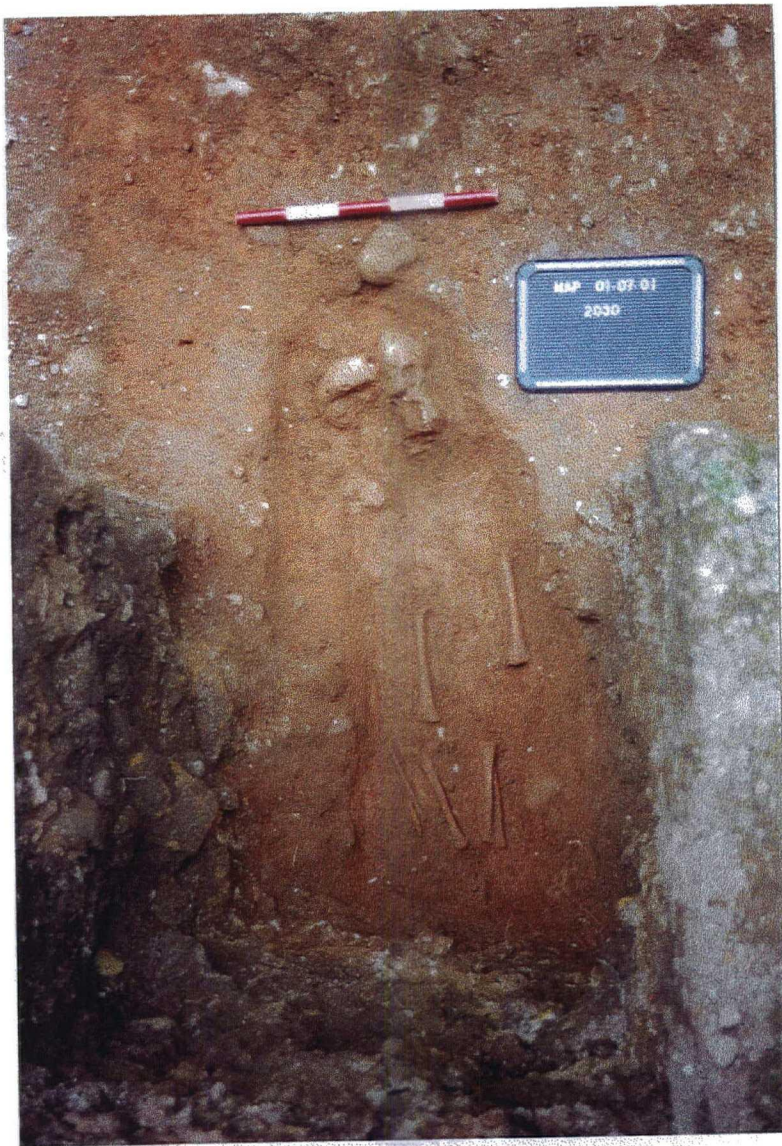

Plate 5. View of Burial 2030. Facing West.

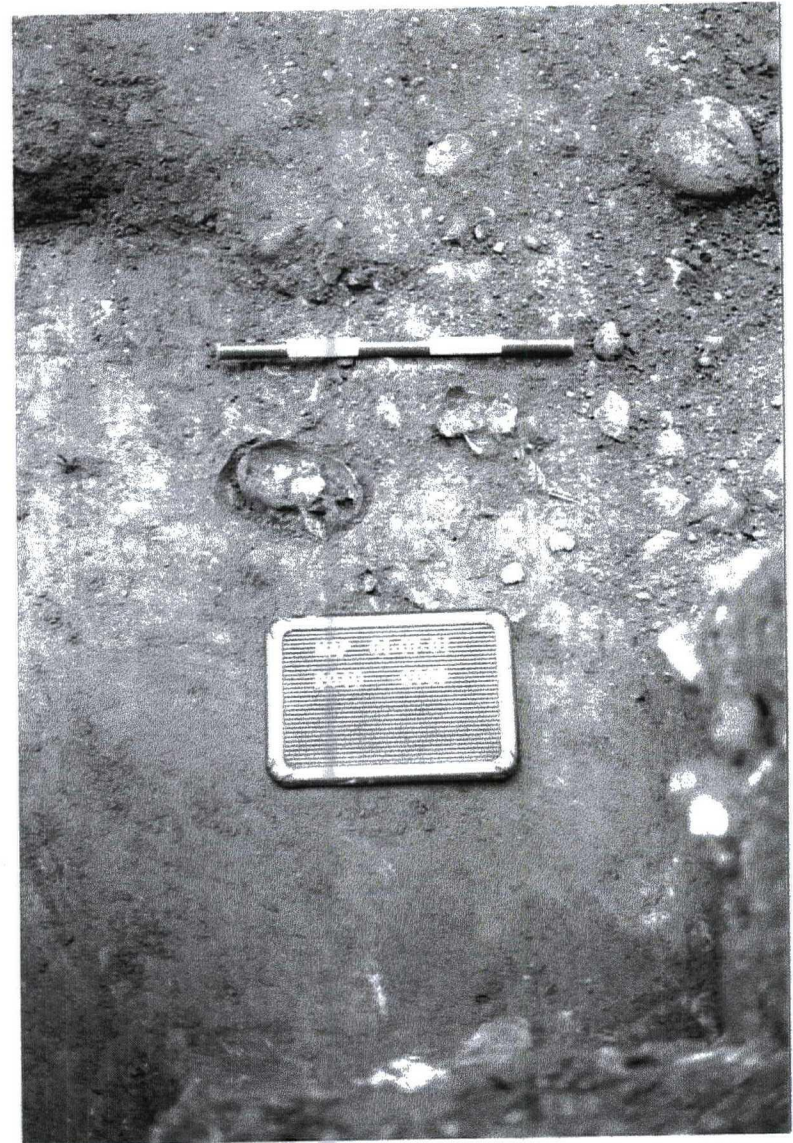

Plate 6. View of Burials 2039 and 2040. Facing West.



Plate 7. View of Burial 2031. Facing West.



Plate 8. View of Burial 2032. Facing North.



Plate 9. View of Clay and Cobble Structure 2008.
Facing South.

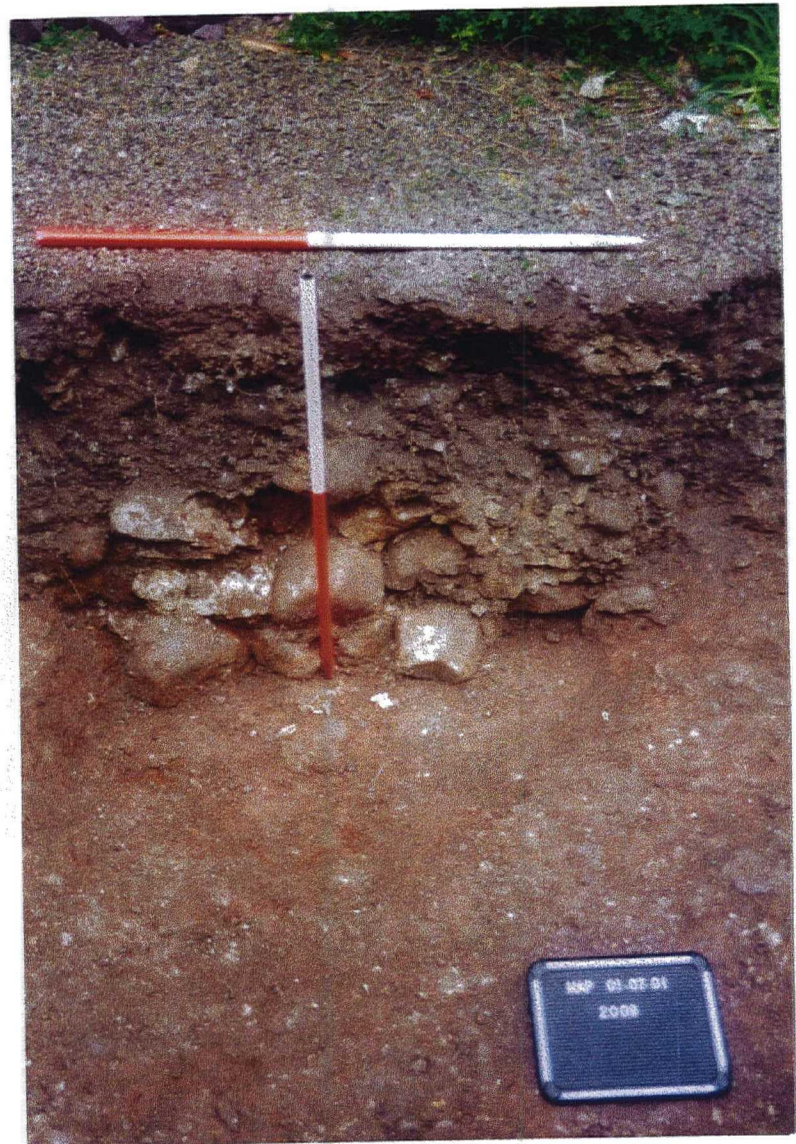

Plate 10. View of Clay and Cobble Structure 2054.
Facing East.