

- Site boundary ▭
- Area thought to be affected by cellars ▭
- Extant fragments of 19<sup>th</sup> C masonry ▭
- Line of 'moat' shown on 19<sup>th</sup> C maps ▭

FIGURE 1  
 EXTRACT FROM THE 1:500 SCALE ORDNANCE SURVEY MAP OF 1892  
 SHOWING THE SITE BOUNDARY AND OTHER FEATURES

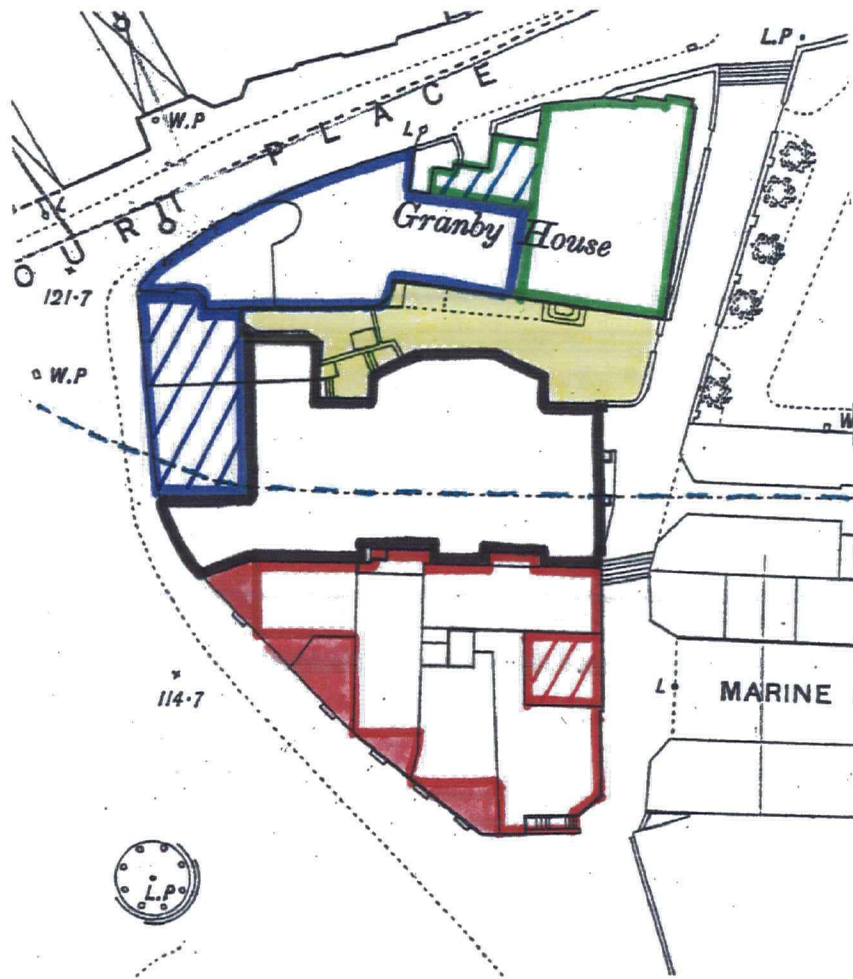



1725-45	to	1892-1912	
1725-45	to	present	
1745-70	to	present	
1745-70	to	1892-1912	
1745-70	to	1939	
1852-92	to	1892-1912	
1852-92	to	1939	
1852-92	to	present	
Area possibly never built on			
Line of 'moat' shown on 19 <sup>th</sup> C maps			

FIGURE 2  
 EXTRACT FROM THE 1:500 SCALE ORDNANCE SURVEY MAP OF 1892  
 SHOWING THE DEVELOPMENT OF THE SITE

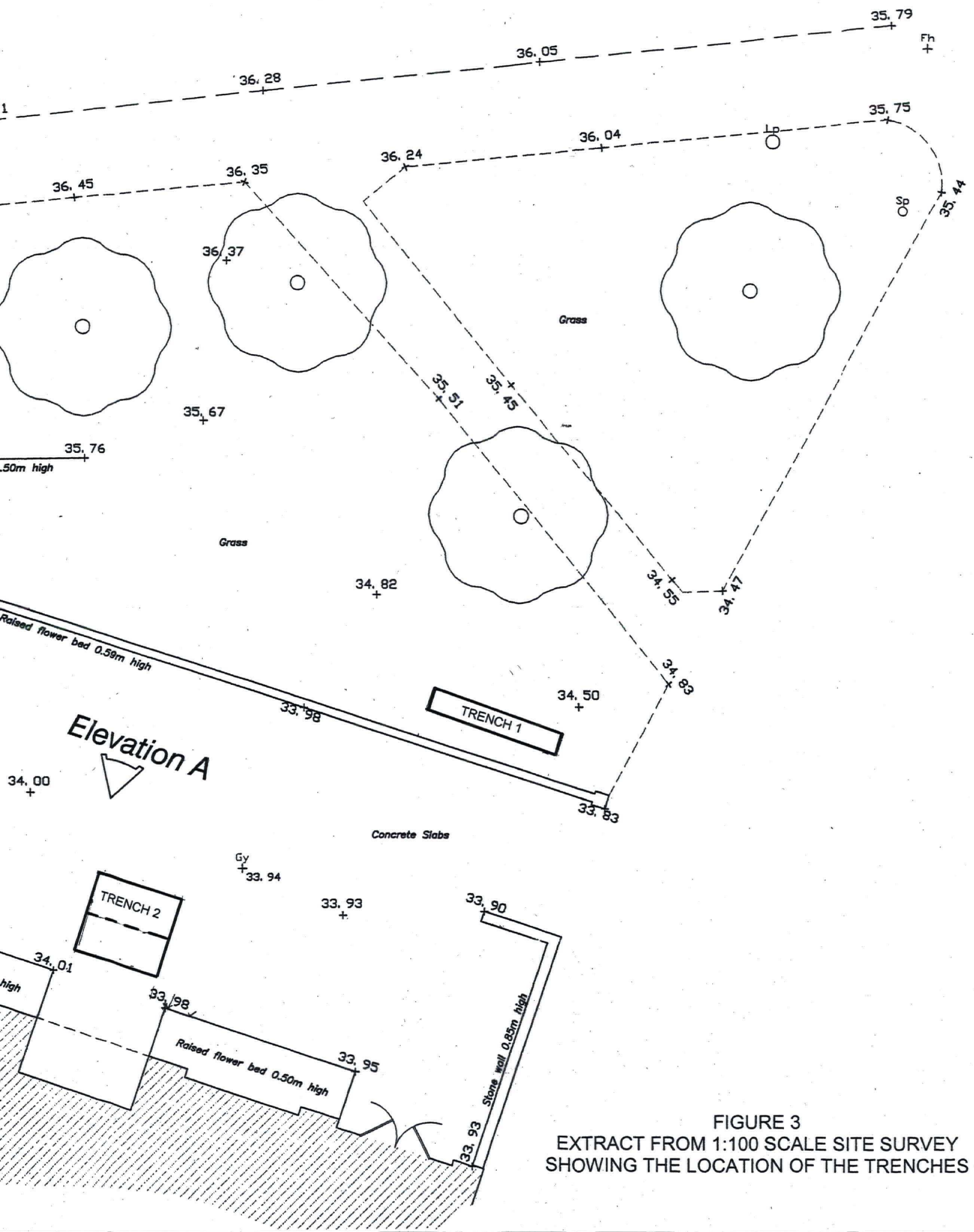

FIGURE 3  
EXTRACT FROM 1:100 SCALE SITE SURVEY  
SHOWING THE LOCATION OF THE TRENCHES

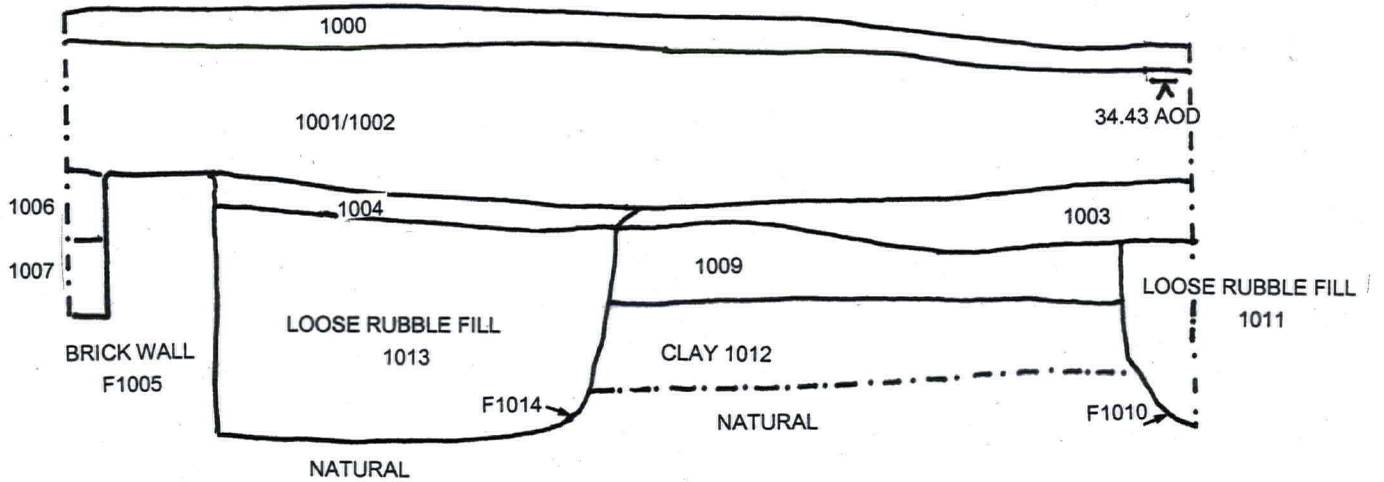

FIGURE 4A TRENCH 1 SOUTH FACING SECTION

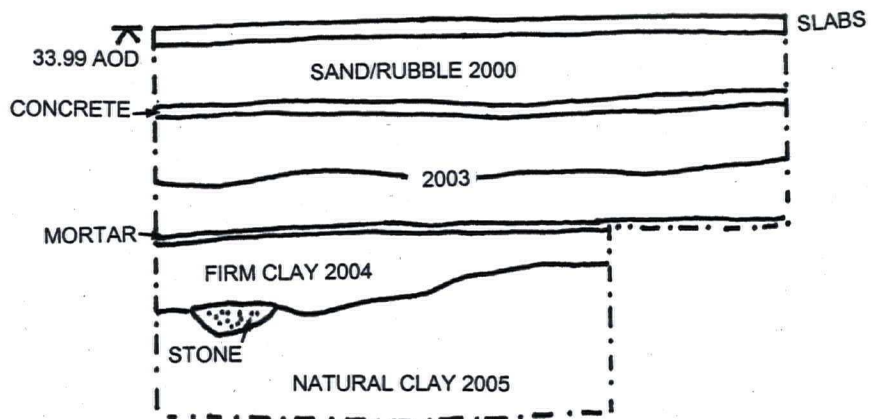
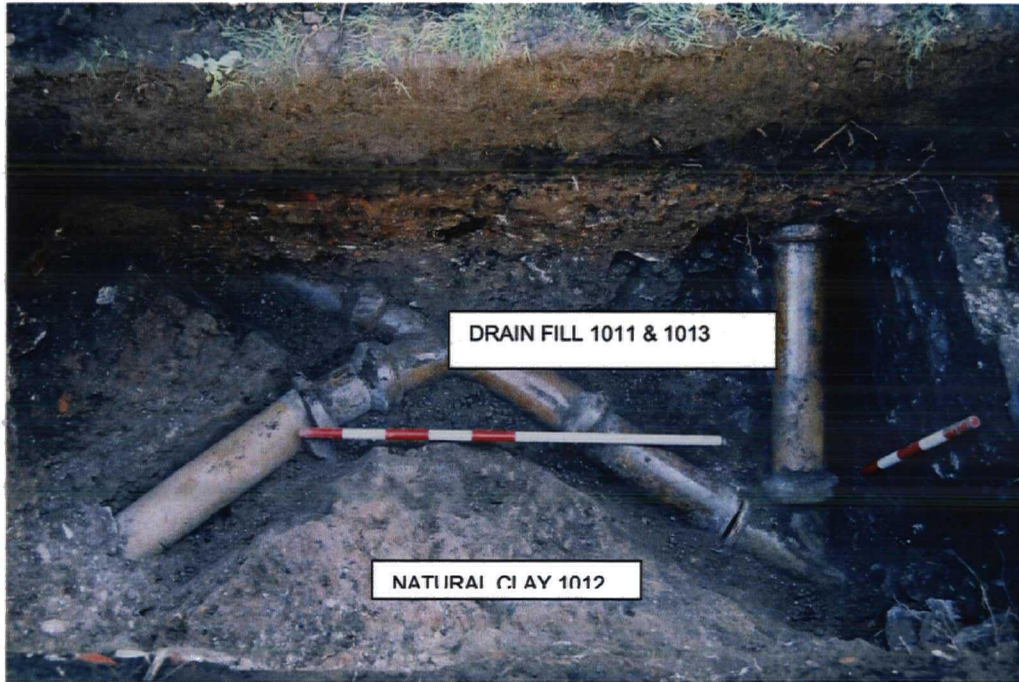
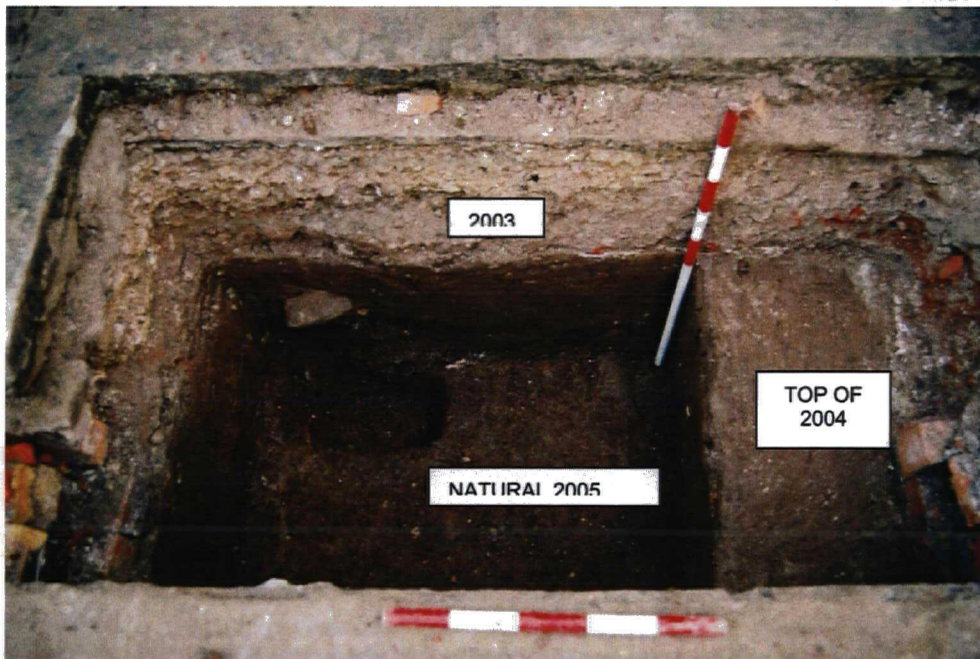

FIGURE 4B TRENCH 2 NORTH FACING SECTION





TRENCH 1 SHOWING DRAIN CUTS 1011 AND 1913 INTO NATURAL 1012



TRENCH 2 SECTION SHOWING 2000, 2003, CLAY 2004 AND NATURAL 2005

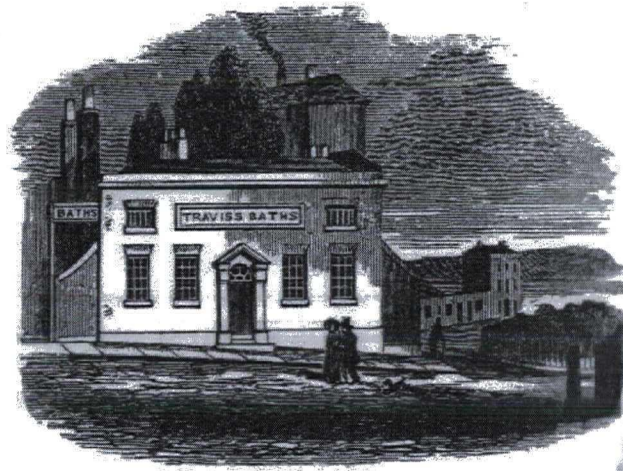

TRAVIS'S BATHS.

This establishment situate at the entrance to the Cliff, was originally opened in 1798. It has since been re-built, and the interior fitted up with every attention to comfort and elegance. The baths are of wood and marble, and are adapted either for plunging, sitting or the recumbent position. Every tide, these baths are supplied with pure sea water, and admit of ever variety of temperature. Rooms are also fitted up for steam, the Douche and Shower Baths.



SITE NAME	The Lounge Site	SITE CODE	LS04
Museum Accession no.		Box no	

Mus. Acc. No.	CONTEXT	WEIGHT	Tile		Scarb. Ware		Stoneware		Unident. Med		Post-medieval		
			No	Wt	No	Wt	No	Wt	No	Wt	No	Wt	Detail
	1000	60									6	60	20th C stoneware tile 19th C drain pipe
	1001	80									19	80	19th and early 20th C
	1003	30									2	30	ceramic drain or flower pot
	1006	139									4	139	19th C pancheon 20th C flower pot Bulwells
	1009	10									3	10	Incl 2 pieces 18th C dutch delft
	1011	1									1	1	Late 19C staffs transfer print
	1012	3							3	3			
	1013	465									10	465	
	2000	15									1	15	19th C staffordshire
	2002	10									2	10	Mid 20th C Johnsons tile
	2004	24							2	24			

==

CATALOGUE OF PRINT PHOTOGRAPHS

SITE CODE LS04		SITE NAME The Lounge Site		
FILM NUMBER 1		FILM TYPE Colour Print 200ASA		
DATE	FRAME NO	DIRECTION OF VIEW	TRENCH	DESCRIPTION
30-Nov-04	0A	WEST	1	1003, 1004 AND TOP OF F1005
30-Nov-04	1A	EAST	1	SIMILAR BUT VIEWED IN OPPOSITE DIRECTION
30-Nov-04	2A	EAST	1	1006 UPPER COURSES OF F1005, 1004
30-Nov-04	3A	EAST	1	SAME AS 2A
30-Nov-04	4A	EAST	1	1006 UPPER COURSES OF F1005, 1004
30-Nov-04	5A	EAST	1	SAME AS 4A
30-Nov-04	6A	WEST	1	1006 UPPER COURSES OF F1005, 1004
30-Nov-04	7A	WEST	1	SAME AS 6A
30-Nov-04	8A	EAST	1	1007 LOOKING TOWARDS F1005 WITH 1004 BEHIND
30-Nov-04	9A	EAST	1	SAME AS 8A
30-Nov-04	10A	EAST	1	F1008 AND F1005
30-Nov-04	11A	EAST	1	SAME AS 10A
30-Nov-04	12A	WEST	1	F1008 AND F1005
30-Nov-04	13A	WEST	1	SAME AS 12A
30-Nov-04	14A	WEST	1	F1008 AND F1005
30-Nov-04	15A	WEST	1	SAME AS 14A
30-Nov-04	16A	WEST	1	LOOKING DOWN ON 1009, 1013
30-Nov-04	17A	WEST	1	SAME AS 16A
	18A	SOUTH	1	NO IMAGE
02-Dec-04	19A	SOUTH	1	LOOKING DOWN ON DRAIN CUTS 1011 AND 1013 WITH NATURAL CLAY 1012 BETWEEN
02-Dec-04	20A	SOUTH	1	SAME AS 18A
02-Dec-04	21A	SOUTH	1	LOOKING DOWN ON DRAIN CUTS 1011 AND 1013 WITH NATURAL CLAY 1012 BETWEEN
02-Dec-04	22A	SOUTH	1	SAME AS 20A
04-Dec-04	23A	SOUTH	2	LOOKING DOWN ON F2001 AFTER 2002 REMOVED
04-Dec-04	24A	SOUTH	2	SAME AS 23A
04-Dec-04	25A	SOUTH	2	SIMILAR TO 23A
04-Dec-04	26A	SOUTH	2	TOP OF 2004 SHOWUNG END OF F201 AND LAYERS 2000, 2003
04-Dec-04	27A	SOUTH	2	TOP OF 2004 SHOWUNG END OF F201 AND LAYERS 2000, 2003
04-Dec-04	28A	WEST	2	TOP OF 2004 SHOWUNG END OF F201 AND LAYERS 2000, 2003
04-Dec-04	29A	SOUTH	2	SHOWING NATURAL CLAY 2005 AND SONDAGE DEEPER INTO IT
04-Dec-04	30A	SOUTH	2	SHOWING NATURAL CLAY 2005 AND SONDAGE DEEPER INTO IT
04-Dec-04	31A	WEST	2	SHOWING NATURAL CLAY 2005 AND SONDAGE DEEPER INTO IT
04-Dec-04	32A	WEST	2	SHOWING NATURAL CLAY 2005 AND SONDAGE DEEPER INTO IT
04-Dec-04	33A	SOUTH	2	SECTION SHOWING 2000, 2003, 204 AND 2005
04-Dec-04	34A	EAST	2	2004, 2005 WITH WALL F2001 BEHIND
04-Dec-04	35A	EAST	2	SIMILAR TO 34A
05-Dec-04	36A	WEST	2	SECTION SHOWING F2001, FILL 2002 WITH 200 AND 2003 TO LEFT ON TOP OF 2004



## INTERIM FIELDWORK REPORTS PUBLISHED 1987-2004

- Report No 1 (1987) AN EXCAVATION AT EAST SANDGATE 1987
- Report No 2 (1988) 18-22 ST SEPULCHRE STREET: AN ARCHAEOLOGICAL EVALUATION
- Report No 3 (1988) EXCAVATIONS AT 7 LEADING POST STREET (published in Transactions No 27, 1989)
- Report No 4 (1988) PARADISE: AN INTERIM REPORT ON RECENT ARCHAEOLOGICAL EXCAVATIONS
- Report No 5 (1989) PARADISE: A REPORT ON ARCHAEOLOGICAL EXCAVATIONS, DECEMBER 1988
- Report No 6 (1989) EXCAVATIONS AT 10-10A ST SEPULCHRE STREET (published in Transactions No 28, 1990)
- Report No 7 (1989) PARADISE: A REPORT ON ARCHAEOLOGICAL EXCAVATIONS, MAY-JUNE 1989
- Report No 8 (1989) EXCAVATIONS AT 35 CASTLEGATE
- Report No 9 (1989) EXCAVATIONS AT NEWBY FARM, NEAR SCARBOROUGH
- Report No 10 (1990) AN ARCHAEOLOGICAL EVALUATION OF 24-26 THE BOLTS
- Report No 11 (1990) AN ARCHAEOLOGICAL EVALUATION OF 119 LONGWESTGATE
- Report No 12 (1991) FIELDWORK AT MANOR FARM, OSGODBY
- Report No 13 (1991) AN ARCHAEOLOGICAL EXCAVATION AT PEASHOLM
- Report No 14 (1991) AN ARCHAEOLOGICAL SURVEY OF FILEY ROMAN SIGNAL STATION
- Report No 15 (1991) AN ARCHAEOLOGICAL ASSESSMENT OF NO 4 NORTH STREET
- Report No 16 (1992) AN EXCAVATION OF THE RAW LIQUOR CISTERN AT THE RAVENSCAR ALUM WORKS
- Report No 17 (1992) AN ARCHAEOLOGICAL EXCAVATION AT 1-3 LEADING POST STREET
- Report No 18 (1992) AN ARCHAEOLOGICAL EXCAVATION ADJACENT TO 35 CASTLEGATE
- Report No 19 (1993) AN ARCHAEOLOGICAL EXCAVATION AT 40 PRINCESS STREET
- Report No 20 (1994) AN ARCHAEOLOGICAL EVALUATION OF A SITE AT GLOBE STREET
- Report No 21 (1996) AN ARCHAEOLOGICAL WATCHING BRIEF AT 33-34 FORESHORE ROAD
- Report No 22(1996) AN ARCHAEOLOGICAL EVALUATION, FORMER CONVENT SCHOOL, QUEEN STREET
- Report No 23 (1996) AN ARCHAEOLOGICAL ASSESSMENT OF LAND ADJACENT TO 22A QUAY STREET
- Report No 24 (1996) AN ARCHAEOLOGICAL EXCAVATION AT THE FORMER CONVENT SCHOOL
- Report No 25 (1997) AN ARCHAEOLOGICAL WATCHING BRIEF AT CASTLE DYKES
- Report No 26 (1997) AN ARCHAEOLOGICAL EVALUATION AT ST PETER'S SCHOOL, AUBOROUGH STREET
- Report No 27 (1997) AN ARCHAEOLOGICAL WATCHING BRIEF AT THE CASTLE HOTEL, QUEEN STREET
- Report No 28 (1997) AN ARCHAEOLOGICAL WATCHING BRIEF AT THE BARN PUBLIC HOUSE, OSGODBY
- Report No 29 (1997) AN ARCHAEOLOGICAL EVALUATION AT 80 ST THOMAS STREET
- Report No 30 (1998) AN ARCHAEOLOGICAL EXCAVATION AT SPRINGFIELD
- Report No 31 (1999) AN EXCAVATION ADJACENT TO MULGRAVE PLACE
- Report No 32 (2000) AN ARCHAEOLOGICAL EXCAVATION AT THE NEWCASTLE PACKET, SANDSIDE
- Report No 33 (2000) A WATCHING BRIEF AT THE FORMER CONVENT SCHOOL, QUEEN STREET
- Report No 34 (2002) AN EARTHWORK SURVEY OF SEAMER MANOR HOUSE
- Report No 35 (2003) AN ARCHAEOLOGICAL EXCAVATION AND WATCHING BRIEF AT 58 QUAY STREET
- Report No36(2004)0 AN ARCHAEOLOGICAL EXCAVATION AT THE FORMER PENTECOSTAL CHURCH  
(forthcoming)
- Report No 37 (2004) AN ARCHAEOLOGICAL EVALUATION AT THE LOUNGE SITE, HARCOURT PLACE