

Discovery and Excavation in Scotland

Updated on 15/06/2007

LOCAL AUTHORITY:	Moray
PROJECT TITLE/SITE NAME:	Burghead Well
PROJECT CODE:	HSCO-90044-2007-01
PARISH:	Duffus
NAME OF CONTRIBUTOR:	Sarah Hogg
NAME OF ORGANISATION:	Kirkdale Archaeology
TYPE(S) OF PROJECT:	Watching brief
NMRS NO(S):	NJ16NW 2
SITE/MONUMENT TYPE(S):	Well
SIGNIFICANT FINDS:	
NGR (2 letters, 8 or 10 figures)	NJ 1103 6916
START DATE (this season)	15 January 2007
END DATE (this season)	15 January 2007
PREVIOUS WORK (incl. <i>DES</i> ref.)	
MAIN (NARRATIVE) DESCRIPTION: (May include information from other fields)	A watching brief was maintained during the excavation of a small trench near Burghead Well. The trench was needed to allow access to the south external wall of a nearby 19 th -century building for repointing work. There were no finds or features of archaeological significance.
PROPOSED FUTURE WORK:	
CAPTION(S) FOR ILLUSTRS:	
SPONSOR OR FUNDING BODY:	Historic Scotland
ADDRESS OF MAIN CONTRIBUTOR:	4, Western Terrace, Edinburgh, EH12 5QF
EMAIL ADDRESS:	g_ewart@hotmail.com
ARCHIVE LOCATION (intended/deposited)	Archive to be deposited in NMRS

Historic Scotland
Properties in Care
Minor Archaeological Works 2007

Burghead Well: Archaeological Monitoring, January 2007

HS PIC Index number: 90044
Project code: HSCO-90044-2007-01

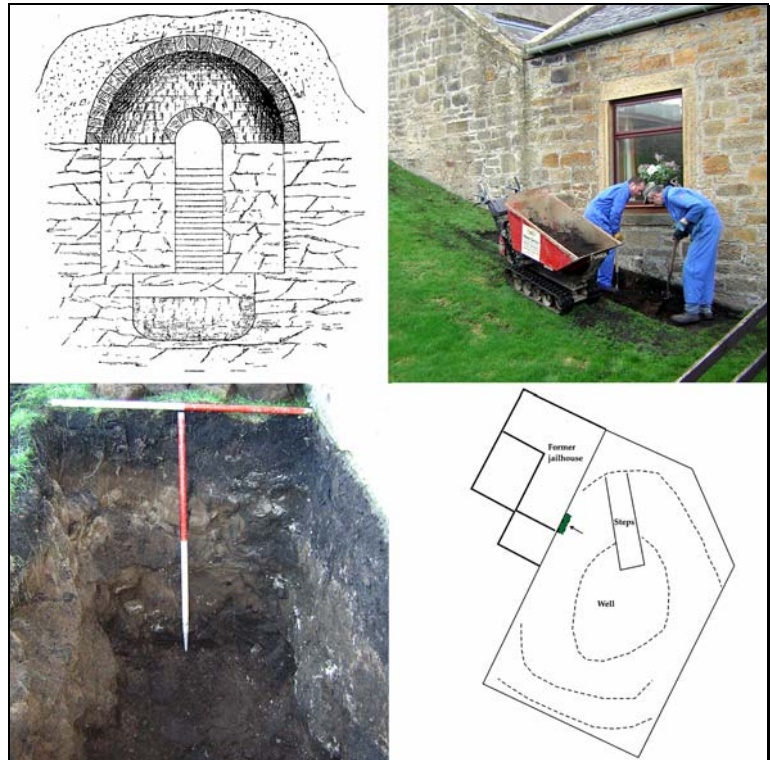

12 March 2007
Kirkdale Archaeology

<u>Site</u>	Burghead Well
<u>N.G.R</u>	NJ 110 691
<u>Project Description</u>	Archaeological monitoring
<u>Project code</u>	HSCO-90044-2007-01

Contents

1.0 Introduction	1
2.0 Description	1
3.0 Interpretation and observations	3
A1.0 Appendix 1: List of contexts	4
A2.0 Appendix 2: List of drawings	4
A3.0 Appendix 3: List of photographs	4
A4.0 Appendix 4: List of finds	5
A5.0 Appendix 5: Archival references	6

SUMMARY: A watching brief was maintained during the excavation of a small trench near Burghead Well. The trench was needed to allow access to the south external wall of a nearby 19th-century building for repointing work. There were no finds or features of archaeological significance.

1.0 INTRODUCTION

Under the terms of its call-off contract with Historic Scotland, Kirkdale Archaeology was asked to undertake a short period of archaeological monitoring at Burghead Well during the excavation of a small trench alongside the wall of a nearby 19th-century building. The work was necessary in order to re-point the exterior wall of the building to prevent damp.

The work was undertaken on 15 January 2007.

2.0 DESCRIPTION

Work commenced with the removal of turf **(101)** from an area 1.00 m N-S by 3.50 m E-W adjacent to the S wall of a 19th-century building, formerly a jailhouse. This revealed a rich, dark brown, sandy topsoil **(102)** which contained late 19th- or 20th-century finds including window glass, iron nails, and white china. Beneath this at a depth of 200 mm on the S side of the trench was pale sand **(104)** containing a mixture of sandstone rubble, rounded beach pebbles and water-eroded sandstone. This was cut to the N by construction cut **(105)** for wall **(103)**. The cut was near vertical, at least 1.00 m deep (not fully excavated), extended c 200 mm from wall **(103)** and was filled with a mixture of pale mortar and dark brown, sandy soil **(106)**.

The final dimensions of the trench were 1.00 m N-S by 3.50 m E-W and between 20 mm deep to the E and 1.00 m deep to the W (the trench was cut in to the slope of the hill resulting in a wedge shaped profile).

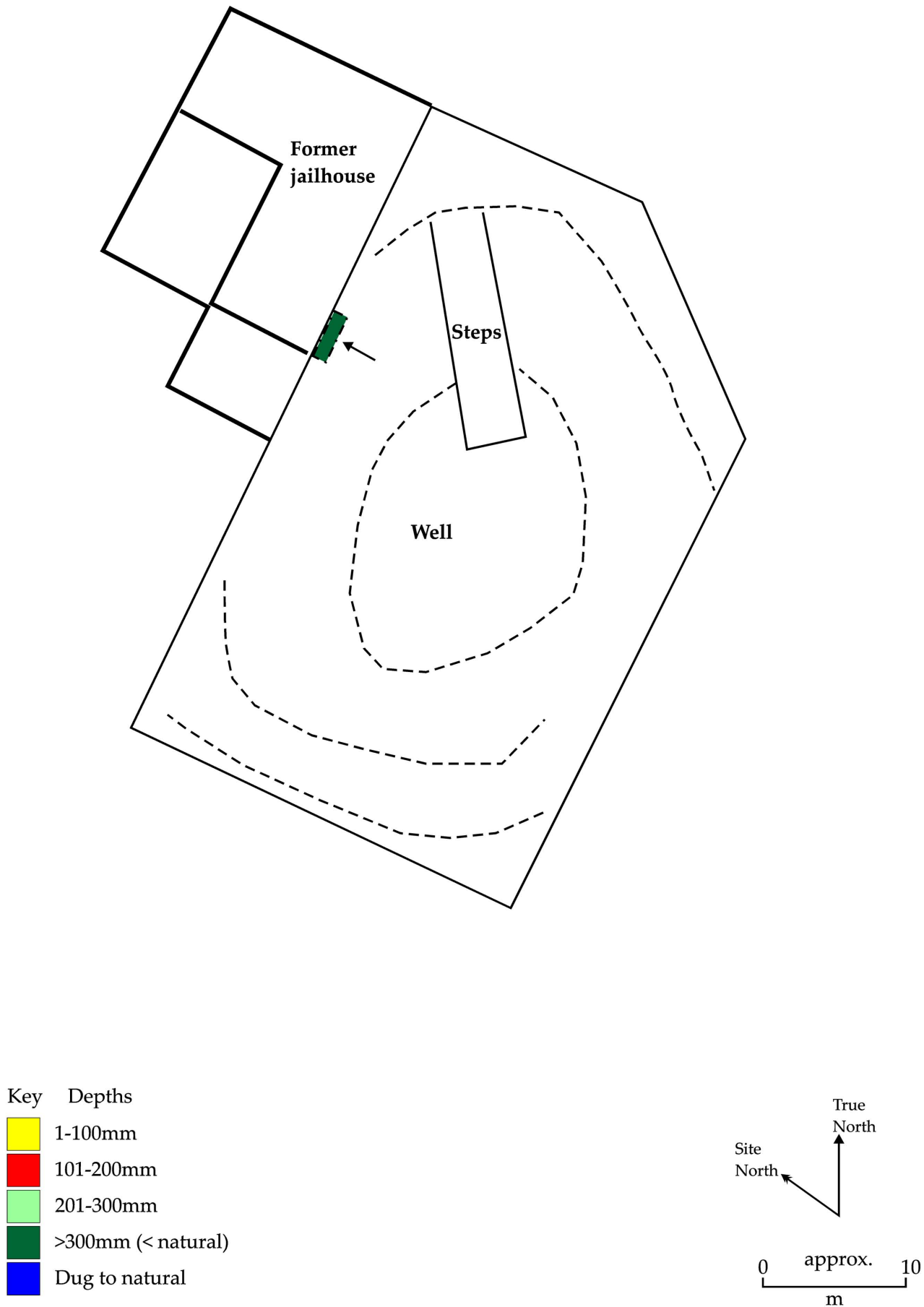

Fig. 1 : Plan (1:400) showing location of excavation



Plate 1 : W end of trench showing E facing section, taken from E

3.0 INTERPRETATION AND OBSERVATIONS

Sandy deposit **(104)** was the earliest deposit identified within the trench. It did not contain any finds but was not a natural deposit as it contained a mixture of sandstone rubble and water-eroded stones. This most likely represents late 19th-century landscaping or may have resulted from excavation and rebuilding carried out at the time of discovery of the Pictish well during the 19th-century. All the deposits above **(104)** relate to the construction and use of the jailhouse, subsequently a residential property in the 20th century.

There were no finds or features of archaeological significance.

A1.0 APPENDIX 1: LIST OF CONTEXTS

#	Description
101	Turf
102	Very rich dark brown sandy topsoil containing window glass, slate and painted plaster.
103	Wall of late 19 th Century house, dressed sandstone blocks.
104	Pale yellow/ light brown sand containing sandstone rubble and smooth water-eroded pebbles and sandstone.
105	Construction cut for 103 through 104 .
106	Pale mortar and sand fill of construction cut 105

A2.0 APPENDIX 2: LIST OF DRAWINGS

#	Type	Description	Scale
1	Plan	Sketch showing location of trench	c 1:400

A3.0 APPENDIX 3: LIST OF PHOTOGRAPHS

HSCO-90044-2007-01-CD1

#	Description	From	Date
1	View showing steps leading to the Burghead Pictish well.	NE	15/01/07
2	Removal of turf and topsoil (101) .	E	15/01/07
3	Detail of entrance to the well, lower three steps, bedrock and lower build inside the well are Pictish.	NE	15/01/07
4	Detail of vaulted roof over the well, late 19 th Century.	NE	15/01/07
5	Turf and topsoil (101) removed.	E	15/01/07
6	Site of Trench against S wall of building (103)	SE	15/01/07
7	General shot during excavation.	SE	15/01/07
8	Trench partially excavated showing E facing section.	E	15/01/07
9	Trench partially excavated showing detail of E facing section.	E	15/01/07
10	Trench Fully excavated showing E facing section.	E	16/01/07
11	Trench Fully excavated showing detail of E facing section.	E	16/01/07
12	Pile of sandstone rubble and beach pebbles removed from sand and rubble context (102) .	S	16/01/07

#	Description	From	Date
13	Shot showing the end of the jailhouse building, the start of the boundary wall and the location of the trench.	S	16/01/07
14	Detail of wall (103)	S	16/01/07
15	Detail of bedrock cut steps next to 19 th Century steps.	/	16/01/07

A4.0

APPENDIX 4: LIST OF FINDS

Bag No.	Description	Quantity	Ctxt
1203-001	Window Glass	2	102
1203-002	Slate	1	102
1203-003	Pb/Cu Alloy 3 pronged object	1	102
1203-004	Tile	1	102

Site	Holyrood Park
HS PIC Index no	90044
Kirkdale Project no	HSCO-90044-2007-01
Date(s) of site work	15 January 2007

Report files submitted on CD:

Report in MS Word	HSCO-90044-2007-01-Report.doc
TIFFs	HSCO-90044-2007-01-Report Fig 1.tif
PDF	HSCO-90044-2007-01-Report.pdf

Other files submitted on CD:

Photo scans	HSCO-90044-2007-01-CD1- 1-15.jpg(s)
--------------------	-------------------------------------