

Discovery and Excavation in Scotland – OASIS-type Form (2006)

LOCAL AUTHORITY:	Argyll And Bute
PROJECT TITLE/SITE NAME:	Iona Monastery, New Guest House (Coffee House)
PROJECT CODE:	HSCO-90351-2008-01; HSCO-90351-2009-01
PARISH:	Kilfinichen and Kilvicken
NAME OF CONTRIBUTOR:	Paul Fox
NAME OF ORGANISATION:	Kirkdale Archaeology
TYPE(S) OF PROJECT:	Watching brief
NMRS NO(S):	NM22SE 115; NM22SE 4.09
SITE/MONUMENT TYPE(S):	Guest Hall
SIGNIFICANT FINDS:	None
NGR (2 letters, 6 figures)	NM 2857 2456
START DATE (this season)	27 November 2008
END DATE (this season)	19 February 2009
PREVIOUS WORK (incl. DES ref.)	
MAIN (NARRATIVE) DESCRIPTION: (May include information from other fields)	<i>A watching brief was maintained at the Welcome Centre, Isle of Iona, Argyll, (formerly the Iona Community Coffee House) during the excavation of small trenches at the northwest, southeast and southwest corners of the building during refurbishment works. The building sits on the west side of the road opposite Iona Abbey, and is located within the area defined by the intermittent remains of an enclosing Vallum, visible mainly to the northwest. There were no finds or features of archaeological significance seen during these works.</i>
PROPOSED FUTURE WORK:	
CAPTION(S) FOR ILLUSTRS:	
SPONSOR OR FUNDING BODY:	Historic Scotland
ADDRESS OF MAIN CONTRIBUTOR:	4, Western Terrace, Edinburgh, EH12 5QF
EMAIL ADDRESS:	g_ewart@hotmail.com
ARCHIVE LOCATION (intended/deposited)	Archive to be deposited in NMRS

Historic Scotland
Properties in Care
Minor Archaeological Works 2008

Iona Abbey:
Iona Community Welcome Centre
Archaeological monitoring,
November 2008

HS PIC Index number: 90351
Project code: HSCO-90351-2008-01

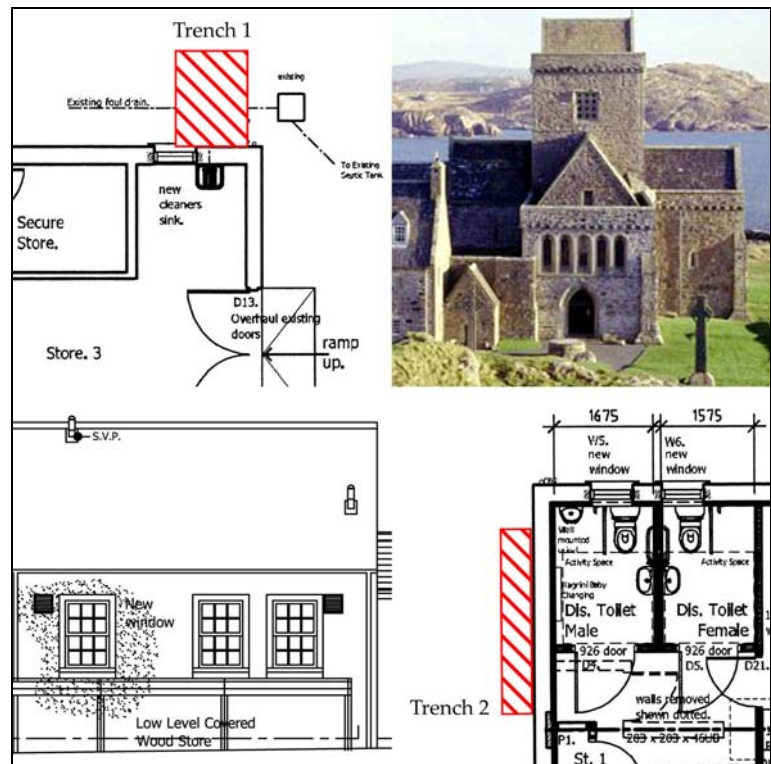

17 February 2009
Kirkdale Archaeology

<u>Site</u>	Iona Abbey
<u>N.G.R</u>	NM 2857 2456
<u>Project Description</u>	Archaeological monitoring
<u>Project code</u>	HSCO-90351-2008-01

Contents

1.0 Summary	1
2.0 Introduction	1
3.0 Description	1
4.0 Interpretation and observations	3
A1.0 Appendix 1: List of contexts	4
A2.0 Appendix 2: List of drawings	4
A3.0 Appendix 3: List of photographs	4

1.0 SUMMARY

A watching brief was maintained at the Welcome Centre, Isle of Iona, Argyll, (formerly the Iona Community Coffee House) during the excavation of two small trenches as part of the refurbishment of the building. The building sits on the west side of the road opposite the abbey, and is located within the area defined by the intermittent remains of an enclosing Vallum, visible mainly to the northwest.

There were no finds or features of archaeological significance.

2.0 INTRODUCTION

Under the terms of its call-off contract with Historic Scotland, Kirkdale Archaeology was asked to undertake a short period of archaeological excavation and monitoring at the Welcome Centre, Isle of Iona, Argyll, (formerly the Iona Community Coffee House) during the excavation of two small trenches as part of the refurbishment of the building.

The Welcome Centre sits to the W of the road running NNE from Baile Mor and is located within the area defined by the intermittent remains of an enclosing Vallum, visible mainly to the NW. There was therefore potential for the presence of *in situ* remains within either of the trenches. There was also the possibility of artifactual re-deposition within the backfills of the cuts for both the building and the existing drain.

The work was carried out manually by both the archaeologist and the contractor, TSL Contractors Ltd of Craignure, Mull, and was undertaken on 27 November 2008.

3.0 DESCRIPTION

3.1 Trench 1

Trench 1 was located at the NW corner of the building. Its purpose was to allow the connection of a 130 mm diameter waste pipe serving a sink in Store 3 to an existing foul drain running N-S to the W of the building. This was thought to be c 1.0 m W of the building and its depth would be at around 700 mm below the current ground

surface, indicated by the exposed 'L'-bend within the manhole to the NW.

The trench measured 1.20 m N-S x 1.60 m E-W, its N edge lying 250 mm S of the NW corner of the Welcome Centre. An existing concrete path **F101** sat between the building to the E and a border of pink granite boulders to the W. The concrete path was broken out with a pneumatic drill and the remaining deposits were removed manually. The path was composed of the concrete surface, **F101**, 80 mm thick sitting on **F102**, a base bed of crushed granite 80 mm thick. The manhole to the NW indicated the run of the drain and the backfilled deposits of the drain cut were removed in spits to locate the drain itself. To the E of the trench, adjacent to the building, these deposits, **F103**, layers of moderately compact re-deposited orange gravel, sand, dark brown silt, broken red brick and pieces of slate and pink granite ran to a depth of 200 mm, deepening to 400 mm (c 650 mm W of the building) where the cut then ran down at a steep angle (to a depth of 850 mm) and the pipe, **F104**, was located. Within **F103** was a Canadian one cent coin dated to 1979. Pipe **F104** was made of black plastic and had an external diameter of 130 mm. 300 mm W of the pipe was a power cable encased in black plastic, **F105**, with an external diameter of 30 mm laid at the same depth in the same cut running N-S with an accompanying earth strap **F106**. At this point it was clear that the trench comprised a cut for the building, **F107**, to the E, 200 mm wide, filled by **F110** (a mixture of sand, dark brown silt and red brick only exposed in plan) and a cut for the drain, a power cable and an earth strap to the W, **F108**, filled by **F103**. Separating these two cuts and truncated by them was a 460 mm wide (E-W) layer of natural orange brown gravel, **F109**. This had to be reduced by 100 mm to allow the connection to be made from the wall to the pipe, although nothing was found within the deposit. It had not been necessary to reduce the entire plan of the trench to the same depth. It was sufficient to expose the existing pipe and leave a diagonal run up to the connection point at the wall. Disturbance of the natural layer exposed was therefore minimal.

3.2 Trench 2

Trench 2 was located at the SW corner of the building, running E towards the SE doorway to allow the installation of a path composed of bedding material and Caithness slates reclaimed from the building.

The trench ran from 700 mm E of the SW corner of the Welcome Centre to the W side of an existing concrete bed serving the door at the SE corner of the building. The trench was 500 mm wide N-S by 3.10 m E-W and was dug to a consistent depth of 400 mm. The trench was dug through an overgrown flower bed and the material removed was loose dark brown silt containing numerous small round stones <5 mm, **F201**. This appeared to be soil introduced to bed the plants.

Below **F201**, at a depth of 400 mm, a compact layer of natural orange brown gravel, **F202**, was encountered – this had been truncated to the N by the cut for the building, **F203**, 160 mm wide N-S. The cut was exposed in plan but further digging was not necessary. Within the cut was **F204**, a poured concrete foundation for the building 160 mm wide and lying at a depth of 400 mm. Nothing could be seen within gravel **F202** that was of archaeological interest and it was not necessary to reduce this layer as part of the works. A batter 250 mm wide (N-S) was cut into the S edge of the trench but nothing of interest was noted.

4.0 INTERPRETATION AND OBSERVATIONS

Although nothing of archaeological interest was noted during the excavation, the presence of natural gravels close to the building indicated that there was still archaeological potential within both trenches. The ramp to be dug at a later date runs from the SE corner of the building NE to meet the road and this will likely be cut through similarly undisturbed deposits. It is therefore recommended that the trench be again cut under appropriate archaeological supervision in order to record the deposits exposed by the work.

A1.0 APPENDIX 1: LIST OF CONTEXTS

Trench 1

F101	Concrete path
F102	Bed of crushed granite below F101
F103	Backfilled layers within Drain Cut F108
F104	Existing 130mm diameter drain
F105	Power Cable W of F104
F106	Earth Strap serving F105
F107	Cut for Welcome Centre
F108	Cut for F104-F106, filled by F103
F109	Layer of Natural Orange Brown Gravel truncated by F107 & F108
F110	Backfill of Cut F107

Trench 2

F201	Introduced bedding Soil
F202	Compact Orange Brown gravel below F201
F203	Cut through F202 for building
F204	Concrete building foundation within F203

A2.0 APPENDIX 2: LIST OF DRAWINGS

No	Type	Description	Scale
1	Plan	Location plan.	1:100
2	Plan	Trench 1 - post excavation plan	1:20
3	Plan	Trench 2 - post excavation plan	1:20

A3.0 APPENDIX 3: LIST OF PHOTOGRAPHS

#	Description	From	Date
1	Pre Ex Shot of Trench 1 looking SE	NW	27/11/08
2	Manhole & Trench 1 in progress looking S	N	27/11/08
3	Open L-bend within Manhole looking S	N	27/11/08
4	Trench 1 in progress, N Facing Section	N	27/11/08
5	Trench 1 in progress, N Facing Section	N	27/11/08
6	Gravel F109 in Trench 1, between Cuts F107 & F108	N	27/11/08
7	Exposed Pipe F104 in Trench 1 looking S	N	27/11/08

#	Description	From	Date
8	Exposed Pipe F104 in Trench 1 looking S	N	27/11/08
9	Exposed Pipe F104 in Trench 1 looking S	N	27/11/08
10	Post Ex Shot of Trench 1 looking S	N	27/11/08
11	Post Ex Shot of Trench 1 looking E	W	27/11/08
12	Pre Ex Shot of Trench 2 looking W	E	27/11/08
13	Pre Ex Shot of Trench 2 looking E	W	27/11/08
14	Post Ex Shot of Trench 2 showing F202-F204	W	27/11/08
15	Post Ex Shot of Trench 2 showing F202-F204	W	27/11/08
16	Post Ex Shot of Trench 2 looking W	E	27/11/08
17	Post Ex Shot of Trench 2 looking W	E	27/11/08
18	Post Ex Shot of Trench 2 with batter to the S	W	27/11/08
19	Shot looking NW at Welcome Centre	SE	27/11/08
20	Shot looking W at Welcome Centre	E	27/11/08
21	Shot looking SW at Welcome Centre	NE	27/11/08
22	Shot looking SE at Welcome Centre & Trench 1	NW	27/11/08
23	Post Ex Shot of Trench 1 looking E	W	27/11/08

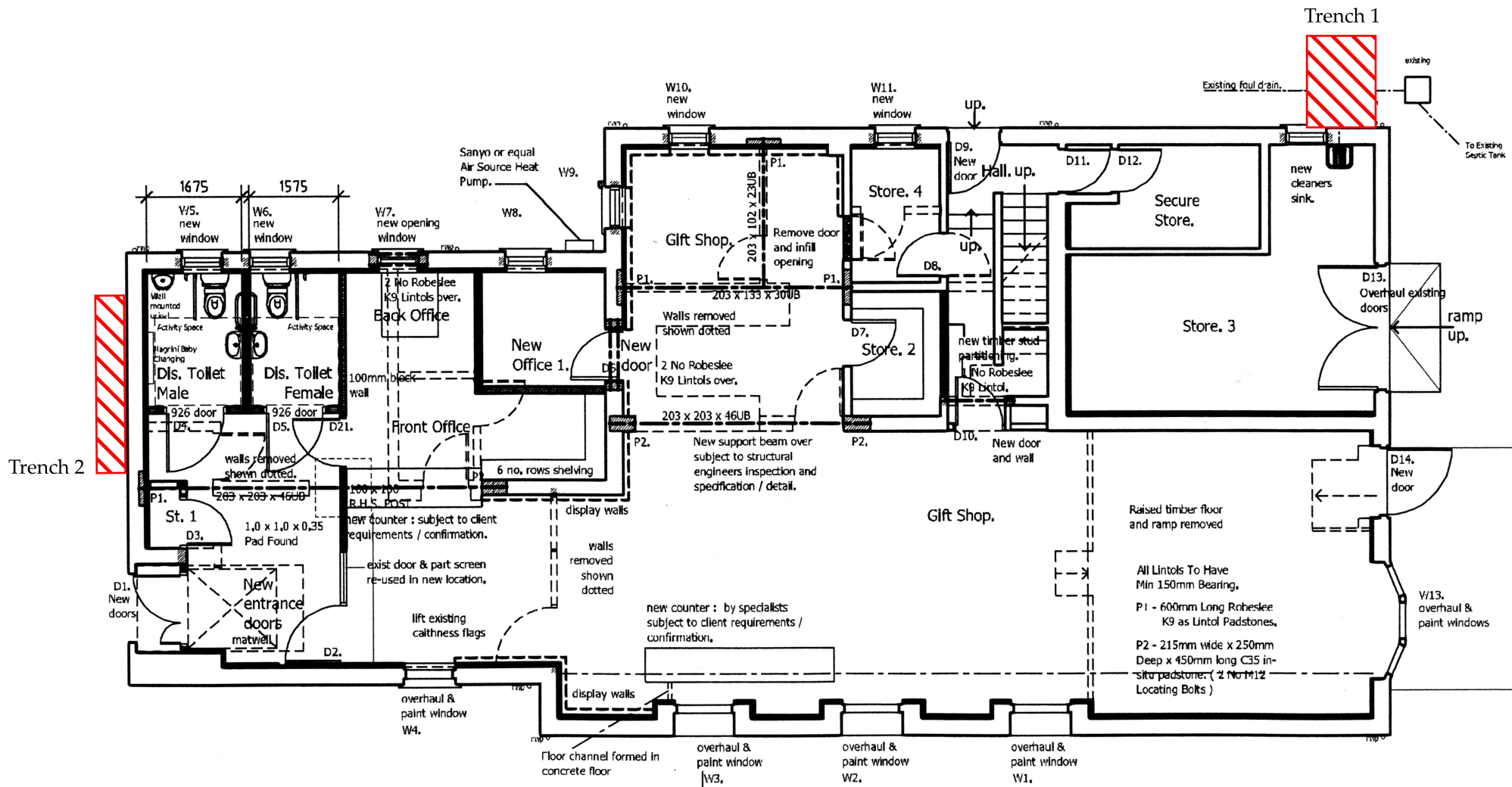
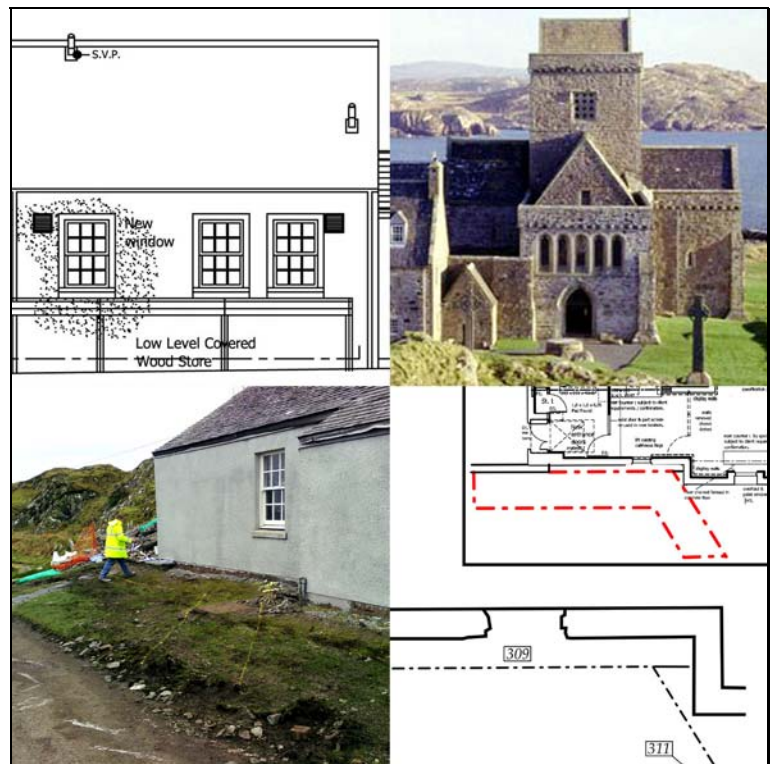

Fig. 1 : Plan showing location of Trenches 1& 2

Historic Scotland
Properties in Care
Minor Archaeological Works 2008-9

**Iona Abbey:
Iona Community Welcome Centre
Archaeological monitoring,
February 2009**

HS PIC Index number: 90351
Project code: HSCO-90351-2009-01



24 March 2009
Kirkdale Archaeology

<u>Site</u>	Iona Abbey
<u>N.G.R</u>	NM 2857 2456
<u>Project Description</u>	Archaeological monitoring
<u>Project code</u>	HSCO-90351-2009-01

Contents

1.0 Summary	1
2.0 Introduction	1
3.0 Description	2
4.0 Interpretation and observations	5
A1.0 Appendix 1: List of contexts	6
A2.0 Appendix 2: List of drawings	6
A3.0 Appendix 3: List of photographs	6
Fig. 1 : Location plan	8

1.0 SUMMARY

A watching brief was maintained at the Welcome Centre, Isle of Iona, Argyll, (formerly the Iona Community Coffee House) during the excavation of a small trench in advance of the installation of an access ramp, part of the refurbishment of the building. The building sits on the west side of the road opposite the abbey, and is located within the area defined by the intermittent remains of an enclosing Vallum, visible mainly to the northwest.

There were no finds or features of archaeological significance.

2.0 INTRODUCTION

Under the terms of its call-off contract with Historic Scotland, Kirkdale Archaeology was asked to undertake a short period of archaeological monitoring at the Welcome Centre, Isle of Iona, Argyll, (formerly the Iona Community Coffee House) during the excavation of a small trench as part of the refurbishment of the building.

The Welcome Centre sits to the W of the road running NNE from Baile Mor and is located within the area defined by the intermittent remains of an enclosing Vallum, visible mainly to the NW. There was therefore potential for the presence of *in situ* remains within the trench. There was also the possibility of artifactual re-deposition within the backfills of the cuts for both the building and the existing drain.

During a previous visit (November 2008: HSCO-90351-2008-01) two trenches had been opened - Trench 1, located at the NW corner of the building, and Trench 2, located at the SW corner of the building, running E towards the SE doorway. No finds of archaeological interest were uncovered during this work. In this latest visit, Trench 3 was to be excavated for the installation of an access ramp to the doorway in the SE corner of the Welcome Centre. The presence of manholes to the E of the building (with their associated pipes) and the disturbance caused by the construction of the building itself implied a low archaeological potential.

The work was carried out by mechanical digger under archaeological supervision on 17-19 February 2009.

3.0 DESCRIPTION

3.1 Trench 3

Trench 3 ran from a point 2.30 m S of the SE corner of the Welcome Centre running N along the side of the building for a total of 9.0 m before it dog-legged NE for 5.00 m until it hit the side of the existing road. The trench was 2.0 m wide and was cut to a depth of 500 mm. An existing path, **F301**, had to be lifted in advance of the excavation; it was composed of slate slabs set in concrete. Only the 2.0 m to the SW was affected by the excavation.



Plate 1: The existing path to the SE door prior to excavation

The excavation began at the S end. A 200 mm layer of turf and topsoil, **F302**, covered a white sandy backfill, **F303**, exposed to a depth of 300 mm. This was the fill of a cut (**F304**) running W from a small manhole to the SE of the Welcome Centre. The S side of the cut was not exposed but the N side was clearly visible. It was at least 750 mm wide. This was part of the original drainage of the building – the pipe was not exposed but modern debris within the fill confirmed its late date.



Plate 2: Looking S pipe cut F304 and backfill F303

To the N of the pipe cut, the section was composed of a 200 mm layer of turf and topsoil, **F302**, overlying a subsoil, **F305**, of mid-brown silty clay, 500 mm deep to the E, rising to a depth of 100 mm to the W and containing numerous angular stones, <80mm. This in turn overlay **F306**, a layer of natural, orange brown, gritty gravel – 500 mm thick to the W and sitting on a clean bed of natural, yellowish brown sand, **F307**, exposed only in plan.



Plate 3: S facing section showing topsoil and subsoil overlying the natural gravel



Plate 4: Looking WSW at the manhole with cast iron pipe below and to the right.

To the W, the gravel was truncated by a 200 mm wide foundation cut, **F308**, for the Welcome Centre, which contained a 60 mm thick poured concrete foundation, **F309**.

When the S-N part of the trench had been excavated, it then doglegged to the NE towards a manhole, **F310**, 680 mm x 680 mm x 500 mm deep.

The manhole was set into a cut, **F311**, not fully exposed, which ran down towards the road. It was filled by **F312**, a mixture of white sand and redbrick backfill showing that the area to the NE was formed from make up. A small section of 100 mm external diameter cast iron pipe, **F313**, was exposed running N from the N side of the manhole bedded at a depth of 500mm.

Nothing of archaeological significance was uncovered during the excavation.

4.0 INTERPRETATION AND OBSERVATIONS

Although nothing of archaeological interest was noted during the excavation, the presence of natural gravel and sand close to the building indicated that there was still archaeological potential within the trench. These two layers were the only natural deposits present, the rest was make up associated with the construction of the building and the layout of the road to the E. The shallow depth of the excavation meant that it was mainly backfilled deposits that were being removed.

Despite the lack of any finds or features of archaeological interest, any further groundbreaking work necessary on the site should still be monitored.

A1.0 APPENDIX 1: LIST OF CONTEXTS

Trench 3

#	Description
F301	Existing Slate & Concrete Path
F302	Turf & Topsoil
F303	White Sandy Backfill of F304
F304	Cut for Pipe Trench to SE of Welcome Centre
F305	Imported mid-brown Silty Clay Subsoil
F306	Natural Orange-Brown Gritty Gravel below F305
F307	Natural Yellowish-Brown Sand below F306
F308	Cut through F307 for Welcome Centre
F309	Concrete Foundation within F308
F310	Manhole within excavation
F311	Cut for F310
F312	White Sand & Red Brick Backfill of F310
F313	Cast Pipe connected to N side of F310

A2.0 APPENDIX 2: LIST OF DRAWINGS

No	Type	Description	Scale
1	Plan	Post Ex Plan of Trench 3	1:50

A3.0 APPENDIX 3: LIST OF PHOTOGRAPHS

#	Description	From	Date
18022009829	Looking SW at Existing Path	NE	18/2/09
18022009830	Looking NW at Welcome Centre & Dig Area	SE	18/2/09
18022009831	Looking E at Existing Path & Abbey	W	18/2/09
18022009832	Looking S at Existing Path, Road & Grass Verge	N	18/2/09
18022009833	Looking NW at Welcome Centre & Path	SE	18/2/09
18022009834	Looking SW at Welcome Centre & Path	NE	18/2/09
18022009835	Looking SW at Path	NE	18/2/09
18022009836	Looking SW at Path	NE	18/2/09
18022009839	Looking ENE at Trench 2	WSW	18/2/09
18022009840	Looking E at Trench 2	W	18/2/09
18022009841	Looking WSW at Welcome Centre & Manhole	ENE	18/2/09
18022009842	Looking WNW at Welcome Centre & Dig Area	ESE	18/2/09

#	Description	From	Date
18022009851	Looking SW, Pre-Ex Shot	NE	18/2/09
18022009852	Initial Excavation, S-Facing Section	S	18/2/09
18022009853	N-Facing Section with Back-filled Pipe	N	18/2/09
18022009854	S-Facing Section Showing Gravel, Sand & Topsoil	S	18/2/09
18022009855	Looking S at Gravel, Sand & Concrete Founds	N	18/2/09
18022009856	Looking W at Gravel, Sand & Concrete Founds	E	18/2/09
18022009857	Looking N at Manhole & Gravel	S	18/2/09
18022009858	Gravel & Sand Natural Looking N	S	18/2/09
18022009859	Looking WNW at Trench 3 & Welcome Centre	ESE	18/2/09
18022009860	Looking SW at Trench 3 to Manhole	NE	18/2/09
18022009863	Natural Ground Section in Field W of Abbey	W	18/2/09
18022009865	Shot of Trench 1 (Backfilled) looking SE	NW	18/2/09
18022009866	Shot of Trench 1 (Backfilled) looking ESE	WNW	18/2/09
18022009867	Manhole & Make-Up Looking S	N	18/2/09
18022009868	Dogleg Excavation Looking W	E	18/2/09
18022009869	Post Ex Shot Looking W at Manhole	E	18/2/09
18022009870	Post-Ex Shot of Manhole & Pipe looking W	E	18/2/09
18022009871	Post-Ex Shot of Manhole & Dogleg looking W	E	18/2/09

