

Name **FISHERGATE**

Date **1978 [FG]**

Subject **AREA R**

**BOOK 2**  
**THE SECTIONS (I)**  
SISSON & PARKER LTD.  
NOTTINGHAM  
**C.S.B.Y**

**FG 78 - AREA R - BOOK 2**

\* The boundary wall is made up partly of standing churchyard wall which extends E. from Nasau's workhouse, and partly of modern wall which surrounds the "Nottingham Castle". The juncture of these two is at the W. side of an excavation. Possibly the mod. wall was built as a retainer when the buildings we dug were demolished. Could there have been added to later and incorporated in the boundary round the "Nottingham Castle".

NB Part of the stretch of churchyard wall between our excavation + Nasau's has also been rebuilt.

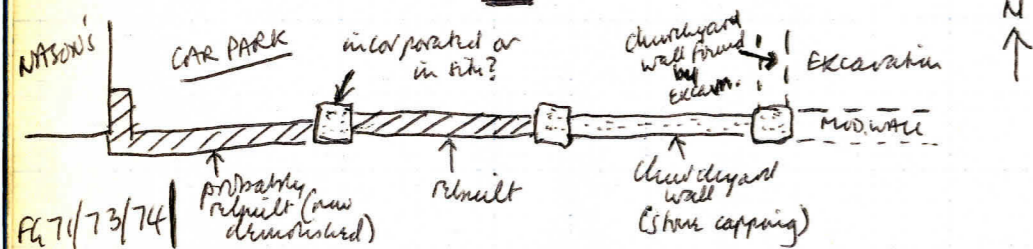

NB. THERE ARE LATER NOTES ON THESE WALLS, WRITTEN AFTER DRAWING THE SECTIONS.

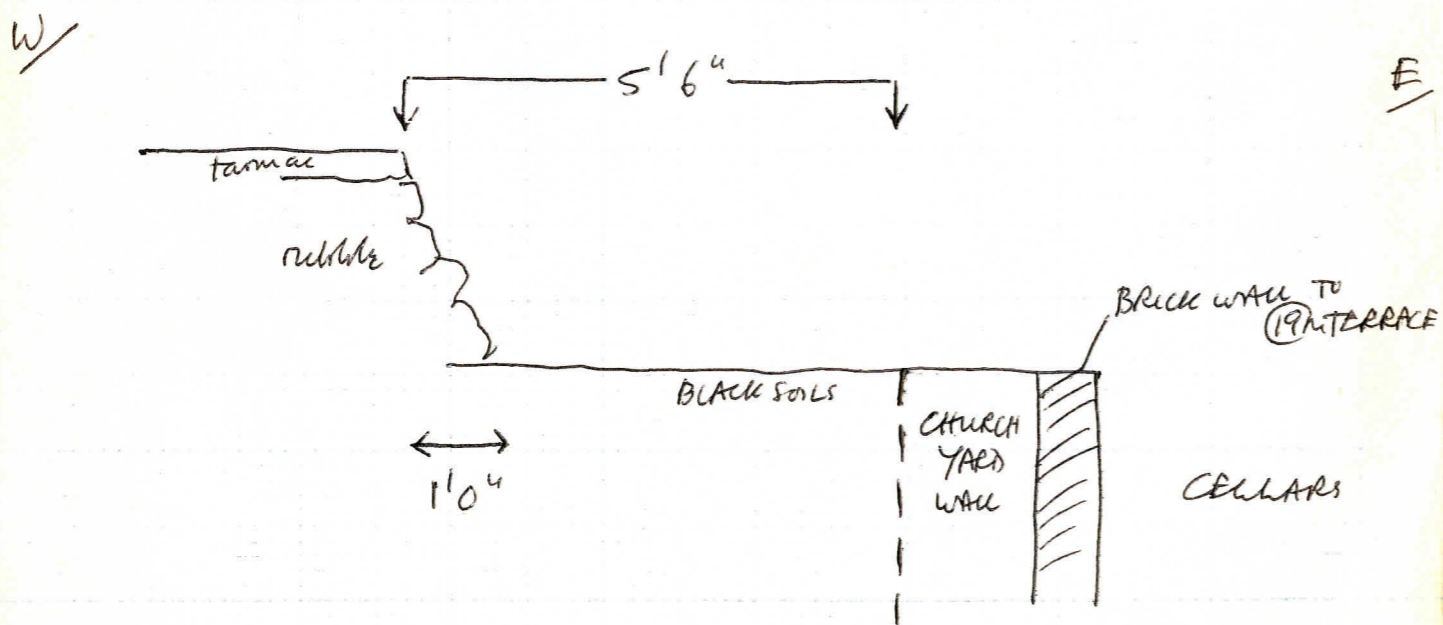

GENERAL NOTE

Area R, the area excavated, coincides with the area of the terraces of 19th cottages evident on the 1881 O.S. @ 1:500, north of the boundary wall\* to the south side of the Ice Stadium carpark.

The excavated area <sup>(by property)</sup> is naturally limited by the W. side of this terrace being adjacent to the boundary of the graveyard (Church property); by the modern <sup>boundary</sup> wall standing at the south end of the terrace; by the modern <sup>boundary</sup> wall standing on the E. side of the terrace; and to the N. by limits agreed for excavation with D.T.S. (not quite the full extent of the terrace for safety reasons with vehicles).

The area opened by machine was somewhat larger than the final excavation. Carpark makeup and surface were removed down to black soils for an extra 5'6" on the W. side, with a batter of 1'0", to avoid the rubble makeup falling in to the trench. It was at this level that the brick walls forming the W. side of the terrace were found, almost directly below car-park makeup.

⊗ IT IS IN FACT 7'6" ON PLAN - MUST HAVE CUT IT BACK

⊗ THIS IS IN MIDDLE OF TRENCH - SEE PLAN

On the N. side car-park surface + makeup were removed 9'9" with a batter of 1'0", back from the area finally excavated. Under

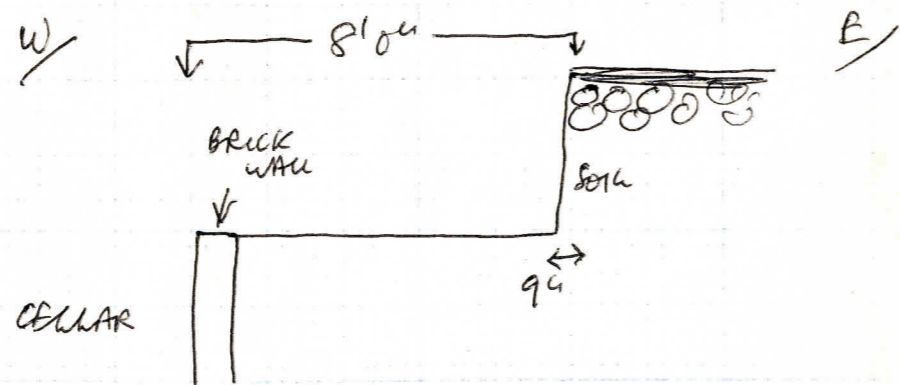
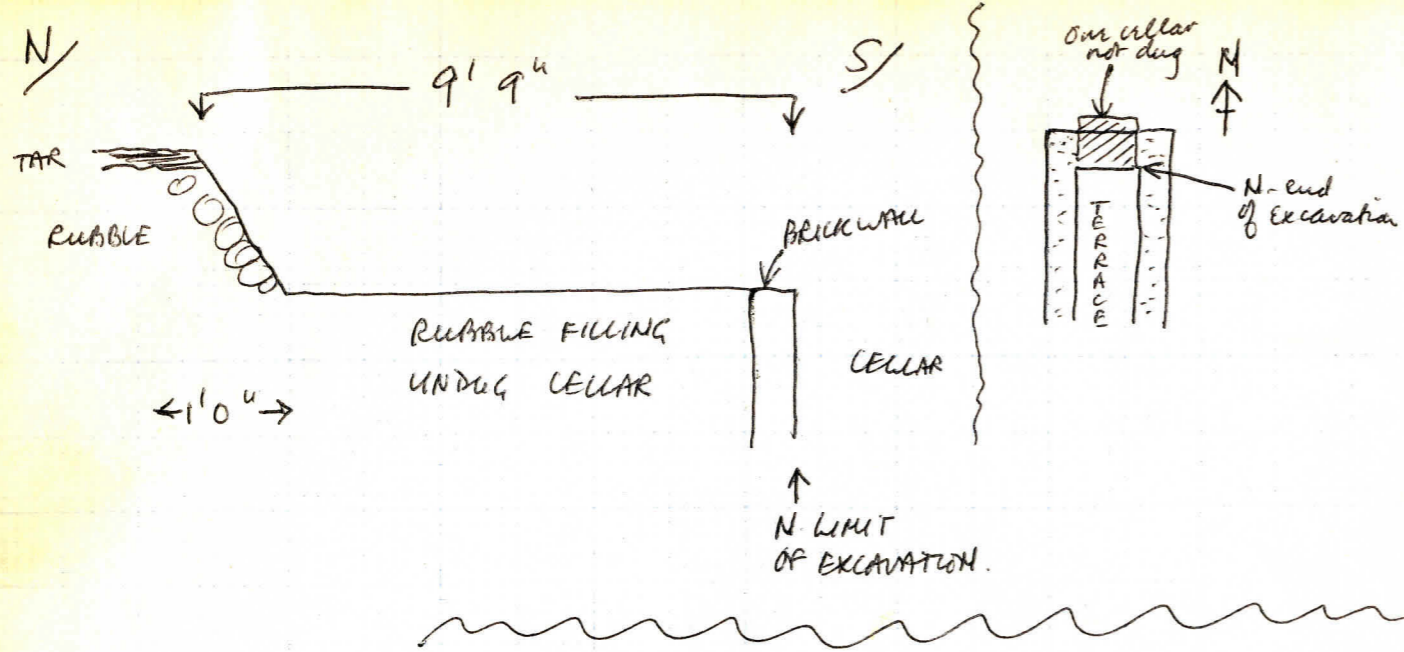

⊗ roughly - see plan

The carpark surface was rubble filling cellars (W side) and soil filling/over brick walls/cellars (E side). The N. limit of the excavation was an E-W brick wall dividing the cellar, so probably only the cellar of one building at the N. end was not excavated.

This undug area at the N. end was ramped gently with a slope from W. to E. for machine work and for human access to the excavation.

The E. side of the area was also cut back, through car-park surface, make-up, rubble and black soil for a distance of 8' 0" ⊗ with a 9" batter. This applies as far south as the N.W. corner of the mod. wall round the "Nottingham Castle" — see sketch plan over. This was then sloped down from N. to S. for access to the excavation. From X to Y was also sloped down and above this level everything removed back to the concrete. From Y southwards concrete was exposed as the E. side of the excavation. This concrete was also exposed as the S. side of the excavation. The concrete seems built to retain the rubble etc. in the cellars\* and has been topped with a brick wall, and its south face faced with boards (so the south side of it all looks like a brick wall).

NB  
\* but not contemporary with the demolition? It had a C.T. through the rubble infill of the cellars. Could be shortly after demolition or some considerable time afterwards.

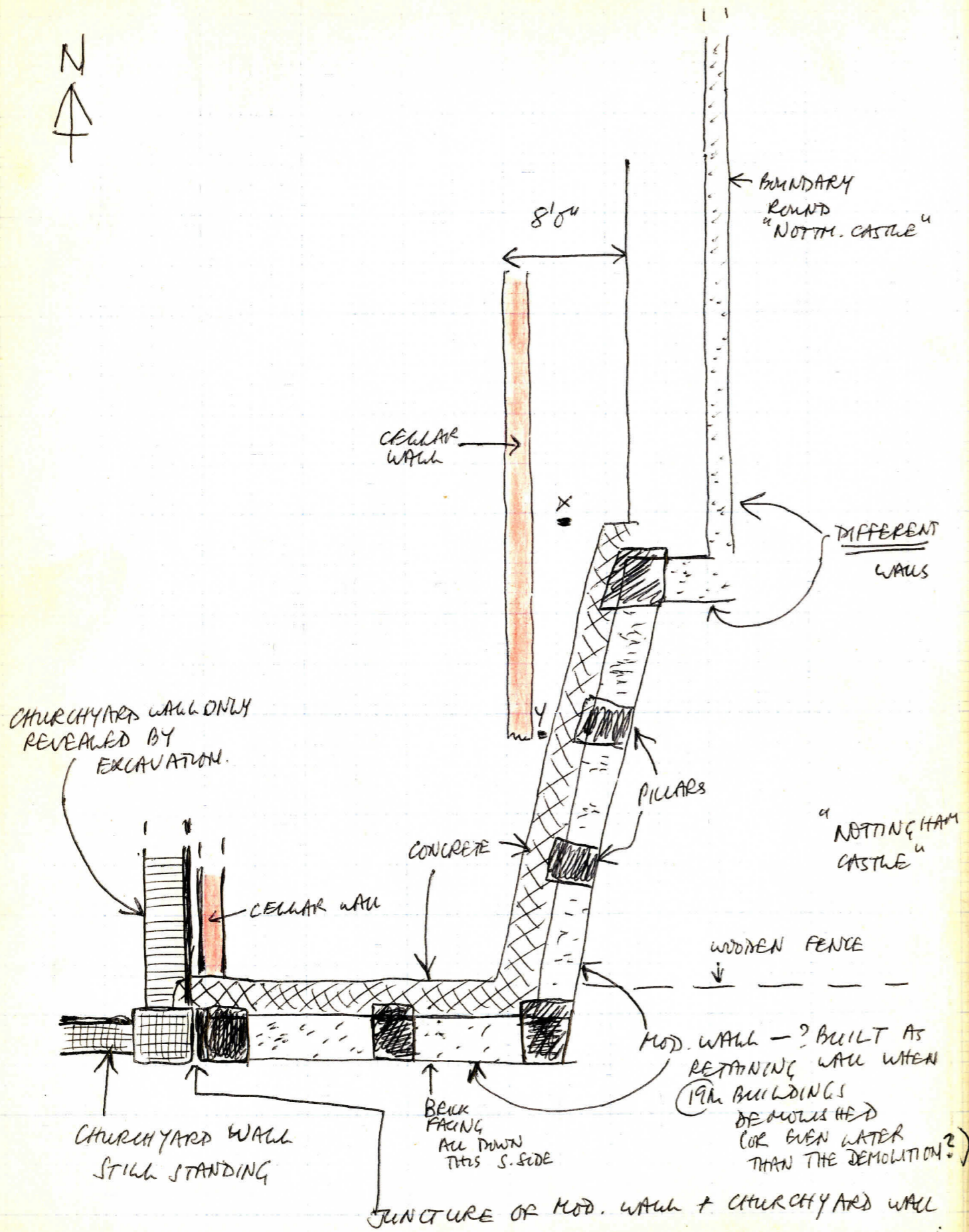

CHURCHYARD WALL ONLY REVEALED BY EXCAVATION.

BOUNDARY ROUND "NORTH CASTLE"

DIFFERENT WALLS

"NOTTINGHAM CASTLE"

MOD. WALL - ? BUILT AS RETAINING WALL WHEN 19th BUILDINGS DEMOLISHED (OR EVEN WATER THAN THE DEMOLITION?)

CHURCHYARD WALL STILL STANDING

BACK FACING ALL DOWN THIS S. SIDE

JUNCTURE OF MOD. WALL + CHURCHYARD WALL

## THE SECTIONS

### Introduction

The excavation consisted of excavating the cellars of the 19th cottages, then removal of the cellar floors + excavation of any underlying features, which proved to be predominantly "modern" except for ...

- (A) 1 rubbish pit at N. end
- (B) the E-W ditch at S. end
- (C) a N-S gully cutting (B.)

} Check G.P.'s notes to see if there are any others.

The depth of the cellars precluded survival of any rampart stratification, so the only choice for a rampart section was to remove one of the long cellar walls (E. side or W. side) to reveal a standing section.

The E. side was abandoned because preliminary investigation + ramping showed ...

(i) The concrete extended into the cellars ~~towards~~ the S. end, where erecting it had included removal of cellar walls to a very low level.

(ii) The cellar walls on the E. side <sup>generally</sup> survived only to a much lower level than on the W. side.

(iii) E. of the cellar walls on the E. side demolition rubble was evident. This suggested anything of interest had probably been lost here, possibly because the terrace of cottages had initially

was an an E-W terrace with the E. side

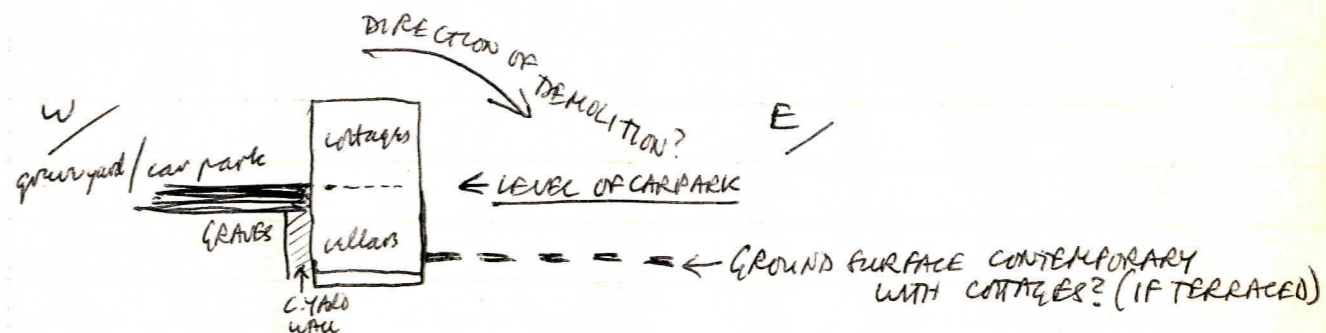

... being much lower, possibly with main access from this side, possibly via steps. Could be they were terraced into a pre-existing slope from W to E?

(iv) South of the carpark wall, it was known that the E. side was relatively disturbed, thus producing a "continuous" section through rampart/ditch.

Consequently it was decided to remove the N-S. brick wall on the W. side of the cellars only, to examine a standing section here along the boundary of the graveyard adjacent to the 19th terrace. It was thought burials would not have taken place right up to the cottages. It was uncertain whether the cottages were earlier or later than the graveyard, but if later it seemed there they would not have a C.T. on the W. side, but would have

N  
A

CAR PARK

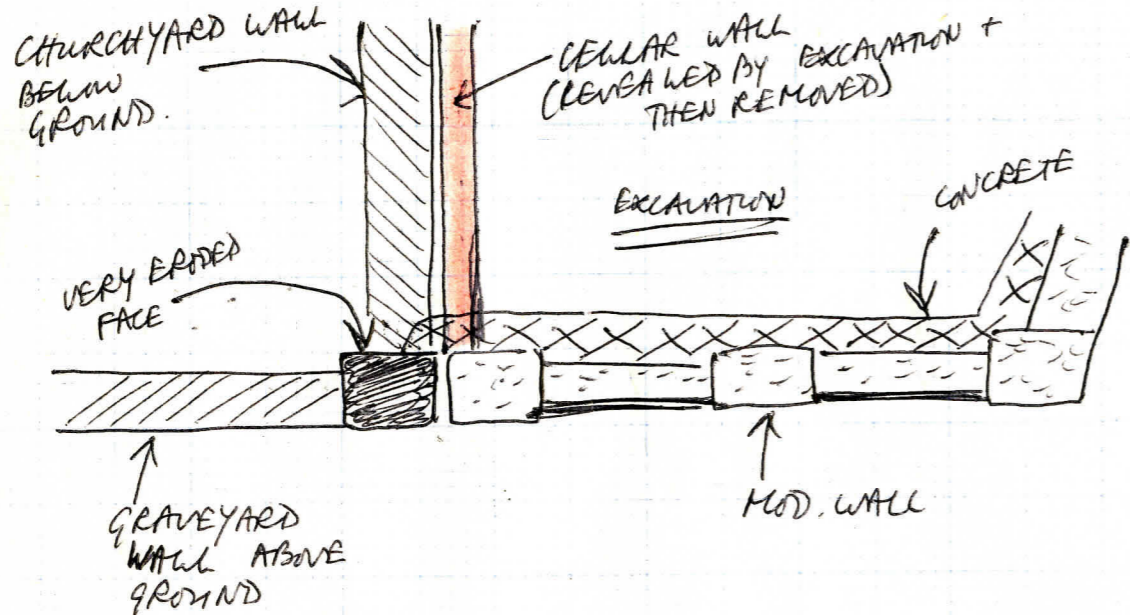

Green built from the E. up to a vertical face.

Removal of the cellar wall on this W. side however revealed another brick wall forming a boundary to the graveyard. The existence of this was previously unknown (there was no evidence of it above ground; and the standing wall left above ground was too eroded for evidence of a corner junction to have survived).

On removal of the cellar wall it was uncertain whether it or the graveyard wall was later. However, drains had been added secondarily to the (19th) cottages + these certainly cut through the graveyard wall.

As evidenced by the section the graveyard wall was in a comparatively ruinous state. Also had an odd structural method of below ground pillars + arches (not elsewhere in (19th) Nottingham buildings). Removal of the cellar wall revealed relatively intact stratification between the pillars, & under the arches, of the churchyard wall.

This churchyard wall was removed before actually drawing the section as it was rather unsafe. After removing it however it was decided to draw the section as though it



\* THEN PERHAPS TO CUT BACK AND DRAW AGAIN

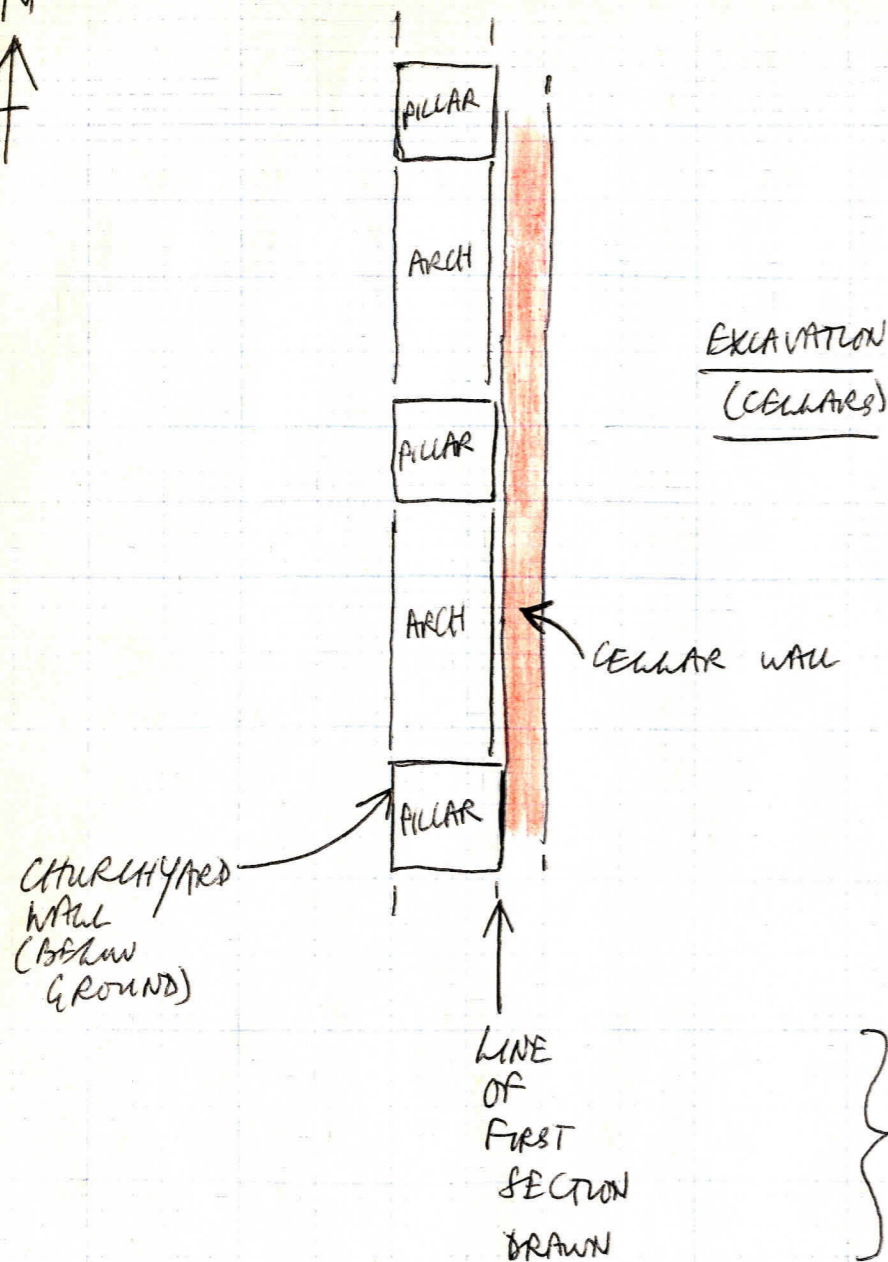

was still in situ. \* Thus the first section drawn is on a line with the outer side of the W. wall of the cellars (see sketch plan opposite).

==

STRATIFICATION SURVIVES UNDER THE ARCHES.



SKETCH PLAN  
NOT TO SCALE

THIS IS LOWEST OFFSET OF THE CONCRETE. SEE MAIN SECTION.

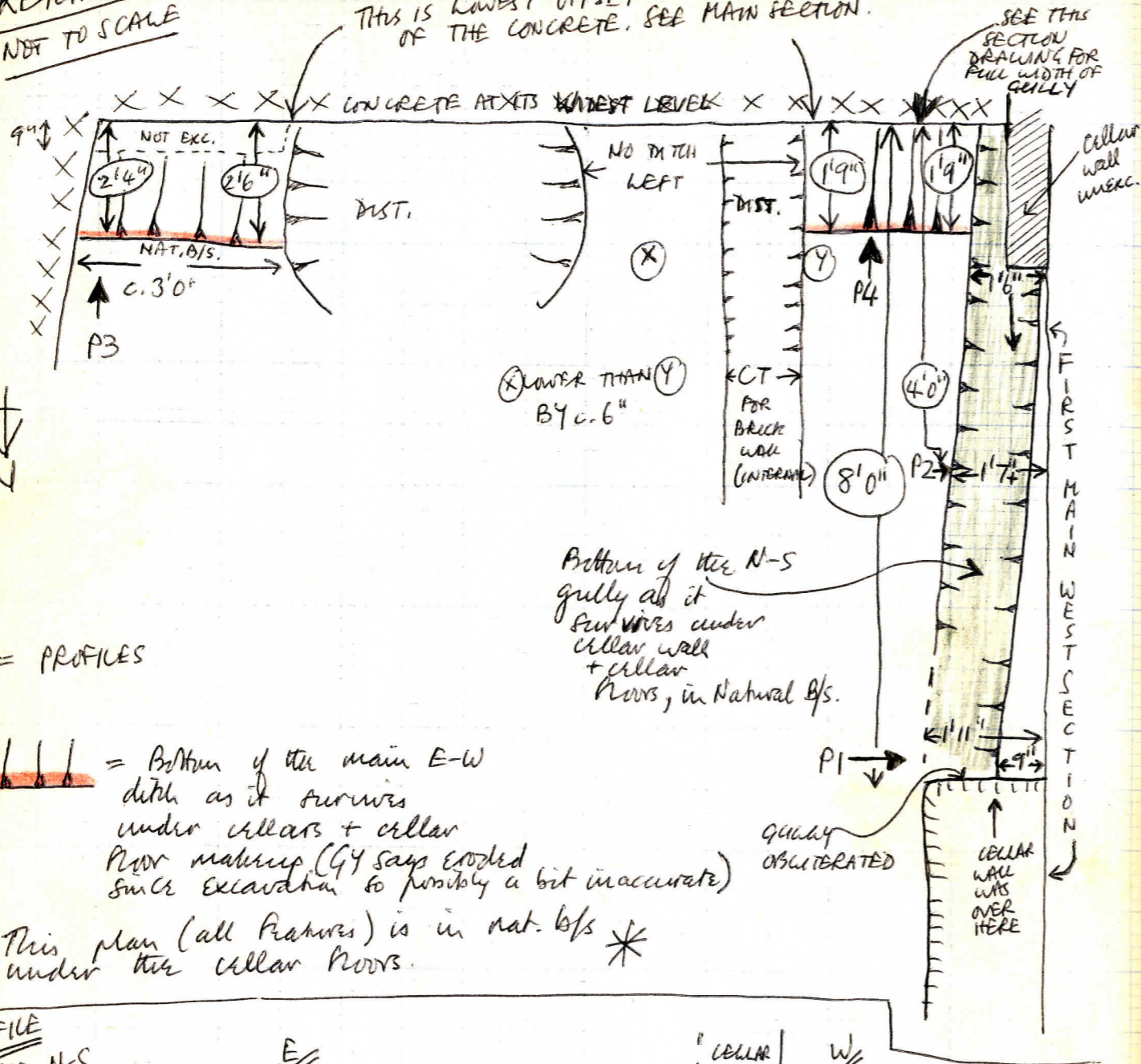

↓  
N

P = PROFILES

= Bottom of the main E-W ditch as it survives under cellars + cellar floor markings (G.Y. says eroded since excavation so possibly a bit inaccurate)

\* This plan (all features) is in nat. b/s \*

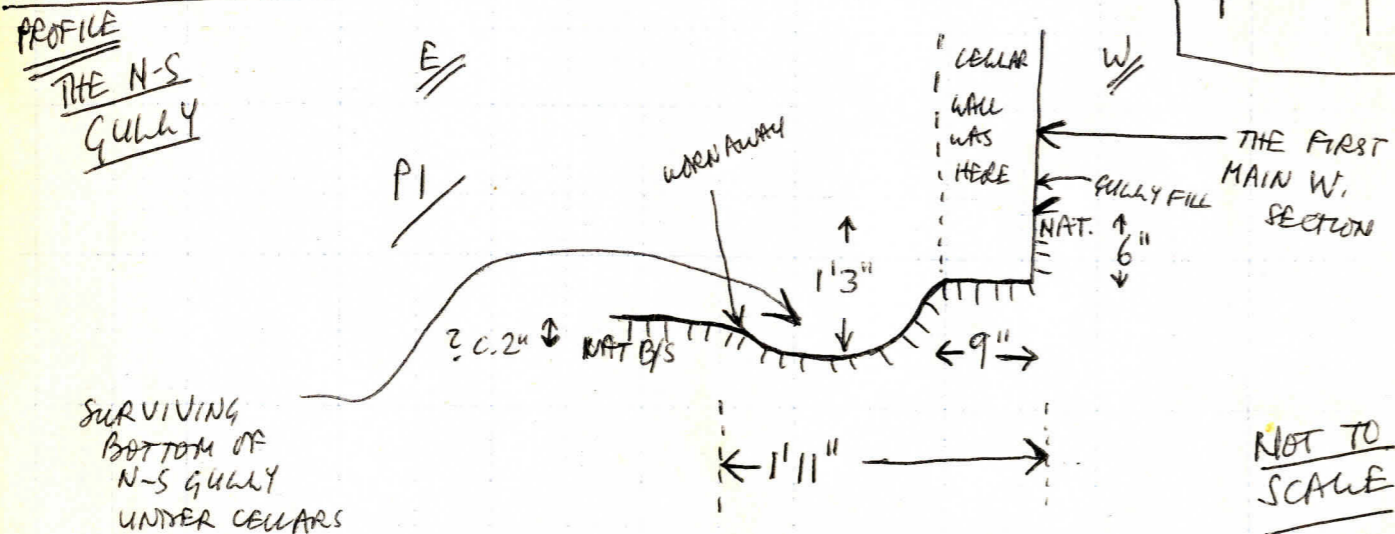

SURVIVING BOTTOM OF N-S GULLY UNDER CELLARS

NOT TO SCALE

Some explanatory notes of the south end of the section.

The very bottom of the large E-W Iron Age/Saxon ditch survives under the cellar floors at the very south end of the trench (see sketch plan opposite). In plan it is evident at both sides of the trench but has been removed by disturbance in the centre of the trench.

G.Y. says it had a more sharply accentuated, "deeper" profile than the slushes here — he thought probably it had been eroded by water and cleaning since he first dug it.

The edge of this big ditch does not however survive in the first W-section drawn. This is because it has been cut away by another small ditch / large gully which runs north-south, slightly obliquely to the drawn section. This oblique angle of ditch/gully to section is what produces the shallowly sloping (from N. to S.) cutting evident in the section. This ditch must be the one seen in the N. section of the 1973 excavation, in the area of the 1971 trench C — it is in fact evident in excavation of the 1978 area S. south of the carpark boundary wall.

PROFILE - THE N-S GULLY

P2

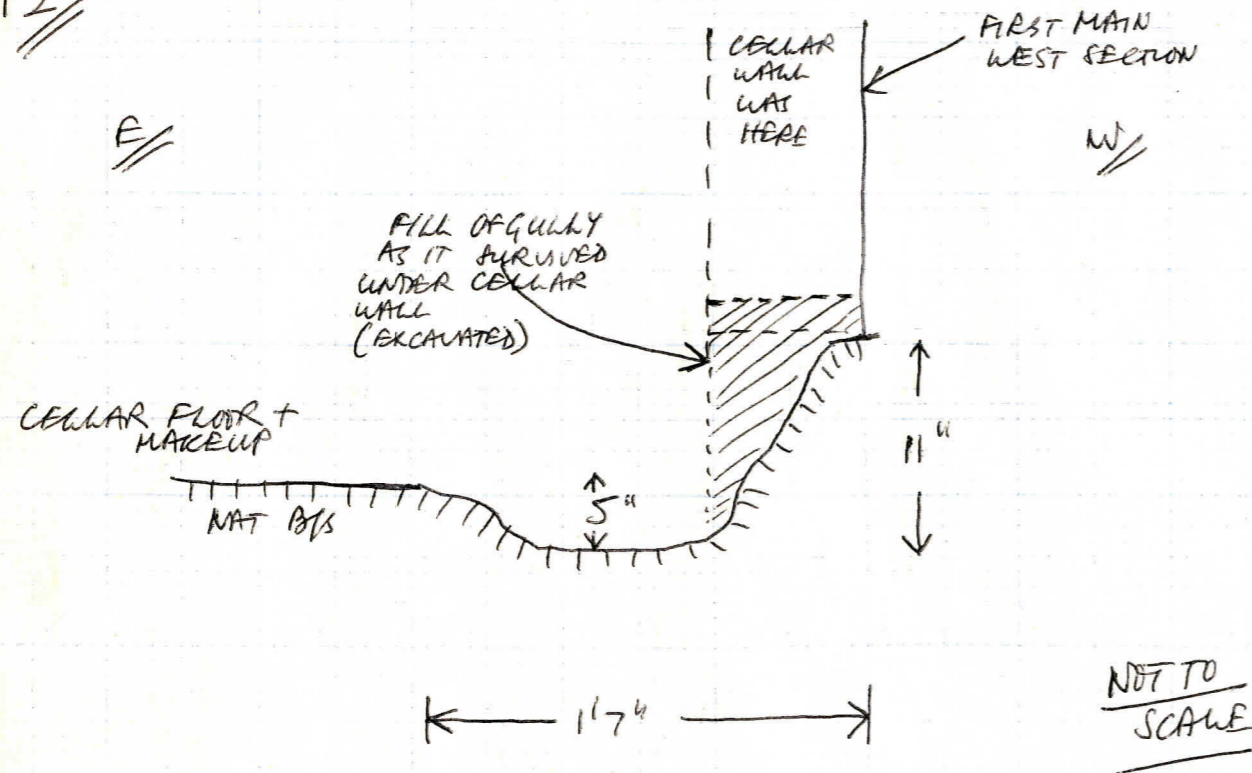

NB This gully at its extreme bottom drops from N. to S. c. 6" in its surviving length of 8' 0".

For full extent of this gully, + its cutting the main E-W ditch, see the E-W section at the S. end drawn with the first main W. section.

Although the N. to S. slope in the drawn section is a result of the N-S gully it is also very worrying. It looks as though the natural has also sloped from N. to S. here (see the pebbles in Nat. station) which means the E-W G.A./Saxon ditch has been cut into a pre-existing slope (cf. BQ T2?). The N-S gully makes it difficult however to establish the degree of any N-S slope in the natural (they look remarkably coincident!).

It looks as though the topography here had originally been complex. Possibly natural sloped from W. to E, as well as from N. to S. This means the N-S gully/ditch had been cut into two slopes (hence its W. side would be higher than its E side, and the further N. it goes the deeper it will appear!). This complexity is intensified by the ~~ES~~ E-W road evident in section, which has also resulted in a lowering of levels, by cutting or by wearing — it has removed upper fill of the N-S gully/ditch as well as upper fill of the large E-W ditch.

- This note on topography is borne out by....
- ① Level of main E-W ditch drops from W to E
  - ② Road drops from W to E
  - ③ N-S gully (bottom) drops from N to S

~~P3~~ PROFILE  
 THE MAIN E-W DITCH  
 (ALMOST AT THE E. LIMIT  
 OF THE EXCAVATION)

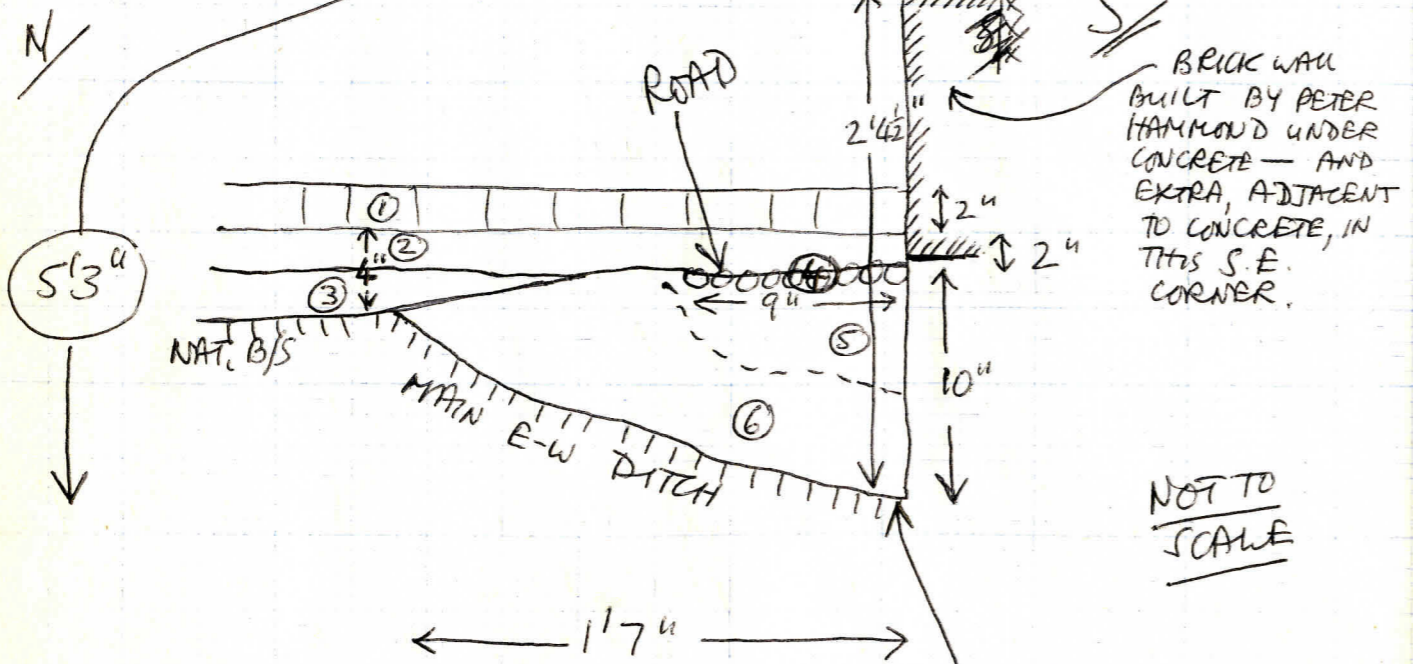

BRICK WALL  
 BUILT BY PETER  
 HAMMOND UNDER  
 CONCRETE — AND  
 EXTRA, ADJACENT  
 TO CONCRETE, IN  
 THIS S. E.  
 CORNER.

NOT TO  
 SCALE

NOTE THIS LEVEL HAS  
 DROPPED 1' 0" FROM  
 THE W. SIDE OF THE  
 TRENCH. LEVEL OF THE  
 ROAD HAS ALSO DROPPED

- ① Cellar brick floor
- ② Mid-grey, yellow speckled muck — cellar floor makeup
- ③ Speckled yellowish muck — cellar floor makeup
- ④ Pebbles — THE ROAD!
- ⑤ Brown sand stained pale grey — by percolation from ROAD? In the DITCH.
- ⑥ DITCH — clean light brown-yellow sand.

VERY IMPORTANT!  
 NOTE ITS LEVEL  
 RE. DITCH.

\* This is the lowest offset on the concrete and it is <sup>[I CHECKED WITH LINE LEVEL!]</sup> horizontal E-W. This will relate P3 to P4 and is shown on the first main W. section.

PROFILE — THE  
MAIN E-W DITCH

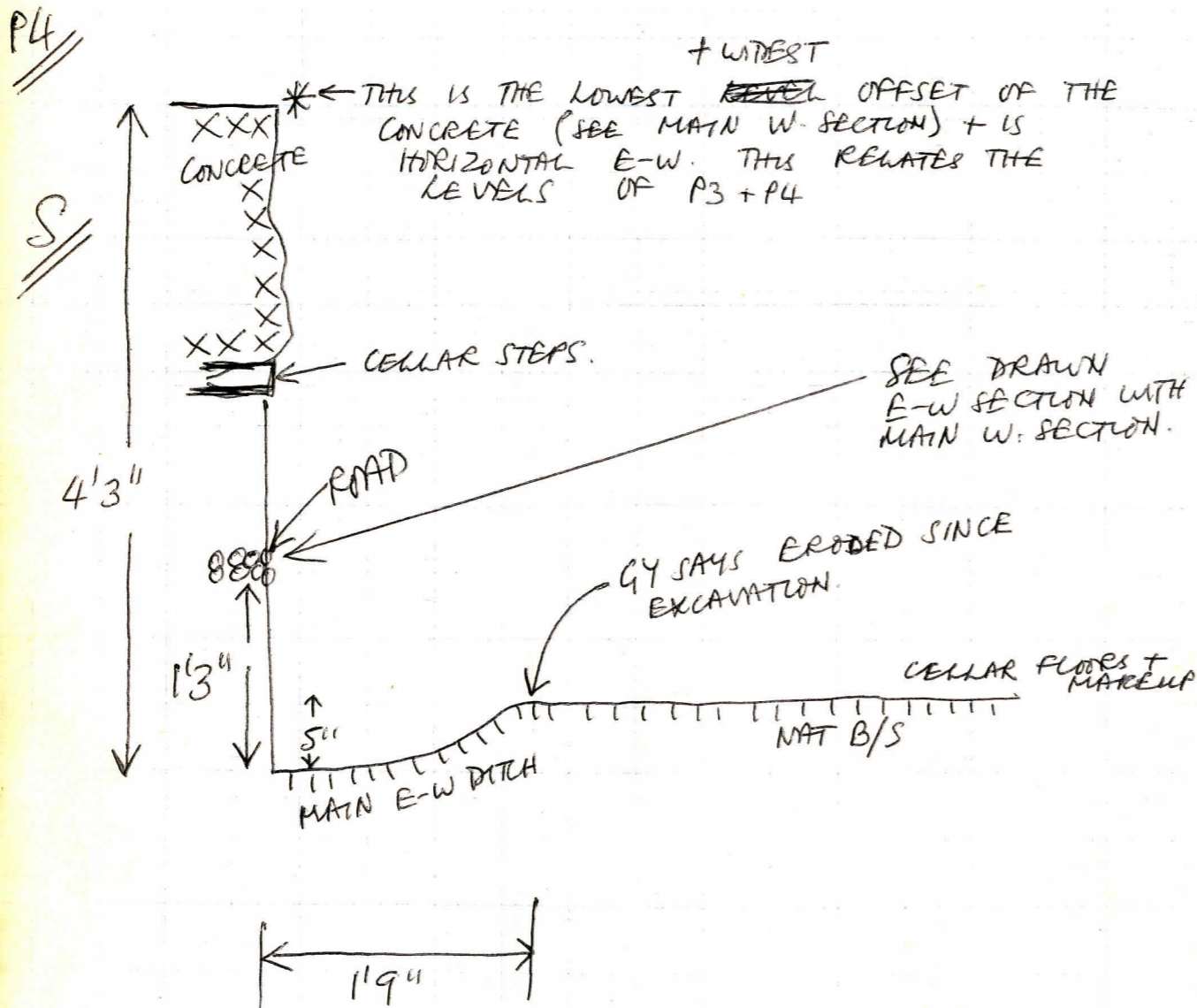

NB LEVEL OF DITCH DROPS BY 1'0" FROM W TO E.  
LEVEL OF ROAD DROPS BY 1'5" FROM W TO E (?? UNLESS E. SIDE IS IN A RUT??)

THE SECTION ITSELF

South end, from 0' to 13'6", including the E-W sections EW I and EW II .....

SECTION NUMBER

STREET NUMBER

1. Modern E-W boundary wall. Constructed of brick over deep concrete base. This concrete base is also a backing to the wall, and is faced with bricks on the southern exposed side. This wall divides the Ice Stadium carpark from the waste ground to the south. Built through the cellars and acts as a retaining wall when there is a considerable change in levels (i.e. the carpark is much higher than the waste ground to the south and than the grounds of the Nottingham Castle pub to the East.) This wall also exists E. of the excavation. See plan of area R.
2. Concrete. Base and backing for brick wall 1. It is really this concrete which performs the retaining function. The wall 1 is a topping and facing to it. Oddly 2 does not go down to bedrock. ? Was it built shortly after demolition of

the 19th terrace we excavated?

3. Tarmac surface of car-park.
4. Kerbstones for path round carpark. This path exists here and on the E-side of the excavation, adjacent to the E-W boundary wall and the wall round the Nottingham Castle.
5. Stone rubble car-park surface make-up. Grey-green rounded stones in grey-white stone dust.  
S was cut back considerably from the actual excavation edges. Projected here from W. to E.
6. Trench for elec. cable to divert street light stump adjacent to the southern boundary wall.  
Fill is S over small stone chips plus some brick rubble.
7. Black soil. This is adjacent to cellar wall (pre- or post-cellar?) and over the churchyard wall.
8. Black soil (s). Same as 7? Projected here from W to E. GY seems to have been

8. Also looks like 20.

\* Add

slopes up gently westwards from here to the W. limit of excavation. At this W. limit of excavation c. 6" of blackish soil(s) have been removed below 5.

Extra notes on 10.

The inside face of 10 (facing east) has rough mortar between the joints which is unpointed and has in places spread over the joints. This is the white mortar but it has stained grey on this side presumably from muck proceeding between the two walls.

This roughness suggests 10 has been built up to something already standing — the question is whether this was up to 9 or originally up to the edge of a C.T. which 9 has removed (i.e. do some or all of the cellars pre-date or post-date 10)

This E. face of the bricks of 10 is also uneven — some bricks scant and project slightly.

This roughness in 10 applies here to its full surviving height  
P.T.O.

this adjacent to the trench. Presumably looking for churchyard wall from the top? \*ADD

9. N-S brick wall forming W. side of cellars of 19th house. The section drawn is immediately behind this.

Wall c. 10" thick.

The concrete 2 courses up to this and overlaps it above the surviving top of the wall 9.

This part left in situ to preserve safety at this end of the trench (i.e. to retain the unstable churchyard wall etc.)

Brickwork is diagrammatic sketch. Courses accurate.

10. ~~Back~~ Brick wall running N-S.

This is churchyard wall forming E. boundary of graveyard (only located by excavation — didn't survive above ground)

c. 1'3" thick, bonded with white mortar.

Immediately behind cellar wall 9.

11. Same as 10, churchyard wall.

Removed before drawing section, but restored here from notes so the section drawn is all in one plane as nearly as possible.

12. Arch. Part of churchyard wall 10.

This technique of wall construction with below-ground pillars and arches fairly common in Nottingham (cf. DH 69 III).

10 CONT

... which we would expect to have been above the ground level ~~and~~ associated with it. This would suggest that 10 has been built up to 9 rather than up to a C.T. edge which no longer survives.

can't be certain about this!

ADD

20B. This has been excavated here, presumably from the top. Extends 1' 8" back from the plane of 20A. Sub-rectangular in shape.

Restored here (taken out before drawing section)

13 } Archers / pillar of churchyard wall 10.  
14 }  
15 }

16 } Construction trench for pillar 14. This is  
17 } void now since removal of 14.

18 Construction trench for pillar of churchyard wall 10, hidden behind 9. This part is void.

19. Loose black soil filling construction trench for pillar of churchyard wall.

20. This shaded area is c. 1' 5" back from the face of the drawn section. Not cleared + drawn — looks like all black soil (s). Possibly 20 up to 27 dug out from top by GY looking for churchyard wall? 28/29/30/31/32 are in same plane as drawn section.

20A. Like 20, this is c. 1' 5" to 1' 7" back from plane of section, so is presumably the material which survives behind the churchyard wall. Looks black soil (s) with yellow flecks but not cleared + drawn with this section.

N.B. GY said that when removing the churchyard wall, where the wall itself did not survive there was rubble black soil material like the intact 28/29/30/31. This presumably is destruction material from where the churchyard wall had fallen down or been removed. This was removed with the churchyard wall back to one plane which is c. 1'6" (i.e. the width of the churchyard wall plus a bit) back from the drain section. The drain section is what survives intact below the arches of the churchyard wall. Some of the material visible (but not drawn) in this inset plane behind the section could be C.T. material for the churchyard wall.

21. Not tampered with, but appear to be feet of stonely. These come right up to the drain section. If properly in situ (and it seems to be) this means a burial later than the destruction of the churchyard wall.



NB. This C-T. continues straight through to the second section (established by excavation).

22 to 26 = fill of C.T. for brick pillar  
14 of churchyard wall.....

22. Black soil heavily packed with coal.

23. Bits of brick

24. Yellow packed grey-black soil packed with bits of coal.

25. Small coal frags

26. Like 24.

27. Currenty void. In the same plane (1'6" back) as 20/20A / behind 14.

Construction trench for drain, still with slightly protruding ceramic drain pipe.

This is later than churchyard wall (B is gone) and presumably later than destruction of churchyard wall as it has been removed through 28/29/30/31/32.

Probably associated with (19th terrace (see GY's notes on R).

28 to 31 presumably material from removed or  
destruction or collapse of churchyard wall.  
In same plane as drawn section....

28. Black soil

29. Bits of brick and mortar or plaster.

30. Black soil.

31. Bits of brick rubble and mortar or plaster.

32. Presumably construction material for churchyard  
wall as it survives also below the arches.  
Bits of coal and coal dust (cf. 34)

33. Like 31.

Largeish bits of brick with white mortar or plaster  
+ some black soil.

Presumably destruction material from churchyard  
wall.

NB. unless re-deposited in a grave (not enough  
to examine for this) 33 seems to underlie  
21.

34 Coal + coal dust like 32.  
Presumably construction material for  
dunghill wall.

Late material in section EW II (the south  
face of the excavation on the same line as  
the E-W concrete) -----

35 } Wooden planks — forms for constructing  
36 } concrete 2, and left in situ.  
37 }

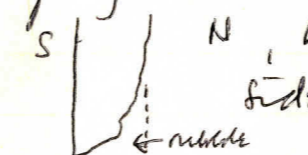
38 Now blocked off by a retaining wall built  
by us — but was black soils + brick rubble,  
going under concrete (probably concrete is  
having been built from the south).  

Probably this is filling of the cellars

39 Brick steps into cellars. Approx. at  
to this section.  
See GY's notes.



40. Brick floor of cellars

41 Internal brick retaining wall running N-S

inside cellar. This construction was

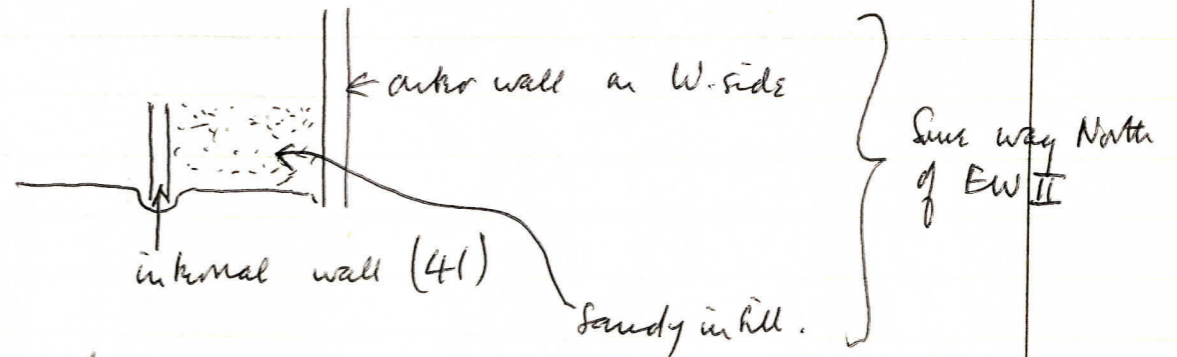

Above the sand infill was a narrow brick "courtyard" with steps running down from it (39) at each end.

42 Mortar brown-black soil filling C.T. for 39/41

43 Mixed mortar, yellow sand, black soil, filling C.T. for 41.

44 Sandy grey-brown soil. Presumably infill under steps, between 41 and 9

45 Coally black soil, as 44

46 Bits of brick and lumps of mortar in mortary brown soil.

Construction level for cellar wall 9 — also fills the C.T. for 9.

47 Light brownish mortar, in C.T. for brick wall 9

N.B. 46 directly across medieval pitted road,  
and C.T. for 9 cuts through the road.

The rest of section EWII is medieval or earlier.



West section, from 0' to 13' 6", cont. ....

The rest of the material here predates construction  
of the churchyard wall ....

48 Humic black soil with occasional coal pieces.  
Must be old (cultivated?) ground surface.

49. Humic black soil with occasional coal pieces.  
like 48 + probably same layer.  
Contains clay pipe bowl.

50. Black soil, slightly greyer/browner than 49.

51. like 50.

52. Feature Fill is fairly homogeneous and black  
+ humic.

Garden feature?

Post hole for N-S boundary fence?

Grave ????. (Very shallow if so, + must  
predate churchyard wall).



Nos. 54 to 58 are very much of a uniformity and form a group of similar colour and texture. All sandy soils of medium brownish grey colour.

54. Grey-brown sandy soil, occasional ch. cl. pebbles. 1 or 2 pebbles + bits of b/s.

55. Slightly darker than 54 with a darker grey silty content.  
Grey-brown sandy soil, occasional ch. cl. pebbles.

56. Grey-brown sandy soil very similar to 54.  
A bit lighter than 55.

57 and 58 are a little smoother and sandier than 54/55/56 but the overall colouring is similar....

57. Light grey-brown very sandy soil, occasional ch. cl. pebbles

58 Similar to 57 but slightly darker and greyer.

        
The layers under 58 down to the red clays would also seem to form a group. They are also greyish-brownish but several shades lighter than 58 and above. Also sandier,....

59. A mt?

Mid to light grey sandy with dark grey nodules.  
A few nodules of red clay + some ch.-cl., 1 bit of b/s  
and 1 sk.

60. A mt?

Very similar to 60.

59 + 60 are darker + greyer than those below.

61. Mid to light grey sandy with a few nodules of  
red clay; some ch.-cl. nodules.

62. Mid to light grey sandy with a few nodules of  
red clay. More reddish than 61 and more  
whitish. Some ch.-cl. nodules.

63. } Probably all one layer. Lighter and less  
64. } red than 62. Mid to light grey very  
65. } sandy soil with whitish sandy nodules.  
A few small nodules of red clay and charcoal.

66

66 and 67 have slightly darker, ~~greyer~~ greyer  
nodules.

66. Mid to light grey sandy with dark grey  
nodules. Occ. ch.-cl. nodules.

67. Similar to 66 but a bit lighter in colour—



NOTE I think the red clay has possibly been used as a road. Could be included as road metalling.

The internal divisions in the red could be due to random dumping of the material, or alternatively traffic running over it and driving it up then redepositing it.

Not certain however how far above the rds could be used as road. Possibly as far up as the surface of 61/62/63/59/64/60/65

Whitish sandy argillous.

68. This is similar to above, but redder. Contains more pebbles of reddish sandy clay, and more white sand.

"Redder" could be worms? or derived from underlying red clays if used as a road? Overall, 68 is faintly whitish light grey to mid-grey sandy with pebbles and wormholes of red clay and occ. ch. cl. pebbles.

Also some sherry pebbles as well as bits of sherry dramm.

69 Mid-grey to dark grey sandy with pebbles of red clay + ch. cl.  
Sherry as dramm.  
Rut?

70 Mixed mid-grey sandy and bits of red clay. Some tracks of charcoal. Redder + clayier than 68. Some sherry pebbles.  
Rut?

71. Sandier + more whitish than 68, with no red content  
Mid-grey to light grey sandy with whitish overtones. A few small pebbles of ch. cl. One sherry.  
Rut? If so, goes down to earlier possible metalling.



77 } Gritty grey sandy with red nodules  
78 }

79 Sandy red clayey. Occasional small nodules/lumps of gritty grey sand. Silty content as down. A few sparse nodules of ch. cl.

80 Gritty grey sandy with red admixture, like 74/77/78.



Under 80 is an abrupt change to dark grey sandy silts. These are mixed silts/sands of very sandy texture. They are presumably accumulations of muck on the pebbled road. Possibly road in use throughout the deposition of these.....

81 Dark grey silty/sandy. Occ. nodules of charcoal. Faint whitish yellow varnish.

82 Similar to 81 but slightly darker grey + more silty.

83 Very similar to 81 but slightly yellower overtones

84. Dark grey silty sandy with a few small charcoal  
pebbles. 1 or 2 pebbles of red sand.  
Medium amount of small pebbles + lenses of  
yellow sand (red and yellow derive from  
the material immediately N. of 84)
85. Darker grey silty/sandy whitish sand  
worms make it lighter than 81/82/83
86. Gravier texture than 85 and with more worms  
of white, yellow, + brown sand. So, dark grey  
silty sandy with these worms. Also a few  
charcoal pebbles.
87. Pebbles.  
Road metalling or disturbed road metalling.
88. More compacted than 86 but similar in texture.  
Also darker in colour.  
Hard dark grey silty sandy with brownish worms  
and a slight hint of green/grey/brown cessy.
89. Pebbles.  
Road metalling or disturbed road metalling.
90. Medium grey to yellowish admixture.  
Very hard + compacted.  
Mixed dark grey silty sandy and yellow  
brown sandy, the latter deriving from the

bottom or edges probably.

Nos 86/87/88/89 are in a rut in the road.

90 may be in the rut or could be sand under the rut stained from the rut.

91. Dark grey silty/sandy with distinct veins of whitish sand.

92. Pebbles.  
Road metalling or disturbed road metalling.

93. Pebbles, as 92.

94. Hard compacted mid-grey silty sandy. Overruns of white sand and dark brown sand. Possibly fairly cassy. 1 ch. d. peck.

95. Similar to 94 but more whitish.

96. Compacted pebble surface.  
Road metalling.

Around + immediately below 96 is a very hard greeny to brown compacted cuss-pan, staining the underlying layers slightly.

Nos. 81 to 96 seem to be in a "cutting".  
Presumably then the road is an E-W  
"cutting" (cf. roads found in 1973/4 of which  
this must be a continuation).

This cutting could be deliberate, or it  
could be due to wearing away and  
erosion due to use of the road.

As the road drops c. 1'6" from W. to  
E. over this trench erosion could have  
caused loss of material towards the  
south East.



97 Mid to dark grey silty sandy with brownish-green  
oxides. Rather like 94+95.

98. Compacted pebble surface with some hard  
greenish cross-pan.

Road metalling.

NB. 97 picks up again over 98 under 71 +  
79 — see section drawing, but couldn't fit  
the number in.

Two thoughts occur re 98.....

(i) it could be pebbles sprayed up from the  
road 96 etc. from carts etc. I doubt this  
as it looks in situ.

(ii) 98 could represent the original level

Direct comparison when describing the section.

100 + 101 aren't really like any of the layers southwards. Not as silty as the 54 to 58 group so probably not with those!

Perhaps most nearly like the greyish layers of over the red clay but not really similar.

Perhaps stripping has occurred and they are top of fill of the N-S gully, and in fact earlier than the road

of the road. The sunken area south of this could be due to road wear. This would mean 96 etc. is re-cutting of the road, of which 98 is the original surface.

Under 97/98/84/90/96 there is an abrupt change in the nature of the stratification. Everything below is light-colored (brown/yellow) + compacted, and is almost pure sand (silted?).

No lentic content, no greys etc.

This remark applies up to the 8' mark on the section (N. of the 8' there is still later stratification yet to be described).

See immediately M+S of S2.

99 Grey-black sandy soil mixed with yellow sand.

100 Mid-grey to dark grey (contains silty bits) sandy soil. In fact very sandy, and with distinct nodules of whitish sand in small clumps. Occasional ch. cl. pebbles.

101 lighter, paler, + sandier than 101. Fairly even admixture. Basically whitish grey sand to sandy mixed with light grey to medium grey sand to sandy.

NB. Under brick pillar 14 part of the upper edge of the gully is visible through natural

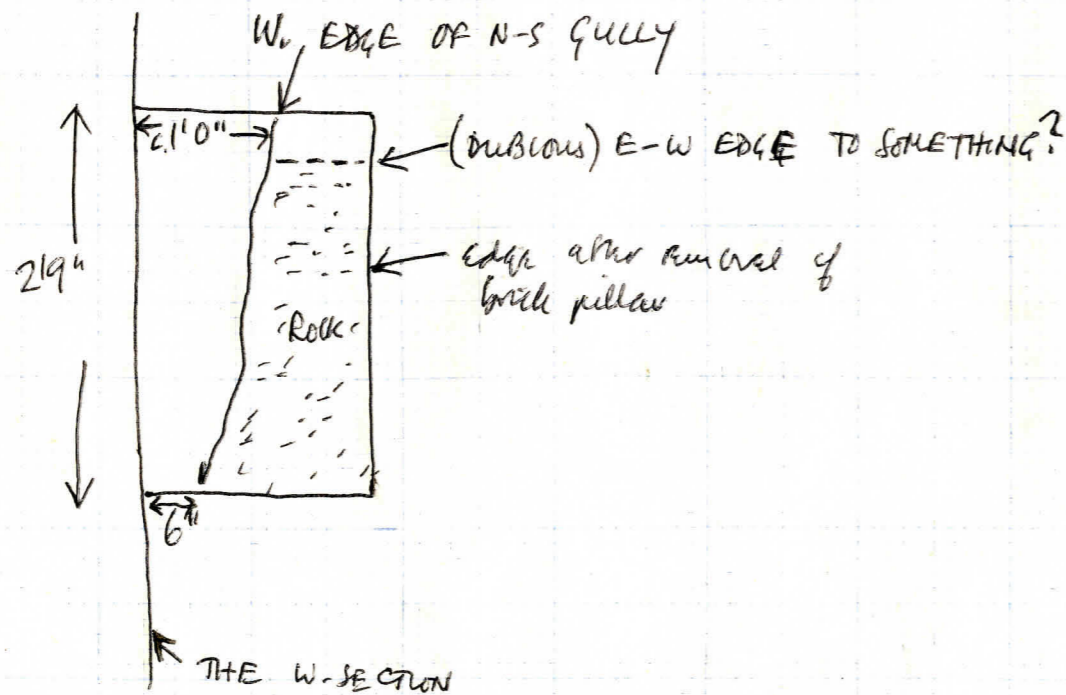

Under 101 in this West section, all the rest would appear to be the filling of the N.S. gully or small ditch, which also appears in area S south of the boundary wall.

This N-S gully is slightly oblique to the drawn section, so the drawing is a longitudinal section through the gully.

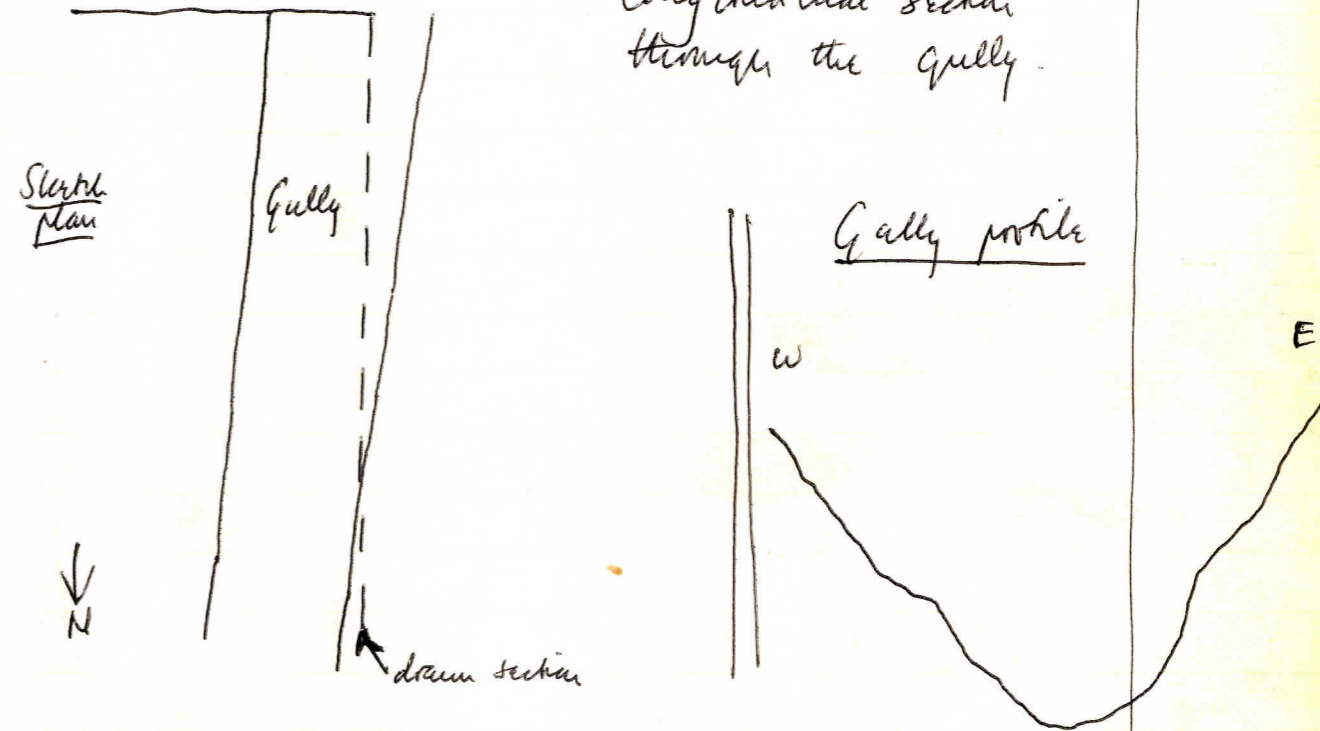

It is this oblique section through the gully which produces the slope in the section from N to S.



102. Definitely bears the hallmarks of the gully layers, i.e. relatively pale + very yellowish and mostly sand.  
Coarse textured light buff yellowy sand with grey nodules (from a small content of grey sand lenses). Contains speckles of lead brownish green (assy?) material.
103. Not certainly = 102 as not enough survives. What there is looks similar to 102 (same greenish speckles).
104. Has pinkish nodules. Basically yellowy-buff coarse sand with nodules (faint) of greyish pink sand.  
Looks similar to 105 but not enough to be certain.
105. Has pinkish nodules. Yellowy-buff coarse sand with a small content of finer greyish pink sand.
106. Very coarse yellowy-buff sand with some speckles of b/s and some hard brownish-green (assy?) speckles. Lighter + cleaner than 102.
107. Can't be certainly related but looks fairly similar to 106, although it lacks the greenish speckles.

when excavated, the area of III is  
Restricted to subsidence into the N-S gully.

108. Not like 109/110/111.

Not like 72 to 80 as it's pinker + sandier.

Pinkish red sand with some content of pinkish  
clay. Some buff sand mixed in.  $\frac{4}{3}$  Closest  
equivalent is III. Is it perhaps = III with  
109 and 110 extra?

109. Hard smooth-textured dense sand (no clay).

Overall colour is pinkish grey, with some buff  
overtones.

Not as red as III.

? = 110 = III

110. Like 109.

111. Very hard, compacted, and dense.

Overall pinkish to pinkish red (but much less  
red than the red clays just South of it), with  
speckles + lenses of greenish (assy?).

Basically pinkish red sand to very sandy  
clay, with some actual clay content in small  
lenses.

=

Except for the greys at the south end, and  
the yellows silted from natural, all the  
rest of the layers in the gully are overall  
similar. All lower sands, all yellowish-buff-tan

Fill of gully — not done  
in stratigraphical order.

in colour, many if not most with a lot of  
small speckles of brownish green (assy?)

112. Coarse buff-fawn sand with yellow nodules  
and brownish-green speckles
113. Darker buff-fawn sand with nodules of khaki-  
brown. No green speckles
114. Pale buff-fawn sand. Slightly finer in texture.
115. Brownish buff-fawn coarse sand.
116. Coarse yellow sand (b/s wash)
117. Coarse buff-fawn sand
118. Coarse yellow sand (b/s wash)
119. Brownish buff-fawn coarse sand
120. Coarse yellow sand (b/s wash)
121. Brownish buff-fawn sand with specks of yellow  
b/s. Some dark brown speckles.
122. Coarse compacted brownish buff-fawn sand with  
brown-green speckles (?assy)  
Sparse flecks (up to 1cm. across) of pinkish red clay.

123. Lighter than 122. Coarse buff-tan sand with brownish-green speckles, the latter giving an overall faintly greenish appearance.
124. Buffish buff-tan sand with yellow orestones. Faint brownish-green speckles.
125. Coarse yellow sand (b/s wash) with admixture of brown sand.
126. Fairly similar to 123 but lacks the greenish appearance. Buff-tan brownish sand with a lot of small dark brown speckles, some of them faintly greenish. Faint pale tan to yellow sand orestones.
127. Hard admixture of light grey sand to grey-tan sand with yellow b/s wash. Some brown speckles.
128. Coarse yellow sand (b/s wash)
129. Like 127 but with more of the greyish sand.
130. Coarse yellow sand (b/s wash)
131. Like 129.
132. Compacted brownish buff-tan sand, coarse texture, with greenish orestones and brown-green speckles. One piece of pinkish red clay.

133. Paler buff fawn sand with admixture of whitish fawn sand. Some brownish green speckles. Faintly greenish appearance.
134. Streaky faintly brownish buff-fawn sand. Brownish green speckles. Slight coarse yellow sand admixture. Faintly greenish appearance.
135. Faintly greyish, compacted light buff-fawn sand with greenish speckles. Slight admixture of whitish-fawn sand.  
When the net is through 135 there's hard dark green cess pan at the edges.
136. Hard compacted buff fawn sand with faint brown-green speckles. Admixture of paler whitish fawn sand gives a "milky" overtone.
137. Dark grey sand to sandy with slight buff/organic content. Some tiny beds of charcoal.
138. Coarse pale grey to mid-grey sand to sandy.
139. Coarse pale grey to mid-grey sand with white sand overtones.
140. Coarse pale whitish grey to whitish fawn sand.

141. Mid-grey sand with whitish fawn sand admixture.
142. Light-grey to mid-grey sand with fawn sand nodules.  
Brownish green speckles.
143. Light grey sand to sandy with white sand nodules.
144. Coarse yellow sand from Gls with white sand and pebbles.
145. Coarse whitish fawn sand
146. Light grey to mid-grey sand to sandy. Some fawn sand content and some brown-green speckles.
147. Mid-grey to dark grey sand to sandy. Some fawn/white nodules and some brown speckles.
148. Mixed lobbly grey sand to sandy and fawn sand. Some brown-green speckles.
149. Pale brownish-fawn sand with yellow sand nodules. Some brownish-green speckles.

Sketch plan of sections

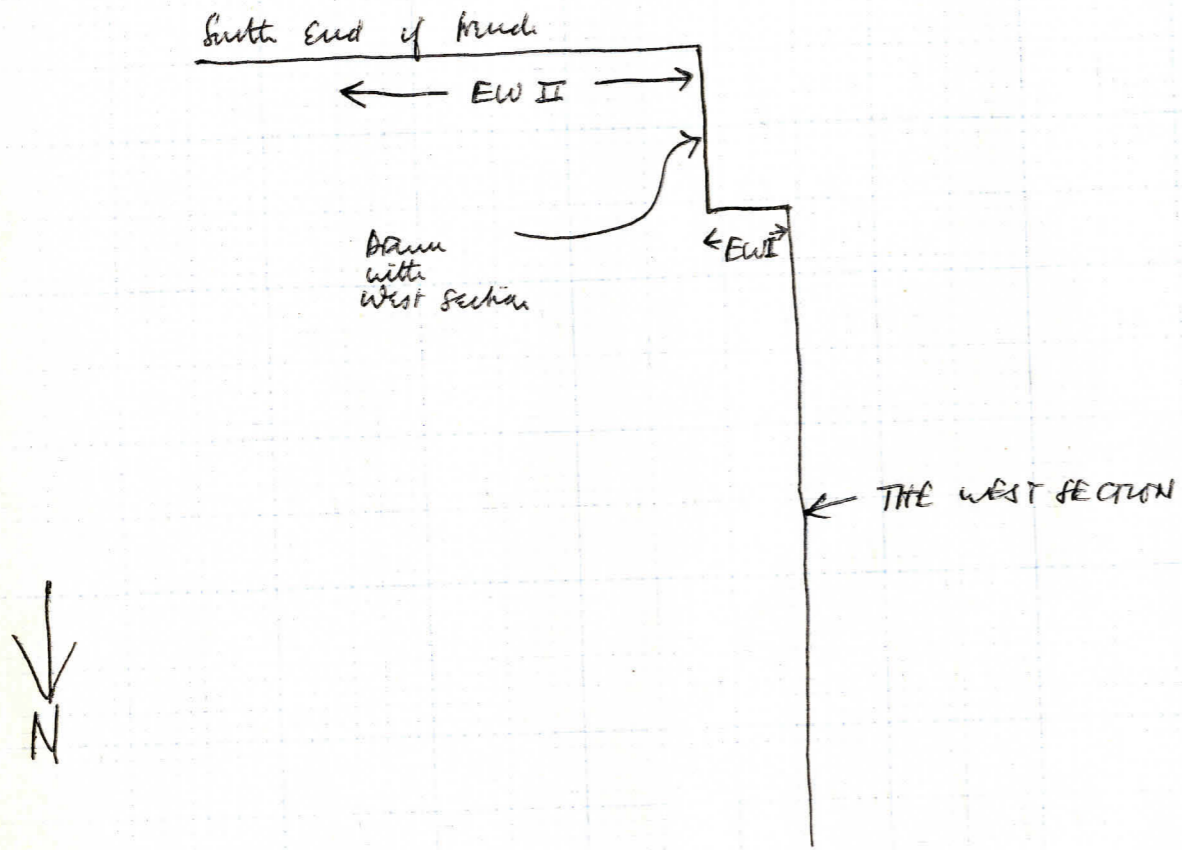

150 Pale fawn sand with grey sand admixture.  
Some brownish green speckles.

151 Grey sand with fawn sand admixture.  
A lot of greenish brown speckles.

The above descriptions include EW I.

EW II  
151/146/147/148/150 already described and  
followed through .....

The road (this runs E to W and is also visible  
in the E-side of trench R. Was also found  
W. of here in 1971/73/74)

152. 3 thick masses of pebbles. Road metalling.  
Not distinguishable as separate surfaces.  
A rut is a possibility?  
Compacted together with cross pan which is also  
about 1/4" thick under 152.

The N-S gully (151/146/147/148/150 also in this)

153 Hard light grey to mid-grey sand with fawn sand  
admixture. 1 or 2 brown-green speckles.

154. Mixed light grey to mid-grey sand and fawn sand. A lot of green speckles, (assy?), and some brown and brown-green speckles.
155. Whitish fawn sand with admixture of light grey sand. Brownish green speckles.
156. Similar to 155 but paler and lacking the brownish green speckles.
157. Light grey to mid-grey sand. A few brown speckles.
158. Grey-fawn sand with whitish sand at bottom. Some brown speckles.
159. Similar to 158 but paler, with more fawn and more white. Brown-speckled.
160. Grey-fawn sand — greyer than 158.
161. Faintly whitish fawn sand.
162. Coarse white sand.



The main E-W ditch

The edge of this (what survives of it under cellars) runs E-W c. 2'0" out from the South end of the trench.

The bulk of the ditch, as located in 1971/1973 and 1974, and being excavated now in area S, lies south of the car-park boundary wall.

163. Compacted brown sand with overtones of white sand and light grey sand. Sparse small dark brown specks.
164. Faintly greyish admixture of white sand and brown sand.
165. Clean brown sand with khaki-brown overtones.
166. Mixed brown sand and white sand with faintly greyish overtones.  
like 164.
167. Coarse yellow sand and white sand from G/S wash. Overtones of light brown sand.  
A few pebbles.

NB. These notes so far on  
the naturals only apply to  
the 0' to 13' 6" on the  
Section.

### Addendum

168. Extra layer in the N-S gully only found  
after removing some natural (see below)  
Layer of dirty redeposited soft natural  
with admixture of grey sand. Contains a  
quantity of small pebbles.

### CHECK ON NATURALS (from 0' to 13' 6")

To follow the dipping natural pebble stratum  
some natural was removed at the S. end of  
the trench (see section) to complete this  
stratum on the section drawing (see section).

Examination of the naturals in the trench  
suggests there may have been a slope from  
N to S in the natural approximately similar  
to the dipping pebble stratum ~~169~~ 169,  
although this could be due to the  
random effect of bedding planes. 169 suggests  
this slope which is fairly similar to that  
produced in section by the N-S gully.

At 3' 3" on the datum 169 ends where  
it joins a hard stratum of orange in the  
yellow. This orange 170 is more nearly  
horizontal, and also contains the occasional pebble.

\* And these striations visible under 170 are also horizontal.

The orange striations in the rock are fairly horizontal over 169 from 0' to 5' on the datum (presumably being dictated by 170).

North of the 5' 0" to 13' 6" the orange striations in the yellow over 169 follow a similar N to S slope as 169.

The striations in the yellow between 170 and 169 are relatively horizontal as is 170.

These notes written not with reference to the N-S gully, which cuts through even the dipping orange striations over 169, but in case there is a N-S slope in natural which would have a bearing on the position of the main E-W ditch at the South end of the bench.

The evidence available is inconclusive, but I would tend to think there was in fact been a N-S slope into which the N-S ditch has been cut.

This is all problematic because we do not have the edge of the E-W ditch in section, and because of the slope produced there by the oblique N-S gully. It all looks peculiar!

af

169. Natural.

Status of pictures in Natural B/S

170. Natural.

Status of harder orange in the yellow  
natural B/S.

---

FROM 13' 6" TO 31' 6"

- 171 } Brick pillar and arches of N-S churchyard  
172 } boundary wall, restored here from GY's  
173 } notebooks. In reality there are voids extending  
c. 116" back from the drain section (from  
Removal of the wall) to the same plane as  
20A.

\* NB. There are late features of a "yellow" nature  
barely discernible in 20A. Possibly graves.

- 174 } Brick pillar and arches of N-S churchyard  
175 } boundary wall, restored here from GY's  
176 } notebooks. (cf. notes on 171/172/173)

177+178+179 — Bottom of construction trench for  
drain later than 173 and 175 .....

177. Black soil with bits of brick, white mortar, coal

178. Bricks with white mortar (not in situ)

179. Black soil with a lot of brick chips  
and small bits of white mortar.

This drain is discernible  
in 20A.

Section South of 171

~~180~~. Void where 171 has been removed.

Construction North of 171 .....

- 181 Small bits of coal and coal dust with slight admixture of black soil
- 182 Looks yellow/gray = admixture of yellow b/s + sand + black soil.
- 183 Admixture of dark sandy soil and bits of coal
- 184 Brownish gray sand to sandy with pieces of yellow sand (from collapsing edge)
- 185 Like 183 but with more coal.
- 186 Gray to gray black sandy soil
- 187 Admixture of dark gray sandy soil and yellow b/s, sand, with sparse small pieces of coal.
- 188 Gray to gray black sandy soil peppered with yellow sand/b/s and small bits of coal.
- 189 Looks yellow-gray = admixture of yellow sand/b/s and gray to black soil
- 190 Gray black soil peppered with yellow sand/b/s and coal.
- 191 Like 190, probably same layer

- 192 Looks yellow-grey = mixed dark soil and yellow sand / b/s
- 193 Grey to black sandy soil packed with coal and with yellow sand / b/s
- 194 Similar to 193 ~~and~~ but with a greater quantity of yellow sand / b/s
- 195 Looks yellow with grey nodules = yellow sand / b/s packed with coal and dark soil.
- 196 Grey-black sandy soil packed with coal and with light flecks of yellow sand. Few frags of brick + white mortar.
- 

Feature — garden or agricultural?

- 197 Blackish soil with grey-brown sandy nodules, with very sparse small coal flecks.
- 

Feature — cf. S2 + S3 — possibly posthole of a N-S boundary fence (or ??? a grave which is pre-wall etc. etc.)

- 198 Dark grey sandy soil with blackish nodules and small yellow flecks + lenses (presumably the yellowish from the edges).
-

N.B. There's a coal spread at the "bottom" of 202 which reaches 228 and 204 but is interrupted by 177/179

Filling of N-S gully/ditch

- 199 light grey sand with yellow streaks + almost indiscernible pinkish washes.
- 200 similar to 199 but with a lot more yellow sand.
- 201 Wash or collapse from yellow G/S = yellow sand with faint grey sand admixture.

Section between 171 and 174

- 202 } Wides from removal of churchyard wall
- 203 } 171/173/ 175/174

Construction March for 171

- 204 Black soil with a few coal streaks.
- 205 Small bits of coal with some admixture of blackish grey soil.
- 206 Grey-black sandy soil
- 207 Grey-black sandy soil mixed with coal and yellow sand.
- 208 Similar to 207 but more yellow



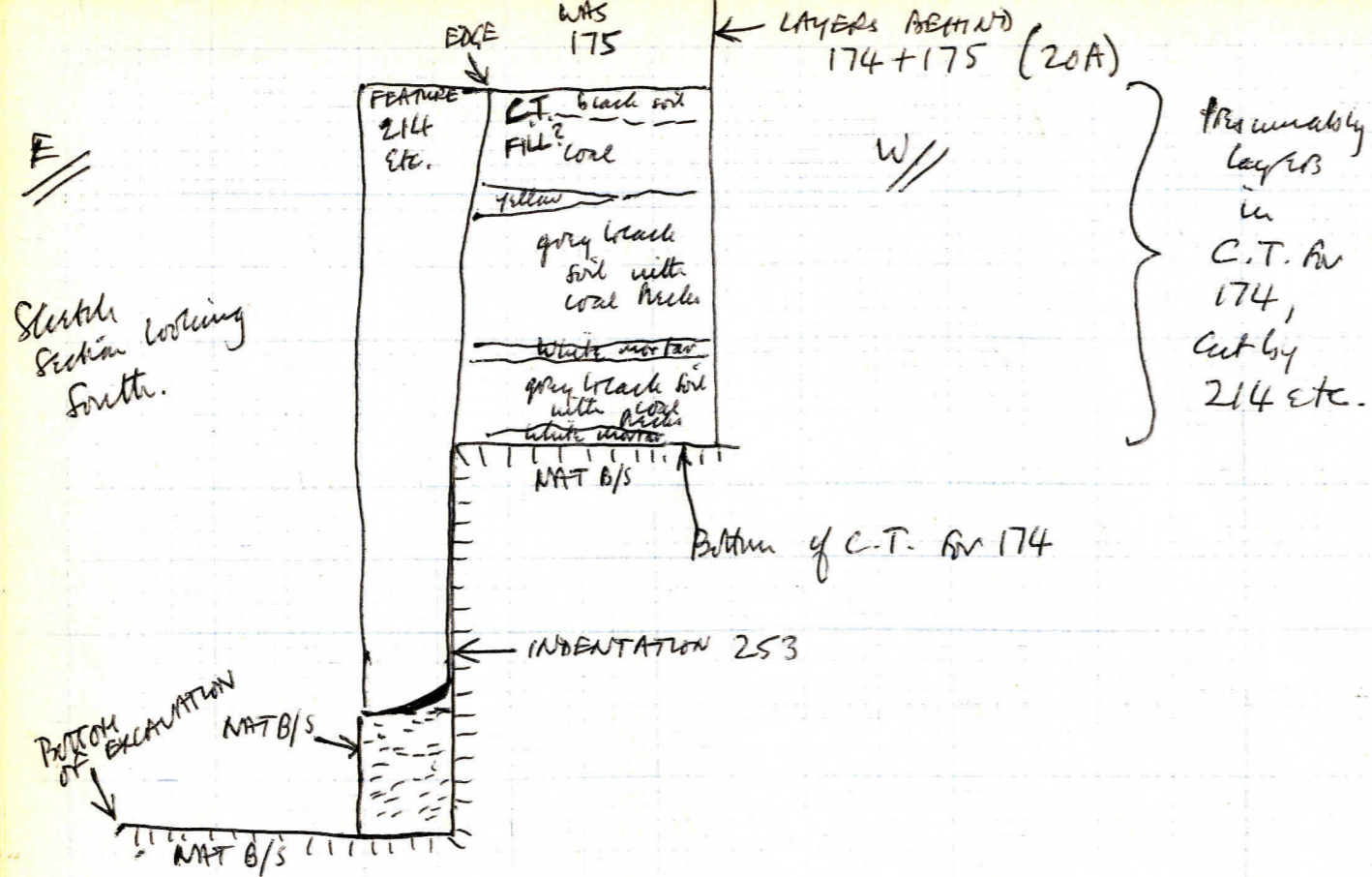

NOTES ON FEATURE

This can't be C.T. for 174 and in fact seems to have been cut from East of the drain section. Looking at the South side of the C.T. for 174 (in the void) there is a nearly vertical edge from the highest possible level c. 5" back from the drain section, through layers which are presumably filling the C.T. for 174. This edge coincides with the indentation in natural (see 253). Also see sketch section above, drawn looking south.

This may be in with two phases of brick cellars here with a sequence of - - - - -  
 Phase 1 cellar / chunky and wall / 214 etc. cut while building phase 2 cellars.

- 209 Coally dark soil with flecks of yellow sand and b/s
- 210 Grey-black sandy soil packed with coal
- 211 Small bits of coal with slight admixture of dark soil.
- 212 Grey-black sandy soil packed with coal and yellow sand.

213 Layer of small bits of coal. Associated with construction of 175. cf. 34  
 [and see extra note on 202, where spread must = 213]

FEATURE (SEE NOTES OPPOSITE)

- 214 Black soil with coally lenses (much disturbed by roots here)
- 215 Grey-black sandy soil with brownish overtones. Sparsely packed with coal.
- 216 Like 215 but with sparse flecks of yellow sand from b/s.
- 217 Like 215 with the addition of several small lumps of white mortar.
- 218 Small bits of coal with slight dark soil admixture. 1 small lump of white mortar.
- 219 Grey-black sandy soil with brown overtones. Sparse flecks of coal and yellow sand / b/s

220 Coarse yellow sand/b/s

221 Gray-black sandy soil mixed with coal.

---

"Horizontal" layers (presumably post-dating a leveling).....

222. Gray-black sandy soil

223. Gray-black sandy soil with some coal streaks

224. Dark gray-brown sandy soil with admixture of blackish soil + occ. coal streaks

225. Similar to 224 but darker and has some yellow streaking

226. Coarsely dark gray-brown sandy soil with blackish nodules

227. Mid-gray to dark gray sandy soil with distinct brown nodules. Coal streaks.

228. Like 227 + possibly same layer.

FEATURE (V. LATE)

(ALL ARE VERY SIMILAR)  
(VERY GREY-BLACKISH, BUT  
LIGHTER THAN 214 ETC.)

- 229 Dark grey sandy soil with a few coal flecks.
- 230 Darker grey sandy soil with coal flecks
- 231 Like 229 but with faint yellow washes
- 232 Grey brown sandy soil with yellow-brown admixture and pebble content.
- 233 More dark grey soil
- 234 Dark grey-brown sandy soil with sparse coal flecks + occasional yellow sand flecks
- 235 Yellow sand/dark grey soil admixture
- 236 Grey-black sandy soil with brown washes. Occasional coal flecks.

FEATURE

(Fairly homogeneous fill of humic soil of very dark grey-brown with blackish nodules)

Possibly a post-hole for N-S boundary fence (cf. 52 etc.)  
or ??? a pre-wall grave or ?? a "garden"  
feature

- 237 Darker than 228. Humic dark grey-brown sandy soil with blackish nodules. Occasional wood pieces.
- 238 Similar to 237 but slightly lighter and greyer / browner.
- 239 Similar to 238 but slightly lighter again.
- 240 Mixed yellow sand and dark soil.

These are latish looking features.  
At a guess the earliest they  
could be would be (18)

+247  
Layers under 246 in this feature are  
thicker and more silty.

### FEATURE(S)

241/242/243 may be part of the underlying  
feature or possibly a separate feature.

241 Dark grey to grey-black sandy soil with occasional  
coal streaks.

242 Similar to 241 but slightly lighter and grayer

243 Dark grey sandy with admixture of brown  
sandy with faint ~~thin~~ yellow streaks. Some coal  
streaks and pebbles. =

244 Grey-brown sandy soil with faint yellow  
streaks. 1 or 2 coal streaks

245 Grey-brown sandy soil heavily streaked with  
yellow sand. Few coal streaks

246 Coarse yellow sand/s-s with some admixture  
of grey-brown sandy.

247 looks grey-yellow = admixture of yellow  
sand and grey-brown sandy. 1 or 2 coal streaks.

248 Grey-black soil with brown streaks. Some coal streaks  
and brick frags.

249 Similar to 248 but with a few yellow streaks.  
No bricks.

250 Similar to 249 but lighter.

251 Blackish grey sandy soil with coal streaks.

252. like 251 but with yellow admixture.

==

Indentation in natural below 174.....

253. The nature here looks cut back from the East, and is c. 4" to 5" behind the line of the section.  
Something removed from here? See G.Y.'s notes.

==

NOTE THAT THERE IS NO 169 SURVIVING  
BETWEEN 171 AND 174.

? POSSIBLY THE PEBBLES IN 243

DERIVE FROM A REMOVED AND

REDEPOSITED 169?

==

NOTE ON SECTION ALIGNMENT.

South of 174 the three areas drawn below the arches are all in the same line N-S and in the same plane.

North of 174 the area under the arch 176 collapsed when the arch was being removed, as the material was very loose. What collapsed, GY thinks was "the same sort of stuff" as that which remains to be drawn.

After the collapse it is .....

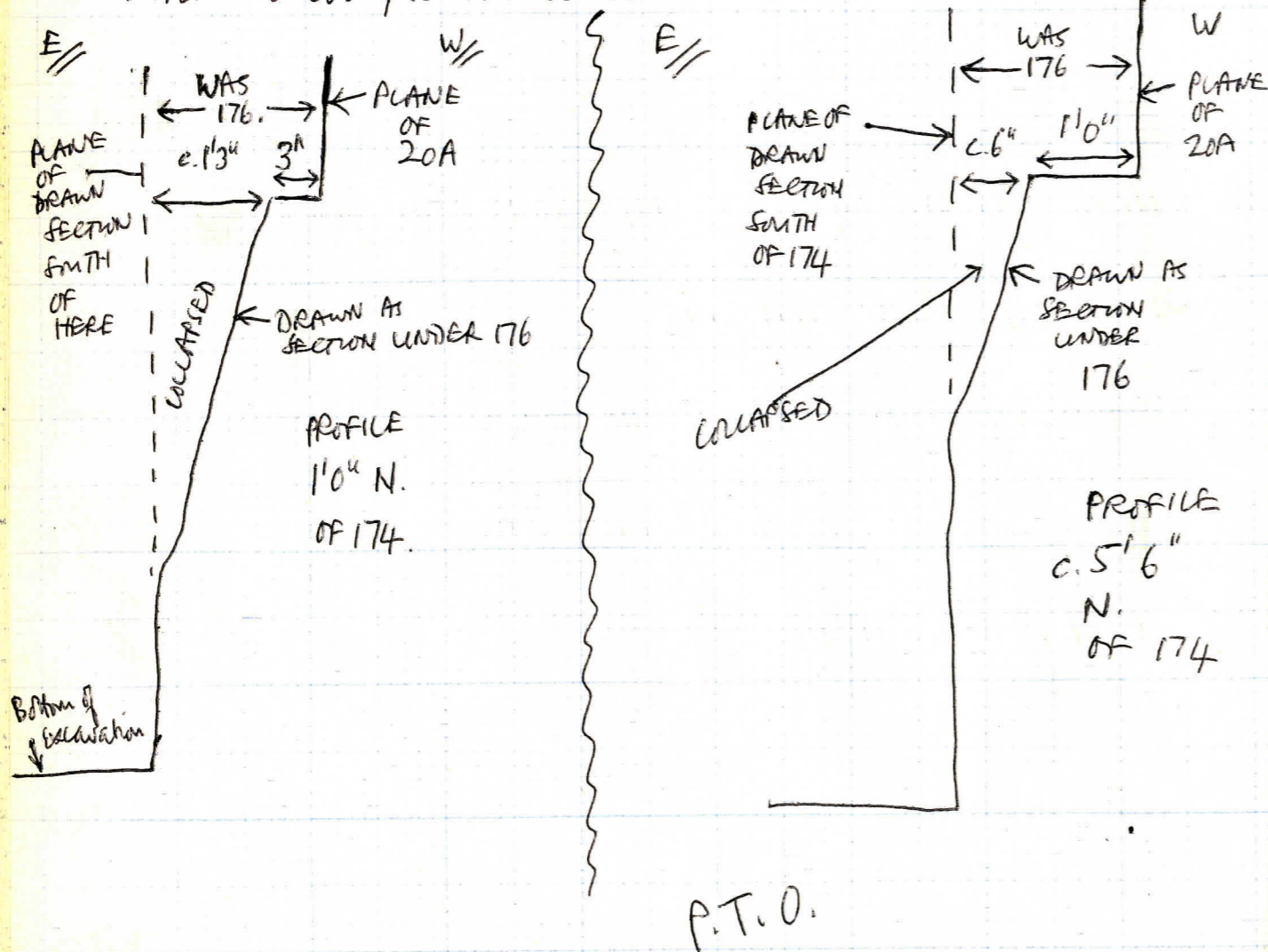

NORTH of 174 up to the 31' 6" mark.....

254 Void from removal of 174/176 ..

Construction made for 174.....

255 Black soil with lots of coal. Probably more than one layer but too little remains to establish this.

256 Layer of small bits of coal associated with construction of 176. cf. 213 and 34

Horizontal layers.....

257 Bits of coal with some soil admixture ~~THAT'S TWO LAYERS - INTERLATES JUST N. OF THIS~~

258 Dark grey-brown sandy soil with a few coal pecks ~~then the soil with brown soil admixture~~ and faint undertones of yellow sand.

259 Dark grey-brown to dark grey sandy soil with faint yellow undertones. Darker than 258.

260 Blackish grey sandy soil with brown overtones. Coal pecks.

261 Coarsely blackish grey sandy soil with brown overtones.

CONT.

c. 6' 0" N. of 174 the section is again in the same plane as that drawn South of 174, but this applies only as far N. as the next pillar (270)

N. of pillar 270 even more had collapsed so what is drawn from pillar 270 to the N.

End of the trench is almost in the same plane as 20A (i.e. practically behind the N-S churchyard wall.)

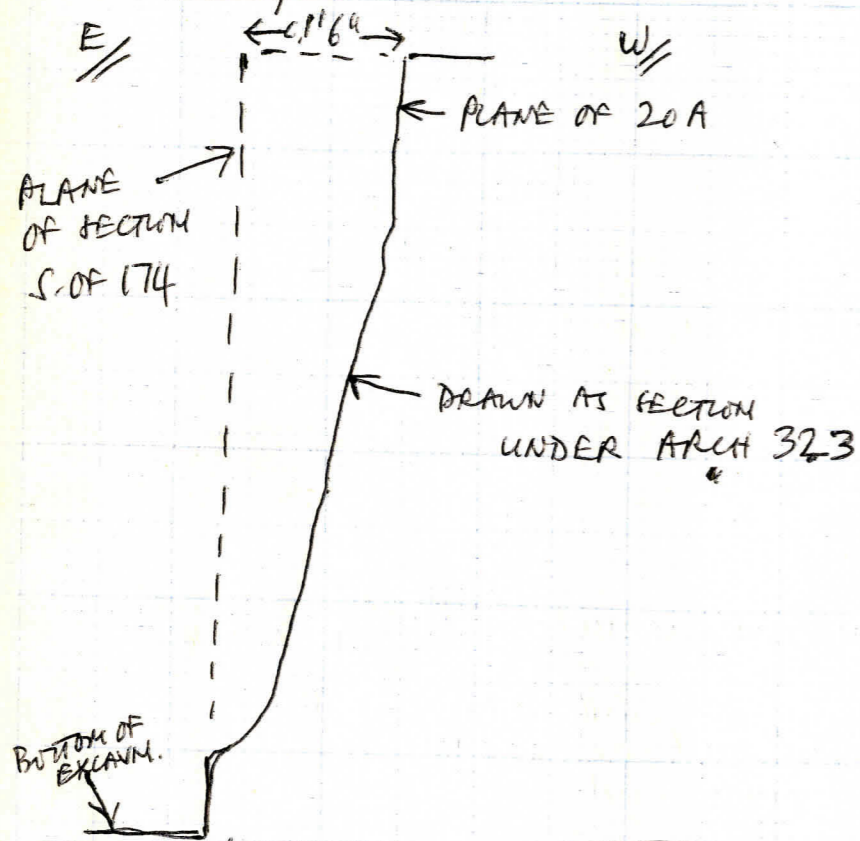

SKETCH PROFILE  
MIDWAY BETWEEN  
THE TWO  
NORTHERN MOST  
PILLARS

270  
AND  
325

N.B. Looks worked along the top of 266.

262 Grey-brown to brown sandy soil with sparse coal pieces and faint yellow washes. One brick fragment.

FEATURE

Possibly posthole for N-S boundary fence, or garden fence, or ??? pre-wall grave (cf. 237 etc.) (Humic dark filling)

263 Dark grey sandy soil with brown washes, 1 or 2 coal pieces. Not very distinct from 262.

264 Similar to 263 but a bit lighter.

265 Similar to 264 but a bit lighter, plus faint yellow washes.

Horizontal layer...

266 Light brown-grey to medium brown-grey very sandy soil. Some small pieces of coal (too hard to be charcoal). Admixture of yellowy brown sand.



? NATURAL

267. Almost certainly natural but not disturbed  
(presumably leveling + cultivation above this).  
Rotten and softened, but basically hard  
pale fawn sand typical of some of the  
upper levels in B.P. beds.  
Feels like nat. + doesn't look redeposited  
at all.

POSSIBLY = 169 (NATURAL)

- 268 Natural pebble stratum — possibly = 169.

269 NATURAL.

Sandy rock with orange strata.

## EXAMINATION OF THE NATURALS

The bedding planes in the natural here are so odd that I've cleaned up the natural and drawn them in on the section.

The harder orange striations seem to indicate the bedding planes so there have been drawn — those which show major changes in slope drawn in orange outlined in pencil (measured in) and those in between drawn in orange only (by eye).

It can be seen there are other slopes/horizontals which may illuminate whether or not the pebbles 169 indicate a slope in natural from N to S — it is possible that it does not !! (in view of the other peculiarities)

SEE THE SECTION DRAWING.

---

NB. It's possible there was a C.T. on the N. side of 270. The natural as drawn is a projection

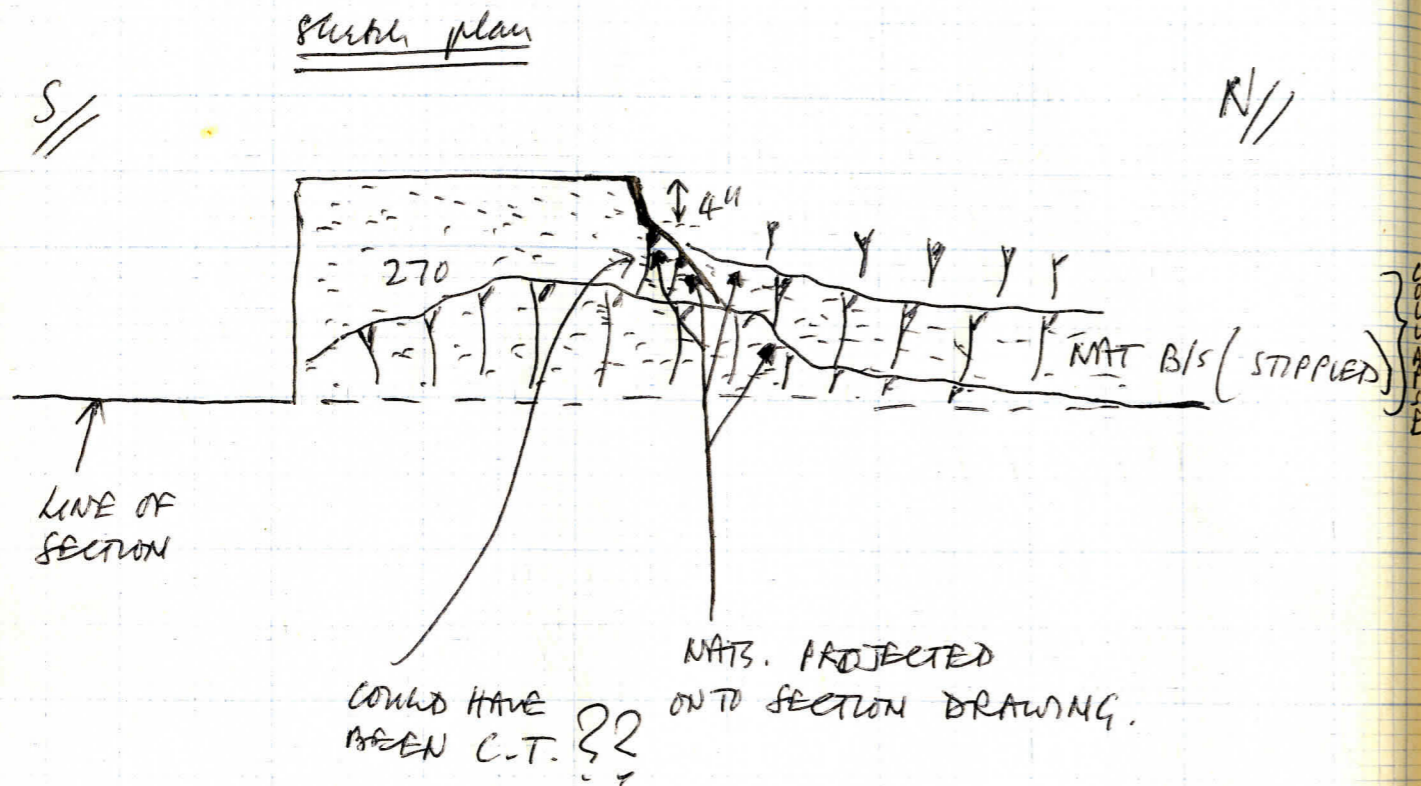

NOTE THAT FROM 270 TO 325 STRAT. HAD TO BE PROJECTED ON TO SECTION + IS REALLY IN SAME PLANE AS 20A (ALMOST)

MAIN FIRST WEST SECTION  
FROM 31' 6" TO PILLAR 270 (@ 39' 0")

270. Brick pillar of churchyard wall (Really this is void as pillar has been removed - restored here from GY's notes)

Construction North of 270

- 271 Grey-black soil with bits of coal.
- 272 Looks yellow grey = grey-black soil with bits of coal and bits and bricks of yellow lts.
- 273 Grey-black soil with a few coal bricks. Some chips of brick and 2 bits of white mortar.
- 274 Grey to grey-black soil with a few coal bricks.
- 275 Dark grey soil with sparse coal bricks and a few bricks of brick and yellow lts.
- 276 Dark grey soil with yellow lts bricks and a few bricks of coal.
- 277 Mixed yellow lts + grey-black soil with occasional coal + white mortar bricks.
- 278 Mixed like 277 but containing large brick frags + lumps of white mortar.

Very late feature — ? post-hole or s.th. else

- 279 Humic sticky black soil with sparse coal nodules.
- 280 Similar to 279 but more greyish.
- 281 Dark grey sandy soil sparsely marked with yellow + bits of coal. Blackish soil nodules.
- 282 Yellow grey sandy soil = mixed grey-black + yellow bits with sparse coal nodules. 1 bit of brick
- 283 Very dark grey sandy soil with yellow nodules.
- 284 Grey-black soil with small coal-nodules and faint yellow nodules.
- 285 Yellow bits with some grey-black soil admixture.
- 286 Looks yellowish-grey with blackish nodules = dark grey sandy with yellow sand admixture, bits of coal + blackish soil + 1 bit of brick
- 287 Grey black soil with bits of coal. Some faint yellow marking.
- 288 Grey black soil a bit lighter than 287 + with more yellow nodules.

==  
"Horizontal" layers

- 289 Bits of coal with some soil admixture.
- 290 Dark grey sandy soil with yellow nodules + black soil nodules.

- 291 Bits of coal with some dark soil admixture. A few bits of brick.
- 292 Coarse yellow sand with an admixture of grey sandy. A few small coal streaks.

---

Feature

- 293 Dark grey to black (ish) sandy soil with a few coal streaks.
- 294 Similar to 293 but a little lighter + greyer.
- 295 Like 293 — darker than 294.
- 296 Dark brown-grey sand to sandy with coal streaks + a coal lump.
- 297 Lots of bits of coal in dark grey sandy with brown warts.

---

"Horizontal" layers (all very "mucky")

- 298 Humic grey-black soil. Some light sand streaks make it lighter than 279. Few small coal streaks.
- 299 Similar to 298 but a bit lighter in colour.

- 300 Bits of coal in dark soil.
- 301 Bits of coal in dark soil with yellow + brown sand streaks. More soil than 300.
- 302 Grey-brown sandy soil with yellow sand streaks and sparse bits/streaks of coal.
- 303 Dark grey with brown streaks = dark grey to black humic soil with an admixture of brown sandy). Sparse coal.
- 304 Darker than 303 = grey-black soil with faint streaks of brown sand. A few coal streaks.
- 305 Sandier + browner than 304 = dark grey-brown to brown very sandy soil. A few small coal streaks. Clay pipe-stem frag. R(72)
- 306 Dense layer of bits of coal in black coal dust.
- 307 Brown sand to sandy with dark grey streaks. 1 or 2 streaks of coal.
- 308 Bits of coal in dark grey to black soil.
- 309 Brown sandy to sandy with dark grey streaks (from dense streaking of dark grey? humic soil). A few coal streaks.
- 310 Grey-brown sand to sandy a bit darker than 317.

---

Feature (looks v. late)

- 311 Mucky dark grey-brown sand with dark grey soil streaks + ~~lenticles~~ some small coal streaks.
- 312 Coarse yellow sand from lfs

317 looks relatively latish.  
Probably post-med plus.  
Seems a little humic.

Natural 318 is probably 3 strata .....

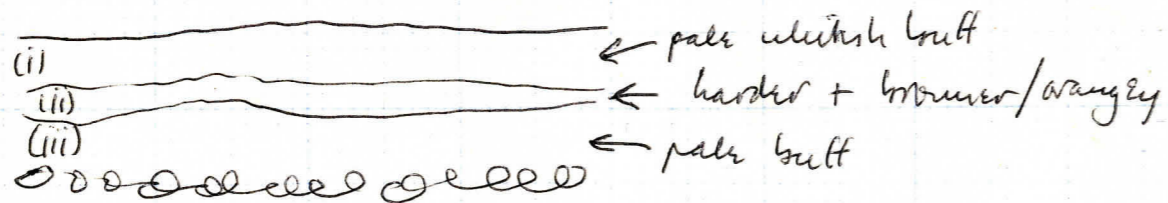

cf. 403/404/405 further N.

313 like 311

314 yellow sand from top, densely packed, with small streaks + streaks of grey soil.

315 grey to grey-brown very sandy soil. A few pebbles.

316 like 314.

"Horizontal" layer

317 light brown to grey sand to sandy mainly packed with small blobs of fawn sand. Some small pieces of ch. a. ? slightly humic (could be veg. or nat.)

NATURAL

318 Overall pale fawn/loess like dense compact sand. Very rooted + wormed. Possibly 3 "layers" in 318 — see opposite.  YES — CHECKED + DRAWN

319 Possible stratum probably = 268

SECTION FROM 39' 0" TO 48' 6"  
EXCLUDING LATE FEATURE OVER PILLAR

~~320~~ Drain construction trench

320 Bracke soil, some bits of brick + white mortar.

321 Ceramic drain pipe.

322 Bracke soil with brick rubble + lumps of white mortar.



323 Archway [restored]

324 Wall [restored]

325 Pillar still in situ

} N-S  
COURTYARD  
WALL  
CONT.



Grave

- 326 Black soil with yellow loess streaks + coal streaks.  
white mortar streaks
- 327 Black soil, white mortar streaks.
- 328 Loos grey-black soil with yellow sand streaks.
- 329 Mixed yellow sand + black soil with coal streaks.
- 330 Black soil, faint yellow streaks + coal streaks.  
Some white mortar streaks.
- 331 Similar to 330.
- 332 Brown-black soil mixed ~~with~~ with yellowish-brown  
sand.
- 333 Black soil with coal streaks + white mortar  
streaks.
- 334 Yellow sand / black soil admixture. Yellower  
than 335.
- 335 Black soil streaked with yellow sand.
- 336 Black soil with a few coal streaks.
- 337 Black soil streaked with yellow sand.
- 338 Black soil with a few coal streaks.

\* The top of this St. comes to within 9" of the  
E. face of the brick pillar 325.  
It has been to some extent inserted inside the  
pillar from the W. side, removing any pillar  
C.T. in the process.  
Must be later than the churchyard wall.

339 Black soil with a few coal-licks and faint  
traces of yellow sand.

340 yellow sand / grey-black soil admixture.

341 Coarse yellow sand from lps, packed with black  
soil, 1 lump of brick.

342 Skeleton (ker)  
See opposite \*

343 Black soil.

---

Grave (Similar overall appearance to 326 etc,  
i.e. nearly all black with occasional yellowy)

344 Humic black soil packed with white mortar.

345 Grey-black soil packed with coal + yellow sand.  
Few lumps of white mortar.

346 Mixed grey-black / yellow

347 Coarse yellow sand with some dark soil admixture.

348 Grey-black soil faintly packed with yellow sand,  
coal, + white mortar.

349 Grey-black soil with blobs of yellow sand / lps —  
some coal lumps

350 Grey-black soil with faint lumps of yellow sand,  
coal, + white mortar.

- 351 Yellower than 350 = gray black soil with coal  
pecks, white mortar pecks, + occasional blobs of yellow sand.
- 352 Looks yellowy dark gray = dark gray to black soil, pecked  
with yellow sand; blobs of yellow + white mortar + coal pecks.
- 353 Black soil pecked with coal + white mortar.

354 like 352 but a bit yellower.

355 Scarlet — feet just showing, c. 1'0" back from  
plane of section, so at least partially inserted  
under the wall.

356 Gray-black soil with faint yellow weathering.  
1 or 2 white mortar pecks + brick frags.

---

Grave? (overall looks similar to 344 etc but  
weaker + less yellowy). <No SK. visible.

357 Gray-black lumpy soil with faint yellow pecks.  
Some coal pecks.

358 Similar to 357 but a bit lighter + greyer.

359 Black soil, coal pecks.

360 Big blobs of yellow lumps in black soil.  
Coal pecks.

361 Gray-black soil with yellow weathering. Some  
coal pecks.

362 Darker than 361 but very similar.

This grave 365 etc. is visible behind 270 cutting through another grave which cuts through C-T. layers.

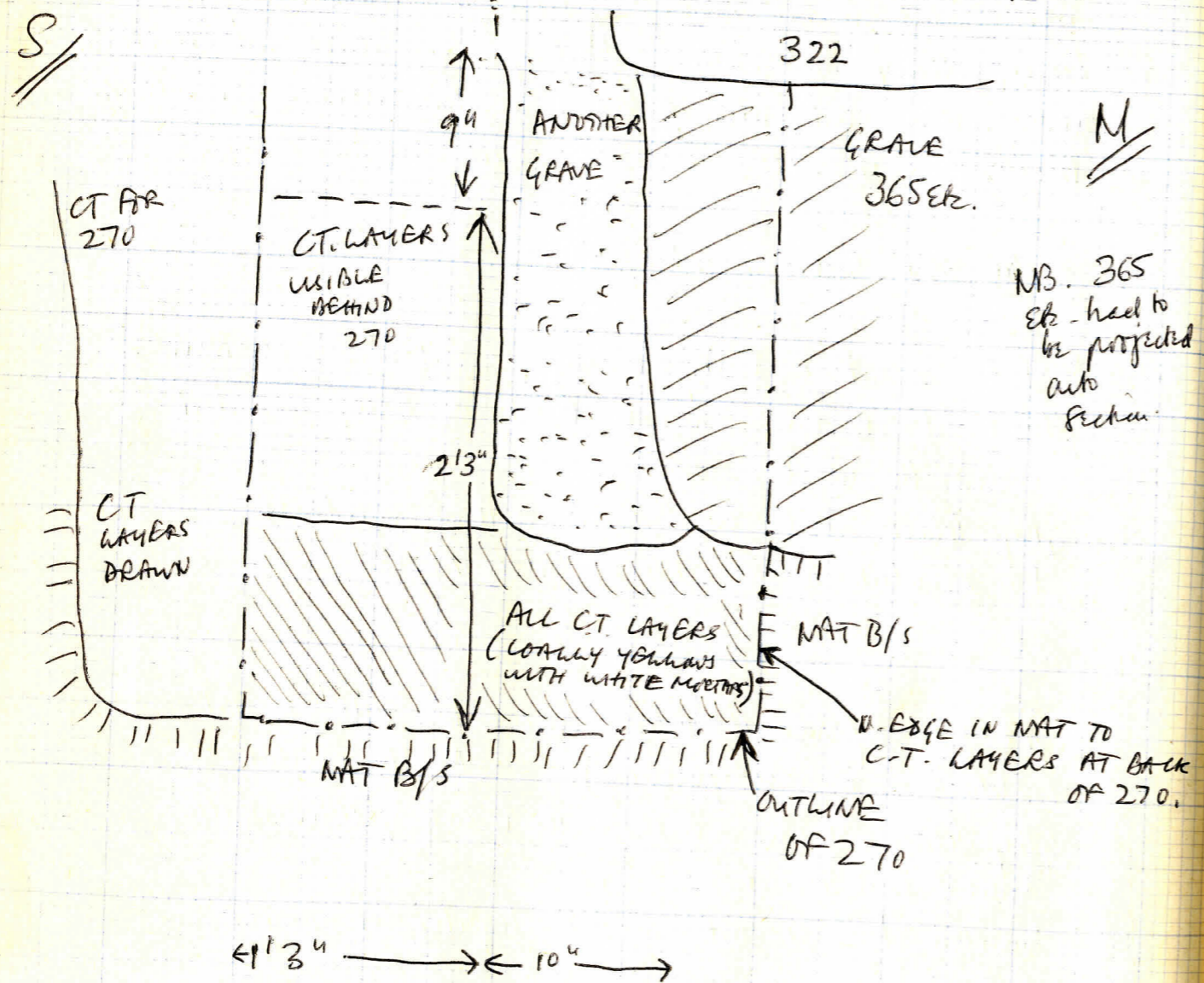

NB. 365 etc. had to be projected into section.

Sketch of strat visible behind 270. C-T. layers followed round from those drawn in section.

363 Mixed black soil + yellow sand. 1 or 2 coal pieces.

364 Black soil with some coal - pieces + yellow weathers.

Grave? (Similar to 357 etc. overall, but yellow) < No SK. visible

365 Grey-black soil with coal pieces + yellow sand pieces.

366 Grey-black soil with large blobs of yellow sand. Sparse coal pieces.

367 Grey-black soil with faint yellow sand pieces + coal pieces.

368 Grey-black soil with faint yellow sand pieces + coal pieces - less yellow than 367

369 Mixed black soil + yellow sand with coal pieces.

370 Black soil with faint yellow pieces. Some iron visible c. 1'3" back from plane of section - so? coffin. (projects 5" E. from back of 270)

"Horizontal" layers 371 to 377 all look very yellowy.

371 Grey-black soil mottled with yellow sand + coal.

372 Looks grey/yellow = admixture of grey sandy and yellow sand, mottled with coal + yellow lfs

- 373 Similar to 372 but slightly darker and greyer.
- 374 Lots of bits of coal in grey sandy soil fairly  
 mixed with yellow sand.
- 375 Similar to 373 but also containing a few bits  
 of brick, and slightly more grey sandy.
- 376 Grey sandy soil mixed with yellow sand and  
 coal.
- 377 Coarse yellow sand/b/s with slight admixture of  
 grey sandy soil. Some coal pieces.

=

Feature (Looks very late)

- 378 Dark grey-brown sandy soil mixed with black soil  
 and a few small coal pieces.
- 379 Grey to grey-black sandy soil with 1 or 2 coal  
 pieces.
- 380 Grey sandy soil with an admixture of yellow sand  
 and a few coal pieces.
- 381 Lots of bits of coal with a slight admixture of  
 grey sandy soil.
- 382 Medium brown-grey very sandy soil with  
 a few coal pieces.

=

Feature (Looks very late)

- 383 Grey to grey-black sandy soil with a few  
 coal pieces.

384 Gray to brown v. sandy soil with an admixture of fine yellow sand. 1 small brick frag.

385 Gray-black sandy soil with a few coal nodules.

386 Similar to 385 but a bit lighter and greyer.

387 Strata of yellow sand.

388 Gray to grey-black sandy soil with a few nodules of coal.

389 Similar to 388

390 Loose grey to grey black sandy soil containing a large rotted iron obj.

391 Gray to grey black sandy soil with some coal nodules and some white mortar nodules.

"Horizontal" layers

392 Mixed buff sand from { These look very late — overall brownish grey mat. lts and dark grey sandy soil. Coal nodules.

393 Gray to grey-brown sandy soil with coal nodules.

394 A bit browner than 393 = Gray-brown sandy soil with coal nodules.

395 A bit browner than 394 = brown-grey very sandy soil with a few coal nodules.

396 Like 394 but a bit greyer.

397 Gray brown sandy soil a bit browner than 396. A few coal nodules and 1 frag. of tile or brick.

398 Lots of bits of coal with admixture of grey-brown sandy soil.

399 Slightly humic medium brown-grey very sandy soil with some coal nodules and buff sand streaks.

Feature < Very brown + sandy - possibly medieval, but <sup>more likely post-med.</sup>

400 Light to medium brown-grey very sandy soil with sparse streaks of charcoal.

401 Similar to 400 but more greyish + slightly more silty.

402 Like 400 but with occasional streaks of yellow sand.

NATURAL

403 Dense pale buff sand (upper levels of G/S).  
Root disturbed.

404 Harder pale buff-orange stratum.

405 Like 403 but even paler. No root disturbance.

406 Pebble stratum - continued, but less dense than heretofore. More a scatter of single pebbles.

= 319 continued.

NOTE ON LATE FEATURE (WITH 410 etc.)

G.Y.'s notebook shows this rubble/plastery material extending to the N. end of the trench.

Assuming what G.Y. has drawn is this material, and not another similar which has been fully removed, then this shift must run obliquely to the section.

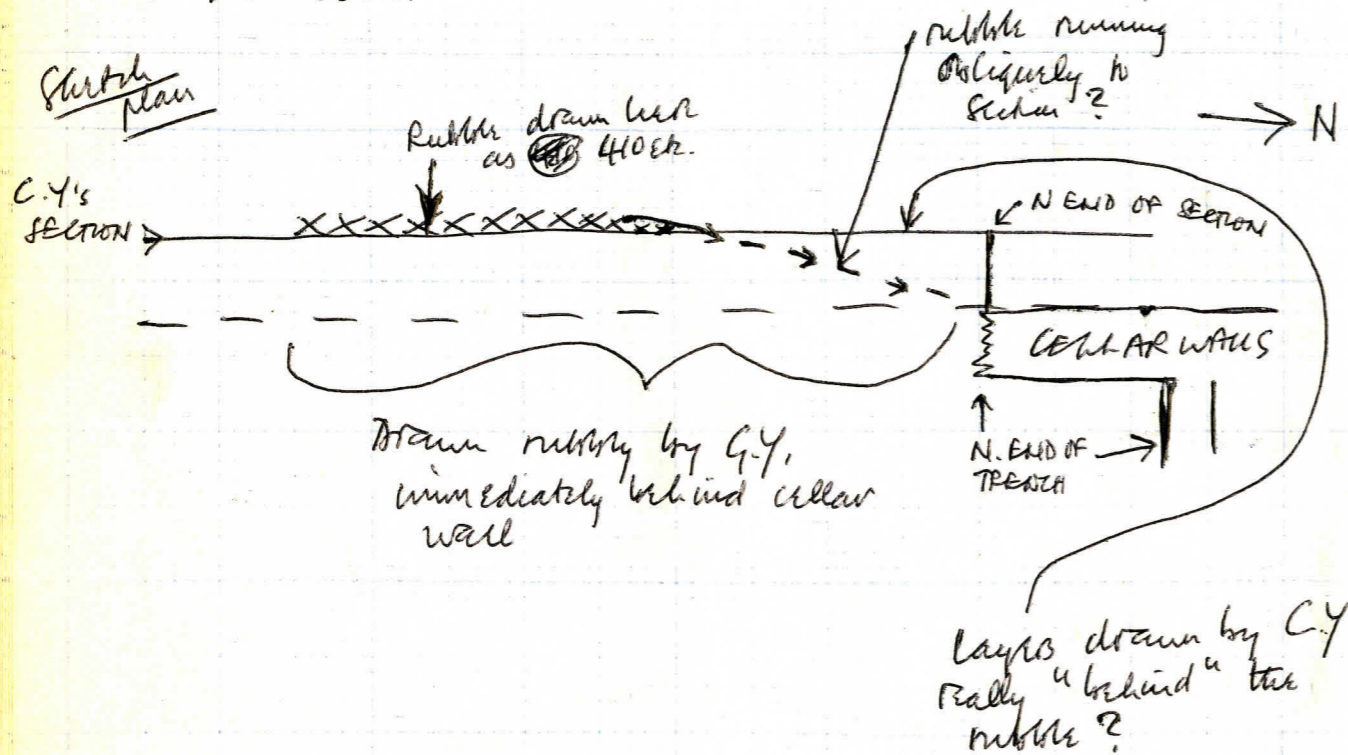

Could this rubble shift be associated with the cellars or the demolition of them? (Wall plaster in it.)

{ Or with churchyard wall, destruction of?  
{ (It so, also back-packed with soils!)

SECTION FROM 48' 6" TO N. END OF TRENCH

Soils over late feature (? dumping when making car-park) ...

407 Humic black soil with occasional pecks of yellow sand. Coal pecks + brick bits.

408 Black soil

409 Humic black soil lightly mixed with yellow sand. Coal pecks, white mortar pecks, a few brick frags.

Modern Feature (see note opposite)

410 Humic black soil lightly mixed with yellow sand. Greyer than 409. Brick, coal, + white mortar pecks.

411 Grey-black soil with lumps, streaks, + lenses of coarse yellow sand from top. White plaster frags.

412 Mostly bits of yellow-white plaster (1 smooth face) with some admixture of grey-black soil. Some small brick frags.

413 Grey-black soil mixed with coarse yellow sand. Brick frag, some pecks of coal + white plaster.

414 Admixture of small bits of coal, coarse yellow sand, grey sandy soil. Some small brick frags.