



KDK ARCHAEOLOGY LTD

## Archaeological Summary Report

Land at and adjacent to 10 High Road  
Broom  
Bedfordshire



### Quality Check

<i>Author</i>	Caroline Barclay Jones MA	<i>Version</i>	123/BHR/2	<i>Date</i>	25 <sup>th</sup> June 2015
<i>Editor</i>	Karin Kaye MA MCIfA	<i>Version</i>		<i>Date</i>	3 <sup>rd</sup> July 2015
<i>Revision</i>		<i>Version</i>		<i>Date</i>	

© KDK Archaeology Ltd. 2015 No part of this document is to be copied in any way without prior written consent.

Every effort has been made to provide as complete and as accurate a report as possible. However, KDK Archaeology Ltd cannot accept any liability in respect of, or resulting from, errors, inaccuracies, or omissions contained in this document.

© Ordnance Survey maps reproduced with the sanction of the Controller of Her Majesty's Stationery Office.  
KDK Archaeology Licence No. 100053538

7b High Street Mews Leighton Buzzard Bedfordshire LU7 1EA

Tel: 01525 385443

Email: [office@kdkarchaeology.co.uk](mailto:office@kdkarchaeology.co.uk)

Website: [www.kdkarchaeology.co.uk](http://www.kdkarchaeology.co.uk)





**CONTENTS**

Summary.....4

1. Introduction .....4

2. Results.....7

3. Conclusions .....9

4. Acknowledgements.....10

**Appendices:**

1. OASIS and Site Data.....11

**Figures:**

1. General location .....3

2. Site location .....5

3. Trench location .....6

**Plates:**

1. Trench 1, facing south-west.....8

2. Trench 2, facing north-west.....8

3. Site stratigraphy.....8

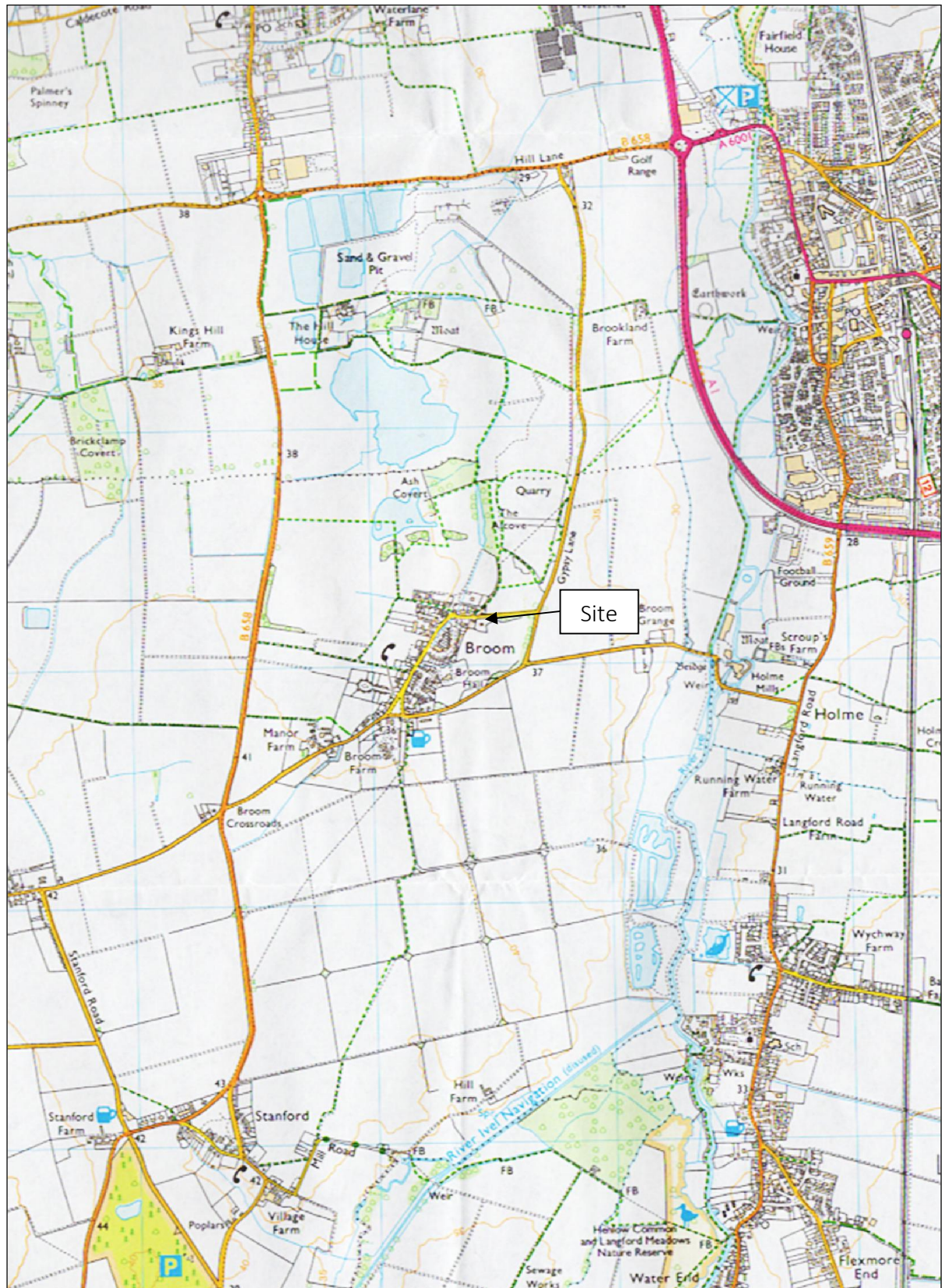

Figure 1: General location (scale 1:25,000)



---

## Summary

In June 2015 KDK Archaeology Ltd undertook a programme of evaluation at land at, and adjacent to, 10 High Road, Broom, Bedfordshire. The work was undertaken in advance of the planned construction of two detached dwellings with double integral garages, and the creation of a new vehicular access. The site is located within a landscape which has evidence of occupation from later prehistoric times onwards, as evidenced by extensive cropmarks in the adjacent field, as well as being within the postulated environs of the medieval settlement of Broom. As a result it was considered that there was potential for later prehistoric remains within the development area, and possibly Saxon, medieval and post-medieval deposits.

Two trenches were excavated in the footprints of the proposed buildings, but no archaeological finds or features were discovered.

## 1 Introduction

1.1 In June 2015 KDK Archaeology Ltd undertook a programme of evaluation at land at, and adjacent to, 10 High Road, Broom, Bedfordshire. The project was commissioned by Mrs Jean Collins, and was carried out according to a Written Scheme of Investigation prepared by KDK Archaeology Ltd (C Barclay Jones 2015), and approved by Hannah Firth, archaeological advisor (AA) to the local planning authority (LPA), Central Bedfordshire Council. The relevant planning application references are APP/P0240/A/13/2205283 and CB/13/00682/FULL.

### 1.2 *Planning Background*

This project has been required under the terms of National Planning Policy Framework (NPPF) as a condition of planning permission for the development of the site.

### 1.3 *The Site*

#### *Location & Description*

The site lies at the eastern end of High Road, which is at the northern-most end of the village of Broom, in the civil parish of Southill and administrative district of Central Bedfordshire. The site is centred on National Grid Reference TL 17501 24187 (Fig. 1).

The development area is bounded to the north by High Road and to the south by open fields. The boundary to the west is formed by the adjoining property and to the east by dense vegetation (Fig. 2). The site is part of the former garden of number 10 High Road, and contains a number of mature trees on the site, some of which alongside High Road are protected by a Tree Protection Order.

#### *Geology & Topography*

The site is on a slight east-west slope, and lies at a height of approximately 35m OAD. The sedimentary deposits of the site are sand and gravel, overlying mudstone bedrock of the Stewartby Member and Weymouth Member (<http://mapapps.bgs.ac.uk>).

#### *Development*

The development comprises the construction of two detached dwellings with double integral garages, and the creation of a new vehicular access (Fig. 3).

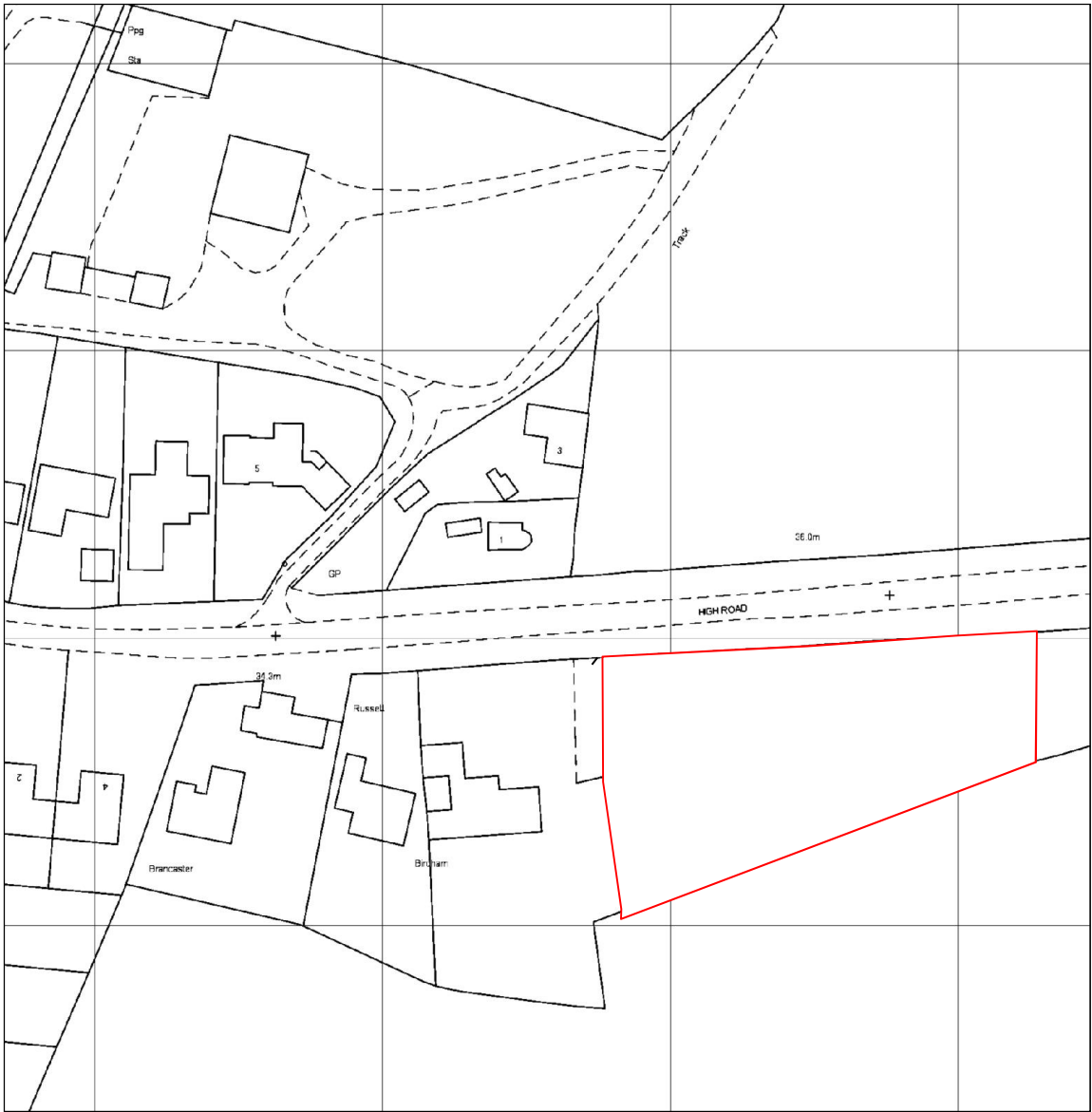

Figure 2: Site location (scale 1:1250)



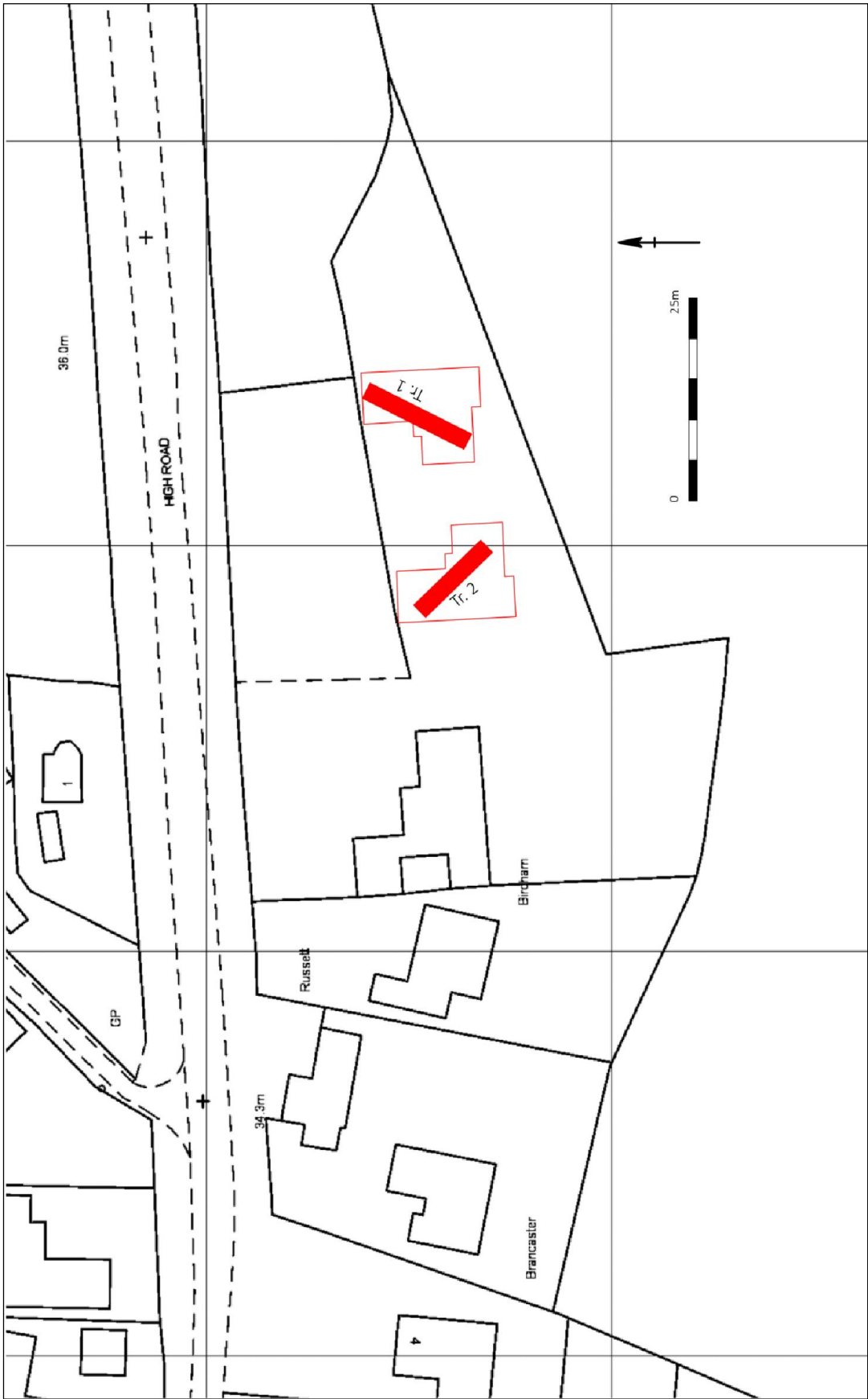

Figure 3: Trench location (scale 1: 1250)



## 2 Results

Two trenches were located within the footprints of the proposed development, and were excavated with a mechanical tracked excavator fitted with a toothless ditching bucket.

### ***Trench 1*** (Fig. 3; Plates 1)

Trench 1 was orientated NNE-SSW and measured 14m long, 2.10m wide and 0.52m max deep. The trench stratigraphy comprised:

0.15m of Topsoil

0.2m of Sub-soil: mid brown silty sand

0.1m of Natural: orange/brown gravelly sand

There were occasional patches of gravel and shingle, particularly at the NNE end of the trench.

The trench contained no archaeological finds, features or deposits.

### ***Trench 2*** (Fig. 3; Plates 2)

Trench 2 was orientated NNW-SSE and measured 11.5m long, 2.1m wide and 0.5m deep. The trench stratigraphy comprised:

0.2m of Topsoil

0.2m of Subsoil: mid brown silty sand

0.1m of Natural: as Trench 1

The trench contained no archaeological finds, features or deposits.





**Plate 1:** Trench 1, facing south-west



**Plate 2:** Trench 2, facing north-west



**Plate 3:** Site stratigraphy



---

### 3 Conclusions

Neither trench contained any archaeological features, deposits or artefacts. This may have been because the sample size was small and each trench fell between what may be widely dispersed features, or that the development area is located beyond that which has been historically occupied.



---

## 4 Acknowledgements

KDK Archaeology is grateful to Jean Collins for commissioning this work. Thanks are also due to Stephen Coleman of Central Bedfordshire and Luton Historic Environment Record for providing historic environment records and other relevant documents and to Hannah Firth of Central Bedfordshire Archaeological Team for monitoring the project.

KDK Archaeology is also grateful to Wilsons of Wallington for providing and driving the machine.

The fieldwork was carried out by David Kaye BA ACIfA and Karin Kaye MA MCIIfA. The report was written by Caroline Barclay Jones MA and edited by Karin Kaye MCIIfA.



## Appendix 1: OASIS and Site Data

PROJECT DETAILS			
<b>Project Name &amp; Address</b>	Land at and adjacent to 10 High Road, Broom, Bedfordshire	<b>Project Site Code</b>	123/BHR
<b>OASIS reference</b>	kdkarcha1-206269	<b>Event/Accession no</b>	BEDFM 2015.33
<b>OS reference</b>	TL 17501 24187	<b>Study area size</b>	2,200 sq m
<b>Project Type</b>	Evaluation	<b>Height (mAOD)</b>	35
<b>Short Description</b>	In June 2015 KDK Archaeology Ltd undertook a programme of evaluation at land at, and adjacent to, 10 High Road, Broom, Bedfordshire. The work was undertaken in advance of the planned construction of two detached dwellings with double integral garages, and the creation of a new vehicular access. The site is located within a landscape which has evidence of occupation from later prehistoric times onwards, as evidenced by extensive cropmarks in the adjacent field, as well as being within the postulated environs of the medieval settlement of Broom. As a result it was considered that there was potential for later prehistoric remains within the development area, and possibly Saxon, medieval and post-medieval deposits. Two trenches were excavated in the footprints of the proposed buildings, but no archaeological finds or features were discovered.		
<b>Previous work</b>	None	<b>Site status</b>	None
<b>Current land use</b>	Garden/unused ground	<b>Planning proposal</b>	Construction of two detached houses with integral double garages
<b>Local Planning Authority</b>	Central Bedfordshire Council	<b>Planning application ref.</b>	CB/13/00682/FULL APP/P0240/A/13/2205 283
<b>Monument type</b>	None	<b>Monument period</b>	None
<b>Significant finds</b>	None	<b>Future work</b>	None
PROJECT CREATORS			
<b>Organisation</b>	KDK Archaeology Ltd		
<b>Project Brief originator</b>	Central Bedfordshire Council	<b>Project Design originator</b>	Caroline Barclay Jones
<b>Project Manager</b>	David Kaye	<b>Director/Supervisor</b>	David Kaye
<b>Sponsor/funding body</b>	Jean Collins		
PROJECT DATE			
<b>Start date</b>	22.06.15	<b>End date</b>	22.06.15
PROJECT ARCHIVES			
	<b>Location</b>	<b>Content (eg. pottery, animal bone, files/sheets)</b>	
<b>Physical</b>	Bedford Museum	-	
<b>Paper</b>		Archive box	
<b>Digital</b>		CD with all digital files	
BIBLIOGRAPHY (Journal/monograph, published or forthcoming, or unpublished client report)			
<b>Title</b>	Archaeological Summary Report: Land at and adjacent to 10 High Road, Broom, Bedfordshire		
<b>Serial title &amp; volume</b>	KDK/123/BHR/2		
<b>Author(s)</b>	C Barclay Jones		
<b>Page nos</b>	11	<b>Date</b>	30.06.15