



**Trial trench evaluation on land at
Tidbury Green Farm
Solihull
November 2016**

Report No. 16/207

Author: Sam Egan

Illustrator: Olly Dindol



**Trial Trench Evaluation on land at
Tidbury Green Farm
Solihull
November 2016**

Report No. 16/207
Accession code: TGFS16

Quality control and sign off:

Issue No.	Date approved:	Checked by:	Verified by:	Approved by:	Reason for Issue:
1	08/12/2016	A Yates	R Atkins	M Holmes	Draft
2	15/02/2017	A Yates	R Atkins	M Holmes	Final

Author: Sam Egan
Illustrators: Olly Dindol

© MOLA Northampton 2016

MOLA
Bolton House
Wootton Hall Park
Northampton
NN4 8BN
01604 700 493
www.mola.org.uk
sparry@mola.org.uk

STAFF

Project Manager: Adam Yates BA MCifA
Text: Sam Egan BSc
Illustration: Olly Dindol BA
Fieldwork: Sam Egan
David Haynes

OASIS REPORT FORM

PROJECT DETAILS		OASIS No: molanort1-270415	
Project name	Trial trench evaluation on land at Tidbury Green Farm, Solihull, November 2016		
MOLA Northampton was commissioned by Lanpro Services Ltd on behalf of Bellway Homes Ltd to carry out an archaeological trial trench evaluation on land at Tidbury Green farm, Solihull as a condition on planning consent. Forty-two (42) trenches were excavated. No archaeological remains were present.			
Project type	Evaluation		
Site status	None		
Previous work	Geophysical survey (Stratascan 2016); Desk Based Assessment (Waterman 2013)		
Current Land use	Arable farmland and grassland		
Future work	Unknown		
Monument type/ period	N/A		
Significant finds	None		
PROJECT LOCATION			
County	West Midlands		
Site address (including postcode)	Tidbury Green Farm, Solihull		
Study area (sq.m or ha)	c14 ha		
OS Easting & Northing (use grid sq. letter code)	SP 102 755		
Height OD	149m- 153m aOD		
PROJECT CREATORS			
Organisation	MOLA (Museum of London Archaeology)		
Project brief originator	Warwickshire County Council Planning Officer		
Project Design originator	Lanpro Services Ltd		
Director/Supervisor	S Egan		
Project Manager	A Yates		
Sponsor or funding body	Bellway Homes Ltd		
PROJECT DATE			
07/11/16- 17/11/16			
ARCHIVES	Location (Accession no.)	Content	
Physical	TGFS16	None	
Paper		Site documents – context sheets et al	
Digital		Mapinfo plans, word report, dxf data, digital photographs	
BIBLIOGRAPHY			
Journal/monograph, published or forthcoming, or unpublished client report (MOLA report)			
Title	Trial trench evaluation on land at Tidbury Green Farm, Solihull, November 2016		
Serial title & volume	16/207		
Author(s)	S Egan		
Page numbers	29		
Date	15/02/17		

Contents

1	INTRODUCTION	
2	AIMS AND OBJECTIVES	
3	BACKGROUND	
	3.1	Topography and geology
	3.2	Historical and archaeological background
4	EXCAVATION METHODOLOGY	
5	THE EXCAVATED EVIDENCE	
	5.1	General stratigraphy
	5.2	Results
	6	DISCUSSION
		BIBLIOGRAPHY
		APPENDIX: CONTEXT INVENTORY

Figures

- Fig 1 Site location
- Fig 2: Trench locations
- Fig 3 Representative section, Trench 13 looking south
- Fig 4 Trench 6 looking west

Trial trench evaluation on land at Tidbury Green Farm Solihull November 2016

Abstract

MOLA Northampton was commissioned by Lanpro Services Ltd on behalf of Bellway Homes Ltd to carry out an archaeological trial trench evaluation on land at Tidbury Green farm, Solihull as a condition on planning consent. Forty-two (42) trenches were excavated. No archaeological remains were present.

1 INTRODUCTION

MOLA (Museum of London Archaeology) were commissioned by Lanpro Services Ltd on behalf of Bellway Homes Ltd to conduct an archaeological evaluation on land at Tidbury Green Farm, Solihull (NGR: SP 102 755) (Fig 1). This followed on from desk-based assessment and geophysical survey. The Planning Archaeologist for Warwickshire County Council, who acts as advisor to Solihull Metropolitan Borough Council advised that a programme of archaeological evaluation should be undertaken as a condition on planning consent to allow the formation of a full mitigation strategy. The requirements were outlined in a Written Scheme of Investigation (WSI) prepared by Lanpro Services Ltd (Gajos 2016).

2 AIMS AND OBJECTIVES

The evaluation of the site was designed to assess the archaeological potential of the site.

The general aims of the investigation of the site were to:

- To determine the location, extent, date, character, condition, significance and quality of any archaeological remains within the development site
- To assess vulnerability/sensitivity of any exposed remains
- To assess the impact of previous land use on site
- To assess the potential for survival of environmental evidence
- To inform a strategy to avoid or mitigate impacts of the proposed development on surviving archaeological remains
- To produce a site archive for deposition with an appropriate museum and to provide information for accession to the Solihull HER

The evaluation was carried out following the guidelines suggested by the CifA's *Standards and guidance for archaeological field evaluations* (CifA 2014), the MOLA fieldwork manual (2014) and the West Midlands regional framework (Watt 2011). Works were carried out in accordance with the National Planning Policy Framework (NPPF, DCLG 2012.)

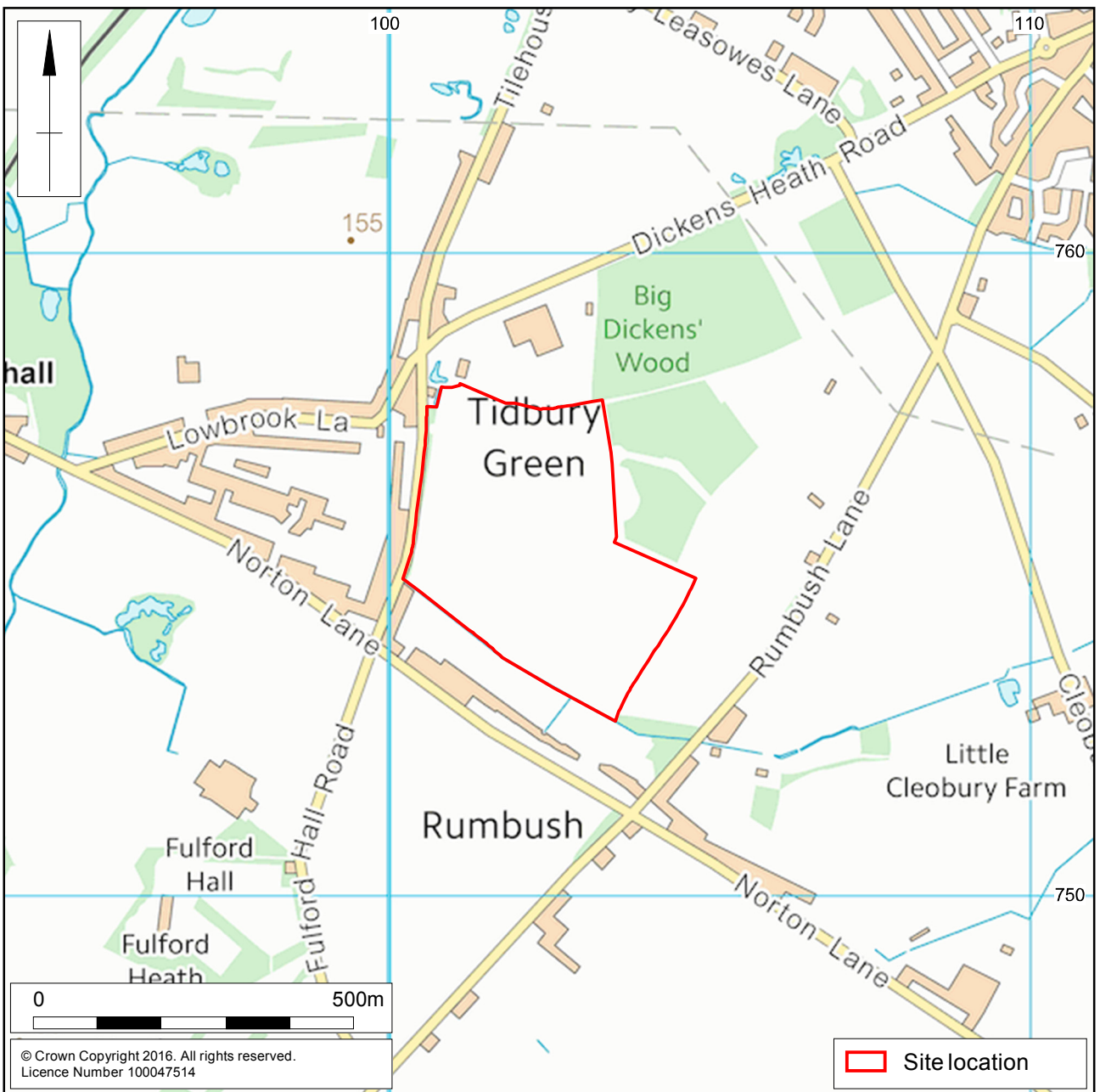
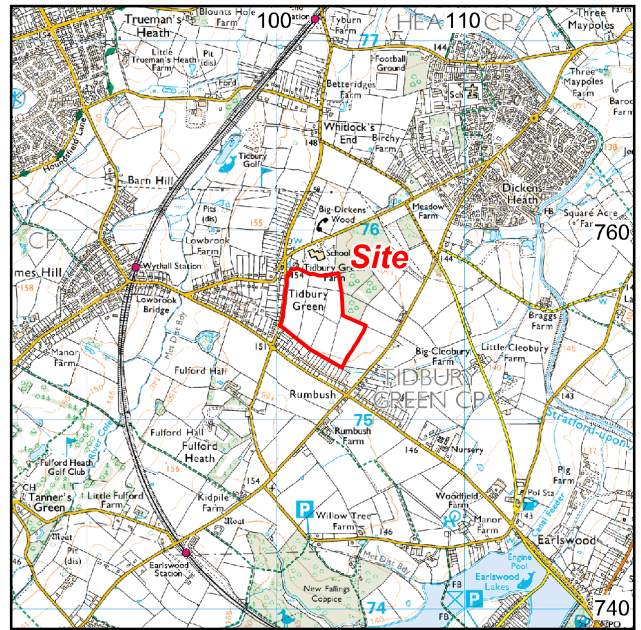
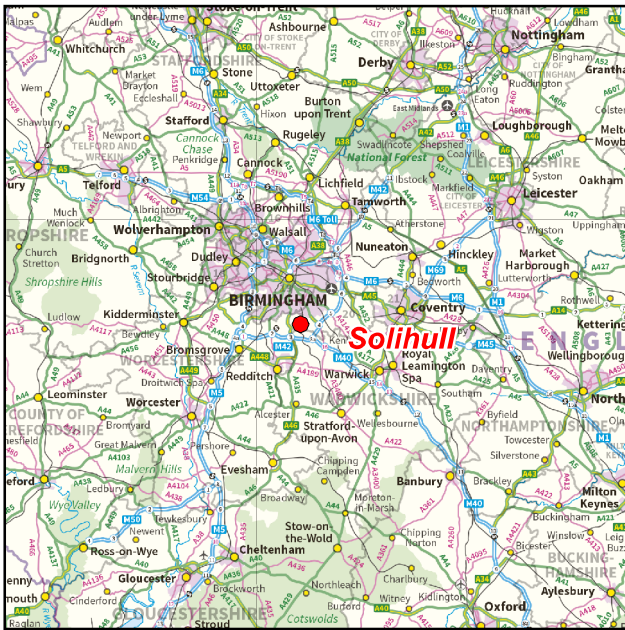

Scale 1:10,000

Site location Fig 1

3 BACKGROUND

3.1 Topography and geology

The site is located on the eastern edge of Tidbury Green and to the south-west of Dickens Heath (Fig 1) (NGR: SP 102 755). The site is approximately 14ha in size and consists of arable fields, with boundaries of mature hedgerows and tree belts. The site is bounded to the north by pasture fields, woodland and Tidbury Green school, to the east by arable/pasture fields and woodland, to the south by residential housing and associated gardens along Norton Lane and to the west by Fulford Hall road.

The bedrock geology has been mapped by the British Geological Society (BGS) as comprising Mercia mudstone overlain by superficial deposits of Alluvium within the southern part of the site (www.bgs.ac.uk)

3.2 Archaeological and historical background

The evaluation area has been the subject of a recent heritage desk based assessment (Waterman 2013) and a geophysical survey was undertaken of the site in June 2016 (Stratascan 2016). The following summarises the findings of those reports.

The region surrounding the Site is believed to have been well-populated with intense cultivation from as early as 3000 BC, with the earliest settlements focused on the richer gravel soils of the river valleys and later spreading to the sandstone soils of the Arden plateau.

The Solihull Historic Environment Record (HER) records undated cropmarks in the southern part of the site (HER MSI9031). The HER record postulates that it is possible these are early- Neolithic in date. However, no trace of these features was identified by the geophysical survey.

A series of four ring ditches dated to between the late Neolithic and early Iron Age periods are recorded at Kidpyle Farm off Rumbush Lane (HER MSI6188, MSI6189, MSI6190 and MSI6191). There are three other records of ring ditches and enclosures with possible prehistoric origins within the desk-based assessments 2km search area (HER MSI8547 and MSI8548 to the southeast of the Site, and MSI8569 to the north-north-east of the Site).

There are no finds related to the Roman period within the 2km search radius, although it is possible that any remains hitherto uncovered are masked by medieval and later settlement.

The Historic Landscape Characterisation for the search area indicates that the landscape within the Site and immediate surrounds has medieval origins, although there are crop-marks which may pre-date this.

The geophysical survey of the site did not identify any remains believed to be of archaeological significance, although a number of anomalies thought to be geological in origin were detected.

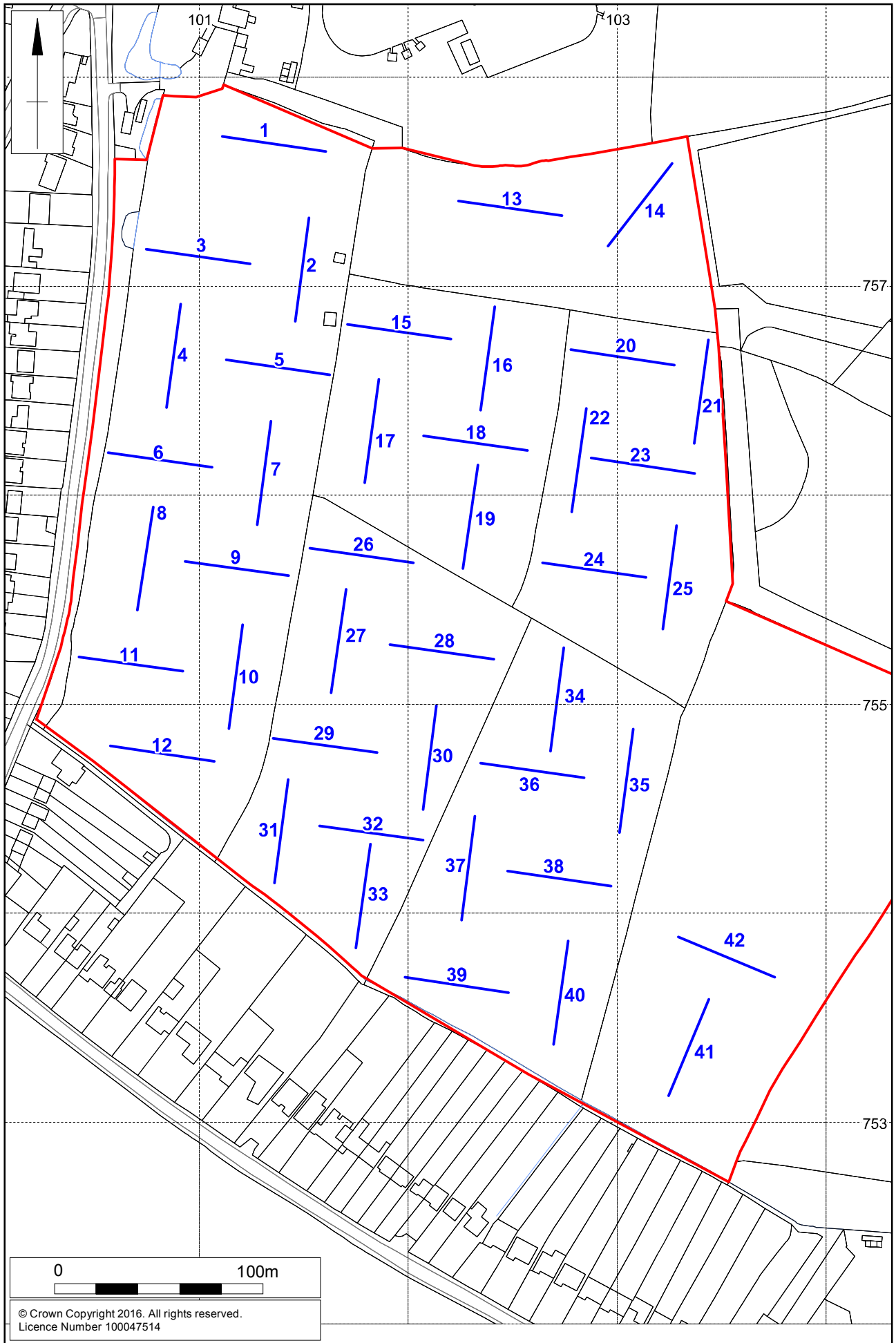

Scale 1:2500

Excavated trenches Fig 2

4 Excavation methodology

Forty-two (42) trenches were excavated (Fig 2). All trenches were excavated using a 360° mechanical excavator fitted with a 1.8m-wide toothless ditching bucket to a length of 50m (Fig 2).

The topsoil and subsoil were removed under archaeological direction to reveal natural substrate. The trenches were located to sample the entire area and to examine geophysical anomalies as well as areas where no anomalies were detected.

The locations of the trenches were surveyed and related to the Ordnance Survey National Grid using Leica Viva GPS survey equipment using SMARTNET real-time corrections, operating to a 3D tolerance of $\pm 0.05\text{m}$. A full photographic record comprising both 35mm black and white negatives and digital images was maintained. The field data from the evaluation has been compiled into a site archive with appropriate cross-referencing.

The trenches and spoil heaps were scanned with a metal detector to ensure maximum finds retrieval. All deposits encountered during the course of the excavation were fully recorded, following standard MOLA procedures (MOLA 2014). All deposits were given a separate context number. They were described on *pro-forma* context sheets to include details of the context, its relationships and interpretation. On completion all trenches were backfilled with their up-cast, lightly compacted by the mechanical excavator.

The evaluation conformed to the Chartered Institute for Archaeologists *Standard and guidance for archaeological field evaluation* (CIfA 2014)). All stages of the project were undertaken in accordance with Historic England's, *Management of Research Projects in the Historic Environment* (MoRPHE) (HE 2015). The evaluation was carried out in accordance with Written Scheme of Investigation (WSI) prepared by Lanpro services (Gajos 2016).

5 THE EXCAVATED EVIDENCE

5.1 General stratigraphy

The stratigraphy on site was very consistent. The natural substrate was between 0.25m and 0.37m below the present ground surface and was characterised as friable dark grey brown silty clay with rare small to medium sub-angular flint nodules, poorly sorted. The subsoil was between 0.09m- 0.36m thick and comprised firm, mid orange brown, silty clay with occasional small sub-angular flint. The topsoil was firm, dark grey brown silty clay with rare small to medium sub-angular flint nodules (Figs 3 and 4).

5.1 Results

No archaeological features were present in any of the trenches. No archaeological material was recovered from the topsoil or subsoil. A number of modern field drains were observed.



Representative section, Trench 13 looking south

Fig 3



Trench 6 looking West

Fig 4

6 DISCUSSION

Trial trench evaluation on land at Tidbury green, Solihull identified no archaeological features. The geophysical survey had identified no anomalies of possible archaeological origin. The only features that were present in the trenches were modern land drains which run north to south across the entirety of the site.

The Solihull HER had recorded possible cropmarks within the south-eastern part of the site. No corresponding anomalies or features were detected by either the geophysical survey or trial trenching, and these were presumably of geological origin.

BIBLIOGRAPHY

CIfA 2014 *Standards and guidance for archaeological field evaluation*, Chartered Institute for Archaeologists

DCLG 2012 *National Planning Policy Framework*, Department of Communities and Local Government

EH 1997 *Archaeological Division Research Agenda* English Heritage

Gajos, P, 2016 Written scheme of investigation for archaeological trial trench evaluation at Tidbury green, Solihull, LANPRO Services

HE 2015 *Management of Research Projects in the Historic Environment: The MoRPHE Project Managers Guide*, Historic England

MOLA 2014 *Archaeological Fieldwork Manual*, MOLA Northampton

Stratascan 2016, *Tidbury Green, Solihull, Geophysical Report, J9968*

Waterman Energy, Environment & Design Limited, 2013. Tidbury Green, Solihull, Heritage Desk Based Assessment

Watt, S, (ed) 2011 *The Archaeology of the West Midlands. A framework for research*, University of Birmingham and English Heritage. Oxbow Books

WEBSITES

www.bgs.ac.uk/geoindex/home.html

MOLA Northampton

15th February 2017

APPENDIX: CONTEXT INVENTORY

Trench No	Length, width & alignment	NGR	Surface height	Depth & height of natural
1	50m x 1.8m E-W	410110;275772 410160;275765	153.60m aOD	0.51m deep 153.09m aOD
<i>Context</i>	<i>Context type</i>	<i>Description</i>	<i>Dimensions</i>	<i>Artefacts/ Samples</i>
101	Topsoil	Friable to firm, dark grey brown silty clay with rare small and medium sub-angular flint nodules, poorly sorted.	0.20m thick	-
102	Subsoil	Firm, mid orange brown, silty clay with occasional small sub-angular flint.	0.31m thick	-
103	Natural	Firm light yellow grey silty clay with occasional small sub-angular flint nodules.	0.51m +	-

Trench No	Length, width & alignment	NGR	Surface height	Depth & height of natural
2	50m x 1.8m N-S	410153;275723 410145;275683	153.13m aOD	0.50m deep 152.63m aOD
<i>Context</i>	<i>Context type</i>	<i>Description</i>	<i>Dimensions</i>	<i>Artefacts/ Samples</i>
201	Topsoil	Friable to firm, dark grey brown silty clay with rare small and medium sub-angular flint nodules, poorly sorted.	0.14m thick	-
202	Subsoil	Firm, mid orange brown, silty clay with occasional small sub-angular flint.	0.36m thick	-
203	Natural	Firm light yellow grey silty clay with occasional small sub-angular flint nodules.	0.50m +	-

Trench No	Length, width & alignment	NGR	Surface height	Depth & height of natural
3	50m x 1.8m E-W	410124;275711 410074;275717	152.89m aOD	0.50m deep 152.38m aOD
Context	Context type	Description	Dimensions	Artefacts/ Samples
301	Topsoil	Friable to firm, dark grey brown silty clay with rare small and medium sub-angular flint nodules, poorly sorted.	0.22m thick	-
302	Subsoil	Firm, mid orange brown, silty clay with occasional small sub-angular flint.	0.28m thick	-
303	Natural	Firm light yellow grey silty clay with occasional small sub-angular flint nodules.	0.50m +	-

Trench No	Length, width & alignment	NGR	Surface height	Depth & height of natural
4	50m x 1.8m N-S	410090;275691 410084;275642	152.53m aOD	0.57m deep 151.96 aOD
Context	Context type	Description	Dimensions	Artefacts/ Samples
401	Topsoil	Friable to firm, dark grey brown silty clay with rare small and medium sub-angular flint nodules, poorly sorted.	0.21m thick	-
402	Subsoil	Firm, mid orange brown, silty clay with occasional small sub-angular flint.	0.36m thick	-
403	Natural	Firm light yellow grey silty clay with occasional small sub-angular flint nodules.	0.57m +	-

Trench No	Length, width & alignment	NGR	Surface height	Depth & height of natural
5	50m x 1.8m E-W	410154;275650 410112;275664	152.27m aOD	0.45m deep 151.82m aOD
Context	Context type	Description	Dimensions	Artefacts/ Samples
501	Topsoil	Friable to firm, dark grey brown silty clay with rare small and medium sub-angular flint nodules, poorly sorted.	0.19m thick	-
502	Subsoil	Firm, mid orange brown, silty clay with occasional small sub-angular flint.	0.26m thick	-
503	Natural	Firm light yellow grey silty clay with occasional small sub-angular flint nodules.	0.45m +	-

Trench No	Length, width & alignment	NGR	Surface height	Depth & height of natural
6	50m x 1.8m E-W	410077;275620 410106;275613	151.29m aOD	0.36m deep 150.93m aOD
Context	Context type	Description	Dimensions	Artefacts/ Samples
601	Topsoil	Friable to firm, dark grey brown silty clay with rare small and medium sub-angular flint nodules, poorly sorted.	0.15m thick	-
602	Subsoil	Firm, mid orange brown, silty clay with occasional small sub-angular flint.	0.21m thick	-
603	Natural	Firm light yellow grey silty clay with occasional small sub-angular flint nodules.	0.36m +	-

Trench No	Length, width & alignment	NGR	Surface height	Depth & height of natural
7	50m x 1.8m N-S	410134;275635 410127;275586	151.89m aOD	0.37m deep 151.52m aOD
Context	Context type	Description	Dimensions	Artefacts/ Samples
701	Topsoil	Friable to firm, dark grey brown silty clay with rare small and medium sub-angular flint nodules, poorly sorted.	0.19m thick	-
702	Subsoil	Firm, mid orange brown, silty clay with occasional small sub-angular flint.	0.18m thick	-
703	Natural	Firm light yellow grey silty clay with occasional small sub-angular flint nodules.	0.37m +	-

Trench No	Length, width & alignment	NGR	Surface height	Depth & height of natural
8	50m x 1.8m N-S	410070;275544 410077;275594	150.02m aOD	0.51m deep 149.51m aOD
Context	Context type	Description	Dimensions	Artefacts/ Samples
801	Topsoil	Friable to firm, dark grey brown silty clay with rare small and medium sub-angular flint nodules, poorly sorted.	0.20m thick	-
802	Subsoil	Firm, mid orange brown, silty clay with occasional small sub-angular flint.	0.31m thick	-
803	Natural	Firm light yellow grey silty clay with occasional small sub-angular flint nodules.	0.51m +	-

Trench No	Length, width & alignment	NGR	Surface height	Depth & height of natural
9	50m x 1.8m E-W	410130;275556 410093;275568	150.73m aOD	0.45m deep 150.28m aOD
Context	Context type	Description	Dimensions	Artefacts/ Samples
901	Topsoil	Friable to firm, dark grey brown silty clay with rare small and medium sub-angular flint nodules, poorly sorted.	0.25m thick	-
902	Subsoil	Firm, mid orange brown, silty clay with occasional small sub-angular flint.	0.20m thick	-
903	Natural	Firm light yellow grey silty clay with occasional small sub-angular flint nodules.	0.45m +	-

Trench No	Length, width & alignment	NGR	Surface height	Depth & height of natural
10	50m x 1.8m N-S	410120;275538 410114;275488	150.38m aOD	0.50m deep 149.88m aOD
Context	Context type	Description	Dimensions	Artefacts/ Samples
1001	Topsoil	Friable to firm, dark grey brown silty clay with rare small and medium sub-angular flint nodules, poorly sorted.	0.25m thick	-
1002	Subsoil	Firm, mid orange brown, silty clay with occasional small sub-angular flint.	0.25m thick	-
1003	Natural	Firm light yellow grey silty clay with occasional small sub-angular flint nodules.	0.50m +	-

Trench No	Length, width & alignment	NGR	Surface height	Depth & height of natural
11	50m x 1.8m E-W	410048;275527 410092;275516	149.55m aOD	0.46m deep 149.11m aOD
Context	Context type	Description	Dimensions	Artefacts/ Samples
1101	Topsoil	Friable to firm, dark grey brown silty clay with rare small and medium sub-angular flint nodules, poorly sorted.	0.19m thick	-
1102	Subsoil	Firm, mid orange brown, silty clay with occasional small sub-angular flint.	0.27m thick	-
1103	Natural	Firm light yellow grey silty clay with occasional small sub-angular flint nodules.	0.46m +	-

Trench No	Length, width & alignment	NGR	Surface height	Depth & height of natural
12	50m x 1.8m N-S	410056;275482 410107;275472	149.47m aOD	0.50m deep 148.97m aOD
Context	Context type	Description	Dimensions	Artefacts/ Samples
1201	Topsoil	Friable to firm, dark grey brown silty clay with rare small and medium sub-angular flint nodules, poorly sorted.	0.22m thick	-
1202	Subsoil	Firm, mid orange brown, silty clay with occasional small sub-angular flint.	0.28m thick	-
1203	Natural	Firm light yellow grey silty clay with occasional small sub-angular flint nodules.	0.50m +	-

Trench No	Length, width & alignment	NGR	Surface height	Depth & height of natural
13	50m x 1.8m E-W	410273;275733 410223;275740	152.88m aOD	0.44m deep 152.44m aOD
<i>Context</i>	<i>Context type</i>	<i>Description</i>	<i>Dimensions</i>	<i>Artefacts/ Samples</i>
1301	Topsoil	Friable to firm, dark grey brown silty clay with rare small and medium sub-angular flint nodules, poorly sorted.	0.37m thick	-
1302	Subsoil	Firm, mid orange brown, silty clay with occasional small sub-angular flint.	0.07m thick	-
1303	Natural	Firm light yellow grey silty clay with occasional small sub-angular flint nodules.	0.44m +	-

Trench No	Length, width & alignment	NGR	Surface height	Depth & height of natural
14	50m x 1.8m NE-SW	410296;275714 410330;275763	152.88m aOD	0.38m deep 152.50m aOD
<i>Context</i>	<i>Context type</i>	<i>Description</i>	<i>Dimensions</i>	<i>Artefacts/ Samples</i>
1401	Topsoil	Friable to firm, dark grey brown silty clay with rare small and medium sub-angular flint nodules, poorly sorted.	0.31m thick	-
1402	Subsoil	Firm, mid orange brown, silty clay with occasional small sub-angular flint.	0.07m thick	-
1403	Natural	Firm light yellow grey silty clay with occasional small sub-angular flint nodules.	0.38m +	-

Trench No	Length, width & alignment	NGR	Surface height	Depth & height of natural
15	50m x 1.8m E-W	410181;275687 410220;275674	152.76m aOD	0.40m deep 152.36m aOD
Context	Context type	Description	Dimensions	Artefacts/ Samples
1501	Topsoil	Friable to firm, dark grey brown silty clay with rare small and medium sub-angular flint nodules, poorly sorted.	0.20m thick	-
1502	Subsoil	Firm, mid orange brown, silty clay with occasional small sub-angular flint.	0.20m thick	-
1503	Natural	Firm light yellow grey silty clay with occasional small sub-angular flint nodules.	0.40m +	-

Trench No	Length, width & alignment	NGR	Surface height	Depth & height of natural
16	50m x 1.8m N-S	410246;275679 410234;275640	152.75m aOD	0.41m deep 152.33m aOD
Context	Context type	Description	Dimensions	Artefacts/ Samples
1601	Topsoil	Friable to firm, dark grey brown silty clay with rare small and medium sub-angular flint nodules, poorly sorted.	0.20m thick	-
1602	Subsoil	Firm, mid orange brown, silty clay with occasional small sub-angular flint.	0.2m thick	-
1603	Natural	Firm light yellow grey silty clay with occasional small sub-angular flint nodules.	0.41m +	-

Trench No	Length, width & alignment	NGR	Surface height	Depth & height of natural
17	50m x 1.8m N-S	410179;275606 410185;275655	151.75m aOD	0.45m deep 151.30m aOD
Context	Context type	Description	Dimensions	Artefacts/ Samples
1701	Topsoil	Friable to firm, dark grey brown silty clay with rare small and medium sub-angular flint nodules, poorly sorted.	0.25m thick	-
1702	Subsoil	Firm, mid orange brown, silty clay with occasional small sub-angular flint.	0.20m thick	-
1703	Natural	Firm light yellow grey silty clay with occasional small sub-angular flint nodules.	0.45m +	-

Trench No	Length, width & alignment	NGR	Surface height	Depth & height of natural
18	50m x 1.8m E-W	410257;275621 410207;275628	152.44m aOD	0.33m deep 152.11 aOD
Context	Context type	Description	Dimensions	Artefacts/ Samples
1801	Topsoil	Friable to firm, dark grey brown silty clay with rare small and medium sub-angular flint nodules, poorly sorted.	0.21m thick	-
1802	Subsoil	Firm, mid orange brown, silty clay with occasional small sub-angular flint.	0.12m thick	-
1803	Natural	Firm light yellow grey silty clay with occasional small sub-angular flint nodules.	0.33m +	-

Trench No	Length, width & alignment	NGR	Surface height	Depth & height of natural
19	50m x 1.8m N-S	410223;275580 410233;275614	151.78m aOD	0.34m deep 151.44 aOD
Context	Context type	Description	Dimensions	Artefacts/ Samples
1901	Topsoil	Friable to firm, dark grey brown silty clay with rare small and medium sub-angular flint nodules, poorly sorted.	0.22m thick	-
1902	Subsoil	Firm, mid orange brown, silty clay with occasional small sub-angular flint.	0.12m thick	-
1903	Natural	Firm light yellow grey silty clay with occasional small sub-angular flint nodules.	0.34m +	-

Trench No	Length, width & alignment	NGR	Surface height	Depth & height of natural
20	50m x 1.8m E-W	410277;275669 410327;275662	152.74m aOD	0.34m deep 152.40m aOD
Context	Context type	Description	Dimensions	Artefacts/ Samples
2001	Topsoil	Friable to firm, dark grey brown silty clay with rare small and medium sub-angular flint nodules, poorly sorted.	0.25m thick	-
2002	Subsoil	Firm, mid orange brown, silty clay with occasional small sub-angular flint.	0.12m thick	-
2003	Natural	Firm light yellow grey silty clay with occasional small sub-angular flint nodules.	0.37m +	-

Trench No	Length, width & alignment	NGR	Surface height	Depth & height of natural
21	50m x 1.8m N-S	410336;275624 410343;275674	152.56m aOD	0.40m deep 152.16 aOD
Context	Context type	Description	Dimensions	Artefacts/ Samples
2101	Topsoil	Friable to firm, dark grey brown silty clay with rare small and medium sub-angular flint nodules, poorly sorted.	0.23m thick	-
2102	Subsoil	Firm, mid orange brown, silty clay with occasional small sub-angular flint.	0.17m thick	-
2103	Natural	Firm light yellow grey silty clay with occasional small sub-angular flint nodules.	0.40m +	-

Trench No	Length, width & alignment	NGR	Surface height	Depth & height of natural
22	50m x 1.8m N-S	410278;275592 410285;275641	152.24m aOD	0.45m deep 151.79m aOD
Context	Context type	Description	Dimensions	Artefacts/ Samples
2201	Topsoil	Friable to firm, dark grey brown silty clay with rare small and medium sub-angular flint nodules, poorly sorted.	0.25m thick	-
2202	Subsoil	Firm, mid orange brown, silty clay with occasional small sub-angular flint.	0.20m thick	-
2203	Natural	Firm light yellow grey silty clay with occasional small sub-angular flint nodules.	0.45m +	-

Trench No	Length, width & alignment	NGR	Surface height	Depth & height of natural
23	50m x 1.8m E-W	410377;275610 410287;275617	152.54m aOD	0.40m deep 152.14m aOD
<i>Context</i>	<i>Context type</i>	<i>Description</i>	<i>Dimensions</i>	<i>Artefacts/ Samples</i>
2301	Topsoil	Friable to firm, dark grey brown silty clay with rare small and medium sub-angular flint nodules, poorly sorted.	0.21m thick	-
2302	Subsoil	Firm, mid orange brown, silty clay with occasional small sub-angular flint.	0.19m thick	-
2303	Natural	Firm light yellow grey silty clay with occasional small sub-angular flint nodules.	0.40m +	-

Trench No	Length, width & alignment	NGR	Surface height	Depth & height of natural
24	50m x 1.8m E-W	410313;275560 410264;275567	152.14m aOD	0.40m deep 151.74 aOD
<i>Context</i>	<i>Context type</i>	<i>Description</i>	<i>Dimensions</i>	<i>Artefacts/ Samples</i>
2401	Topsoil	Friable to firm, dark grey brown silty clay with rare small and medium sub-angular flint nodules, poorly sorted.	0.21m thick	-
2402	Subsoil	Firm, mid orange brown, silty clay with occasional small sub-angular flint.	0.19m thick	-
2403	Natural	Firm light yellow grey silty clay with occasional small sub-angular flint nodules.	0.40m +	-

Trench No	Length, width & alignment	NGR	Surface height	Depth & height of natural
25	50m x 1.8m N-S	410321;275535 410328;275585	152.02m aOD	0.43m deep 151.59 aOD
Context	Context type	Description	Dimensions	Artefacts/ Samples
2501	Topsoil	Friable to firm, dark grey brown silty clay with rare small and medium sub-angular flint nodules, poorly sorted.	0.22m thick	-
2502	Subsoil	Firm, mid orange brown, silty clay with occasional small sub-angular flint.	0.21m thick	-
2503	Natural	Firm light yellow grey silty clay with occasional small sub-angular flint nodules.	0.43m +	-

Trench No	Length, width & alignment	NGR	Surface height	Depth & height of natural
26	50m x 1.8m E-W	410165;275571 410202;275565	151.11m aOD	0.39m deep 150.72aOD
Context	Context type	Description	Dimensions	Artefacts/ Samples
2601	Topsoil	Friable to firm, dark grey brown silty clay with rare small and medium sub-angular flint nodules, poorly sorted.	0.21m thick	-
2602	Subsoil	Firm, mid orange brown, silty clay with occasional small sub-angular flint.	0.18m thick	-
2603	Natural	Firm light yellow grey silty clay with occasional small sub-angular flint nodules.	0.39m +	-

Trench No	Length, width & alignment	NGR	Surface height	Depth & height of natural
27	50m x 1.8m N-S	410163;275505 410170;275555	150.37m aOD	0.40m deep 149.97m aOD
Context	Context type	Description	Dimensions	Artefacts/ Samples
2701	Topsoil	Friable to firm, dark grey brown silty clay with rare small and medium sub-angular flint nodules, poorly sorted.	0.21m thick	-
2702	Subsoil	Firm, mid orange brown, silty clay with occasional small sub-angular flint.	0.19m thick	-
2703	Natural	Firm light yellow grey silty clay with occasional small sub-angular flint nodules.	0.40m +	-

Trench No	Length, width & alignment	NGR	Surface height	Depth & height of natural
28	50m x 1.8m E-W	410239;275522 410191;275528	151.33m aOD	0.42m deep 150.91m aOD
Context	Context type	Description	Dimensions	Artefacts/ Samples
2801	Topsoil	Friable to firm, dark grey brown silty clay with rare small and medium sub-angular flint nodules, poorly sorted.	0.20m thick	-
2802	Subsoil	Firm, mid orange brown, silty clay with occasional small sub-angular flint.	0.22m thick	-
2803	Natural	Firm light yellow grey silty clay with occasional small sub-angular flint nodules.	0.42m +	-

Trench No	Length, width & alignment	NGR	Surface height	Depth & height of natural
29	50m x 1.8m E-W	410185;275476 410135;275483	150.30m aOD	0.39m deep 149.91m aOD
Context	Context type	Description	Dimensions	Artefacts/ Samples
2901	Topsoil	Friable to firm, dark grey brown silty clay with rare small and medium sub-angular flint nodules, poorly sorted.	0.19m thick	-
2902	Subsoil	Firm, mid orange brown, silty clay with occasional small sub-angular flint.	0.20m thick	-
2903	Natural	Firm light yellow grey silty clay with occasional small sub-angular flint nodules.	0.39m +	-

Trench No	Length, width & alignment	NGR	Surface height	Depth & height of natural
30	50m x 1.8m N-S	410213;275499 410207;275449	150.74m aOD	0.41m deep 150.33m aOD
Context	Context type	Description	Dimensions	Artefacts/ Samples
3001	Topsoil	Friable to firm, dark grey brown silty clay with rare small and medium sub-angular flint nodules, poorly sorted.	0.18m thick	-
3002	Subsoil	Firm, mid orange brown, silty clay with occasional small sub-angular flint.	0.23m thick	-
3003	Natural	Firm light yellow grey silty clay with occasional small sub-angular flint nodules.	0.41m +	-

Trench No	Length, width & alignment	NGR	Surface height	Depth & height of natural
31	50m x 1.8m N-S	410129;275426 410142;275464	149.30m aOD	0.38m deep 148.92m aOD
Context	Context type	Description	Dimensions	Artefacts/ Samples
3101	Topsoil	Friable to firm, dark grey brown silty clay with rare small and medium sub-angular flint nodules, poorly sorted.	0.19m thick	-
3102	Subsoil	Firm, mid orange brown, silty clay with occasional small sub-angular flint.	0.19m thick	-
3103	Natural	Firm light yellow grey silty clay with occasional small sub-angular flint nodules.	0.38m +	-

Trench No	Length, width & alignment	NGR	Surface height	Depth & height of natural
32	50m x 1.8m E-W	410206;275428 410157;275441	149.94m aOD	0.39m deep 149.55aOD
Context	Context type	Description	Dimensions	Artefacts/ Samples
3201	Topsoil	Friable to firm, dark grey brown silty clay with rare small and medium sub-angular flint nodules, poorly sorted.	0.20m thick	-
3202	Subsoil	Firm, mid orange brown, silty clay with occasional small sub-angular flint.	0.19m thick	-
3203	Natural	Firm light yellow grey silty clay with occasional small sub-angular flint nodules.	0.39m +	-

Trench No	Length, width & alignment	NGR	Surface height	Depth & height of natural
33	50m x 1.8m N-S	410171;275391 410181;275433	149.20m aOD	0.39m deep 148.81aOD
Context	Context type	Description	Dimensions	Artefacts/ Samples
3301	Topsoil	Friable to firm, dark grey brown silty clay with rare small and medium sub-angular flint nodules, poorly sorted.	0.21m thick	-
3302	Subsoil	Firm, mid orange brown, silty clay with occasional small sub-angular flint.	0.18m thick	-
3303	Natural	Firm light yellow grey silty clay with occasional small sub-angular flint nodules.	0.39m +	-

Trench No	Length, width & alignment	NGR	Surface height	Depth & height of natural
34	50m x 1.8m N-S	410268;275477 410274;275527	151.03m aOD	0.39m deep 150.64m aOD
Context	Context type	Description	Dimensions	Artefacts/ Samples
3401	Topsoil	Friable to firm, dark grey brown silty clay with rare small and medium sub-angular flint nodules, poorly sorted.	0.21m thick	-
3402	Subsoil	Firm, mid orange brown, silty clay with occasional small sub-angular flint.	0.18m thick	-
3403	Natural	Firm light yellow grey silty clay with occasional small sub-angular flint nodules.	0.39m +	-

Trench No	Length, width & alignment	NGR	Surface height	Depth & height of natural
35	50m x 1.8m N-S	410301;275438 410307;275488	150.80m aOD	0.35m deep 150.45m aOD
Context	Context type	Description	Dimensions	Artefacts/ Samples
3501	Topsoil	Friable to firm, dark grey brown silty clay with rare small and medium sub-angular flint nodules, poorly sorted.	0.21m thick	-
3502	Subsoil	Firm, mid orange brown, silty clay with occasional small sub-angular flint.	0.14m thick	-
3503	Natural	Firm light yellow grey silty clay with occasional small sub-angular flint nodules.	0.35m +	-

Trench No	Length, width & alignment	NGR	Surface height	Depth & height of natural
36	50m x 1.8m E-W	410284;275464 410234;275471	150.97m aOD	0.31m 150.66m aOD
Context	Context type	Description	Dimensions	Artefacts/ Samples
3601	Topsoil	Friable to firm, dark grey brown silty clay with rare small and medium sub-angular flint nodules, poorly sorted.	0.21m thick	-
3602	Subsoil	Firm, mid orange brown, silty clay with occasional small sub-angular flint.	0.10m thick	-
3603	Natural	Firm light yellow grey silty clay with occasional small sub-angular flint nodules.	0.31m +	-

Trench No	Length, width & alignment	NGR	Surface height	Depth & height of natural
37	50m x 1.8m N-S	410225;275396 410232;275446	149.54m aOD	0.40m deep 149.14m aOD
Context	Context type	Description	Dimensions	Artefacts/ Samples
3701	Topsoil	Friable to firm, dark grey brown silty clay with rare small and medium sub-angular flint nodules, poorly sorted.	0.22m thick	-
3702	Subsoil	Firm, mid orange brown, silty clay with occasional small sub-angular flint.	0.18m thick	-
3703	Natural	Firm light yellow grey silty clay with occasional small sub-angular flint nodules.	0.40m +	-

Trench No	Length, width & alignment	NGR	Surface height	Depth & height of natural
38	50m x 1.8m E-W	410297;275413 410247;275420	150.29m aOD	0.29m deep 150m aOD
Context	Context type	Description	Dimensions	Artefacts/ Samples
3801	Topsoil	Friable to firm, dark grey brown silty clay with rare small and medium sub-angular flint nodules, poorly sorted.	0.20m thick	-
3802	Subsoil	Firm, mid orange brown, silty clay with occasional small sub-angular flint.	0.09m thick	-
3803	Natural	Firm light yellow grey silty clay with occasional small sub-angular flint nodules.	0.29m +	-

Trench No	Length, width & alignment	NGR	Surface height	Depth & height of natural
39	50m x 1.8m E-W	410198;275372 410248;275361	149.15m aOD	0.32m deep 148.83 aOD
Context	Context type	Description	Dimensions	Artefacts/ Samples
3901	Topsoil	Friable to firm, dark grey brown silty clay with rare small and medium sub-angular flint nodules, poorly sorted.	0.23m thick	-
32902	Subsoil	Firm, mid orange brown, silty clay with occasional small sub-angular flint.	0.09m thick	-
3903	Natural	Firm light yellow grey silty clay with occasional small sub-angular flint nodules.	0.32m +	-

Trench No	Length, width & alignment	NGR	Surface height	Depth & height of natural
40	50m x 1.8m N-S	410276;275386 410269;275337	149.66m aOD	0.23m deep 149.43m aOD
Context	Context type	Description	Dimensions	Artefacts/ Samples
4001	Topsoil	Friable to firm, dark grey brown silty clay with rare small and medium sub-angular flint nodules, poorly sorted.	0.22m thick	-
4002	Subsoil	Firm, mid orange brown, silty clay with occasional small sub-angular flint.	0.01m thick	-
4003	Natural	Firm light yellow grey silty clay with occasional small sub-angular flint nodules.	0.23m +	-

Trench No	Length, width & alignment	NGR	Surface height	Depth & height of natural
41	50m x 1.8m N-S	410352;275377 410332;275331	150.15m aOD	0.48m deep 149.67m aOD
<i>Context</i>	<i>Context type</i>	<i>Description</i>	<i>Dimensions</i>	<i>Artefacts/ Samples</i>
4101	Topsoil	Friable to firm, dark grey brown silty clay with rare small and medium sub-angular flint nodules, poorly sorted.	0.36m thick	-
4102	Subsoil	Firm, mid orange brown, silty clay with occasional small sub-angular flint.	0.12m thick	-
4103	Natural	Firm light yellow grey silty clay with occasional small sub-angular flint nodules.	0.48m +	-

Trench No	Length, width & alignment	NGR	Surface height	Depth & height of natural
42	50m x 1.8m E-W	410394;275386 410343;275405	150.46m aOD	0.48m deep 149.98m aOD
<i>Context</i>	<i>Context type</i>	<i>Description</i>	<i>Dimensions</i>	<i>Artefacts/ Samples</i>
4201	Topsoil	Friable to firm, dark grey brown silty clay with rare small and medium sub-angular flint nodules, poorly sorted.	0.37m thick	-
4202	Subsoil	Firm, mid orange brown, silty clay with occasional small sub-angular flint.	0.11m thick	-
4203	Natural	Firm light yellow grey silty clay with occasional small sub-angular flint nodules.	0.48m +	-



MOLA
Bolton House
Wootton Hall Park
Northampton
NN4 8BN
01604 809 800
www.mola.org.uk
sparry@mola.org.uk