

NORTHERN ARCHAEOLOGICAL ASSOCIATES LTD
FORGE FARM, RAVENSWORTH, NORTH YORKSHIRE
Negative Watching Brief Report

Site name: Forge Farm	Grid reference: NZ1399408044
Parish: Ravensworth	District: Richmondshire County: North Yorkshire
Administrative authority: RDC	Development: Residential
Client: Mallard Homes Ltd.	
Planning application reference: 16/00427/FULL	
Site supervisor: Therese Falk	Project manager: Oliver Cooper
Fieldwork Date(s): 26/02/20	NAA project number: 2040 Site code: RFF20
NAA report number: 20/22	Report date: 04/03/2020

Reasons for watching brief

The proposed development site at Forge Farm was located to the north-west of the village green, behind properties 13 and 13a that face onto Waitlands Lane (Fig 1). The site consisted of an agricultural strip field with a series of derelict barn buildings in the south-eastern corner, bounded by residential properties to the north and south, and an area of woodland to the west.

Settlement at Ravensworth originated in the early medieval period and this is reflected in the layout of the village, with long, narrow residential plots of tofts and crofts radiating from the central village green. The existing village is dominated by the surviving ruins of the 14th-century castle to the south. The proposed development site was located within the footprint of two of the medieval crofts (Fig 2). A heritage appraisal (HIA 2016) concluded that there was potential for medieval remains relating to the early uses of the plot to be present. Since such remains were likely to be subject to disturbance as a result of the proposed development, the agreed mitigation strategy was to excavate three trenches to evaluate the potential for survival of archaeological remains.

Results

Trench locations are shown on Figure 3.

Trench 1

Trench 1 was excavated within the eastern part of the proposed development area. It was located 2m west of an extant garden wall and orientated east to west. The trench measured 5m by 2m and was excavated to a depth of 1m. An initial layer of 0.4m deep topsoil consisting of sandy silt was removed to expose a 0.35m deep sandy silt subsoil. Underlying the subsoil was a layer of colluvium (hill-wash), comprising clayey silt and measuring 0.25m in depth. Natural gravel was encountered at a depth of 1m. No archaeological features or finds were present.



Plate 1: north-facing section of Trench 1.

Trench 2

Trench 2 was excavated within the northern part of the proposed development area. It was located 6.5m south of an extant garden fence and orientated north to south. The trench measured 5m by 2m and was excavated to a depth of 1.2m. An initial layer of 0.2m deep topsoil consisting

of sandy silt was removed to expose a 0.3m deep sandy silt subsoil. Underlying the subsoil was a thick layer of colluvium, comprising clayey silt and measuring 0.7m in depth. Natural gravel was encountered at a depth of 1.2m. No archaeological features or finds were present.



Plate 2: east facing section of Trench 2.

Trench 3

Trench 3 was excavated centrally within the proposed development area. It was located 11.5m north of an extant garden fence and orientated east to west. The trench measured 4m by 2m and was excavated to a depth of 0.8m. An initial layer of 0.2m deep topsoil consisting of sandy silt was removed to expose a 0.2m deep sandy silt subsoil. Underlying the subsoil was a layer of colluvium, comprising clayey silt with frequent inclusions of small stones and measuring 0.4m in depth. Natural gravel was encountered at a depth of 0.8m. No archaeological features or finds were present.

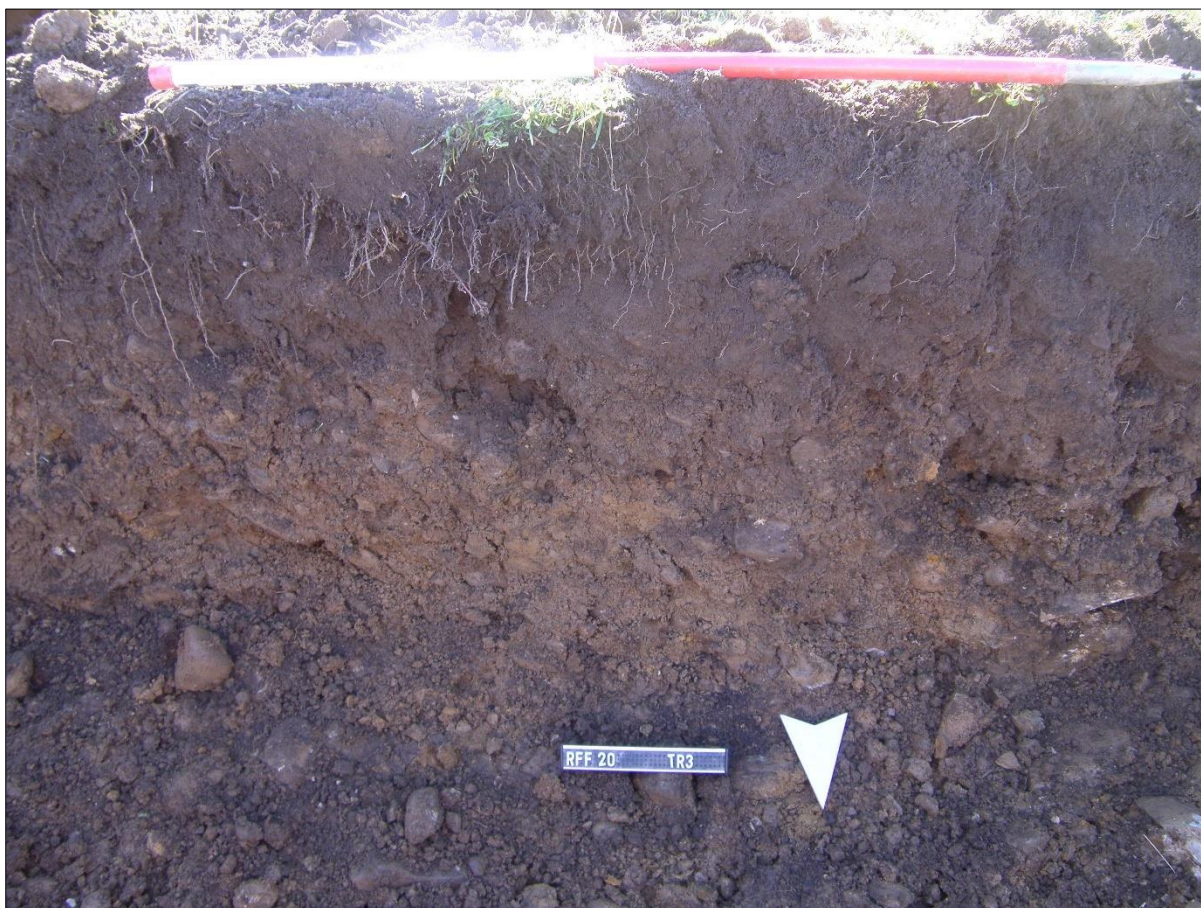

Plate 3: north facing section of Trench 3.

Discussion

There was a similar soil profile in each of the trenches: natural gravelly clay was overlain by up to up to 0.7m of colluvium, which was sealed by between 0.2m and 0.35m of subsoil- probably the remains of medieval or later ploughing. There was up to 0.4m of topsoil. No features or buried deposits of archaeological interest were identified, and there were no finds. No further work is considered necessary for this development.

Documentation

The trenches were recorded using digital photography, and representative sections of each trench were drawn at a 1:10 scale prior to backfilling. The archive will be stored internally at NAA.

Reference

Harris Irwin Associates Ltd (2016) *Proposed Housing Development, Forge Farm, Ravensworth: Heritage Statement.*

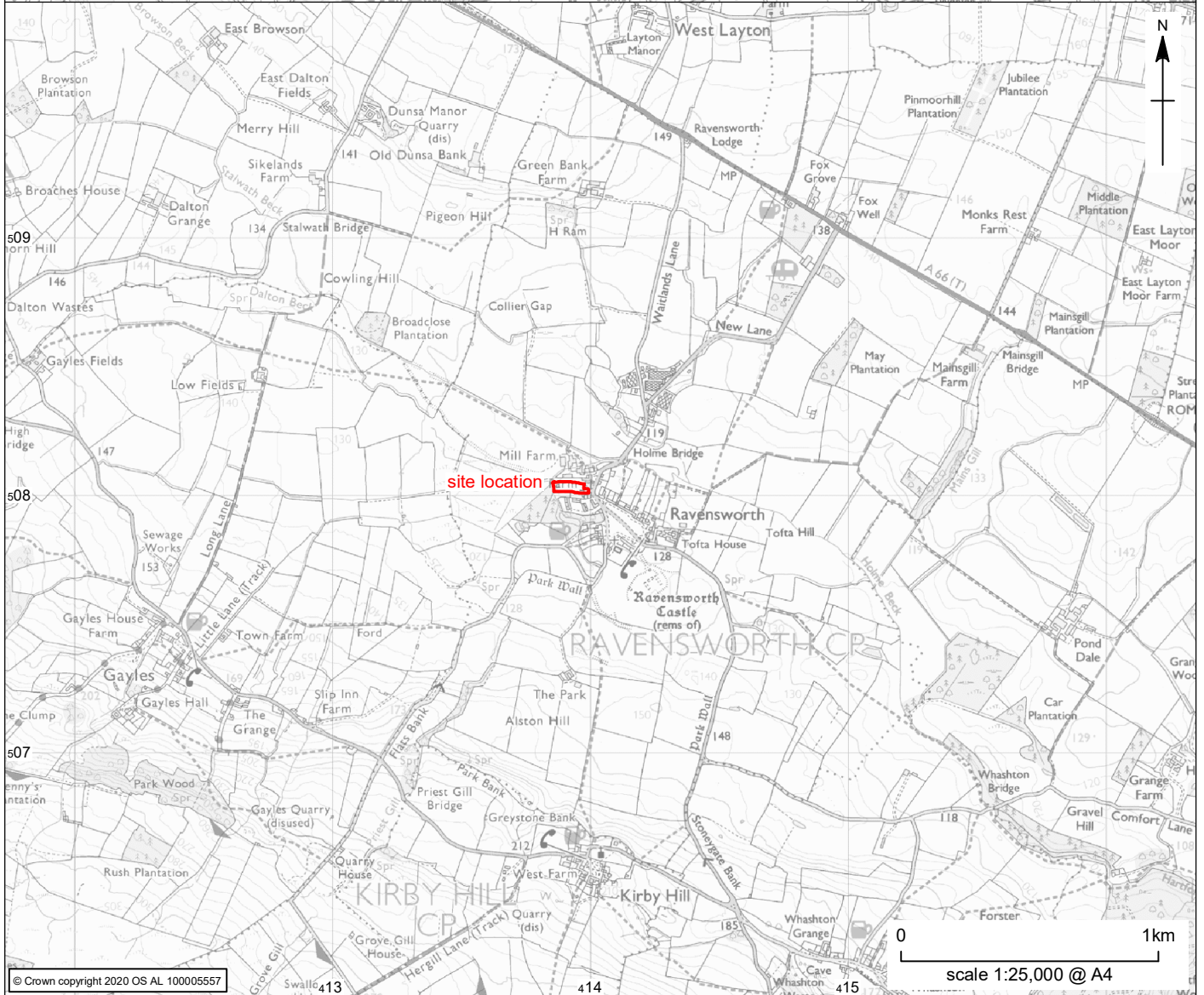
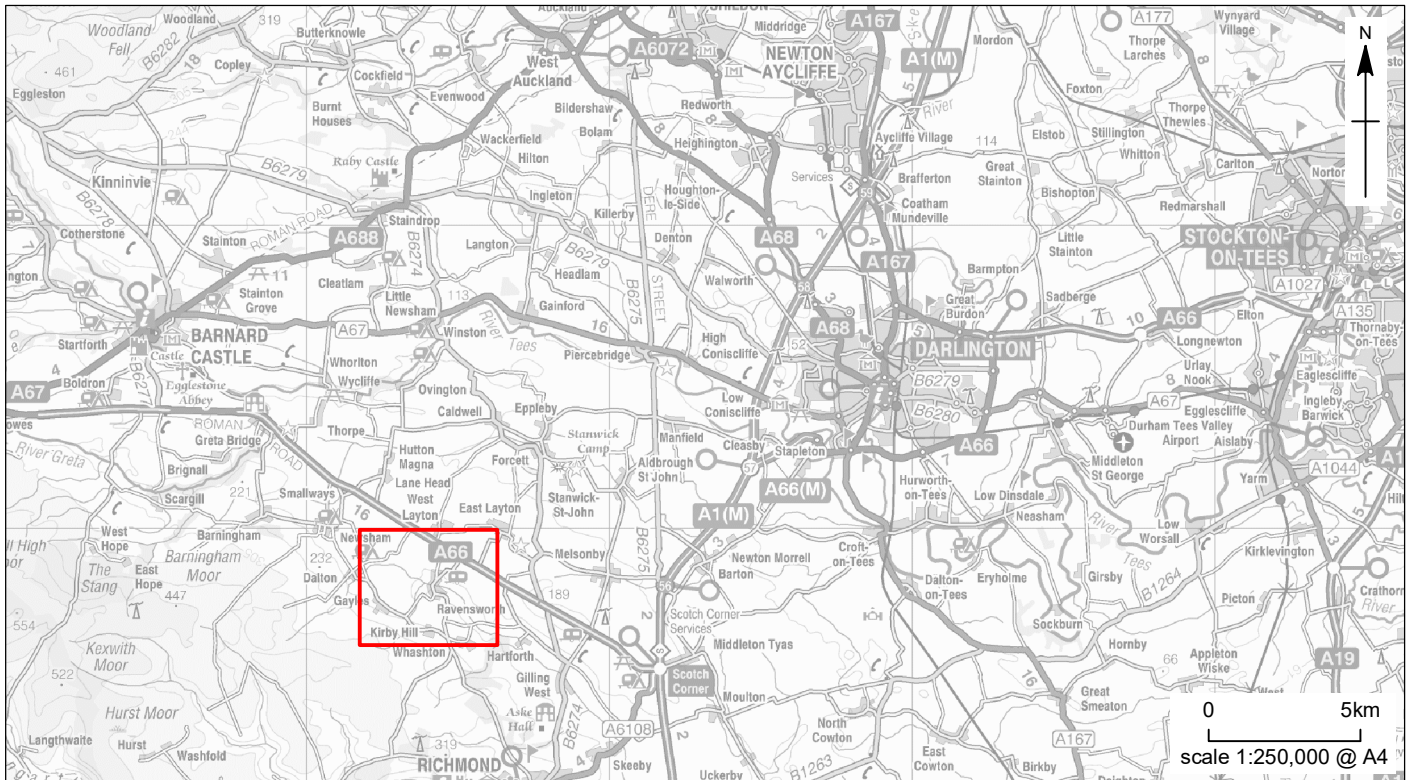

© Crown copyright 2020 OS AL 100005557

©NAA 2020

Forge Farm, Ravensworth: site location

Figure 1

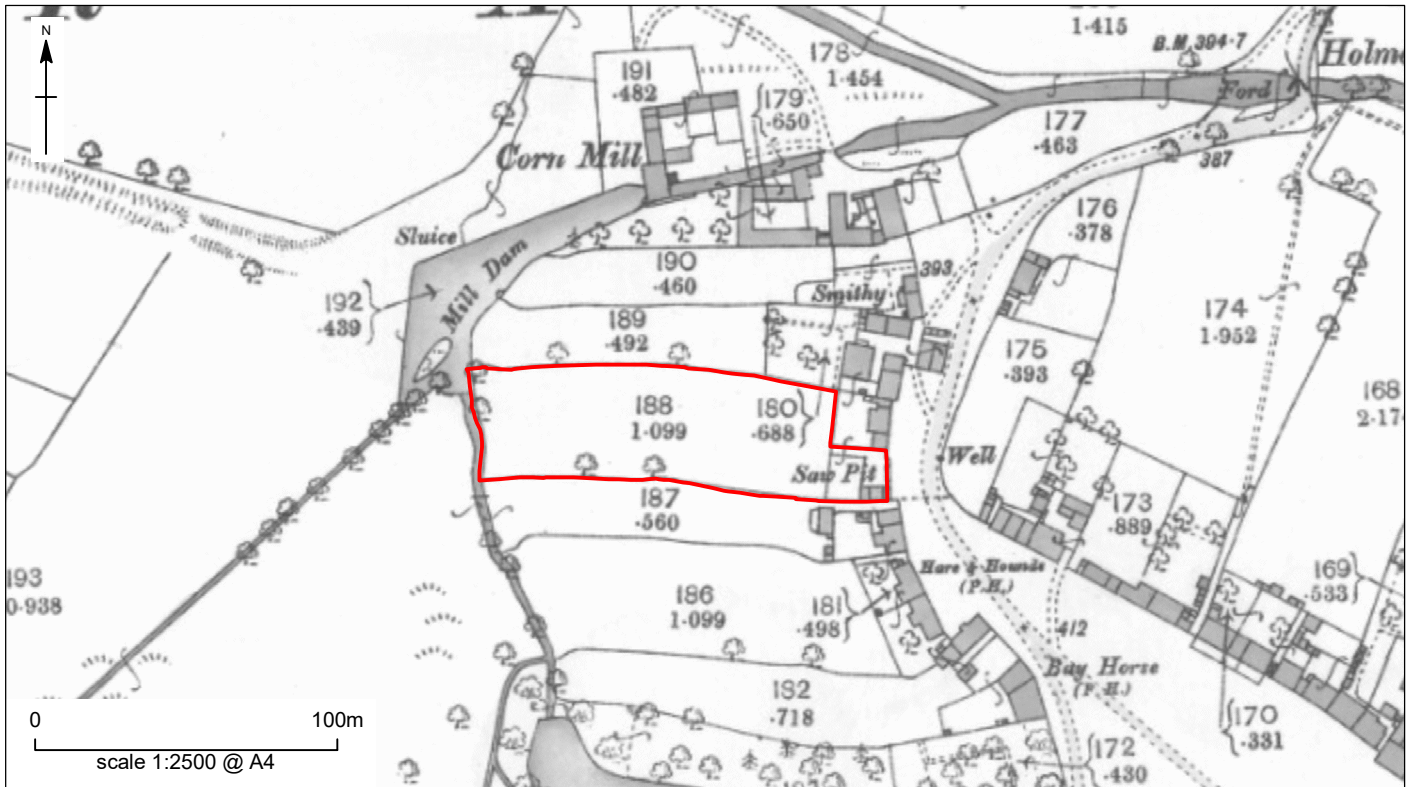

©NAA 2020

Forge Farm, Ravensworth: Ordnance Survey map, 1893

Figure 2



Google Earth ©2019 (Imagery date: 27/06/2018)

scale 1:1000 @ A4

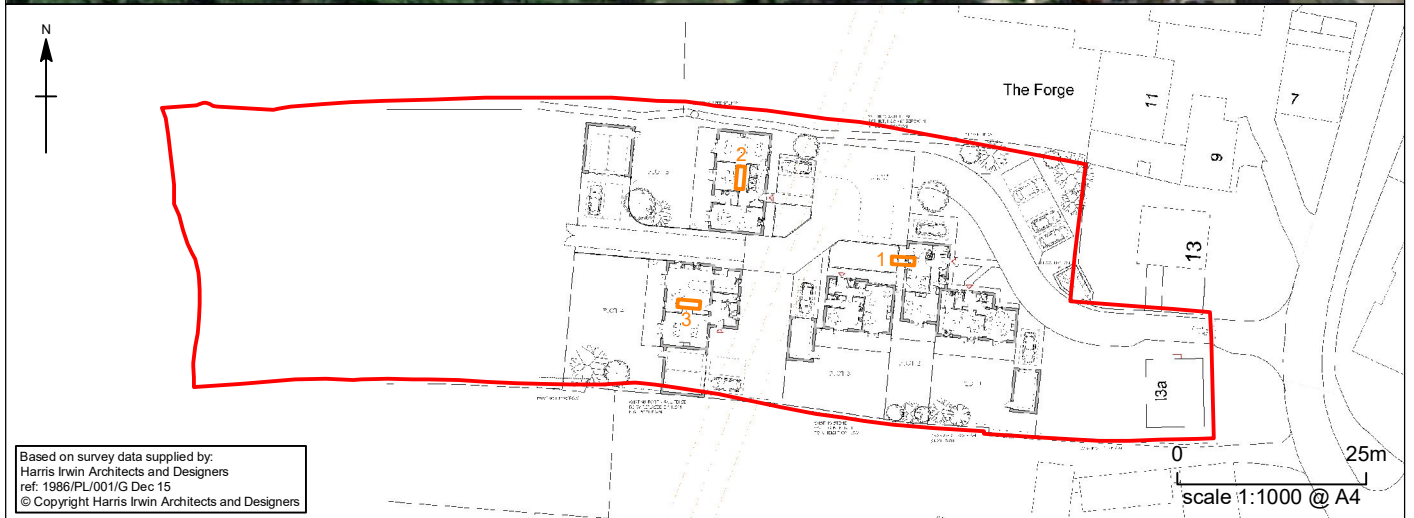

Based on survey data supplied by:
Harris Irwin Architects and Designers
ref: 1986/PL/001/G Dec 15
© Copyright Harris Irwin Architects and Designers

scale 1:1000 @ A4

©NAA 2020

Forge Farm, Ravensworth: trial trench locations overlain on Google Earth imagery and proposed development plan

Figure 3