

# EXETER : EXE BRIDGES

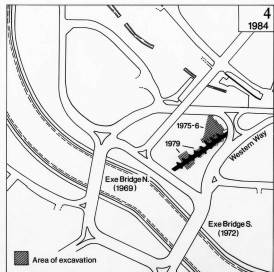

0 300m

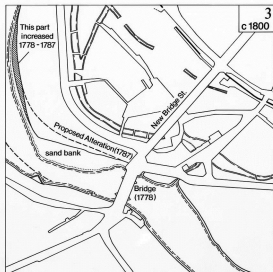
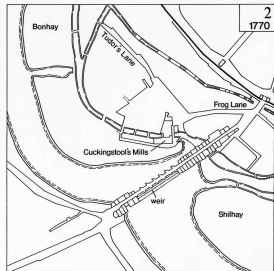
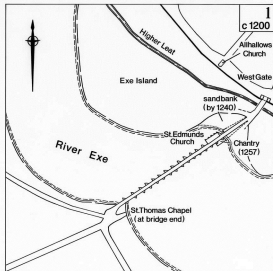

EXETER : EXE ISLAND C. 1770

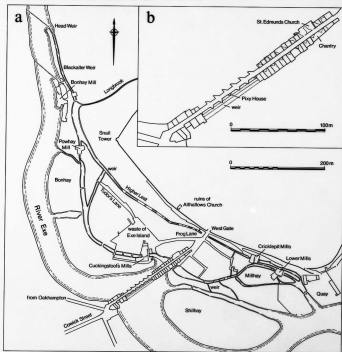



# MEDIEVAL EXE BRIDGE, EXETER

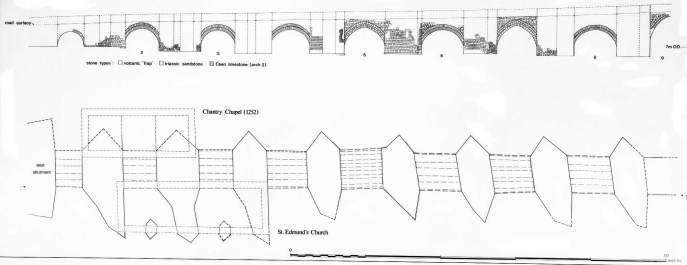

Original Fabric

EXETER: MEDIEVAL EXE BRIDGE

Pier 5

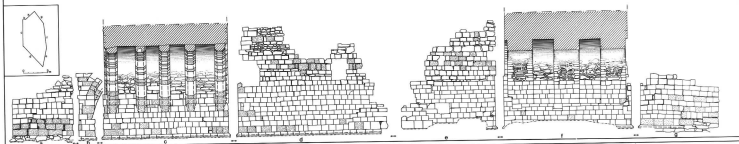

Pier 6

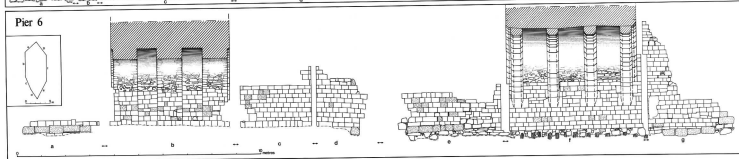

EXETER: MEDIEVAL EXE BRIDGE

Original Fabric

Pier 7

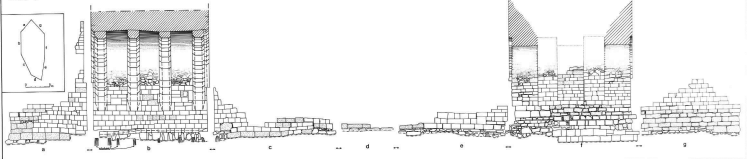

Pier 1



EXETER Eye Bridge 1979

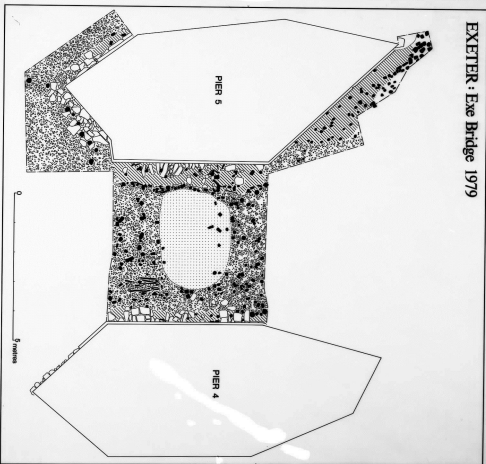



ST. EDMUND'S CHURCH, EXETER  
13<sup>th</sup> Cent. 15<sup>th</sup> Cent.

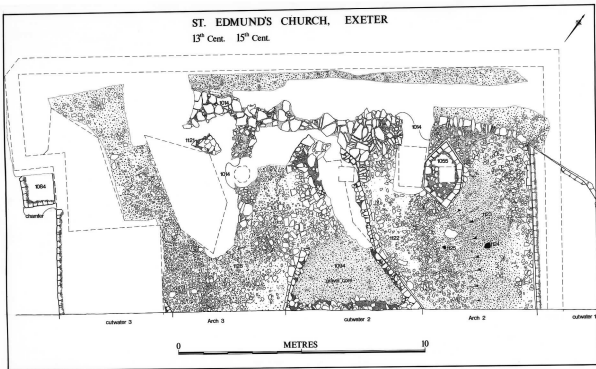

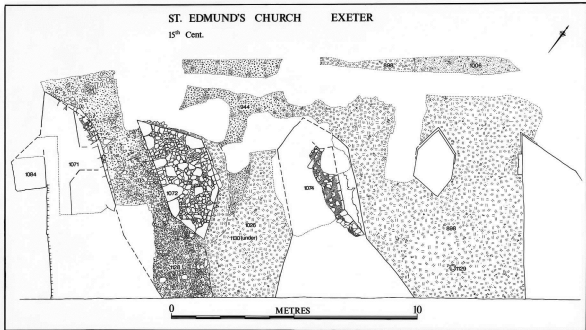

ST. EDMUND'S CHURCH      EXETER

16<sup>th</sup> Cent.

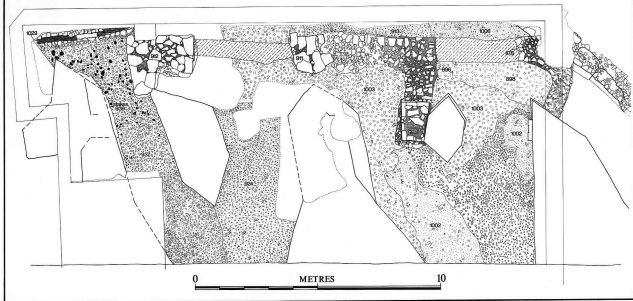



ST. EDMUNDS CHURCH, EXETER  
development

13th Cent.

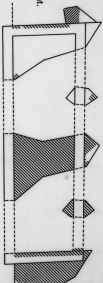

15th Cent.

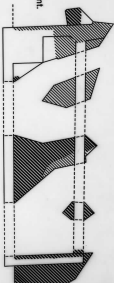

18th Cent.  
(Addition 1858)

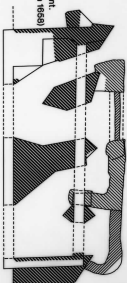

1834

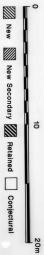
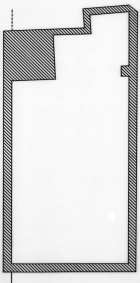

**FROG STREET  
TENEMENTS A and B  
Phase 1B**

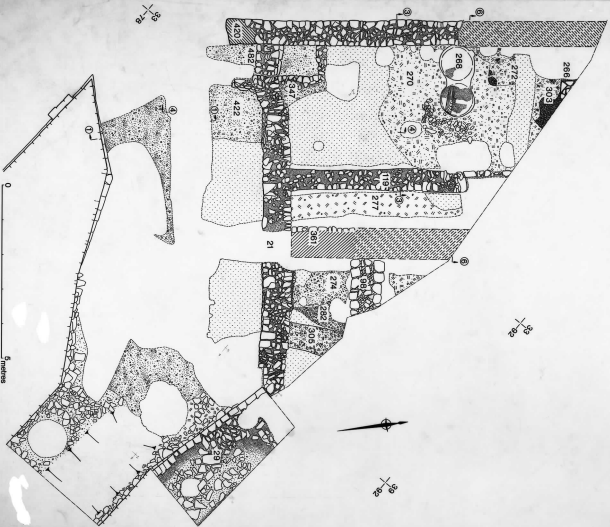

# FROG STREET TENEMENTS A and B

Phase 2



FROG STREET  
TENEMENTS A and B  
Phase 3



FROG STREET  
TENEMENT C  
Phase 1A



FROG STREET  
TENEMENT C  
Phase IB

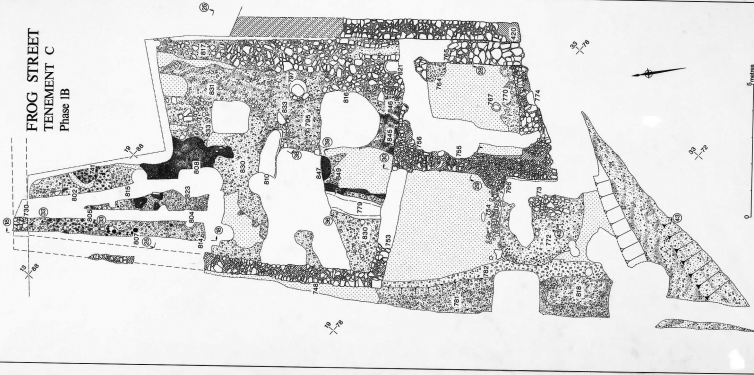

FROG STREET  
TENEMENT C  
Phase 2A



**FROG STREET  
TENEMENT C  
Phases 2A-E**

2B

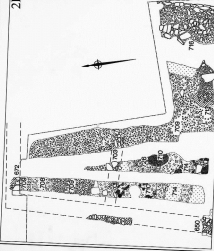

2A

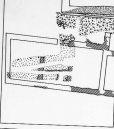

2B

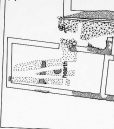

2C

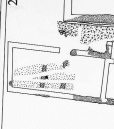

2D



2E



2C



2E

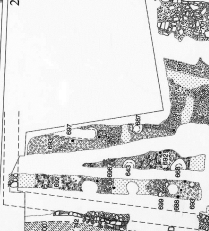

Legend:  
New  
Existing  
Proposed  
Structure  
Fences



FROG STREET  
TENEMENT C  
Phase 3A

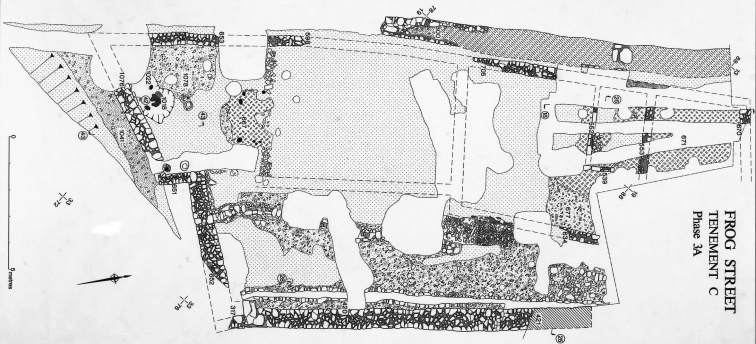

FROG STREET  
TENEMENT C  
Phase 2D

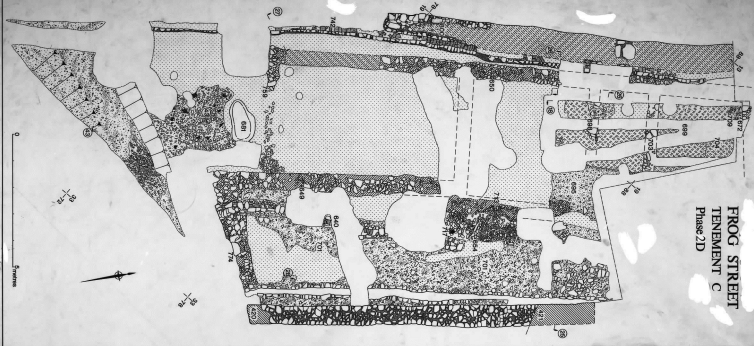

FROG STREET  
TENEMENT C  
Phase 3B

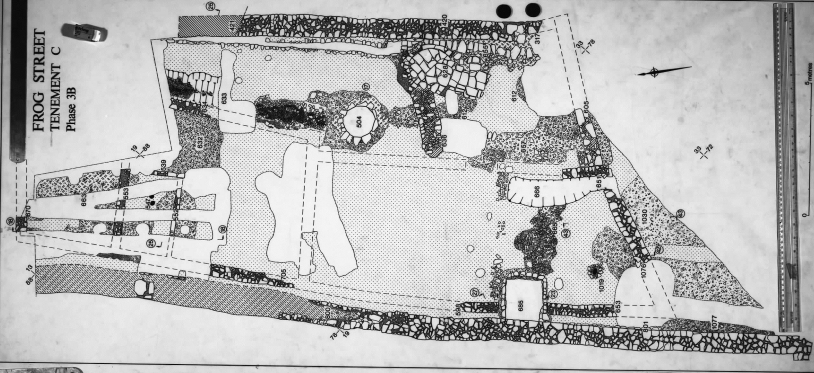

1/8" = 1'-0"

FROG STREET  
TENEMENT C  
Phase 4

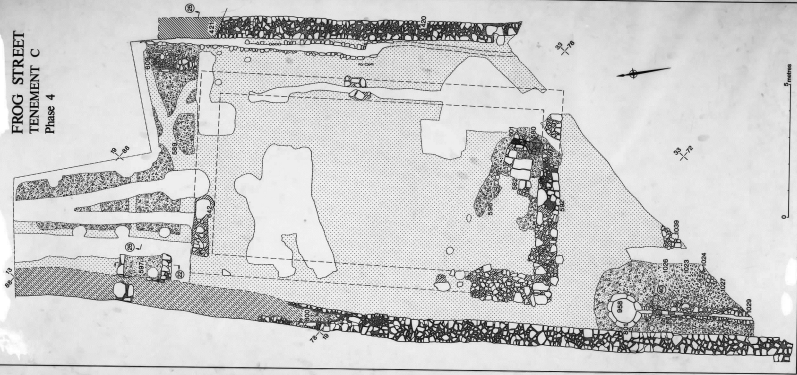

## EXETER : FROG STREET TENEMENTS

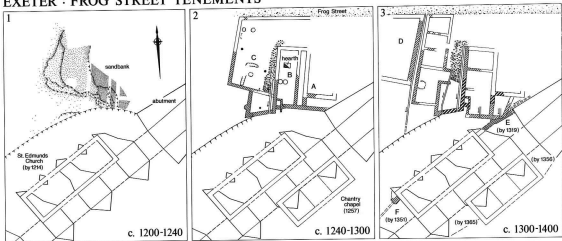

# EXETER : FROG STREET TENEMENTS

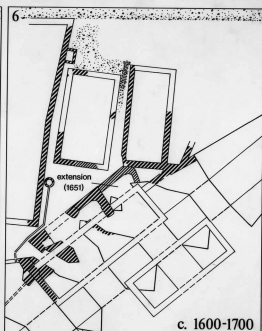
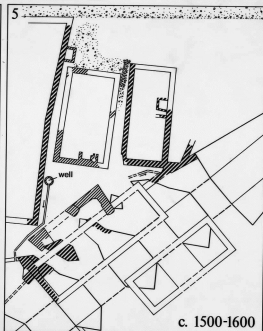
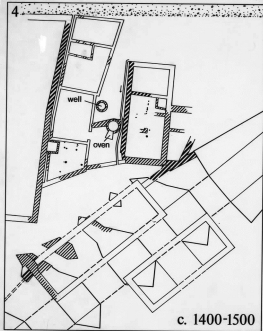

New
  New Secondary
  Retained
  Conjectural (except bridge)

0 

 30m

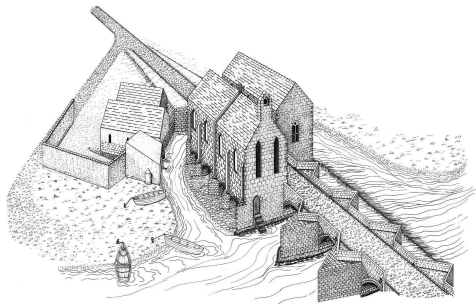

0

29

20

cm

### MEDIEVAL EXE BRIDGE EXETER

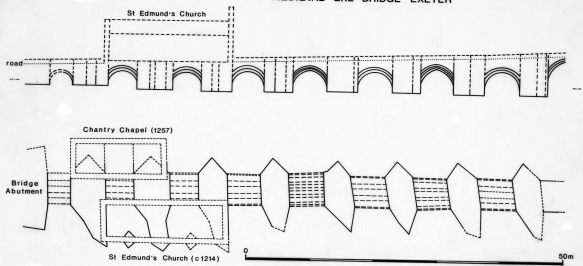



**Hurdle of green hazel,  
willow, and sallow.**

Found below construction layers of bridge.

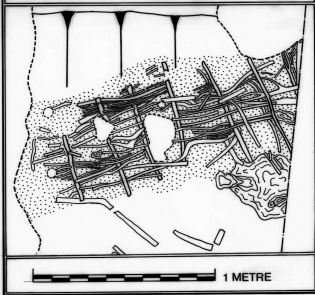

IDGE





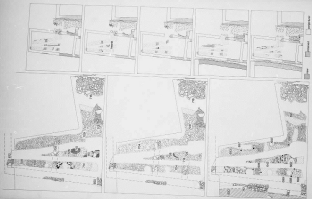









# PRESENT REMAINS

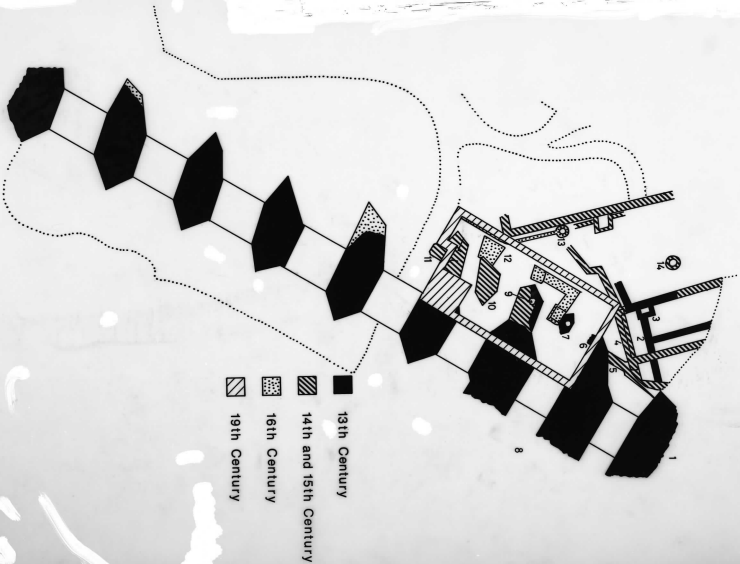



0 5 10 20

ACTUAL SITE

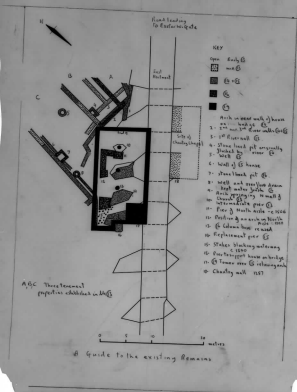

EGYPT 01 51

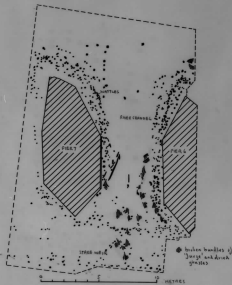

1. Plan of the site showing the layout of the towers and the surrounding area. The towers are labeled 'TOWER' and 'TOWER'. The plan includes a scale bar at the bottom indicating 0, 5, 10, and 20 METERS. A north arrow is in the top left. The plan is labeled 'EGYPT 01 51'.

Fig 1

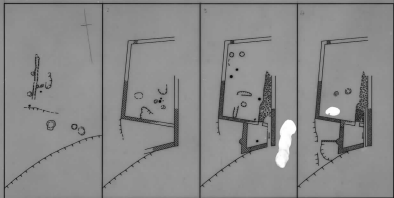
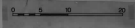

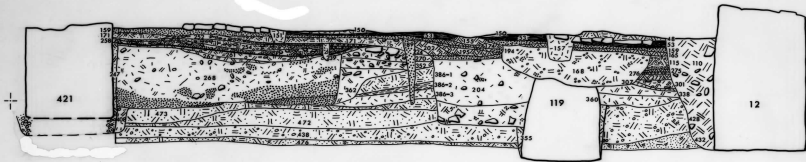

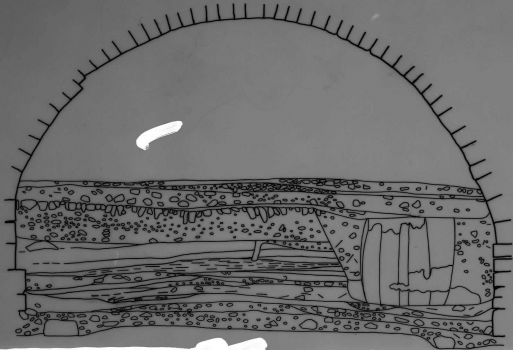

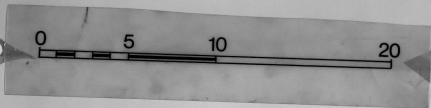
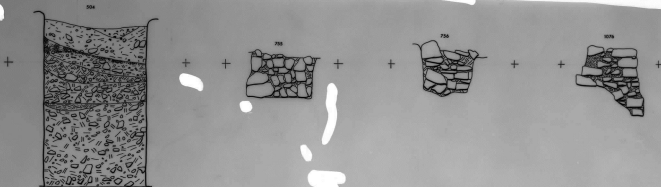



1056

1073



420



1119

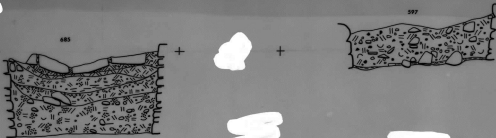



# EXETER, EXE BRIDGE 1975-9

Sections

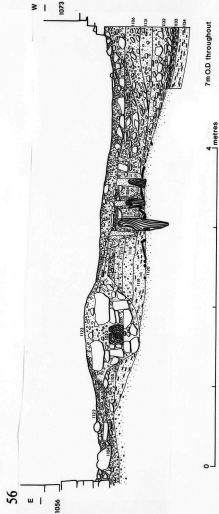

# EXETER, EXE BRIDGE 1975-9

## Tenement B, Sections

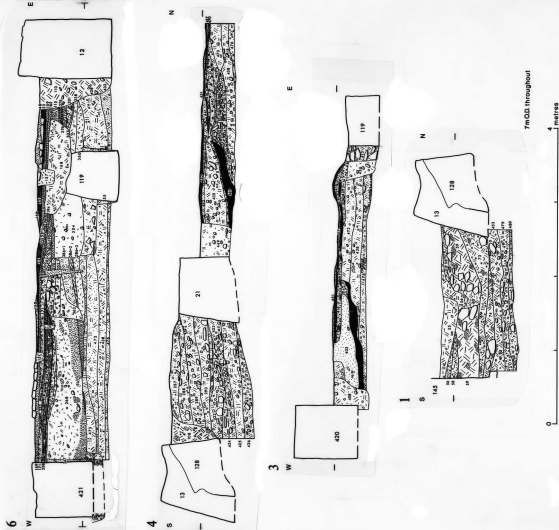

EXETER, EXE BRIDGE 1975-9  
Tenement C, Sections

43



17

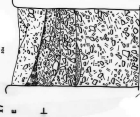

29



30



42



22



23



26



27



28



w 40



36

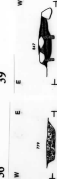

39



38



33

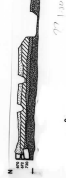

37



Fin OD throughout



fig 32

50



**EXETER. EXE BRIDGE 1975-9**  
 Tenement C, Sections

18

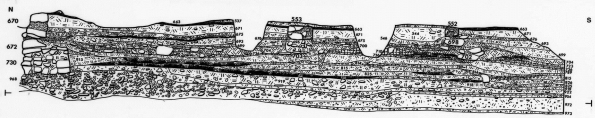

25

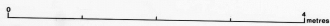
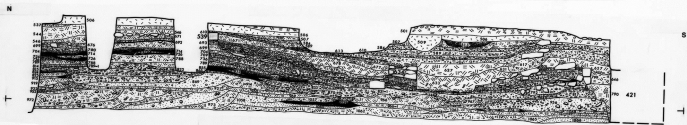

7m OD. throughout

18

25