

**SUFFOLK**  
**ARCHAEOLOGY**

• A HISTORY OF EXPERTISE •

**Beyton House Coach  
House,**  
Beyton, Suffolk  
BEY 016

**Client: Brown and Scarlett Architects on  
behalf of client**

**Date:**  
April 2015

Archaeological Monitoring Report  
SACIC Report No. 2015/23  
Author: Linzi Everett  
© SACIC





## HER Information

---

**Site Code:** BEY 016  
**Site Name:** Beyton House Coach House  
**Report Number** 2015/23  
**Planning Application No:** 1641/13  
**Date of Fieldwork:** October 2014  
**Grid Reference:** TL 9359 6246  
**Oasis Reference:** suffolka1- 208080  
**Curatorial Officer:** Richard Hoggett  
**Project Officer:** Linzi Everett  
**Client/Funding Body:** Brown and Scarlett Architects on behalf of client

Digital report submitted to Archaeological Data Service:

<http://ads.ahds.ac.uk/catalogue/library/greylit>

Prepared By: L. Everett

Date: April 2015

Approved By: Rhodri Gardner

Position: Contracts Manager

Date:

Signed:



# Contents

---

## Summary

<b>1. Introduction and methodology</b>	<b>1</b>
<b>2. Geology and topography</b>	<b>1</b>
<b>3. Archaeology and historical background</b>	<b>3</b>
<b>4. Results</b>	<b>3</b>
<b>5. Discussion</b>	<b>4</b>
<b>6. Bibliography</b>	<b>6</b>

## List of Figures

Figure 1. Site location, including HER entries	2
Figure 2. Floor plan of the coach house	4

## List of Plates

Plate 1. Stripped ground level	5
Plate 2. Drain run	5

## Appendices

Appendix I. WSI	7
Appendix II. OASIS summary	11



## **Summary**

Archaeological monitoring of ground level reduction was undertaken at Beyton House, Beyton, as a condition of a planning consent to develop the former coach house. A short drain run revealed clean natural subsoil but elsewhere, the stripped surface comprised only a loose imported sub-base.





## **1. Introduction and methodology**

---

Archaeological monitoring of groundworks associated with the conversion of a mid 19th century coach house was carried out at Beyton House, Beyton (BEY 016; TL 9359 6246). The proposed development area (hereafter referred to as 'the site') consisted of a brick and flint rubble built coach house, latterly used as a garage, facing Beyton House to the south.

The monitoring was a condition of planning consent for development, due to the sites location within an area of archaeological potential (see Paragraph 2.1, Suffolk County Council Archaeological Service (SCCAS) Brief). Fieldwork was carried out according to a Brief issued by Richard Hoggett of the SCCAS Conservation Team which outlined the manner of the fieldwork, and a Written Scheme of Investigation (WSI) detailing the archaeological methodology (Appendix I).

The archaeological monitoring was commissioned by Brown and Scarlett Architects (on behalf of a client).

The site has been given the County Historic Environment Record (HER) code BEY 016, under which all elements of the site archive are identified. An OASIS record (for the Archaeological Data Service) has been initiated and the reference code suffolka1-208080 has been used for this project.

## **2. Geology and topography**

---

The site lies within the grounds of Beyton House which is situated on the southern edge of Beyton parish. The area as a whole lies on a slight slope from the west down to the east/south-east, being part of a series of slight undulations within the landscape.

The drift geology of the area consists of superficial deposits of Lowestoft Formation sand and gravel, overlying bedrock Crag group sand. On site the geology presented itself as mid orange sandy-clay with moderate sub-angular flint content, and greyish-yellow clay with patches of chalk flecks and moderate levels of flint.

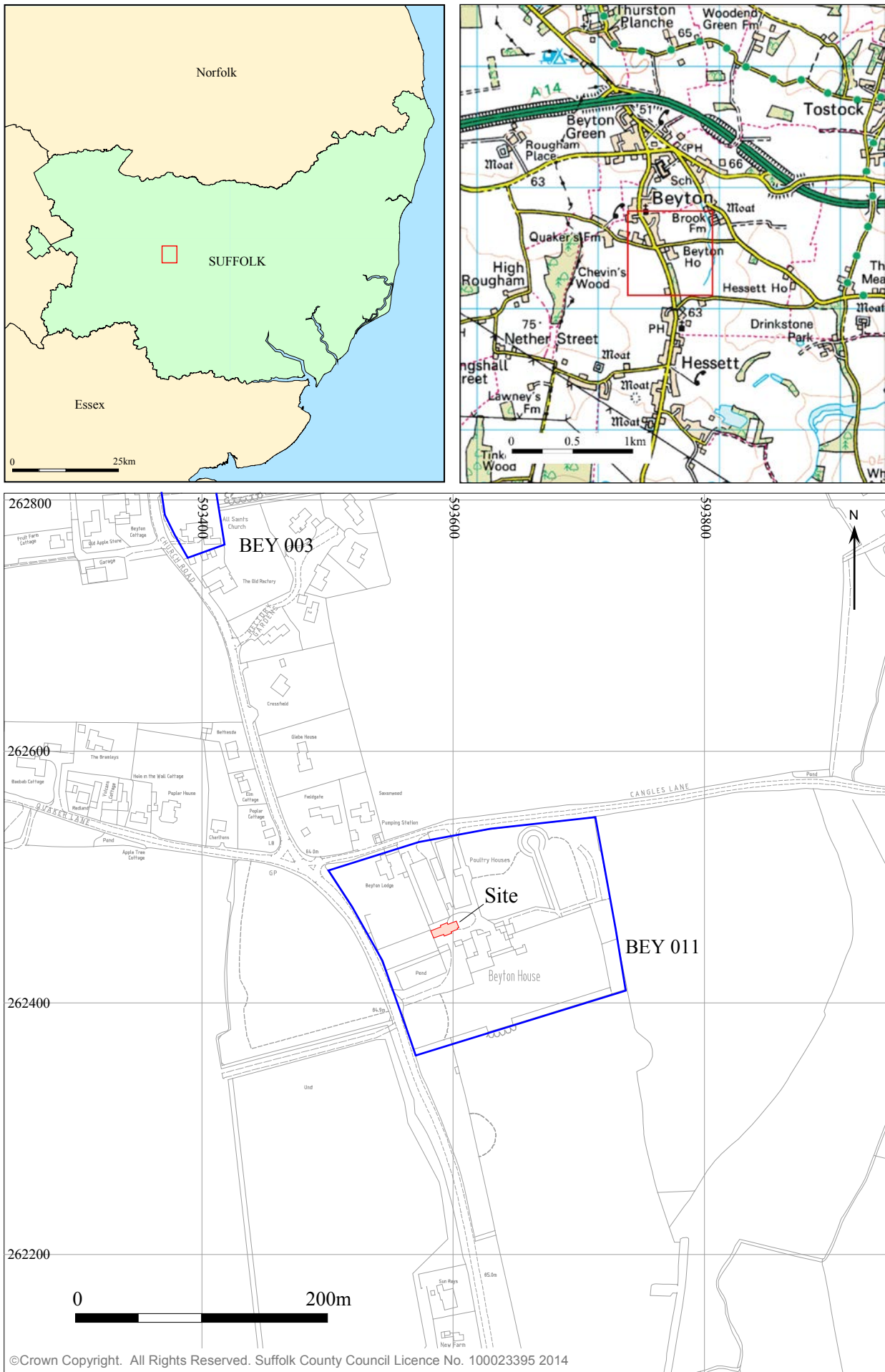

Figure 1. Site location, including HER entries

### **3. Archaeology and historical background**

---

The coach house is a former stable block associated with Beyton House which adjoins or overlies a possible infilled moat which enclosed or partly enclosed an earlier large house (BEY 011). The site was the subject of a standing building report by Leigh Alston in 2013. The coach house does not appear on the tithe map of 1838 but is shown on the 1st edition Ordnance Survey map of 1884. It is believed to have been built during the 1850's as dressed medieval masonry incorporated into the fabric is likely to have been sourced from the parish church when its nave was rebuilt in 1854. (Alston, 2013)

The property is located on the southern fringe of the current village core, on the south east corner of a crossroads close to the Hessett parish boundary. As well as occupying part of a probable moated site, it lies close to the medieval church (BEY 003), a probable post-medieval boundary ditch (BEY 010) and a 17th century farm house (BEY 001). There was therefore believed to be high potential for post-medieval, medieval and earlier occupation deposits on the site.

The Suffolk Landscape Character assessment defines the area from Woolpit and Thurston in the north, to Leavenheath and Polstead in the south, and including Beyton, as ancient rolling farmlands. These have a settlement pattern of 'dispersed farmsteads of medieval origin interspersed with some larger hamlets and occasional villages', within 'rolling clayland landscapes dissected, sometimes deeply, by river valleys' (SCC, 2012).

### **4. Results**

---

Approximately 0.25m of concrete and tiled floors were removed from the coach house, revealing a loose, sandy mortar sub-base layer (Plate 1). Removal of a narrow, brick lined drain at the west end of the former stable rooms showed clean boulder clay natural subsoil at a depth of c.0.2m from the stripped surface (Plate 2).

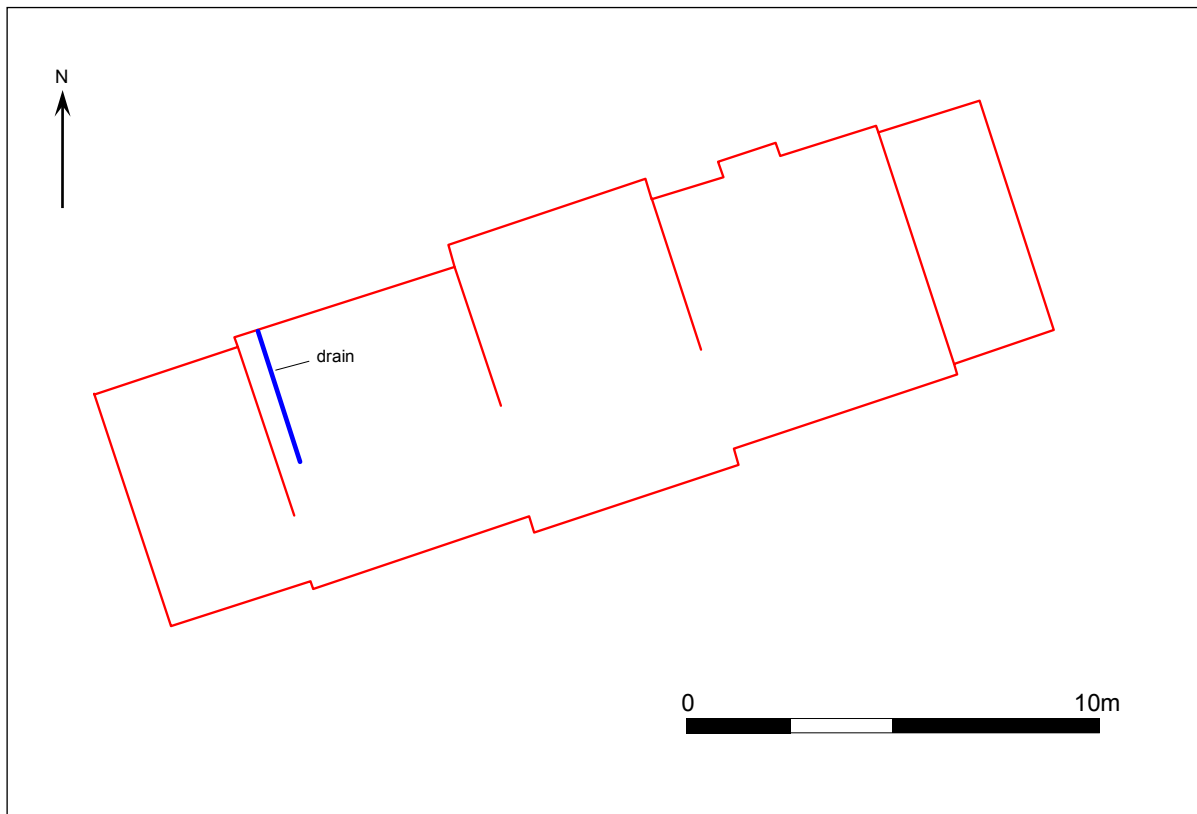

Figure 2. Floor plan of the coach house

## 5. Discussion

---

No archaeological evidence was observed during the monitoring as the groundworks did not cut through recent made up ground, except within the small drain run. As the groundworks were extremely limited, the negative results should not be seen as definitive evidence for the absence of archaeological deposits within the study area.





Plate 1. Stripped ground level



Plate 2. Drain run

## 6. Bibliography

---

Alston, L., 2013, Coach Houes and Stables, Beyton House Beyton: Historic Asset Assessment, Bury St Edmunds: SCCAS

SCC, 2012, Suffolk Landscape Character Assessment, information obtained from <http://www.suffolklandscape.org.uk/landscapes/Ancient-rolling-farmlands.aspx>, Ipswich: Suffolk County Council

Sims, J., 2012, Glebe House, Church Lane, Beyton, BEY 015, Archaeological Evaluation Report, SCCAS Report No. 2012/120, Bury St Edmunds: SCCAS



## WRITTEN SCHEME OF INVESTIGATION FOR ARCHAEOLOGICAL MONITORING

### Beyton House, Beyton, Suffolk

**PLANNING STATUS:** 1641/13 (mid Suffolk)

**GRID REF:** TL 9359 6246

**Suffolk HER No:** TBA

**SCCAS JOB CODE:** TBA

#### 1. Background

- 1.1 The Field Team of the Suffolk County Council Archaeological Service (SCCAS) has been asked to provide a Written Scheme of Investigation for the archaeological monitoring and recording of groundwork associated with the conversion and extension at the above site.
- 1.2. The project design has been produced for Patrick Stephenson of Brown and Scarlett Architects (on behalf of a client) and follows a Brief and Specification from Richard Hoggett of the Suffolk County Council Archaeological Service Conservation Team.
- 1.3. An allowance has been made to cover the projected cost of this work and the relevant estimate has been sent alongside this WSI.

#### 2 Project Aims

- 2.1 To produce a permanent record of the site in an archive that will be deposited with Suffolk HER.
- 2.2 The site will be recorded under a new HER site code. An OASIS form will be initiated prior to the start of fieldwork and a .pdf version of the report uploaded on to the website <http://ads.ahds.ac.uk/catalogue/library/greylit> for immediate release

#### 3 Monitoring of Ground works: method statement

- 3.1 An experienced field archaeologist from SCCAS Field Team will be in constant attendance whilst all potentially damaging groundworks excavations are completed.

- 3.2** Any archaeological features exposed during the work will be sectioned by hand with sampling at a normal standard for medieval and earlier deposits (i.e. 100% of structural features or graves/cremations, 50% of contained features e.g. pits, and 10-20% of linear features). Deposits will be sampled for environmental material as appropriate (and as suggested by EAA Occ. Paper Research Agenda- Environmental Archaeology). If thought appropriate and of archaeological benefit a metal detector search of exposed surfaces and spoil will be undertaken.
- 3.3** Site records will be made on SCCAS pro forma context sheets under a continuous and unique numbering system and conventions compatible with the county Historic Environment Record will be used throughout the monitoring. Site plans will be drawn at 1:20 or 1:50 as appropriate and sections at 1:10 or 1:20 (all on plastic drawing film) and related to the OS map cover. A photographic record of the site and any archaeological features will be kept using digital images, and monochrome images where appropriate. The site will be registered within the OASIS system as is normal for the county, if the monitoring results merit it.
- 3.4** A Ministry of Justice licence for removal of human remains will be obtained if necessary (any such find would require work in that part of the site to stop until the human remains have been recorded/removed). However this is unlikely to happen on this site.

#### **4 Report/Archive**

- 4.1** All site and finds records will be entered onto Microsoft Access databases and will be archived in paper and electronic form. Site plans and sections will be inked up or digitised for report and archive purposes.
- 4.2** All finds will be processed at Shire Hall, Bury St Edmunds, to minimum standards laid down by the relevant finds groups (e.g. Roman Pottery Research Group) and stored in archive stable bags/boxes. Metal finds will be x-rayed if appropriate and stabilised as necessary to ICON standards. Environmental samples will be processed and assessed by a recognised regional contractor. It is anticipated that finds will be deposited in the County Store for future reference.
- 4.3** A full monitoring report summarising all the findings and containing a full assessment of all finds and samples will be produced and copies submitted to the client, the Conservation Team at Suffolk CC and the county HER. The report will contain all appropriate scale plans and sections. The monitoring report will contain a recommendation for further analysis and publication of the results as appropriate and in accordance with regional research agendas and strategies (EAA Occ. Papers 3&8). The report will form the basis for full discharge of the relevant condition.
- 4.4** A full project archive will be submitted to the County Store and every effort will be made to ensure that the landowner agrees to the deposit of all the finds (the Field Team will take responsibility to report any finds which might qualify under the Treasure Act 1996). The archive will be in paper and electronic form. A



summary of the project findings will also be produced. The landowner/developer will receive copies of the report with all finds fully listed

## **5 On completion of the work**

- 5.1** Hard copies and a single pdf file on CD of the report will be submitted to SCC Conservation Team.
- 5.2** The project archive will be submitted to Suffolk HER (a fixed charge for the deposition of the archive is included in the costing).
- 5.3** The oasis record will be completed and a pdf version of the report uploaded for immediate release.

## **6 Risk Assessment**

- 6.1** Work in a rural location close to operating mechanical plant. **Medium Risk.**
- 6.2** For single person working Suffolk County Council operates a 'reporting-in' procedure at the middle and end of each day.
- 6.3** Site staff will wear protective clothing at all times on site (hard hat, high visibility vest, steel-toe cap boots). The PO will report to the main contractor/developer at the beginning of each site visit. All staff hold CSCS cards.
- 6.4** Vehicles will be parked in a safe location.
- 6.5** A fully charged mobile phone will be on site at all times.
- 6.6** Site staff will be aware of the location of the nearest A&E unit and a vehicle will be on site at all times. It is likely that the relevant PO will be a qualified First Aider.
- 6.7** Suffolk County Council holds full insurance policies for field work (details on request).



**OASIS ID: suffolka1-208080****Project details**

Project name	BEY 016 Beyton House Coach House, Beyton
Short description of the project	Archaeological monitoring of ground level reduction was undertaken at Beyton House, Beyton, as a condition of a planning consent to develop the former coach house. A short drain run revealed clean natural subsoil but elsewhere, the stripped surface comprised only a loose imported sub-base.
Project dates	Start: 01-10-2014 End: 02-04-2015
Previous/future work	Yes / Not known
Any associated project reference codes	1641/13 - Planning Application No.
Any associated project reference codes	BEY 016 - HER event no.
Type of project	Recording project
Site status	None
Current Land use	Other 2 - In use as a building
Monument type	DRAIN Modern
Significant Finds	N/A None
Investigation type	"Watching Brief"
Prompt	Direction from Local Planning Authority - PPS

**Project location**

Country	England
Site location	SUFFOLK MID SUFFOLK BEYTON BEY 016 Beyton House Coach House
Study area	200.00 Square metres
Site coordinates	TL 9359 6246 52.2257854194 0.834782361762 52 13 32 N 000 50 05 E Point

**Project creators**

Name of Organisation	Suffolk Archaeology CIC
Project brief originator	Local Planning Authority (with/without advice from County/District Archaeologist)
Project design originator	Richard Hoggett
Project director/manager	Rhodri Gardner
Project supervisor	Linzi Everett
Type of sponsor/funding body	Architect
Name of sponsor/funding	Brown and Scarlett Architects

body

---

### Project archives

Physical Archive Exists?	No
Digital Archive recipient	ADHS
Digital Archive ID	BEY 016
Digital Contents	"none"
Digital Media available	"Images raster / digital photography","Text"
Paper Archive recipient	Suffolk HER
Paper Archive ID	BEY 016
Paper Contents	"none"
Paper Media available	"Correspondence","Photograph","Unpublished Text"

---

### Project bibliography 1

Publication type	Grey literature (unpublished document/manuscript)
Title	BEY 016 Beyton House Coach House
Author(s)/Editor(s)	Everett, L.
Other bibliographic details	2015/23
Date	2015
Issuer or publisher	SACIC
Place of issue or publication	Needham Market



Suffolk Archaeology CIC  
Unit 5 | Plot 11 | Maitland Road | Lion Barn Industrial Estate  
Needham Market | Suffolk | IP6 8NZ  
[Rhodri.Gardner@suffolkarchaeology.co.uk](mailto:Rhodri.Gardner@suffolkarchaeology.co.uk)

01449 900120  
[www.suffolkarchaeology.co.uk](http://www.suffolkarchaeology.co.uk)

