



## **2 Old Mill Lane, Edinburgh**

### **Archaeological Watching Brief**

**Authors: Samira Hill MA MSc**  
**Illustrations: Ian Hill BSc MSc**

Heritage and Archaeological Research Practice  
Conference House  
152 Morrison Street  
The Exchange  
Edinburgh  
EH3 8EB

## **CONTENTS**

<b>1. INTRODUCTION .....</b>	<b>3</b>
<b>2. METHODOLOGY .....</b>	<b>5</b>
<b>3. ARCHAEOLOGICAL RESULTS.....</b>	<b>7</b>
<b>4. DISCUSSION AND CONCLUSIONS.....</b>	<b>9</b>
<b>5. APPENDICES .....</b>	<b>10</b>

## **ILLUSTRATIONS**

<b>Fig. 1 – Site Location Map.....</b>	<b>4</b>
<b>Fig. 2 – Trench Location Plan and Location of Deposits.....</b>	<b>12</b>
<b>Fig. 3 – SE Facing Section Showing Transition from Garden Soil (005) to Rubble (002).....</b>	<b>13</b>
<b>Fig. 4 – SW Facing Elevation of Wash House Foundations (004).....</b>	<b>13</b>
<b>Plate 1 – SW Facing Elevation of Wash House Foundations (004).....</b>	<b>13</b>

# **1. INTRODUCTION**

## **1.1 General**

1.1.1 Heritage and Archaeological Research Practice Limited (HARP) were commissioned by Forth Property Management to carry out a programme of archaeological works at the location of a proposed extension to the rear of 2 Old Mill Lane, Edinburgh in order to fulfill an archaeological condition as part of planning consent (Centred 327325 670719). The works consisted of an archaeological watching brief to monitor ground breaking associated with the development. This report presents the findings of the watching brief.

1.1.2 The development area is located in the garden to the rear of 2 Old Mill Lane in the Cameron Toll/Liberton area of Edinburgh (see Fig. 1). The site consisted of mainly concrete paving, a low garden wall and a small washhouse that was demolished prior to the construction of the extension.

1.1.3 Work was carried out between Wednesday 25<sup>th</sup> and Thursday 26<sup>th</sup> May 2012. The weather was fairly mixed and inclement.

## **1.2 Background**

1.2.1 There is potential for buried archaeological remains in the area due to the location of the site within the bounds of the historic settlement of Neither Liberton. The site lies within the historic limits of Neither Liberton, which has been recorded as far back as 1369.

1.2.2 Much of the post-medieval layout of the village still survives, centred upon the 18<sup>th</sup> century Neither Liberton House and Neither Liberton Mill (to the west & east of this site) and this layout can clearly be seen on both the 1853 1<sup>st</sup> Edition OS map and the earlier eighteenth century (c.1750) Military Survey by General Roy.

1.2.3 Whilst the scale of the development is small there is clearly a potential for buried archaeological remains within the development area.

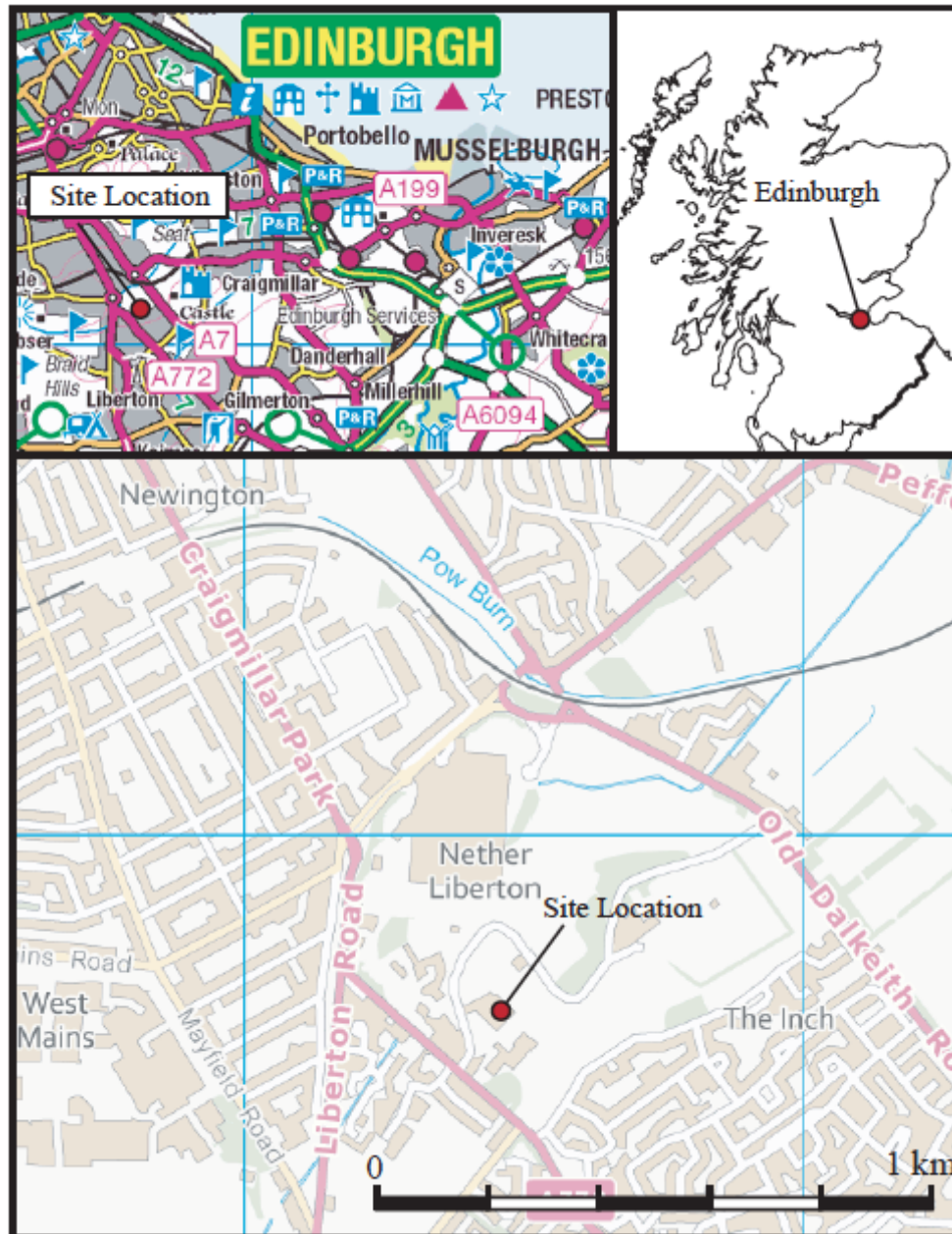

**Fig.1 Site Location Map**

## **2. METHODOLOGY**

### **2.1 General**

2.1.1 All work undertaken by HARP was conducted with regard to the Institute of Field Archaeologists' (IFA) *Standard and Guidance for an Archaeological Watching Brief* and *Code of Conduct*.

### **2.2 Watching Brief Strategy**

2.2.1 The Watching Brief was carried out under strict archaeological monitoring during the ground-breaking works associated with the foundations for the proposed extension in order to identify any potential buried archaeological remains. Foundation trenches were excavated to the rear of 2 Old Mill Lane and were 0.8m wide and up to 0.83m deep (see Figure 2 for trench locations). All ground-breaking that was carried out by aid of machine excavators was done so with a smooth-bladed ditching bucket to remove modern overburden, under constant archaeological supervision.

2.2.2 Any archaeological features such as linear features or pits uncovered were excavated by hand and recorded. Structural remains such as walls were cleaned and recorded by drawing and photography.

2.2.3 Bulk samples of any features of archaeological interest were taken in order to establish their likely date, nature, extent and condition. All such sample excavation was conducted by hand. Bulk samples consisted of a minimum of 10 litres, unless the feature was smaller than this, in which case a minimum of 50% of the feature was sampled.

2.2.4 All excavation and on-site recording was carried out according to standard HARP procedures, principally by drawing, by photography and by completing standard HARP record forms.

### 3. ARCHAEOLOGICAL RESULTS

#### 3.1 General

3.1.1 A list of all archaeological contexts including descriptions can be found in Appendix 1. All Appendices are to be found in section 5.

3.1.2 All numbers in bold and parentheses in the following sections correspond to context numbers listed in the Appendices. Context numbers in rounded parentheses refer to deposits, whilst those in square parentheses refer to cuts for features.

3.1.3 Excavation revealed two distinct deposit types within the garden, split into the north east and south west halves of the foundation trenches (Figure 2). The north eastern half consisted of a rich grey-brown garden soil **(005)** that contained occasional modern debris and pipes associated with the wash house that had been previously demolished. This generally continued to a depth of 0.4m deep. It overlay a dark brown silty clay subsoil layer **(003)** that continued to a depth of 0.3m. **(003)** overlay a mid orange-brown clayey sand natural **(006)** (see Figure 3).

3.1.4 The south western half of the foundation trench consisted of modern concrete paving **(001)** overlying a rubble bedding deposit **(002)** for the paving, which consisted of small and medium stones with occasional bricks and mortar fragments. This deposit continued to a depth of 0.3m and overlay the garden soil **(005)** noted in the north eastern half of the foundation trench (see Figure 3).

3.1.5 The only feature of note uncovered during excavations was the foundations for a mortar bonded stone built wall **(004)** running north west to south east. The wall remains were 0.5m thick, 0.37m and three courses high and a length of 0.8m (see Plate 1), the remains continued beyond the edges of the



trench. The remains however were part of the foundations of the washhouse that had been demolished previously.



**Plate 1 – South West Facing Elevation of Wash House Foundations (004)**



## **4. DISCUSSION AND CONCLUSIONS**

### **4.1 General**

4.1.1 No archaeologically significant remains were uncovered during excavations at 2 Old Mill Lane. Deposits that were revealed consisted of garden soil and modern building remains. The only feature revealed were parts of the foundations of the modern washhouse that had been previously demolished.

4.1.2 No remains relating to the post-Medieval village of Neither Liberton were revealed, however it must be noted that the nature of the excavations were small scale and localised.

## 5. APPENDICES

### Appendix 1

#### Context Register

Context No.	Description	Interpretation	Stratigraphic Relationship
001	Concrete	Modern concrete paving slabs	Above (002)
002	Rubble deposit with mortar and brick fragments	Bedding deposit for paving slabs	Below (001)
003	Dark brown silty clay with charcoal flecks	Build up of subsoil	Above (006)
004	Mortar bonded stone wall	Foundations for modern Wash House	Above (003)
005	Dark grey-brown sandy silt	Garden soil	Above (003)
006	Mid orange-brown clayey silt	Natural	Below (003)

### Appendix 2

#### Photographic Register

##### *Colour Slide Film 1*

Photo Number	Description	Taken From	Conditions
1	SW Facing Elevation of Wall (004)	SW	O/C
2-3	SE Facing Section of Western Foundation Trench at house	SE	O/C
4-5	SW Facing Section of Foundation Trench	SW	O/C
6-7	SE Facing Section of Western Foundation Trench showing Transition from Rubble (002) to Garden Soil (005)	SE	O/C
8-9	General View of Excavation Area	SE	O/C
10-11	General View of Excavation Area	N	O/C
12-13	General View of Excavation Area	W	O/C
14-15	General View of Excavation Area	S	O/C

### *Digital Register*

<b>Jpeg Number</b>	<b>Description</b>	<b>Taken From</b>	<b>Conditions</b>
5214	SW Facing Elevation of Wall (004)	SW	O/C
5215	General Shot of Wall (004)	NW	O/C
5217	SW Facing Section of Foundation Trench	SW	O/C
5218	SE Facing Section of Western Foundation Trench showing Transition from Rubble (002) to Garden Soil (005)	SE	O/C
5219	SE Facing Section of Western Foundation Trench showing Transition from Rubble (002) to Garden Soil (005)	SE	O/C
5220	General shot of Western Foundation Trench	SE	O/C
5222	General shot of Foundation Trenches	N	O/C
5223	General shot of Foundation Trenches	W	O/C

### **Appendix 3**

#### **Drawing Register**

<b>Drawing No.</b>	<b>Sheet No.</b>	<b>Description</b>	<b>Section / Plan</b>	<b>Scale</b>
1	1	SE Facing Section of Western Foundation Trench at House	S	1:20
2	1	SW Facing Section of Foundation Trench	S	1:20
3	1	SE Facing Section of Western Foundation Trench Showing Transition from (002) to (005)	S	1:20
4	2	SW Facing Elevation of Wall (004)	S	1:20
5	2	Foundation Trench Location Plan	P	1:50

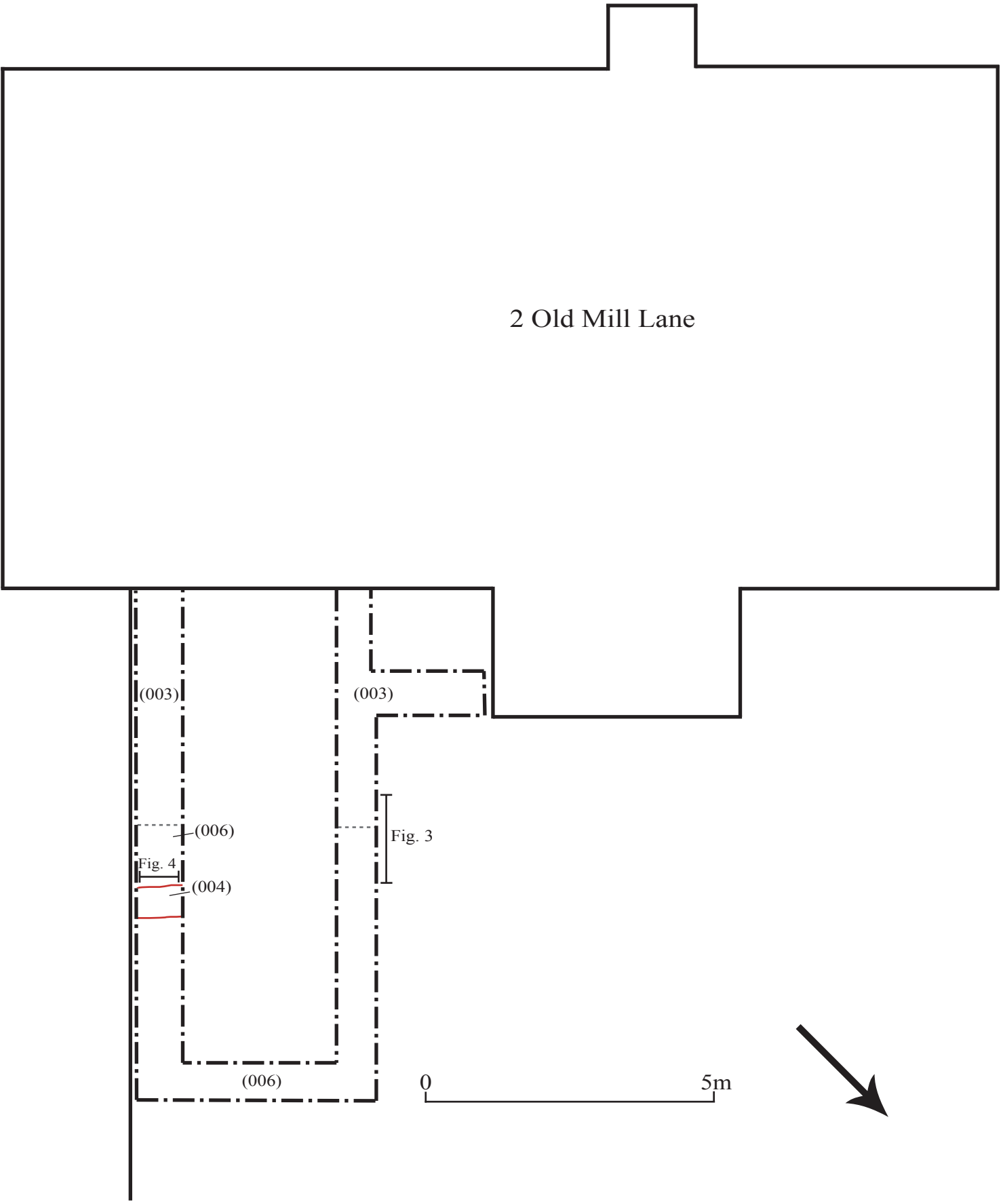

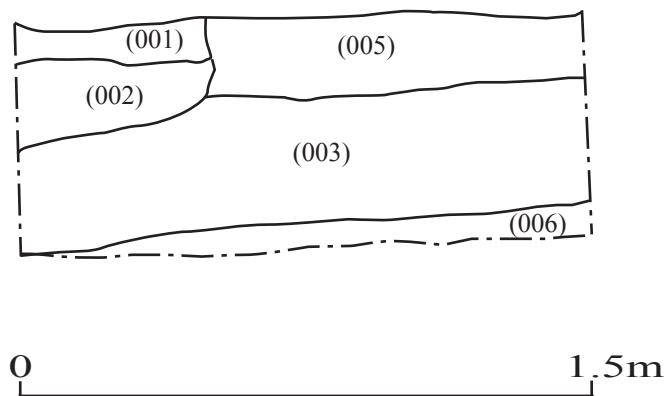

Fig.3 - SE Facing Section Showing Transition from Garden Soil (005) to Rubble Deposit (002)

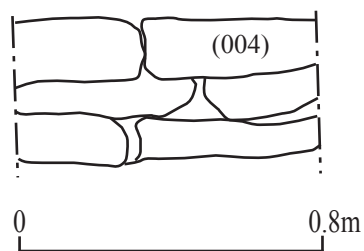

Fig.4 - SW Elevation of Wash House Foundations (004)