

<b>Site Name/Address:</b> 12-18 PUMP HILL, LOUGHTON, ESSEX IG10 1RU	
<b>Parish:</b> LOUGHTON	<b>District:</b> EPPING FOREST
<b>NGR:</b> TQ 42662 9709	<b>Site Code:</b> EPF 2449/13
<b>Type of Work:</b> TRIAL TRENCHING	<b>Site Director/Group:</b> ZOE ALLVEY SCHOFIELD
<b>Date of Work:</b> 24 <sup>TH</sup> JULY 2014	<b>Size of Area Investigated:</b> 14.4SQM OF 500 SQM
<b>Location of Finds/Curating Museum:</b> EPPING FOREST	<b>Funding source:</b> OWNER
<b>Further Seasons Anticipated?</b> NO	<b>Related EHCR No's:</b> 4061 & 18372
<b>Final Report:</b> EPF14	<b>OASIS number:</b> 186339

**Periods Represented:** 17<sup>TH</sup>/18<sup>TH</sup>/19<sup>th</sup>/20<sup>th</sup> Century

**SUMMARY OF FIELDWORK RESULTS:**

THE SITE IS LOCATED BETWEEN TWO NEIGHBOURING HOUSES IN A RESIDENTIAL STREET THAT CONTAINS SEVERAL LISTED BUILDINGS DATING TO 18<sup>TH</sup> CENTURY.

A SINGLE TRIAL TRENCH (1.2M X 12.0M) WAS CUT ACROSS THE CENTRAL AXIS OF THE PROPOSED DEVELOPMENT (DIRECTION NORTH – SOUTH) TO SUB SOIL DEPTH (70CM).

THERE WERE THREE LAYERS IN THE STRATIGRAPHY.

001 – SUB-SOIL (50CM)

002 – MIXED LAYER OF SUB-SOIL & NATURAL CLAY (10CM)

003 – NATURAL CLAY 10CM >

CONTEXT 001 WAS A DARK BROWN SOIL WITH A LOOSE, DRY CONSISTENCY AND ORGANIC, STONE, CONSTRUCTION AND HOUSEHOLD DEBRIS DEPOSITS.

CONTEXT 002 WAS A MIXED LAYER OF NATURAL SANDY CLAY AND SUB-SOIL WITH STONE AND CHARCOAL DEPOSITS.

CONTEXT 003 WAS NATURAL CLEAN SANDY CLAY WITH STONE DEPOSITS BUT NO EVIDENCE OF OCCUPATION.

CONTEXT 002 WAS A MIXED LAYER OF CONTEXTS 001 & 003 AND THE DEPOSITS IN CONTEXT 001 & 002 RANGED FROM 19<sup>TH</sup> TO 21<sup>ST</sup> CENTURY. INDICATING THAT THE SITE HAD SUFFERED PAST DISTURBANCE.

ONE SHERD OF LATE MEDIEVAL POTTERY AND SEVERAL SHERDS OF 18<sup>TH</sup> & 19<sup>TH</sup> CENTURY POTTERY SHERDS WERE FOUND UNSTRATIFIED IN THE SPOIL HEAP BUT THERE WERE NO FINDS IN SITU IN TRENCH 1.

STRATIGRAPHIC PRESENTATION AND SITE SURFACE AND SPOIL HEAP DEPOSITS INDICATED THAT THE SITE HAD SUFFERED SIGNIFICANT DISTURBANCE, PROBABLY DURING PAST CONSTRUCTION ACTIVITY.

SUMMARY OF FIELDWORK RESULTS:

THE SITE IS LOCATED BETWEEN TWO NEIGHBOURING HOUSES IN A RESIDENTIAL STREET THAT CONTAINS SEVERAL LISTED BUILDINGS DATING TO 18<sup>TH</sup> CENTURY.



THE CENTRAL AXIS OF THE SOIL DEPTH (70CM).

CONSISTENCY AND DEPOSITS. AND SUB-SOIL WITH STONE DEPOSITS BUT NO

AND THE DEPOSITS IN INDICATING THAT THE SITE

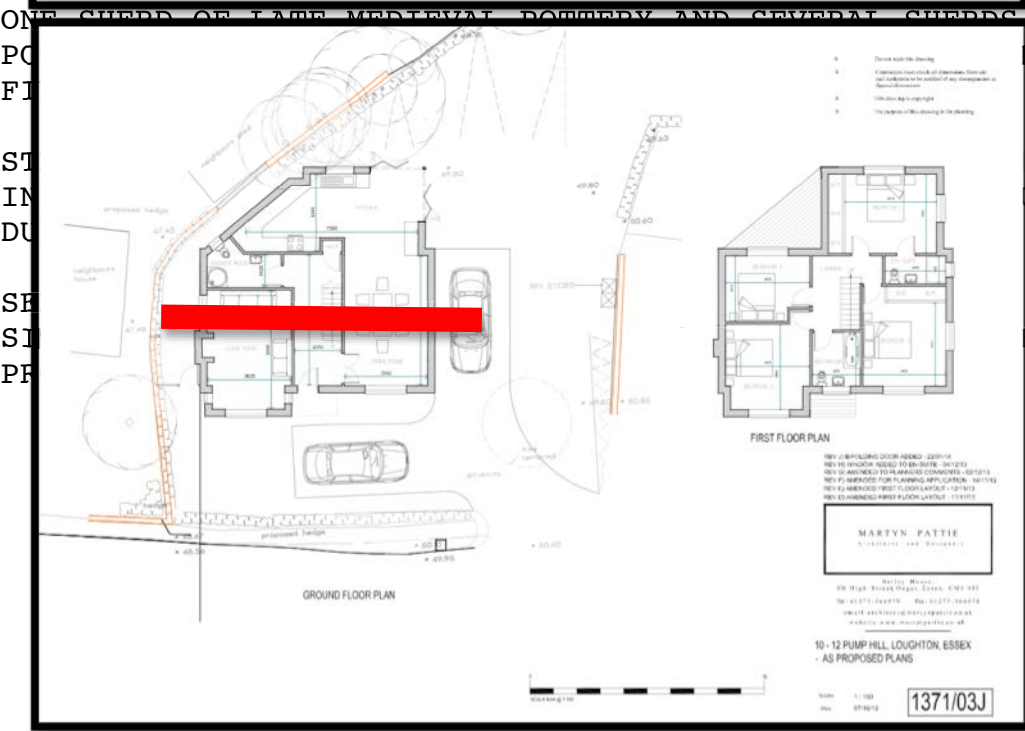

OF 18<sup>TH</sup> & 19<sup>TH</sup> CENTURY HEAP BUT THERE WERE NO

HEAP DEPOSITS OR BURNANCE, PROBABLY

CENTRAL AXIS OF