



C263 ARCHAEOLOGY CENTRAL Survey Report Archaeological Evaluation Connaught Tunnel (XSY11)

Document Number: C263-MLA-X-RGN-CR146_WS158-50002

Document History:

Version:	Date:	Prepared By:	Checked by:	Approved by:	Version History
1.0	03/05/12	C Drew (MOLA)	S Jones (MOLA)	D Divers (MOLA)	For CRL Review
		<i>C Drew</i>	<i>S Jones</i>	<i>DD</i>	

CROSSRAIL REVIEW AND ACCEPTANCE STATUS	
This decal is to be used for submitted documents requiring acceptance by CRL.	
<input checked="" type="checkbox"/>	Code 1. Accepted. Work May Proceed
<input type="checkbox"/>	Code 2. Not Accepted. Revise and resubmit. Work may proceed subject to incorporation of changes indicated
<input type="checkbox"/>	Code 3. Not Accepted. Revise and resubmit. Work may not proceed
<input type="checkbox"/>	Code 4. Received for information only. Receipt is confirmed
Reviewed/Accepted by: (signature)	<i>[Signature]</i>
Print Name:	S. CARVER
	Date: 4/19/12
Acceptance by CRL does not relieve the designer/supplier from full compliance with their contractual obligations and does not constitute CRL approval of design, details, calculations, analyses, test methods or materials developed or selected by the designer/supplier.	

This document contains proprietary information. No part of this document may be reproduced without prior written consent from the chief executive of Crossrail Ltd.

MOLA Survey Report for Crossrail

Event code / MOLA site code	XSY11
Sub-site division (if applicable)	Connaught Tunnel
Site Address	Victoria Dock Road / Connaught Road London
Type of archaeological fieldwork	Evaluation
Coordinate system	Crossrail London Survey Grid
Survey method and control	GPS survey and optical survey using GPS derived control
Survey date / surveyors	14/12/2011: Catherine Drew and Mark Burch 15/03/2012: Mark Burch and Gideon Simons 22/03/2012: Mark Burch and Gideon Simons 17/04/2012: Catherine Drew and Mark Burch
Derivation of vertical control	Levels collected by GPS for Trench 1 TBMs established by GPS for Trenches 2 and 3 TBM provided by on site surveyor for Trench 4
Values of TBMs	Trench 2: 101.80mATD & 102.14mATD Trench 3: 101.65mATD Trench 4: 101.85mATD
Additional information	Survey control coords (temporary control): 100: 91433.543 35422.737 101: 91417.719 35426.682 102: 92465.029 34549.106 103: 92449.194 34552.509
Digital deliverable metadata	Microstation dgn V8 format on LSG coordinates, in metres drawing units File Name : XSY11_archaeological_trenches.dgn

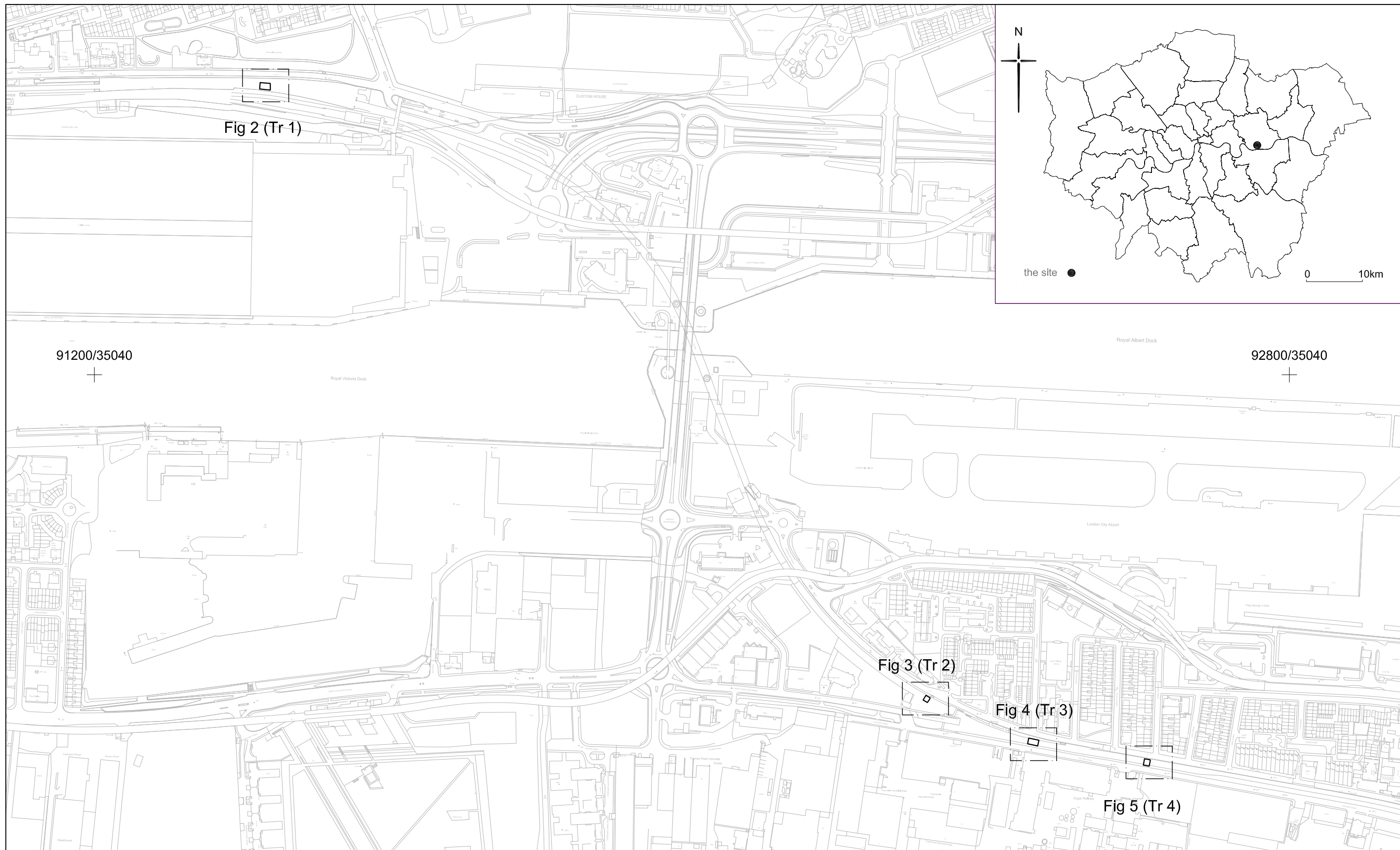

Fig 1: Index of survey report figures

Site code: XSY11

Figure type: Survey report (1/5)

Based upon the Ordnance Survey mapping with the permission of the Controller of Her Majesty's Stationery Office © Crown Copyright. Unauthorised reproduction infringes Crown Copyright and may lead to prosecution or civil proceedings. TFL 100032379 2010.

Type of fieldwork:

Evaluation

Site Address:

Crossrail: C263 Connaught Tunnel,
Victoria Dock Road,
London

□ Trench edge

□ Location of additional figures

1:5000 @ A3

0 250m

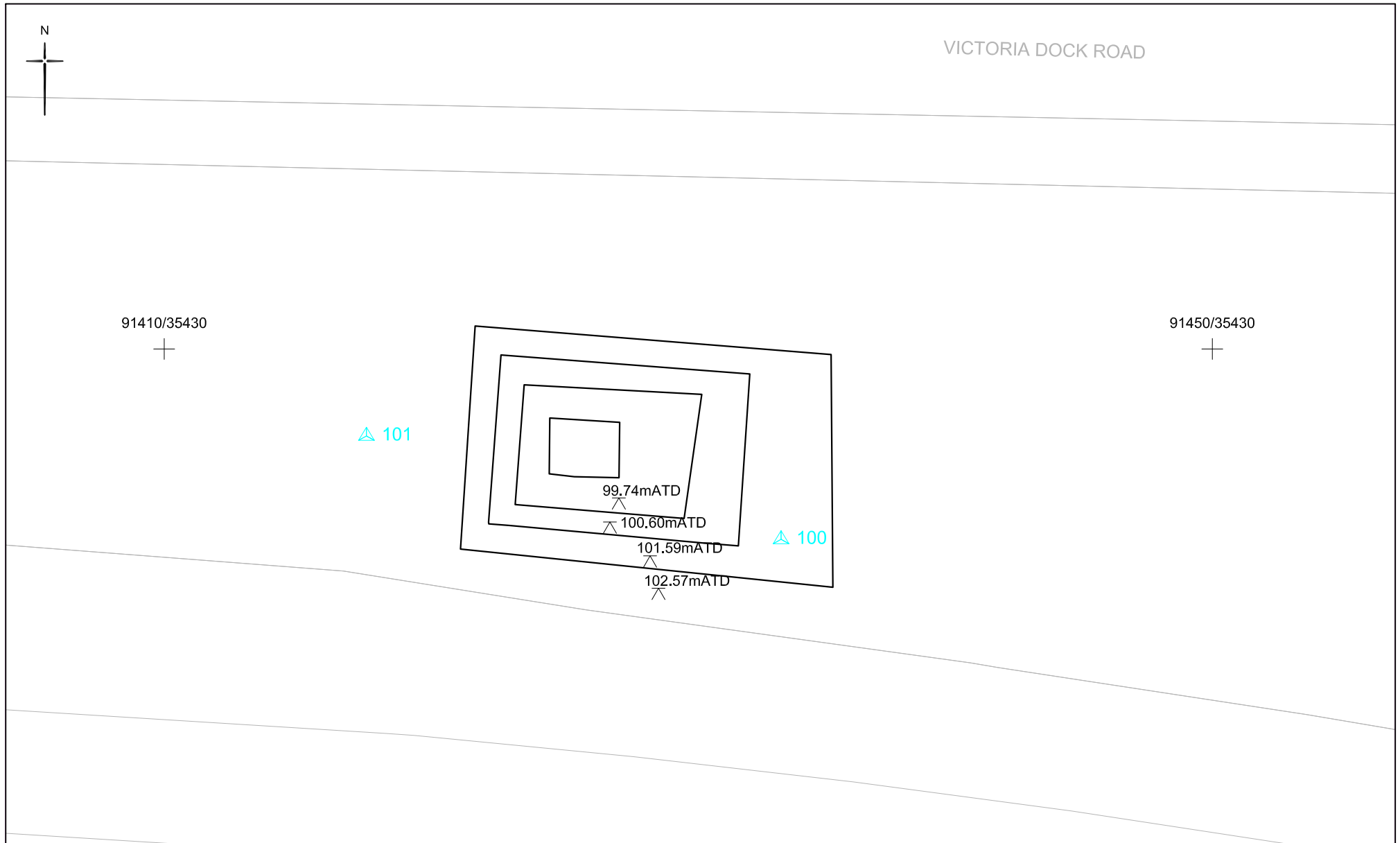
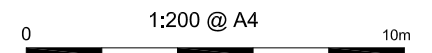

Fig 2: Trench 1
 Site code: XSY11
 Figure type: Survey report (2/5)

Based upon the Ordnance Survey mapping with the permission of the Controller of Her Majesty's Stationery Office © Crown Copyright. Unauthorised reproduction infringes Crown Copyright and may lead to prosecution or civil proceedings. Tfl. 100032379 2010.

Type of fieldwork:
 Evaluation
 Site Address:
 Crossrail: C263 Connaught Tunnel,
 Victoria Dock Road,
 London

- Trench edge
- ▲ 10.24mOD TBMs
- ▲ 100 GPS derived control
- ▲ 102.57mATD GPS derived levels



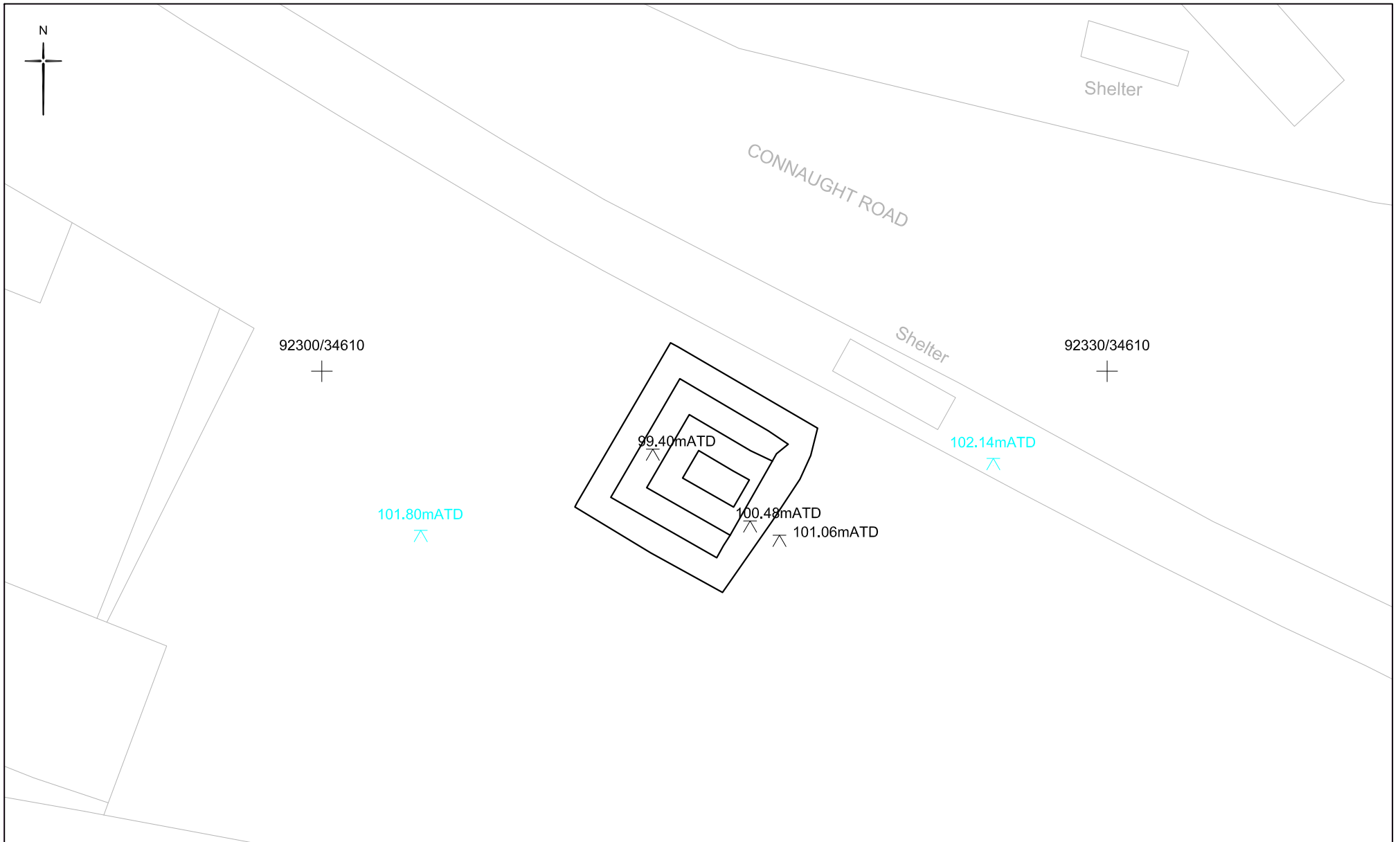





Fig 3: Trench 2
 Site code: XSY11
 Figure type: Survey report (3/5)

Based upon the Ordnance Survey mapping with the permission of the Controller of Her Majesty's Stationery Office © Crown Copyright. Unauthorised reproduction infringes Crown Copyright and may lead to prosecution or civil proceedings. TFL 100032379 2010.

Type of fieldwork:
 Evaluation
 Site Address:
 Crossrail: C263 Connaught Tunnel,
 Victoria Dock Road,
 London

-  Trench edge
-  10.24mOD TBMs
-  100 GPS derived control
-  102.57mATD GPS derived levels

0 1:200 @ A4 10m

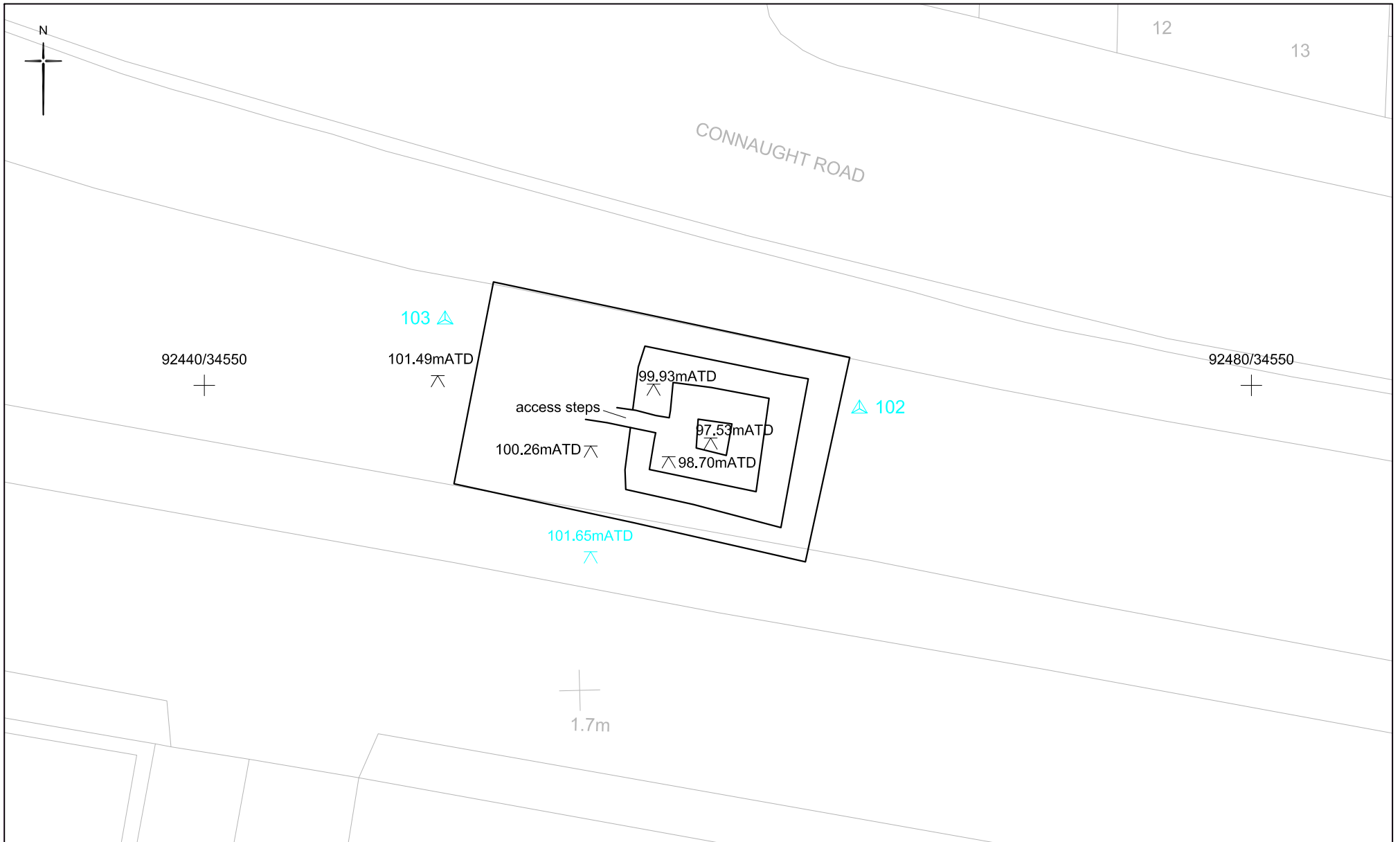
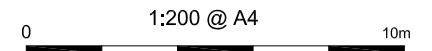

Fig 4: Trench 3
 Site code: XSY11
 Figure type: Survey report (4/5)

Based upon the Ordnance Survey mapping with the permission of the Controller of Her Majesty's Stationery Office © Crown Copyright. Unauthorised reproduction infringes Crown Copyright and may lead to prosecution or civil proceedings. TFL 100032379 2010.

Type of fieldwork:
 Evaluation
 Site Address:
 Crossrail: C263 Connaught Tunnel,
 Victoria Dock Road,
 London

- Trench edge
- 10.24mOD
 TBMs
- 100
 GPS derived control
- 102,57mATD
 GPS derived levels



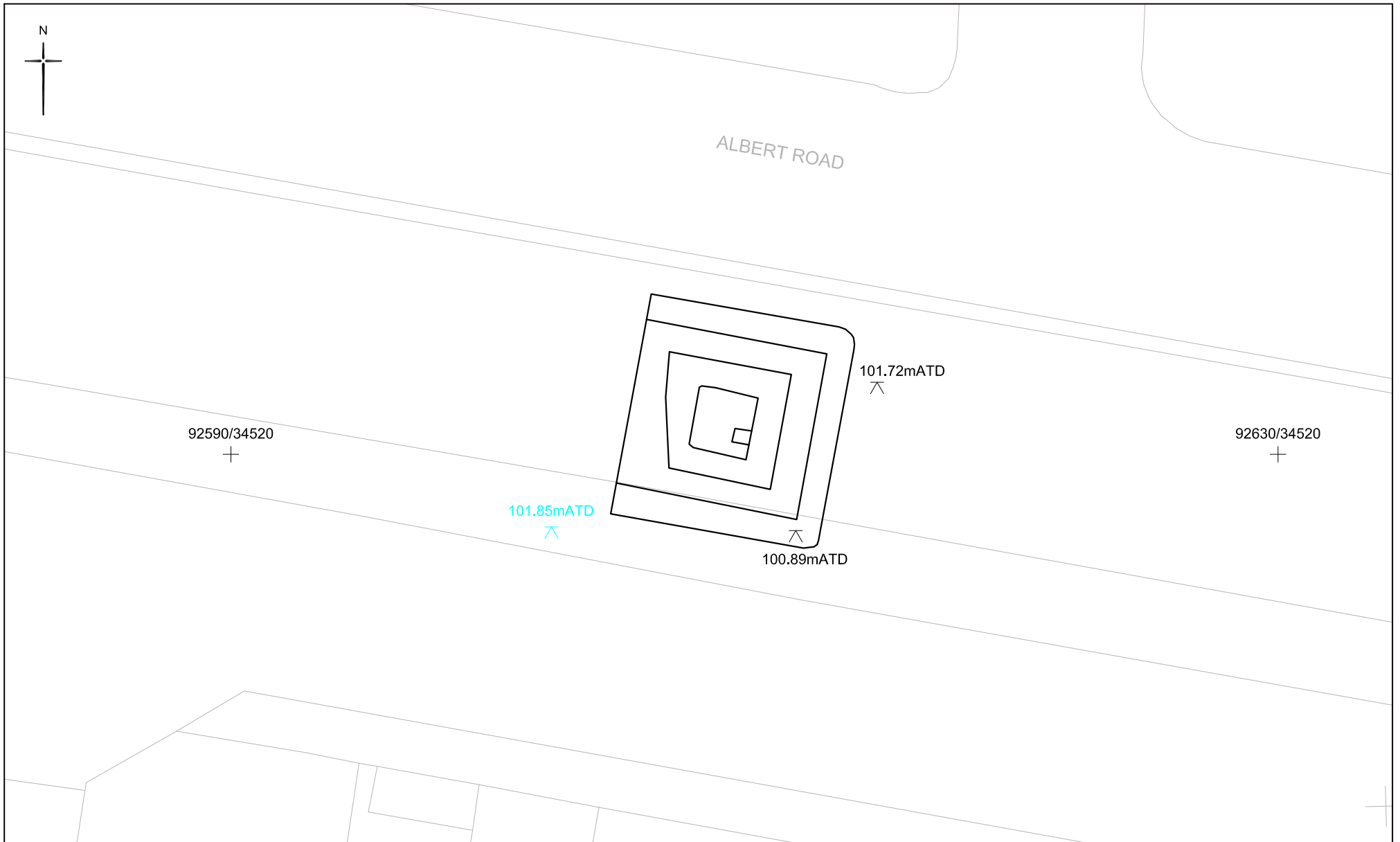





Fig 5: Trench 4
 Site code: XSY11
 Figure type: Survey report (5/5)

Based upon the Ordnance Survey mapping with the permission of the Controller of Her Majesty's Stationery Office © Crown Copyright. Unauthorised reproduction infringes Crown Copyright and may lead to prosecution or civil proceedings. TFL 100032379 2010.

Type of fieldwork:
 Evaluation
Site Address:
 Crossrail: C263 Connaught Tunnel,
 Victoria Dock Road,
 London

-  Trench edge
-  10.24mOD TBMs
-  100 GPS derived control
-  102.57mATD GPS derived levels

