

# HEATHER STODDART (RCAHMS) – MIDLOTHIAN

July 26, 2013 Historic Environment Scotland Archaeological Prospection, Buildings, Day of Archaeology 2013, Industrial #myarchaeology, architectural drawings, draughtsperson, drawings, Heather Stoddart, illustrator and surveyor, Midlothian, Newtongrange, RCAHMS, Royal Commission on the Ancient and Historical Monuments of Scotland, Scotland, Scottish Archaeology, Scottish architecture, Scottish Mining Museum, survey, survey drawings, Total Station, Victoria Colliery



*Heather Stoddart,  
RCAHMS*

I am Heather Stoddart, draughtsperson, illustrator and surveyor in the Architecture and Industry Section at RCAHMS.

My chosen building is the impressive [Lady Victoria Colliery](#) at Newtongrange, which we recorded for Industrial Survey.

This was one of the largest surviving Victorian collieries in Midlothian and Europe that was saved from demolition after its closure in 1981 and is now the site of the [Scottish Mining Museum](#). The tall red-brick buildings and the arcading create an impressive structure that housed one of Scotland's most important industrial processes.

We were asked to produce survey drawings of the ground plan of the site, pithead tub-circuit plan and the North, South, West and East elevations which was an extensive amount of survey work but shows the layout of the buildings to scale and generated a good comprehensive record of the complex.

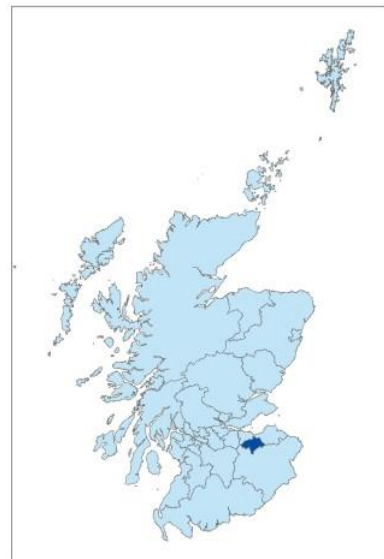

*Midlothian 'Contains  
Ordnance Survey data ©  
Crown copyright and  
database right 2011'*

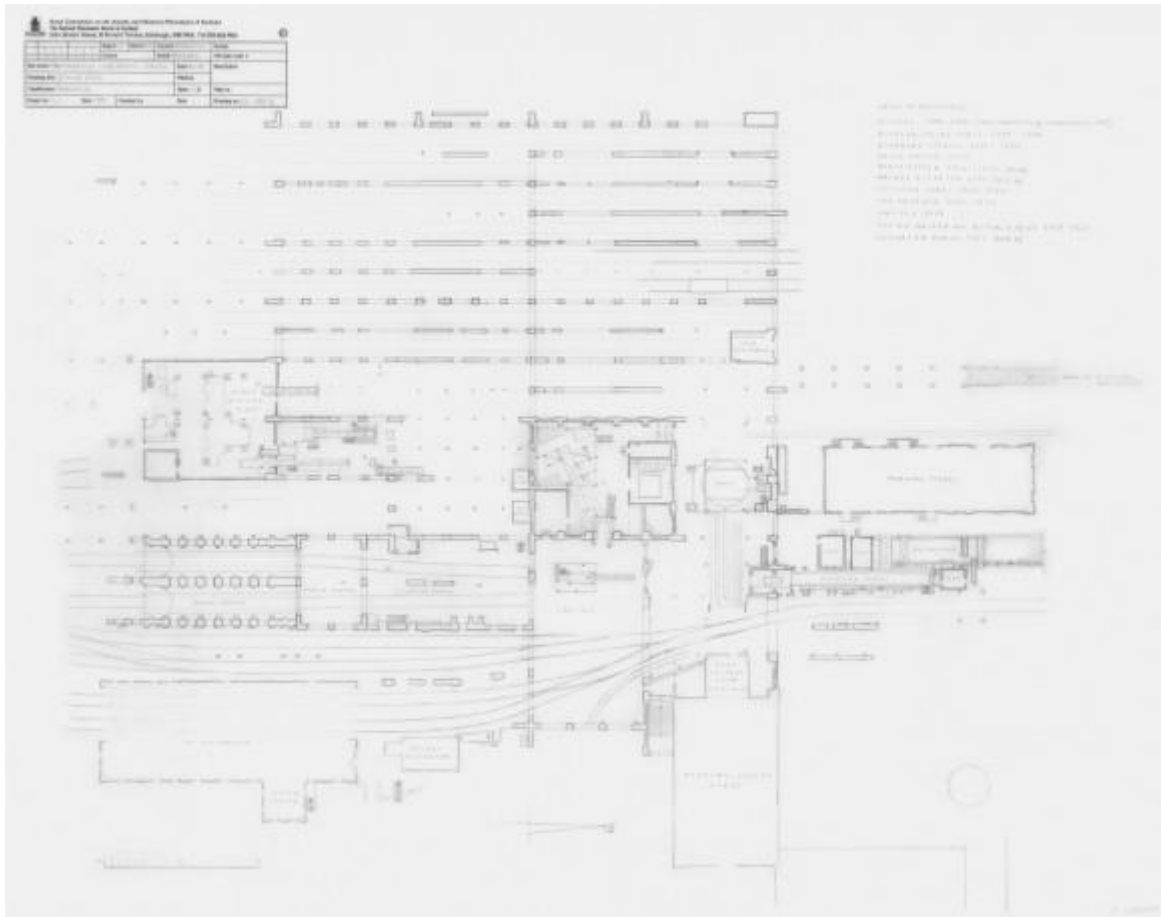

*Survey drawing of the ground plan of Lady Victoria Colliery, drawn by the author. Copyright RCAHMS*

Drawing any Industrial site can be challenging as you are recording a process and machinery but the scale of this site made it even more so. Often a process links one level to another like hoppers, conveyor belts, winding gear and elevators which is important to record and was the case at this site too.



*East elevation of Lady Victoria Colliery. Drawn by the author. Copyright RCAHMS*

The initial survey was started using an EDM/Total Station (a distance laser theodolite) which generated an accurate skeleton layout of the buildings from which we were able to generate the scaled plans and subsequently the elevations. We also used the EDM to assist with the recording of the Headgear which is the steel structure located above the mine shaft and can be seen from quite a distance due to its elevated position.

I also created finished digital images of the North and West elevations for ‘Scottish Collieries’, a RCAHMS publication which was published in 2006.

The North elevation image was nominated as Scotland’s favourite archive image by public vote in 2008 for [RCAHMS Treasured Places](#).

This is what I’ve chosen for Day of Archaeology, but why not tell us your favourite archaeological sites in Scotland on Twitter using [#MyArchaeology](#).