

Context/record sheet

Humberside Archaeological Unit

A	Location <u>DITCH</u>		Grid ref.		Site code <u>BENGATE 88</u>		Context/Record no. <u>115</u>		
	Category <u>STRUCTURE</u>				Form		Orientation		
B	Length <u>2.30m</u>		Width <u>0.40m</u>		Diameter		Height/Depth <u>0.06</u>		
	Co-ordinates				Level				
				T.B.M.=		BS.= +		FS.= -	
Plan no. <u>3</u>			Section no. <u>2</u>			Photo b/w		Photo c.	
Soil	Colour				Type				
	Consistence				Inclusions				
Structure	Building materials		Unit sizes		Coursing/Bond				
	<u>BRICK</u>		<u>235X11.8X X 5cms</u>						
			<u>24 x 12 x 6cm</u>						
								Bonding material <u>WHITE MORTAR</u>	
C Description and comments									
<p><u>TWO COURSES OF BRICK, LAID (ENGLISHT), AGAINST W. FACE OF WALL -</u>  <u>? FORMS A PLATFORM AGAINST WALL. THIS CURIOUS STRUCTURE RESTS ON</u>  <u>THE TOP OF A BANK OF POSTMEDIEVAL DARK SOIL. ABOUT 4 BRICKS AT</u>  <u>S. END Laid ALSO IN OPPOSITE DIRECTION WERE REMOVED BEFORE THE</u>  <u>STRUCTURE WAS RECOGNISED. A BRICK Laid <del>IN THE SAME WAY</del> IN THE SAME WAY,</u>  <u>PROTECTIVE<sup>W</sup> BEYOND THE ALIGNMENT OCCURS AT THE SECTION. IS NOT JANTED TO WALL</u></p>									
Date encountered <u>11/4/89</u>			Excavation method				% Level of disturbance		
D Stratigraphic relationships									
Earlier than	Soil			Cut Feature			Structure		
	Below	<u>2</u>		Below	<u>2</u>		Below	<u>114</u>	
	Sealed by			Cut by			Butted by		
	Overlapped by			Contains			Cut by		
Contemp with	Cut by					Encloses			
	Part of			Part of			Part of		
	Merges with			Includes			Joined with		
Later than	Includes								
	Above			Cut from			Above	<u>116</u>	
	Seals			Cuts			Butted to		
	Overlaps						Cuts		
	Lies against						Driven into		
Contained by								Contained by	
Same as			Characteristically similar to						
E Provisional interpretation									
Note book refs.					Matrix		Phase		Date
F	Finds			Recorded finds					
	<u>Pottery</u>								
<u>Animal bone</u>									
Samples	Soil	Wood	R/Carbon	Masonry	Brick	Tile	Slag		
G	Originator(s) <u>MF</u>				Checked by			Date	

Street - NOT TO SCALE

↑ N.

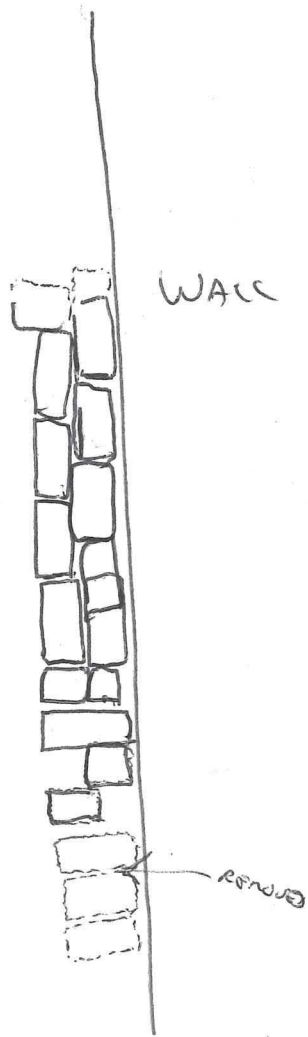

Context/record sheet

A Location <u>DITCH</u>		Grid ref.		Site code <u>BUNGATE 88</u>		Context/Record no. <u>116</u>	
Category <u>LAYER</u>				Form		Orientation	
B Length		Width		Diameter		Height/Depth <u>0.36m</u>	
Co-ordinates				Level			
				T.B.M.=		BS.= + FS.= -	
Plan no.			Section no. <u>2</u>		Photo b/w		Photo c.
Soil	Colour <u>BLACK</u>			Type <u>? ASH - CINDER</u>			
	Consistence <u>GRITTY</u>			Inclusions <u>IRON, PLASTER, U. SMALL BRICK FRAG.</u>			
Structure	Building materials		Unit sizes		Coursing/Bond		
					Bonding material		
C Description and comments							
<u>DARK GRITTY LAYER, MADE ASH ON CINDER, HEAPED AGAINST W. FACE OF WALL AT THE N. END OF TRENCH. BRICK IS KEPT ON TOP OF THIS DEPOSIT.</u>							
Date encountered <u>11/4/88</u>		Excavation method			% Level of disturbance		
D Stratigraphic relationships							
Earlier than	Soil <u>115</u>			Cut Feature		Structure	
	Below			Below		Below	
	Sealed by			Cut by		Butted by	
	Overlapped by			Contains		Cut by	
Cut by					Encloses		
Contemp with	Part of			Part of		Part of	
	Merges with			Includes		Joined with	
	Includes						
Later than	Above <u>123</u>			Cut from		Above	
	Seals			Cuts		Butted to	
	Overlaps					Cuts	
	Lies against					Driven into	
	Contained by					Contained by	
Same as			Characteristically similar to				
E Provisional interpretation							
Note book refs.				Matrix		Phase	Date
F Finds	Pottery <input checked="" type="checkbox"/>			Recorded finds			
	Animal bone						
Samples	Soil	Wood	R/Carbon	Masonry	Brick	Tile	Slag
G Originator(s)				Checked by			Date

Humberside Archaeological Unit



Context/record sheet

A	Location <u>DITCH</u>		Grid ref.		Site code <u>BEN GATE 88</u>		Context/Record no. <u>18</u>	
	Category <u>LAYER</u>				Form		Orientation	
B	Length		Width		Diameter		Height/Depth <u>65cms +</u>	
	Co-ordinates				Level			
	: : :				T.B.M.=		BS.= + FS.= -	
	Plan no.			Section no. <u>3</u>		Photo b/w		Photo c.
Soil	Colour <u>GREY-BROWN</u>				Type <u>CLAY</u>			
	Consistence <u>SOFT PLASTIC</u>				Inclusions <u>OCCASIONAL BRICK FRAGS</u>			
Structure	Building materials		Unit sizes		Coursing/Bond			
					Bonding material			
C	Description and comments							
<p><u>A STREAKY MOTTLED GREY-BROWN CLAY AT THE UPPER PART OF AN E-W SECTION CUT ACROSS LAYERS LYING TO THE W. OF THE WALL, ONE OF A SERIES OF LAYERS WHOSE CHARACTER DIFFERS FROM THOSE RECORDED IN SECTION TO THE S. INCLUDES A LENS OF SILTY MATERIAL, RUNS DOWN, PERHAPS INFILLING A SCOPE IN FRONT OF RAMPART</u></p>								
Date encountered <u>13/4/88</u>			Excavation method			% Level of disturbance		
D	Stratigraphic relationships							
	Soil		Cut Feature			Structure		
Earlier than	Below <u>109</u>		Below			Below		
	Sealed by		Cut by			Butted by		
	Overlapped by		Contains			Cut by		
Contemp with	Cut by					Encloses		
	Part of		Part of			Part of		
	Merges with		Includes			Joined with		
Later than	Includes							
	Above <u>119</u>		Cut from			Above		
	Seals		Cuts			Butted to		
	Overlaps					Cuts		
	Lies against					Driven into		
Contained by					Contained by			
Same as			Characteristically similar to					
E	Provisional interpretation							
<u>FILL OR RAMP AGAINST LAYERS HEARD UP BY WALL</u>								
Note book refs.					Matrix		Phase	Date
F	Finds		Recorded finds					
	Pottery <input checked="" type="checkbox"/>							
Animal bone								
Samples	Soil	Wood	R/Carbon	Masonry	Brick	Tile	Slag	
G	Originator(s) <u>MF</u>				Checked by			Date

Humberside Archaeological Unit

Context/record sheet

A	Location <u>DITCH</u>		Grid ref.		Site code <u>BUNGATE 88</u>		Context/Record no. <u>119</u>	
	Category <u>LAYER</u>				Form		Orientation	
B	Length		Width		Diameter		Height/Depth <u>0.10 - 0.35m</u>	
	Co-ordinates				Level			
					T.B.M. =		BS. = +	
	Plan no.		Section no. <u>3</u>		Photo b/w		Photo c.	
Soil	Colour <u>DK GREY</u>				Type <u>CLAY-LOAM MIX</u>			
	Consistence <u>GRITTY PLASTIC SOFT</u>				Inclusions <u>BRICK FRAGS POTTERY, SOME SMALL STONE</u>			
Structure	Building materials		Unit sizes		Coursing/Bond			
					Bonding material			
C	Description and comments <u>(w.06)</u> <u>LAYER IN FRONT OF WALL RUNNING DOWN THE SLOPE OF A BANK OF CLAY</u> <u>MAX OF 10cm CONTAIN "OCCLUSION" TYPE MATERIAL - <del>2cm</del> THIS APPEARS MORE</u> <u>PROMINENT THAN IN OTHER LAYERS IN SECTION VIEW. THIS IS POSSIBLY A</u> <u>GREASIER EQUIVALENT OF (3)</u> <u>CONTAINED A GEORGE III PENNY OF 1805 or 1806</u>							
Date encountered <u>13/4/88</u>		Excavation method			% Level of disturbance			
D	Stratigraphic relationships							
Earlier than	Soil			Cut Feature			Structure	
	Below <u>118</u>			Below			Below	
	Sealed by			Cut by			Butted by	
	Overlapped by			Contains			Cut by	
Contemp with								
	Part of			Part of			Part of	
	Merges with			Includes			Joined with	
Later than								
	Above <u>120</u>			Cut from			Above	
	Seals			Cuts			Butted to	
	Overlaps						Cuts	
	Lies against						Driven into	
						Contained by		
Same as <u>103</u>			Characteristically similar to					
E	Provisional interpretation							
Note book refs.				Matrix		Phase		Date
F	Finds			Recorded finds <u>123</u>				
	Pottery <input checked="" type="checkbox"/>							
Animal bone								
Samples	Soil	Wood	R/Carbon	Masonry	Brick	Tile	Slag	
G	Originator(s) <u>MF</u>				Checked by			Date

Humberside Archaeological Unit

Context/record sheet

A	Location	Grid ref.	Site code	Context/ Record no.
	Category <b>LAYER</b>		<b>BENGATE 88</b>	<b>120</b>
B	Length	Width	Diameter	Height/Depth <b>c 45cms.</b>
	Co-ordinates		Level	
	:	:	T.B.M.=	BS.= + FS.= -
	Plan no.	Section no. <b>3</b>	Photo b/w	Photo c.
Soil	Colour <b>TA GREY</b>	Type <b>CLAY</b>		
	Consistence <b>SOFT PLASTIC</b>	Inclusions <b>BRICK FRAGS LARGE &amp; SMALL, SLIGHT MORTAR FLICKING</b>		
Structure	Building materials	Unit sizes	Coursing/Bond	
			Bonding material	
C	Description and comments			
	<b>HEAVY BANK OF GREY CLAY - WITH PATCHES OF BROWN CLAY, HEARD AGAINST W. FACE OF WALL. DISTINCTION WITH 18 IS LUCKY, BUT MAX OF AS INDICATED BY PILING OUT OF BRICK RUBBLE</b>			
	Date encountered <b>13/4/88</b>	Excavation method	% Level of disturbance	
D	Stratigraphic relationships			
Earlier than	Soil	Cut Feature	Structure	
	Below <b>119</b>	Below	Below	
	Sealed by	Cut by	Butted by	
	Overlapped by	Contains	Cut by	
Contemp with	Part of	Part of	Part of	
	Merges with	Includes	Joined with	
	Includes			
Later than	Above <b>121</b>	Cut from	Above	
	Seals	Cuts	Butted to	
	Overlaps		Cuts	
	Lies against		Driven into	
	Contained by		Contained by	
	Same as <b>105</b>	Characteristically similar to		
E	Provisional interpretation			
	Note book refs.	Matrix	Phase	Date
F	Findings	Recorded finds		
	Pottery <input checked="" type="checkbox"/>			
	Animal bone			
Samples	Soil	Wood	R/Carbon	Masonry
				Brick
				Tile
				Slag
G	Originator(s)	Checked by	Date	
	<b>MF.</b>			

Humberside Archaeological Unit





Context/record sheet

A Location		Grid ref.		Site code <b>BEVGATE 88</b>		Context/ Record no. <b>122</b>	
Category <b>LAYER</b>				Form		Orientation	
B Length		Width		Diameter		Height/Depth	
Co-ordinates				Level			
				T.B.M. =		BS. = +      FS. = -	
Plan no.			Section no. <b>S</b>		Photo b/w		Photo c.
Soil	Colour <b>DK. ORANGEY-BROWN/GREY</b>			Type <b>CLAY</b>			
	Consistence <b>FIRM PLASTIC</b>			Inclusions <b>SLIGHT SMALL CRUSH MORTAR/BRICK</b>			
Structure	Building materials		Unit sizes		Coursing/Bond		
					Bonding material		
C Description and comments							
<b>LAYER OF FIRM CLAY SEALING BOTTOM TWO COURSES OF BRICKWORK AND CHAIN FOOTINGS OF WALL. POSSIBLE EQUIVALENT OF (17)</b>							
Date encountered <b>13/4/88</b>		Excavation method			% Level of disturbance		
D Stratigraphic relationships							
		Soil		Cut Feature		Structure	
Earlier than	Below <b>121</b>		Below		Below		
	Sealed by		Cut by		Butted by		
	Overlapped by		Contains		Cut by		
	Cut by				Encloses		
Contemp with	Part of		Part of		Part of		
	Merges with		Includes		Joined with		
	Includes						
Later than	Above		Cut from		Above		
	Seals		Cuts		Butted to		
	Overlaps				Cuts		
	Lies against				Driven into		
	Contained by				Contained by		
Same as <b>107</b>		Characteristically similar to					
E Provisional interpretation							
Note book refs.				Matrix		Phase	Date
F Finds	Pottery <input checked="" type="checkbox"/>			Recorded finds			
	Animal bone						
Samples	Soil	Wood	R/Carbon	Masonry	Brick	Tile	Slag
G Originator(s) <b>MF</b>				Checked by			Date

Humberside Archaeological Unit

Context/record sheet

A Location		Grid ref.		Site code		Context/Record no. 123		
Category				BEVGATE 88		Form		
LAYER						Orientation		
B Length		Width		Diameter		Height/Depth up to 50cm		
Co-ordinates				Level				
: : :				T.B.M. =		BS. = + FS. = -		
Plan no.			Section no. 2			Photo b/w	Photo c.	
Soil	Colour			Type				
	DR. GREY			CLAY-SILT				
Structure	Consistence			Inclusions				
	SOFT PLASTIC			BRICK RUBBLE, MUCH POT.				
Building materials		Unit sizes		Coursing/Bond				
				Bonding material				
C Description and comments								
THICK LAYER - UP TO 50CM DEEP, LING AGAINST W. FACE OF WALL TOWARD N. END OF TRENCH; DEPOSIT WHERE IT MET WALL. BONE AND POTTERY ARE PRESENT IN THIS DEPOSIT, THOUGH NONE HAD NOT BEEN RETAINED.								
Date encountered		13/4/80		Excavation method		% Level of disturbance		
D Stratigraphic relationships								
		Soil		Cut Feature		Structure		
Earlier than	Below		116		Below		Below	
	Sealed by				Cut by		Butted by	
	Overlapped by				Contains		Cut by	
Cut by						Encloses		
Contemp with	Part of				Part of		Part of	
	Merges with				Includes		Joined with	
	Includes							
Later than	Above		124		Cut from		Above	
	Seals				Cuts		Butted to	
	Overlaps						Cuts	
	Lies against						Driven into	
	Contained by						Contained by	
Same as		Characteristically similar to						
E Provisional interpretation								
UPCAST ? FROM DITCH ? DUMPED AGAINST WALL FACE								
Note book refs.				Matrix		Phase	Date	
F Finds	Pottery ✓			Recorded finds				
	Animal bone							
Samples	Soil	Wood	R/Carbon	Masonry	Brick	Tile	Slag	
G Originator(s)				Checked by			Date	

Humberside Archaeological Unit

Context/record sheet

A Location		Grid ref.		Site code <i>BEVLATE 88</i>		Context/ Record no. <i>24</i>	
Category <i>LAYER</i>				Form		Orientation	
B Length		Width		Diameter		Height/Depth <i>0.20m</i>	
Co-ordinates			Level		T.B.M. =   B.S. = +   F.S. = -		
Plan no.		Section no. <i>2</i>		Photo b/w		Photo c.	
Soil	Colour <i>LIGHT GREY</i>			Type <i>CLAY</i>			
	Consistence <i>FIRM PLASTIC</i>			Inclusions <i>WHITE MORTAR, SMALL BRICK FRAGS ON TOP</i>			
Structure	Building materials		Unit sizes		Coursing/Bond		
					Bonding material		
C Description and comments							
<i>FIRM CLAY LYING TO W OF, AGAINST BAR OF, WALL IN GREY STREAKS APPEAR THROUGHOUT THIS MATERIAL; EITHER ROOT DISTURBANCE OR ROTTED ORGANIC FRAGMENT</i>							
Date encountered <i>13/4/88</i>		Excavation method			% Level of disturbance		
D Stratigraphic relationships							
Earlier than	Soil		Cut Feature		Structure		
	Below <i>123</i>		Below		Below		
	Sealed by		Cut by		Butted by		
	Overlapped by		Contains		Cut by		
Cut by				Encloses			
Contemp with	Part of		Part of		Part of		
	Merges with		Includes		Joined with		
	Includes						
Later than	Above		Cut from		Above		
	Seals		Cuts		Butted to		
	Overlaps				Cuts		
	Lies against				Driven into		
	Contained by				Contained by		
Same as		Characteristically similar to					
E Provisional interpretation							
Note book refs.				Matrix		Phase	Date
F Finds	Pottery			Recorded finds			
	Animal bone						
Samples	Soil	Wood	R/Carbon	Masonry	Brick	Tile	Slag
G Originator(s)				Checked by			Date

Humberside Archaeological Unit

A	Location		Grid ref.		Site code BELGATE 88		Context/ Record no. 125		
	Category STRUCTURE				Form LINEAR		Orientation N-S.		
B	Length		Width		Diameter		Height/Depth		
	Co-ordinates				Level				
	:   :   :				T.B.M.=		B.S.= +		F.S.= -
	Plan no. 1 2		Section no.			Photo b/w		Photo c.	
	Soil	Colour			Type				
Consistence			Inclusions						
Structure	Building materials COBBLES.		Unit sizes		Coursing/Bond				
					Bonding material				
C Description and comments									
LINE OF COBBLES RUNNING PARALLEL TO DRAW 9, JUST E. OF IT. THE NORTHWARD COBBLE LIES ON ITS OWN, RUNNING SOUTH THERE ARE THREE MORE GROUPS OF COBBLES SEPARATED BY GAPS. A SMALL GROUP OF COBBLES ALSO LIE E. OF THE LINE. THE COBBLES ARE SET INTO ORANGE GRUNT WHICH LIES MOIST, BUT NOT ALL, TO THE E. OF THE COBBLES. DISTURBED - CUT BY - ST									
Date encountered									
Excavation method									
% Level of disturbance									
D Stratigraphic relationships									
	Soil			Cut Feature			Structure		
Earlier than	Below			Below			Below		
	Sealed by			Cut by			Butted by		
	Overlapped by			Contains			Cut by 130		
	Cut by						Encloses		
Contemp with	Part of			Part of			Part of		
	Merges with			Includes			Joined with		
	Includes								
Later than	Above			Cut from			Above		
	Seals			Cuts			Butted to		
	Overlaps						Cuts		
	Lies against						Driven into 128		
	Contained by						Contained by		
Same as			Characteristically similar to						
E Provisional interpretation									
Note book refs.									
Matrix									
Phase									
Date									
F	Finds		Recorded finds						
	Pottery								
Animal bone									
Samples	Soil	Wood	R/Carbon	Masonry	Brick	Tile	Slag		
G Originator(s)					Checked by			Date	

Context/record sheet

A	Location		Grid ref.		Site code		Context/Record no.		
	Category STRUCTURE				BELGATE 88		26		
B	Length 66cm		Width 60cm		Diameter		Height/Depth		
	Co-ordinates				Level				
				T.B.M. =		B.S. = +		F.S. = -	
Plan no.			Section no.			Photo b/w		Photo c.	
Soil	Colour				Type				
	Consistence				Inclusions				
Structure	Building materials		Unit sizes		Coursing/Bond				
	BRICK		13 X 5cm						
			26 X 11 X 5cm						
								Bonding material	
								BUFF AND WHITE MORTAR	
C Description and comments									
FRAGMENT									
RECTANGULAR SETTING OF BRICK Laid flat, ON EDGE AND ON END OVER PARTS - THE MIDDLE									
ESPECIALLY - OF THE SETTING BROWN & BLACK FINE ASH (IES) THIS IS SET ON TOP									
OF RAMPART CLAY, THE RAMPART CLAY HAS CRACK - PERHAPS DOWN EDGE OF									
FILLED CONSTRUCTION CUT FOR WALL, WHICH RUNS ALONG THE W. EDGE OF									
THIS STRUCTURE.									
Date encountered 14/4/88			Excavation method			% Level of disturbance			
D Stratigraphic relationships									
Soil			Cut Feature			Structure			
Earlier than	Below			Below			Below		
	Sealed by			Cut by			Butted by		
	Overlapped by			Contains			Cut by		
	Cut by						Encloses		
Contemp with	Part of			Part of			Part of		
	Merges with			Includes			Joined with		
	Includes								
Later than	Above			Cut from			Above		
	Seals			Cuts			Butted to 27		
	Overlaps						Cuts		
	Lies against						Driven into		
	Contained by						Contained by		
Same as			Characteristically similar to						
E Provisional interpretation									
? HEARTH OR FIRE POSITION									
Note book refs.				Matrix		Phase		Date	
F	Finds			Recorded finds					
	Pottery								
Animal bone									
Samples	Soil		Wood	R/Carbon	Masonry	Brick	Tile	Slag	
G Originator(s)					Checked by		Date		
MF									

Humberside Archaeological Unit

SKETCH - NOT TO SCALE

F - MID FLAT, E - ON EDGE, END - ON END

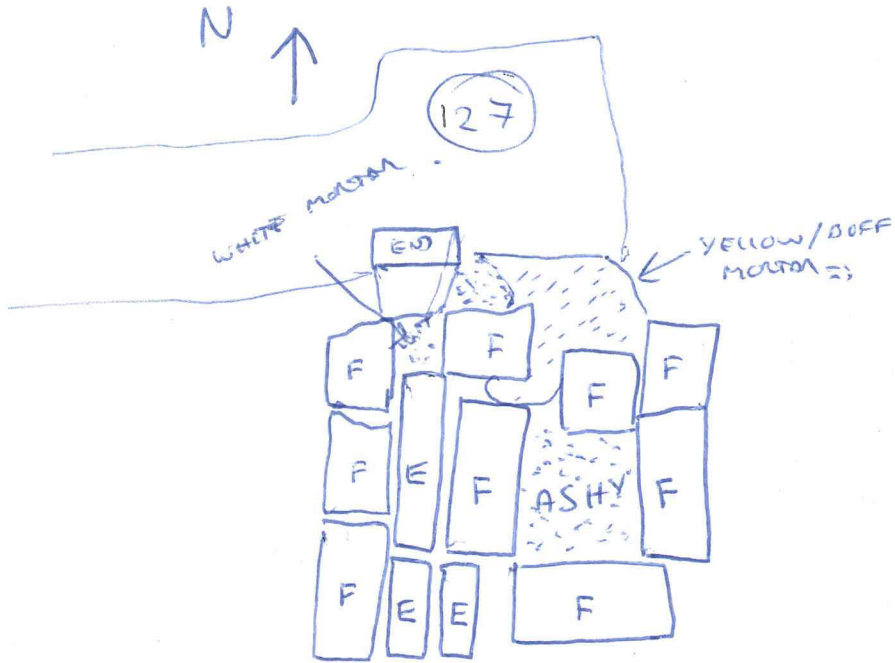

Context/record sheet

A Location		Grid ref.		Site code		Context/Record no.	
Category		STRUCTURE		BENGATE 88		1 27	
				Form		Orientation	
				LINEAR		E-W	
B Length		Width		Diameter		Height/Depth	
0.58m		0.14m					
Co-ordinates				Level			
				T.B.M. =			
				B.S. = +		F.S. = -	
Plan no.			Section no.			Photo b/w	Photo c.
	Soil	Colour		Type			
		Consistence		Inclusions			
	Structure	Building materials	Unit sizes		Coursing/Bond		
		BRICK	27X13.5X5.5cm				
					Bonding material		
					PALE BUFF MORTAR		
C Description and comments							
BRICK STRUCTURE IMMEDIATELY N. OF 26, CONSISTS OF BRICK AND FLINT, TWO COURSES							
SURVIVE. BOTH BRICK & BRICK FRAGMENTS HAVE BEEN USED							
Date encountered		Excavation method			% Level of disturbance		
14/4/88							
D Stratigraphic relationships							
		Soil		Cut Feature		Structure	
Earlier than	Below			Below		Below	
	Sealed by			Cut by		Butted by 1 26	
	Overlapped by			Contains		Cut by	
	Cut by					Encloses	
Contemp with	Part of			Part of		Part of	
	Merges with			Includes		Joined with	
	Includes						
Later than	Above			Cut from		Above	
	Seals			Cuts		Butted to	
	Overlaps					Cuts	
	Lies against					Driven into	
	Contained by					Contained by	
Same as		Characteristically similar to					
E Provisional interpretation							
Note book refs.				Matrix		Phase	Date
F Finds	Pottery			Recorded finds			
	Animal bone						
Samples	Soil	Wood	R/Carbon	Masonry	Brick	Tile	Slag
G Originator(s)				Checked by			Date
MF							

Humberside Archaeological Unit