

Photographs - Mezzanine

il_001_22.12.15



il_002_22.12.15

underside of lintel - steel joists & gypsum plaster repair
- C20



i2_001_22.04.20
linen cupboard to left IS



i2_002_14.06.21
linen cupboard removed - new partition



i4_001_15.05.20



i4_002_22.12.15





i4_003_22.12.15



i4_004_05.10.15



i4_005_22.12.15



i4_006_14.06.21



i4_007_14.06.21



i5_001_14.05.20



i6_001_22.12.15



i6_002_14.05.20



i6_003_14.06.21 - note straight joint, brick repair and lathe-and-plaster ceiling, with part gypsum skim.



i6_004_14.06.21 - note studwork for former cupboard or blocked door to outer edge of floor plan

i7_001_14.05.20



i7_002_22.12.15



i8_001_14.05.20



i8_002_14.05.20



i8_003_14.05.20

i8_004_14.06.21
new partition to replace linen cupboard to left.
Outer wall lined with studwork and lathe-and-plaster.





i8_005_14.06.21



i8_006_14.06.21



i8_007_14.06.21



i9_001_05.10.15 - underside of 1851 or C20 staircase



i10_001_22.12.15 - cupboard with rails, hooks and former brick arch - location of former staircase



i11_001_22.12.15 - linen cupboard interior

Photographs - First Floor



f5_001_14.06.21



f5_002_14.05.20



f5_003_05.10.15



f5_004_14.06.21

f7_001_14.05.20



f7_002_05.10.15



f7_003_14.06.21

Note arch to niche to right of current doorway,
indicates previous 1806 doorway position.
Inserted ceiling removed and raised to original height.



f7_004_22.12.15

Bulkhead to former inserted ceiling.

f8_001_14.05.20



f8_002_05.10.15





f8_003_14.06.21



f8_004_14.06.21 - note bricked-up corner flue to this space.



f8_005_14.06.21



f8_006_14.06.21 - former location of hearth visible in floor by made-up boards replacing stone hearth



f9_001_05.10.15



f9_002_05.10.15



f9_003_14.06.21 - partition with fanlight re-located



f10_001_15.10.15 - access from first floor to mezzanine

f10_002_14.05.20
first floor service stairs of 1851



f10_003_14.05.20



f11_001_14.05.20



f11_002_14.05.20



f11_003_05.10.15



f11_004_05.10.15



f12_001_14.05.20



f12_002_14.05.20
Bedroom with small internal window and new partition,
probably added in 1851 to light the corridor



f12_003_14.05.20



f12_004_05.10.15



f12_005_05.10.15



f13_001_14.05.20



f13_002_05.10.15



f13_003_14.05.20



f13_004_05.10.15



f14_001_14.05.20



f14_002_14.06.21 - after removal of angled wall



f14_003_14.05.20
Ashcombe Park - Historic Building Record



f14_006_14.04.20



f14_004_14.06.21



f14_005_14.06.21



f14_007_14.06.21



f15_001_14.05.20



f15_002_05.10.15

f15_003_14.05.20



f15_004_14.06.21



f17_001_14.06.21 - relocated door to right



f17_002_14.05.20



f17_003_14.05.20



f19_001_05.10.15



f19_002_05.10.15

f20_001_14.05.20



f20_002_05.10.15



f21_05.10.15
Housemaid's cleaning cupboard



f23_001_14.05.20 - inserted C20 door
Ashcombe Park - Historic Building Record



f23_002_22.12.15 - attic access

Photographs - Butler's Wing

f24_001_14.05.20



f24_002_14.05.20





f25_001_14.05.20



f25_002_14.05.20



f26_001_14.05.20



f26_002_14.05.20

Photographs - Courtyard

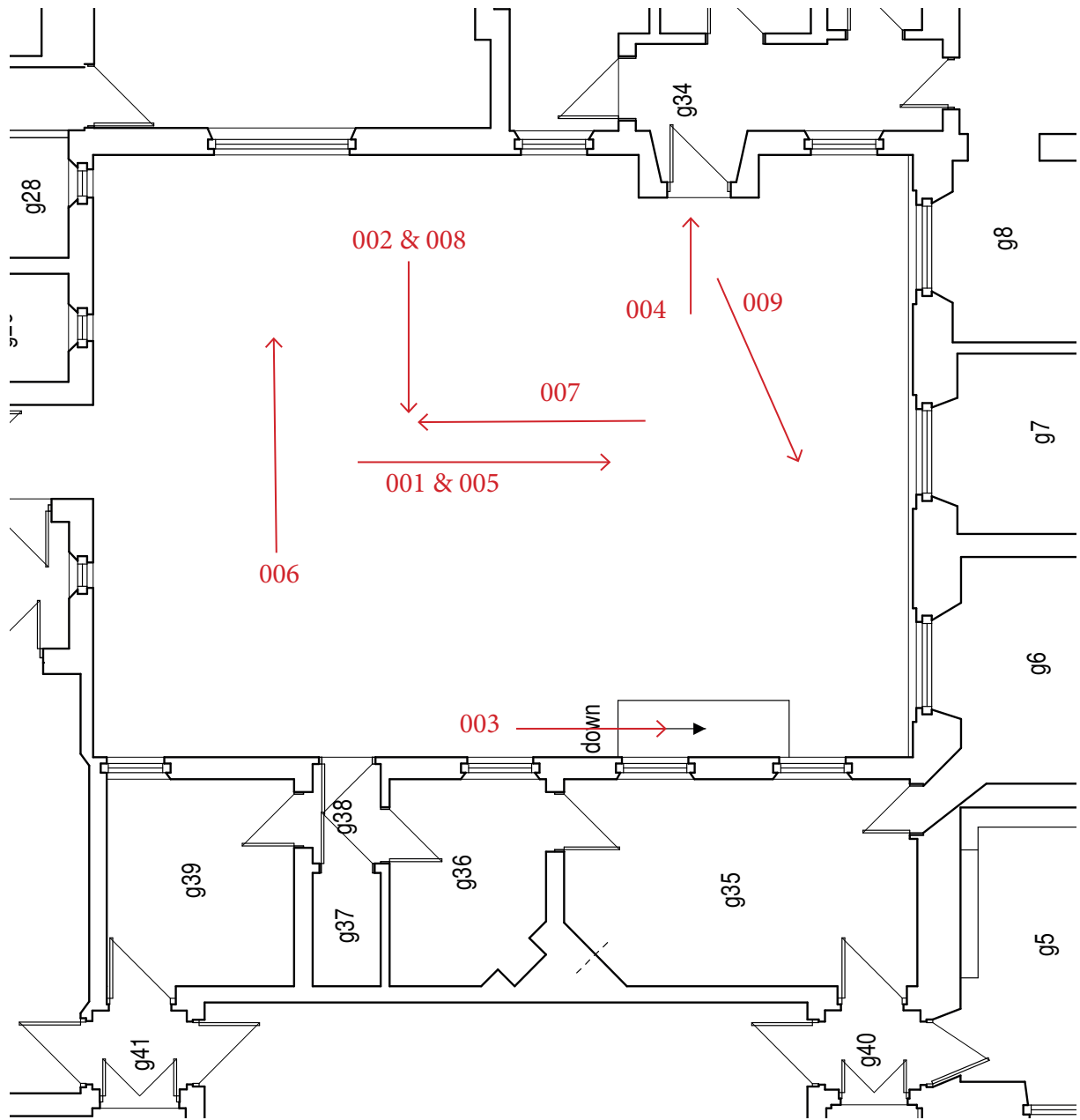



C001_17.09.15



C005_14.06.21



C002_17.09.15



C008_14.06.21



C004_17.09.15



C003_14.02.21



C009_14.06.21



C006_14.06.21



C007_14.06.21

Photographs - Terrace



T001_14.06.21



T002_14.06.21

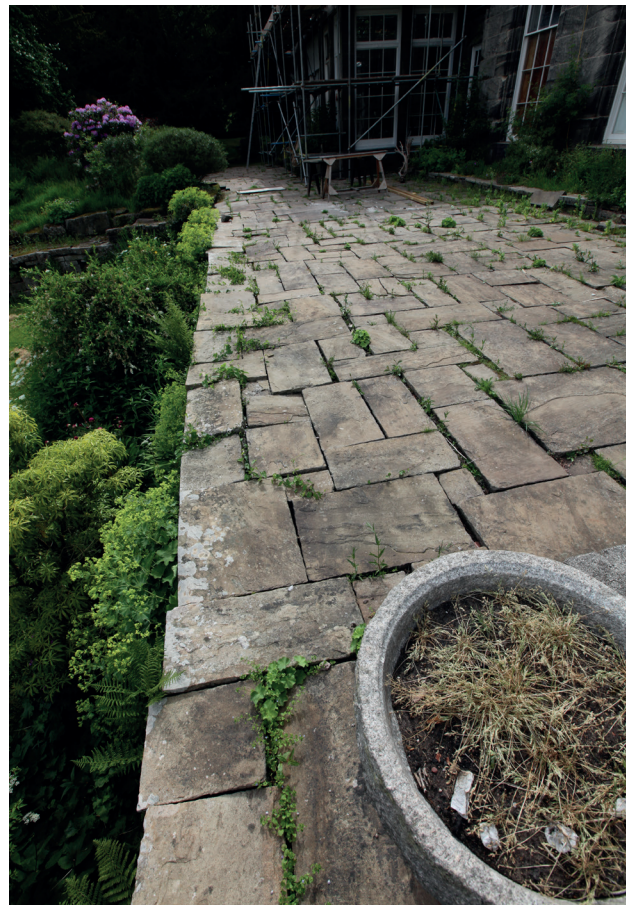

T004_14.06.21



T003_14.06.21



T005_14.06.21



T009_14.06.21



T006_14.06.21



T008_14.06.21



T007_22.04.20



PC001_14.06.21



PC002_14.06.21



PC003__14.06.21

END