

PLAN OF THE REMAINS OF AN OLD CHURCH ON THE GOSFORTH ESTATE

ON A SCALE OF 16 FEET TO ONE INCH.

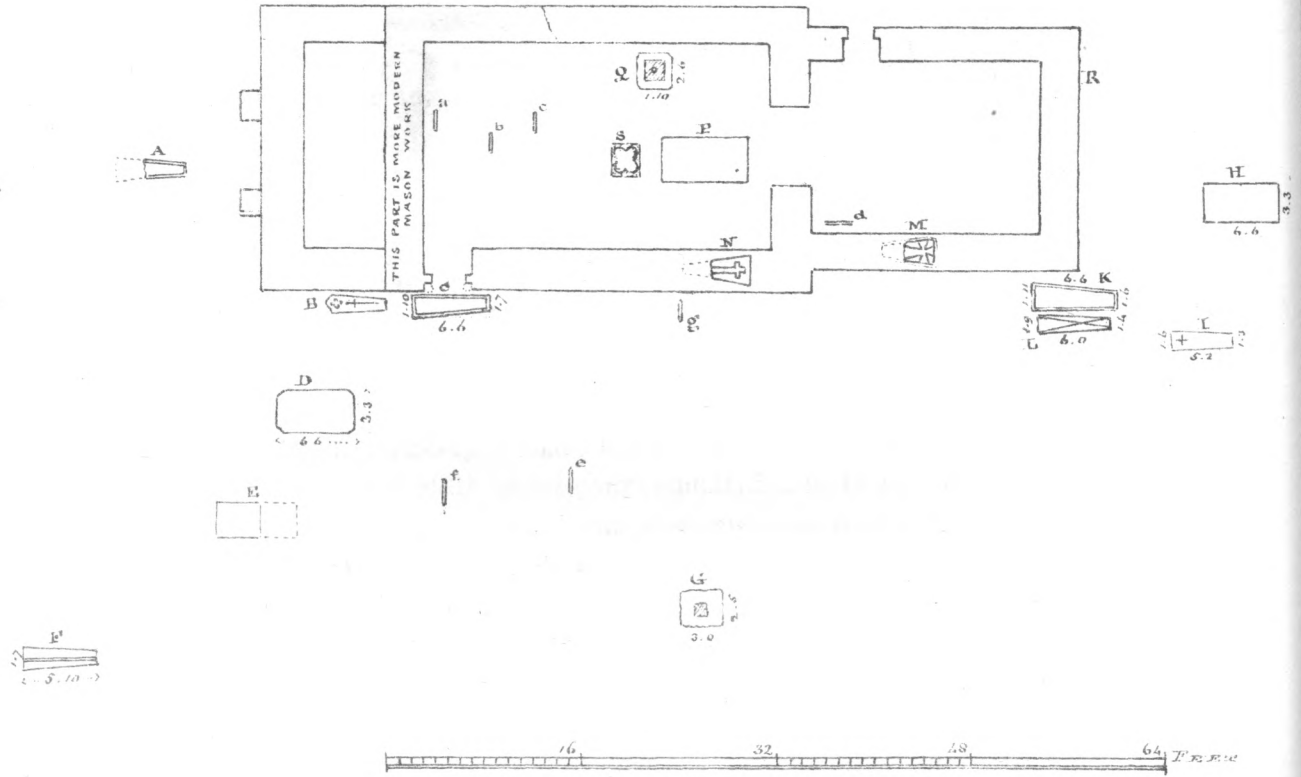

DRAWN 11th OCTOBER 1826

SECTION OF STONE I

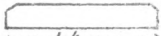

SECTION OF STONE F



SECTION OF STONE K

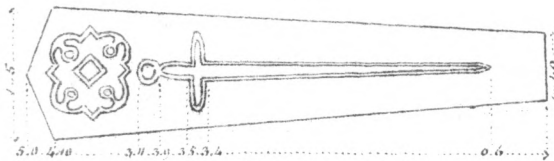

STONE B.

STONE S

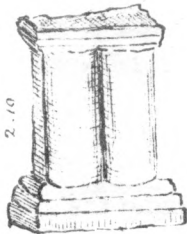

ARMORIAL BEARINGS ON STONE H



ARMORIAL BEARINGS ON STONE D



STONE UPSIDE DOWN IN THE WALL AT R



XXXI.—*An Account of the Remains of a Chapel, or Church, and Kirk Garth, near Low Gosforth House, in the County of Northumberland, in a Letter from Mr. JOHN BELL, Librarian, to JOHN ADAMSON, Esq., Sec. See Plate VII.*

Windmill Hills, Gateshead, 20th December, 1826.

DEAR SIR,

ON the Gosforth estate, rather better than a gun-shot to the south-south-east of Low Gosforth House, the seat of Robert William Brandling, Esq., and about nine furlongs north from the present church, are the remains of a chapel, or church, and kirk-garth, with some tombstones. Mr. Brandling having, in the course of this summer, had the place cleared of the weeds and long-deposited rubbish that covered it, which shewed a number more of these mementoes, and as there is little or no notice of this chapel in any of our county histories, I was induced to walk out to view it, when I took the plan and copies of the existing inscriptions, which I send herewith, for the Society's acceptance.

The place is curious, there being evident traces of it having been on fire, and part of it being of more modern mason work, causes a conjecture that it has been partly re-built, leaving out a portion of the west end, but subsequently to have fallen over to the south, as the walls shew, which are standing about three or four feet high, and in the front are leaning outwards.

THE STONES

- A. C. K. Are oblong, with only a moulding round the edge.
- B. An oblong stone, marked with a sword and an ornament.

- D. A table stone, with armorial bearings, viz. a Chevron between three Bucks. Inscribed " The burial place of John Robinson Senior Lucy his wife deputed ye 2d of Novemb. 1664 also William Robinson their Son Margaret his wife deputed ye 12th of Novem 1666 also Elizabeth his wife who departed ye 26 of October 1691.
- E. An un-lettered table stone broken in two.
- F. An oblong stone raised along the middle.
- G. The base or foot of a cross, from having a square hole for the shaft thereof.
- H. A table stone, with armorial bearings, viz. a Chevron debruised by a Fess, charged with a Crescent between three Annulets, inscribed

The Buriall place of William
Hedley yeoman Mary his
Wife & 12 children He deputed
Octob^r ye 29 1664 John their
Son deputed June the 13th 1665.

HIS EPITAPH.

In christian hope one Rests Here
Observe yet Reader Shed a Teare
He was a Godly Zealous Youth
Never desserting from the Truth
Humilitie Love Honestie
Each Vertue of Humanitie
did in him Florish Whilst Here he
livd in Faith Hope & Chartie
Ending this Life in Godly Sort
Yielding to the World a Good Report

- I. An oblong stone, marked with a small cross.
- L. An oblong stone, crossed from the opposite corners.
- M. Part of an oblong stone, marked with a cross. This was found among the ruins, and placed upon the wall.

- N. Nearly the same as the last, but has been burnt.
 - P. A large flat stone.
 - Q. A hollow stone like the top of a font.
 - R. At this place, in the original building, a stone marked C O H, and seemingly part of a Roman altar, is built upside down.
 - S. A stone; in all appearance, the shaft or support for the stone marked Q.
- a, b, c, d, e, f, g, are fragments of plain head-stones, or flags, set up to shew some places of interment, supposed to have taken place after the chapel had fallen.

I am, DEAR SIR,

Your's respectfully,

JOHN BELL.