

CHIBBURN PRECEPTORY, FROM THE S.E.

AUGUST, 1895.

X.—CHIBBURN AND THE KNIGHTS HOSPITALLERS IN
NORTHUMBERLAND;¹ (WITH DOCUMENTS FROM MR.
WOODMAN'S COLLECTION.)

BY J. CRAWFORD HODGSON.

[Read on the 27th day of March, 1895.]

'FOR men strongly moved by the Christian faith it was natural to yearn after the scenes of the Gospel narrative. In old times this feeling had strength to impel the chivalry of Europe to undertake the conquest of a barren and distant land, and . . . there were always many who were willing to brave toil and danger for the sake of attaining to the actual and visible Sion. These venturesome men came to be called Pelerins or Pilgrims.'²

To provide more effectively for the reception and shelter of these pilgrims to Jerusalem, there was established a military brotherhood whose companions were designated the knights of St. John. 'I will not,' says Mr. J. M. Kemble, 'waste time or space upon . . . the theory and place in history of the order of Hospitallers or Knights of St. John of Jerusalem . . . Nor is it needful to speak of the honour and dignity of their gallant companions in the thirteenth and fourteenth centuries; nor of the grandeur of their early wars in Palestine, and, what are better known, their later wars in Rhodes and Malta . . . Leaving all such questions, our present business is to see how, while the order of the Knights Hospitallers did exist, and its brethren were to be found in many parts of Europe, they managed the estates from which they derived their wealth, and with it their power.'³

The earliest and chief possession of the order in Northumberland was at Chibburn, a small manor between Widdrington and the white shore of Druridge bay. The mansion house and roofless walls of the

¹ Compare the 'Temple Thornton Farm Accounts,' p. 40. The woodcuts illustrating this paper have been kindly lent by the Royal Archaeol. Institute.

² Kinglake, *Crimea*, vol. i. p. 41.

³ Introduction to the *Report of Prior Philip de Thame to the Grand-Master Elyan de Villanova, for A.D. 1338.* 65 Camden Soc. 1857, p. xiii.

CHIBBURN PRECEPTORY :

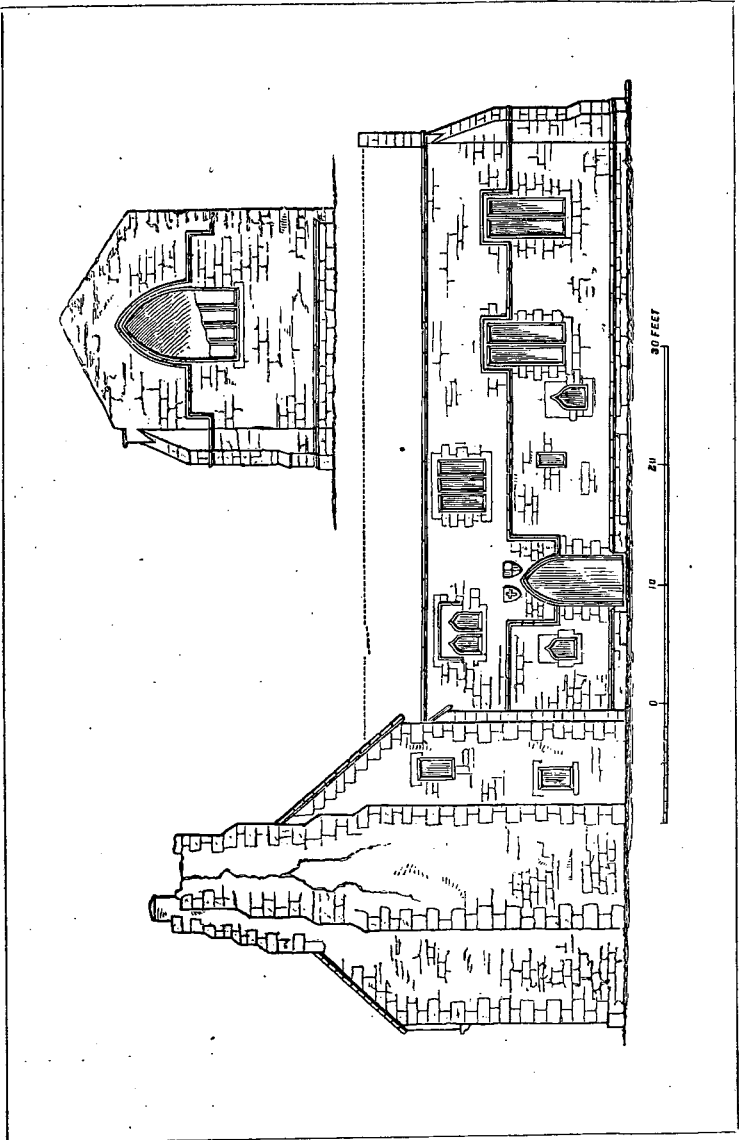

REMAINS OF CHIBBURN PRECEPTORY (Elevation from the South).

chapel of the preceptory remain virtually as they were left by the Hospitallers. Their architectural features have been described in a paper by the late Mr. F. R. Wilson, printed in a former volume of the transactions (*Arch. Ael.*, vol. v. p. 113) of this society; in a short account by Mr. J. H. Parker in his *Domestic Architecture in England in the Fourteenth Century*; and in a valuable paper of great accuracy, contributed by Mr. Woodman to the *Archaeological Journal*, vol. xvii. pp. 35-38. Mr. Woodman says:—

The building has been defended by a moat, enclosing an area of about 100 yards in diameter; the walls are of stone, and the roof had been originally covered with freestone slates. The buildings, as will be seen on the accompanying ground-plan, formed a parallelogram, having a courtyard (A) in the middle;

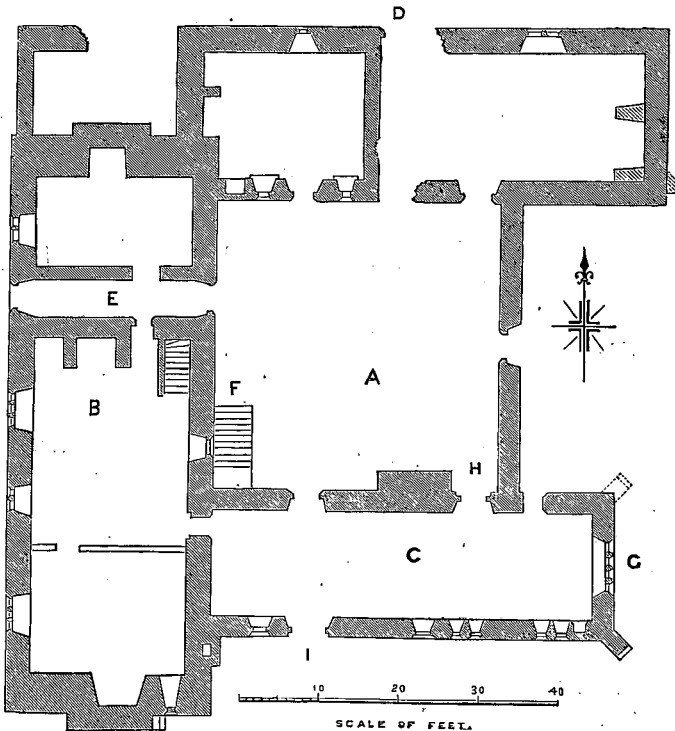

on the west side is the dwelling house (B); the chapel (C) occupies the entire south side, and various offices have been on the north and east. The principal entrance was by an arched gateway (D) into the court on the north side. The dwelling house (B) is of two stories, and has been divided into three apartments

on each floor. On the ground floor is a passage (E) with a low arched doorway, and there are four mullioned windows, two of three lights, and the others of two lights each; the stairs leading to the upper floor are constructed of solid blocks of wood; the ceiling of the ground floor is formed merely by the oak joists and boards of the floors of the apartments above, both joists and boards having a reed run along their angles, and the under surface of the boards planed smooth, and left without any plaster. The windows of the upper floor opening towards the west are now flush with the wall, being of comparatively modern construction, but originally they appear to have rested on corbels projecting about twelve inches, and this arrangement may have served, it is supposed, for some purpose of defence.

There is also access to this floor by stone stairs (F) from the court. In each apartment is a spacious fire-place, deeply recessed, having the lintel formed of a very large stone, with a relieving arch above. In one of the upper chambers an old partition remains, consisting of oak planks set in grooves at the top and bottom. The edges of the planks are reeded on the face; they measure about five inches broad and three inches thick, and are placed four inches apart, the intervening spaces being filled up with clay and straw.

The southern or external wall of the chapel (C) had probably undergone many alterations before it ceased to be used for a place of worship. At the east end (G), which some have supposed more modern than the rest, is a pointed window of four lights (see section of jamb, fig. 1); on the south side were two

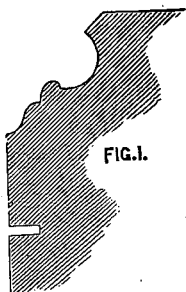

FIG. I.

large square-headed windows, possibly more modern than the western part of the building; and at about mid-height there is a string-course (see section, fig. 2) which rose over the large windows and fell at the doorway. There have apparently been two entrances, one on the north side (H) by a pointed arch with mouldings (see section of door jamb, fig. 3), and the other on the south (I), a plain-pointed doorway with a drip-stone. On each



FIG. II.

side of the latter door there is an ogee window widely splayed and square-headed on the inside; above, and a little to the west of the doorway, is a double ogee

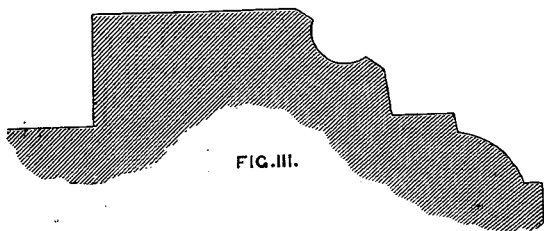

FIG. III.

window with drip-stone above; a cornice ran along beneath the roof (see section, fig. 4). Immediately over the arch of the south doorway there are two escut-

cheons; the charges are nearly obliterated, but traces of a cross patée, doubtless for the knights of St. John, may be seen on one, and a quarterly coat on the other. The east end (G) has an oblique buttress at the south-east angle, and possibly a similar buttress may have existed at the other angle.

In the chapel a peculiarity deserves notice; there is a floor nearly on a level with that of the upper rooms and communicating with them; the upper chamber so formed had a fireplace in a massive chimney which is built from the ground, projecting on the outside near the entrance door (H). The floor does not extend to the east window, but about two-thirds of the entire length from the west

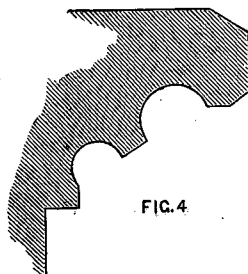

FIG. 4

end. This chamber probably opened at the east end into the chapel, and was doubtless used by the principal inmates of the house at the time of divine service. Another example of such an arrangement may be noticed in the chapel in Warkworth castle. The piscina remains in the south-east angle; human bones have been occasionally found, and a grave slab with a cross flory now forms the threshold of the door leading from the courtyard into a stable (see p. 280). This slab is of greater width at the head than at the foot; the head of the cross carved upon it is pierced in the centre with a large curvilinear lozenge. In one of the windows the upper portion of a stone coffin may be seen, placed in a cavity of the wall. There remains a corbel or truss rudely carved in oak, which may have been intended to represent the mitred head of a bishop, or possibly an angel, with a fillet round the forehead ornamented in front with a cross. Of the roof, now wholly fallen, a few strong rafters remained in 1853, supporting thatch. The original roof may have been of higher pitch.⁵

But Mr. Woodman's collection contains some unprinted documents which, with some other notices printed in the appendix, will yield all that is known of the connection of the Hospitallers with this county.

The date or period of the acquisition of Chibburn by the order can only be inferred. The manor of Widdrington was held in the time of Henry II. by Bertram de Widdrington of Walter fitz-William as of his barony of Whalton, but his right of possession was disputed by William Tascha. To decide the cause a wager of battle or judicial duel was appointed to be fought at Whalton, when on the non-appearance of Tascha and of his surety, Alan de Dririg, the judgment of the court was given for Widdrington and attested by a large number of the gentlemen of the district. Now, the absence from this list of the names of the preceptor and brethren of Chibburn offers negative

⁵ The *Archaeological Journal*, 1860, pp. 35-38.

evidence that the house was not then founded.⁶ On the suppression of the Templars in 1308, efforts were made by the Hospitallers to get themselves declared heirs to their possessions, their claim being supported by the pope. Before the king would make the desired grant, an enquiry was made into the temporal position of the claimants, and the return made in 1313 to the mandate of the nuncio, preserved in Bishop Kellaw's Register, makes particular mention of the house of Chibburn; a proof that this estate was an original possession, and not a reversion from the Templars.

The next notice is to be found in the report made in 1338 by prior Philip de Thame to the grand-master Elyan de Villanova. It was discovered by the Rev. Lambert Larking in 1839 in a plastered over closet at Malta, and contains a detailed account of the income and outgoings of the bailiwick of Chibburn under its preceptor, brother John de Bilton.

BAILLIWICK OF CHIBBURN IN THE COUNTY OF NORTHUMBERLAND.⁷

Chibburn—There is a manor there, built and ruinous, of which the manor house is worth yearly 6s.
 There are 190 acres of land there, at 4d. an acre, and they are worth 63s. 4d.
 Also 8 acres meadow, at 2s. an acre, worth 16s.

⁶ In the Calendar of Escheats in the sixth year of Henry IV., there is mention of 'Willelmus Heron Chevalier et Elizabetha uxor ejus Escheti maner. de Temple Thornton LVI acre terr. ut de hospit. de Chilburne,' and in the Great Pipe Roll, anno 1228, in the twelfth of Henry III., 'Et de x^s de quadam navi fracta in Chilburnemue.' In the appendix to *North Durham* (dclxxi. p. 116), Dr. Raine prints a grant to Holy Island, witnessed by John de Crauinne, the preceptor of Chibburn, and Alan and Robert, clerks of the same place.

⁷ *BAJULIA DE CHIBOURN, IN COMITATU NORTHUMBRIE.*

Chiburn. Est ibidem unum manerium edificatum et ruinosum, cujus herbagium valet per annum vj^s
 Sunt ibidem ix^{xx}. acre terre, pretium acre iiijd. et valent lxij^s iii^d
 Item viij. acre prati, pretium acre ijs. et valent xvi^s
 Item de redditu assiso per annum xx marce; tempore pacis, que nunc propter guerram Scotie vix levari possunt: — per annum cx^s
 Item fraria ibidem per annum, ratione guerre supradicte, xij marce et dimidia, et non plus, quia ista bajulia est in marchia Scotie.
 Et de perquisitis curiarum per annum x^s
 Item de pastura, tam pro vaccis quam pro bidentibus xl^s
 Et de firmis et molendinis per annum v marce
 § Summa totalis recepti et proficui dicte bajulie ... xxxv marce xij^s

Reprise. Inde in expensis domus; videlicet. pro preceptore, ij. fratribus, et aliis de familia domus, prout decet, et etiam aliis supervenientibus, causa supradicta. In

Also for assize rent, 20 marks yearly in time of peace, which now can scarcely be raised on account of the Scotch war: yearly	110s.
Also the brotherhood there, yearly 12½ marks and not more, for the above reason, because that bailiwick is in the Scottish march	12½ marks
And for perquisites of the courts, yearly	10s.
Also for pasture, both for cows and sheep	40s.
And for farms and mills, yearly	5 marks
Sum total of receipts and profits of the said bailiwick	35 marks 12s.

DISBURSEMENTS.

Thence in household expences; viz., for the master, two friars, and others of the household, as is becoming, and also for others who come in, for the aforesaid cause. In bread, furnished yearly, 25 quarters at 3s. a quarter, worth ...	75s.
In brewing ale, 28 qrs. 'brasei ordeï,' at 2s. a quarter worth	56s.
In cooking expences, as in flesh, fish, etc., 18d. a week ...	78s.
And in robes, mantles, and other things necessary for the master and his brotherhood	69s. 4d.
And for the salary of one chaplain, yearly	15s.
And for the salary of one chamberlain, yearly	10s.
Also for a groom, 5s., and for one villein, 3s.	8s.
And for the salary of one 'lotricis,' yearly	12d.
Pensioner. Also William de Wyrkelee received yearly, for the term of his life by charter of the chapter	20s.

	pane furnito per annum xxv. quarteria, pretium quarterii iijs. et valent	lxxv ^s
In	cerevisia bracianda xxviij. quarteria brasei ordeï, pretium quarterii iijs. et valent	lvj ^s
Et	in expensis coquine, ut in carne pisce et aliis, per septimanam xvijjd.	lxxviij ^s
Et	in robis, mantellis, et aliis necessariis preceptoris, et confratris sui	lxi ^s iij ^d
Et	pro stipendio unius capellani per annum	xv ^s
Et	in stipendio j. camerarii per annum	x ^s
Item	pro palefridario vs. et pro j. pagetto iijs.	viiij ^s
Et	in stipendio unius lotricis per annum	xij ^d
Pensionarius.	Item Willelmus de Wyrkelee capit per annum, ad terminum vite, per cartam capituli	xx ^s
	Item cuidam senescalco defendendo negotia domus per annum	vj ^s viij ^d
	Item clerico colligenti confrariam per annum	j marca
	Summa omnium expensarum et solutionum xxvj marce	vj ^s viij ^d
	Summa Valoris.—Et sic remanent ad solvendum ad Thesaurarium pro oneribus supportandis ix marce,	vj ^s viij ^d
	Et non plus quia terra est destructa et depredata pluries per guerram Scotie.	

Nomina Fratrum } Frater Johannes de Bilton, s. preceptor.
 } Frater Johannes Dacombe, capellanus.
 } Frater Simon Dengayne, s.

Also to a certain steward, defending the affairs of the house,
 yearly 6s. 8d.
 Also to a clerk defending the brotherhood, yearly 1 mark
 Total of all expences and payments 26 marks 6s. 8d.
 Total value:—And so there remain, to be paid to the
 Treasurer for meeting obligations... .. 9 marks 6s. 8d.
 And no more, because the land has been laid waste and
 plundered several times by the Scottish war.

Names of the brothers { Brother John of Bilton, preceptor.
 { Brother John Dacombe, chaplain.
 { Brother Simon Dengayne.

Between the year 1313 and the suppression of the order, the Hospitallers had acquired by gift and possibly by purchase many other estates and lands in the county. They are enumerated in the Minister's Accounts of 5 Edward vi. Besides Chibburn and Temple Thornton there were lands at Meldon, Morpeth, Ulgham, North Seaton, Newbiggin, Ellington, Shilbottle, Warkworth, Spindleston, Fallodon, Woodhall, Felton, Bolton, Alnwick, Stanforth-hall, Temple Healey, Whalton, Kenton, Longwitton, Thockrington, Denton, Fenham, Killingworth, Edlingham, Hoborn, Bockenfield, Burton, Milburn-grange, Chevington, Morwick, and coal mines at Fenham, which, with some arrears recovered in that year, produced a gross income of £25 2s. 10d.

Two years afterwards, Sir John Widdridgton and Cuthbert Musgrave of Harbottle, in consideration of £756 1s. 5½d., obtained a grant under the great seal, of the manor of Chibburn and certain lands which had belonged to Newminster at Shotton, adjacent to the Widdrington manor of Plessy.

At the end of the sixteenth century Chibburn was in the possession of Hector Widdrington of Berwick, a natural son of Sir John Widdrington. He was presumably a tenant.

His will and inventory remain at Durham. They are as follow:—

In the name of God Amen, I Hector Wooddrington, one of the Constables of Horsmen of her Ma^{tie} Towne of Barwicke upon Twede, though sike in bodye yett of good and p^{er}fect remembra^{nce} the Lord be thanked therfore, do make and ordayne this my last Will and Testam^t in mannr and forme followinge. First I bequythe my Soul to Almightye God and my bodye to be buried in the earthe. Itm I gyve and bequythe unto Ralphe Wooddrington the House in Barwike wherin I nowe dwell, and fiftye pounds in moneye to be payd hym by my executorys uppon the receipt of my goods and debts. Itm I gyve and bequythe unto Isabell Graye, Dowghter unt' my Sister Marye Graye, fourty pounds to be payd as is aforesaid. Itm I gyve and bequethe unto my Sister

Rebecka Wooddrington, ten pounds. Itm I gyve and bequythe unto my Brother Isacke Wodrington his eldest sonne Robt. Ten pounds. Itm I gyve and bequythe unto my Serva'nts Mathewe Humphraye and Thomas Raye, eyther of them, ten pounds and all the Corne betwene them I have lying at CHIBBURNE. Itm I gyve and bequythe unto Steven Bell, fortye shillings. Itm I gyve unto Roland Archer, syxe pounds. Itm I gyve and bequythe vnto Marye Lancaster, in remembran'ce of my good will towards her one hundrethe angells. Itm I gyve vnto Thomas Garratt and Hector Garratt, Ten pounds betwene them to be equalye devyded. Itm I gyve and bequythe vnto John Harwood, Ten pounds. Itm I gyve unto Willm. Tappye, in concydera'con of all his paynes and debts I owe him, fyve pounds. The rest of all my Goods and Chattalls, moveables and immovables, Bonnds, Bills debts, and debts, Lands Leases, recking w^{ch} anye maner of wayes are dewe to me, my debts beinge payd and my Funerall expences discharged, I gyve and bequythe unto Elizabethe Ladye Wooddrington her heirs and assigns for ev^r, whom I ordayne and make my sole and full Executrix of this my last Will and Testament. In witnes wherof to these pr'sents I have sett my hand the xxviij daye of Aprill 1593 in the fyve and thirtye yeare of the raigne of O^r Sovraigne Ladye Elizabethe, by the Grace of God, Quene of England, France and Ireland, Defende^r of the Faythe, &c.

Hector Wooddrington his mark X.

I give unto Willm Teasdall xl^s and unto Hector Hall xl^s. Itm to Emay xx^s and a cote in the pr'senc' of Willm Garford John Harwood Thomas ^X his mark Raye.

[The inventory taken 15 May, 1593, after enumerating testator's goods at Berwick amounting to ciii^{li} xi^s ii sets out]

Itm Good of the said Hector Wooddrington at Chiburne presed by Willm. Garford, Robt. Trumble, Vincent Tailer and Rowland Archer.

Imprimis one flanders chist... ..	iiijs ^s	
Itm in the same chist, iiij table clothes, and tow cupbord clothes	xiijs ^s	iiij ^d
Itm vii napkins	ij ^s	iiij ^d
Itm one Featherbed, one bolster, two pillowes, ij Blanketts, one pece of blewe Clothe, one quilt, and one covringe of arras	xc ^s	
Itm one greate chist... ..	vij ^s	
Itm one Basin and Ewre, iiij pewder dishes, v Saucers, syx Poringgers, and three broken candelsticks ...	vij ^s	
Itm one quishinge of arras worke and two pec ^s of nedell worke for quishings		xiiij ^d
Itm one cros bowe and a Racke	xiijs ^s	iiij ^d
Some	iiij ^{li}	ix ^s ii ^d
Somma totalis viii ^{li} iiij ^d ...		

W. Garford—Robert Tromble—Vincent X Tayler
Roland X Archer.

During the seventeenth century Chibburn may have been used, as the Rev. John Hodgson suggests, as a dower house for the ladies of

the Widdrington family. During the last decade it was occupied by one of the family of Burrell of Long Houghton and Lesbury, for on the 11th November, 1697, George Burrell of Chibburn, conveyed a messuage and close in Alnmouth to Brown.

With the rest of the Widdrington estate it was forfeited for the part taken by William Lord Widdrington in the rebellion of 1715, and was subsequently sold to the York Buildings Company. While in the Crown a survey was made, from which the following is extracted:—

NORTHUMBERLAND.—[Extract from] A survey of the estate late of the Lord Widdrington at Widdrington castle in the parish of Woodhorne in the county aforesaid taken July 3 1717 5 yards & a half to the perch.⁸

Tenants.	Chiburne in the Chapelary.
John Annett 26 : 13 : 04	Three houses and Homesteads
Tho. Annett 26 : 13 : 04	Meg's meadow } 10
John Garrett 26 : 13 : 04	The Fatteningfield Pasture } 16
	Whitefield and oakesdo. and arable } 56
	The Cow Close Meadow and arable } 18
£80 : 00 : 00	The Linck pasture } 24
	ST. JOHN'S FLATT, meadow arable
	and pasture } 26
	The Greens and ST. JOHN'S PAS-
	TURE } 27
	acres 177 £80 : 00 : 00

Though the mansion house must have been well known to Horsley, who resided at Widdrington, where, besides his ministerial avocation, he acted as agent to the York Buildings Company,⁹ it is not noticed in his *Northumberland*. It was dismissed by the Rev. John Hodgson in a few words, and attracted little notice until about 1846, when a commencement was made in pulling down some of the buildings for the sake of the material, a proceeding fortunately quickly arrested by the judicious interference and protestations of neighbouring anti-quaries and men of taste. The mansion has not ceased to be occupied, formerly as a farm house, latterly in tenements by labourers. During last summer, at the intercession and recommendation of the Rev. Wm. Greenwell, the present owner, Mr. Taylor of Chipchase, by the replacing of fallen stones, the mending of roofs and of chimney stacks, and by the judicious running of cement into the interstices and rents in the walls, has done what was necessary to preserve and keep good these unique buildings for many years to come.

⁸ From the original in the Tower of London among the papers taken from Essex House relating to the rebellion of 1715.—W. W.

⁹ *Newcastle Journal*, 13th January, 1721/2.

APPENDICES.

A.—GRANT FROM WALTER FITZ WILLIAM BARON OF WHALTON TO
BERTRAM DE WIDDRINGTON.

Walterus, filius Willelmi omnibus hominibus suis et amicis francis et Anglis presentibus et futuris salutem. Sciatis me dedisse et concessisse Bertramo de Wdringtuna villam que vocatur Wdringtuna et medietatem Burgundie¹⁰ cum omnibus pertinentiis suis in bosco et in plano; in pratis et in pascuis; in aquis et molendinis, liberas et quietas sibi et heredibus suis in perpetuum tenendas a me et heredibus meis sicut pater suus melius et liberius eas una die et una nocte tenuit et ipsemet hactenas tenuit pro servicio unius militis faciendo in feudo et hereditate. Cognitum etiam vobis sit omnibus qui has litteras videritis vel auferitis quod illa calumpnia quam Willelmus Tasca habuit adversus Bertram de Wdrington quod Bertram dirationavit iudicio curie domini sui et quod Willelmus nequiter eam amisit eo quod die cepit in curia summi domini Walteri filii Willelmi de nequitia sua defendendi et hoc se defecit; et Alanus de Dririg parem suum vadem suum dedit ad probandum illum de nequitia et ille suum dedit et diem cepit ad defendendum se iudicio curie domini sui, scilicet, duello et ad dies constitutos et terminatos nec venit nec contra mandationem immo ut nequam se deficit et ideo iudicio curie summi domini Walteri filii Willelmi ut nequam eam amisit et Bertramo sicut recto heredi remisit sicut propria hereditas sua. Et quod ego Walterus filius Willelmi warranto hoc iudicium quod factum fuerit apud Weltuna de appellatione Alani de Dririg et de defectu Willelmi Tascha. Hoc sciendum quod Hodonellus de Umframvilla hoc iudicium fecit et testimonio suo approbat illud cum his qui subsequuntur. Testibus Willelmo de Merlay, Widone Tyson, Willelmo de Turbrevilla, Waltero filio Stanceli, Richardo fratre ejus, Ulfchill de Swyneburna, Davido de Buivilla, Johanne filio Semani, Wilardo de Trophill, Rogero fratre ejus, Richardo filio Semani, Radulfo de Sancto Petro, Willelmo de Grenevilla, Richardo Bartrum, Umfrido de Oglia, Gilberto filio ejus, Roberto de Newham, Roberto de Unfanwilla, Huctredo filio Faramani, Willelmo filio Alfredi, Hugone filio Stanfelini, Osberto Presbitero de Weltun, Osberto Presbitero de Ortun, Willelmo de Hebra, Herberto Preposito de Mitford, Alstar filio Glessan, Roberto filio Petri, Roberto Belmis, Rogero filio Grunbald.¹¹

B.—GRANT FROM EDWARD VI. TO SIR JOHN WIDDRINGTON AND
CUTHBERT MUSGRAVE.

Exchequer Remembrancer's Office, Originalia Roll, 7 Edw. vi. part 2.

Rex omnibus ad quos etc. Salutem. Sciatis quod nos pro summa septingentarum quinquaginta sex librarum septem decem denariorum et unius obuli legalis monete Anglie ad manus Edmundi Pekham militis ad usum nostrum per dilectum nobis Johannem Wytheryngton de Wytheryngton in Comitatu Northumbrie militem et Cuthbertum Musgrave de Harbottell in dicto Comitatu Northumbrie armigerum praemanibus bene et fideliter soluta unde fatemur nos plenarie fore satisfactos et resolutos eosdemque Johannem et Cuthbertum

¹⁰ Burgundea = Burradon in Tynemouthshire.

¹¹ Hodgson, part ii. vol. ii. p. 248.

heredes, executores et administratores suos inde acquietatos et exoneratos esse per presentes de gratia nostra speciali ac ex certa sciencia et mero motu nostris dedimus et concessimus ac per presentes damus et concedimus prefatis Johanni Wytherington et Cuthberto Musgrave totum Dominium et Manerium nostrum de Chibborne cum suis iuribus, membris et pertinentiis universis in Comitatu nostro Northumbrie parcellum possessionum nuper preceptoris montis Sancti Johannis Baptiste in Comitatu nostro Eboraci nuper Prioratui sive Hospitali sancti Johannis Jerusalem in Anglia modo dissoluto dudum spectantium et pertinentium ac parcellum possessionum inde existentium ; ac omnia et singula mesuagia, molendina, tofta, cotagia, columbaria, ortos, pomeria, Gardina, Domos, edificia, terras, tenementa, prata, pascuas,¹¹ pasturas, communias, boscos, sub-boscos, vasta, Jampnum, bruere, moras, mariscos, aquas, Stagna, Vivaria, piscaria, piscaciones, redditus, reversiones, servicia, feoda militum, Warda, maritagia, escaeta, relevia, Curias letas, visa ffrancorum .plegiarum ac omnia ad visum [francie] plegiae pertinentia, catalla,¹² Waiviata, extrahitura, catalla felonum et fugitivorum ac felonum de se et in exigend. posit. ; Necnon deodandum, fines, amerciamenta, herietta, liberas Warrenas, ac omnia [alia] jura, jurisdictiones et proficua, commoditates, emolumenta et hereditamenta nostra, quecumque cum pertinentiis suis universis scituata, jacentia, et existentia in Chibborne, in dicto Comitatu Northumbrie ac alibi in eodem Comitatu Northumbrie, dicto Dominio et manerio de Chibborne quoquomodo spectantia vel pertinentia aut ut membripartes vel parcella ejusdem Domini et Manerii antehac habita, cognita, accepta, usutata, seu reputata, existentia ac eciam omnes omnimodis decimas bladorum, garbarum, granorum et feni ac alias decimas quascumque in Chibborne in dicto Comitatu Northumbrie dicto nuper preceptori Montis sancti Johannis Baptiste et dicto nuper prioratui sive Hospitali sancti Johannis Jerusalem in Anglie quondam spectantia pertinentia ac parcellum possessionum inde existentium ; ac eciam totum illud messuagium et tenementum nostrum et unum le Garthe nostrum ac omnes terras et pasturas nostras, continentes per estimationem triginta octo acras ; ac communiam pasture cum omnibus et singulis suis pertinentiis in Shotton juxta Stannyngton in dicto Comitatu nostro Northumbrie modo vel nuper in tenura sive occupacione Rogeri Blackberd ac nuper monasterio de Newmynster in dicto Comitatu Northumbrie dudum spectantem et pertinentem ac parcellum possessionum inde nuper existentium ; Necnon totum illud Cotagium sive tenementum nostrum cum pertinentiis in Shotton alias dictum Shotton juxta Stannyngton in dicto Comitatu Northumbrie modo vel nuper in tenura sive occupacione Johannis Cowper nuper Monasterio sive Dominio Monalium infra villam Novi Castri super Tinam dudum spectantem et pertinentem ac parcellum possessionum inde nuper existen¹³

Et he littere nostre patentes vel Irrotulamenta earundem erunt annuatim et de tempore in tempus tam dicto Cancellario et Generalibus supervisoribus ac consilio nostro dicte Curie nostro Augmentacionum et Revencionum Corone nostre, quam omnibus Receptoribus, auditoribus et aliis officariis et ministris nostris heredum

¹¹ Pastura is used for all kinds of pasture, in meadows, fields, etc. ; pascua is a place set apart for cattle, *e.g.*, mountains, moors, marshes, plains, untilled ground.

¹² Waiviatum, things with no owner assigned to them.

¹³ Ebor. m. 95.

et successorum nostrorum quibuscumque pro tempore existente sufficiens Warrantum et exoneratio in hac parte; volumus eciam ac per presentes concedimus prefatis Johanni Wytheryngton et Cuthberto Musgrave, quod habeant et habebunt has litteras nostras patentes sub magno sigillo nostro Anglie debito modo factum et sigillatum absque fine seu feodo magno vel parvo nobis in¹⁴ Hanaperio nostro seu alibi ad usum nostrum proinde quoquomodo reddendo solvendo vel faciendo. Eo quod expressa mencio, etc. In cujus rei, etc., apud Westmonasterium secundo die Maii.

C.—COURT OF AUGMENTATIONS: MINISTERS' ACCOUNTS.

Newminster incip. 4-5 Edw. vj.

Percell. possessionum nuper preceptoris Montis Sancti Johannis Baptiste in Comitatu Eboraci.

Balliatum terrarum et possessio- num in Comitatu Northumbrie dicto nuper preceptoris pertinen- tium.	}	Compotus Johannis Taylor deputati Roberti Fenwicke Ballivi sive Collectoris reddituum et firmarum ibidem per tempus supradic- tum.
---	---	---

ARRERAGIA. Idem onerat super compotum de lxvi^s viii^d de arreragiis ultimi compoti anni proximi precedentis prout in pede ejusdem plenius patet. Summa lxvi^s viii^d.

**TEMPLE
THORNETON** Sed reddet compotum de iiiij^{ij} vj^s de redditibus et firmarum tam liberorum tenentium quam tenentium ad voluntatem domini Regis in Templethorneton solvendo annuatim ad festa Sancti Martini in Hieme et invencionis Sancte Crucis equaliter. Et de xvi^s de firma tocius capelle de Thorneton ac unius parvi clausi vocati Chaple Yarde et unius molendini aquatici cum suis pertinenciis in Thorneton simul cum omnibus et singulis decimis eidem capelle pertinentibus quoquo modo spectantibus sic modo dimiss. Roberto Bullocke per Indenturam sub sigillo Curie Augmentationum datum apud Westmonasterium xii^o die Julii anno regis Henrici viii^{vi} xxxvii^o per annum solvendo ad festa Sancti Michaelis Arch. annunciationis Beate Marie Virginis prout in dicta Indentura in compoto anni Regis Edwardi sexti primi ad largum declaratum plenius patet. Et de xvj^d de firma unius parcelli terre vastae jacentis in dicta villa de temple-thorneton predicta super quam quidem parcellum terre scilicet cujusdem Molendini quondam statuit cum gardino eidem annexato in tenura predicti Roberti Bullok de novo repertum per examinationem dicti compoti super hunc compotum. coram Auditore solvendo ad terminos predictos per equales porciones. Summa iiiij^{ij} viij^s viii^d.

**REDDITUS ASSISE
DE MELDONE.**¹⁵ Et de xx^d de redditibus Assise in Meldone predicto exeuntibus de certis terris vocatis Heron Land, Bores land solvendo ad festum Sancti Martini in Hieme et invencionis Sancti Crucis equaliter. Et de xii^s viij^d de firma iiiij^{or} cotagiorum cum pert.

¹⁴ Office of the Treasury to which are brought moneys for sealing charters, etc.

¹⁵ Meldon is very near to Temple Thornton, and belonged to the Heron family, who seem to have been munificent donors to the order. This family also possessed the estate and barony of Hadston, in the parish of Warkworth, and closely adjoining Chibburn. Their later seat was at Bokenfield, in the parish of Felton, out of which the order drew 12d. per annum.

ibidem in tenura et occupacione uxoris Roberti Watson, Rob. Rotherome, Joh. Rochester, Joh. Hale de anno in annum solvendo ad festa predicta equaliter. Summa xiiij^s iiij^d.

- MORPETHE.** Et de xii^d de firma certarum terrarum in tenura Joh. Harrison per annum solvendo ad festum Sancti Martini etc. Summa xij^d.
Et de iiij^{li} de firma domini sive manerii de Chibborne cum omnibus terris, dominicis, pratis, pascuis, pasturis aliis proficuis, ac commoditatibus quibuscumque eidem dominio sive manerio spectantibus, sic dimiss. Joh. Affenwicle per indenturam sub sigillo Curie Augment. etc. pro termino annorum misericordie ad hoc coram auditore ostens. Reddendo inde ad festa Annunc. Beate Marie Virginis et Sancti Michaelis Arch. ultra stipendium capellani divina servicia infra capellam dicti domini Celebrantis, per annum. Summa iiij^{li}.
- HUGHAM.**¹⁶ Et de ii^s ii^d de redd. et firmis tam liberorum quam custumariorum tenentium ac ad voluntatem domini Regis in villa de Hugham predicta per annum solvendo ad festa predicta equaliter. Summa ii^s ii^d.
- SEATON
WOODHORN.** Et de vj^s de redd. et firmis in villa de Woodhorne seaton per annum solvendo ad festa predicta per equales porciones. Summa vj^s.
- NEWBIGGINGE.** Et de v^s ij^d de redd. et firmis tam liberorum tenentium quam tenentium custumariorum in Newbigginge predicto annuatim solvendo ad festa predicta per equales porciones. Summa v^s ij^d.
- ELLINGTON.** Et de v^s de redd. et firm. in Ellington predicto solvendo annuatim ad festa predicta per equales porciones in tenura diversorum tenentium ad voluntatem domini Regis solvendo ut supra. Summa v^s.
- SHILBOTTELL.** Et de ij^s iiij^d de redd. et firm . . . terrarum in Shilbottell predicto in tenura diversorum tenentium solvendo ad festa Sancti Martini in Hieme et Pentecostes per equales porciones. Summa ii^s iiij^d.
- WARKEWORTHE.**¹⁷ Et de v^s de redd. et firmis in Warkeworthe predicto in tenura diversorum tenentium Solvendo annuatim ad festa predicta per equales porciones. Summa v^s.
- SPINDLESTON.** Et de vj^s viii^d de redd. et firm. terrarum et tenementorum in Spindlestone predicto in tenura diversorum tenentium Solvendo annuatim ad terminos equaliter. Summa vi^s viii^d.

¹⁶ Ulgham, a chapelry in the parish of Morpeth.

¹⁷ 1 Edw. I. Robt. de Hampton, Sheriff of North^d, accounts with the King, and takes credit for 2 marks granted to the Knights Templars for 2 years, and the Sheriff charges himself with 8^s 8^d for 13 acres of land and one toft for the Sergeanty of Tokesden, received from the Prior of the Hospital of Jerusalem in England, and also of £11 11s. from the same for the years aforesaid. *Pipe Rolls*, 1, 2, and 3 Edw. III., all in one roll. There is still a field close to Togston, but in Acklington township, called Temple-hill.

- FALLOWDOWNE.**¹⁸ Et de ij^s de redd. et firm. terrarum in Fallowdowne predicto in tenura diversorum tenentium. Solvendo annuatim ad festa predicta equaliter. Summa ij^s.
- WOODHALL ET BURNWICKE.** Et de x^s de redd. et firm. terrarum et tenementorum ibidem in tenura diversorum tenentium Solvendo annuatim ad festa predicta per equales porciones. Summa x^s.
- BOLTONE IN COOKEDALE.** Et de viij^s de redd. et firm. diversorum terrarum et tenementorum in Bolton et Cookedale. Solvendo annuatim ad festa, etc. Summa viij^s.
- FELTONE.** Et de iiiij^d de redd. et firm. in Felton predicto in tenura diversorum tenentium Solvendo annuatim, etc. Summa iiiij^d.
- GRENEFFILDE**¹⁹
IN ALNEWICKE. Et de vj^s viiiij^d de redd. et firm. trium messuagiorum extra villam de Alnewicke cum totis terris in le Southside de Alnewicke predicto Solvendo annuatim, etc. Summa vj^s viiiij^d.
- STANFORTHALL.** Et de xl^s de firma cujusdam graungie vocate Staynforthall cum omnibus terris, pratis, pascuis, pasturis eidem pertin. dimiss. Christofero Burrell per indenturam ut dicitur Solvendo, etc. Summa xl^s.
- TEMPLE HELAY.**²⁰ Et de liij^s iiiij^d de firma duarum porcionum omnium illorum terrarum, pratorum, pastur. cum suis pert. in Temple Helawe predicto dimiss. Cuthberto Radcliffe militi de anno in annum reddendo inde annuatim ad dicta festa per equales porciones. Et de xxvj^s viij^d de firma tercię partis terrarum, pratorum et pastur. in Temple Helaye predicto dimiss. Joh. Orde per annum Solvendo, etc. Summa iiiij^d.
- LYNDON BRIG.** Et de xvij^s de firma duorum tenementorum vocatorum Templehouse et Shepewoode cum pert. scituat. jacentium et existentium in dicto Com. Northumbrie cum omnibus terris, pratis, pascuis, et pasturis communis, proficuis, commoditatibus et emolumentis quibuscumque dictis tenementis quoquo modo spectantibus et pertin. sic dimiss. per indenturam sub sigillo Curie Augmen. pro termino xxj annorum Reddendo inde ad festa predicta prout tam in dicta Indentura data xx^o die Decembris anno Regis Henrici viii^o xxxvij^o quam in compoto de anno Regis Edwardi vi^o primo ad largum et plenius patet. Summa xvij^s.
- WHAWTON.** Et de ij^s de firma certarum terrarum in Whawton predicto dimiss. Geo. Simpson ad voluntatem Domini Regis Solvendo annuatim, etc. Summa ij^s.
- KENTON.** Et de iiiij^s de firma certarum terrarum cum suis pert. in Kentone predicto sic dimiss. Wm^o Baynett de anno in annum. Solvendo, etc. Summa iiiij^s.

¹⁸ Falloodon, in the parish of Embleton.

¹⁹ The Alnwick lands began at the top of Clayport.—On them is built the mansion called Swansfield. Tate, ii. p. 65.

²⁰ Temple Healey, in the chapelry of Netherwitton.

- LONGWITTON.** Et de v^s de firma certarum terrarum cum suis pert. in Longewitton predicto dimiss. Robt^o Stephenson de anno in annum. Solvendo ad festa Sancti Martini in Hieme, et inventionis Sancti Crucis equaliter. Summa v^s.
- THOKEINGTON.**²¹ Et de xx^s de firma omnium terrarum et tenementorum cum pert. jacentium in villa et campis de Thorneton, parva Babington, et Biall infra communes ibidem vocatos Temple lande cum libertatibus, Fraunchisis, proficuis commoditatibus eisdem terris et tenementis spectantibus et pertin. sic dimiss. Edw^o Shaftoo per indenturam sub sigillo nuper prioratus Hospitalis Sancti Joh. Jerusalem in Anglia datam xvij^o die Maii anno Regis Henrici viii^o x^o pro termino xl annorum prout tam In dicta indentura quam in compoto anni precedentis plenius patet. Solvendo, etc. Summa xx^s.
- DENTONE.**²² Et de xiii^s iiiij^d de firma certarum terrarum et tenementorum cum suis pert. in Dentone predicto dimiss. Anthonio Errington Solvendo, etc. Summa xiii^s iiiij^d.
- FENDHAM.** Et de xlvi^s viij^d de firma omnium illorum terrarum, pratorum et pasturarum vocatorum Feneham ac unius tenementi super eandem pasturam edificati cum universis boscis subboscis mineriis carbonum et metellorum de et in predictis terris pratis et pasturis vocat. Feneham tantummodo except. et reservat. sic dimiss. Geo. Davell per indenturam sub sigillo communi prioris nuper hospitalis Sancti Joh. Jerusalem in Anglia datum xxi^o die Novembris anno Regis Henrici viii^o xxix^o pro termino xxj annorum extunc proxime sequentium per annum Solvendo ad festa purificationis Beate Marie Virginis et Sancti Petri quod dicitur ad vincla prout tam In dicta Indentura quam in compoto anni precedentis. Summa xlvi^s viij^d.
- KILLINGWORTHE.** Et de viij^s de firma certarum terrarum, etc., in Killingworth predicto dimiss. Joh. Killingworthe ad voluntatem Domini Regis Solvendo ad festa Sancti Martini et pentecostes equaliter. Summa viij^s.
- TINDALE.** Et de x^s de firma cujusdam pasture vocate Le Nooke in Tindale in tenura assignatorum Gilberti Stokalle per annum Solvendo, etc. Summa x^s.
- EDLINGHAM.** Et de ii^s de redd. assise diversorum liberorum tenentium domini Regis in Edlingham predictum Solvendo annuatim, etc. Summa ii^s.
- HOLBORNE.** Et de xvij^d de redd. assise diversorum liberorum tenentium Domini Regis in Holborne predicto Solvendo, etc. Summa xvij^d.
- BUCKINGFELDE.** Et de xij^d de redd. assise, etc., in Bucken felde predicto Solvendo, etc. Summa xij^d.
- BURTON.** Et de ij^s de firma unius clausi terre vocati Sancte Johannes lande in tenura — Stephenson per annum Solvendo, etc. Summa ii^s.

²¹ Thockrington, Little Bavington, and Ryal.

²² Denton and Fenham, near Newcastle.

MILBORNE- GRAUNG.	Et de xij ^d de redd. assisé liberorum, etc., de Milborne graunge predicto annuatim Solvendo ad festa Sancti Martini in Hieme et Inventionis Sancti Crucis equaliter. Summa xij ^d .
CHIBBINGTON.²³	Et de ij ^s de redd. assise diversorum liberorum, etc., et de Chibbington predicto Solvendo, etc. Summa ii ^s .
MERRICKE.²⁴	Et de ij ^s de redd. assise, etc., de Merricke predicto Solvendo, etc. Summa ij ^s .
ALNEWICKE.	Et de xij ^d de firma unius cotagii in Bellegate in tenura et occupacione Roberti Muscrope ad voluntatem domini Regis. Solvendo annuatim ad festum Sancti Martini. Summa xij ^d .
MINERUM CARBONUM.	Et de vj ⁿ xiiij ^s iiij ^d de firma tocus mineri carbonum hoc anno terris et pasturis vocatis Fentun invent. dimiss. Radulfo Carre et aliis mercatoribus ville Novi castri super Tinam per Indenturam misericordie ad huc viss. per annum Solvendo ad festa annunciationis Beate Marie Virginis et Sancti Michaelis Arch. equaliter. Summa vj ⁿ xiiij ^s iiij ^d . Summa totalis oneris xxxv ⁿ ij ^s x ^d .
FEOD ET REGARD.	Idem computat in feodo dicti computant ballivi et collectoris omnium et singulorum reddituum et firmarum predictorum ad lx ^s per annum cum vj ^s viij ^d plus eidem allocatum in et recompensacione mane laboris sue hoc anno sustentat in et super collectionem reddituum et firmarum predictorum ex discretione auditoris et receptoris quam solebat allocari viz. in allocatione hujusmodi per tempus hujus compoti lx ^s et in regardo dato clerico auditoris pro scriptura hujus compoti et omnis parcelli ejusdam ad ij ^s per annum viz. in allocatione hujusmodi per tempus hujus compoti prout allocatum est alio auditori Curie Augmentationum ij ^s . Summa lxiij ^s .
DECASUS REDDITUS.	Et in decasu reddituum diversorum terrarum et tenementorum in Boltone et Rookedale superius onerat. ad viij ^s per annum in titulo pro se Eo quod jacet vastum et in occupatione per totum tempus hujus compoti et nihil inde levari potest ex sacramento dicti computationis super hunc compotum coram auditore et sic in decasu per tempus hujus compoti viij ^s . Et in decas. redd. customariorum tenentium de Hugham superius onerat. ad ij ^s ij ^d per annum in titulo pro se eo quod jacet vastum et in occupatione per totum tempus hujus compoti et nihil inde levari potest ex sacramento etc. ij ^s ij ^d . Et in decasu redd. liberorum tenentium domini Regis de Holborne superius onerat. ad xviiij ^d per annum in titulo pro se Eo quod jacet vastum et in occupatione per multos annos elapsos nulla districcio ibidem habenda est ex sacramento computat. super hunc compotum et sic in decas., etc., xviiij ^d . Summa xj ^s viij ^d .

²³ In 1568 Sir John Widdrington and Sir Thos. Grey held lands in West and East Chevington. *Feodary's book*.

²⁴ Morwick, 37 Eliz., the property of the Greys of Chillingham and of Cuthbert Bates, now of the Duke of Northumberland.

Et in denariis per dictum computantem liberat, Thome
LIBERACIONES Newnham milit. receptori domini Regis ibidem de exitibus
DENARIORUM. officii sui hujus anni ad divers. vices infra tempus hujus
 compoti prout per librum Receptoris super hunc compotum
 ostens. et examinat. et in custodia dicti Receptoris remanet. xix^s xiiij^s iiiij^d.
 Et in denariis in compoto receptoris hujus anni onerat. super Joh. Taylor
 ballivum ac collectorem reddituum et firmarum in Temple Thorneton, Meldon
 et Morpeth cum aliis parcellis nuper preceptoris predicti jacentibus in
 Comitatu Northumbrie de parte exit. offic. Domino Regi debitorum finitum
 ad festum Sancti Michaelis Arch. anno Regis nunc Edwardi vj^{ti} v et per
 ipsum aretro et nondum solut. — xxxv^s x^d. Summa xxjⁱⁱ ix^s ii^d.
 Summa allocacionum et liberacionum xxvⁱⁱ ij^s x^d. Et debet x^d.

RESPECTUANTUR. Et de et pro tot denariis de exitibus et proficuis pro uno anno
 et de redditibus domino Regi debitis at festum Sancti Michaelis
 Arch. anno regis Edwardi vj^{ti} v^o provenientibus de firma mineri

The serveis to
 surveye the s^d
 Coolemyne -
 whether it lye
 wast or no.

carbonum in Fentun in tenura Radulfi Carre ad vjⁱⁱ xiiij^s iiiij^d
 per annum Eo quod idem Radhulfus negat solvere dictum
 redditum pro uno anno et die predicto, racione quod dictum
 minerum carbonum jacuit vastum per tempus unius anni et
 di asserens quod nullum proficuum inde provenisse per tempus
 predictum Ideo hic posuit in respecuacione quousque refert warrant. a cancellario
 et concilio Curie augmentacionum pro allocacione ejusdem.

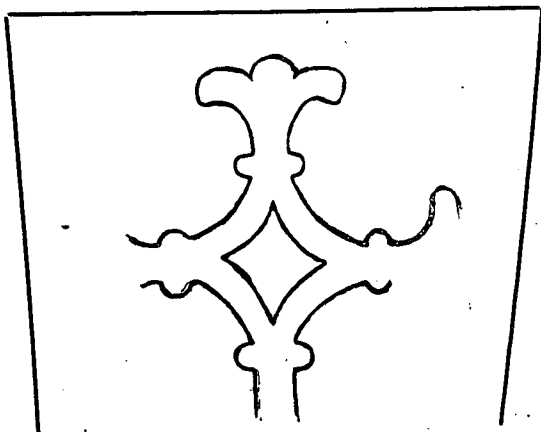

GRAVE COVER, CHIBBURN (See p. 267).