

**CAS 84 LV: Lemaistre vault - Interpretative notes and diagrams**

**1<sup>st</sup> stratigraphic order**

context	no	date	notes
0166	2		
0156	4	1761	
0400	4		
0392	3		
0396	4/5	1768	
0155	5	* 1755	date not chronological
0364	5	* 1760	BRPL under pile
0154	4/5	1763	
0160	5	1755	
0111	5	1777	
0173	5	*	See reappraisal of secondary coffins - N.B. secondary
0420	2/3		
0137	5		
0168	4		
0158	4	1779	
0161	4		
0129	4	1781	
0120	5	17779	
0159	4	1784	
0108	4		
0144	3		
0138	5		
0109	5	1791	
0123	4	1793	
0126	4		
0145	4		
0119	4	1795	
0127	4		
0321	2		
0111	5	* 1777	date not chronological
0107	5		* no outer
0107	5		* no outer
0106	5		* no outer
0143	3		
0133	3		
0096	5	* 1794	Date not chronological
0095	4		

The Lemaistre/Ponterdant vault (vault 434), so called because all extant BRPL's are from either of those families . This oblong vault 2.88m x 2.76m is situated at the lower level directly underneath the central point of the tower [ - in fact there is poss evidence that a plumb bob was affixed to the central point at this level (0191)] in the tower foundations. N/S/E walls filled in with dividing walls of SS 14/15 Access only available from W down tunnel 0.98m wide - 03.43 m long + 01.20m high i.e. restricted. Height of highest point in vault = 01.55m high.

Ist stratigraphic order

BRPL = Breast plate

Cospn = Coffin support

context	no	description
0166	2	Dump of 60% lime 40% sandy mortar on floor of vault + extending down W/E tunnel access. In corners and unevenly deposited. Same composition as mortar in surrounding brickwork. Residue of building works.
0156	4	W/E/H Adult triple shell lead (0157) Inner (0394) Collapsed on N side p22. Body undisturbed. BRPL: Mrs Sussannh Lemaistre 8 <sup>th</sup> Dec 1761 78 years.
0400	4	COSP. 0008 x 11.4m x 00.38m Conifer lying N/S 0.62. E of W wall against N wall - not supporting a coffin
0392	3	Dump of frags of childrens' coffins in NW corner of vault overlying (400). Remnants of BRPL = MRS J _ JANy 1760 giving a TPQ for disturbance.
0396	4/5	W/E/H child's double coffin lead (0397) placed over (0392) in NW corner. Body undisturbed. BRPL: Masr David Pontardant 29 <sup>th</sup> Nov 1768 2 yrs 7mons cf stratigraphy later dates: earlier!!
0155	5	W/E/H Child's triple coffin lead:(0152) Inner lid(1976) Placed on (1396). Outer lid missing. Body undisturbed. BRPL: Miss Susanh Lemaistre May 12 1755 8 weeks. NB earlier than (0396)
0364	5	W/E/H Child's triple coffin lead:(066) lid(359). Placed S of (0396) + (0155) on floor. Outer lid missing. Body undisturbed. BRPL: Miss Susanh Judith Lemaistre Jany 17 <sup>th</sup> 1760 15 days. As (0392) has a T.P.Q of Jan. (1760) is prob a redep.
0154	4/5	W/E/H child's triple shell lead:(0153) Inner lid:(358) Placed on (0364). Outer lid missing. Body undisturbed. Well packed. BRPL: Miss Ann Lemaistre died Sptt 16 1763 14 weeks. Could be primary.
0160	5	Burial plate: Miss Susan Lemaistre May 12 1755 8 weeks. Placed on top of (1054) Presumably from misplaced outer coffin lid of (0155)
0161	4	2x coffin supports: 01.00m x 0.17m x 0.25m, 0.50m x 0.16m x 0.025m. Placed over 0156 + under 0129
0129	4	W/E/H Adult triple shell lead:0130 Iner: 0147. Collapsed to N. Placed on 0161 Cosps. Outer lid missing. Body undisturbed . Mrs Sarah Pontardant 05/05/1781 34 Lead 0173
0173	5	W/E/H Childs Double coffin;(4002) = inner lid. Placed S of (364)(156)(160) on (0392). Outer coffin not apparent. Skele ?undisturbed??
0420	2/3	Dump of child's coffin wood frags (side) at E wall on floor of vault
0137	5	Dump of coffin wood frags in SE corner of vault - frags of 2 outer wooden coffin sides also inc. textile, coffin furniture + piece of p. pot - stoneware rim + side - to be analysed
0168	4	2x cosps 0.26, long + 0.36cm long (no other dims recorded) Placed on floor of vault approx E/N towards E wall.
0158	4	N/S/H Triple shell Adult coffin. Good rich lead: 0415 Inner:0416.

		Placed on 0168 against E wall. BRPL: Mr Daniel Lemaistre died April 11 <sup>th</sup> 1772 Aged 61. Body undisturbed
0120	5 !!	W/E/H Adult triple shell coffin lead:0121 Inner:0338 Placed on 166. (Dump on floor of vault) S of 0129. BRPL: Mr John Lemaistre died 14 <sup>th</sup> June 1779 58. Body - more or less undisturbed skull - sideways. However dates suggest secondary (?)!!
0159	4	S/W/H Adult triple shell, lead:0403, Inner lid: 1811. Placed directly over 0158 against E wall - in LV. Good cond. BRPL: Mrs Judith Lemaistre Obiit Jany 8 <sup>th</sup> 1784 78 Body undisturbed
0108	4	N/S/M Adult triple shell lead: 0171 Inner: 1402 Placed directly on 0159 against E wall. BRPL: Mr James Lemaistre died 26 January 1790 Aged 63. Body Undisturbed
0144	3	Dump of lead "foil" or rotten lead coffin frags - has that burnt look. Dumped on top of 0129
0138	5	W/E/H Adult triple shell - no outer lead: 0138 Inner lid: 0352 placed over 0144 on top of 0129. Body undisturbed. Not even base of outer coffin apparent. (therefore moved)
0109	4	W/E/H Adult single shell coffin packed with sawdust. Placed over 0120 also 0023. BRPL: Mr David Pontardant died 25 Nov 1791 aged 92. Body undisturbed
0123	4	W/E/H Childs single coffin placed directly over 0173. BRPL Miss Mary Ann Pontardant died 17 <sup>th</sup> Dec 1793 aged 2 weeks. Body apparently undisturbed.
0126		2 x coffin supports (cosps) - 0.26 x 0.14 x 0.07m + 0.28 x 0.08 x 0.07m. Placed at shoulder + near foot C. N/S position under 0119 performing same function as...
0145		4 x coffin supports (cosps) - 0.39 x 0.15 x ? 00.07, 0.36 x 0.13 x ? 00.07, 0.36 x 0.13 x ? 00.07, 0.22 x 0.10 x ? 00.07. These coffin supports (with 0126) are arranged evenly under 0119, 1 at foot (+1 = 0126), 1 at shoulder (+1 = 0126) + 2 at head end supporting coffin off the ground. No evidence that wood is reused.
0119	4	W/E/H Adult triple shell lead: 0139 Inner: 0386. Good cond. Placed on coffin supports (cosps) 0145 + 0126 against S wall and W wall of vault. BRPL: Mr David Pontardant died 21 <sup>st</sup> Apr 1795 aged 58. Body undisturbed although skull sideways.
0127	4	Coffin supports (cosps) x 3 - 0.60 x 0.08 x 0.08, 0.62 x 0.08 x 0.08, 0.79 x 0.08 x 0.08
0321	2	One copper pin (SHPN) found between 0127 and 0111
0111	5	W/E/H Adult triple shell coffin lead: 0112 + Inner: 0342. Placed partly on 0126, slightly on 0127. coffin supports (cosps) N of 0119. BRPL: Miss Harriet Lemaistre died Jan 30 <sup>th</sup> 1777 aged 15 year. Frag of side and top missing, body undisturbed so presumably moved
0107	5	W/E/H Adult Inner coffin collapsing at joints skel undisturbed head on side. Placed directly over 0119. (lid chamfered)
0106	5	W/E/H Adult Inner coffin. Placed directly over 0111. Skeleton undisturbed head to side. If Inner redep
0143	3	Dump of textiles, wood, uppn dumped on top of 0138 N.B. Poss assoc with reorgan represented by 0321, 0107, 0106
0133	3	Childs outer coffin lid dumped on top of 0143 - presumably part of tidying up procedure.
0096	5	W/E/H adult triple shell coffin lead: 0097 Inner 0354. Placed on

---

0095	4	0127. BRLP: Mrs Henrietta Lemaistre died 9 <sup>th</sup> Dec 1794 aged 68. Skeleton undisturbed. But date demands redep. interp cf 0119 E/W/H adult coffin place directly on 0096 No uppns CING attached with nails. Body undisturbed.
------	---	--

---

LV staativox Spit 2  
17.07.87

context	type	date	position	Plan
0095	01		01	0095
0096	01	1794	01	0095
0097	16			
0106	01		02	0077
0107	01		01	0107
0108	01	1790	01	0108
0109	01	1791	01	0077
0111	01	1775	01	0096
0112	16			
0119	01	1795	01	0111
0120	01	1779	01	0096
0121	16			
0123	01	1793	01	0096
0126	12			0145
0127	12			0145
0129	01	1781	01	0077
0130	16			
0133	19			0108
0137	05			0137
0138	16		01	0077
0139	16			
0143	15			0108
0144	15			0095
0145	12			0145
0147	01			
0149	05			0108
0152	16			
0153	16			
0154	01	1763	01	0096
0155	01	1755	01	0096
0156	01	1761	01	0096
0157	16			
0158	01	1779	01	0158
0159	01	1784	01	0159
0160	05			0096
0161	12			0120
0166	05			0166
0168	12			0145
0171	16			
0173	16		01	0153
0188	09			0082
0191	10			0082
0321	05			
0338	02			
0342	02			
0352	03			
0354	02			

0358	03			
0389	03			
0364	01	1760	08	0145
0366	16			
0386	03			
0392	05	1760		0392
0394	02			
0396	01	1768	01	0153
0397	16			
0400	12			0400
0402	02			
0403	16			
0415	16			
0416	03			
0419	05			0149
0420	05			0420
0434	11			
1811	03			
1971	03			
4002	03			

Spit 2 Matrix  
17.07.87

Context	Type	Lead	Inner	Skeleton
0095	01			2052
0095	01	0097	0354	2184
0106	01			2056
0107	01			2059
0108	01	0171	0402	2207
0109	01			2063
0111	01	0112	0342	2175
0119	01	0139	0386	2203
0120	01	0121	0338	2162
0123	01			2065
0126	12			
0127	12			
0129	01	0130	0147	2070
0133	19			
0137	05			
0138	16	0139	0352	2183
0143	15			
0144	15			
0145	12			
0149	05			
0154	01	0153	0358	2188
0155	01	0152	19711	2249
0156	01	0157	0394	2204
0158	01	0415	0416	2211
0159	01	0403	1811	2251
0160	05			
0161	12			
0166	05			
0168	12			
0173	16	0173	4002	2248
0188	09			
0191	10			
0321	05			
0364	01	0366	0395	2250
0392	05			
0396	01	0397		2206
0400	12			
0419	05			
0420	05			

Outer coffins with their Uppn nos and dates from the Lemaistre Vault  
17.07.87

Outer coffins	Vault	Uppn. No.	Date
0155	LV		1755
0364	LV	09	1760
0156	LV		1761
0154	LV		1763
0396	LV	04	1768
0111	LV		1775
0120	LV	57	1779
0158	LV	03	1779
0129	LV	01	1781
0159	LV	01	1784
0108	LV	01	1790
0109	LV	01	1791
0123	LV	09	1793
0096	LV		1794
0119	LV	01	1795
0095	LV		
0106	LV		
0107	LV		



Outer coffins with their Uppn nos. from the Lemaistre Vault 17.07.87

Outer coffin	Vault	Uppn. No
0095	LV	
0096	LV	
0106	LV	
0107	LV	
0108	LV	01
0109	LV	01
0111	LV	
0119	LV	01
0150	LV	57
0123	LV	09
0129	LV	01
0154	LV	
0155	LV	
0156	LV	
0158	LV	03
0159	LV	01
0364	LV	09
0396	LV	04

## Inscriptional information from the Lemaistre Vault

### Skeleton Inscription

2063 MR DAVID PONTARDANT DIED 23 NOV 1797 AGED 92  
2070 MRS SARAH PONTARDANT DIED 5TH MAY 1781 IN THE 36th YEAR OF HER AGE  
2070 Mrs SARAH PONTARDANT DIED 5th MAY 1781 IN THE 35th YEAR OF HER AGE  
2162 MR JOHN LEMAISTRE DIED 14th JUNE 1779 IN THE 59TH YEAR OF HIS AGE  
2162 Mr JOHN LEMAISTRE DIED 14th JUNE 1779 IN HIS 59TH YEAR  
2175 MISS HARRIOTT LEMAITRE DIED JANy 30TH AGED 15 YEARS BR LEMAISTRE  
2184 Mrs HENRIETTA LEMAISTRE DIED 9th DEC<sup>r</sup> 1794 AGED 68 YEARS  
2184 Mrs HENRIETTA LEMAISTRE DIED 9th DEC<sup>r</sup> 1794 AGED 68 YEARS  
2188 MISS ANN LEMAISTRE DIED SEP 16 1763 AGED 14 WEEKS  
2203 MR DAVID PONTERDANT DIED 24TH. APRIL 1795 AGED 58 YEARS BR PONTADANT  
2203 Mr DAVID PONTERDANT DIED 24th APRIL 1795 AGED 58 YEARS BR PONTADANT  
2204 MRS SUSAN<sup>h</sup> LEMAISTER DIED 8th DECEM<sup>r</sup> 1761 AGED 78 BR LEMAISTRE  
2204 MRS SUSAN<sup>h</sup> LEMAISTRE DIED 8th. DECEM<sup>r</sup> 1761 AGED 78 YEARS  
2206 MAST<sup>r</sup> DAVID PONTARDANT DIED NOV 29th AGED 2 YEARS & 7 MON<sup>s</sup> BR PONTERDENT  
2207 MR JAMES LEMAISTRE DIED 26TH JAN 1790 AGED 63  
2207 Mr JAMES LEMAISTRE DIED 26 JANUARY 1790 AGED 63  
2211 MR DANIEL LEMAITRE DIED APR 11th 1779 AGED 62  
2211 MR DANIEL LEMAITRE DIED APRIL 11th 1779 AGED 61  
2249 MISS SUSAN<sup>h</sup> LEMAISTRE DIED MAY 12th 1755 AGED 8 WEEKS  
2250 MISS SUSAN<sup>h</sup> JUDITH LEMAITRE DIED JANy 17th 1760 AGED 15 DAYS BR LEMAISTRE  
2251 MISS SUSAN<sup>h</sup> JUDITH LEMAITRE DIED JANy 17th 1760 AGED 15 DAYS BR LEMAISTRE  
2251 MRS JUDITH LEMAISTRE OBIIT JANy 8th 1784 AETAT 78

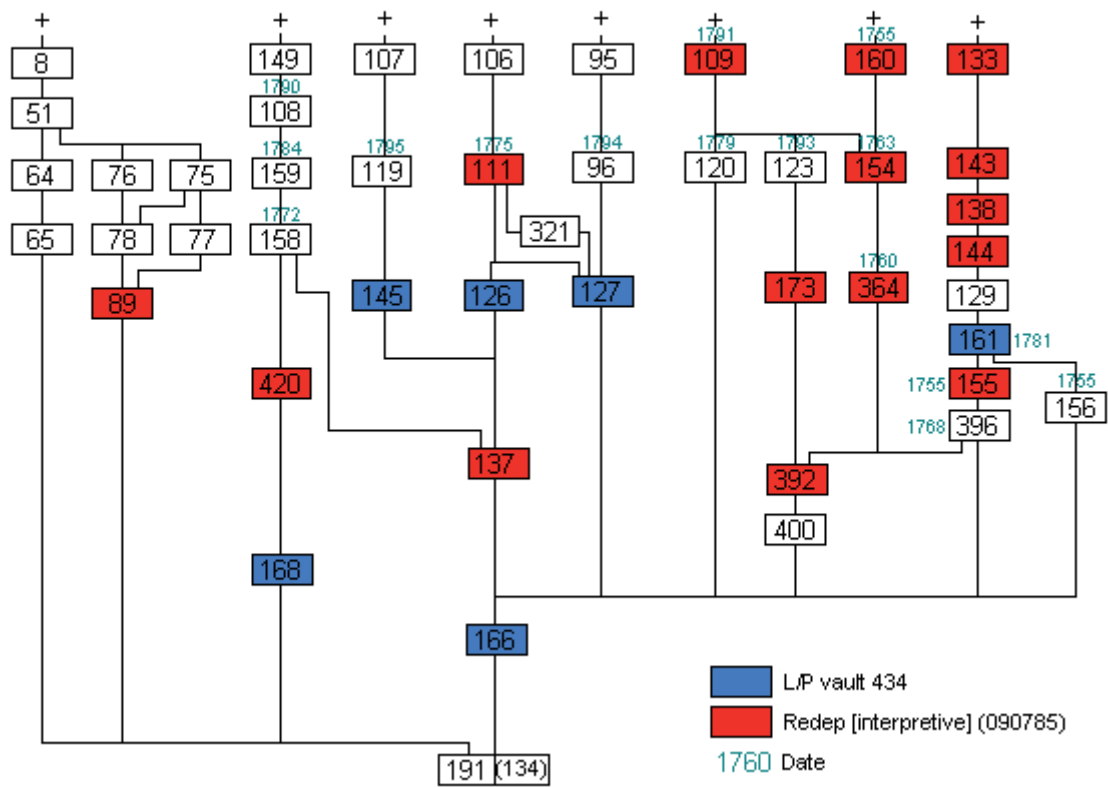

SC 21/6/85

Use of Vault Matrix - 17/07/85  
 ( N/A JR 27/07/87)

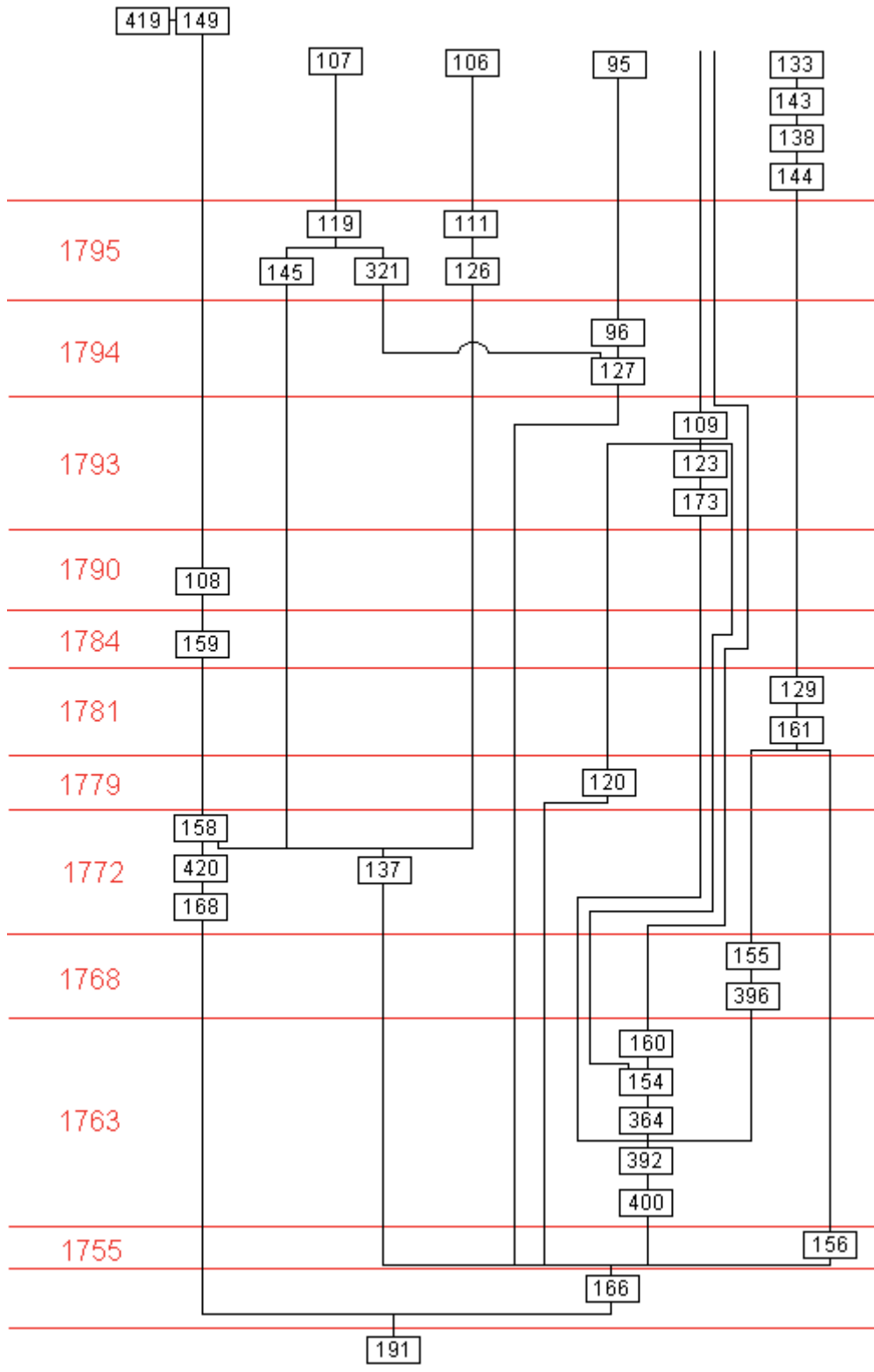

Note to Jez Reeve: Interpretive matrix has to be checked out by drawing the phases out + seeing if it works out logically then write up in English  
 17/07/85

Diagrammatic sketch of 434 with stratigraphic references

09/07/85 JR

DIAGRAMATIC SKETCH OF 434 WITH STRATIGRAPHIC REFERENCES

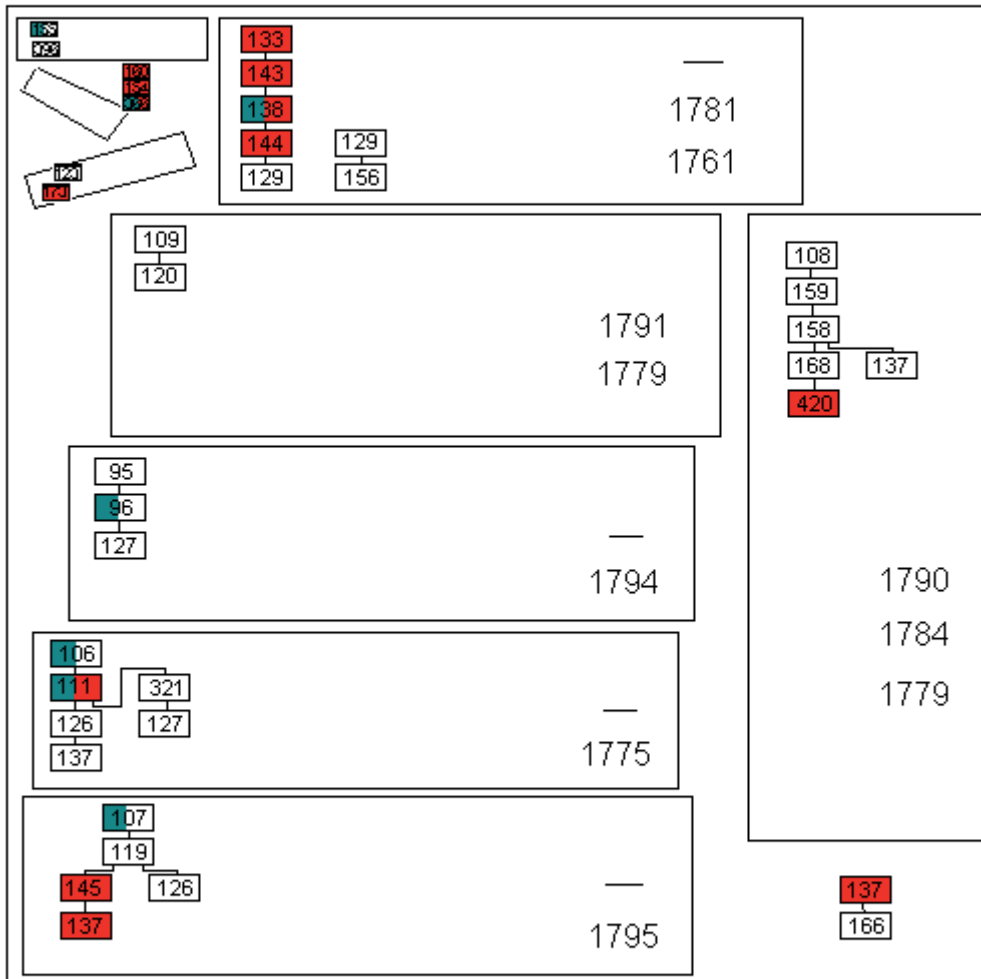

NOT TO SCALE

- Redep (interpretive)
- Reappraisal of secondary interments by JS 24.02.88

**Notes on Vault 434 -  
09/07/85 JR**

Don't consider 51,65,67,75,76,77,78 as "belonging" to vault 434

Interpretive Notes:

REDEP	IN ORIGINAL PLACE
89	95
111	96
133	106
137	107
138 ?	108
143 ?	119
144	120 ?
154 ?	123
160	129
173	149
364	109
392	
396	156
420	158
321	159
155	161

11/07/85

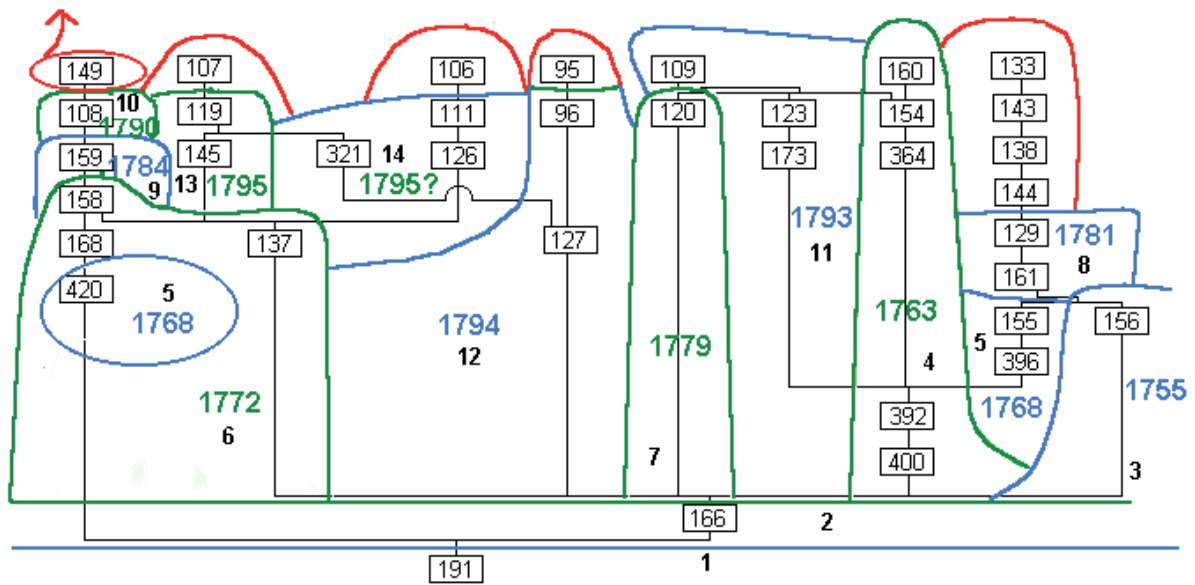

Key to numbers on drawing

- 1 191
- 2 166
- 3 156
- 4 400 392 364 154 160
- 5 420 392 396 155
- 6 168 158
- 7 120
- 8 161 129
- 9 159
- 10 68
- 11 173 123 109
- 12 127 96
- 13 145 119
- 14 321 126 111
- 15 107 106 95 144 138 143 133

## **Ponterdant/Lemaistre Vault and Access Tunnel: An Opinion**

The P/L vault was filled from the west by access along a short low narrow tunnel. This tunnel, at first led into an empty almost square vault where three similar tunnels, one to the North, South and East had been blocked flush with the walls of the vault by brick partitions. Three brick widths thick, faced on both sides, these walls were finished before coffins, at least in the N + S tunnels, were stacked with their ends pressed against the wall faces (details see N: coffins 228, 230, 242, 246 and S coffins 203, 211). In the P/L vault coffins 119, 159 and 157 were likewise pressed against the partition faces. As for dating this is not clear as only one wall has so far been removed, 18.IV.85, and contained, apart from the bricks, no useful dating evidence, certainly the partitions are not contemporary with the primary build of the tower vaults for none of them are tied into the vault fabric, nor is the brickwork similar in content or build. (Detail see 188)

Within the P/L vault coffins covered the entire floor surface overlaying in the case of 158, 117, 139 laterally placed rectangular section plank coffin supports and in the case of 121, 157 and the supports overlying 166 a shallow, 3-6cm, layer of builders mortar - subject to analysis, this may be a detail left by the bricklayers on completion of the partition walls, or

The adult coffins in the vault were arranged in six stacks stacked two high except for two three high stacks topped by coffins 108, to the East and coffin 138, to the North; only the East stack survived to its original height.

In the N.W. corner were concentrated the childrens coffins, 7 in all, (triple shell) comprising wood outer coffins with lead inners and one, 123, wooden outer coffin only - this stack appears to unevenly placed and discovery of coffin lid 133 on top of 138 suggested rearrangement at some date. Further evidence of disturbance came from 112 which had been distorted, perhaps by being stood on whilst coffins were rearranged or placed around it in the vault. From observed evidence during excavation and later reading of breastplates the following sequence of deposition of adult coffins is proposed.

The first coffin in the vault may have been a child's, 152 dated 1755 (the remainder of childrens coffin stack remain undecorated 22.IV.85) whilst if the dates of coffins 158 and 159 allow then 157 was the first adult coffin into the vault placed in 1761, followed by 112 in 1775, 120 in 1779 and at sometime during this period probably 158. The coffins were placed singly on the floor at first stacking possibly beginning in the 1780s with 159, undated (as yet!) and with 129 in 1781. A gap still remained which 119 would fill later and was perhaps deliberately left for the manouvering of coffins whilst restacking.

Above 129 was placed 138, a layer of damaged lead(?) foil between them, the date of this is not clear for it is impossible to say whether this coffin was deposited before or after 108, 1790 - the placing of either of these with either in situ would have been difficult. Notwithstanding this 138 must have been placed before 109, 1791 as this blocks areas to the N part of the vault. It is also possible that 138 has been removed from its original position as the top is damaged, perhaps when stood on, and its outer wooden coffin absent. A possible scenario is that at the time of the placing of 112, 1778, 138 was damaged, it having been placed opposite the access tunnel the debris from the rotted wooden outer coffin tipped into the SE corner of the vault, 137, and some topped beneath the supports of 112. More damage was sustained when 120 and 129 were placed finally when 109, a very large coffin was to be placed in the vault sheer practicality dictated the moving of 138 to above 129.

Whatever the reason for the deposition of 137 it probably took place before 1775 for 132's plank supports was placed on top of the debris, although this assumes that 112 was not itself moved after its original placing.



Subsequent to the deposition of 108, 1790 which completed the E stack, the gaps in the vault were probably filled: 109 in 1791, 97 in 1794 and awkwardly 119 in 1795 - the damage to 112 occurring perhaps when coffins to the E were stacked (103, 159, 158) and 119 placed.

The filling of the P/L was as a result of the placing of these unmarked, possibly inner wooden coffins in the SW area of the vault - these plain coffins were placed in order 107, 108, 95 and lately the access tunnel filled.

**Initial build:**

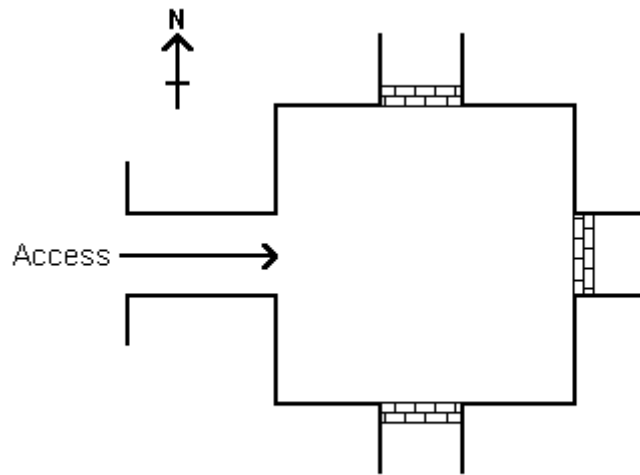

**The Filling:**

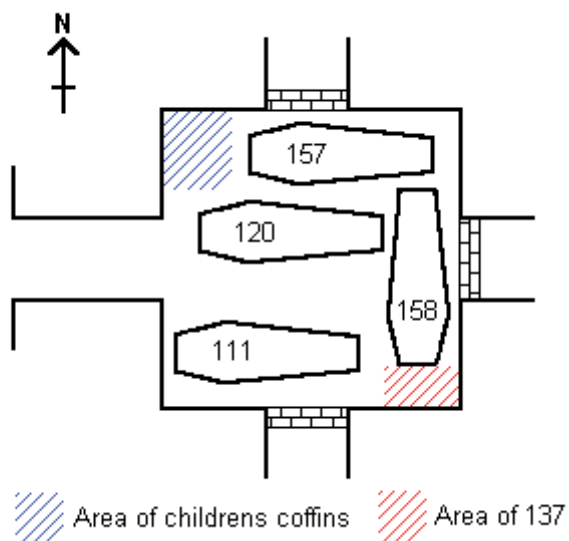

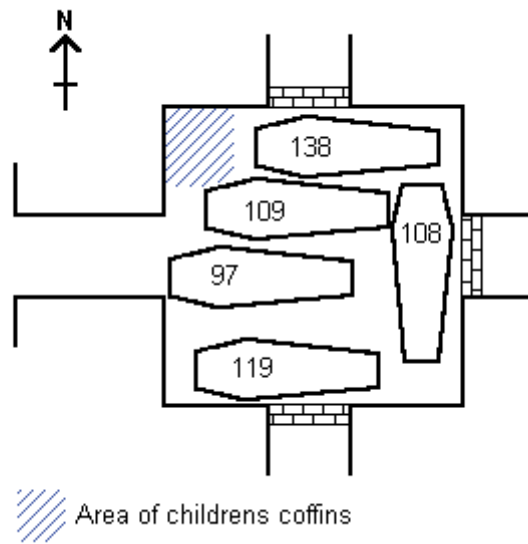
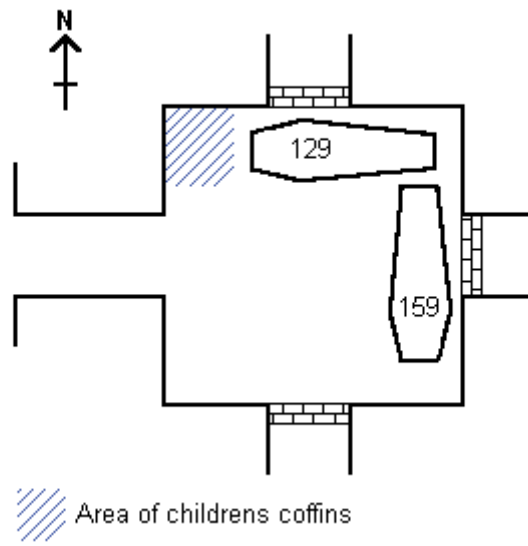

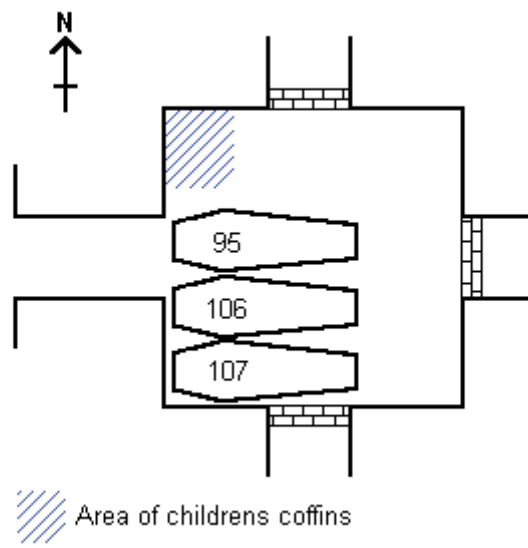

## **Infilling of the Lemaistre/Pontardant Vault**

Within the vault there are 5 stacks of coffins laid E-W (head orientation varied) and one stack laid N-S. Orientation varied but the Christain tradition of head to the E appeared to be of secondary importance to the practical demands of spacing, e.g. coffins 108 and 159.

Stylistically the type of fitting cannot be differentiated from coffin to coffin although some stylistic chronological development might be deduced from the breastplates. The majority of the Lemaistre/Pontardant breastplates were made from lead and painted black. Styles ranged from an earlier predominantly floral (rose + sunflower) rectangular type (typology type 10??) to a later more elaborately detailed rectangular breastplate depicting angels, cherubs etc (typology type 12??). However it must be stressed that identification toward a development is very tenuous when approx 1/4 of the sample were missing and over such a limited period of time (40 years). A notable exception was the breastplate of 159 which read

"Mrs Judith Lemaistre Obyt Jany 8th 1784 ACtat 78"  
all other inscriptions being in English.

The method of affixing the BRPL varied from outer coffin where it was attached with tacks, to the inner lead coffins where the plate was either soldered onto the coffin at the corners or in the centre of each side to the lead coffins where the inscription was stamped into the lead itself. A possible stylistic variation might be identified by the use of different borders.

It is not possible to reconstruct the infilling of the vault by use of the physical relationships alone but a combination of physical relationships, interpretation and artefact evidence enables a tentative reconstruction.

SEE DIAGRAMS 1 - 19 for partitioning of adult coffins within 434.  
(physical positions of childrens coffins diagrams 1 & 2)

It is possible that some of the coffins have been rearranged - this can be proved in the case of the childrens coffins because of dates - but certain of the adult coffins 95, 138 had no outer wooden coffin (137 wood dump poss represents outer coffin to 138), and 112 had been disturbed. The earliest coffin (dated by BRPL) is that of a child 155(1755), the earliest adult coffin being dated 1761, 156. Several coffins were placed on upon coffin supports - it is notable that such coffins would be otherwise placed on the floor or in one case on top of coffin 156 orientated in the same direction - therefore it would seem plausible to assume that the supports are to protect the hands of the bearers. (In all other cases coffins are stacked alternately with the head first orientated E and then W wards etc).

Filling of the Lemaistre/Pontardant Vault  
(from the church forwards to most recent deposits)

1.

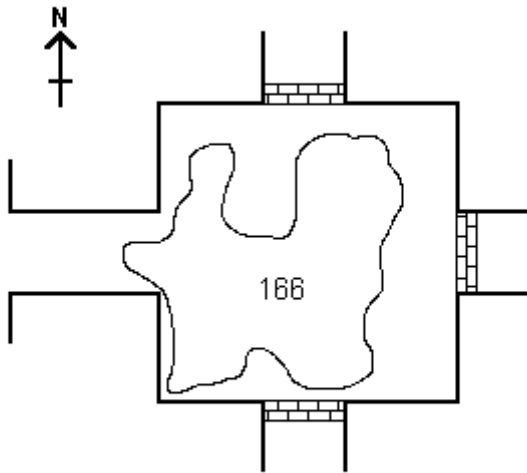

2.

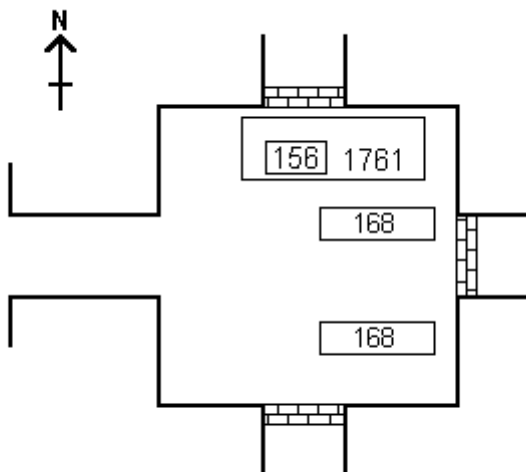

3.

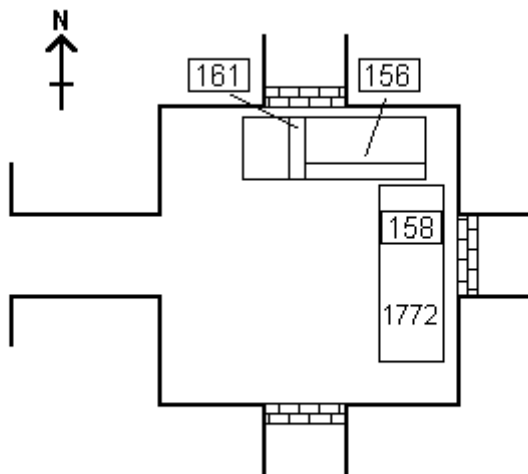

4.

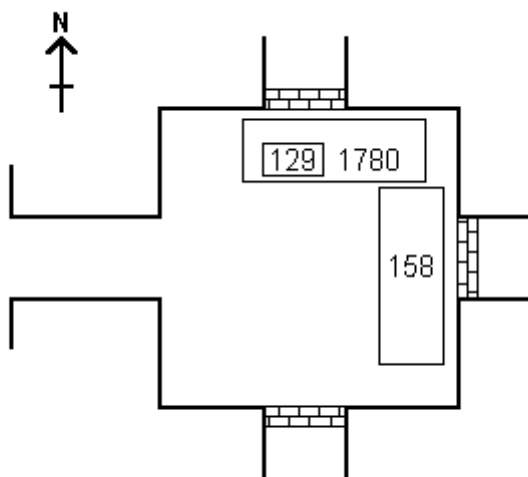

5.

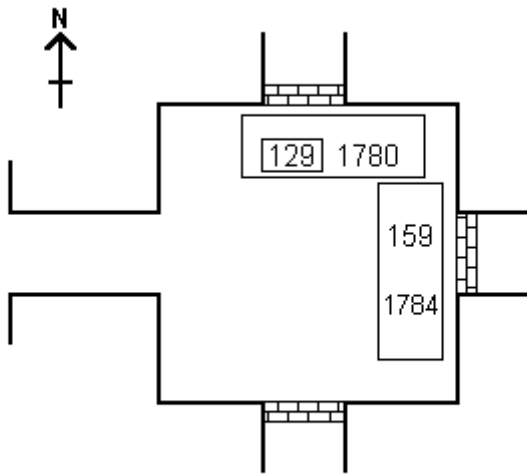

6.

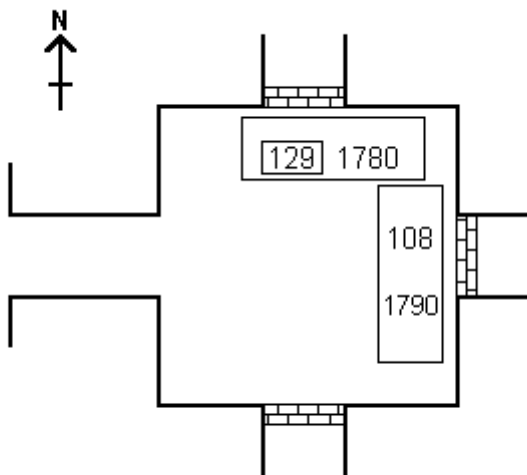

7.

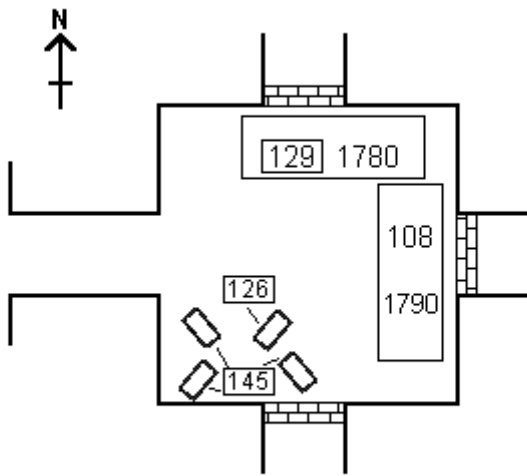

8.

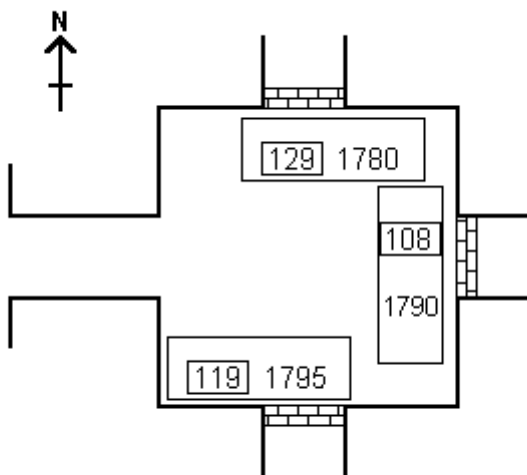



9.

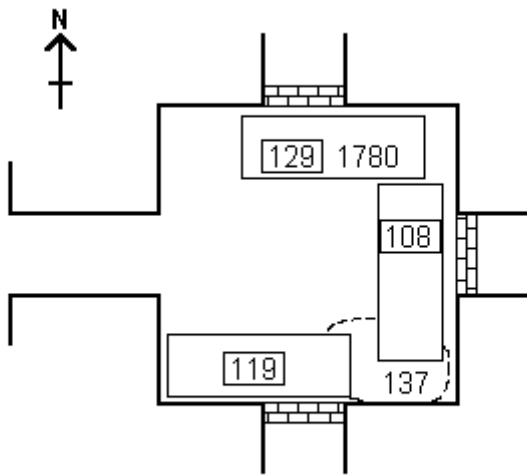

10.

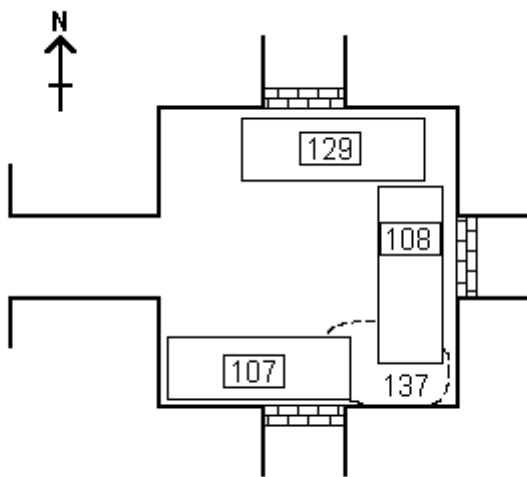

11.

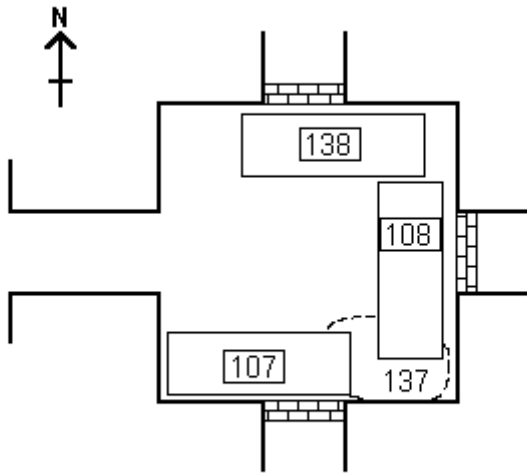

12.

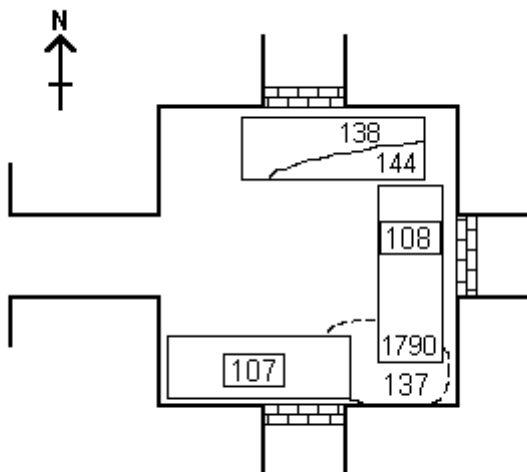

13.

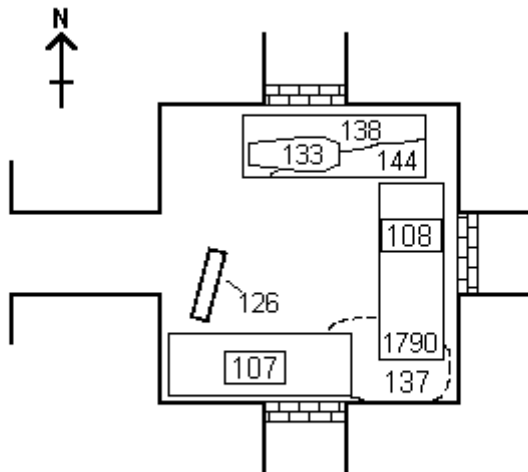

14.

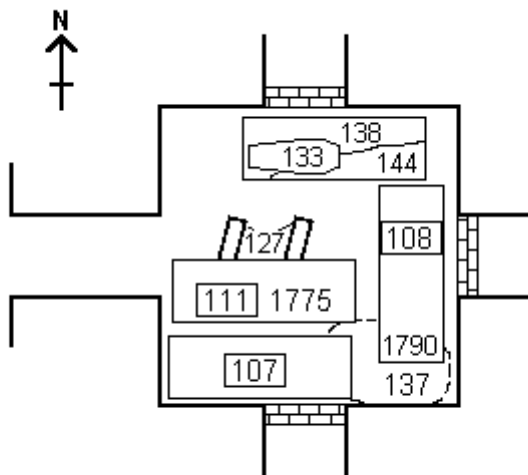

15.

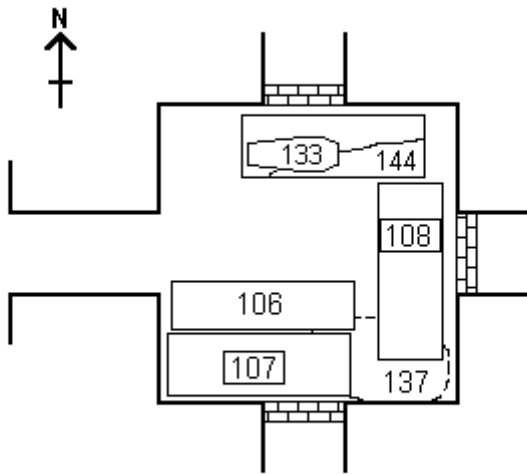

16.

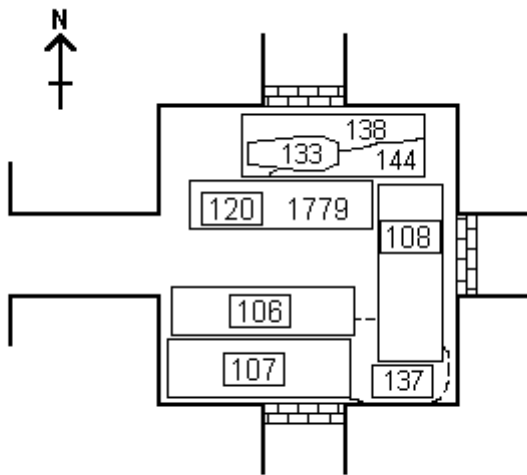

17.

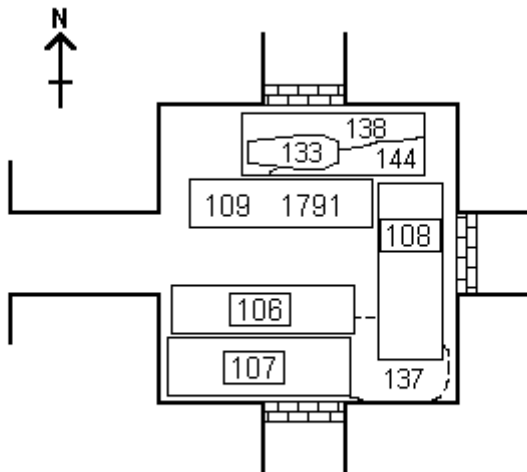

18.

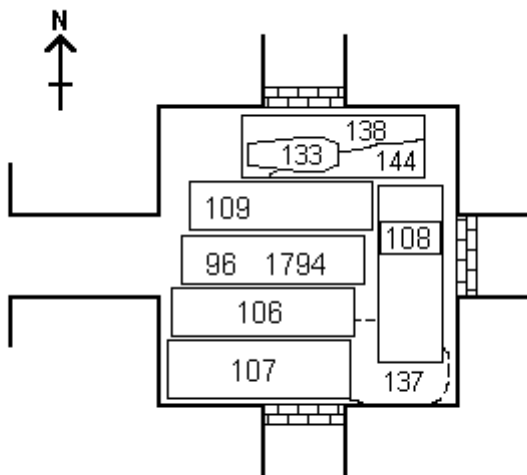

19.

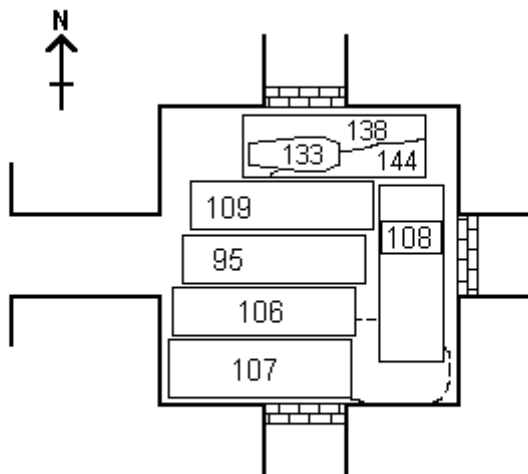

### Childrens coffins

The Childrens coffins were all placed within the NW corner of the vault.

Sketch plan of the childrens' coffins on the floor.

1.

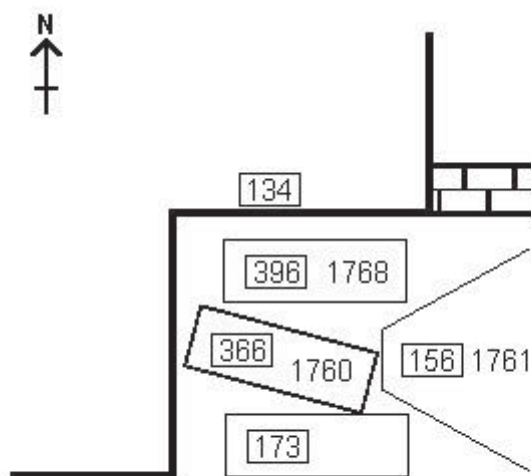

2.

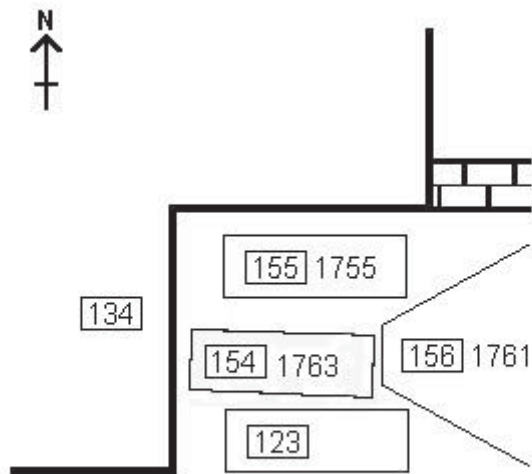

3.

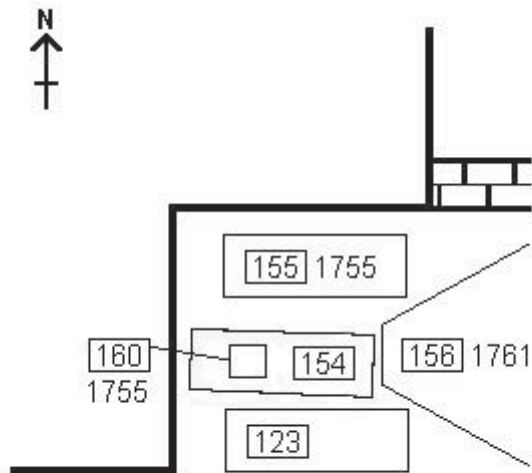

As the Breastplate dates show there has been extensive reshuffling of the childrens' coffins and it is therefore impossible to make an accurate reconstruction of the deposition of the childrens' coffins. However simply from dates of breastplates it would appear to be:

123	
173	
396	1768
154	1763
366	1760
160	1755
155	1755

173 and 123 - position on the strat matrix unknown as neither of these coffins were dated therefore they have been placed at the latest possible position.

(Pure guess work) NB it is possible that some of the childrens' coffins could be related to the woman identified by the BRPL. eg. it would seem poss. that 129 Mrs Sarah Pontardant died 1780 aged 35 could have died in childbirth. It is poss that the position of the childrens' coffins could be determined by their family relationship with the adult coffins but this is purely hypothetical and cannot be proven !!



Possible strat matrix for the L/P vault

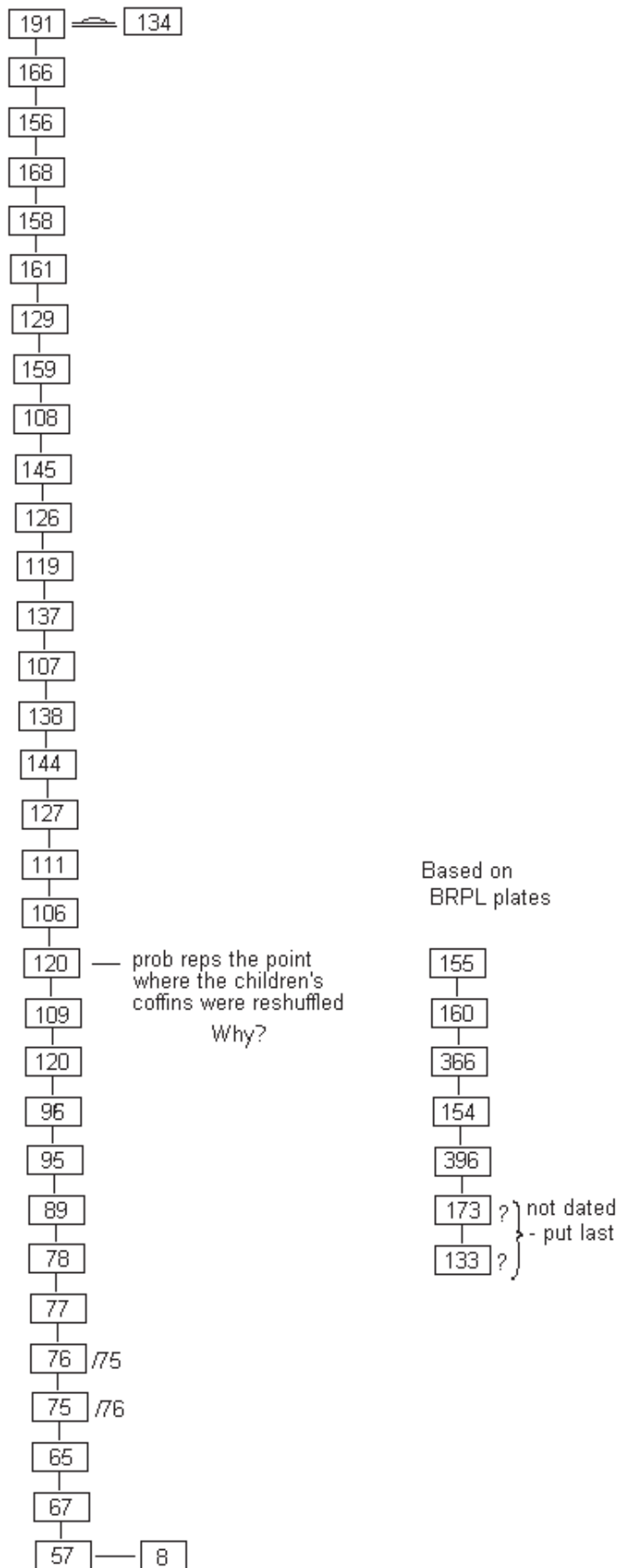

**Created chronology - BRPL**  
**09/07/85**

Sex/age	Context nos	Dates		Dates	Contexts	Sex/age
F68	96	09 12 1794		08 05 1755	156	F78
M63	108	26 01 1790		11 05 1755	160	F8W
M92	109	25 11 1791		12 05 1755	152	F8W
F15	111 (112)	30 01 1755		17 01 1760	364	F 15D
M58	119	21 04 1795		16 09 1763	154	F 14W
M59	120	14 06 1779		29 11 1768	396	M 7M
F2W	123	17 12 1793		11 04 1772	158	M62
F35	129	05 05 1781		30 01 1775	111	F15
F8W	151 (152)	12 05 1755		14 06 1779	120	M59
F14	154 (153)	16 09 1763		05 05 1781	129	F35
F78	156 (157)	08 05 1755		08 01 1784	159	F78
M62	158	11 04 1772		26 01 1790	108	M63
F78	159	08 01 1784		25 11 1791	109	M92
F8W	160	11 05 1755		17 12 1793	123	F2W
F15D	364 (366)	17 01 1760		09 12 1794	96	F68
M2Y7M	397	29 11 1768		21 04 1795	119	M58

List OF contexts in 434 L/P vault

SC 21/6/85

Outer wooden shell	Inner Lead shell	Inner wooden shell	Skeleton	Dump/cosp	No. of shells
				51 (skeles)	0
65		67	51?		2
		75	2043		1
		76	2044		1
		77	2046		1
		78	2047		1
				89	0
95			2052		1
96	97	354	2184		3
		106 (external cover)	2056		1
		107 (external cover)	2059		1
108	171	402	2207		3
109			2063		1
111	112	342	2175		3
119	139	386	2203		3
120	121	338	2162		3
123			2065		1
				126 cosp	0
				127 cosp	0
129	130	147	2070		3
		133			1
137?	138	352	2183		3
				143	0
				145 cosp	0
				144	2
155	152	not opened			2>
154	153	358	2188		3
156	157	394	2204		3
158	415	416	2211		3
159	403	not opened			0
364	366	not opened			2
				160	0
				161 cosp	0
				168 cosp	0
	173	not opened			1>
396	397		2206		2
				392	0
				400 cosp	0
				419	0
				420	0
				166 mortar dump	
				191 floor	

**TOTALs**

18 contexts - outer coffins    14 contexts - lead coffins    19 contexts - inner wooden coffins    20 skeleton nos (excl 51)    16 dumps/cosp + floor (incl 51)

NB more inner wooden coffins would prob have been found if all lead coffins had been opened

**TOTAL NUMBER OF CONTEXTS - 87**

156	(157)	Mrs Susannh Lemaistre died 8 <sup>th</sup> December 1761 Aged 78.
159	(403)	Mrs Judith Lemaistre obyt Jany 8 <sup>th</sup> 1784 Etat 78
396	(173)	Masr David Pontardant Died Novr 29 <sup>th</sup> 1768 Aged 2 years 7 mons
158	(415)	Mr Daniel LeMaitre Died. April 11 <sup>th</sup> 1772 Aged 61.
364	(366)	Miss Susanh Judith Lemaitre Died Jany 17 - 1760 Aged 15 days.

(366) denotes an inner Pb coffin.

**Lemaistre/Pontardent Dated Contexts****SC 21/6/85**

- (75) Not dated
- (76) Not dated
- (77) Not dated
- (78) Not dated
- 89 - dump BRPL of Mrs Harriet Lemaistre died Jan 30<sup>th</sup> 1777 aged 51
- 95 Not dated
- 96 o/c (97) BRPL reads Mrs Henrietta Lemaistre died 9<sup>th</sup> Dec 1794 aged 68 years
- 106 Not dated
- 107 Not dated
- 108 (171) BRPL reads Mr James Lemaistre died 26<sup>th</sup> Jan 1790 aged 63
- 109 BRPL reads Mr David Pontardant died 25<sup>th</sup> Nov 1791 aged 92
- 111 (112) BRPL reads Miss Harriet Lemaistre died Jan 30<sup>th</sup> 1775 aged 15 years
- 119 (139) BRPL reads Mr David Pontardant died 21<sup>st</sup> April 1795 aged 58 years
- 120 (121) BRPL reads Mr John Lemaistre died 14<sup>th</sup> June 1779 in his 59th year
- 123 BRPL illegible
- 129 (130) BRPL reads Mrs Sarah Pontardant died 5<sup>th</sup> May 1780 in 35<sup>th</sup> yr of her age
- 133 not dated
- (138) not dated
- 155 (152) BRPL reads Miss Susan LeMaistre died May 12<sup>th</sup> aged 8 weeks
- 154 (153) BRPL reads Miss Anne Lemaistre died Sept 16 1763 aged 14 weeks

(75) **Plans for the Lemaistre/Pontardant Family**

**Square 100/205**

<b>plan no</b>	<b>context</b>
82	191
166	166
145	145, 126
119	119, 111
107	107, 106

**Square 100/210**

<b>plan no</b>	<b>context</b>
	134 191, 188
	166 166
	159 107, 106, 159
	145 145, 126
	137 137
	111 111, 119, 158

**Square 105/205**

<b>plan no</b>	<b>context</b>
400	400
392	392
166	166
153	173, 366, 396
145	127, 364, 366
964	89, 111, 96, 120, 123, 156, 157, 154, 153, 160, 152, 155
191	191
77	77, 78, 106, 95, 109, 129, 154
65	67, 65, 51, 75, 76
8	8

**Square 105/210**

<b>plan no</b>	<b>context</b>
420	420
419	419
166	166
145	168, 127
134	191, 134
120	152, 155, 153, 161, 157, 156, 120, 158, 96, 111
108	147, 133, 143, 138
95	159, 106, 95, 109, 129, 130

100/205

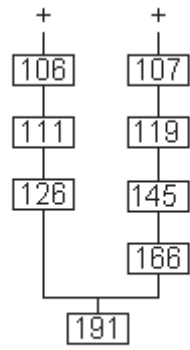

100/210

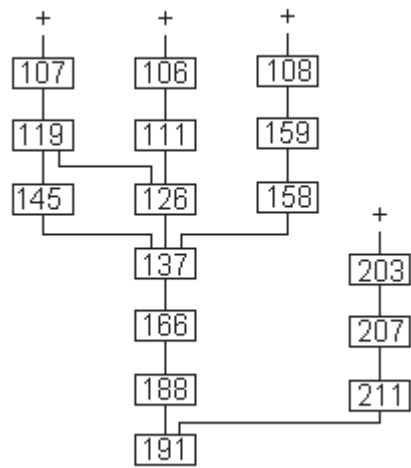

105/205

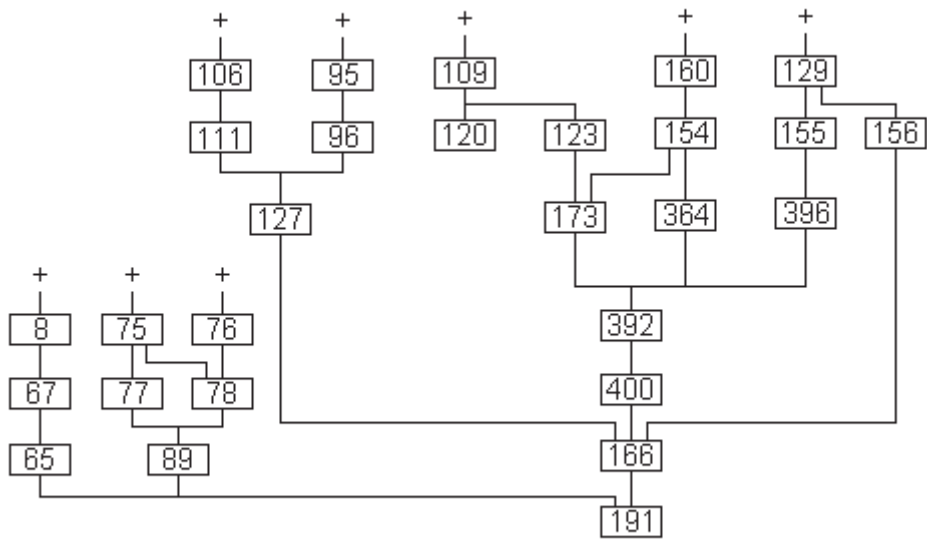

105/210 L/P

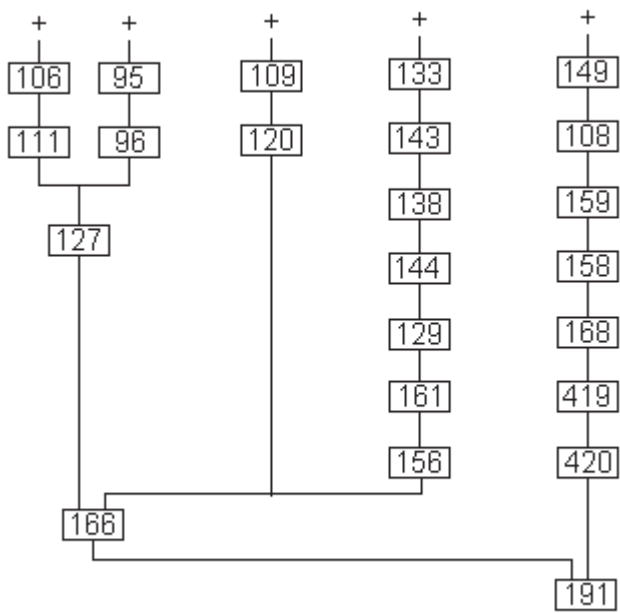



**Pontardant/Lemaistre Vault - 434**

**SC 21/06/85**

(Interpretive Discussion from most modern backwards to church)

The vault occupies the central position in the lower portico area and is flanked on the N & S sides by tunnels (lower north and lower south tunnels). The space occupied by the vault itself was deliberately allowed for when the construction of 134 took place; this contrasts with the subsequent positioning of the Lemaistre/Pontardant vault by blocking walls of red and yellow stocks which separate 434 from the N & S tunnels.

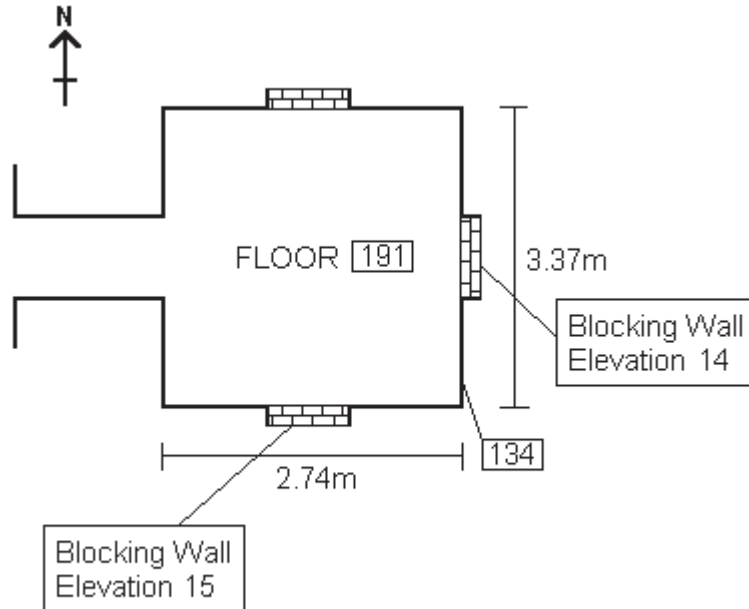

Blocking wall 188 was comprised of red and yellow stocks laid on bed in alternate rows of headers and footers (resembling English Bond) which have been bonded onto 134. It was faced on both skins and was rubble infilled.

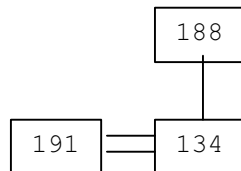

The vault is approached via a short access tunnel from the west (0.95m wide x 3.35m long x 1.20m high). The vault is rectangular and arched.

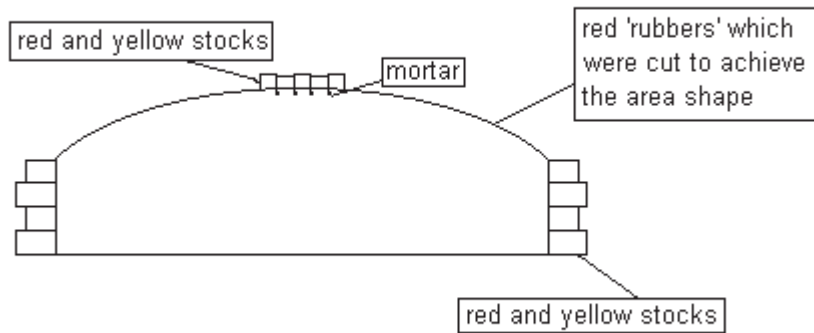

It was tentatively suggested that the vaulting had been constructed using a wooden framework as a guide and support during construction from above - this was proposed to explain why mortar postholes beyond the brickwork. It is possible that the mortar dump 166 found immediately above the floor 191 relates to the construction of the ceiling or to the construction of the blocking walls. (Plan 166)

#### ACCESS TUNNEL

The access tunnel provides entrance to 434 from the west. Its mouth(?) was blocked by 8, a coffin wood dump, which had been placed over 51, 65 and 67. 65 "the disaster box" was a roughly constructed plain wooden box 1.80m long x 1.60m wide which had been placed on the floor. It had a (fragmentary) inner wooden lining 67 inside which was deposited 51 an assorted collection of 21 skulls, vertebrae, femurs ribs etc. Following the discovery of a treponated skull and certain other marked bone the physical anthropologists have suggested that this box was used to bury autopsy cases. (have they? JR)

Further eastwards are coffins 75 and 76 which have been interpreted as inner wooden coffins (they are devoid of coffin furniture). Under 76 is inner coffin 77 and under 76 is inner coffin 78. No strict stratigraphical relationship can be proved between 77 and 78 though their spacing and position relative to each other and to 134 suggests that 78 was deposited before 77.

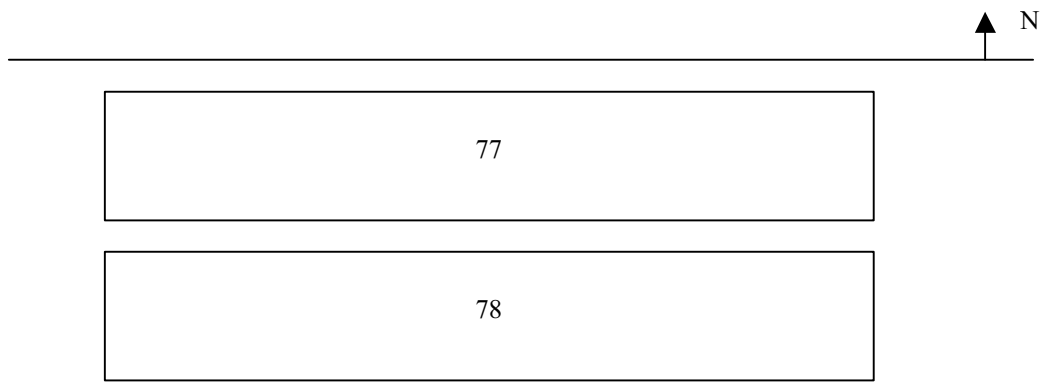

Both 77 and 78 are over 89 a BRPL belonging to Mrs Harriet Lemaitre died Jany 30th aged 51

E	191	Floor
	166	Mortar dump
	89	BRPL
	78	Inner coffin
	77	Inner coffin
	75/76	Inner coffin
	76/75	Inner coffin
	65	Autopsy box
	51	Skeletons
W	8	Wood dump