

Figure 1: Site location



Figure 2: Proposed Site Plan

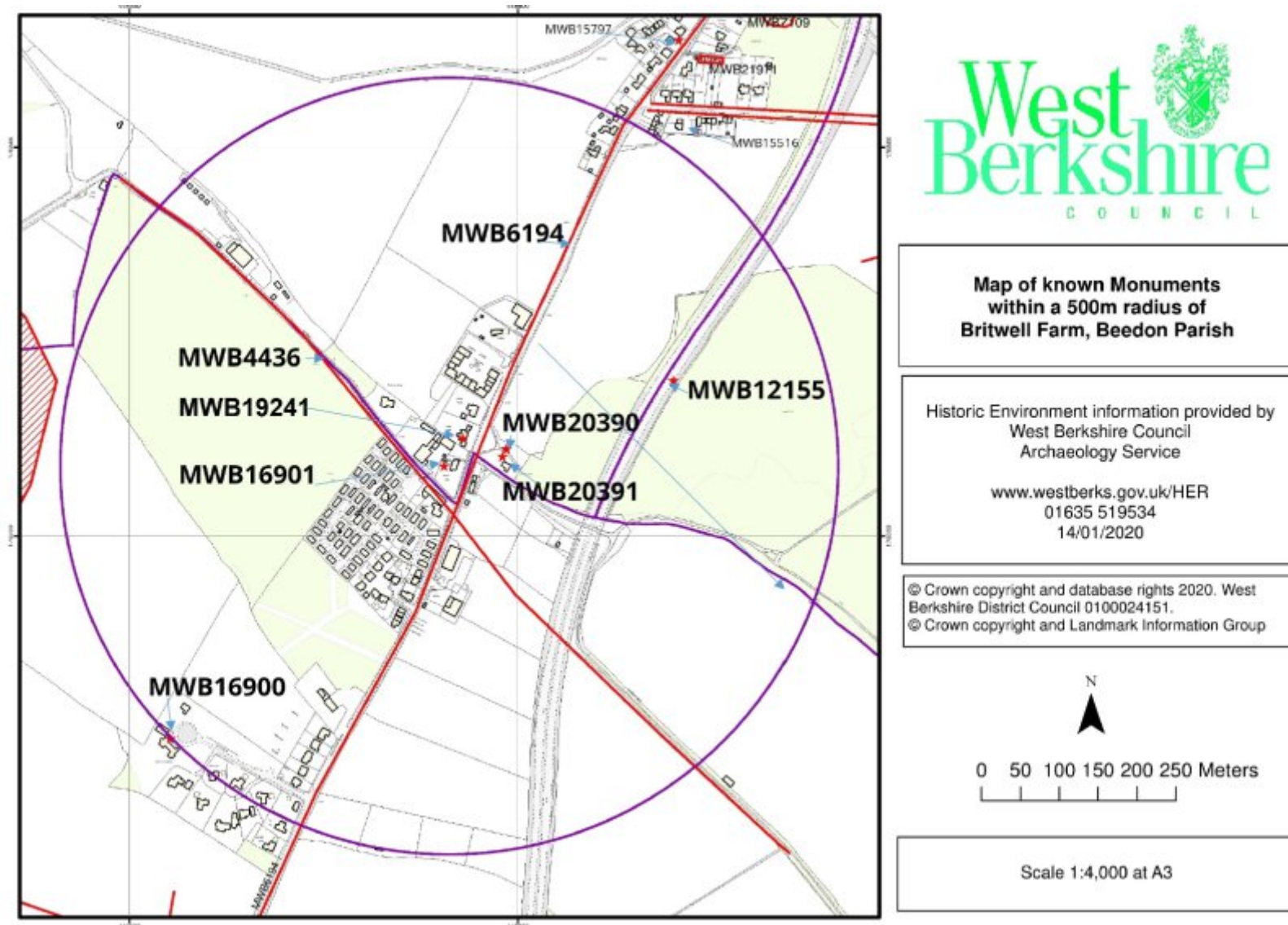

Figure 3: Location of Heritage Assets within the Study Area

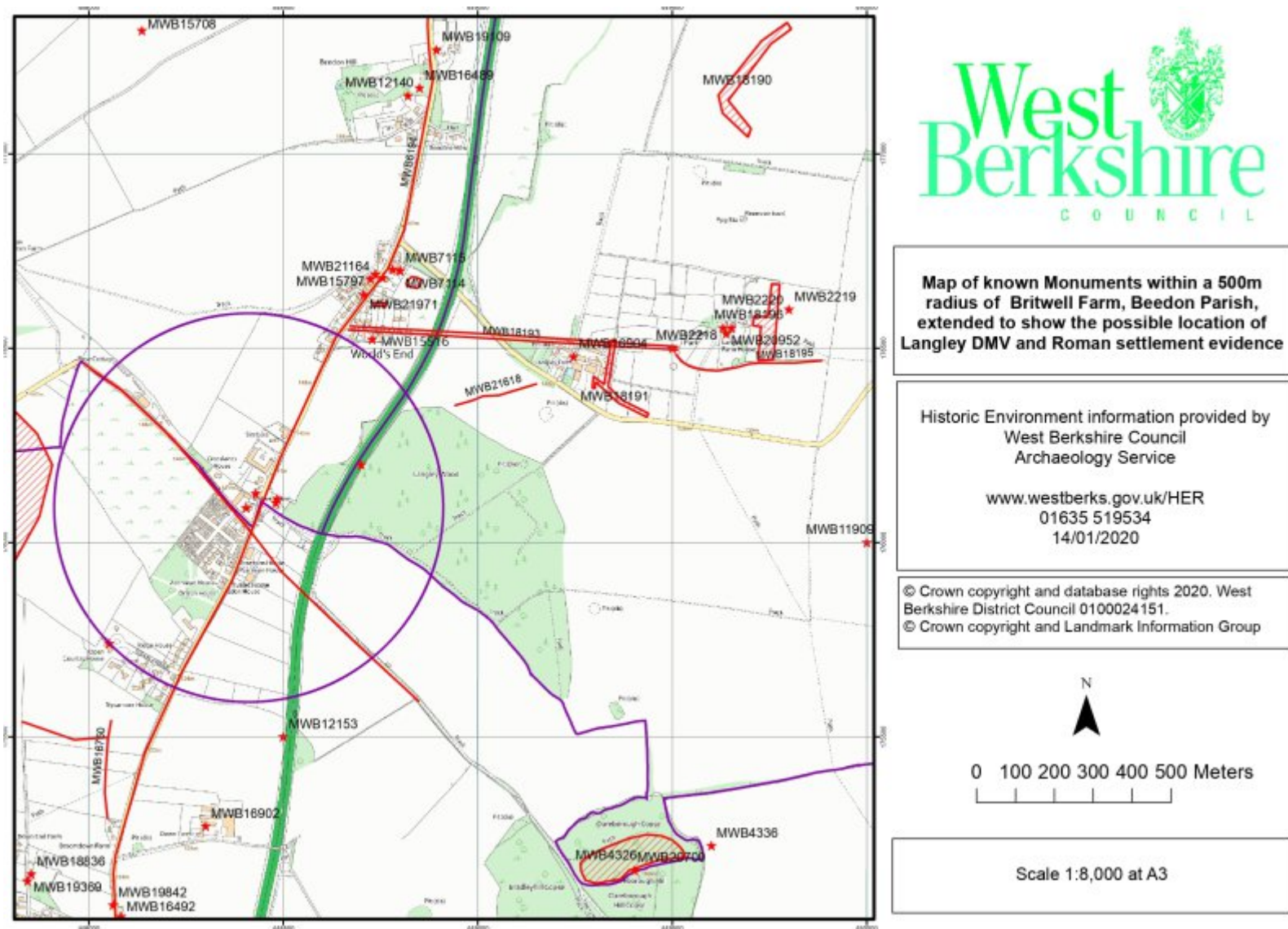

Figure 4: Location of Heritage Assets just beyond the Study Area



Figure 5: Robert Morden's map of 1650-1703 (reproduced with kind permission from The Royal Collection Trust accessed 5/2/20)



Figure 6: Extract from John Rocque map of 1761  
(reproduced with kind permission from The Royal Collection)

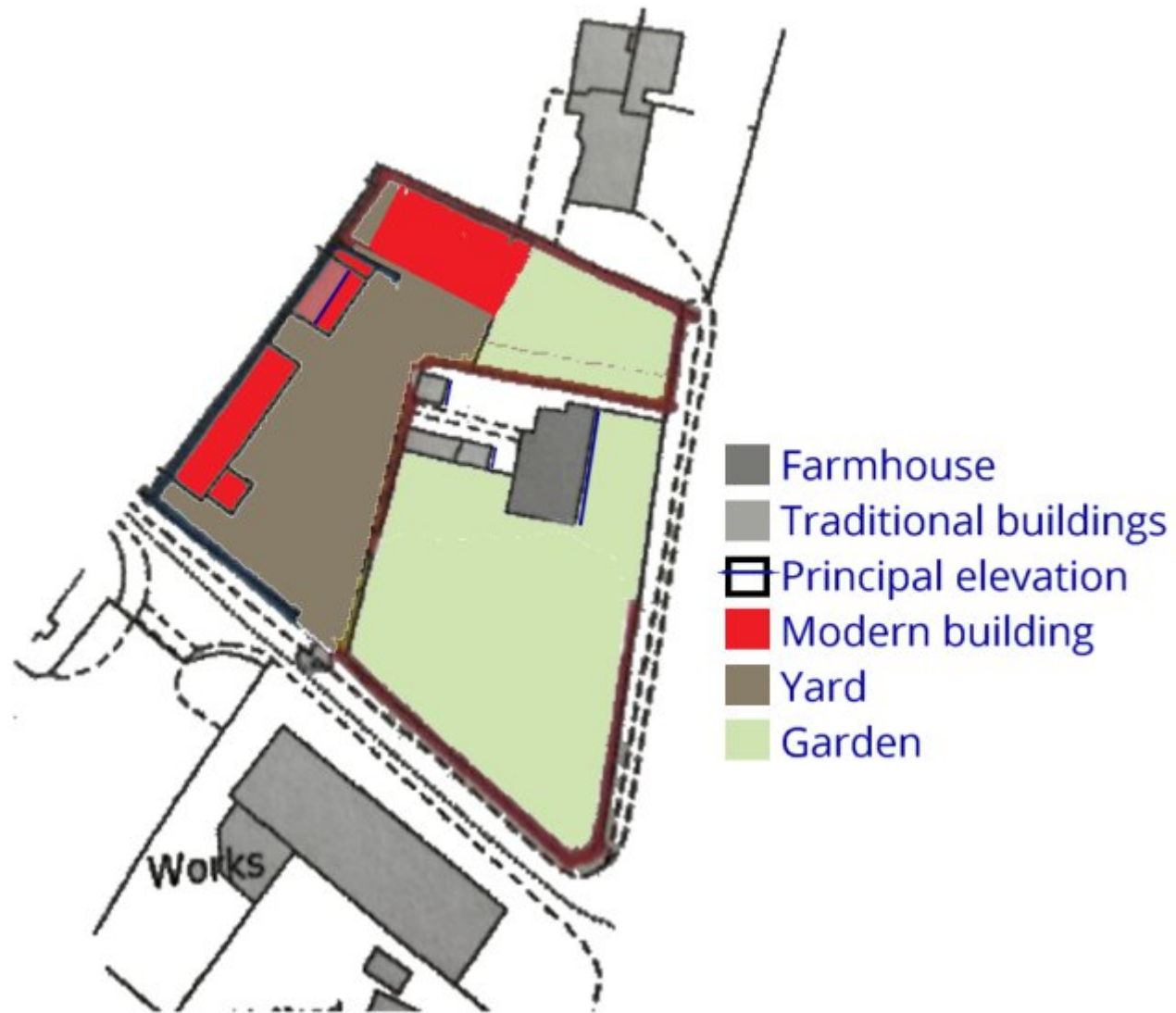

Figure 7: An illustration of the degree of change within the Site



### John Rocque 1761

(Extract from John Rocque's map of 1761  
(reproduced with kind permission from Berkshire  
Record Office)



### Tithing 1839

(Extract from The Chapelry of Oare Tithing map of 1839  
(reproduced with kind permission from Berkshire  
Record Office)

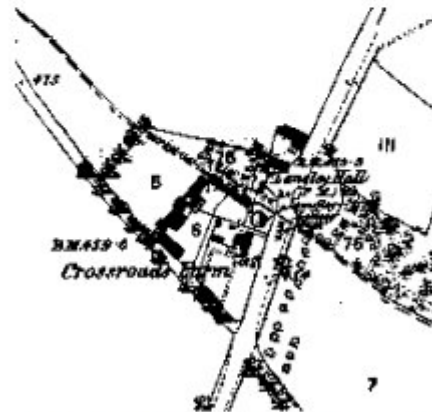

### Ordnance Survey 1880

Extract from The Ordnance Survey map of 1880  
(reproduced with kind permission from The  
Ordnance Survey Office)



### Current layout 2020

Extract from the location drawing  
(reproduced with kind permission from  
Stephen P Smith)

Figure 8: An illustration of map regression evidencing the degree of change within the Site