

Buckingham's Premises, London Street, Norwich.

We give the illustration, which we owe to the kindness of Mr. E. H. Buckingham, A.R.I.B.A., of the old panel work at these premises, concerning which Mr. Beecheno kindly supplies the following historical notes:—

In 1626 George Birch, who was Sheriff in 1604 and Mayor in 1621, lived at Caley's corner, *i.e.*, in London Street at the south-west corner of Swan Lane. So it may be presumed that Buckingham's premises formed part of his house. He was an apothecary, and is mentioned by Peter Peterson in his will (1603) as his "worthy friend and neighbour." Mr. Beecheno says he has reason to believe that Peterson lived in the last house on the Castle Fee in St. Andrew's, that is, next adjoining the present "International Stores" in Castle Street. He would therefore be very nearly opposite Birch and fully justified in calling him "neighbour."

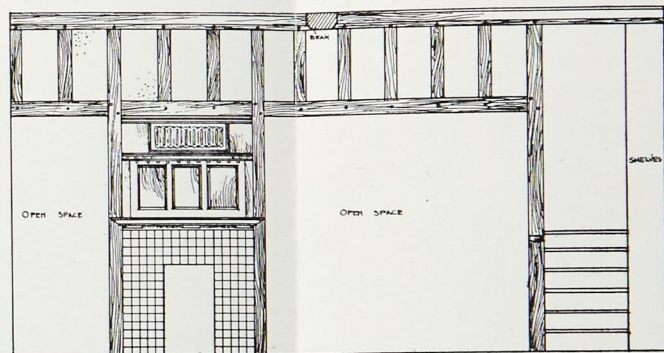
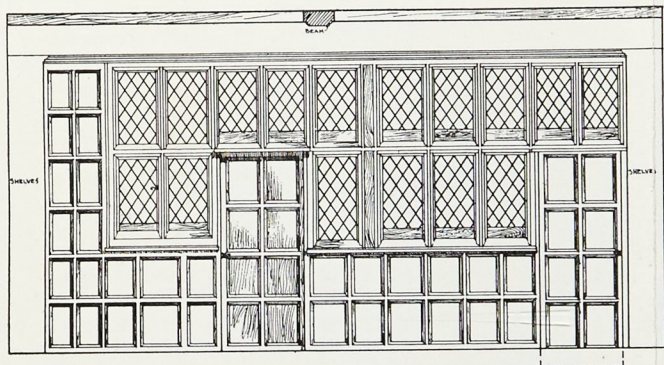

• SECTION THROUGH PANEL MOULDING •



• SECTION THROUGH MULLION •

PANELLING IN MESSRS J. BUCKINGHAM
AND SONS PREMISES
LONDON STREET • NORWICH •

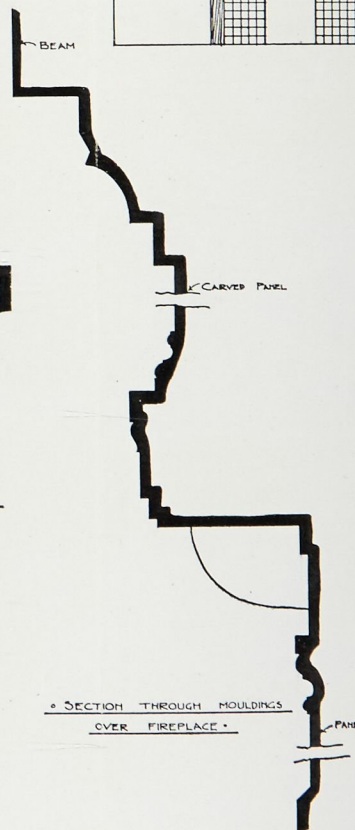

• SECTION THROUGH MOULDINGS
OVER FIREPLACE •

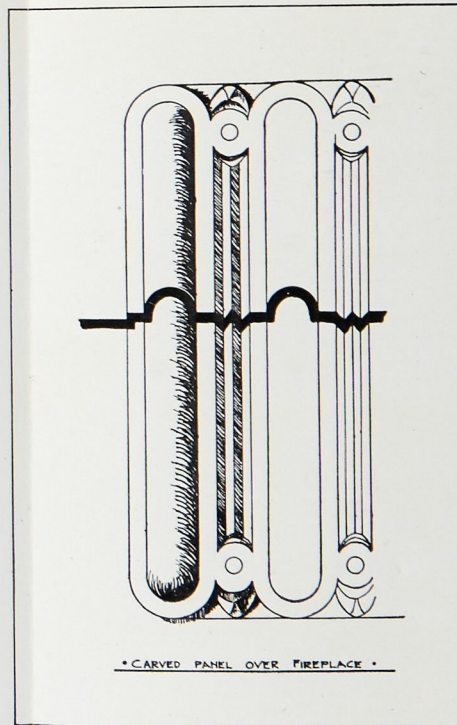

• CARVED PANEL OVER FIREPLACE •

• SCALE FOR ELEVATIONS 8 FEET TO 1 INCH •
• SECTIONS FULL SIZE •