

## Tudor Ceiling at No. 22, St. Giles Street, Norwich.

COMMUNICATED BY

E. H. BUCKINGHAM, A.R.I.B.A.

---

This interesting ceiling was discovered in 1920 at the residence of Dr. Bremner, No. 22, St. Giles Street, Norwich, when building alterations were in progress by Messrs. Read & Son, of Pottergate Street.

The workmen had removed some flooring for the purpose of electric wiring, and it was then discovered that the under side of the joists were carved. It was therefore decided to remove the plaster ceilings beneath and expose the whole of the joists, which are now acting as ceiling joists, and a new floor has been erected above them.

The date of the joists appears to be late 16th or early 17th century, and the workmanship indicates that three distinct craftsmen were employed, as the joists vary slightly in the cutting of the leaves and the rope entwined by the leaves.

I have been unable to trace the history of the house, but there appears to be no doubt that at one period No. 22 and No. 18 were one residence, or possibly an hostel, as there is a covered way leading to the entrance to No. 18, which is in a small courtyard.

DINING ROOM CEILING AT NO 22 ST. GILES ST. NORWICH

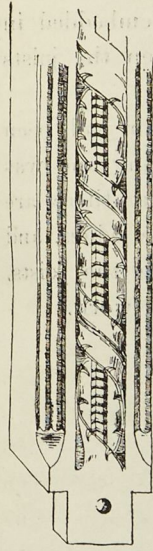
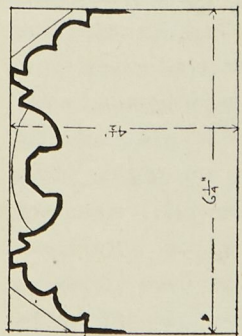

DETAIL OF CARVING TO CEILING JOIST

SCALE OF INCHES

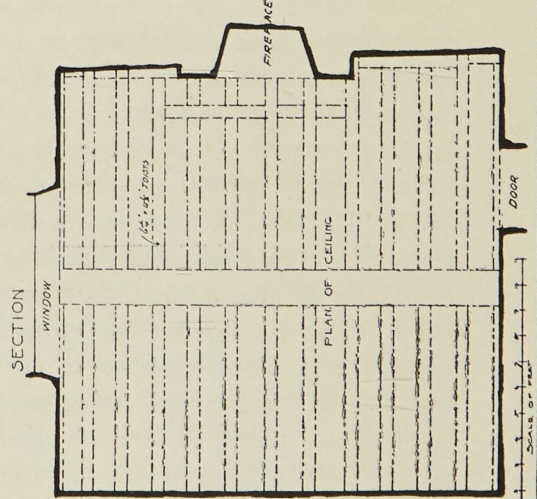

SECTION

PLAN OF CEILING

SCALE OF INCHES

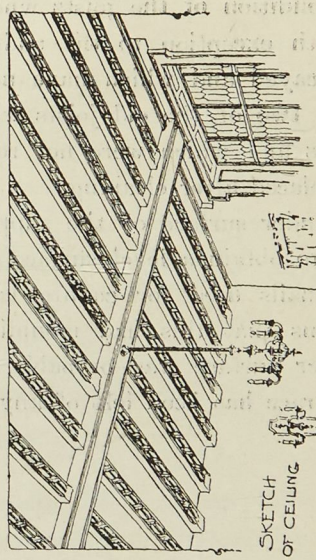

SKETCH OF CEILING

ERNEST H. BUCKINGHAM  
A.S. 1912  
26<sup>th</sup> MARCH 1921.



The condition of the joists when discovered was very good with exception to the ends of five or six, which were decayed and which have now been repaired with parts of two of the old joists which were embedded in the walls and which were not required when the joists were replaced after cleaning.

The under surface of the supporting beam had been hacked to obtain a level surface for plastering and was full of nails used for counter-lathing, but there are indications that this had mouldings on the edges, and the under surface was probably carved like the joists, but no trace has been left of any decorative work.

---