

SHEFFIELD MANOR

SITE RECORDS

VOL. 4

1971 (1)

AREA XX

TRENCHES A B D E
& FEATURE INDEX.

CONTENTS

	<u>page</u>
TRENCH A	5
Plan of Drain, feature 1	6
Plan of Drain, feature 2	8
TRENCH B	13
Plan of Trench B	14
Section of dump of kiln debris	18
TRENCH D	25
Plan of Trench D	24
TRENCH E	35
Plan of Trench E	34
FEATURE INDEX	AT END
CORRELATION OF LAYERS	45

MANOR 1971

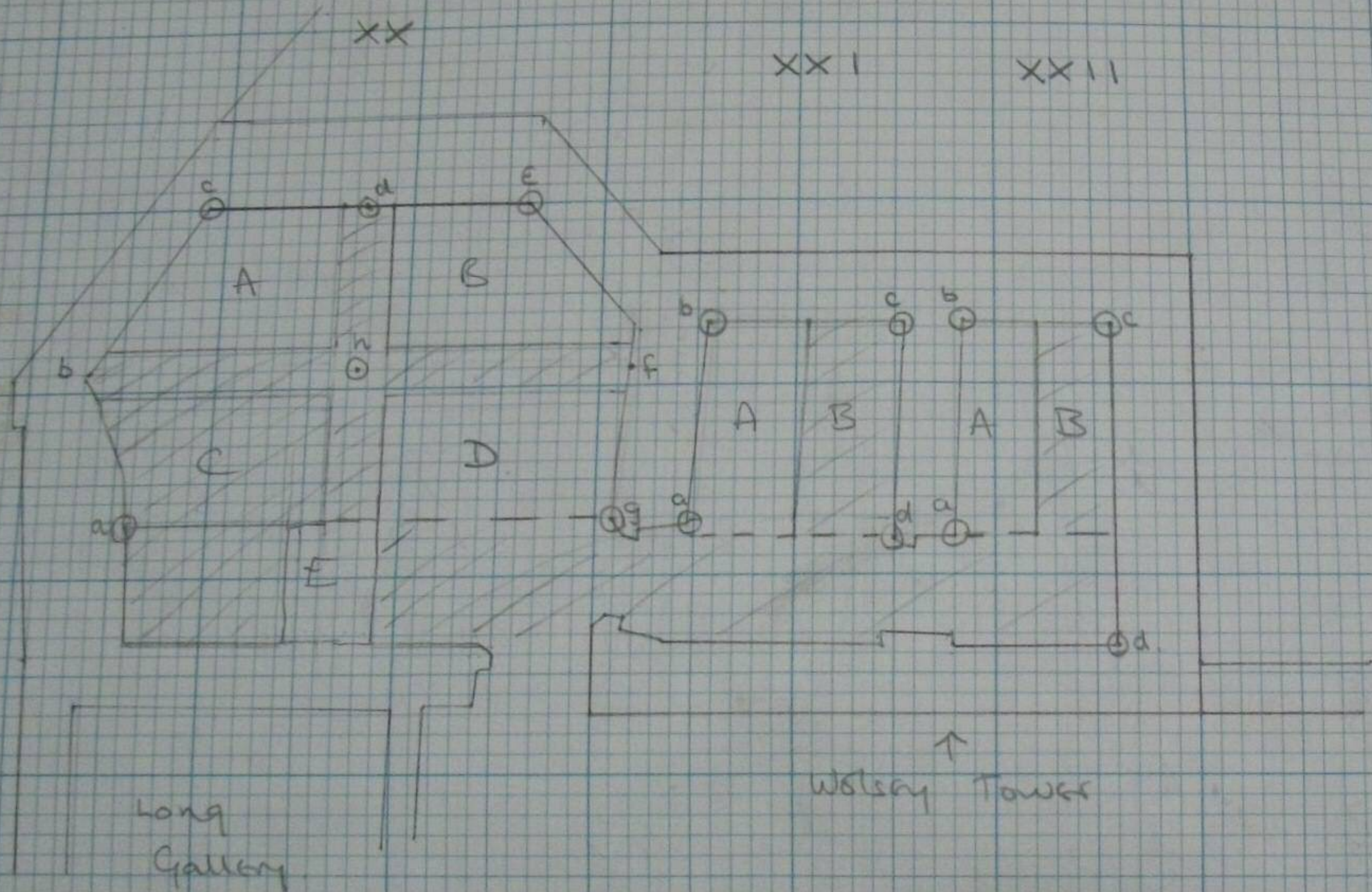
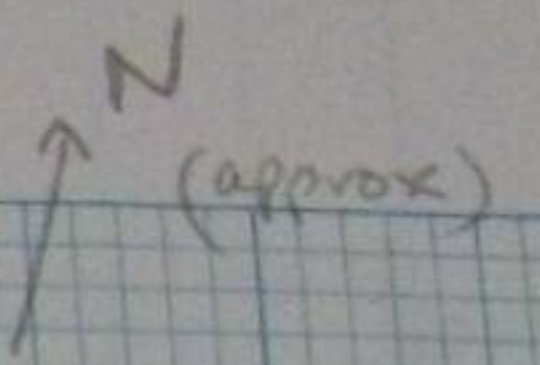

////// = Initially excavated.

Scale 1" = 8'

PLAN of EXCAVATION

SITES (3) xx xx1 xx11

xx
- Divided into 4 squares A, B, C, D.
Base line c, d, e (d mid-point along c, e)
LEVEL - bottom of flat joint slot.
d-h = 7' long
Banks 2' wide

xx1 b-c. Divided in $\frac{1}{2}$ (A x B) \rightarrow 9' long section
 $\frac{1}{2}$ way between E x W walls.

xx11 b-c. as above. "

FINDS.

Small finds - separate Register number for each

Quantities - bagged as for section of site x layer

eg. SM 71 / $\frac{xx}{A}$ / (10).

SKETCH PLAN, TRENCH A

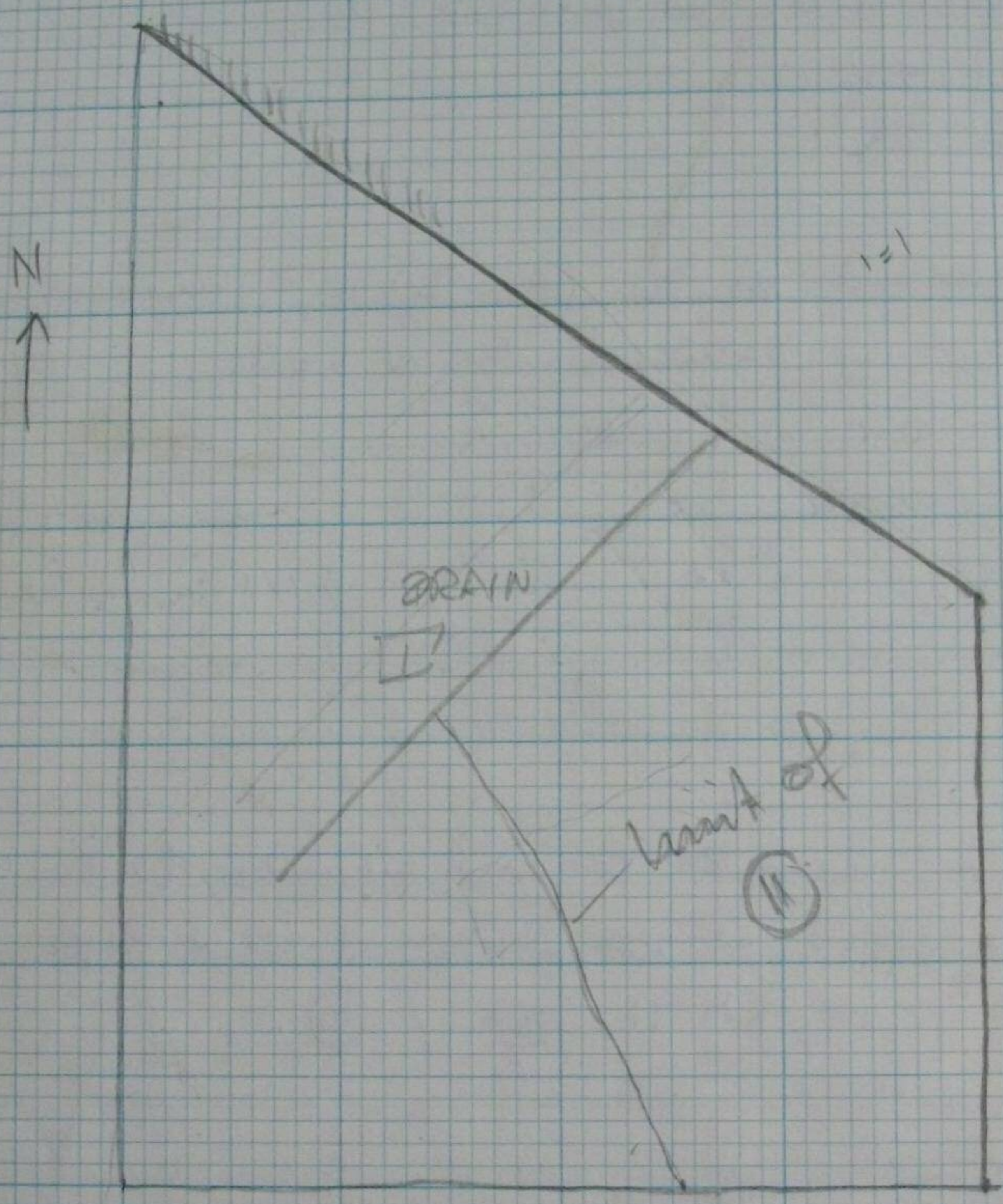

TRENCH A

① Dark brown loam, SW. of drain [□], rising steeply. Layer cuts stratified charcoal, clay etc by NW wall —? Modern oven's edge of drain [□]

② Black hard packed earth, NE of drain, ~~back~~ layer of tread, topsoil, etc.

□ Stone-lined drain, running NW-SE across site; some capping stones in situ. Mason's cleaning makes relationships difficult to interpret. General tread layer ② appears to cover ~~the~~ edges, ① + ③ also do so.

③ Light brown layer, SW of drain [□], under ① covers edges of drain [□]. Contained Mod. brick temp hearth. [NB. sim' of ^{Layer, layer} 107, to XXII A ⑧]

④ Fill of drain [□]. Modern grt. } Dark loam

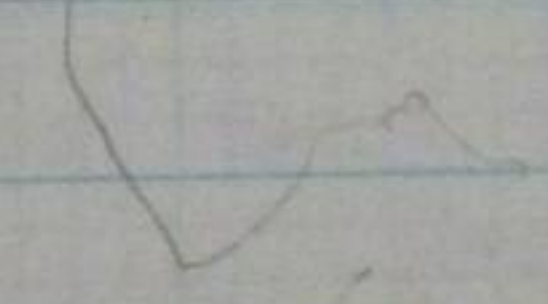

SKETCH PLAN, DRAIN, 1

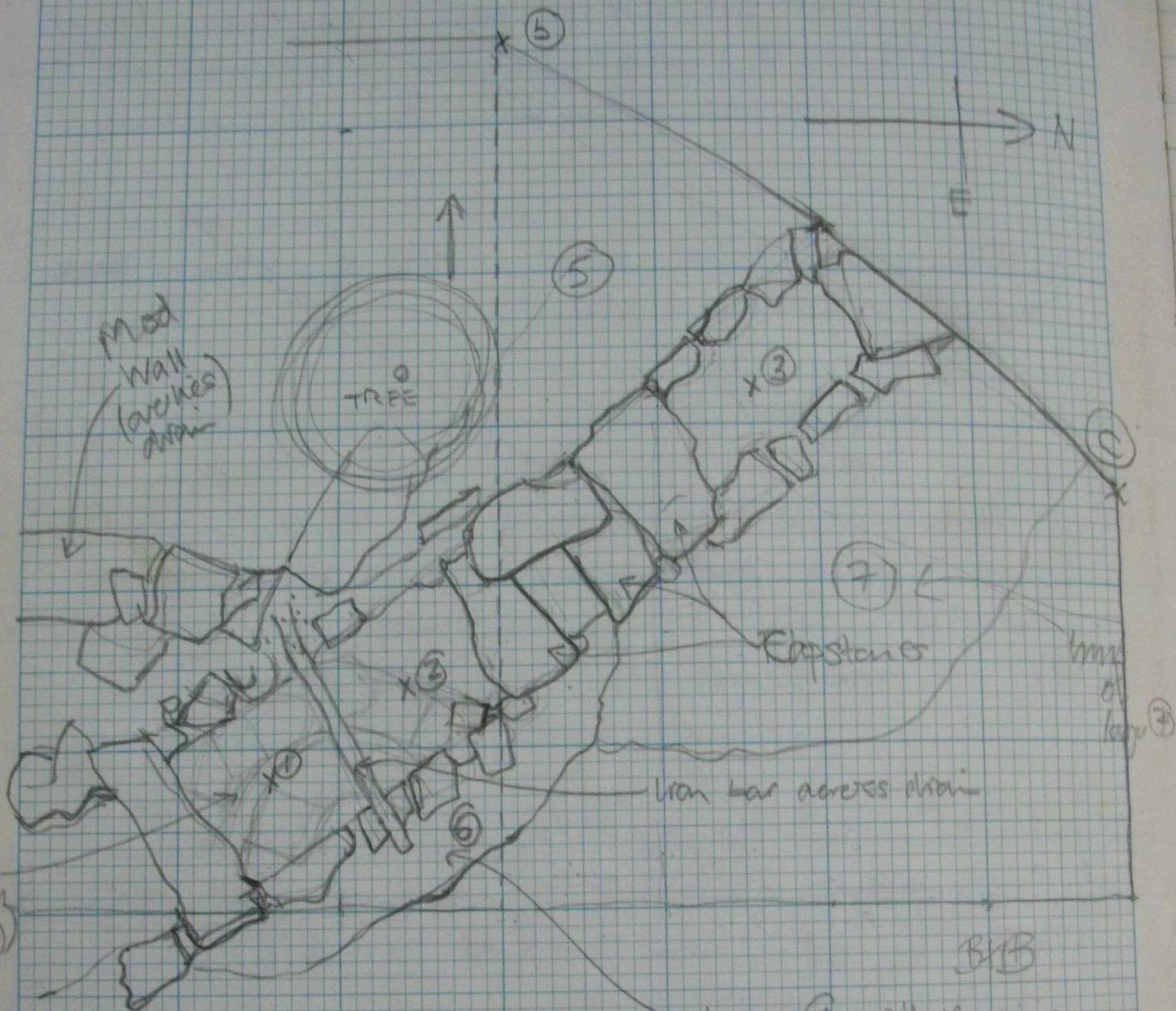

SCALE 1" = 2' 1:24

DEPTH

x ①	14"
x ②	12"
x ③	14"

⑤ Black soil with stones, bricks etc, cut by drain [1] + to SW of it. Under ③, Saggars conc in between drain [1] + feature [2]. Perforated brick from above feature [2]

⑥ Soil similar to ~~5~~ ⑤, but NE of [1] + cut by it. Under ②. See plan, p 6, for extent. Mostly removed by rifle maza, or general use of room.

⑦ Stony red burnt clay, NE of drain, + cut by it, under ②, ? kiln collapse. Extent see plan opposite

⑧ Red burnt clay, under ② abuts ⑦, similar to XX/B ⑬, + XX/D ③.

⑨ Black loam, fill of feature [2], con of WIV ④.

~~10~~

⑩ Khaki sandy clay, abuts ⑧, under ⑦
contains many bricks + stones, only in NW corner of trench. Patches of red burnt clay, coal, etc etc. Only found outside in structure.
Disturbed by vandals. Upper levels stony + kiln debris, the layer marked by saggars - these uprooted by vandals.

Large quantities of Momas ware.

1" = 1'

TRENCH A

FEATURE 2

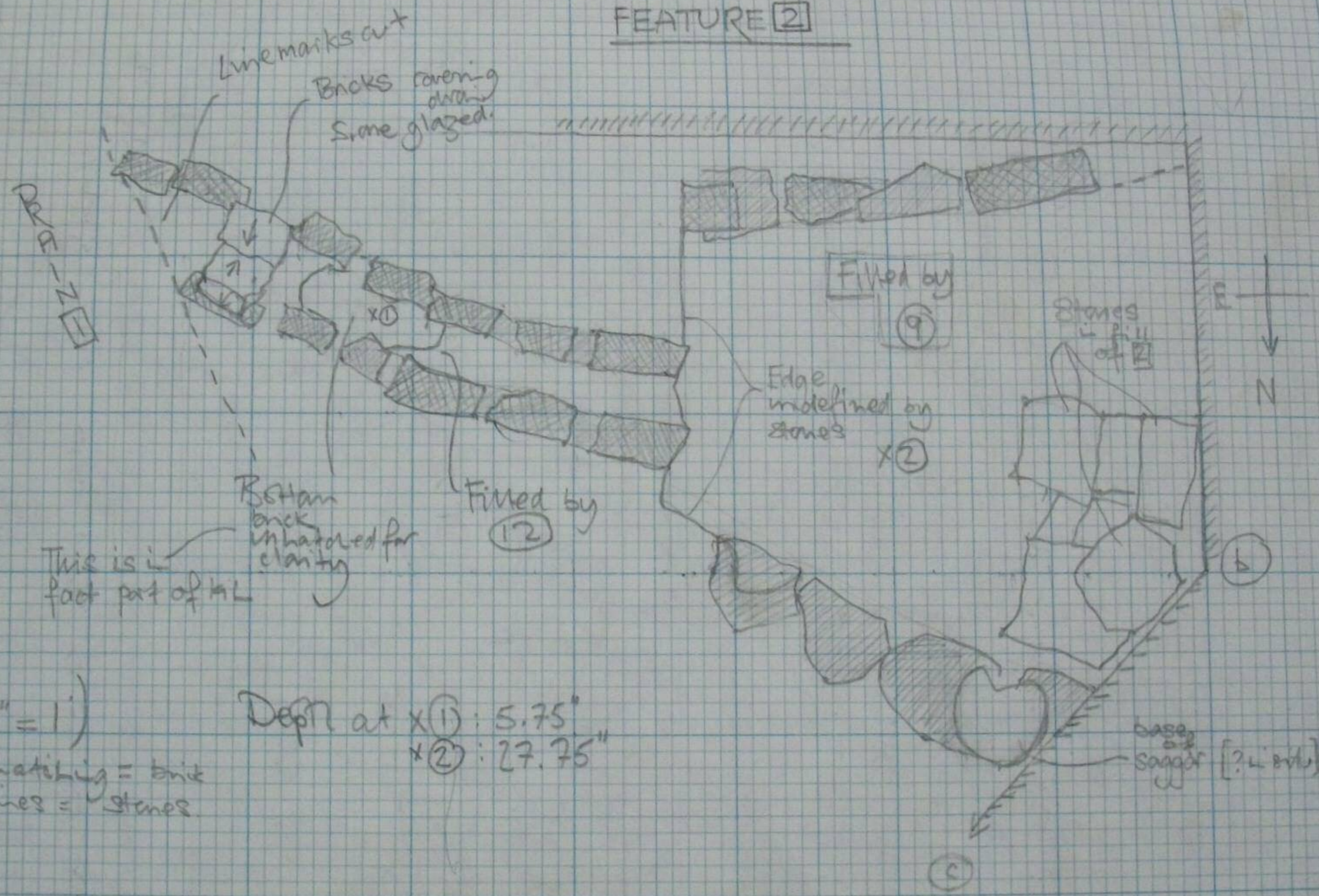

SCALE 1:12 (1" = 1')

Depth at x(1) : 5.75"
x(2) : 27.75"

KEY : Cross-hatching = brick
Cross lines = stones

(12) Fill of brick drain of feature [2] - Black orangey loam.

(13) Khatai sandy clay, similar to (11) + XX/B (18), but SW of drain [1]'s cut. Many saggars etc
△ Beames quite red with patches of burnt red clay but centre of

(14) Thin layer - troddle, under (11) & outside kiln, E of drain, Khatai, + red clay

(15) Coal layer, thin, under (14). similar effect. Note flat bstr (14) + (15) overlap ^{site of} one brick in ante course 1' in for E section.

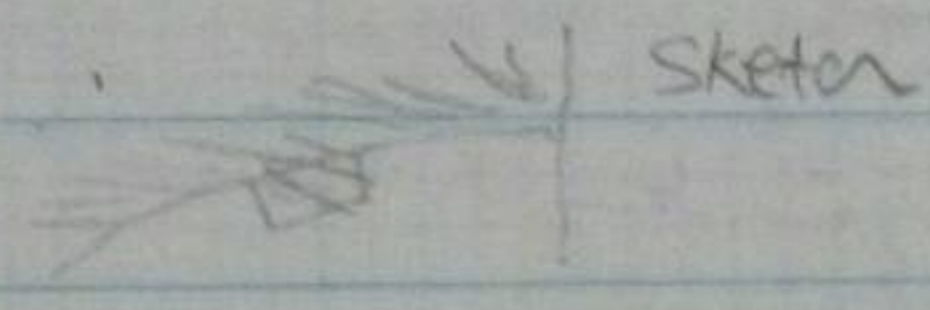

(16) Coal layer, under (15), distinguished by silve-grey tread layer. Also outside kiln to N. Continues SW of mud drain [1].



(17) Orange clay with mth clay, mortar frags etc, under (18) outside kiln.

(18) Dirty red clay with bits of black loam etc L kiln, under (11), filling interstices of remaining bricks. L [3A]

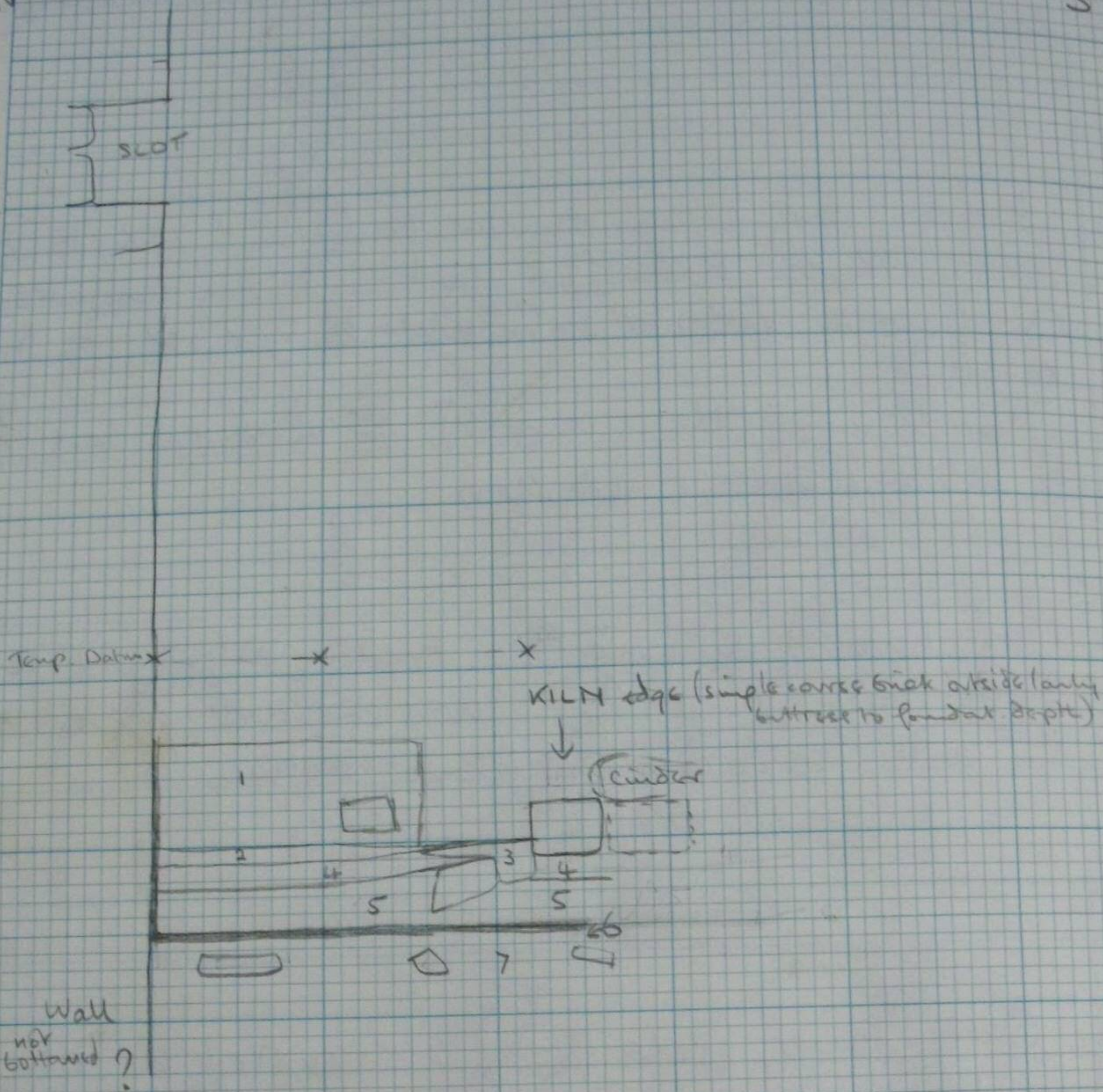

KEY

- ① Brown soil crammed w. small shards of Roman ware & some burnt brick.
- ② Coal
- ③ Bruit clay & bit of coal (NB fire directly over top)
- ④ Brown clay / soil - no pottery.
- ⑤ Sandy with mortar & plaster. (1/2" thick)
- ⑥ Thin hard layer of mortar. (also plaster down wall to this level)
- ⑦ Rubble filling v. like XXI - eg. brown soil, small stuff, coal & oyster shells.

19

Sandy mortar, with limestone rubble, plaster, etc, under (17), underlies parts of kiln, especially chimney flues.

20

Main floor level, marked by floor plaster. Underlies kiln, ~~that~~ which is built on same sining flagstones.

Stemon.

Sketch

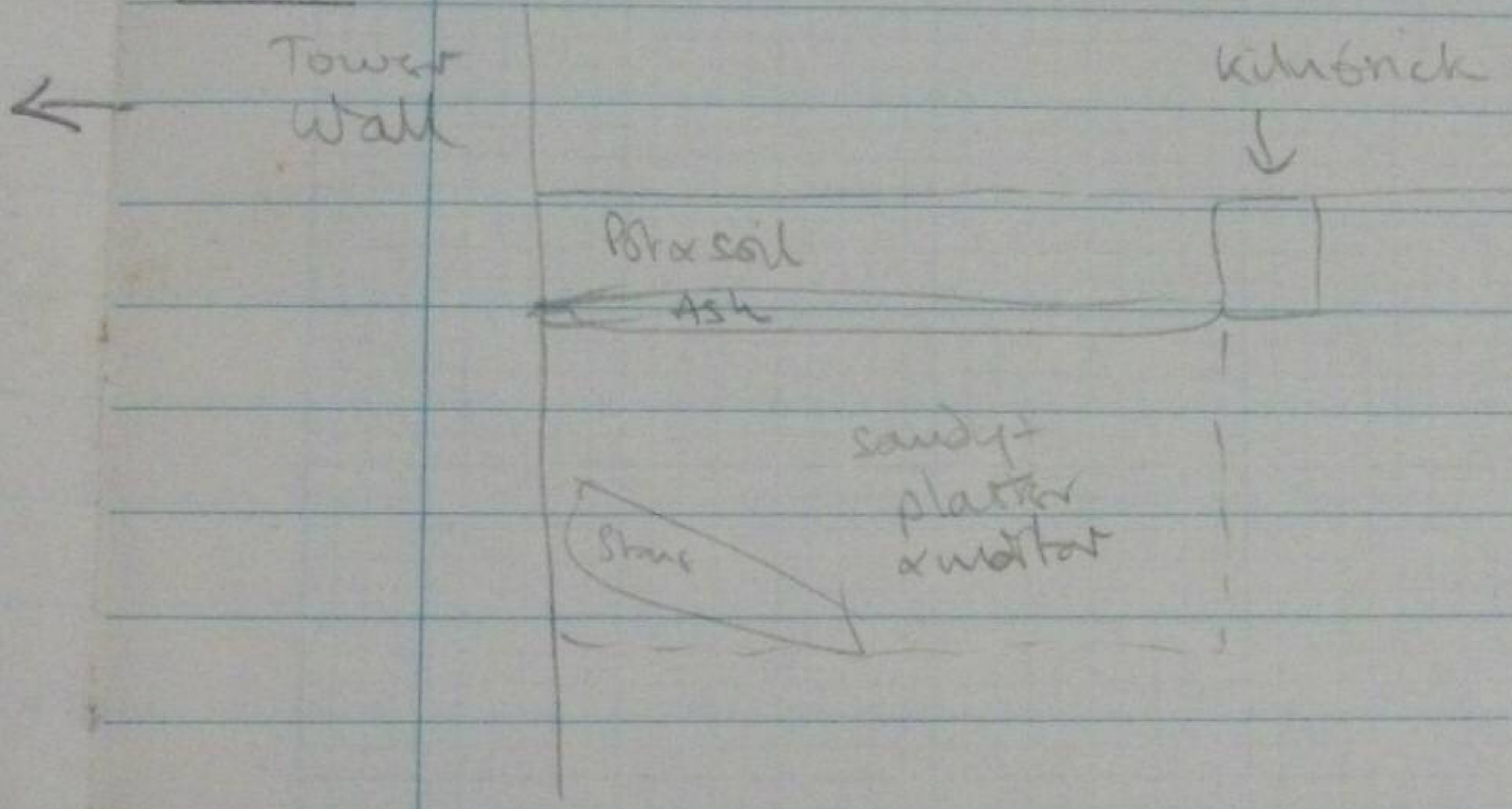

NB KILN BRICKS, av. $9\frac{1}{2} \times 4\frac{1}{2} \times 3$ " same finish textured, halved to c. 5" long.

1298 S 02

SKETCH PLAN, TRENCH B.

SCALE 1" = 2'

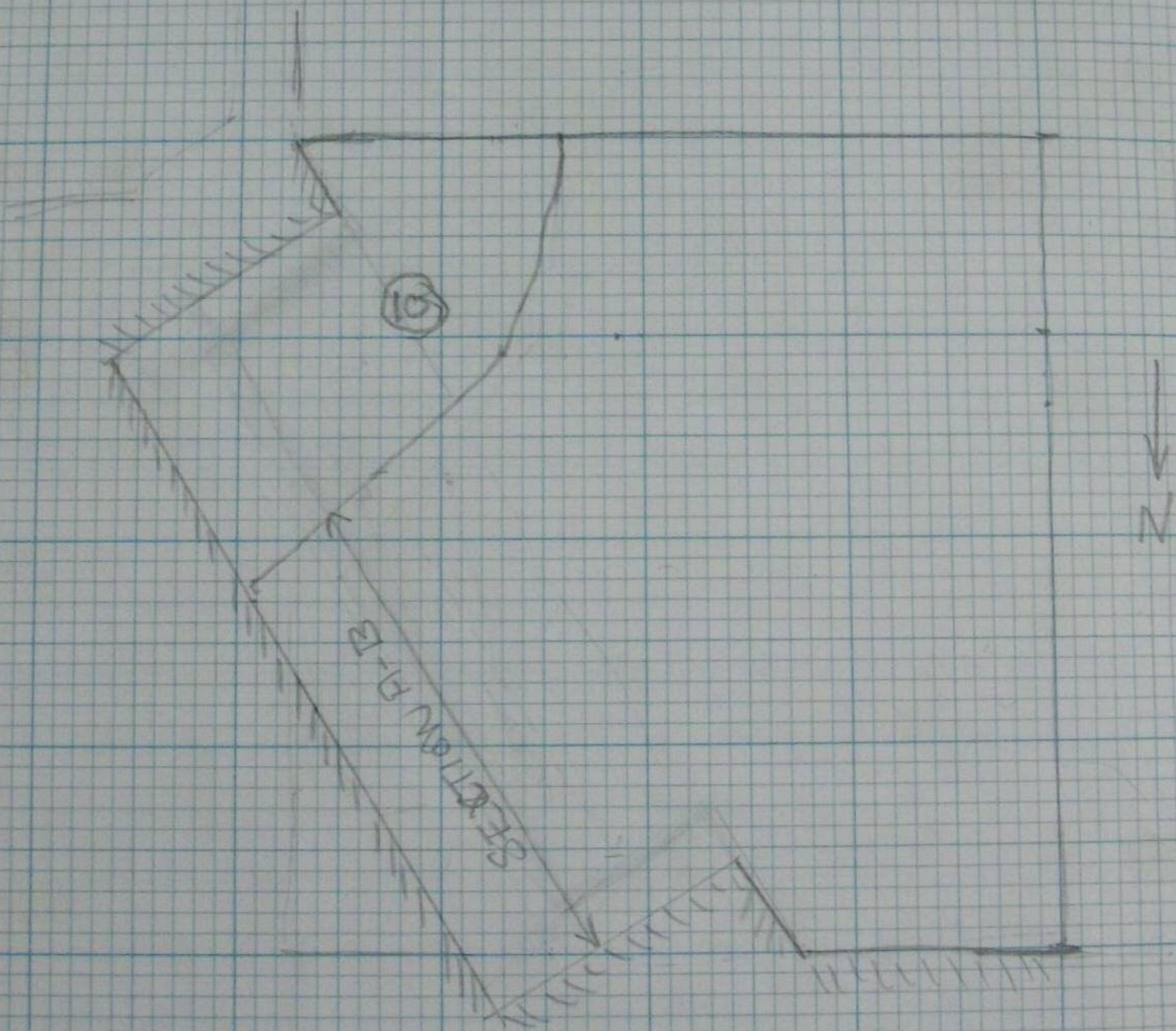

TRENCH B

- ① Black loam, ~~away~~ - E/W corner, 1' out from wall.
- ② Light brown sandy mortary soil, existing only in NE corner after masons' depositions, sloping down → S. 1' deep.
- ③ Charcoal layer, under ②, merges with ⑤.
- ④ Burnt clay, thin layer, separating ③ from ⑤, plaster out to snow ③.
- ⑤ Charcoal layer, many lumps of carbon etc., under ④
coal
- ⑥ Burnt clay, with lumps of unfired clay, under ⑤.
Similar consistency to brick found on site. ? Decayed brick in quantity. Manor ware
Layer of decayed brick = ⑥A in section drawn overhead.
- ⑦ Unburnt buff-colored clay, under ⑥ Manor ware
- ⑧ Bright burnt clay, under ⑦, merges with ⑥ to E, Manor ware in quantity.

SURFACE
 TOP
 BOTTOM

Layers ② - ⑧ represent the remains of a dump of kiln debris, sectioned overhead, mostly removed by mason.

- ⑨ Black hard-packed tread, similar to ① - XX
covered all of trench except N, where large
dump of material removed by mason.
- ⑩ Black clayey soil, containing many stones bricks etc.
~~cut by drain ⑪~~
- ⑪ ~~Modern~~ Black soil, cuts red clay etc, under ①,
by man. ⑫
- ⑫ Loose sandy mortar, over N area of trench
under former tip. Mortar were
- ⑬ Brnt clayey layer, under ⑪
- ⑭ Light red brnt clay, similar to brnt brick,
under ⑨, over most of trench. Contains light
brown clay, cinders, slag (little), much brnt clay fired,
+ clayey red clay (decayed bricks?) Under ⑨
Merges with ⑥/⑧, cut by ⑩
- ⑮ Mortar light brown loam, appears only in section A-B
under modern repair of wall, covering brick debris
layer ② - ⑧
- ⑯ Black loam, under ⑧, [see section A-B], in pile of
brick debris in NE of trench, mixed with
wall. (see note back 1 page)

B&T
small
traces
left
by
mason

SECTION A-B, TRENCH B (see plan)

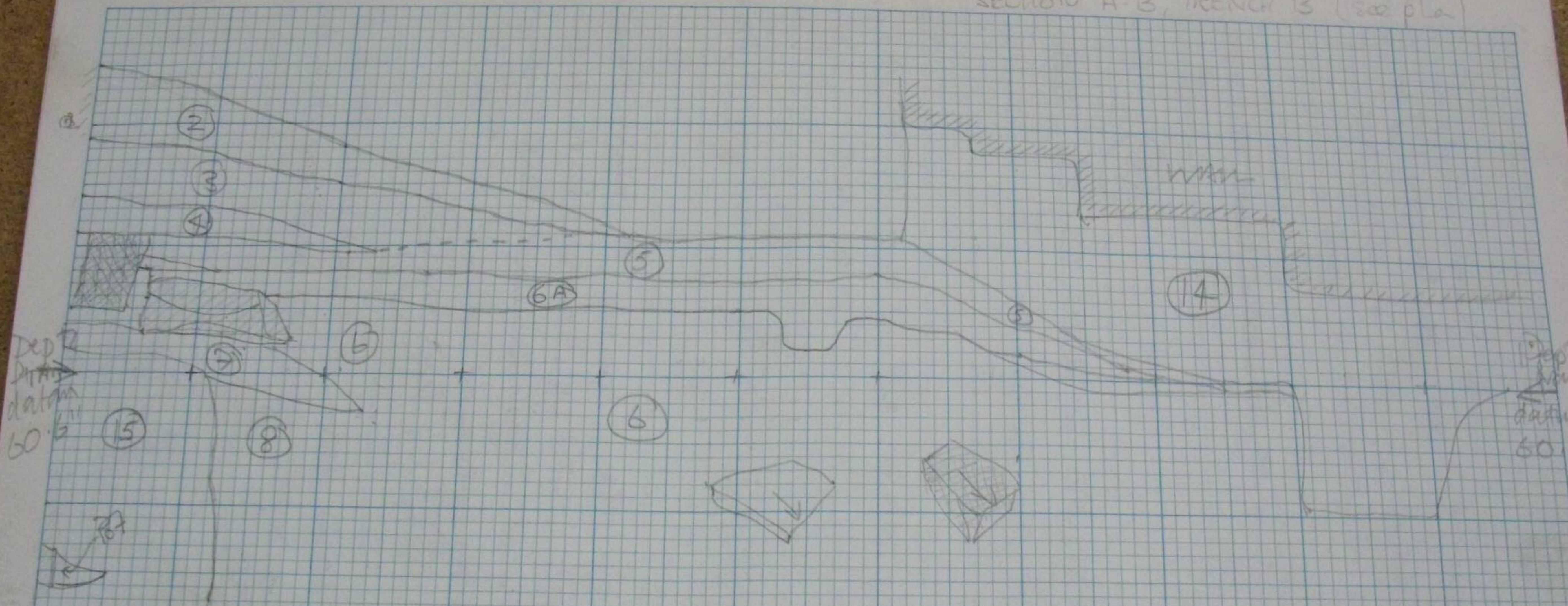

Dep
from
datum
60.6'

Dep
from
datum
60.6'

GENERAL LEVEL LEFT BY MASONRY DEBRADATIONS, LEVEL MERGES WITH LEVEL 13.

(15) (contd) layer comes between pile of
wall + wall — prob topsoil

(16) Rubby debris, with burnt clay, of all consistencies, under
(13), quantities of brick

(17) Fill of beam slot is fireplace sandy loose
material; behind pile of debris repres. by (2)-(8) +
(15)

(18) Khaki-green clay, under ~~TR~~ (16) + (13)
over all trench except kil in SE corner.
Stoney, compare XX/A (17), but not so clearly
defined as kil heavily robbed at this point.

(19) Sandy light green layer, with? iron discoloration.
Under (18) is fireplace. Below level of highest
beam slot.

(20) Coal layer - loose, of. XX/A (15) Under (18)
Note to left of fire-hole as in XX/A
(15). Outside of kil, collected between
wall + kil.

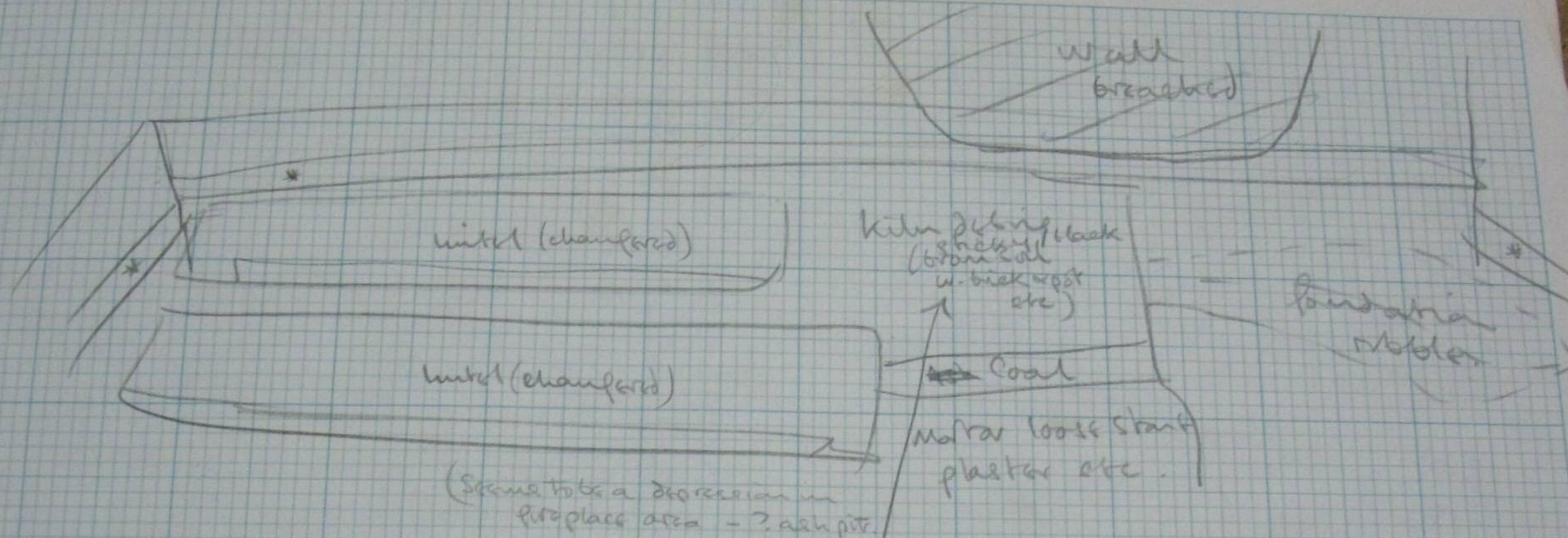

3) sketch of fireplace corner

* slots

Dec '71 fireplace discover.
 in W wall of room & lintel
 pits ∴ this probab. not a
 fireplace corner.
 Distance here poss caused
 by wall breach.

Pottery & plaster mixed
 lots of unrec'd not all saved.

- (21) Hard packed coat layer of xx/A (16), outside kiln, under (20) Abutts large stones in feature [4]
- (22) Orange packed layer under (20) + (21), but in fact (21) does not always go down onto (22) i.e. (22) + (21) are contemporaneous. (22) Does not cover all of area outside kiln, + overlaps
- (23) Matting stuff, similar to xx/A (19), under (21) + (22).
- (24) Similar layer to (23) i.e. decorative layer of Manar, but darker + less mortar, more loose.
- (25) Mound of hardened mortar cement, under (23), are (26), May correspond to pile used to construct kiln - NO. see main plan.

FIREPLACE LINTELS →

Small 32" x 13" x 8"

Larger 37" x 15½" x 8"

TRENCH D.

SKETCH PLAN.

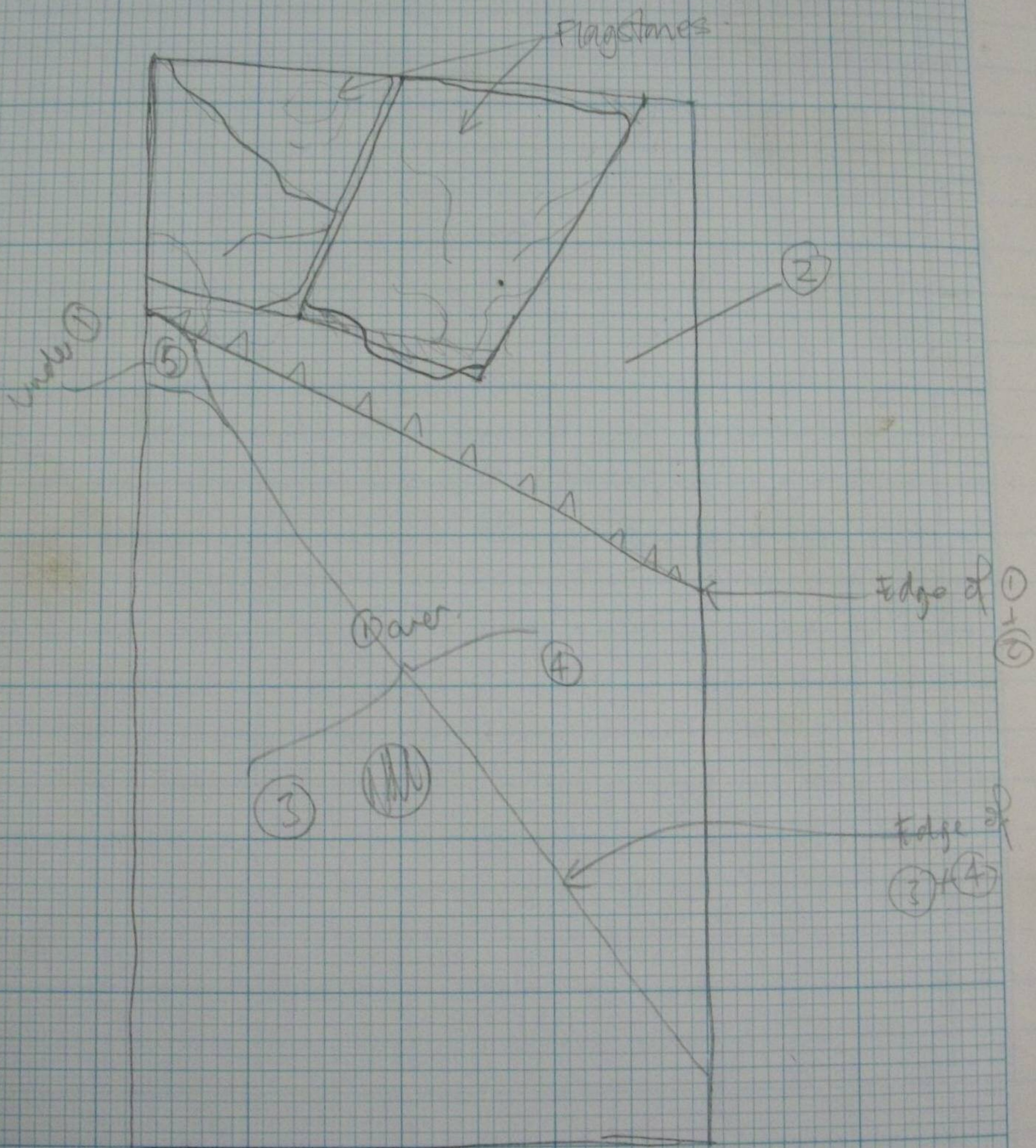

TRENCH D

25

- ① Black clayey soil, with much burnt clay, charcoal etc; few sherds — tread + gen. build-up, covered all trench
- ② Black loam, ^{blue-backed} blue ? plaster, herring-bone ribbing. Modern disturbance. Also cutsmilk bottle?, sandstone etc. Bottomed with flagstones under ①
- ③ Red burnt clay, under ①, consistency similar to burnt brick, cut by ② + ④, overlies exactly burnt staves, flags etc of feature
- ④ Black soil, cut into ③, merges with ①, though contains more burnt clay, etc., = ②, though more stony etc.
- ⑤ Mixed loam, with much burnt clay etc., cut into ③.

Trench C recess in wall @ point (a) post-kiln wall inserted. Clearance Dec '71 shows to be fireplace - lintels & supps. missing - chimney hollow above but inner part of wall appears to have been rebuilt. ^{back wall well built} Some blocking @ bottom of fireplace in outside wall. A VE-W cross wall, adjacent, breached by later cottage adaptation as doorway w. steps leading down to lower level than original in small room which was covered — at of one corner of the kiln, after it fell out of use.

Trench B.

Fireplace lintels appear to fit fireplace in C. Disturbance in fill & float/mortar levels not explained at this point - not staggered slots in walls.

TRENCH A & B slot in back wall also earthen @ point (b) - does not appear to be related to kiln - too close to coal & ash level to also standing room (p. 11 opp.) Also not high enough above floor level to allow standing room? base connected w. panelling & plaster wk. decoration.

NB. Rough (mass) found round pottery in right hand side of fireplace.

TRENCH E; SKETCH PLAN

E 55 1/2" x 60" S

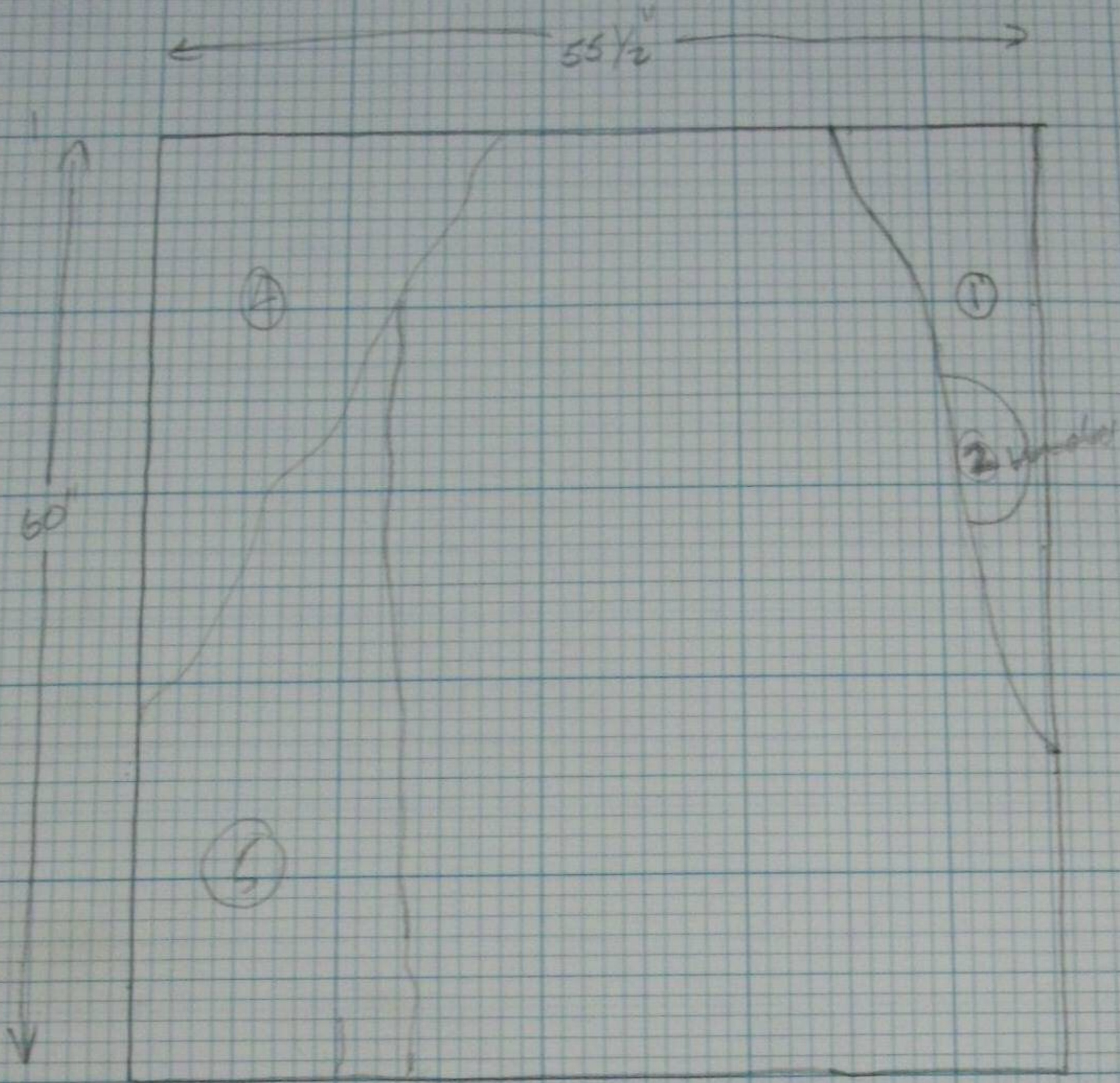

SCALE
1" = 1'

TRENCH E.

① Light brown loam, with sandstone frags.

② Pit L ③, containing loam similar to ①, + sandstone frags., 6" deep - ~~more~~ root disturbance

③ Bunt red clay, with unburnt red clay, similar to $\frac{XX}{B}$ ⑥, under ①, are most of trench.

④ Dark brown loam, containing large limestone in SW of trench. Contained decaying shoe leather - Modern.

⑤ Black mortaring soil, under ④, by S. wall, with ③. Modern disturbance.

⑥ Black charcoal tread, outside kiln, cf. XX/A + XX/B, survives only to a width of 6" because cut by mud. dist. ⑤. Covered by red clay ③

⑦ Brown orangey layer, under ⑥, with possibly tread on floor surface, but extent not sufficient to determine whether floor is so.

SM 71 XX

AREA A

AREA B

AREA D

AREA E

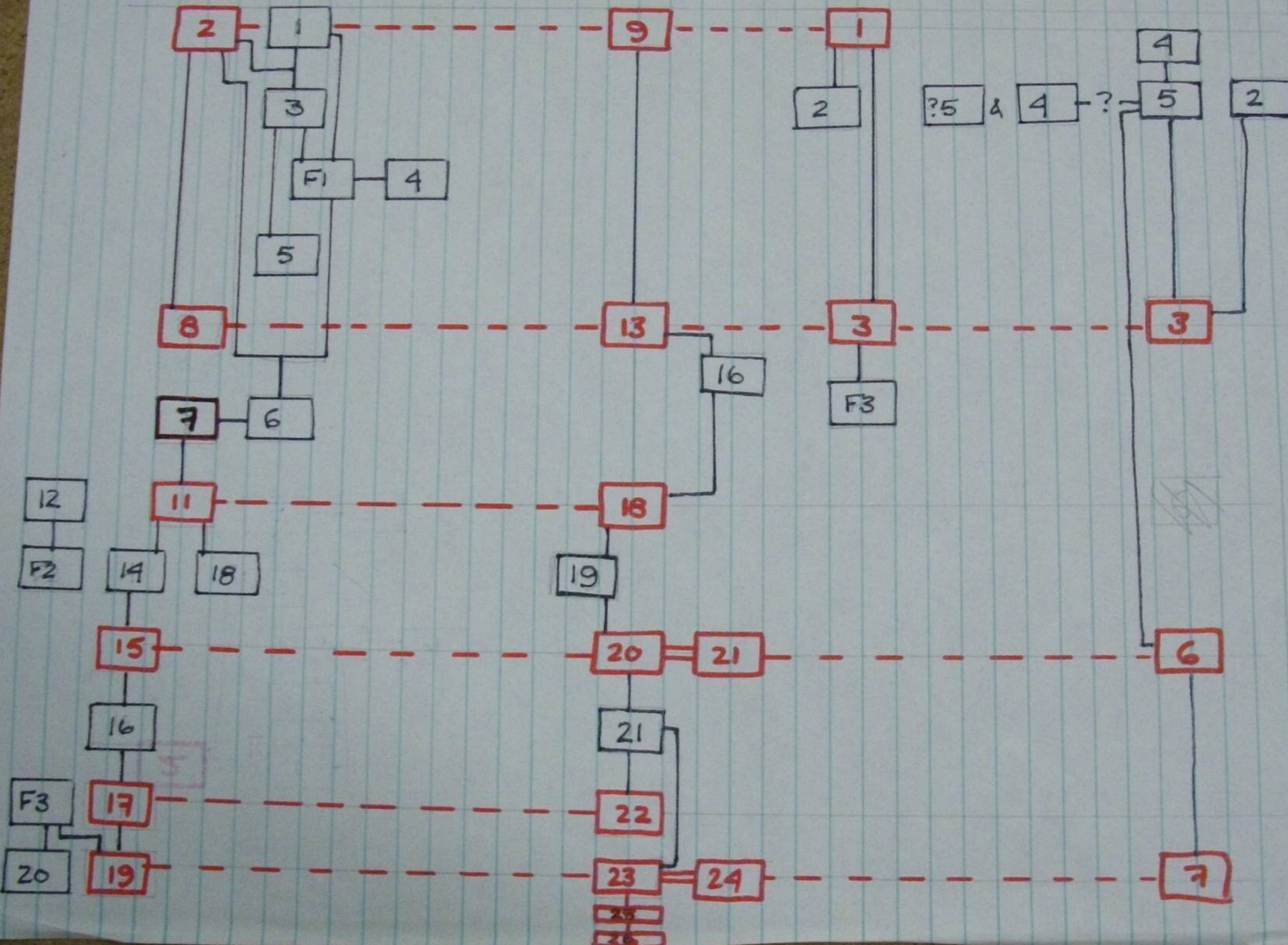

TREAD LAYER
MODERN DISTURBANCE NR. E. WALL

RED CLAY of KILN COLLAPSE

KHAKI LAYER of KILN ROBBING

LAYERS of TRODDEN COAL

LAYER of TRODDEN RUBBLE?

MORTARY RUBBLE

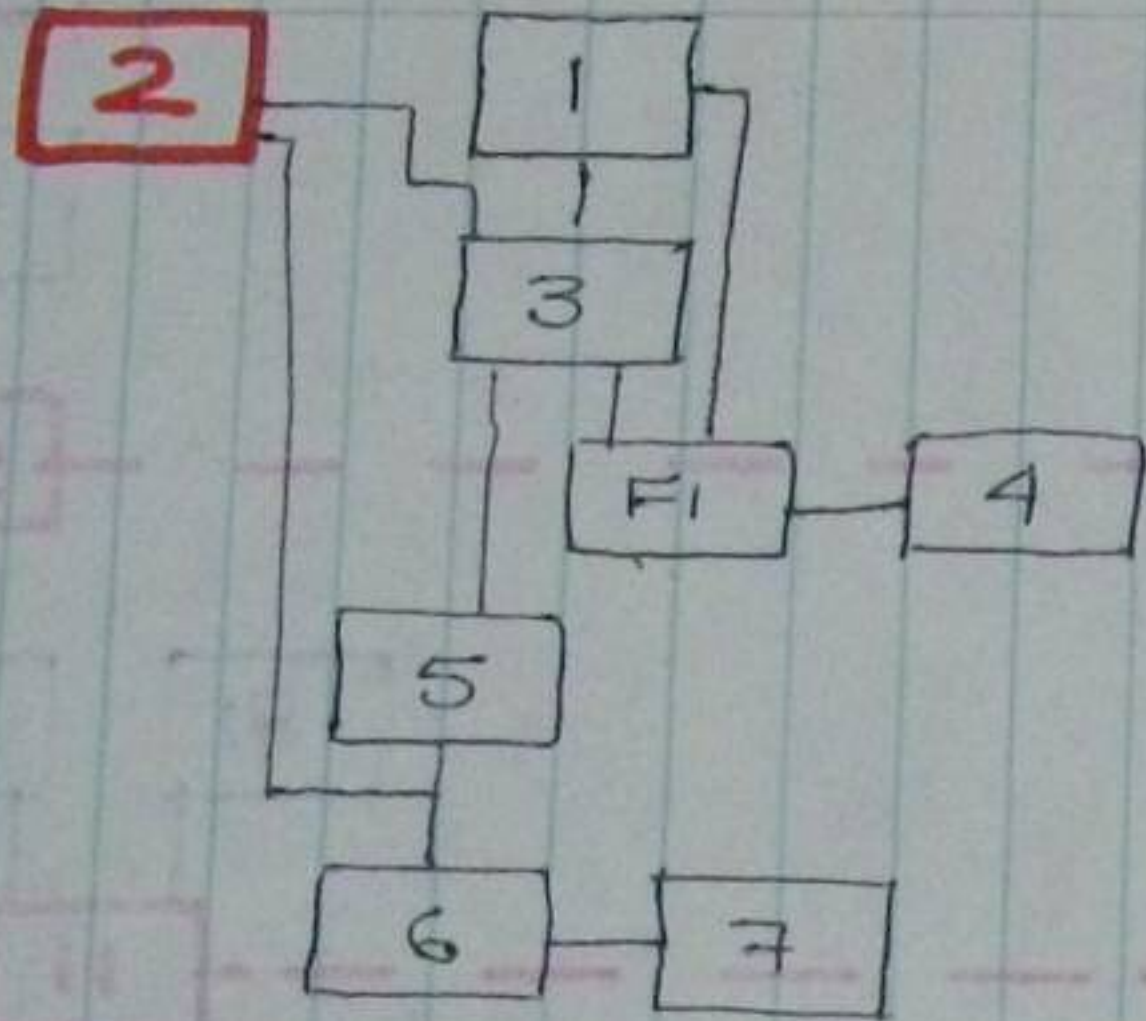

8

7

CORRELATION OF LAYERS

45

Tread layer

A (2), B (9), D (1).

Red clay of kiln collapse

A (8), B (13), D (3), E (3).

Khaki layer of kiln robbing.

A (11), B (18), Did not appear in D, or E, due to heavy modern disturbance.

Layers of trodden coal.

A (15) + (16), B (20) + (21), E (6), Did not appear in D due to heavy robbing. [noisy assemblage layers]

Layer of trodden rubble

A (17), B (22), Layer missing in E (see note to layer (7))

Mortary rubble underneath this

A (19), B (23) + (24), E (7) - Note that E (7) is rather less mortary.

Model distance near E. wall.

B (10), D (2), (5)+(4). E (5) is separate but
same dist. on S side of room.

TRENCH XV

FEATURE INDEX

[1] Drain, modern, stone-lined, in trench A. [see sketch plan] Some cap-stones in situ. Paved out at approx 2' from S edge of room (? cut by modern clearance) Bottom revealed brick floor + laid stones of kiln. Cuts XX A/6, cut by XA ①, ② + ③

[2] Stone-lined pit, in trench A, covered by layer ⑤ - note brick 'dwa' into it, fill ⑨, contained Cer of W.IV Δ . Cuts Mura + kiln floor levels. Uses kiln debris in construction eg. sappers, re-used bricks etc.

[3] KILN

References: in Trench A [3A]

Under A ⑧

L Tr A, SW of area [3AA]

⑪

L Tr B [3B]

Over ⑫ + ⑬

L Tr D [3D]

L Tr E [3E]

[4] Large stones in fireplace in XY/B