

NORFOLK ARCHAEOLOGICAL UNIT

Report No. 1090

**An Archaeological Watching Brief at Meadow House,
West Barsham, Norfolk**

41740 BAS

Gary L. Trimble

October 2005

© Norfolk Archaeological Unit

Contents

Summary

- 1.0 Introduction
- 2.0 Observations
- 3.0 Conclusions

Acknowledgements

Figures

- Fig. 1 Site location
- Fig. 2 Site plan

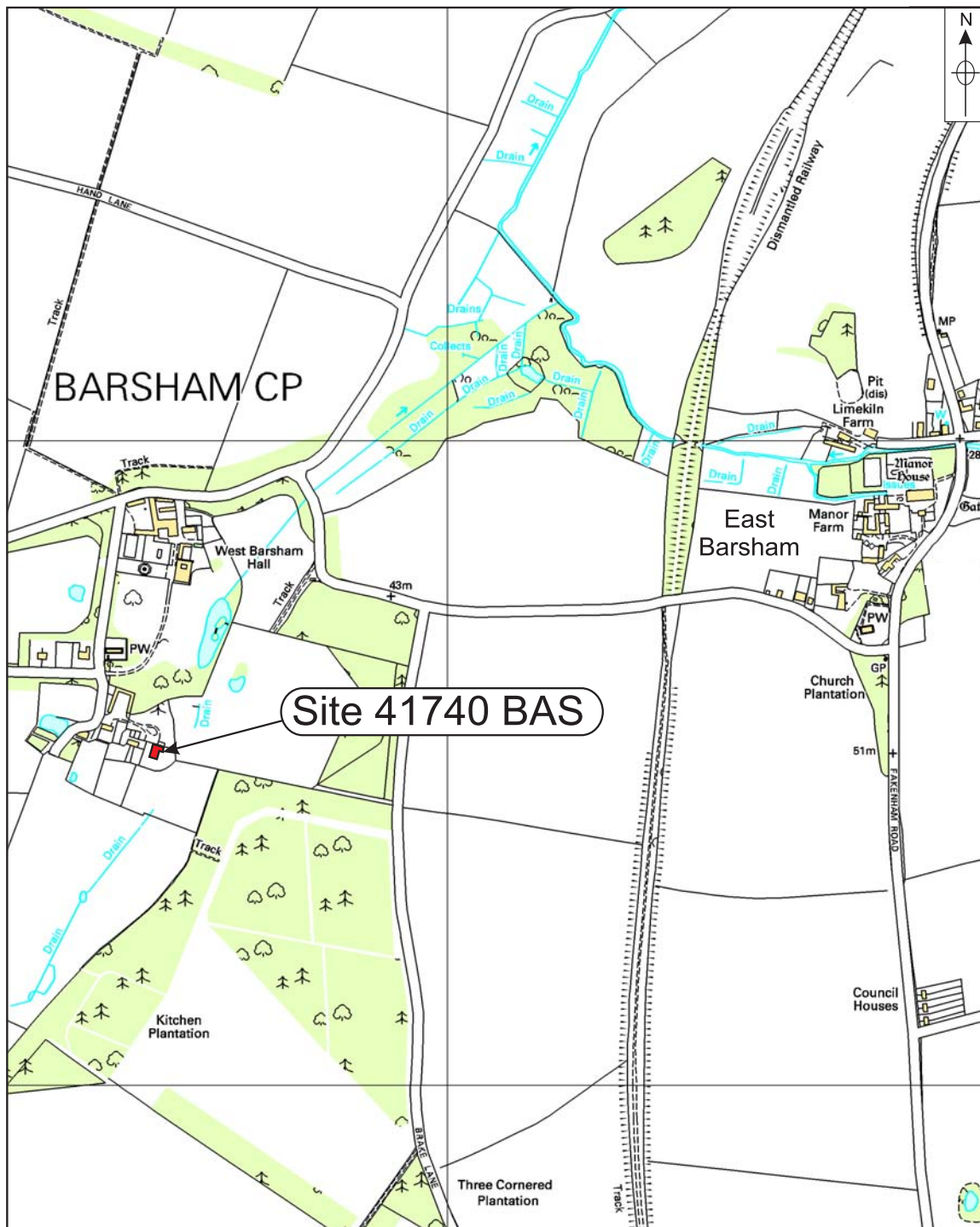

0 1000m

Figure 1. Site location. Scale 1:10,000

Local Authority No.100019340

Fig. 1 is based upon the Ordnance Survey 1:10,000 map with the permission of the Controller of H.M. Stationery Office © Crown Copyright
 'Unauthorised reproduction infringes Crown copyright and may lead to prosecution or civil proceedings' Norfolk County Council, County Hall, Norwich
 (05/01/05). Reference copy: no further copies to be made.

'We would draw your attention to the fact that the Copyright Designs and Patents Act 1988 will continue to apply to the Ordnance Survey map which will be subject to Crown copyright protection. The Ordnance Survey map is supplied for the sole purpose of assisting you to understand the information overlaid on it. Should you wish to use the information in any other way, for example by making multiple copies or issuing copies to the public, then please contact Ordnance Survey and they will advise you as to whether or not you will require a licence' Ordnance Survey (01/01/05)

Location: West Barsham, Norfolk
District: North Norfolk
Grid Ref: TF 9054 3354
HER No.: 41740 BAS
Date of work: 7th and 8th February 2005

Summary

An archaeological watching brief carried out during the excavation of foundation trenches for an extension at Meadow House, West Barsham revealed no features, objects or deposits of archaeological significance.

1.0 Introduction

(Figs 1 and 2)

An archaeological watching brief was undertaken during the excavation of foundation trenches for the construction of an extension to the east side of Meadow House, West Barsham, Norfolk. The survey area measured 10m x 6m (60 sq. m).

Fisher & Sons Ltd commissioned the work.

This archaeological watching brief was undertaken in accordance with a Brief issued by Norfolk Landscape Archaeology (ER/05/10/04). The Norfolk Museums and Archaeology Service currently hold the site archive, in accordance with the relevant policy on archiving standards.

The objective of this watching brief was to record any archaeological evidence of an earlier building that was revealed during groundworks. The Brief required that the works required constant monitoring by an approved archaeological contractor.

2.0 Observations

No archaeological features or deposits were recorded during the watching brief. The foundation trenches were excavated by mechanical excavator to a depth of 0.90m. Fragments of modern building material, glass and pottery sherds dating to the early 20th century were (although not retained) noted throughout a profile that consisted of mid to dark grey silty sands. This suggests dumping of soil to make up the ground level here had occurred relatively recently. Therefore, although nothing of archaeological significance was recorded, archaeological remains could lie deeply buried beneath this make-up material.

3.0 Conclusions

No features or deposits of archaeological significance were recorded during the watching brief. However, it is possible that archaeological remains may survive beneath the considerable depth of dumped material on the site

Acknowledgements

Thanks to Fisher & Sons Ltd. who commissioned this work. Gary Trimble carried out the watching brief fieldwork. The report was illustrated and produced by David Dobson and Julie Curl, edited by Alice Lyons and Andy Shelley.

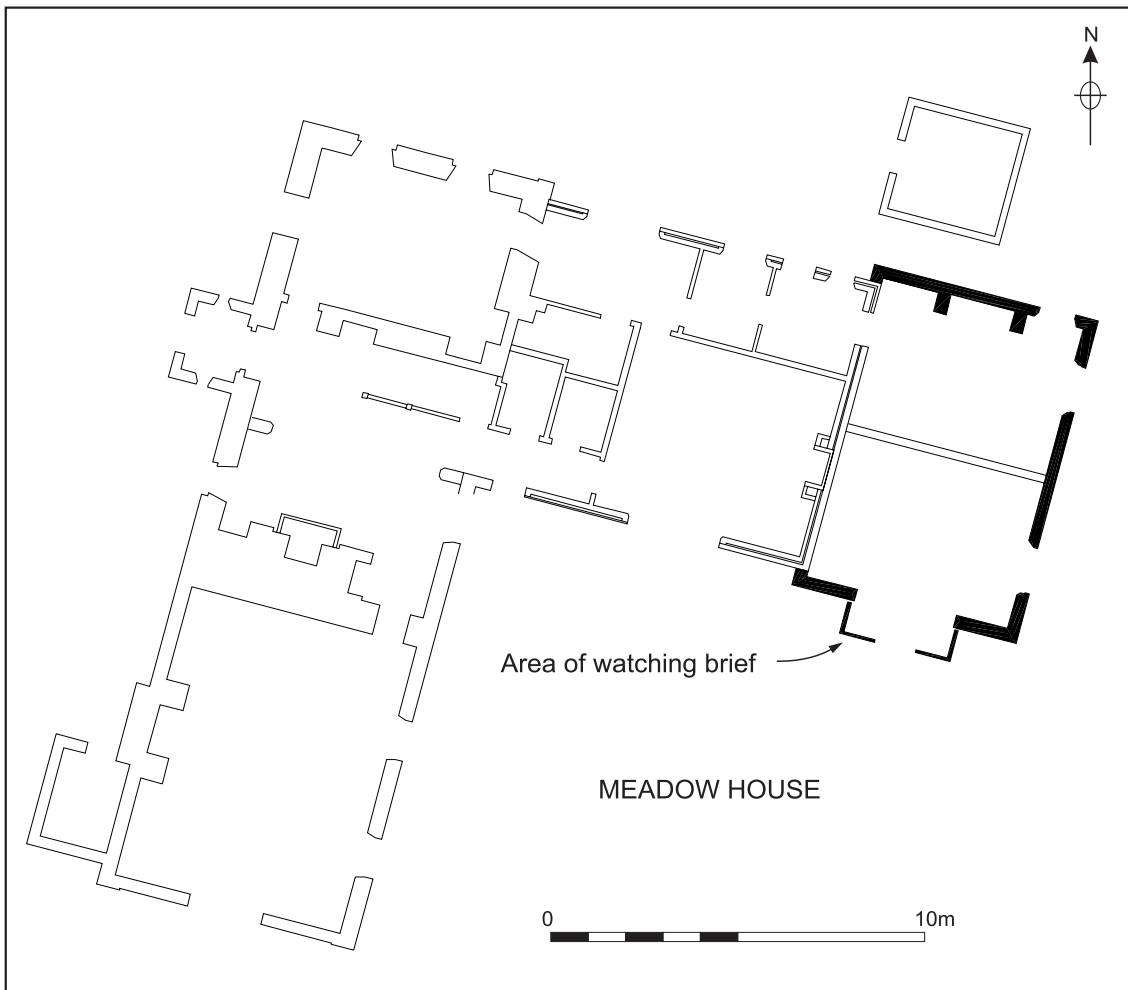

Figure 2. Site plan. Scale 1:200