

**NORFOLK ARCHAEOLOGICAL UNIT**

Report No. 844

**An Archaeological Watching Brief at 147 Wootton Road,  
Kings Lynn, Norfolk**

39249 KLY

Kenneth Penn

July 2003

© Norfolk Archaeological Unit



## Contents

---

### **Summary**

- 1.0 Introduction
- 2.0 Geology and Topography
- 3.0 Archaeological and Historical Background
- 4.0 Methodology
- 5.0 Results
- 6.0 Conclusions

### **Acknowledgements**

Appendix 1: Context Summary

### **Figures**

- Fig.1 Site Location
- Fig.2 Trench Plan
- Fig.3 Sections of Pits [1], [3], [5] and [7]

Local Authority No.076759

Fig.1 is based upon the Ordnance Survey 1:10,000 map with the permission of the Controller of H.M. Stationery Office © Crown Copyright 'Unauthorised reproduction infringes Crown copyright and may lead to prosecution or civil proceedings' Norfolk County Council, County Hall, Norwich (30/07/2003). **Reference copy: no further copies to be made.**



Location: 147 Wootton Road, Kings Lynn

Grid Ref: TF 6380 2108

HER No.: 39249 KLY

Date of Fieldwork: 22nd April 2003

---

## **Summary**

*Observation of groundworks at 147 Wootton Road, Kings Lynn, identified four small irregular pits within the foundation trenches. No finds were retrieved however, and the pits remain undated.*

## **1.0 Introduction**

Fig. 1

The site lay at 147 Wootton Road, Kings Lynn, which consists of a long plot in the suburbs of the town, running west towards the Gaywood River and former marshes beyond. Now in Kings Lynn, this area lies in the former parish of Gaywood.

The work was commissioned by David Taylor Building of Kings Lynn .

This archaeological watching brief was undertaken in accordance with a Brief issued by Norfolk Landscape Archaeology (NLA Ref: EJR 01/06/2002) and a Method Statement for watching briefs prepared by the Norfolk Archaeological Unit (NAU).

The site archive is currently held by the Norfolk Museums and Archaeology Service, following the relevant policy on archiving standards.

## **2.0 Geology and Topography**

At the time this archaeological watching brief was undertaken the plot was vacant, although until recently a bungalow had stood here and evidence of modern occupation debris was apparent throughout the topsoil.

The plot lay close to the River Gaywood, on the gentle slope leading down to the river flood plain and stood on a natural subsoil of sandy clays.

## **3.0 Archaeological and Historical Background**

Fig. 1

The site lies close to evidence of Saxon occupation, and adjacent to the road from Gaywood to Wootton. Two points of archaeological interest are recorded in the Norfolk Historic and Environment Record (HER), these are listed below:

- HER 14673: an isolated find of an iron spearhead, identified as Early Saxon in date, was previously found within the survey area (HER 39249)
- HER 5544: a Middle Saxon brooch has been recorded to the east of the survey area, on the site of a 17th century cemetery.

## 4.0 Methodology

The objective of this watching brief was to record any archaeological evidence revealed during the excavation of groundworks

All archaeological features and deposits were recorded using NAU *pro forma* sheets. Trench locations, plans and sections were recorded at appropriate scales.

## 5.0 Results

Figs 2 & 3

The main trenches were 0.90m wide, the other trenches some 0.50m wide, and up to 1.10m deep. The topsoil was c.0.60m deep over a sandy clay natural subsoil. The site lay close to the River Gaywood, to the west, with a 2m slope down to the river flood plain, some 50m to the west.

Four features were recorded in the trenches examined during this work (Fig. 2), all were irregular pits (Fig. 3), although their full extents exceeded the trench walls and could not be fully defined.

- Pit [1] was about 0.40m wide and 0.25m deep, with a fill ([2]) of dark brown to black sandy loam. There were no finds.
- Pit [3] was about 0.70m wide and 0.30m deep, with a fill ([4]) of dark loam with fragments of shell. There were no finds.
- Pit [5] was about 0.90m wide and 0.25m deep, with a fill ([6]) of dark loam with fragments of shell. There were no finds.
- Pit [7] was about 2.50m wide and 0.55m deep, with two fills. The lower fill ([9]) was a dark grey silt; the upper fill ([8]) was a black loam with fragments of shell.

## 6.0 Conclusions

Although there is evidence nearby for Saxon activity, no evidence for this was seen at 147, Wootton Road, although conditions were not good for identifying archaeological features, and those that were seen could not be dated.

### ***Acknowledgements***

We are grateful to David Taylor for commissioning this work and to his staff for their assistance on site. Equipment was loaned by Dr A. Rogerson and S. Ashley of NLA. The report was illustrated and produced by Maggie Foottit and edited by Alice Lyons.

### **Appendix 1: Context Summary**

<b>Context</b>	<b>Type</b>	<b>Description</b>	<b>Context Date</b>
1	Cut	Cut for pit	Unknown
2	Deposit	Fill of [1], dark brown/black sandy loam	Unknown
3	Cut	Cut for pit	Unknown
4	Deposit	Fill of [3], dark loam with fragments of shell	Unknown
5	Cut	Cut for pit	Unknown
6	Deposit	Fill of [5], dark loam with fragments of shell	Unknown
7	Cut	Cut for pit	Unknown
8	Deposit	Upper fill of [7], black loam with fragments of shell	Unknown
9	Deposit	Lower fill of [7], dark grey silt	Unknown





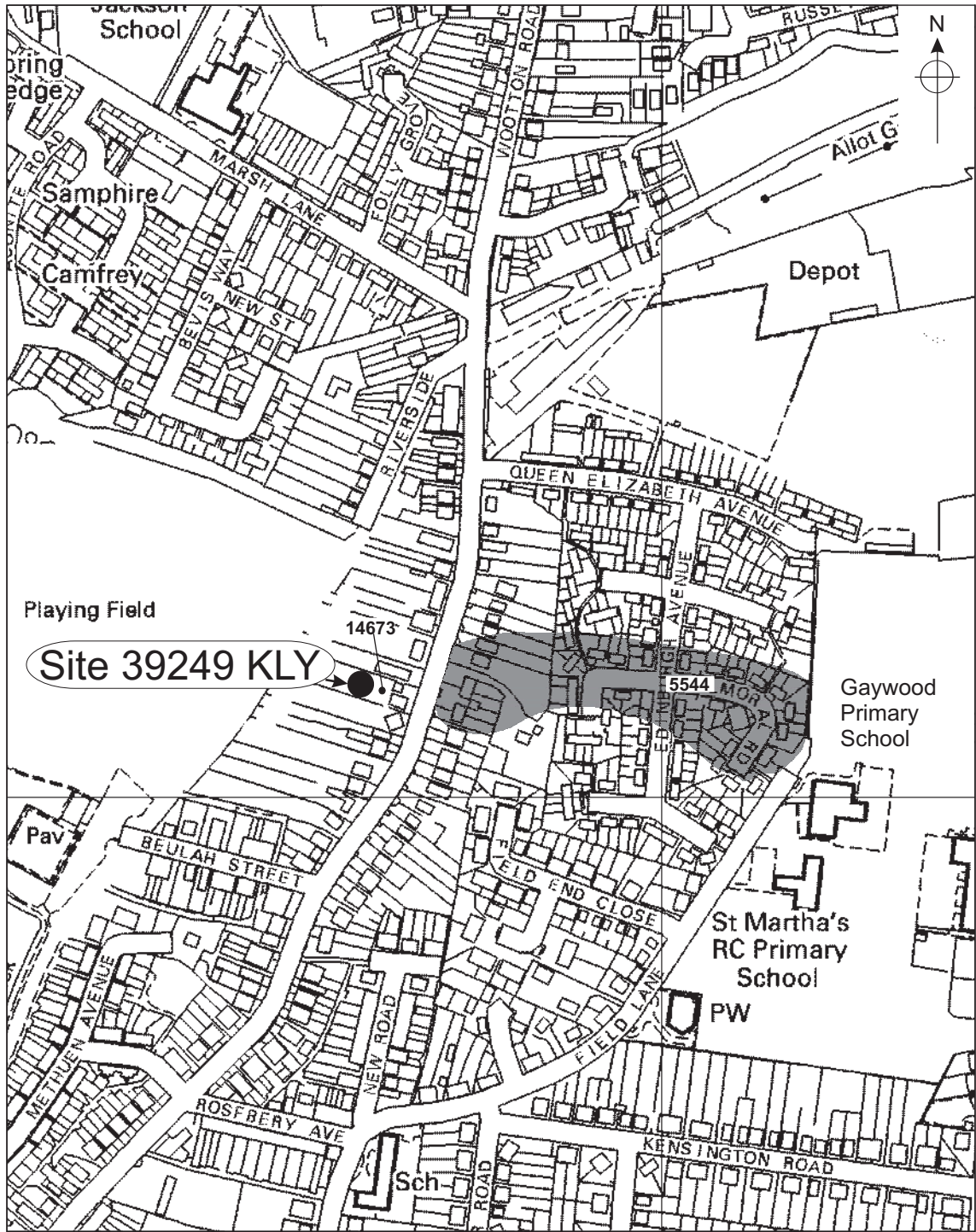
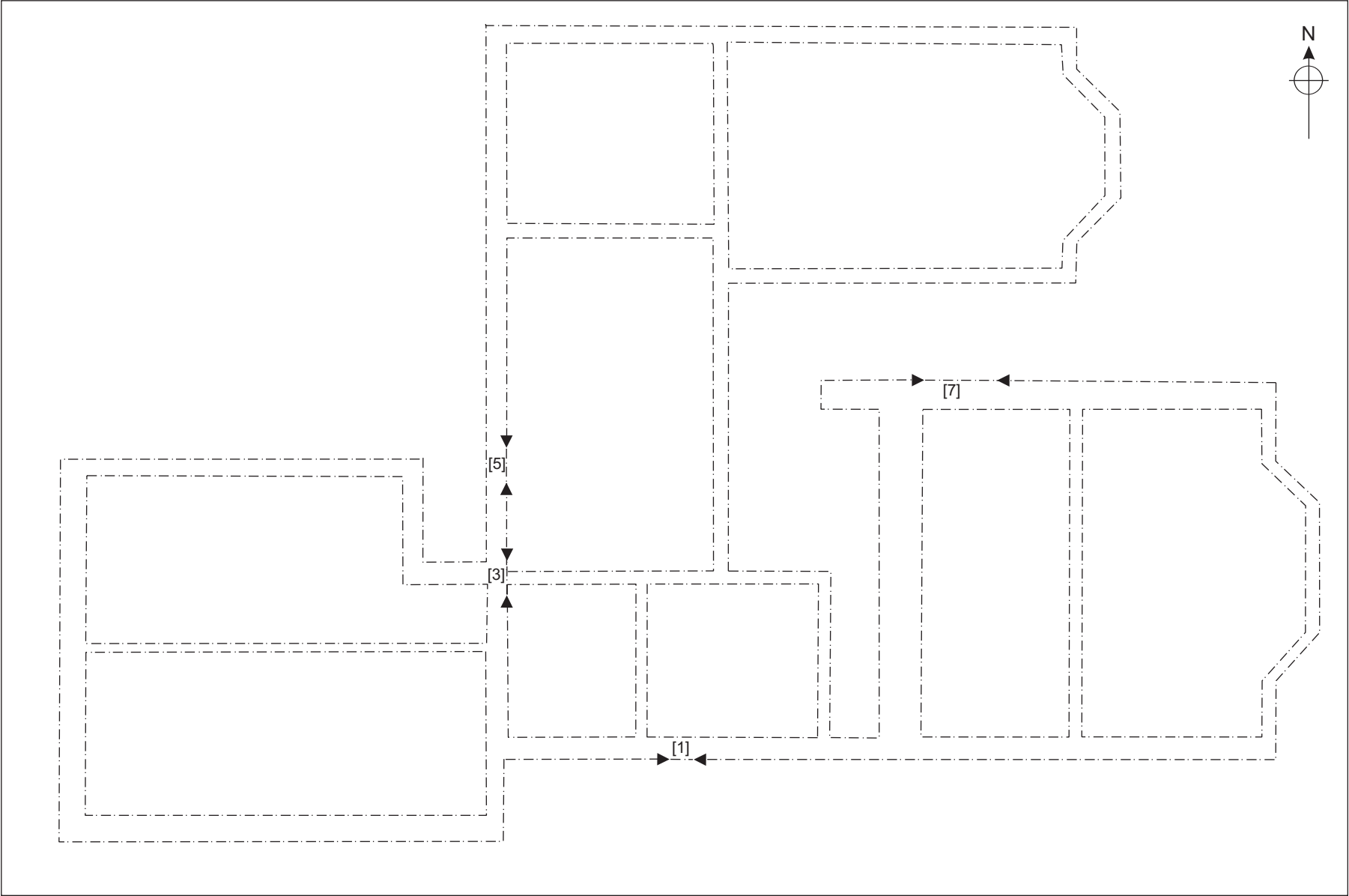
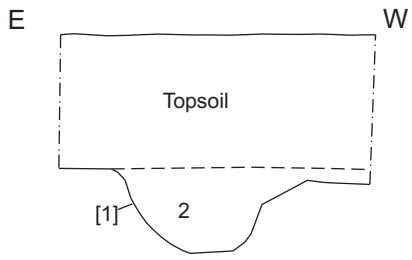

Figure 1. Site Location. Scale 1:5000



0 5m  
Figure 2. Trench Plan. Scale 1:100



North facing section

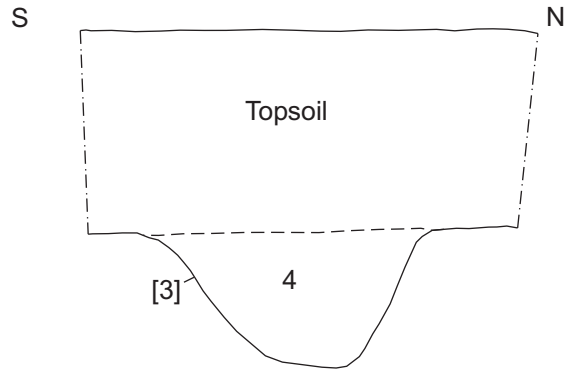

East facing section

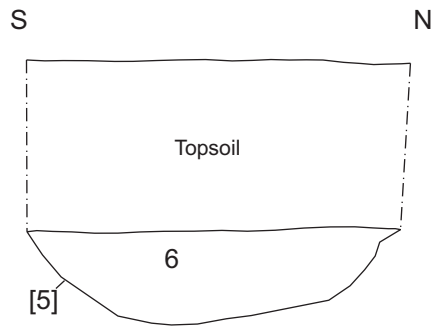

East facing section

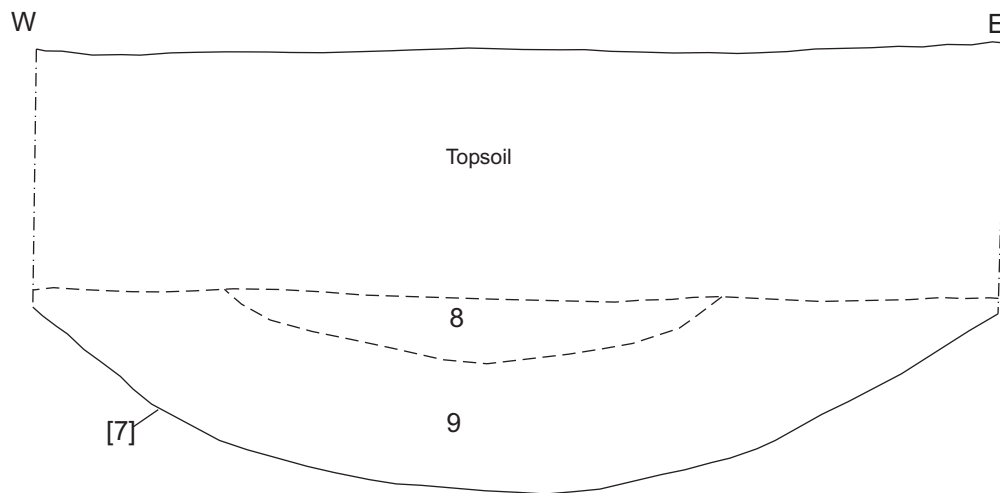

South facing section



Figure 3. Sections of Pits [1], [3], [5] and [7] Scale 1:20