

Report № 1975a

**An Archaeological Evaluation
of land to the rear of 20 Bishopsgate, Norwich**

NHER 51771 N

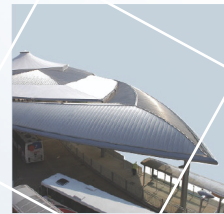

Stephen Morgan

October 2008

BAU1975

© NAU Archaeology



NAU ARCHAEOLOGY PROJECT CHECKLIST		
Project overseen by	David Whitmore	
Draft completed	Stephen Morgan	14/10/2008
Graphics completed	David Dobson	08/10/2008
Edit completed	Richard Hoggett	20/10/2008
Signed off	Andrew Hutcheson	29/10/2008

NAU Archaeology
Scandic House
85 Mountergate
Norwich
NR1 1PY

Contents

<i>Summary</i>	1
1.0 Introduction	1
2.0 Observations	1
3.0 Conclusions	4
<i>Acknowledgements</i>	4
Appendix 1a: Context Summary	7
Appendix 1b: OASIS feature summary table	7

Figures

Figure 1	Site location
Figure 2	Trench location
Figure 3	Trench Plan
Figure 4	Section 1

Plates

Plate 1	View of Trench
---------	----------------

Location:	Land to the rear of 20 Bishopgate, Norwich
District:	Norwich
Grid Ref.:	TG 2376 0895
HER No.:	51771
Dates of Fieldwork:	16 September 2008

Summary

On 16 September 2008 NAU Archaeology excavated an evaluation trench in order to assess the archaeological impact of drainage works on land to the rear of 20 Bishopgate, Norwich. This evaluation was carried out following the implementation of the drainage works and prior to new garages being built on the site. The deposits found in the trench consisted of make-up deposits. Further excavation of the trench had to be halted, as contaminated liquid and soils were encountered.

1.0 Introduction

The site was in an area of proposed new garages on land to the rear of 20 Bishopgate, Norwich, currently used for parking (Fig. 1). This site is situated c.350m to the east of the cathedral church of the Holy and Undivided Trinity and c.30m to the south of St Helen's Church, Bishopgate.

The evaluation trench measured 1.50m north–south by 1.50m east–west and was located to the south of 20 Bishopgate (Fig. 2). The drainage works in question were located immediately to the south of this trench.

This work was funded by Owen Bond Partnership on behalf of the Lower School, Norwich Cathedral.

This archaeological evaluation was undertaken to fulfil a planning condition requested by Dr Roland Harris, Norwich Cathedral Archaeologist in a brief dated 7 August 2008.

The site archive is currently held by NAU Archaeology and on completion of the project will be deposited with Norfolk Museums and Archaeology Service, following the relevant policy on archiving standards.

2.0 Observations

The south-western quarter of the evaluation trench was excavated to a maximum depth of 0.67m, at which level contaminated liquid and soil were found (Plate 1). Upon consultation with the Cathedral Archaeologist it was decided that, for health and safety reasons, no further excavation should take place.

The lowest deposit revealed in the trench was a brown peaty silty sand (01), which was probably a former garden soil (Figs 3 and 4). This deposit was of unknown depth and was overlain by a brown gravely sandy silt (02) (Figs 3 and 4). Deposit (02), which was observed to be 0.18m deep, was a make-up deposit for the current pea-shingle surface.

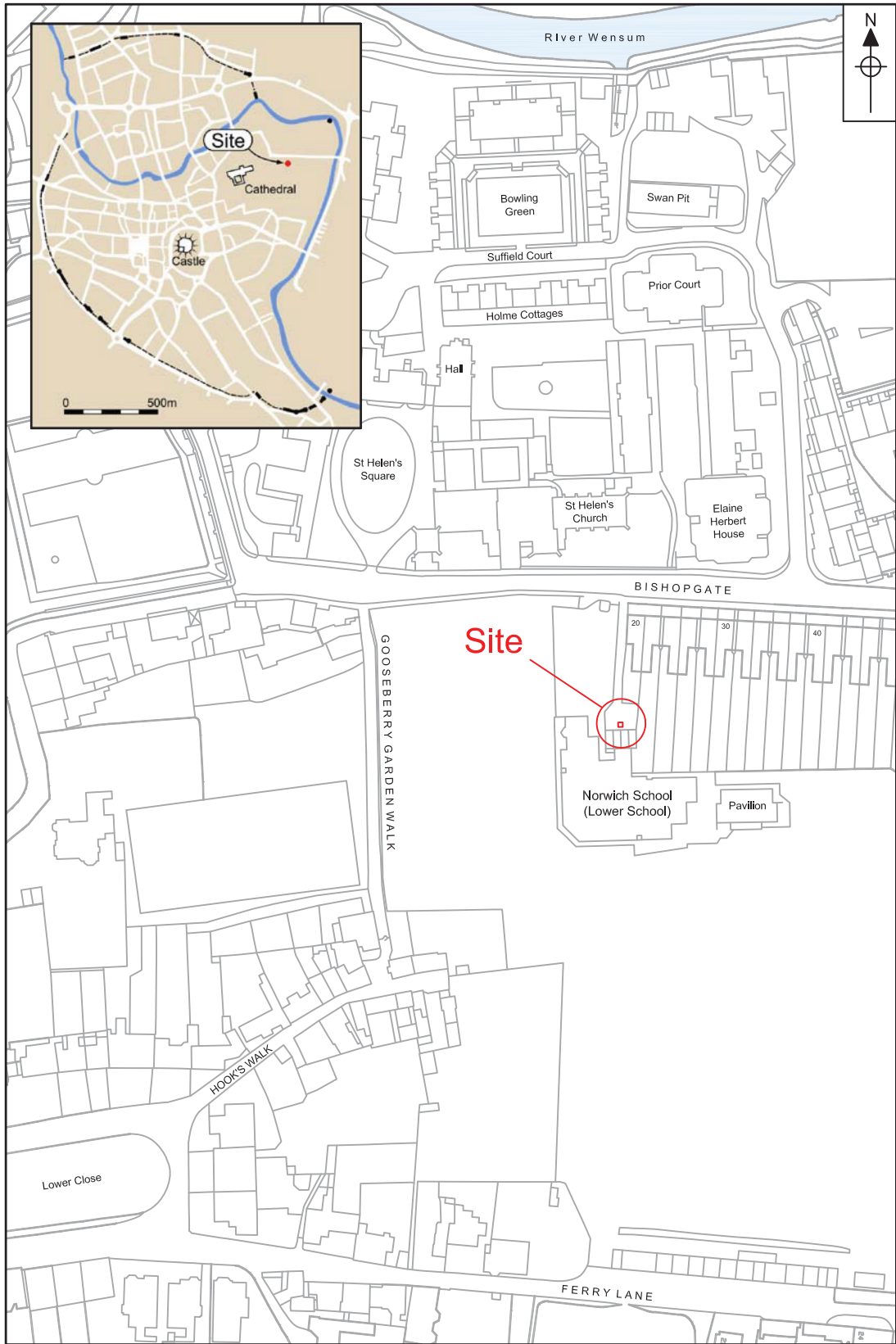

© Crown Copyright. All rights reserved. Local Authority No. 100019340



Figure 1. Site location. Scale 1:2000

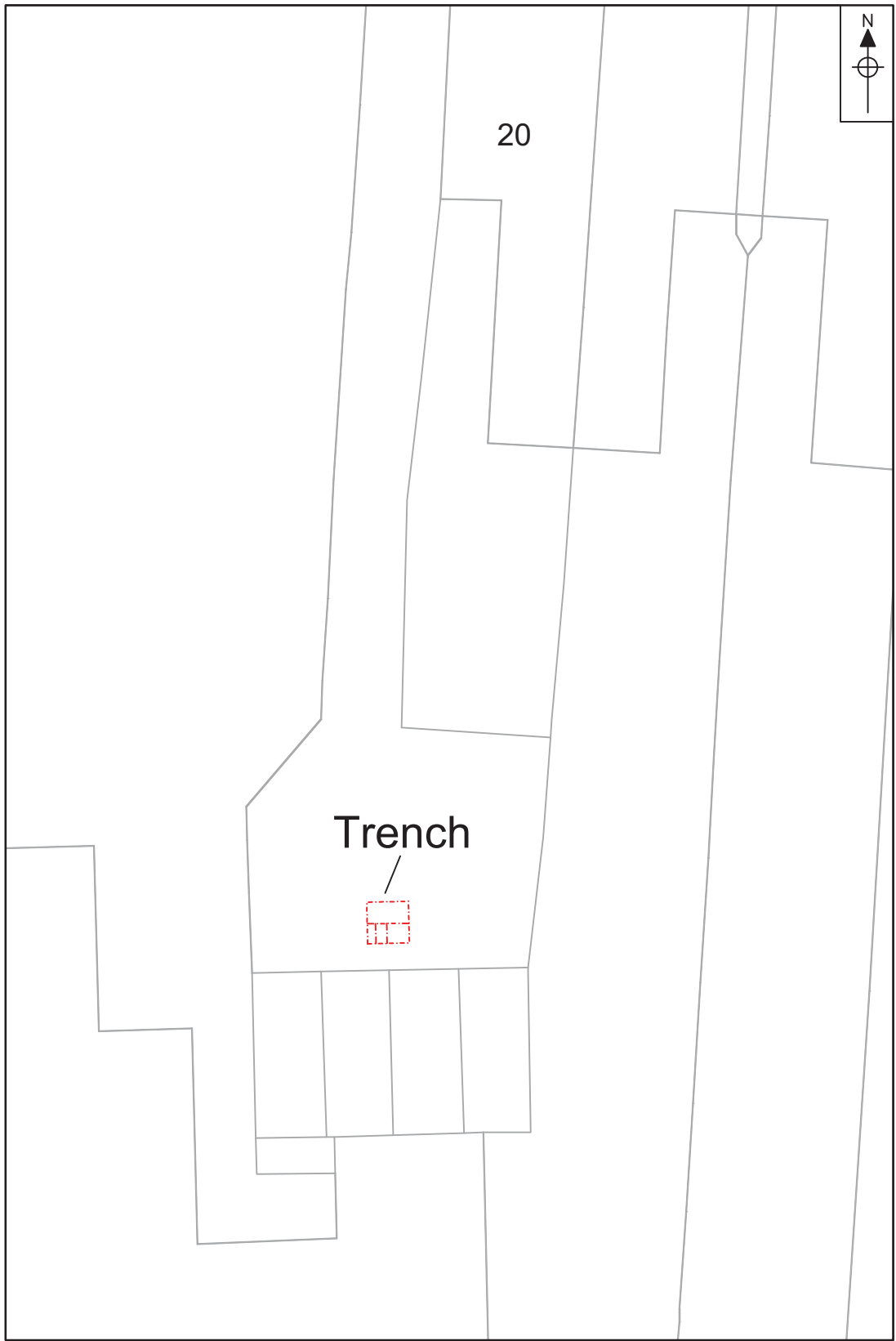

© Crown Copyright. All rights reserved. Local Authority No. 100019340



Figure 2. Trench location. Scale 1:200

3.0 Conclusions

The limited amount of information which could be gained from this trench suggested that no significant archaeological remains or deposits were disturbed during the recent drainage works.

Acknowledgements

This work was funded by Owen Bond Partnership on behalf of the Lower School, Norwich Cathedral. Fieldwork was carried out by John Ames and the author. This report was edited by Richard Hoggett and illustrated by David Dobson.

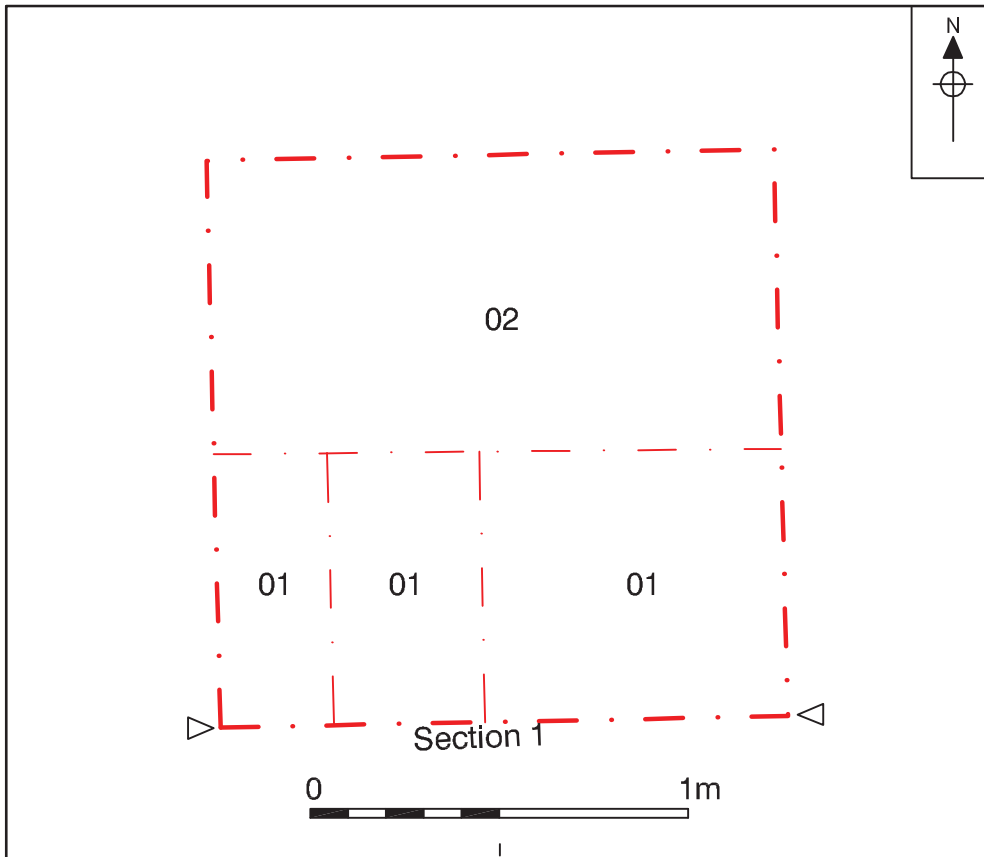

Fig. 3. Trench plan. Scale 1:20

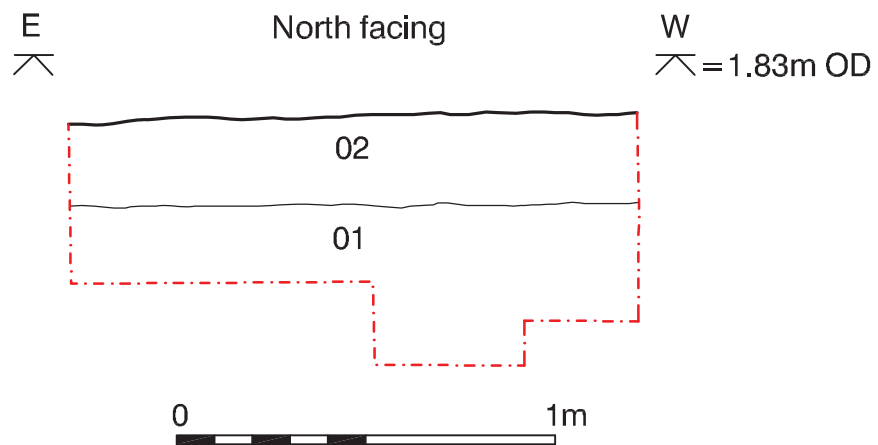

Fig. 4. Section 1. Scale 1:20



Plate 1. View of Trench

Appendix 1a: Context Summary

Context	Category	Description	Period
01	Deposit	Brown peaty silty sand	Post-medieval
02	Deposit	Brown gravely sandy silt	Post-medieval

Appendix 1b: OASIS feature summary table

Period	Feature type	Quantity
Post-medieval (1540 to 1900)	Deposit	2