

Report BAU2638



nau archaeology

An Archaeological Evaluation of Land between 74 and 76 Fitzgerald Road, Bramford, Suffolk

BRF084

Prepared for
Orwell Housing Association Limited
Crane Hill Lodge
325 London Road
Ipswich
IP2 0BE

Lilly Hodges BSc PlfA

January 2011



www.nps.co.uk

PROJECT CHECKLIST		
Project Manager	Nigel Page	
Draft Completed	Lilly Hodges	19/01/2011
Graphics Completed	David Dobson	25/01/2011
Edit Completed	Jayne Bown	27/01/2011
Signed Off	Nigel Page	27/01/2011
<i>Issue 1</i>		

NAU Archaeology

Scandic House
85 Mountergate
Norwich
NR1 1PY

T 01603 756150

F 01603 756190

E jayne.bown@nps.co.uk

www.nau.org.uk

BAU 2638

© NAU Archaeology

Contents

Summary 5

1.0 Introduction 5

2.0 Geology and Topography 5

3.0 Archaeological and Historical Background..... 5

4.0 Methodology 7

5.0 Results..... 9

6.0 Conclusions 10

Acknowledgements..... 11

Bibliography 11

Appendix 1: Context Summary 11

Figures

Figure 1 Site Location

Figure 2 Trench Location (1:250) and Section 1 (scale 1:20)

Plates

Plate 1 Post excavation view of trench looking north

Plate 2 Section 1 showing topsoil and subsoil, facing west

Location:	Land between 74 and 76 Fitzgerald Road, Bramford
District:	Mid Suffolk
Grid Ref.:	TM 122 461
HER No.:	BRF 084
OASIS Ref.:	92104
Client:	Orwell Housing Association
Dates of Fieldwork:	13 January 2011

Summary

An archaeological evaluation was conducted for Orwell Housing Association ahead of two proposed dwellings located between 74 and 76 Fitzgerald Road, Bramford, Suffolk.

The evaluation consisted of one 14m x 1.8m trench within the footprint of the proposed dwellings. No archaeologically significant finds or features were present.

1.0 INTRODUCTION

This work was undertaken to fulfil a planning condition set by Mid Suffolk District Council (Ref. 0572/10) and a Brief issued by Suffolk County Council (Ref. FitzgeraldRoadBramford_2010). The work was conducted in accordance with a Project Design and Method Statement prepared by NAU Archaeology (Ref. NAU/BAU2638/NP). This work was commissioned and funded by Orwell Housing Association Limited.

This programme of work was designed to assist in defining the character and extent of any archaeological remains within the proposed redevelopment area, following the guidelines set out in *Planning Policy Statement 5: Planning For The Historic Environment* (Communities and Local Government 2010). The results will enable decisions to be made by the Local Planning Authority about the treatment of any archaeological remains found.

The site archive is currently held by NAU Archaeology and on completion of the project will be deposited with the Suffolk County Council, following the relevant policies on archiving standards.

2.0 GEOLOGY AND TOPOGRAPHY

The underlying geology is glaciofluvial drift (sands and gravels) over chalk (www.bgs.ac.uk)

Bramford itself is bounded to the east by the River Gipping and to the west by the B1113. The site is situated just east of the B1113 on the north side of the east-west aligned Fitzgerald Road. It lies at some distance from the river at a height of c.10-15.00m OD in the south-west corner of the village (Fig. 1).

3.0 ARCHAEOLOGICAL AND HISTORICAL BACKGROUND

The site is located in Bramford just off Loraine Way (the B1113 Roman Road (BRF023)) which runs north-south immediately to the west of the village.

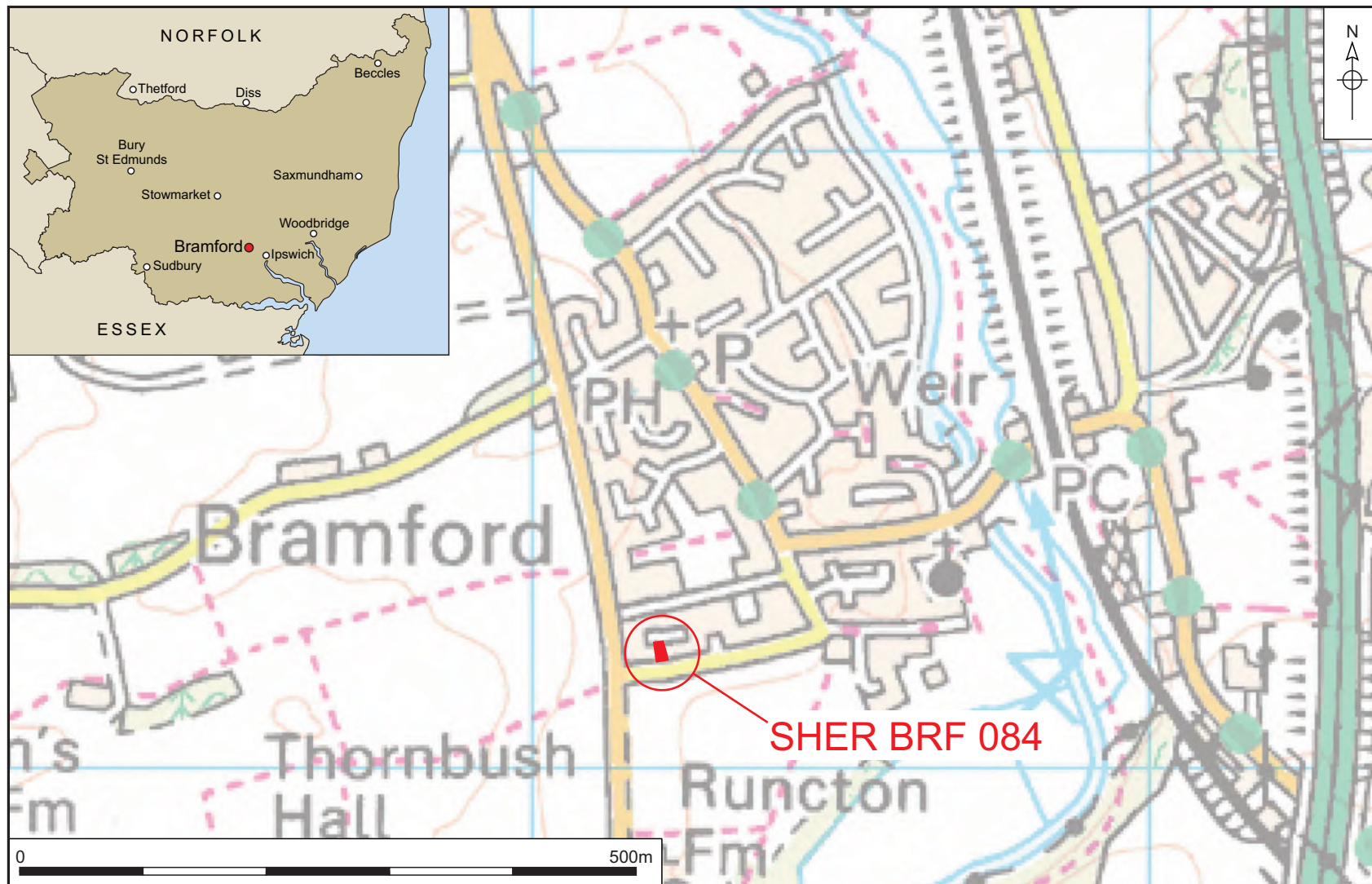

© Crown Copyright. All rights reserved. Local Authority No. 100019340

Figure 1. Site location. Scale 1:5000

Information held in the Suffolk Historic Environment Record indicates that the site has the potential to contain archaeological remains of Saxon through to post-medieval date, especially in the field bounded by Fitzgerald Road and Loraine Way to the south-east of the development site. A scatter of metal finds of Roman and Saxon date (BRF037) has been found in the north-east corner of this field and in its south-west corner a scatter of finds (BRF041) which include Saxon, medieval and post-medieval pottery and a post-medieval Nuremberg token is recorded.

4.0 METHODOLOGY

The objective of this evaluation was to determine as far as reasonably possible the presence or absence, location, nature, extent, date, quality, condition and significance of any surviving archaeological deposits within the development area.

The Brief required that a single 12m x 1.8m trench be excavated within the proposed footprint. The trench was extended for an additional 2m due to the presence of a water pipe which ran diagonally across the trench and necessitated a baulk of soil to remain to protect it (Fig. 1).

Machine excavation was carried out with a wheeled JCB-type excavator equipped with a toothless ditching bucket and operated under constant archaeological supervision.



Plate 1. Post excavation view of trench, looking north

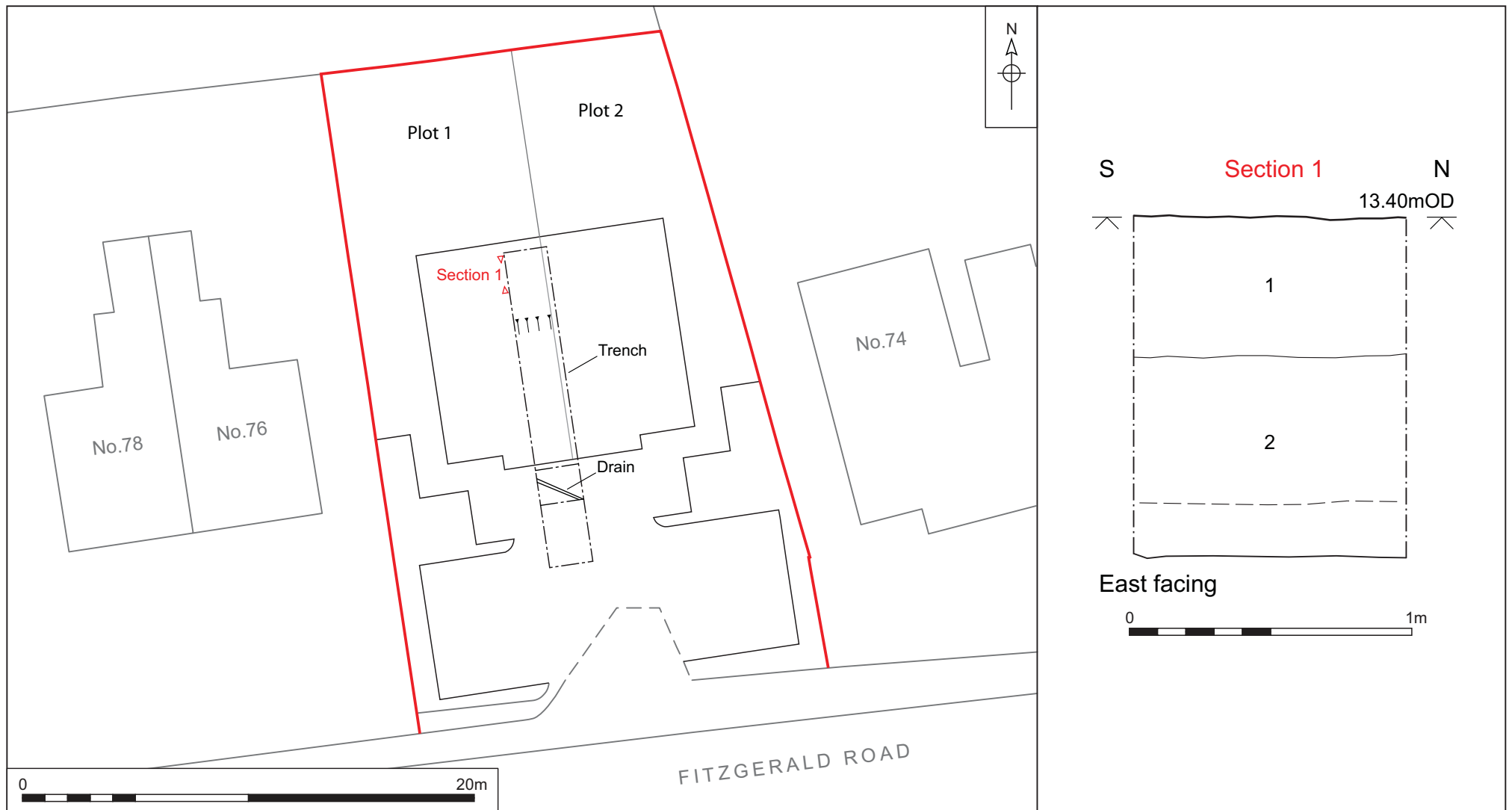

Figure 2. Trench location (scale 1:250) and Section 1 (scale 1:20)

Spoil was scanned with a metal-detector however no finds were recovered.

No environmental samples were taken due to absence of archaeological features.

All deposits were recorded using NAU Archaeology pro forma, plans and sections were recorded at appropriate scales. Monochrome and digital photographs were taken of the trench and deposits where appropriate.

The temporary benchmark used during the course of this work was transferred from an Ordnance Survey benchmark with a value of 12.8260m OD, located on the south-west side of 72 Fitzgerald Road.

Site conditions were good, with the work taking place in fine weather.

5.0 RESULTS

The trench was excavated to a depth of c.1.2m (Plate 1).

The topsoil [1] consisted of a dark greyish brown slightly clayey sandy silt c.0.5m deep. The subsoil [2] was a light brown slightly clayey sandy silt c.0.7m deep with a slightly sandier area of subsoil present c.0.2m deep at the base of the trench above the yellow sandy natural. The boundaries between these layers were fairly diffuse (Plate 2).



Plate 2. Section 1 showing topsoil and subsoil, facing west

At the north end of the trench was a small feature cut into the subsoil which contained a few jam jars, bottles and china of modern date. These finds were not retained and the feature was not recorded.

6.0 CONCLUSIONS

Despite the archaeological potential of the site based on the proximity of multi-period sites to the development site, no archaeologically significant finds or features were present within the evaluation trench.

Recommendations for future work based upon this report will be made by Suffolk County Council.

Acknowledgements

The author would like to thank Mark Tye of GB Digger Hire for the machining work and Colin Pendleton of Suffolk County Council for the provision of HER data.

The fieldwork was undertaken by the author and Pete Crawley. Graphics were completed by the author and David Dobson who also produced the report. The editing of this report was undertaken by Jayne Bown.

Bibliography

Communities and Local Government 2010 Planning Policy Statement 5: Planning for the Historic Environment (PPS5). TSO, Norwich

British Geological Survey <http://www.bgs.ac.uk/opengeoscience> accessed 19/01/11

Appendix 1: Context Summary

Context	Category	Cut Type	Fill Of	Description	Period
1	Deposit			Topsoil	Unknown
2	Deposit			Subsoil	Unknown