

# Rousay Drive, Aberdeen Archaeological Evaluation: Data Structure Report

OASIS No. aocarcha1-119554

AOC 21796

15<sup>th</sup> February 2012



ARCHAEOLOGY

HERITAGE

CONSERVATION

# Rousay Drive, Aberdeen Archaeological Evaluation: Data Structure Report

---

**On Behalf of:** Santon Group Developments Ltd, Tesco  
Stores Ltd and HSBC PLC  
c/o Goodson Associates,  
53 Melville Street  
Edinburgh  
EH3 7HL

**National Grid Reference (NGR):** NJ 8975 0658 (centred)

**Planning Application No:** 080701

**AOC Project No:** 21796

**Prepared by:** Rob Engl

**Illustration by:** Stefan Sagrott

**Date of Fieldwork:** 6<sup>th</sup> - 9<sup>th</sup> February 2012

**Date of Report:** 15<sup>th</sup> February 2012

**This document has been prepared in accordance with AOC standard operating procedures.**

**Author: Rob Engl**

**Date: 15th February 2012**

**Approved by: John Gooder**

**Date: 15th February 2012**

**Draft Report Stage:**

**Date: 15th February 2012**

**Enquiries to:** AOC Archaeology Group  
Edgefield Industrial Estate  
Edgefield Road  
Loanhead  
EH20 9SY

Tel. 0131 440 3593  
Fax. 0131 440 3422  
e-mail. [admin@aocarchaeology.com](mailto:admin@aocarchaeology.com)

---

## Contents

	<b>Page</b>
List of illustrations .....	3
Plates.....	3
List of appendices.....	3
Abstract.....	4
1 INTRODUCTION .....	5
2 OBJECTIVES .....	6
3 METHOD .....	6
4 RESULTS .....	6
5 CONCLUSION.....	7
6 REFERENCES .....	8
APPENDIX 1: TRENCH SUMMARIES .....	10
APPENDIX 2: PHOTOGRAPHIC REGISTER .....	13
APPENDIX 3: DISCOVERY AND EXCAVATION IN SCOTLAND REPORT .....	14

---

## List of illustrations

- Figure 1 Site location  
Figure 2 Trench Location

## Plates

- Plate 1: Trench 3  
Plate 2: Trench 10

## List of appendices

- Appendix 1 Trench Summaries  
Appendix 2 Photographic Register  
Appendix 3 *'Discovery and Excavation in Scotland'* Entry

## Abstract

---

A programme of archaeological works was required by Goodson Associates on behalf of Santon Group Developments Ltd, Tesco Stores Ltd and HSBC PLC in respect to a proposed supermarket development at Rousay Drive, Aberdeen. The development area consists of an urban site covering approximately 2.5 ha, which is currently unoccupied waste ground.

In total 13 trenches totalling 1100 m<sup>2</sup> metres were excavated. No archaeologically significant material was observed. The north-west of the site bordering the Lang Stracht appeared to be undisturbed agricultural land, with the remainder of the site being heavily truncated by previous building and demolition works.

# 1 INTRODUCTION

## 1.1 Project Background

1.1.1 A programme of archaeological works was required by Goodson Associates on behalf of Santon Group Developments Ltd, Tesco Stores Ltd and HSBC PLC in respect to a proposed supermarket development at Rousay Drive, Aberdeen. The development area consists of an urban site covering approximately 2.5 ha, which is currently unoccupied waste ground. The proposed development lies within the administrative area of Aberdeen City Council, which is advised on archaeological matters by Dr. Judith Stones, Keeper of Archaeology, Aberdeen City Council. A programme of archaeological works had been specified by Dr. Stones in keeping with the policies outlined in *Scottish Planning Policy (2010)* and *PAN 2/2011 Planning And Archaeology (2011)* in order to record the extent and significance of any archaeological remains which may be present within the development area.

## 1.2 Site Location

1.2.1 The development site lies to the west of the centre of Aberdeen immediately to the south of the main thoroughfare, A944 „Lang Stracht“. To the west lies „Rousay Drive“ with „Eday Road“ to the south. A built-up area, including Sheddocksley Baptist Church, lies to the east.

## 1.3 Archaeological background

1.3.1 The 1<sup>st</sup> Edition Ordnance Survey (OS) map of 1869 shows the site as greenfield with no development though the boundaries of the site are established at this point. The precursors of Lang Stracht, Rousay Drive and Eday Road are already prominent roads by the mid 19<sup>th</sup> century. On the western corner of Lang Stracht and Rousay road there is shown „Bonnymuir“ which consists of two large subdivided buildings forming a central courtyard. On the northern side of Lang Stracht opposite the site lies „Bonaccord Cottage“. With the exception of these two buildings, the development area and surrounding countryside are mostly farmland. The 2<sup>nd</sup> Edition OS map (1902) and the 1938 OS map show a similar rural picture, although by 1902-03 to the south of Eday Road, Oldmill Poorhouse was built which became the foundation of Woodend General Hospital.

1.3.2 Woodend Hospital is recorded in the Royal Commission for Ancient and Historical Monuments of Scotland (*NMRS NJ80NE 65*) with some of its earliest elements now B-Listed buildings. As the hospital grew throughout the mid 20<sup>th</sup> century an annexe building (*NMRS NJ80NE 65.08*) was constructed on the northern side of Eday Road within the proposed development area. This building is depicted on the 1959 OS map as series of three N-S aligned narrow buildings connected by a single E-W corridor. This main building was positioned towards the eastern edge of the development area. Two more narrow N-S aligned buildings lay to the south of the main building with a final building aligned along Eday Street in the SW corner of the development area. The 1964 OS map depicts an E-W line of trees and turning circle off Lang Stracht to the north of the main building. The OS maps of the 1970s and 1980s showed very little change. By the time of the 1990-95 OS map all of the Hospital Annexe buildings have been demolished and the development area is empty of structures.

## 2 OBJECTIVES

2.1 The objectives of the archaeological works were:

- i) to determine and assess the character, extent, condition, quality, date and significance of any buried archaeological remains within the proposed development area through evaluation trenching;
- ii) to advise and implement an appropriate form of mitigation, such as excavation, post-excavation analyses and publication, given the infeasibility of preserving the archaeological material *in situ*, should significant archaeological remains be encountered.

## 3 METHOD

- 3.1 The *Written Scheme of Investigation* (AOC 2012) proposed the excavation of trenches equating to a 5% sample of the development area. The site covered approximately 2.5 ha resulting in evaluation trenching with a total basal area of 1,250 m<sup>2</sup>. The thirteen trenches excavated correspond to a little under the 5% sample specified in the *Written Scheme of Investigation* due to the trench locations being altered slightly from the trench location provided with the WSI, due to the presence of utility services, areas of substantial hard standing and pathways.
- 3.2 All trenches were excavated with a nine tonne wheeled excavator using a 2.0 m wide ditching bucket. The trench details are summarised in Appendix 1. Machine excavation was conducted in shallow units/spits through topsoil/overburden to the upper surface of the underlying geological deposits. The evaluation trial trenching was undertaken according to AOC Archaeology Group's standard operating procedures as detailed with the *Written Scheme of Investigation* (AOC 2012).

## 4 RESULTS

- 4.1 The works were conducted between 6<sup>th</sup> and 9<sup>th</sup> February 2012. The weather conditions during the evaluation were cold and dry. Overall archaeological visibility was good. In total thirteen trenches were opened totalling 1100 m<sup>2</sup> (Figure 2).
- 4.2 In general the proposed development was covered by a thin layer of rich silty imported topsoil, between 0.20 m and 0.35 m in depth. The natural subsoil comprised a pale green and orange sandy clay, which in turn directly overlay a light greenish/blue boulder clay.
- 4.3 Within the north-west of the site original agricultural deposits were observed, and a narrow 0.05 m interface between the topsoil and subsoil was in evidence. This was disturbed in places by several large demolition pits (Plate 1).



**Plate 1: Trench 3**

- 4.4 In approximately two thirds of the site the original topsoil had been removed to natural subsoil and replaced with madeground and demolition material (Plate 2). Through the middle of the development area, truncation had removed the subsoil boulder clay to a depth of 1.2 m. Two rubble drains representing agricultural activity were revealed within Trench 1 and Trench 13.



**Plate 2: Trench 10**

- 4.5 No significant archaeological features or unstratified artefacts were identified by the evaluation.

## **5 CONCLUSION**

- 5.1 The evaluation demonstrated considerable truncation deriving from previous building works, demolition activity and subsequent site levelling had occurred across the majority of the site. Again



where the original agricultural soils survived in the north-west of the development area no archaeological presence was observed. Scanning of the spoil arisings from the evaluation trenches failed in identifying any residual artefactual material. The significant balance of probability is that the development area is archaeologically sterile. As no significant archaeological features or artefacts were identified it is recommended that no further archaeological works are required. These recommendations will require confirmation by the Keeper of Archaeology, archaeological advisor to the City of Aberdeen Council.

## 6 REFERENCES

Dunbar, L. 2012 *Tesco Woodend, Aberdeen: Archaeological Evaluation Written Scheme of Investigation* AOC Archaeology Client Report

Scottish Government 2010 *Scottish Planning Policy*.

Scottish Government 2011 *2/2011 Planning and Archaeology*.

.

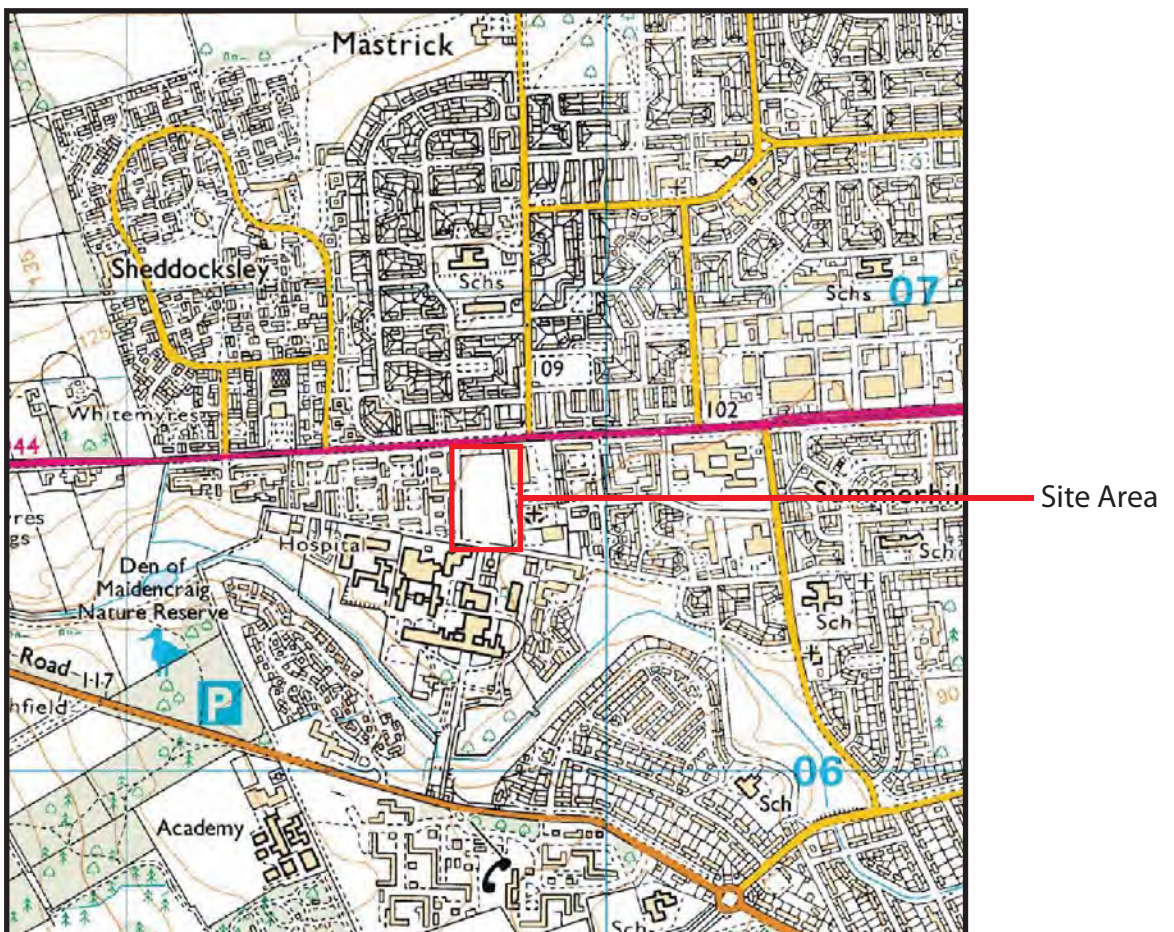
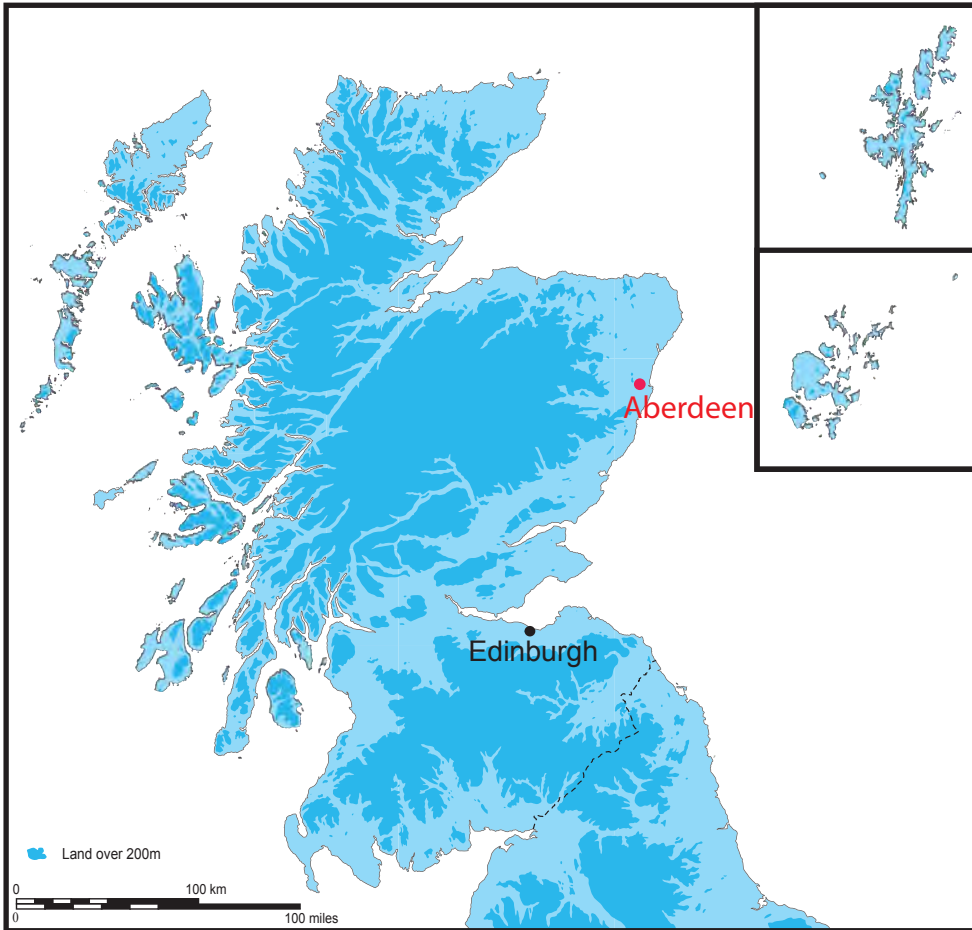

Reproduced from the Ordnance Survey 1:25 000 scale map with the permission of the controller of Her Majesty's Stationary Officer. Crown Copyright.  
 AOC Archaeology Group, Edgefield Industrial Estate, Loanhead, Midlothian, EH20 9SY  
 OS License No.: 100016114

Figure 1: Location of the site at Rousay Drive, Aberdeen

Figure 2: Evaluation trench layout at Rousay Drive, Aberdeen

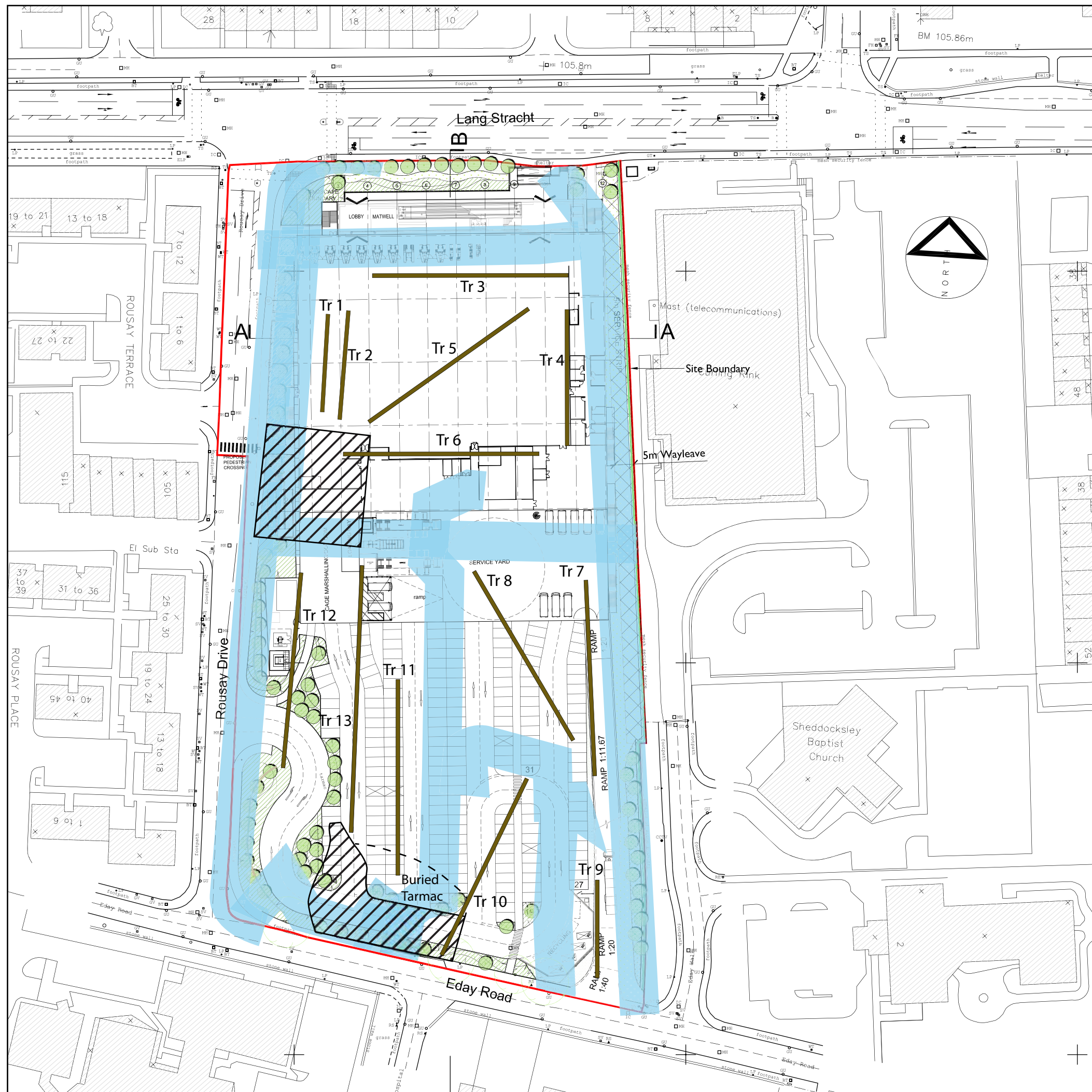

- Service Buffer
- Evaluation Trench
- Area of handstanding

10m 0 20m

Based on a drawing supplied by the client

# **Rousay Drive, Aberdeen: Archaeological Evaluation Data Structure Report**

## **Section 2: Appendices**

## APPENDIX 1: TRENCH SUMMARIES

### Trench 1

Dimensions	24 m by 2.0 m
Orientation	N-S
Depth of Topsoil	0.20 m to 0.30 m
Features	None
Drains	Rubble x 1 (E/W)
Subsoil	Light green and orange sandy clay
Finds	None

### Trench 2

Dimensions	27 m by 2.0 m
Orientation	N-S
Depth of Topsoil	0.20 m to 0.4 m
Features	None
Drains	None
Subsoil	Light green and orange sandy clay
Finds	None

### Trench 3

Dimensions	49 m by 2.0 m
Orientation	E-W
Depth of Topsoil	0.12 m to 0.25 m
Made Ground	0.30 m to 1.1 m
Features	Demolition pits x 3.
Drains	None
Subsoil	Light green and orange sandy clay
Finds	None

### Trench 4

Dimensions	30 m by 2.0 m
Orientation	N-S
Depth of Topsoil	0.11 m to 0.14 m
Made Ground	0.5m (+)
Features	None
Drains	None
Subsoil	Light green and orange sandy clay
Finds	None

### Trench 5

Dimensions	50 m by 2.0 m
Orientation	NE-SW
Depth of Topsoil	0.19 m to 0.27 m
Features	None
Subsoil	Light green and orange sandy clay
Finds	None

**Trench 6**

Dimensions	50 m by 2.0 m
Orientation	E-W
Depth of Topsoil	0.22 m to 0.27 m
Made Ground	0.7 m to 0.79 m
Features	None
Drains	None
Subsoil	Light green and orange sandy clay
Finds	None

**Trench 7**

Dimensions	50 m by 2.0 m
Orientation	N-S
Depth of Topsoil	0.08 m
Made Ground	0.53 m
Features	Dead BT cable 29.0 m from north end of trench
Drains	None
Subsoil	Light green and orange sandy clay
Finds	None

**Trench 8**

Dimensions	50 m by 2.0 m
Orientation	NW-SE
Depth of Topsoil	0.08 m to 0.69 m
Made Ground	0.65 m
Features	None
Drains	None
Subsoil	Light green and orange sandy clay
Finds	None

**Trench 9**

Dimensions	25 m by 2.0 m
Orientation	N-S
Depth of Topsoil	0.23 m
Made Ground	0.80 m
Features	Ceramic pipe and brick cistern
Drains	None
Subsoil	Light green and orange sandy clay
Finds	None

**Trench 10**

Dimensions	35 m by 2.0 m
Orientation	NE-SW
Depth of Topsoil	0.22 m
Made Ground	0.44 m to 0.67 m

Features	None
Drains	None
Subsoil	Light green and orange sandy clay
Finds	None

### Trench 11

Dimensions	50 m by 2.0 m
Orientation	N-S
Depth of Topsoil	0.10 m to 0.17 m
Made Ground	0.69 m to 1.1 m
Features	None
Drains	None
Subsoil	Light green boulder clay
Finds	None

### Trench 12

Dimensions	60 m by 2.0 m
Orientation	N-S
Depth of Topsoil	0.16 m to 0.5 m
Made Ground	0.25 m to 0.44 m
Features	None
Drains	None
Subsoil	Light green and orange sandy clay
Finds	None

### Trench 13

Dimensions	55 m by 2.0 m
Orientation	N-S
Depth of Topsoil	0.16 m to 0.55 m
Made Ground	0.60 m to 0.80 m
Features	None
Drains	Rubble drain x 1; Clay drain x 1
Subsoil	Light green and orange sandy clay
Finds	None

## APPENDIX 2: PHOTOGRAPHIC REGISTER

### Black & White Print Film 1 & Digital

Frame	Trench	Description	From
1-2	-	Registration	-
3-4	T1	T1 (Post-ex)	S
5	T2	T2 (Post-ex)	S
6		General shot of site (SE corner)	SW
7		General shot of site (South)	S
8		General shot of site (North)	S
9	T3	T3 (Post-ex)	W
10	T4	BT cable in N end of trench	NE
11	T4	T4 (Post-ex)	N
12	T5	T5 (Post-ex)	NE
13	T6	T6 (Post-ex)	W
14	T7	T7 (Post-ex)	N
15	T7	Cables in trench	W
16	T8	T8 (Post-ex)	N
17	T9	T9 (Post-ex)	S
18	T10	T10 (Post-ex)	NE
19	T11	T11 (Post-ex)	N
20	T12	T12 (Post-ex)	N
21	T13	T13 (Post-ex)	N
22-25	-	General shots of area post-ex	Var



**APPENDIX 3: DISCOVERY AND EXCAVATION IN SCOTLAND REPORT**

<b>LOCAL AUTHORITY:</b>	Aberdeen City Council
<b>PROJECT TITLE/SITE NAME:</b>	Rousay, Drive, Aberdeen
<b>PROJECT CODE:</b>	AOC 21796
<b>PARISH:</b>	Aberdeen
<b>NAME OF CONTRIBUTOR:</b>	Rob Engl
<b>NAME OF ORGANISATION:</b>	AOC Archaeology Group
<b>TYPE(S) OF PROJECT:</b>	Archaeological Evaluation
<b>NMRS NO(S):</b>	None
<b>SITE/MONUMENT TYPE(S):</b>	None
<b>SIGNIFICANT FINDS:</b>	None
<b>NGR (2 letters, 6 figures)</b>	NJ 8975 0658
<b>START DATE (this season)</b>	6 <sup>th</sup> February 2012
<b>END DATE (this season)</b>	9 <sup>th</sup> February 2012
<b>PREVIOUS WORK (incl. DES ref.)</b>	None
<b>MAIN (NARRATIVE) DESCRIPTION:</b> (May include information from other fields)	<p>An archaeological evaluation was required by prior to a proposed supermarket development at Rousay, Drive, Aberdeen. The development area consisted of urban unoccupied waste ground.</p> <p>In total 13 trenches totalling 1100 m<sup>2</sup> were excavated during the course of the evaluation. No archaeologically significant material was observed. The north-west of the site bordering the Lang Stracht appeared to be relatively undisturbed former agricultural ground, with the remainder of the site being heavily truncated by previous building and demolition works.</p>
<b>PROPOSED FUTURE WORK:</b>	None
<b>CAPTION(S) FOR ILLUSTRS:</b>	n/a
<b>SPONSOR OR FUNDING BODY:</b>	Santon Group Developments Ltd, Tesco Stores Ltd and HSBC PLC, c/o Goodson Associates, 53 Melville Street, Edinburgh, EH3 7HL
<b>ADDRESS OF MAIN CONTRIBUTOR:</b>	AOC Archaeology Group; Edgefield Road Industrial Estate; Loanhead, Midlothian, EH20 9SY
<b>EMAIL ADDRESS:</b>	Rob.engl@aocarchaeology.com
<b>ARCHIVE LOCATION</b>	Archive to be deposited in NMRS



**AOC Archaeology Group**, Edgefield Industrial Estate, Edgefield Road, Loanhead EH20 9SY  
tel: 0131 440 3593 | fax: 0131 440 3422 | e-mail: [edinburgh@aocarchaeology.com](mailto:edinburgh@aocarchaeology.com)

[www.aocarchaeology.com](http://www.aocarchaeology.com)