

Altyre Dairy Agricultural Building, Forres, Moray: Archaeological Monitored Topsoil Strip Report

AOC 22472
Oasis No.1-154908
July 2013

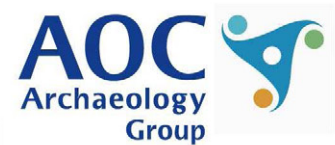
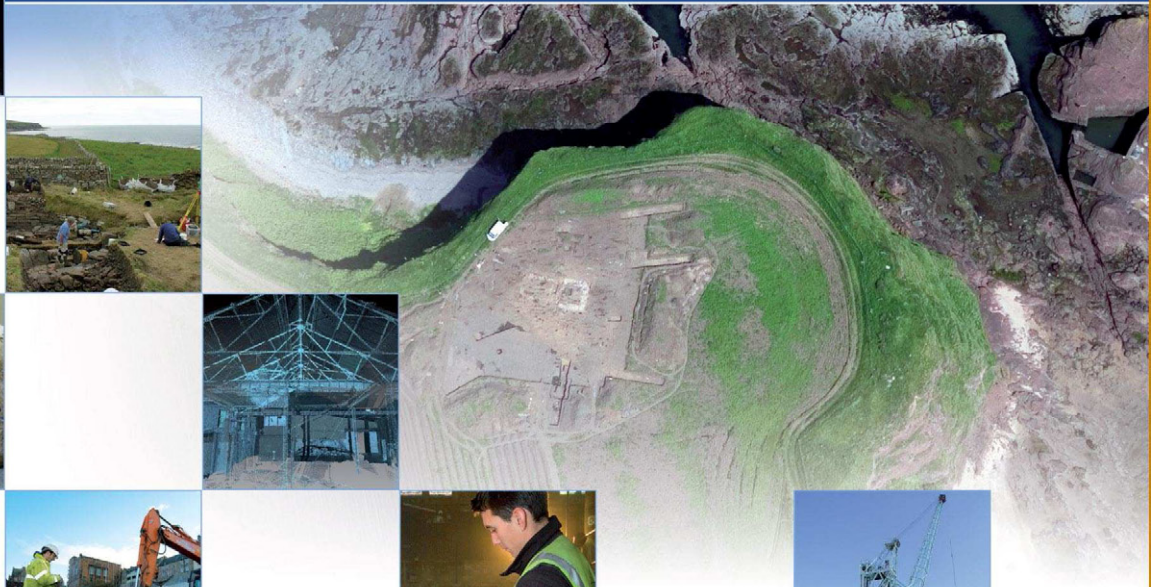

ARCHAEOLOGY

HERITAGE

CONSERVATION

Altyre Dairy Agricultural Building, Forres, Moray: Archaeological Monitored Topsoil Strip Report

On Behalf of: Grant & Geoghegan

National Grid Reference (NGR): NJ 0343 5456

AOC Project No: 22472

Prepared by: Rob Engl

Illustration by: Diana Sproat

Date of Fieldwork: 10th July 2013

Date of Report: 17th July 2013

This document has been prepared in accordance with AOC standard operating procedures.

Author: R Engl

Date: 17th July 2013

Approved by: M Cook

Date: 19th July 2013

Draft/Final Report Stage: Draft

Date: 19th July 2013

Enquiries to: AOC Archaeology Group
Edgefield Industrial Estate
Edgefield Road
Loanhead
EH20 9SY

Tel. 0131 440 3593
Fax. 0131 440 3422
e-mail. edinburgh@aocarchaeology.com



Contents

	Page
List of illustrations	2
List of plates	2
List of appendices	2
Abstract	3
0 NON TECHNICAL SUMMARY	4
1 INTRODUCTION	4
1.1 Project Background	4
1.2 Curatorial control	4
1.3 Site Location.....	4
1.4 Archaeological Background.....	4
2 OBJECTIVES	5
3 METHOD	5
4 RESULTS	5
4.1 Introduction.....	5
4.2 Overview	6
5 CONCLUSION	6
6 REFERENCES	7
APPENDIX 1: PHOTOGRAPHIC REGISTER	9
APPENDIX 2: 'DISCOVERY AND EXCAVATION IN SCOTLAND' REPORT	10

List of illustrations

Figure 1: Site Location

Figure 2: Area of Monitored Topsoil Strip

List of plates

Plate 1: Western Area of Site during Monitored Topsoil Stripping from North-east

Plate 2: Site during Monitored Topsoil Stripping from West

List of appendices

Appendix 1: Photographic Register

Appendix 2: *'Discovery and Excavation in Scotland'* Report

Abstract

An archaeological monitored topsoil strip was required by Grant and Geoghegan on behalf of their client Altyre Estate as a condition of planning consent (13/00629/APP) on ground breaking works associated with the construction of a new dairy shed at the Altyre Estate, Forres, Moray (NGR: NJ 034 544). The scope of the works was determined by Moray Council as advised by Aberdeenshire Council Archaeology Service (ACAS), in keeping with the policies outlined in SPP (2010) and PAN 2/2011 Planning and Archaeology (Scottish Government 2011).

The removal of introduced topsoil and made ground up to 0.70 metres in depth across the development area revealed neither significant archaeological features nor artefactual material.

No further works are recommended.

0 NON TECHNICAL SUMMARY

- 0.1 An archaeological monitored topsoil strip was required by Grant and Geoghegan on behalf of their client, Altyre Estate, at the site of a proposed new dairy shed at Altyre Estate, Forres, Moray. The work was required in response to a planning condition set by Moray Council, who are advised on archaeological matters by the Aberdeenshire Council Archaeology Service (ACAS). The archaeological works required were in accord with *Scottish Planning Policy* (Scottish Government 2010) and PAN 2/2011 Planning and Archaeology (Scottish Government 2011).

1 INTRODUCTION

1.1 Project Background

- 1.1.1 An archaeological monitored topsoil strip was required by Grant and Geoghegan on behalf of their client Altyre Estate at the site of a proposed new dairy shed at Altyre Estate, Forres, Moray. The work was required in response to a planning condition set by Moray Council, who are advised on archaeological matters by the Aberdeenshire Council Archaeology Service (ACAS). The archaeological works required were in accord with *Scottish Planning Policy* (Scottish Government 2010) and PAN 2/2011 Planning and Archaeology (Scottish Government 2011).

1.2 Curatorial Control

- 1.2.1 This programme of works was designed to fully satisfy the requirements of Moray Council, as advised on archaeological matters by ACAS. The *Written Scheme of Investigation* (AOC 2013) outlined the entirety of the archaeological programme of work needed to mitigate the effects of the proposed development; it detailed principally the methodology to be employed in implementing the archaeologically monitored topsoil strip.

1.3 Site Location

- 1.3.1 The proposed development is located on agricultural land partially within a former walled garden associated with the now removed Altyre House (NMRS: NJ05SW 4) The site is bounded to the south by an existing farmyard. The site is centred on NGR c.NJ 0343 5456.

1.4 Archaeological Background

- 1.4.1 The Royal Commission on Ancient and Historical Monuments of Scotland (RCAHMS) does not list any known archaeological sites within the development boundaries. However, the site is located within the grounds of the Altyre Estate, the family estate of the Cumming Clan. The original location of the estate house, Altyre House, lies to the immediate north-east of the proposed development. The house (NMRS: NJ05SW 4) was demolished in 1962. This building was replaced by a second estate house,

designed by WL Carruthers and built in 1895. Originally built as a parsonage, the manse residence associated with the near by Episcopal chapel, the house was enlarged and renamed Altyre House in 1931.

- 1.4.2 More generally, the Altyre Estate contains a series of buildings and structures associated with the later reconstruction and re-development of the estate including the stables (NMRS: NJ05SW 4.01), the kennels (NMRS: NJ05SW 4.01), the walled garden (NMRS: NJ05SW 4.02), the gardeners cottage (NMRS: NJ05SW 4.03 and (NMRS: NJ05SW 4.04), the old stables (NMRS: NJ05SW 4.05), the generator house (NMRS: NJ05SW 4.06) and the west lodge (NMRS: NJ05SW 4.07).

2 OBJECTIVES

- 2.1 The objectives of the Archaeological Monitored Topsoil Strip were:
- i) to safeguard the archaeological resource that may be disturbed by the proposed development works;
 - ii) given the discovery of significant archaeological material that will suffer an adverse impact from the development (ie, where preservation *in-situ* is impractical), the recording of all archaeological features by means of a mitigation strategy to be formulated with ACAS.

3 METHOD

- 3.1 The ground breaking works were carried out by means of a Mechanical Digger equipped with a toothless ditching bucket. Excavation was in shallow units/spits. All machine excavation was supervised by an experienced field archaeologist.
- 3.2 The proposed building plot is partially covered by an existing concrete foundation. This foundation will be retained and form part of the floor of the new building, with the topsoil around the concrete to be stripped to formation level.

4 RESULTS

4.1 Introduction

- 4.1.1 The Monitored Topsoil Strip was carried out under dry weather conditions on the 10th July 2013.

4.1.2 The various data gathered from the monitored top-soil strip are presented as a series of appendices:

Appendix 1 contains the photographic register;

Appendix 2 reproduces the '*Discovery & Excavation in Scotland*' entry.

4.2 Overview

4.2.1 The monitored topsoil strip incorporated a rectangular block of land approximately 20.0 m by 10.0 m in area. This was crossed east to west by a post and wire fence.

4.2.2 The area north of the fence is currently a ploughed field and appears to partially lie within a former walled garden. A mixed deposit of imported topsoil and made ground was revealed ranging from 0.40 m to 0.70 m in depth. This in turn overlay a natural of orange sands and gravels. No archaeologically significant material was revealed.

4.2.3 The area to the south of the wire fence bordered onto an existing concrete platform. This revealed an imported topsoil 0.30 m in depth. Again, no archaeologically significant material was revealed.



Plate 1. Western area of site during Monitored Topsoil Stripping from north-east

5 CONCLUSION

5.1 No significant archaeological deposits were revealed. It would appear that previous construction and demolition phases associated with the estate have removed the

original topsoil and replaced it with a mixed deposit consisting of made ground and imported garden soil.



Plate 2. Site during Monitored Topsoil Stripping from west

- 5.2 No further archaeological works are recommended. This recommendation will require ratification by ACAS on behalf of Moray Council.

6 REFERENCES

AOC 2013 *Altyre Dairy Agricultural Building, Forres, Moray; Written Scheme of Investigation*, Unpubl AOC Archaeology Client Report

Scottish Government 2010 *Scottish Planning Policy*.

Scottish Government 2011 *PAN 2/2011 Planning and Archaeology*.

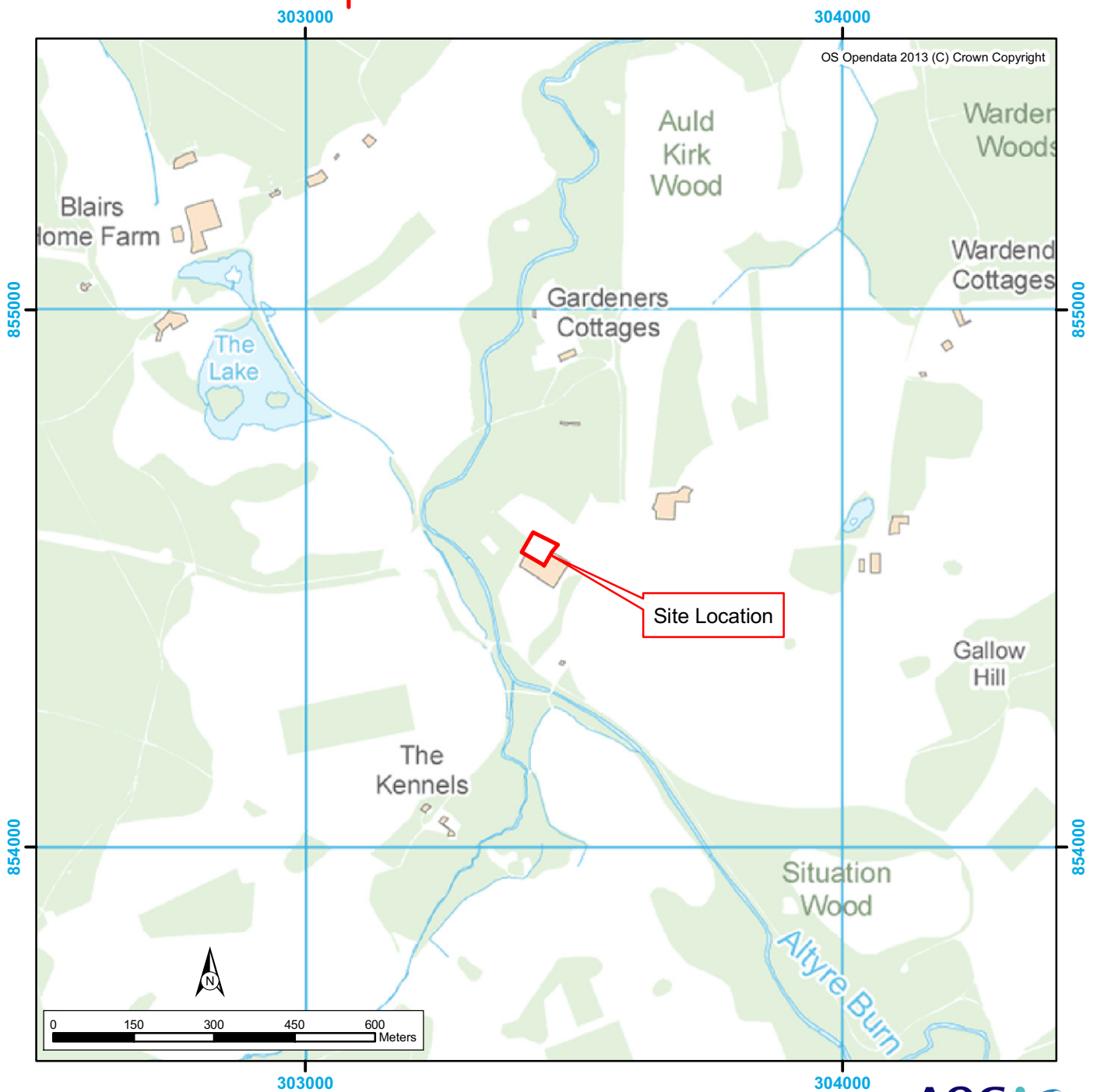
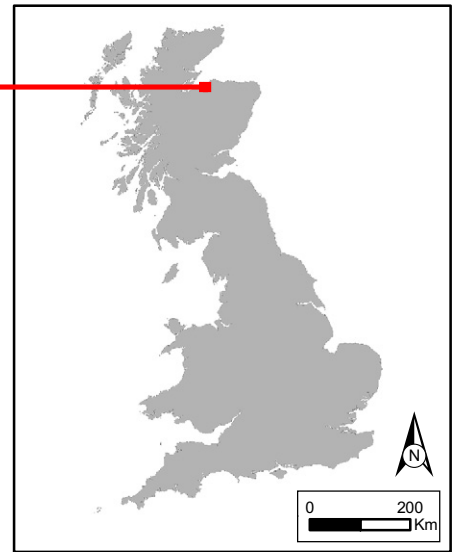
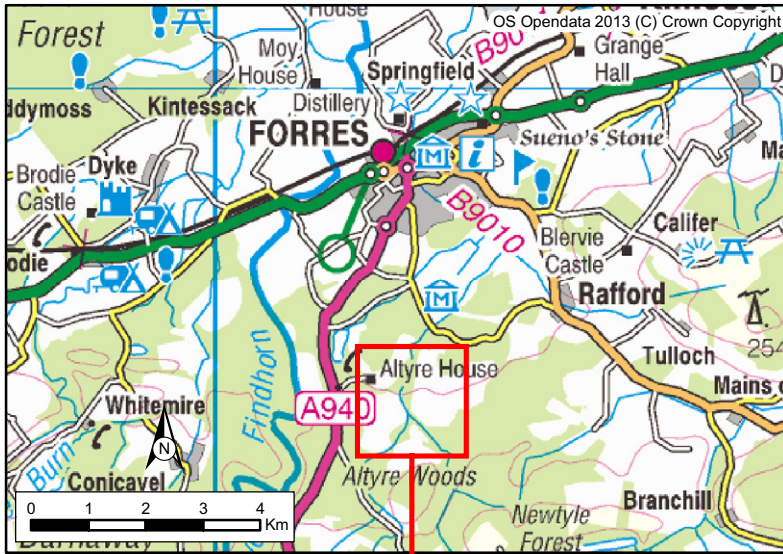

Figure 1: Site location plan



Figure 2: Site plan (provided by client) showing location of watching brief area

Altyre Dairy Agricultural Building, Forres, Moray: Archaeological Monitored Topsoil Report

Section 2: Appendices

APPENDIX 1: PHOTOGRAPHIC REGISTER

APPENDIX 1: PHOTOGRAPHIC REGISTER

Film 1 Digital

Frame	Description	From
1	Registration	
2	Working shot during topsoil stripping of north-eastern area	NE
3	Working shot during topsoil stripping of north-eastern area	N
4-5	Working shot during topsoil stripping	W
6-7	South-eastern corner post-excavation	NE
8	Post-excavation view of development area	W

APPENDIX 2: DISCOVERY AND EXCAVATION IN SCOTLAND REPORT

LOCAL AUTHORITY:	Moray Council
PROJECT TITLE/SITE NAME:	Altyre Dairy Agricultural Building, Forres, Moray; Monitored Topsoil strip
PROJECT CODE:	22472
PARISH:	Moray
NAME OF CONTRIBUTOR:	Rob Engl
NAME OF ORGANISATION:	AOC Archaeology Group
TYPE(S) OF PROJECT:	Monitored Topsoil Strip
NMRS NO(S):	None
SITE/MONUMENT TYPE(S):	None
SIGNIFICANT FINDS:	None
NGR (2 letters, 6 figures)	NJ 0343 5456
START DATE (this season)	10 th July 2013
END DATE (this season)	10 th July 2013
PREVIOUS WORK (inc DES)	None
MAIN (NARRATIVE) DESCRIPTION: (May include information from other fields)	<p>An archaeological monitored topsoil strip was required as a condition of planning consent (13/00629/APP) on ground breaking works associated with the construction of a new dairy shed at the Altyre Estate, Forres, Moray (NGR: NJ 0343 5456).</p> <p>The removal of introduced topsoil and made ground up to 0.70 metres in depth across the development area revealed neither significant archaeological features nor artefactual material. No further works are recommended.</p>
PROPOSED FUTURE WORK:	None
CAPTION(S) FOR ILLUSTRATIONS:	N/A
SPONSOR OR FUNDING BODY:	Grant & Geoghegan
ADDRESS OF MAIN CONTRIBUTOR:	AOC Archaeology Group
EMAIL ADDRESS:	admin@aocarchaeology.com
ARCHIVE LOCATION	Archive to be deposited in NMRS

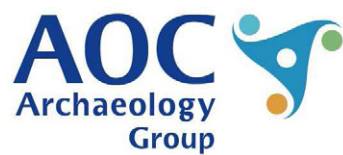
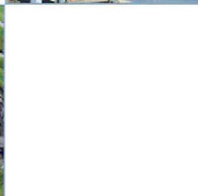
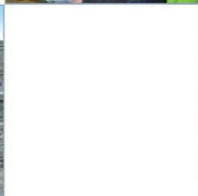
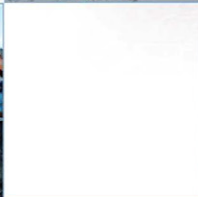
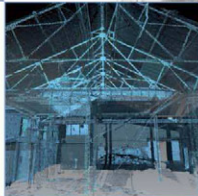
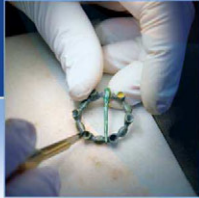

AOC Archaeology Group, Edgefield Industrial Estate, Edgefield Road, Loanhead EH20 9SY
tel: 0131 440 3593 | fax: 0131 440 3422 | e-mail: edinburgh@aocarchaeology.com

www.aocarchaeology.com