

Land at West Edinburgh, known as Land East of Millburn Tower, Edinburgh: Archaeological Evaluation Data Structure Report

AOC Project 22984
19th November 2015

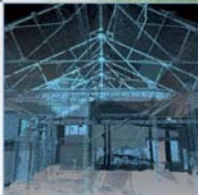

AOC
Archaeology
Group 

ARCHAEOLOGY

HERITAGE

CONSERVATION

Land at West Edinburgh, known as Lands East of Millburn Tower, Edinburgh: Archaeological Evaluation Report

On Behalf of:	Murray Estates Lothian Limited
National Grid Reference (NGR):	NT 17393 71826 (centre)
AOC Project No:	22984
OASIS No:	1-230781
Prepared by:	Rob Engl & Stuart Wilson
Illustration by:	Lisa Bird
Date of Fieldwork:	26 th October – 13 th November 2015
Date of Report:	19 th November 2015

This document has been prepared in accordance with AOC standard operating procedures.

Author: Rob Engl

Date: 16th November 2015

Approved by: Diana Sproat

Date: 19th November 2015

Draft/Final Report Stage: Draft

Date: 19th November 2015

Enquiries to: AOC Archaeology Group
Edgefield Industrial Estate
Edgefield Road
Loanhead
EH20 9SY

Tel. 0131 440 3593
Fax. 0131 440 3422
e-mail. admin@aocarchaeology.com



Contents

Page

List of Figures	1
List of Plates	1
List of Appendices	1
Summary	2
1 INTRODUCTION	3
1.1 Site Background.....	3
1.2 Site Location	3
1.3 Archaeological background (Based on AOC Archaeology DBA).....	3
2 OBJECTIVES	5
3 METHODOLOGY	5
4 RESULTS	5
5 CONCLUSIONS & RECOMMENDATIONS	9
6 REFERENCES	9
APPENDIX 1: Trench Descriptions	11
APPENDIX 2: Photographic Record	29
APPENDIX 3: Context Register	33
APPENDIX 4: Sample Register.....	34
APPENDIX 5: Drawing Register	35
APPENDIX 6: Small Finds Register	35
APPENDIX 7: 'Discovery and Excavation in Scotland' Report.....	36

List of Figures

- Figure 1: Site Location plan
- Figure 2: Site plan showing location of evaluation trenches
- Figure 3: Plan of Linear [2301]
- Figure 4: East facing section of linear [2301]
- Figure 5: Plan of Linear [2601]
- Figure 6: North-east facing section of linear [2601]
- Figure 7: Plan of linear [5101]
- Figure 8: West facing section linear [5105]
- Figure 9: Plan of linear [5501]
- Figure 10: East facing section linear [5501]
- Figure 11: Plan of linear [5901]
- Figure 12: North facing section linear [5901]
- Figure 13: Plan of pits [7101] and [7103]
- Figure 14: South facing section of pit [7101]
- Figure 15: West facing section of pit [7103]
- Figure 16: Plan and sections of ring ditch [8301]

List of Plates

- Plate 1: West facing section Ditch [2301]
- Plate 2: SW facing section Ditch [2601]
- Plate 3: South facing section of Pit [7103]
- Plate 4: South facing section of Pit [7101]
- Plate 5: Post-excavation shot of Ring-groove [8301] from SW
- Plate 6: Post-excavation shot of Ring-groove [8301] from
- Plate 7: Slot E [8301] showing step

List of Appendices

- Appendix 1: Trench Descriptions
- Appendix 2: Photographic Record
- Appendix 3: Context Register
- Appendix 4: Sample Register
- Appendix 5: Drawing Register
- Appendix 6: Small Finds Register
- Appendix 7: *'Discovery and Excavation in Scotland'* Report

Summary

This report presents the results of an archaeological evaluation undertaken by AOC Archaeology Group on behalf of Murray Estates Lothian Limited ahead of the development of land at West Edinburgh, known as 'Land East of Millburn Tower'. The development area totalled 53.99 ha

The evaluation consisted of the machine trenching of 14,700 m². The evaluation trenching was targeted upon anomalies uncovered through an earlier phase of geophysical survey undertaken by AOC in September 2015.

The proposed development was situated in an area of undulating, improved agricultural land and substantial colluvial deposits were encountered within the lower lying areas.

Significant archaeological features were encountered in the form of a ring-ditch/groove structure, two pit features and several linear field boundaries. The majority of these features were of probable late prehistoric date.

1 INTRODUCTION

1.1 Site Background

- 1.1.1 AOC Archaeology Group was commissioned by Murray Estates Lothian Limited to carry out a programme of archaeological works ahead of the development of land at West Edinburgh, known as 'Land East of Millburn Tower'. The development area totals 53.99 ha.
- 1.1.2 The proposed development lies within the administrative area of the City of Edinburgh Council, which is advised on archaeological matters by Mr John Lawson of the City of Edinburgh Council Archaeology Service (CECAS). The archaeological works were conducted in accordance with the principals set out in *Scottish Planning Policy* (2014) and *Planning & Archaeology* (2011) and in accordance with City of Edinburgh Council requirements as advised by CECAS.
- 1.1.3 The objective of the archaeological works was to determine the existence of any buried archaeological remains within the development area by means of a programme of trial trenching. This was partially targeted on the findings of a geophysical survey undertaken by AOC Archaeology in September 2015. A Written Scheme of Investigation (AOC 2015) outlining the entire programme of archaeological works was agreed with CECAS in advance of the evaluation being undertaken.
- 1.1.4 The evaluation revealed a limited suite of archaeologically significant remains including a ring-groove structure of later prehistoric date, together with two pit features, and prehistoric and post medieval field boundaries. Associated small finds consisted of a flint flake and 19th century glass and ceramics.
- 1.1.5 The evaluation revealed that the proposed archaeological remains identified during the geophysical survey were related to changes in the underlying drift geology. This included the former course of the Gogar Burn.

1.2 Site Location

- 1.2.1 The development area is located within an area of open farmland to the south of Gogar village and the A8, Glasgow Road. It is bounded to the east by the A720 and to the south by the Edinburgh to Glasgow Railway and the current location of the Gogar Burn. Located just to the west of the site there is the Millburn Tower Designed Landscape. The proposed development is centred on NT 17393 71826. (Figure 1).

1.3 Archaeological background (Based on AOC Archaeology DBA)

1.3.1 Prehistoric (8000 BC-AD 43)

- 1.3.1.1 Prehistoric activity is known in the area. Moloney and Lawson (2007) reported on the findings from excavations undertaken in 1990-2 prior to the development of Edinburgh Park and note a number of prehistoric (Neolithic to Iron Age) features including a trackway. Area F was closest to the proposed survey, adjacent to Site 3 across the A720, which uncovered a cobbled scooped structure of Iron Age date. Moloney and Lawson (2007:21) note this feature as being unique to the type. Further to this, AOC Archaeology undertook work to the east of the survey area in 2015 to the south of the Edinburgh Park development and found a cobble lined hollow and a piece of Bronze Age pot from a feature previously thought to have been ploughed away. Thereby there is evidence of the survival of prehistoric remains from the surrounding area and a high possibility of further discoveries in the survey area.
- 1.3.2 There is evidence of two Roman sites on the survey area, Site 2, a temporary camp located in the centre of the site and Site 3, a marching camp located on the eastern boundary of the survey area to the A720 (Figure 2). Site 3 has an area of 7.5 ha and ditches measuring 300m north to south by approximately 250m east to west. Site 3 was investigated in the 1980's with the construction of the A720, which found v-shaped ditches of 1m width and of varying depth. A piece of roman pottery was found in the ditches dating the feature (Maxwell & Wilson 1987). It is unknown to what extent the construction of the A720 has damaged the site. Aerial photography from the Royal Commission in 1986 shows the construction of the A720 and the Roman

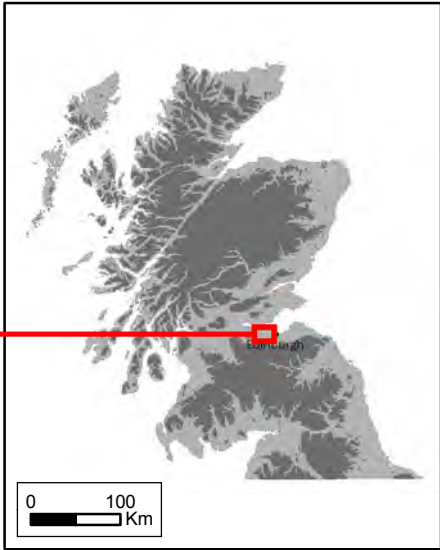
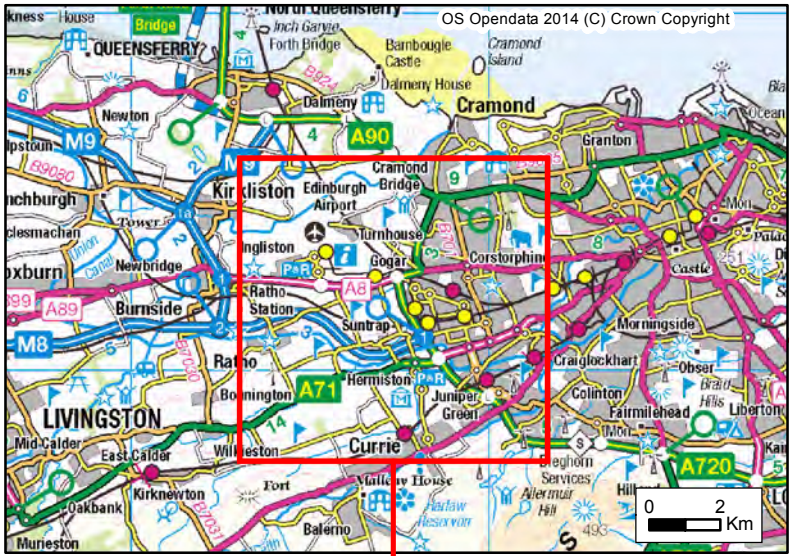

315000

320000

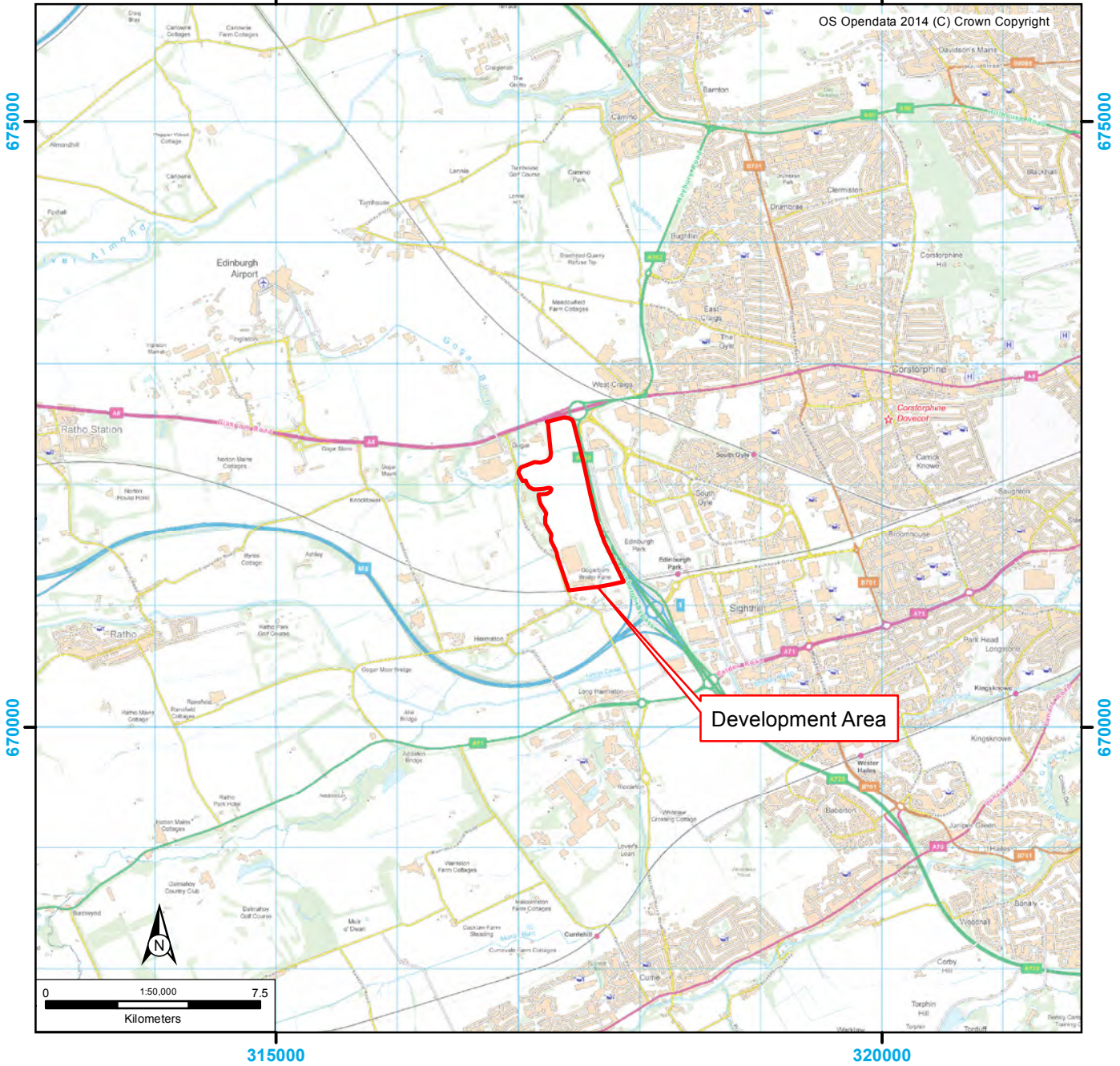

Figure 1: Site Location Plan

Camp (NT17 SE 24) extending into the survey area which may suggest remains survive. Site 2 is known from aerial photography alone. The exact date of either of the sites is unknown. Maxwell and Wilson (1987) and Engl (2014) have linked these camps to the westward extension of Dere Street towards Newbridge.

1.3.3 Medieval (AD 410-1600)

1.3.3.1 There is no cartographic or bibliographical evidence for medieval period activity in the survey area. Early cartographic evidence does not mention the site. The Mercator map (1595) notes the location of Edinburgh but is not more specific. It may be that the area was open land used for agricultural purposes.

1.3.3.2 Evidence of medieval activity for the area is sparse. Nether Gogar (Site 39) and Outer Gogar were settled between 1200-1600AD (Morrison, et al 2007). Moreover, a Viking brooch was found (Site 35) to the west of the site. Thereby, though the survey area not have been intensively utilised, this does not discount the possibility of finding medieval remains on the site.

1.3.4 Post-medieval (AD 410-1900)

1.3.4.1 The Gogar burn and the village of Gogar are mentioned in early post-medieval cartography. Adair (1682) is the first to fully represent the area, indicating the location of both the burn and the village (Figure 4), though Nether Gogar and the burn are well known from documentary evidence pre-dating this (Morisson, et al, 2007). William Roy records the area in 1752-55 in the Military Maps of Scotland. The burn is shown running around the survey area over what is now the A720, and was open ground. Kirkwood (1817) shows a more detailed map of the area, naming the villages around the burn and the position of the road towards Corpstorphine. In the 1st Edition Six Inch Ordnance Survey (1852) the burn can be seen in a similar position.

1.3.4.2 The area of the survey seems to have been open land, a field used for agriculture from Roy's representation (1752-55) to the modern day. Some changes can be seen in the 2nd Edition 6 inch Ordnance Survey map where field boundaries within the survey area appear for the first time with trees being used to delimitate the individual fields.

1.3.4.3 There are no buildings shown cartographically in the post-medieval period. Roy's Military Map (1752-55) shows two possible features in the area; the "Calter Stone" and an old mill. The lack of recognisable features means it is difficult to say if the "Calter stone" feature is within the survey area. Kirkwood (1817) notes the location of the "Callerstone" though on this representation it is outside the survey area. There are documentary references to a mill along the Gogar Burn, being used by the medieval villages of Over Gogar and Neather Gogar (Morisson, et al, 2007), though it is unknown in what condition it was by the 18th century. Though Roy mentions the feature, it was not in use and may have been a ruin. The 1st Edition Six Inch Ordnance Survey (1852) indicates the presence of a gravel quarry in the north west of the survey area, though it is not found in later representations suggesting that it may have been a short lived feature. From the 2nd Edition Six Inch Ordnance Survey there are no features noted in the area.

1.3.4.4 Milburn Tower (Site 9) to the west of the survey area has been marked cartographically since 1752-55, yet Roy did not name the building, and Kirkwood (1817) is the first to name the site. No changes to the area are noted in the post-medieval maps.

1.3.4.5 Another feature of the post-medieval period which can be traced is a track way or road which cuts across the southern portion of the survey area linking Gogar Green to Corstorphine. The road which cuts off from what is now known as Gogar Station Road runs north-east, south-west to Corstorphine, across the Gogar Burn. The track is marked by John Adair in 1682 with a bridge noted across the burn. Though Kirkwood (1817) suggests that the road or track will be outside the survey area the later Ordnance Survey Maps (1st and 2nd Edition) indicate that the road may be found at the south end of the site.

2 OBJECTIVES

2.1 The objectives of the archaeological evaluation were:

- i) to determine and assess the character, extent, condition, quality, date and significance of any buried archaeological remains within the proposed development area;
- ii) to advise and implement an appropriate form of mitigation, such as, excavation, post-excavation analyses and publication given the infeasibility of preserving the archaeological material *in situ*, should significant archaeological remains be encountered.

3 METHODOLOGY

3.1 The archaeological evaluation was undertaken on 26th October – 13th November 2015 using an excavator fitted with a 2.0 m wide toothless ditching bucket. A 3% evaluation of the development area was originally required totalling 14,711 m²; a further two per cent was to be evaluated in the event of substantial archaeology being revealed. Given that small amounts of significant archaeological material was recorded it was decided excavate an additional 350 linear metres. This was undertaken after on site consultation with Mr John Lawson of CECAS. The evaluation was undertaken in dry, clear conditions with good archaeological visibility. Trenches were recorded and subsequently backfilled and tracked-over by the machine.

4 RESULTS

4.1 A site plan showing the location of trenches within Fields A & B is given in Figure 2. The site was covered by a well-sorted improved top-soil, comprising a red brown clay rich sandy matrix. This topsoil varied in depth from c.0.30 m to 0.50 m and contained numerous fragments of white glazed ceramics and bottle glass. The subsoil consisted of orange sandy clay with quantities of shattered sandstone and shale with patches of gravel, boulder clay and manganese. Rubble and ceramic drains were frequently encountered orientated on various alignments according to the varied ground conditions. A colluvial deposit of red brown sandy silt was encountered within the majority of the trenches. This deposit ranged from 0.10 m to 1.20 m in depth and was located within the lower areas of the undulating ground.

4.2 The excavation of several trenches close to the Gogar Burn revealed the probable former course of the Burn. This appeared as a band of clay and gravel running across the base of a slope aligned E/W

4.3 Field A

4.3.1 Trench 23 Linear Ditch [2301]

4.3.1.1A single linear feature was recorded within Trench 23. This feature ran across the trench aligned NE/SW and was 1.0 m wide with moderately sloping sides and a concave base (Figures 3 & 4). The feature was 0.35 m in depth and contained a single compact fill of compact grey brown sandy clay (2302). The feature is the probable remains of a former field boundary of pre-modern date.



Plate 1: West facing section Ditch [2301]

4.3.2 Trench 26 Linear Ditch [2601]

4.3.2.1 An almost identical feature was identified within Trench 26 which ran parallel with Trench 23. The linear ditch was again 1.0 m wide with an identical depth and single fill (Figures 5 & 6). Several shards of bottle glass [SF1] were recovered from the fill.



Plate 2: SW facing section Ditch [2601]

4.3.3 Trench 51 Linear Ditch [5101]

4.3.3.1 A further linear ditch feature [5101] was recorded aligned across Trench 51 N/S. This feature was 0.82 m in width with a depth of 0.35 m (Figures 7 & 8). The feature had moderately sloping sides, a narrow flat base and was filled by a single deposit of grey brown sandy clay.

4.3.4 Trench 55 Linear Ditch [5501]

4.3.4.1 A shallow linear cut was recorded with Trench 51. This feature was aligned E/W and ended in a rounded terminus (Figures 9 & 10). The feature was 0.90 m in width with moderately sloping sides and a flat base. A single grey flint flake [SF2] of east coast derivation was recovered from the single fill (5502). The feature is probably of late prehistoric date.

4.3.4 Trench 58 Quarry Scoop [5801]

4.3.4.1 A large probable quarry scoop was identified at the northern end of Trench 58. This feature was approximately 9.0 m in extent with a depth of 1.68 m. The scoop was filled with loose dark brown sandy clay (5802) with numerous gravel inclusions. A number of 19th century flower pot shards and white ceramics were recovered.

4.3.5 Trench 59 Linear Ditch [5901]

4.3.5.1A N/S aligned linear cut was recorded with Trench 59. The feature was 0.72 m in width with moderately sloping sides and a rounded base some 0.33 m deep (Figures 11 & 12). No finds were recovered from the single fill (5902). The feature is probably of late prehistoric date.



Plate 3: South facing section of Pit [7103]



Plate 4: South facing section of Pit [7101]

4.3.6 Trench 71 Pits [7101 & 7103]

4.3.6.1 Two substantial circular pit features were recorded within Trench 71. The pits were of similar dimensions at nearly a metre in diameter (Figures 13-15). Pit [7101] was the shallower of the two with gently sloping sides and a rounded base, with Pit [7103] being deeper at 0.38 m in depth. Both pits contained identical fills of dark brown sandy clay with numerous inclusions of cremated bone. The pits are of likely prehistoric date.



Plate 5: Post-excitation shot of Ring-groove [8301] from SW

4.3.7 Trench 83 Ring-groove/ditch Structure [8301]

4.3.7.1A single large, circular ditch cut was recorded within Trench 83. This trench was extended to reveal the full extent of the feature. The ditch cut was circular in plan and measured 7.0 m in diameter (Figure 16). No entrance or gap was revealed and no internal features were observed. Five two metre wide slots were excavated through the ring ditch revealing a width up to 1.10 m. The ditch had generally steep sloping sides and a flat base. The northern part of the ditch appeared stepped along both the inner and outer perimeters.

This did not extend to the rest of the feature. The ditch was filled by orange brown sandy clay. This contained numerous large sub-angular packing stones [8302] throughout, though these were concentrated within Slots A & B. Small quantities of cremated bone were also recovered. The ring-ditch feature is almost certainly prehistoric in date and is probably a roundhouse structure or possibly the remains of a small barrow.



Plate 6: Post-excitation shot of Ring-groove [8301] from SW



Plate 7: Slot E [8301] showing step

4.3.7 Trench 7 Linear Ditch [701]

4.3.7.1A small linear trench was recorded within Trench 7. This feature was aligned NE/SW with moderately sloping sides and a rounded base. The ditch was filled with a single deposit of grey brown sandy clay (702).

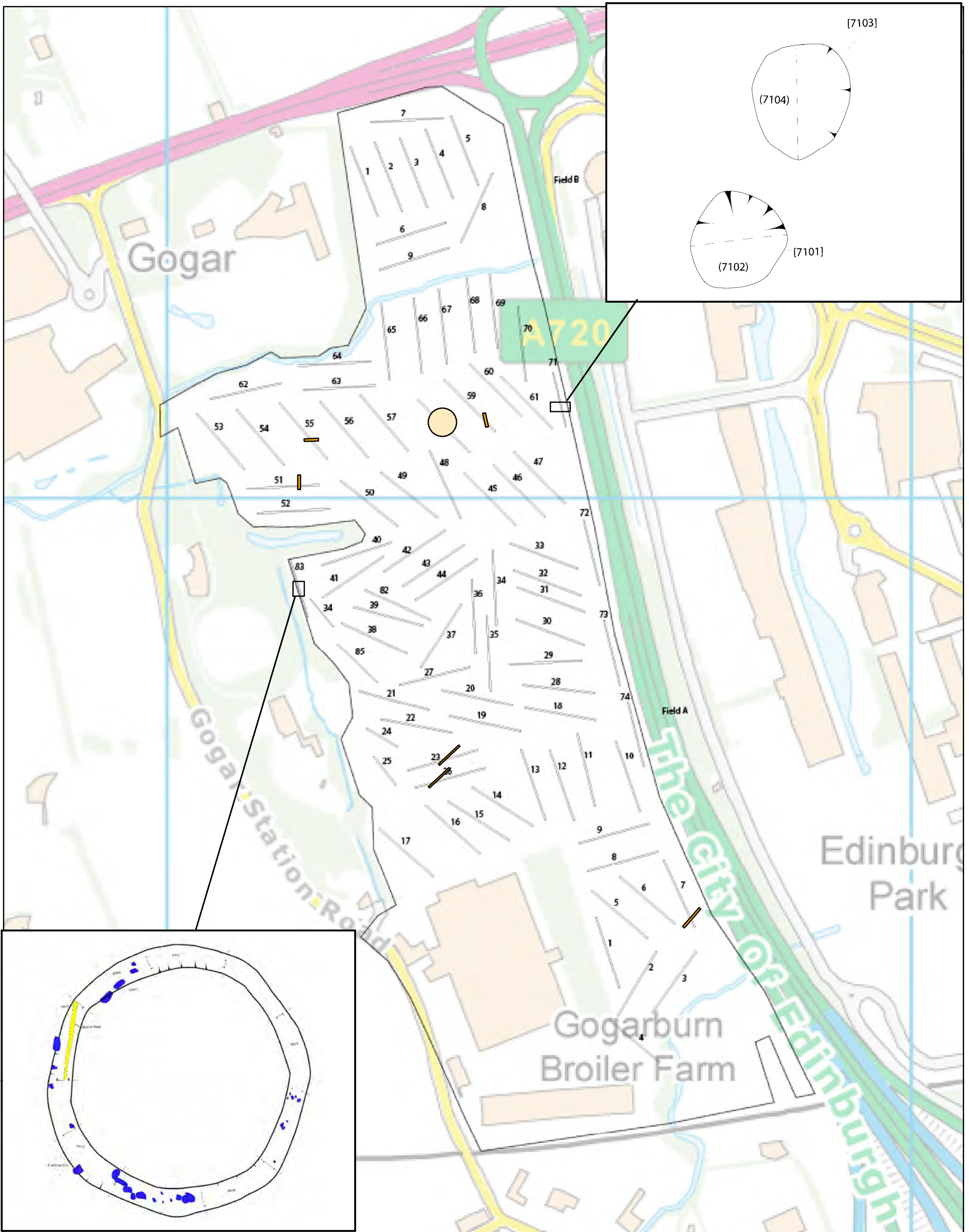



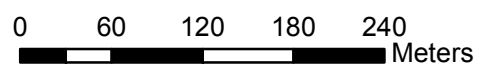

Figure 2- Site Plan showing location of evaluation trenches

Project No.:	22984
Date:	16.11.2015
Scale at A3:	1:4,984

AOC Archaeology Group
 (c) AOC Archaeology 2015

-  72 Trench and Trench Number
-  Linear Feature
-  Scoop Feature



Cartographic data derived from OS OpenData, Crown Copyright



Figure 3- Plan of linear [2301]

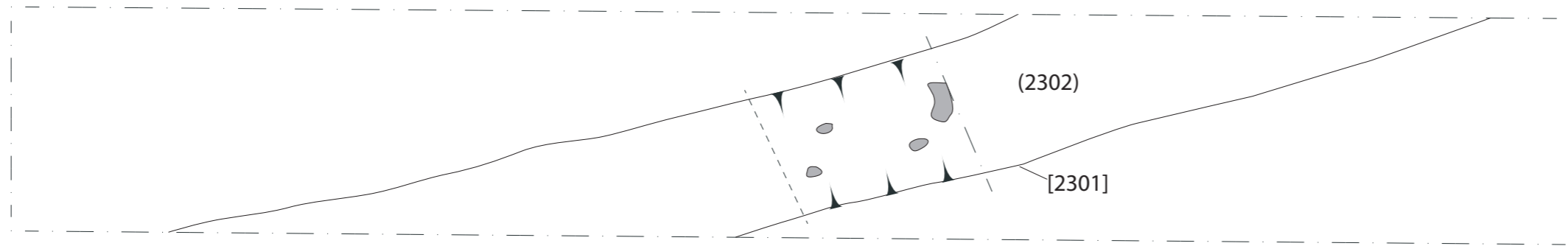

Figure 4- South east facing section

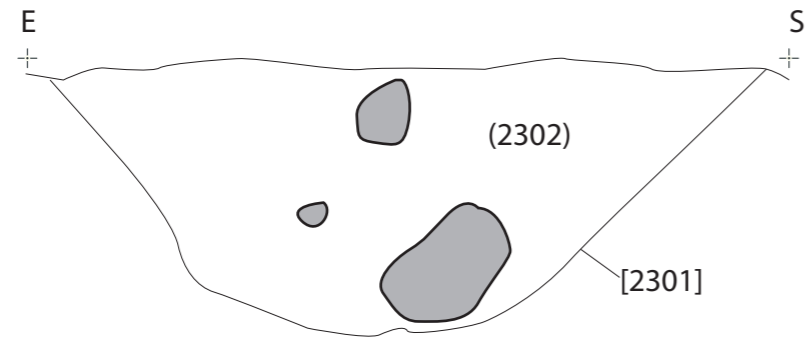

Figure 5- Plan of linear [2601]

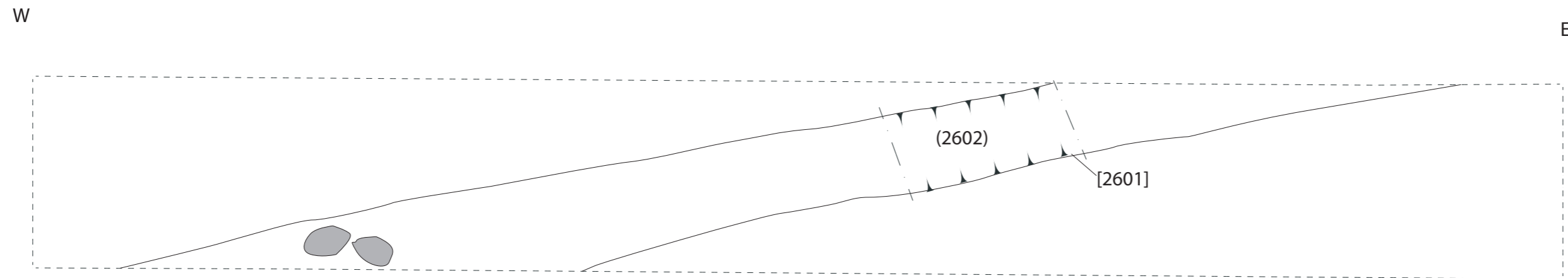

Figure 6- South east facing section of [2601]

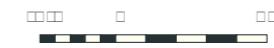
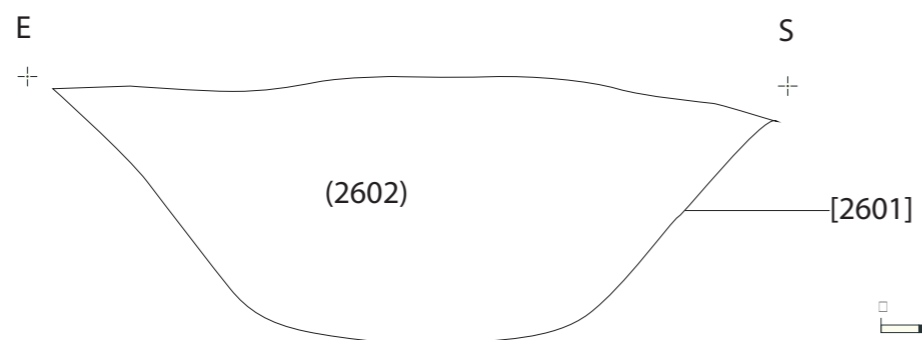

Figure 7- Plan of linear [5101]
in Trench 51

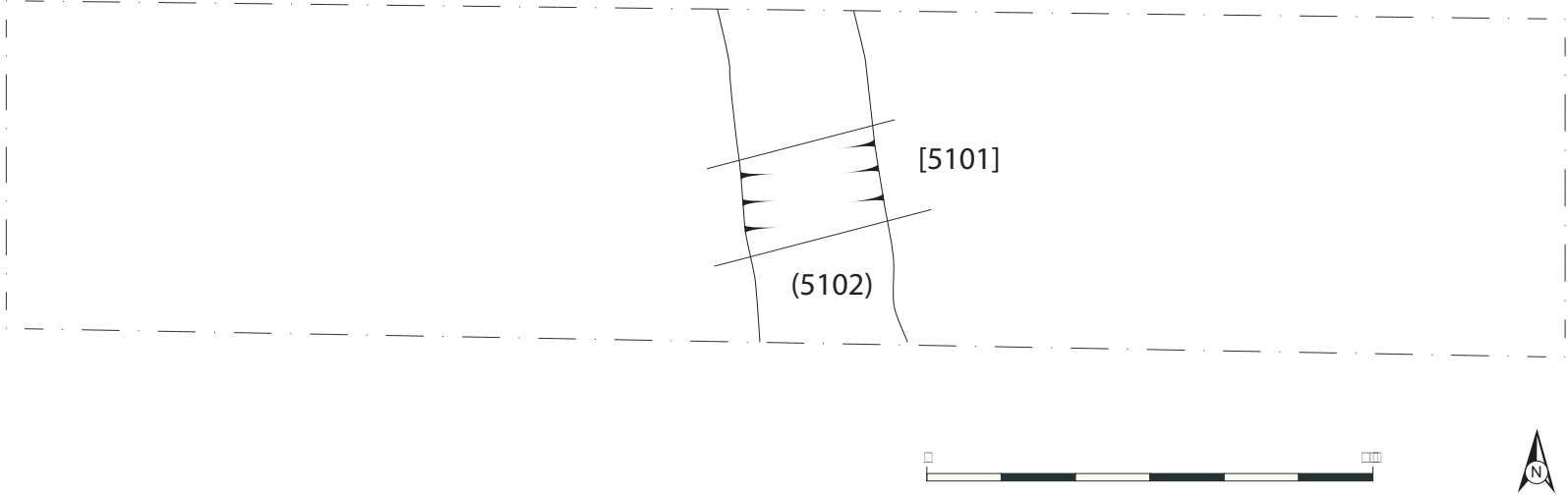

Figure 8- West facing section of linear [5105] in Trench 55

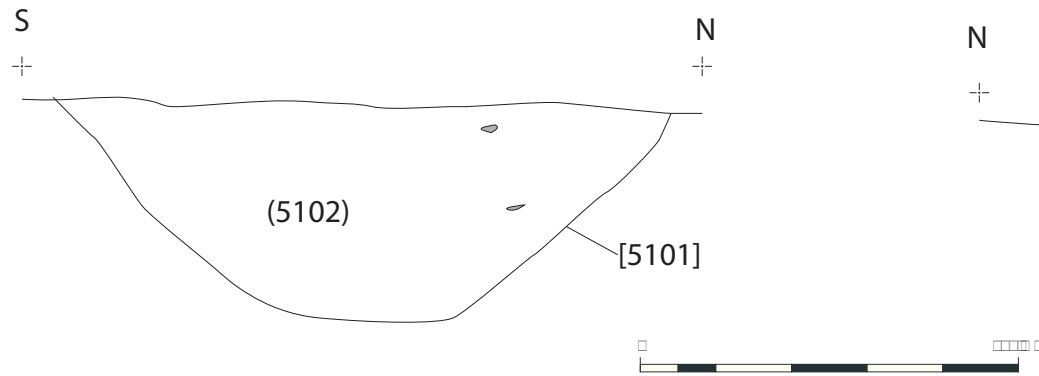

Figure 10- East facing section of [5501] in Trench 55

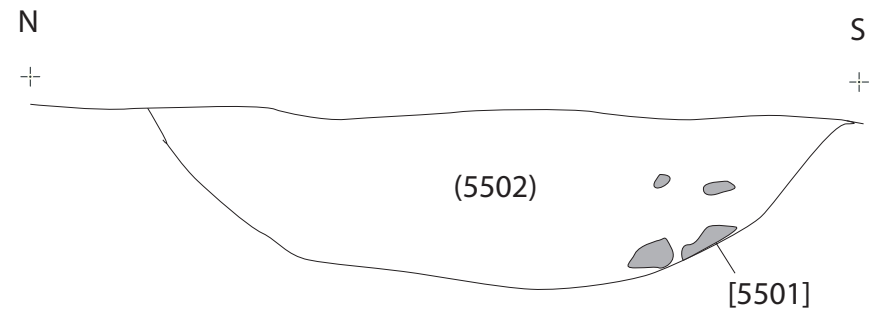

Figure 9- Plan of [5501] in Trench 55 showing a linear feature



Figure 11- Plan of linear [5901] in Trench 59



Figure 12-North facing section of linear feature in Trench 59

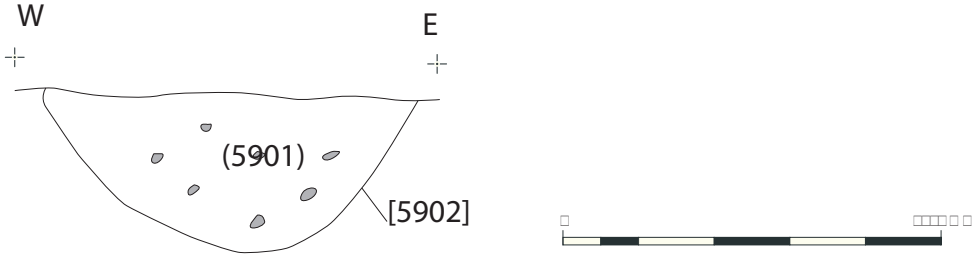

Figure 13- Plan of pits [7101] and [7103] in Trench 7

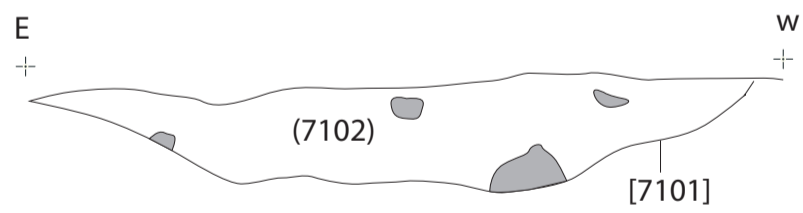
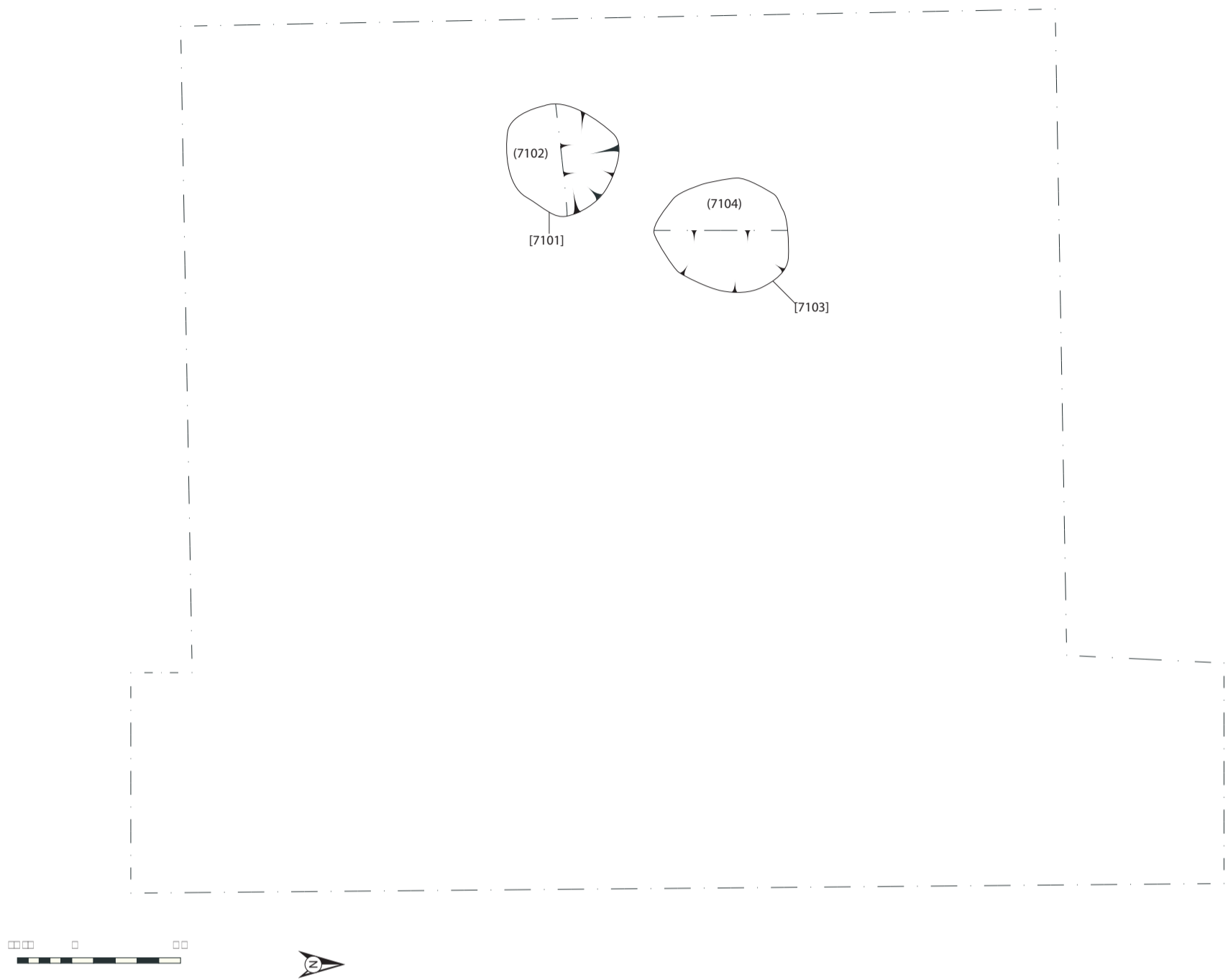

Figure 14- South facing section of Pit [7101] in Trench 7

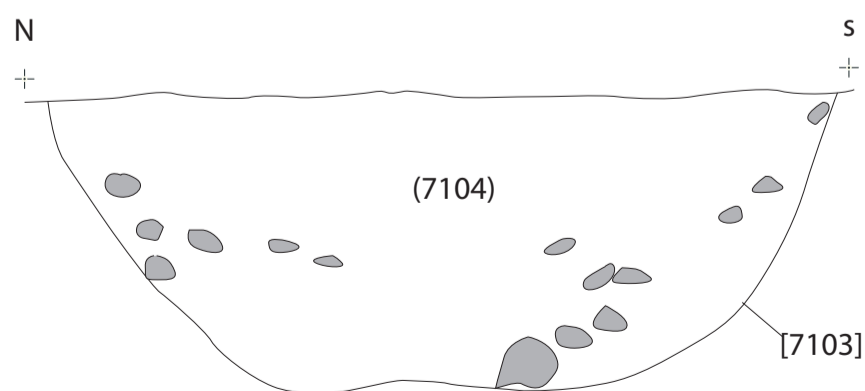
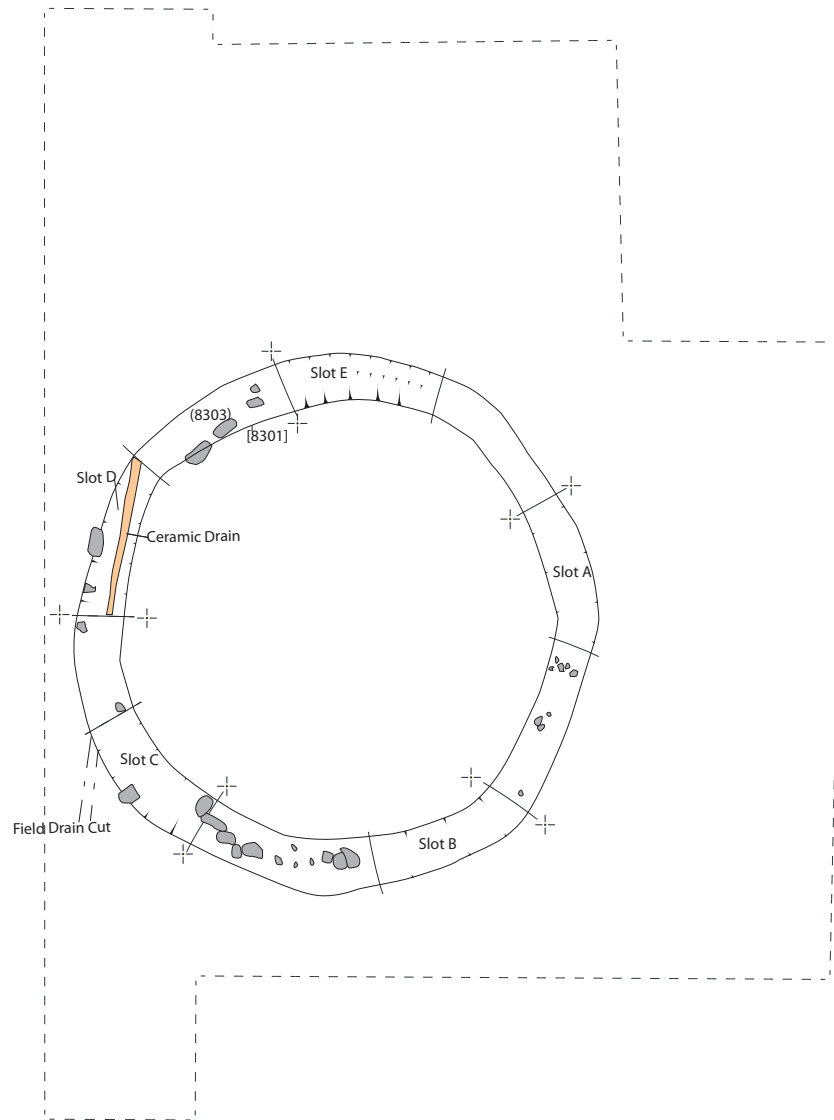

Figure 15- West facing section of Pit [7103] in Trench 7



Figure 16-Plan of Ring Ditch [8301] and sections



Slot A
South facing section of [8301]

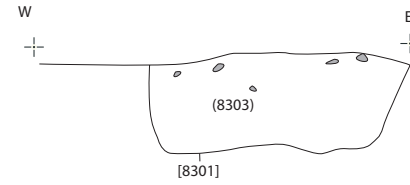

Slot B
South facing section of [8301]

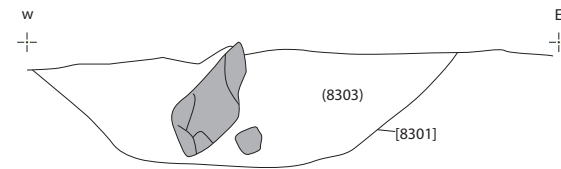

Slot C
West facing section [8301]

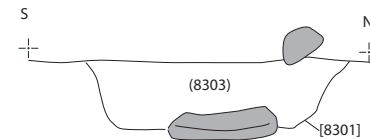

Slot D
North facing section [8301]

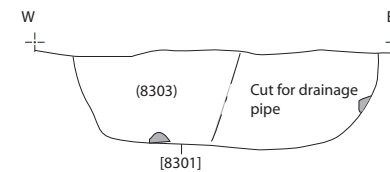

Slot E
East facing section [8301]

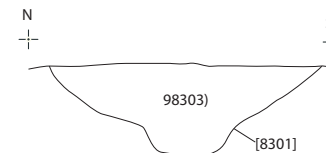

5 CONCLUSIONS

- 5.1 The evaluation completed at Land East of Millburn Tower was comprehensive and was able to target a number of anomalies identified by the earlier phase of geophysical survey. The vast majority of the anomalies identified by the geophysical survey were shown through evaluation to derive from geological variations and processes rather than anthropomorphic means.
- 5.2 The bulk of the evaluation trenching revealed no features of archaeological significance and as a whole most of the site can be viewed in all probability as free from significant archaeological deposits and features. However, there were significant, if localised archaeological features in the form of the ring-groove/ditch feature, boundary ditches and pits were revealed. These features were largely restricted to the freer draining sands and gravels. In terms of significance of most importance is the ring-groove/ditch roundhouse structure which has been effectively fully recorded during the evaluation works. Although significant, the structures are of local importance and are not significant enough to prevent the development going ahead on the two areas of where they were identified.
- 5.3 Due to the level of recording already undertaken during the archaeological evaluation, AOC see no reason for further mitigation works. However, the need and scope of further archaeological mitigation works including field-work and post-excavation are the responsibility of Mr Lawson of CECAS on behalf of City of Edinburgh Council.

6 REFERENCES

AOC Archaeology (2015). *Land at West Edinburgh, known as Lands East of Millburn Tower & the Gogar Burn Reconnection Project, Edinburgh: Archaeological Geophysical Survey and Evaluation*. Written Scheme of Investigation Unpublished Client Report.

Scottish Government 2014 *Scottish Planning Policy*.

Scottish Government 2011 *PAN 2/2011 Planning and Archaeology*.

**Land at West Edinburgh, known as Lands East of Millburn
Tower, Edinburgh:
Section 2: Appendices**

APPENDIX 1: Trench Descriptions (Field A)

Trench 1

<i>Dimensions</i>	100 m by 2.0 m
<i>Orientation</i>	N/S
<i>Depth of Topsoil</i>	0.30 m to 0.45 m
<i>Depth of Colluvium</i>	N/A
<i>Depth of Excavation</i>	0.32 m to 0.50 m
<i>Significant Features</i>	None
<i>Other Features</i>	None
<i>Subsoil</i>	Orange/brown sandy clay with shattered sub-angular sandstones.
<i>Finds</i>	Occasional white ceramics throughout top-soil

Trench 2

<i>Dimensions</i>	100 m by 2.0 m
<i>Orientation</i>	SE/NW
<i>Depth of Topsoil</i>	0.20 m to 0.30 m
<i>Depth of Alluvium</i>	0.20 m
<i>Depth of Excavation</i>	0.40 m
<i>Significant Features</i>	None
<i>Other Features</i>	Ceramic drains at 5.0 m intervals N/S and E/W
<i>Subsoil</i>	Orange/brown sandy clay with shattered sub-angular sandstones. Numerous plough scars.
<i>Finds</i>	None

Trench 3

<i>Dimensions</i>	100 m by 2.0 m
<i>Orientation</i>	NW/SE
<i>Depth of Topsoil</i>	0.30 m
<i>Depth of Alluvium</i>	0.30 m
<i>Depth of Excavation</i>	0.40 m to 0.80 m
<i>Significant Features</i>	None
<i>Other Features</i>	ceramic drains at 9 m & 80 m. Rubble drains at 35 m & 70 m all E/W
<i>Subsoil</i>	Orange/brown sandy clay with shattered sub-angular sandstones.
<i>Finds</i>	White ceramic throughout top-soil

Trench 4

<i>Dimensions</i>	100 m by 2.0 m
<i>Orientation</i>	NW/SE
<i>Depth of Topsoil</i>	0.32 m to 0.45 m
<i>Depth of Colluvium</i>	0.05 m to 0.10 m
<i>Depth of Excavation</i>	0.40 m to 0.60 m
<i>Significant Features</i>	None
<i>Other Features</i>	None
<i>Subsoil</i>	Dark Orange/brown sandy clay with gravel.
<i>Finds</i>	White ceramic throughout top-soil

Trench 5

<i>Dimensions</i>	100 m by 2.0 m
<i>Orientation</i>	NW/SE
<i>Depth of Topsoil</i>	0.30 m
<i>Depth of Alluvium</i>	0.10 m to 0.20 m
<i>Depth of Excavation</i>	0.40 m to 0.50 m
<i>Significant Features</i>	None
<i>Other Features</i>	None
<i>Subsoil</i>	Orange/brown sandy clay with shattered sub-angular sandstones.
<i>Finds</i>	None

Trench 6

<i>Dimensions</i>	100 m by 2.0 m
<i>Orientation</i>	NW/SE
<i>Depth of Topsoil</i>	0.30 m to 0.40 m
<i>Depth of Colluvium</i>	0.10 m to 0.20 m
<i>Depth of Excavation</i>	0.50 m to 0.60 m
<i>Significant Features</i>	None
<i>Other Features</i>	None
<i>Subsoil</i>	Orange/brown sandy clay with shattered sub-angular sandstones.
<i>Finds</i>	White ceramic and glass through top-soil

Trench 7

<i>Dimensions</i>	100 m by 2.0 m
<i>Orientation</i>	S/N
<i>Depth of Topsoil</i>	0.30 m to 0.45 m
<i>Depth of Colluvium</i>	0.15 m to 0.20 m
<i>Depth of Excavation</i>	0.50 m to 0.70 m
<i>Significant Features</i>	Linear ditch feature [701] at 4.0 m E/W
<i>Other Features</i>	Rubble drain at 65 m E/W. Ceramic drain at 67 m E/W.
<i>Subsoil</i>	Orange/brown sandy clay with shattered sub-angular sandstones.
<i>Finds</i>	Occasional white ceramic throughout top-soil.

Trench 8

<i>Dimensions</i>	100 m by 2.0 m
<i>Orientation</i>	W/E
<i>Depth of Topsoil</i>	0.30 m to 0.40 m
<i>Depth of Colluvium</i>	0.10 m to 0.20 m
<i>Depth of Excavation</i>	0.30 m to 0.60 m
<i>Significant Features</i>	None
<i>Other Features</i>	None
<i>Subsoil</i>	Orange/brown sandy clay with shattered sub-angular sandstones.
<i>Finds</i>	Occasional white ceramic throughout top-soil.

Trench 9

<i>Dimensions</i>	100 m by 2.0 m
<i>Orientation</i>	E/W
<i>Depth of Topsoil</i>	0.33 m to 0.50 m
<i>Depth of Colluvium</i>	0.10 m
<i>Depth of Excavation</i>	0.40 m to 0.60 m
<i>Significant Features</i>	None
<i>Other Features</i>	Rubble drain at 12.0 m SE/NW
<i>Subsoil</i>	Orange/brown sandy clay with shattered sub-angular sandstones/shale.
<i>Finds</i>	None

Trench 10

<i>Dimensions</i>	100 m by 2.0 m
<i>Orientation</i>	S/N
<i>Depth of Topsoil</i>	0.30 m to 0.45 m
<i>Depth of Colluvium</i>	None
<i>Depth of Excavation</i>	0.40 m to 0.60 m
<i>Significant Features</i>	None
<i>Other Features</i>	Rubble drain at 45.0 m NW/SE
<i>Subsoil</i>	Orange/brown sandy clay with shattered sub-angular sandstones. Occasional stone drags and plough scars
<i>Finds</i>	None

Trench 11

<i>Dimensions</i>	100 m by 2.0 m
<i>Orientation</i>	N/S
<i>Depth of Topsoil</i>	0.30 m to 0.40 m
<i>Depth of Colluvium</i>	0.10 m
<i>Depth of Excavation</i>	0.45 m
<i>Significant Features</i>	None
<i>Other Features</i>	None
<i>Subsoil</i>	Orange/brown sandy clay with gravels. Occasional stone drags and plough scars
<i>Finds</i>	None

Trench 12

<i>Dimensions</i>	100 m by 2.0 m
<i>Orientation</i>	N/S
<i>Depth of Topsoil</i>	0.30 m to 0.45 m
<i>Depth of Colluvium</i>	None
<i>Depth of Excavation</i>	0.30 m to 0.50 m
<i>Significant Features</i>	None
<i>Other Features</i>	None
<i>Subsoil</i>	Orange/brown sandy clay with shattered sub-angular sandstones. Occasional stone drags and plough scars
<i>Finds</i>	Occasional white ceramic throughout top-soil

Trench 13

<i>Dimensions</i>	100 m by 2.0 m
<i>Orientation</i>	N/S
<i>Depth of Topsoil</i>	0.40 m to 0.54 m
<i>Depth of Colluvium</i>	None
<i>Depth of Excavation</i>	0.50 m
<i>Significant Features</i>	None
<i>Other Features</i>	Rubble drain at 50.0 m NW/SE
<i>Subsoil</i>	LightOrange/brown sandy clay with shattered sub-angular sandstones. Occasional stone drags and plough scars
<i>Finds</i>	Occasional white ceramic throughout top-soil

Trench 14

<i>Dimensions</i>	100 m by 2.0 m
<i>Orientation</i>	N/S
<i>Depth of Topsoil</i>	0.40 m to 0.54 m
<i>Depth of Colluvium</i>	None
<i>Depth of Excavation</i>	0.50 m
<i>Significant Features</i>	None
<i>Other Features</i>	Rubble drains at 5.0 m intervals E/W
<i>Subsoil</i>	Light orange/brown sandy clay with shattered sub-angular sandstones. White silty clay band at 3.5 m. Occasional stone drags and plough scars
<i>Finds</i>	Occasional white ceramic throughout top-soil

Trench 15

<i>Dimensions</i>	100 m by 2.0 m
<i>Orientation</i>	NW/SE
<i>Depth of Topsoil</i>	0.30 m
<i>Depth of Colluvium</i>	0.40 m
<i>Depth of Excavation</i>	0.50 m
<i>Significant Features</i>	None
<i>Other Features</i>	Rubble drains at 25.0 m intervals E/W
<i>Subsoil</i>	Orange/brown sandy clay with shattered sub-angular sandstones. Patches of coal/manganese. Occasional stone drags and plough scars
<i>Finds</i>	Occasional white ceramic throughout top-soil

Trench 16

<i>Dimensions</i>	100 m by 2.0 m
<i>Orientation</i>	NW/SE
<i>Depth of Topsoil</i>	0.30 m to 0.50 m
<i>Depth of Colluvium</i>	0.40 m
<i>Depth of Excavation</i>	0.50 m
<i>Significant Features</i>	None
<i>Other Features</i>	None
<i>Subsoil</i>	Orange/brown sandy clay with shattered sub-angular sandstones. Patches of coal/manganese. Occasional stone drags and plough scars
<i>Finds</i>	Occasional white ceramic throughout top-soil

Trench 17

<i>Dimensions</i>	100 m by 2.0 m
<i>Orientation</i>	NW/SE
<i>Depth of Topsoil</i>	0.30 m
<i>Depth of Colluvium</i>	None
<i>Depth of Excavation</i>	0.38 m to 0.52 m
<i>Significant Features</i>	None
<i>Other Features</i>	Ceramic drain at 10.0 m intervals E/W
<i>Subsoil</i>	Orange/brown sandy clay with shattered sub-angular sandstones. Patches of coal/manganese. Occasional stone drags and plough scars
<i>Finds</i>	Occasional white ceramic throughout top-soil

Trench 18

<i>Dimensions</i>	100 m by 2.0 m
<i>Orientation</i>	NW/SE
<i>Depth of Topsoil</i>	0.30 m to 0.53 m
<i>Depth of Colluvium</i>	None
<i>Depth of Excavation</i>	0.40 m to 0.60 m
<i>Significant Features</i>	None
<i>Other Features</i>	Ceramic drain at 90.0 m NE/SW
<i>Subsoil</i>	Orange/brown sandy clay with shattered sub-angular sandstones. Patches of coal/manganese. Occasional stone drags and plough scars
<i>Finds</i>	Occasional white ceramic throughout top-soil

Trench 19

<i>Dimensions</i>	100 m by 2.0 m
<i>Orientation</i>	SE/NW
<i>Depth of Topsoil</i>	0.30 m to 0.40 m
<i>Depth of Colluvium</i>	0.10 m
<i>Depth of Excavation</i>	0.40 m to 0.50 m
<i>Significant Features</i>	Modern pit at 25.0 m
<i>Other Features</i>	Rubble drain at 5.0 m intervals N/S
<i>Subsoil</i>	Compact orange/brown sandy clay with gravel. Patches of coal/manganese. Occasional stone drags and plough scars
<i>Finds</i>	Occasional white ceramic throughout top-soil

Trench 20

<i>Dimensions</i>	100 m by 2.0 m
<i>Orientation</i>	NW/SE
<i>Depth of Topsoil</i>	0.30 m to 0.40 m
<i>Depth of Colluvium</i>	0.10 m

<i>Depth of Excavation</i>	0.40 m to 0.45 m
<i>Significant Features</i>	Rectangular modern cut at 90.0 m
<i>Other Features</i>	Rubble drain at 5.0 m intervals N/S
<i>Subsoil</i>	Compact orange/brown sandy clay with gravel. Patches of coal/manganese. Occasional stone drags and plough scars
<i>Finds</i>	Occasional white ceramic throughout top-soil

Trench 21

<i>Dimensions</i>	100 m by 2.0 m
<i>Orientation</i>	SE/NW
<i>Depth of Topsoil</i>	0.30 m to 0.40 m
<i>Depth of Colluvium</i>	0.10 m to 0.20 m
<i>Depth of Excavation</i>	0.40 m to 0.50 m
<i>Significant Features</i>	None
<i>Other Features</i>	Rubble drain at 7.0 m & 21.0 m N/S
<i>Subsoil</i>	Orange/brown sandy clay with gravel. Occasional stone drags and plough scars
<i>Finds</i>	Occasional white ceramic throughout top-soil

Trench 22

<i>Dimensions</i>	100 m by 2.0 m
<i>Orientation</i>	SE/NW
<i>Depth of Topsoil</i>	0.30 m
<i>Depth of Colluvium</i>	0.20 m to 0.25 m
<i>Depth of Excavation</i>	0.40 m to 0.50 m
<i>Significant Features</i>	Faint traces of rig and furrow 2.0 m wide and spaced at 2.0 m intervals.
<i>Other Features</i>	Rubble drain at 2.0 m & 8.0 m N/S
<i>Subsoil</i>	Orange/brown sandy clay with gravel. Occasional stone drags and plough scars
<i>Finds</i>	Occasional white ceramic throughout top-soil

Trench 23

<i>Dimensions</i>	100 m by 2.0 m
<i>Orientation</i>	E/W
<i>Depth of Topsoil</i>	0.35 m to 0.40 m
<i>Depth of Colluvium</i>	0.10 m to 0.40 m
<i>Depth of Excavation</i>	0.45 m to 0.90 m
<i>Significant Features</i>	Linear ditch [2301]
<i>Other Features</i>	None
<i>Subsoil</i>	Orange/brown sandy clay with gravel. Occasional stone drags and plough scars
<i>Finds</i>	Occasional white ceramic throughout top-soil

Trench 24

<i>Dimensions</i>	50 m by 2.0 m
<i>Orientation</i>	SE/NW
<i>Depth of Topsoil</i>	0.30 m
<i>Depth of Colluvium</i>	None
<i>Depth of Excavation</i>	0.40 m to 0.50 m
<i>Significant Features</i>	None
<i>Other Features</i>	Rubble drain at 42.0 m N/S. Ceramic drain at 5.0 m N/S
<i>Subsoil</i>	Orange/brown sandy clay with gravel. Occasional stone drags and plough scars
<i>Finds</i>	Occasional white ceramic throughout top-soil

Trench 25

<i>Dimensions</i>	50 m by 2.0 m
<i>Orientation</i>	SE/NW

<i>Depth of Topsoil</i>	0.30 m to 0.40 m
<i>Depth of Colluvium</i>	0.10 m to 0.20 m
<i>Depth of Excavation</i>	0.40 m to 0.55 m
<i>Significant Features</i>	None
<i>Other Features</i>	Ceramic drains at 15.0 m, 21.0 m & 40.0 m NE/SW
<i>Subsoil</i>	Orange/brown sandy clay with gravel. Occasional stone drags and plough scars
<i>Finds</i>	Occasional white ceramic throughout top-soil

Trench 26

<i>Dimensions</i>	100 m by 2.0 m
<i>Orientation</i>	E/W
<i>Depth of Topsoil</i>	0.40 m
<i>Depth of Colluvium</i>	0.10 m to 0.45 m
<i>Depth of Excavation</i>	0.50 m to 0.60 m
<i>Significant Features</i>	Linear Ditch [2601]
<i>Other Features</i>	Rubble drain at 35.0 m N/S
<i>Subsoil</i>	Orange/brown sandy clay with gravel. Occasional stone drags and plough scars
<i>Finds</i>	Occasional white ceramic throughout top-soil

Trench 27

<i>Dimensions</i>	100 m by 2.0 m
<i>Orientation</i>	E/W
<i>Depth of Topsoil</i>	0.40 m
<i>Depth of Colluvium</i>	0.10 m
<i>Depth of Excavation</i>	0.50 m
<i>Significant Features</i>	None
<i>Other Features</i>	Rubble drain at 40.0 m N/S
<i>Subsoil</i>	Orange/brown sandy clay with gravel. Occasional stone drags and plough scars
<i>Finds</i>	Occasional white ceramic throughout top-soil

Trench 28

<i>Dimensions</i>	100 m by 2.0 m
<i>Orientation</i>	NW/SE
<i>Depth of Topsoil</i>	0.40 m
<i>Depth of Colluvium</i>	None
<i>Depth of Excavation</i>	0.50 m
<i>Significant Features</i>	None
<i>Other Features</i>	None
<i>Subsoil</i>	Orange/brown sandy clay with gravel. Occasional stone drags and plough scars
<i>Finds</i>	Occasional white ceramic throughout top-soil

Trench 29

<i>Dimensions</i>	100 m by 2.0 m
<i>Orientation</i>	E/W
<i>Depth of Topsoil</i>	0.40 m – 0.53 m
<i>Depth of Colluvium</i>	0.10 m to 0.45 m
<i>Depth of Excavation</i>	0.44 m to 0.56 m
<i>Significant Features</i>	None
<i>Other Features</i>	Rubble drain at 70.0 m E/W
<i>Subsoil</i>	Orange/brown sandy clay with gravel. Occasional stone drags and plough scars
<i>Finds</i>	Occasional white ceramic throughout top-soil

Trench 30

<i>Dimensions</i>	100 m by 2.0 m
<i>Orientation</i>	NW/SE
<i>Depth of Topsoil</i>	0.27 m to 0.40 m
<i>Depth of Colluvium</i>	0.10 m to 0.45 m
<i>Depth of Excavation</i>	0.50 m to 0.60 m
<i>Significant Features</i>	None
<i>Other Features</i>	Rubble drain at 25.0 m N/S.
<i>Subsoil</i>	Orange/brown sandy clay with gravel. Occasional stone drags and plough scars
<i>Finds</i>	Occasional white ceramic throughout top-soil

Trench 31

<i>Dimensions</i>	100 m by 2.0 m
<i>Orientation</i>	NW/SE
<i>Depth of Topsoil</i>	0.38 m to 0.80 m
<i>Depth of Colluvium</i>	0.30 m to 0.40 m
<i>Depth of Excavation</i>	0.40 m to 0.85 m
<i>Significant Features</i>	None
<i>Other Features</i>	None
<i>Subsoil</i>	Orange/brown sandy clay with gravel. Occasional stone drags and plough scars
<i>Finds</i>	Occasional white ceramic throughout top-soil

Trench 32

<i>Dimensions</i>	100 m by 2.0 m
<i>Orientation</i>	NW/SE
<i>Depth of Topsoil</i>	0.45 m to 0.50 m
<i>Depth of Colluvium</i>	None
<i>Depth of Excavation</i>	0.50 m to 0.55 m
<i>Significant Features</i>	None
<i>Other Features</i>	Ceramic drain at 23.0 m N/S
<i>Subsoil</i>	Orange/brown sandy clay with gravel. Occasional stone drags and plough scars
<i>Finds</i>	Occasional white ceramic throughout top-soil

Trench 33

<i>Dimensions</i>	100 m by 2.0 m
<i>Orientation</i>	NW/SE
<i>Depth of Topsoil</i>	0.30 m to 0.58 m
<i>Depth of Colluvium</i>	None
<i>Depth of Excavation</i>	0.32 m to 0.60 m
<i>Significant Features</i>	None
<i>Other Features</i>	Ceramic drain at 11.0 m NE/SW
<i>Subsoil</i>	Orange/brown sandy clay with gravel. Occasional stone drags and plough scars
<i>Finds</i>	Occasional white ceramic throughout top-soil

Trench 34

<i>Dimensions</i>	100 m by 2.0 m
<i>Orientation</i>	N/S
<i>Depth of Topsoil</i>	0.38 m to 0.45 m
<i>Depth of Colluvium</i>	None
<i>Depth of Excavation</i>	0.40 m to 0.45 m
<i>Significant Features</i>	None
<i>Other Features</i>	None
<i>Subsoil</i>	Orange/brown sandy clay with gravel. Occasional stone drags and plough scars
<i>Finds</i>	Occasional white ceramic throughout top-soil

Trench 35

<i>Dimensions</i>	100 m by 2.0 m
<i>Orientation</i>	N/S
<i>Depth of Topsoil</i>	0.44 m to 0.52 m
<i>Depth of Colluvium</i>	None
<i>Depth of Excavation</i>	0.48 m to 0.55 m
<i>Significant Features</i>	None
<i>Other Features</i>	Rubble drain at 10.0 m NE/SW
<i>Subsoil</i>	Orange/brown sandy clay with gravel. Occasional stone drags and plough scars
<i>Finds</i>	Occasional white ceramic throughout top-soil

Trench 36

<i>Dimensions</i>	100 m by 2.0 m
<i>Orientation</i>	N/S
<i>Depth of Topsoil</i>	0.35 m to 0.45 m
<i>Depth of Colluvium</i>	None
<i>Depth of Excavation</i>	0.37 m to 0.45 m
<i>Significant Features</i>	None
<i>Other Features</i>	None
<i>Subsoil</i>	Orange/brown sandy clay with gravel. Occasional stone drags and plough scars
<i>Finds</i>	Occasional white ceramic throughout top-soil

Trench 37

<i>Dimensions</i>	100 m by 2.0 m
<i>Orientation</i>	NE/SW
<i>Depth of Topsoil</i>	0.32 m to 0.45 m
<i>Depth of Colluvium</i>	None
<i>Depth of Excavation</i>	0.45 m to 0.50 m
<i>Significant Features</i>	None
<i>Other Features</i>	Rubble drain at 80.0 m N/S
<i>Subsoil</i>	Orange/brown sandy clay with gravel. Occasional stone drags and plough scars
<i>Finds</i>	Occasional white ceramic throughout top-soil

Trench 38

<i>Dimensions</i>	100 m by 2.0 m
<i>Orientation</i>	NW/SE
<i>Depth of Topsoil</i>	0.44 m to 0.55 m
<i>Depth of Colluvium</i>	None
<i>Depth of Excavation</i>	0.50 m to 0.60 m
<i>Significant Features</i>	None
<i>Other Features</i>	Rubble drain at 15.0 m NW/SE
<i>Subsoil</i>	Yellow/brown sandy clay with gravel. Occasional stone drags and plough scars
<i>Finds</i>	Occasional white ceramic throughout top-soil

Trench 39

<i>Dimensions</i>	100 m by 2.0 m
<i>Orientation</i>	NW/SE
<i>Depth of Topsoil</i>	0.50 m to 0.58 m
<i>Depth of Colluvium</i>	None
<i>Depth of Excavation</i>	0.60 m
<i>Significant Features</i>	None
<i>Other Features</i>	Rubble drain at 5.0 m & 20.0 m N/S
<i>Subsoil</i>	Yellow/brown sandy clay with gravel. Occasional stone drags and plough scars
<i>Finds</i>	Occasional white ceramic throughout top-soil

Trench 40

<i>Dimensions</i>	100 m by 2.0 m
<i>Orientation</i>	SW/NE
<i>Depth of Topsoil</i>	0.40 m to 0.48 m
<i>Depth of Colluvium</i>	None
<i>Depth of Excavation</i>	0.50 m
<i>Significant Features</i>	None
<i>Other Features</i>	Ceramic drain at 48.0 m N/S
<i>Subsoil</i>	Yellow/brown sandy clay with gravel. Occasional stone drags and plough scars
<i>Finds</i>	Occasional white ceramic throughout top-soil

Trench 41

<i>Dimensions</i>	100 m by 2.0 m
<i>Orientation</i>	NE/SW
<i>Depth of Topsoil</i>	0.40 m
<i>Depth of Colluvium</i>	0.20 m

<i>Depth of Excavation</i>	0.40 m to 0.60 m
<i>Significant Features</i>	None
<i>Other Features</i>	Ceramic drain at 32.0 m N/S. Rubble drain at 0.20 m N/S
<i>Subsoil</i>	Yellow/brown sandy clay with gravel. Occasional stone drags and plough scars
<i>Finds</i>	Occasional white ceramic throughout top-soil

Trench 42

<i>Dimensions</i>	100 m by 2.0 m
<i>Orientation</i>	NE/SW
<i>Depth of Topsoil</i>	0.20 m to 0.30 m
<i>Depth of Colluvium</i>	0.50 m
<i>Depth of Excavation</i>	0.60 m to 1.10 m
<i>Significant Features</i>	None
<i>Other Features</i>	None
<i>Subsoil</i>	Yellow/brown sandy clay with gravel. Occasional stone drags and plough scars
<i>Finds</i>	Occasional white ceramic throughout top-soil

Trench 43

<i>Dimensions</i>	100 m by 2.0 m
<i>Orientation</i>	NE/SW
<i>Depth of Topsoil</i>	0.30 m to 0.47 m
<i>Depth of Colluvium</i>	None
<i>Depth of Excavation</i>	0.33 m to 0.53 m
<i>Significant Features</i>	None
<i>Other Features</i>	None
<i>Subsoil</i>	Yellow/brown sandy clay with gravel. Occasional stone drags and plough scars
<i>Finds</i>	Occasional white ceramic throughout top-soil

Trench 44

<i>Dimensions</i>	100 m by 2.0 m
<i>Orientation</i>	NE/SW
<i>Depth of Topsoil</i>	0.38 m to 0.51 m
<i>Depth of Colluvium</i>	None
<i>Depth of Excavation</i>	0.40 m to 0.56 m
<i>Significant Features</i>	None
<i>Other Features</i>	None
<i>Subsoil</i>	Yellow/brown sandy clay with gravel. Occasional stone drags and plough scars
<i>Finds</i>	Occasional white ceramic throughout top-soil

Trench 45

<i>Dimensions</i>	100 m by 2.0 m
<i>Orientation</i>	NW/SE
<i>Depth of Topsoil</i>	0.37 m to 0.43 m
<i>Depth of Colluvium</i>	None
<i>Depth of Excavation</i>	0.40 m to 0.50 m
<i>Significant Features</i>	None
<i>Other Features</i>	None
<i>Subsoil</i>	Yellow/brown sandy clay with gravel. Occasional stone drags and plough scars
<i>Finds</i>	Occasional white ceramic throughout top-soil

Trench 46

<i>Dimensions</i>	100 m by 2.0 m
<i>Orientation</i>	NW/SE
<i>Depth of Topsoil</i>	0.38 m to 0.55 m
<i>Depth of Colluvium</i>	None
<i>Depth of Excavation</i>	0.40 m to 0.58 m
<i>Significant Features</i>	None
<i>Other Features</i>	Rubble drain at 30.0 m, 55.0 m & 62.0 m
<i>Subsoil</i>	Yellow/brown sandy clay with gravel. Occasional stone drags and plough scars
<i>Finds</i>	Occasional white ceramic throughout top-soil

Trench 47

<i>Dimensions</i>	100 m by 2.0 m
<i>Orientation</i>	NW/SE
<i>Depth of Topsoil</i>	0.30 m to 0.37 m
<i>Depth of Colluvium</i>	0.30 m to 0.35 m
<i>Depth of Excavation</i>	0.65 m to 0.80 m
<i>Significant Features</i>	None
<i>Other Features</i>	Ceramic drains at 5.0 m, 11.0 m N/S. Rubble drain at 53.0 m E/W
<i>Subsoil</i>	Yellow/brown sandy clay with gravel. Occasional stone drags and plough scars
<i>Finds</i>	Occasional white ceramic throughout top-soil

Trench 48

<i>Dimensions</i>	100 m by 2.0 m
<i>Orientation</i>	N/S
<i>Depth of Topsoil</i>	0.30 m to 0.53 m
<i>Depth of Colluvium</i>	1.40 m
<i>Depth of Excavation</i>	0.45 m to 1.70 m
<i>Significant Features</i>	None
<i>Other Features</i>	None
<i>Subsoil</i>	Yellow/brown sandy clay with gravel. Occasional stone drags and plough scars
<i>Finds</i>	Occasional white ceramic throughout top-soil

Trench 49

<i>Dimensions</i>	100 m by 2.0 m
<i>Orientation</i>	NW/SE
<i>Depth of Topsoil</i>	0.30 m to 0.47 m
<i>Depth of Colluvium</i>	0.80 m to 1.70 m
<i>Depth of Excavation</i>	0.50 m to 1.80 m
<i>Significant Features</i>	None
<i>Other Features</i>	Rubble drains at 13.0 m & 82.0 m SW/NE & E/W
<i>Subsoil</i>	Yellow/brown sandy clay with gravel. Occasional stone drags and plough scars
<i>Finds</i>	Occasional white ceramic throughout top-soil

Trench 50

<i>Dimensions</i>	100 m by 2.0 m
<i>Orientation</i>	NW/SE
<i>Depth of Topsoil</i>	0.40 m to 0.45 m
<i>Depth of Colluvium</i>	0.30 m
<i>Depth of Excavation</i>	0.70 m to 0.85 m
<i>Significant Features</i>	None
<i>Other Features</i>	None
<i>Subsoil</i>	Yellow/brown sandy clay with gravel. Occasional stone drags and plough scars
<i>Finds</i>	Occasional white ceramic throughout top-soil

Trench 51

<i>Dimensions</i>	100 m by 2.0 m
<i>Orientation</i>	E/W
<i>Depth of Topsoil</i>	0.30 m to 0.40 m
<i>Depth of Colluvium</i>	None
<i>Depth of Excavation</i>	0.40 m to 0.45 m
<i>Significant Features</i>	Ditch [5101]
<i>Other Features</i>	Ceramic drains at 0.0 m E/W & 25.0 m NNE/SSW
<i>Subsoil</i>	Yellow/brown sandy clay with gravel. Occasional stone drags and plough scars. Clay pocket at 12.0 m to 18.0 m
<i>Finds</i>	Occasional white ceramic throughout top-soil

Trench 52

<i>Dimensions</i>	100 m by 2.0 m
<i>Orientation</i>	W/E
<i>Depth of Topsoil</i>	0.30 m
<i>Depth of Colluvium</i>	0.10 m

<i>Depth of Excavation</i>	0.40 m
<i>Significant Features</i>	None
<i>Other Features</i>	None
<i>Subsoil</i>	Orange sandy clay with gravel and patches of coal/manganese. Occasional stone drags and plough scars
<i>Finds</i>	Occasional white ceramic throughout top-soil

Trench 53

<i>Dimensions</i>	100 m by 2.0 m
<i>Orientation</i>	NE/SW
<i>Depth of Topsoil</i>	0.30 m to 0.40 m
<i>Depth of Colluvium</i>	0.20 m to 0.20 m
<i>Depth of Excavation</i>	0.50 m
<i>Significant Features</i>	None
<i>Other Features</i>	Rubble drain at 5.0 m N/S. Clay drains at 10.0 m intervals from 17.0 m
<i>Subsoil</i>	Orange/brown sandy clay with gravel. Occasional stone drags and plough scars
<i>Finds</i>	Occasional white ceramic throughout top-soil

Trench 54

<i>Dimensions</i>	100 m by 2.0 m
<i>Orientation</i>	SE/NW
<i>Depth of Topsoil</i>	0.40 m
<i>Depth of Colluvium</i>	0.25 m
<i>Depth of Excavation</i>	0.70 m
<i>Significant Features</i>	None
<i>Other Features</i>	Rubble drains at 12.0 m NE/SW. Clay drains at 5.0 m intervals from 3.0 m
<i>Subsoil</i>	Orange/brown sandy clay with gravel. Occasional stone drags and plough scars
<i>Finds</i>	Occasional white ceramic throughout top-soil

Trench 55

<i>Dimensions</i>	100 m by 2.0 m
<i>Orientation</i>	SE/NW
<i>Depth of Topsoil</i>	0.30 m to 0.40 m
<i>Depth of Colluvium</i>	0.10 m to 0.25 m
<i>Depth of Excavation</i>	0.40 m to 0.60 m
<i>Significant Features</i>	Linear ditch feature [5501] at 8.0 m E/W
<i>Other Features</i>	Rubble drain at 90.0 m NE/SW.
<i>Subsoil</i>	Orange/brown sandy clay with gravel. Clay at 90.0 m to 95.0 m. Occasional stone drags and plough scars
<i>Finds</i>	Occasional white ceramic throughout top-soil

Trench 56

<i>Dimensions</i>	100 m by 2.0 m
<i>Orientation</i>	SE/NW
<i>Depth of Topsoil</i>	0.30 m
<i>Depth of Colluvium</i>	0.10 m to 0.20 m
<i>Depth of Excavation</i>	0.40 m to 0.50 m
<i>Significant Features</i>	Linear ditch feature [5601] at 70.0 m N/S
<i>Other Features</i>	None
<i>Subsoil</i>	Orange/brown sandy clay with gravel. Patches of clay with manganese. Occasional stone drags and plough scars
<i>Finds</i>	Occasional white ceramic throughout top-soil

Trench 57

<i>Dimensions</i>	100 m by 2.0 m
<i>Orientation</i>	SE/NW
<i>Depth of Topsoil</i>	0.40 m
<i>Depth of Colluvium</i>	0.10 m to 0.20 m
<i>Depth of Excavation</i>	0.40 m to 0.60 m
<i>Significant Features</i>	None
<i>Other Features</i>	Rubble drain at 30.0 m NW/SE

Subsoil Orange/brown sandy clay with gravel. Patches of clay with manganese. Occasional stone drags and plough scars
Finds Occasional white ceramic throughout top-soil

Trench 58

Dimensions 100 m by 2.0 m
Orientation SE/NW
Depth of Topsoil 0.50 m
Depth of Colluvium 0.70 m
Depth of Excavation 0.52 m to 1.60 m
Significant Features Quarry Scoop [5801]
Other Features None
Subsoil Orange/brown sandy clay with gravel. Patches of clay with manganese. Occasional stone drags and plough scars
Finds Occasional white ceramic throughout top-soil

Trench 59

Dimensions 100 m by 2.0 m
Orientation NW/SE
Depth of Topsoil 0.30 m to 0.49 m
Depth of Colluvium 0.10 m to 0.50 m
Depth of Excavation 0.40 m to 1.10 m
Significant Features Linear N/S ditch feature [5901]
Other Features None
Subsoil Orange/brown sandy clay with gravel. Patches of clay with manganese. Occasional stone drags and plough scars
Finds Occasional white ceramic throughout top-soil

Trench 60

Dimensions 100 m by 2.0 m
Orientation NW/SE
Depth of Topsoil 0.30 m to 0.38 m
Depth of Colluvium 0.50 m to 0.75 m
Depth of Excavation 0.40 m to 1.20 m
Significant Features None
Other Features None
Subsoil Orange/brown sandy clay with gravel. Patches of clay with manganese. Occasional stone drags and plough scars
Finds Occasional white ceramic throughout top-soil

Trench 61

Dimensions 100 m by 2.0 m
Orientation NW/SE
Depth of Topsoil 0.40 m to 0.49 m
Depth of Colluvium 0.40 m to 0.50 m
Depth of Excavation 0.40 m to 1.10 m
Significant Features None
Other Features Ceramic drain at 70.0 E/W
Subsoil Orange/brown sandy clay with gravel. Patches of clay with manganese. Occasional stone drags and plough scars
Finds Occasional white ceramic throughout top-soil

Trench 62

Dimensions 100 m by 2.0 m
Orientation W/E
Depth of Topsoil 0.30 m to 0.40 m
Depth of Colluvium 0.20 m
Depth of Excavation 0.40 m to 0.60 m
Significant Features None
Other Features Ceramic drain at 5.0 intervals from 27.0 m SW/NE. Rubble drain at 20.0 m & 40.0 m N/S
Subsoil Orange/brown sandy clay with gravel. Patches of clay with manganese. Occasional stone drags and plough scars

<i>Finds</i>	Occasional white ceramic throughout top-soil
Trench 63	
<i>Dimensions</i>	100 m by 2.0 m
<i>Orientation</i>	E/W
<i>Depth of Topsoil</i>	0.30 m
<i>Depth of Colluvium</i>	0.15 m
<i>Depth of Excavation</i>	0.45 m
<i>Significant Features</i>	None
<i>Other Features</i>	Ceramic drain at 15.0 intervals from 15.0 m N/S
<i>Subsoil</i>	Orange/brown sandy clay with gravel. Patches of clay with manganese. Occasional stone drags and plough scars
<i>Finds</i>	Occasional white ceramic throughout top-soil
Trench 64	
<i>Dimensions</i>	100 m by 2.0 m
<i>Orientation</i>	W/E
<i>Depth of Topsoil</i>	0.35 m to 0.40 m
<i>Depth of Colluvium</i>	0.15 m to 0.40 m
<i>Depth of Excavation</i>	0.40 m to 0.80 m
<i>Significant Features</i>	None
<i>Other Features</i>	Ceramic drains at 8.0 m intervals from 4.0 m NW/SE
<i>Subsoil</i>	Orange/brown sandy clay with gravel. Patches of clay with manganese. Occasional stone drags and plough scars
<i>Finds</i>	Occasional white ceramic throughout top-soil
Trench 65	
<i>Dimensions</i>	100 m by 2.0 m
<i>Orientation</i>	N/S
<i>Depth of Topsoil</i>	0.35 m to 0.40 m
<i>Depth of Colluvium</i>	0.10 m to 0.50 m
<i>Depth of Excavation</i>	0.50 m to 0.90 m
<i>Significant Features</i>	None
<i>Other Features</i>	None
<i>Subsoil</i>	Orange/brown sandy clay with gravel. Patches of clay with manganese. Occasional stone drags and plough scars
<i>Finds</i>	Occasional white ceramic throughout top-soil
Trench 66	
<i>Dimensions</i>	100 m by 2.0 m
<i>Orientation</i>	N/S
<i>Depth of Topsoil</i>	0.35 m to 0.40 m
<i>Depth of Colluvium</i>	0.10 m to 0.50 m
<i>Depth of Excavation</i>	0.50 m to 0.90 m
<i>Significant Features</i>	None
<i>Other Features</i>	None
<i>Subsoil</i>	Orange/brown sandy clay with gravel. Patches of clay with manganese. Occasional stone drags and plough scars
<i>Finds</i>	Occasional white ceramic throughout top-soil
Trench 67	
<i>Dimensions</i>	100 m by 2.0 m
<i>Orientation</i>	N/S
<i>Depth of Topsoil</i>	0.35 m to 0.40 m
<i>Depth of Colluvium</i>	0.10 m to 0.50 m
<i>Depth of Excavation</i>	0.50 m to 0.90 m
<i>Significant Features</i>	None
<i>Other Features</i>	None
<i>Subsoil</i>	Orange/brown sandy clay with gravel. Patches of clay with manganese. Occasional stone drags and plough scars
<i>Finds</i>	Occasional white ceramic throughout top-soil

Trench 68

<i>Dimensions</i>	100 m by 2.0 m
<i>Orientation</i>	N/S
<i>Depth of Topsoil</i>	0.35 m to 0.40 m
<i>Depth of Colluvium</i>	0.20 m to 0.30 m
<i>Depth of Excavation</i>	0.60 m to 0.70 m
<i>Significant Features</i>	None
<i>Other Features</i>	None
<i>Subsoil</i>	Orange/brown sandy clay with gravel. Patches of clay with manganese. Occasional stone drags and plough scars
<i>Finds</i>	Occasional white ceramic throughout top-soil

Trench 69

<i>Dimensions</i>	100 m by 2.0 m
<i>Orientation</i>	N/S
<i>Depth of Topsoil</i>	0.35 m
<i>Depth of Colluvium</i>	0.10 m to 0.30 m
<i>Depth of Excavation</i>	0.50 m to 0.70 m
<i>Significant Features</i>	None
<i>Other Features</i>	None
<i>Subsoil</i>	Orange/brown sandy clay with gravel. Patch of clay at 70.0 m corresponds with geophysical survey findings. Occasional stone drags and plough scars
<i>Finds</i>	None

Trench 70

<i>Dimensions</i>	100 m by 2.0 m
<i>Orientation</i>	N/S
<i>Depth of Topsoil</i>	0.30 m
<i>Depth of Colluvium</i>	0.10 m
<i>Depth of Excavation</i>	0.45 m
<i>Significant Features</i>	Three circular pit features [7001-7003-7005] at 61.0 m
<i>Other Features</i>	None
<i>Subsoil</i>	Orange/brown sandy clay with gravel. Patches of clay with manganese. Occasional stone drags and plough scars
<i>Finds</i>	Occasional white ceramic throughout top-soil

Trench 71

<i>Dimensions</i>	50 m by 2.0 m
<i>Orientation</i>	N/S
<i>Depth of Topsoil</i>	0.30 m
<i>Depth of Colluvium</i>	0.30 m at 30.0 m
<i>Depth of Excavation</i>	0.40 m to 0.65 m
<i>Significant Features</i>	Two circular Pits [7101-7103]
<i>Other Features</i>	Modern service cut at 5.0 m
<i>Subsoil</i>	Orange/brown sandy clay with gravel. Patches of clay with manganese. Occasional stone drags and plough scars
<i>Finds</i>	Occasional white ceramic throughout top-soil

Trench 72

<i>Dimensions</i>	100 m by 2.0 m
<i>Orientation</i>	N/S
<i>Depth of Topsoil</i>	0.40 m
<i>Depth of Colluvium</i>	0.20 m
<i>Depth of Excavation</i>	0.50 m to 0.60 m
<i>Significant Features</i>	None
<i>Other Features</i>	None
<i>Subsoil</i>	Orange/brown sandy clay with gravel. Patches of clay with manganese. Occasional stone drags and plough scars
<i>Finds</i>	Occasional white ceramic throughout top-soil

Trench 73

<i>Dimensions</i>	100 m by 2.0 m
<i>Orientation</i>	N/S
<i>Depth of Topsoil</i>	0.40 m
<i>Depth of Colluvium</i>	0.10 m
<i>Depth of Excavation</i>	0.50 m
<i>Significant Features</i>	None
<i>Other Features</i>	None
<i>Subsoil</i>	Orange/brown sandy clay with gravel. Patches of clay with manganese. Occasional stone drags and plough scars
<i>Finds</i>	Occasional white ceramic throughout top-soil

Trench 74

<i>Dimensions</i>	100 m by 2.0 m
<i>Orientation</i>	N/S
<i>Depth of Topsoil</i>	0.35 m to 0.40 m
<i>Depth of Colluvium</i>	None
<i>Depth of Excavation</i>	0.50 m
<i>Significant Features</i>	None
<i>Other Features</i>	None
<i>Subsoil</i>	Orange/brown sandy clay with gravel. Patches of clay with manganese. Occasional stone drags and plough scars
<i>Finds</i>	Occasional white ceramic throughout top-soil

Trench 82

<i>Dimensions</i>	100 m by 2.0 m
<i>Orientation</i>	NW/SE
<i>Depth of Topsoil</i>	0.40 m to 0.50 m
<i>Depth of Colluvium</i>	None
<i>Depth of Excavation</i>	0.42 m to 0.55 m
<i>Significant Features</i>	None
<i>Other Features</i>	None
<i>Subsoil</i>	Orange/brown sandy clay with gravel. Patches of clay with manganese. Occasional stone drags and plough scars
<i>Finds</i>	Occasional white ceramic throughout top-soil

Trench 83

<i>Dimensions</i>	100 m by 2.0 m
<i>Orientation</i>	N/S
<i>Depth of Topsoil</i>	0.35 m to 0.40 m
<i>Depth of Colluvium</i>	0.10 m to 0.50 m
<i>Depth of Excavation</i>	0.50 m to 0.90 m
<i>Significant Features</i>	Circular ring-groove feature [8301] at 63.0 m
<i>Other Features</i>	Ceramic drain at 60.0 m NE/SW
<i>Subsoil</i>	Orange/brown sandy clay with gravel. Patches of clay with manganese. Occasional stone drags and plough scars
<i>Finds</i>	Occasional white ceramic throughout top-soil

Trench 84

<i>Dimensions</i>	25 m by 2.0 m
<i>Orientation</i>	NW/SE
<i>Depth of Topsoil</i>	0.25 m to 0.50 m
<i>Depth of Colluvium</i>	None
<i>Depth of Excavation</i>	0.30 m to 0.50 m
<i>Significant Features</i>	None
<i>Other Features</i>	None
<i>Subsoil</i>	Orange/brown sandy clay with gravel. Patches of clay with manganese. Occasional stone drags and plough scars
<i>Finds</i>	Occasional white ceramic throughout top-soil

Trench 85

<i>Dimensions</i>	25 m by 2.0 m
<i>Orientation</i>	NW/SE
<i>Depth of Topsoil</i>	0.40 m
<i>Depth of Colluvium</i>	None
<i>Depth of Excavation</i>	0.50 m
<i>Significant Features</i>	None
<i>Other Features</i>	None
<i>Subsoil</i>	Orange/brown sandy clay with gravel. Patches of clay with manganese. Occasional stone drags and plough scars
<i>Finds</i>	Occasional white ceramic throughout top-soil

Trench Descriptions (Field B)

Trench 1

<i>Dimensions</i>	100 m by 2.0 m
<i>Orientation</i>	NNW/SSE
<i>Depth of Topsoil</i>	0.40 m
<i>Depth of Colluvium</i>	0.10 m to 0.20 m
<i>Depth of Excavation</i>	0.50 m to 0.60 m
<i>Significant Features</i>	None
<i>Other Features</i>	Victorian dumped deposit underlying top-soil at 65.0 m to 75.0 m. Rubble drains at 10.0 m intervals from 5.0 m NE/SW
<i>Subsoil</i>	Orange/brown sandy clay with gravel. Patches of clay with manganese. Occasional stone drags and plough scars
<i>Finds</i>	Occasional white ceramic throughout top-soil

Trench 2

<i>Dimensions</i>	100 m by 2.0 m
<i>Orientation</i>	SSE/NNW
<i>Depth of Topsoil</i>	0.40 m to 0.50 m
<i>Depth of Colluvium</i>	0.10 m to 0.20 m
<i>Depth of Excavation</i>	0.50 m to 0.60 m
<i>Significant Features</i>	None
<i>Other Features</i>	Victorian dumped deposit underlying top-soil at 65.0 m to 75.0 m. Clay drains at 5.0 m intervals from 0.0 m E/W
<i>Subsoil</i>	Orange/brown sandy clay with gravel. Patches of clay with manganese. Occasional stone drags and plough scars
<i>Finds</i>	Occasional white ceramic throughout top-soil

Trench 3

<i>Dimensions</i>	100 m by 2.0 m
<i>Orientation</i>	NNW/ SSE
<i>Depth of Topsoil</i>	0.40 m to 0.50 m
<i>Depth of Colluvium</i>	0.10 m to 0.60 m
<i>Depth of Excavation</i>	0.50 m to 1.00 m
<i>Significant Features</i>	None
<i>Other Features</i>	Modern dumped deposit underlying top-soil at 5.0 m to 20.0 m. Clay drains at 5.0 m intervals from 0.0 m E/W
<i>Subsoil</i>	Orange/brown sandy clay with gravel. Patches of clay with manganese. Occasional stone drags and plough scars
<i>Finds</i>	Occasional white ceramic throughout top-soil

Trench 4

<i>Dimensions</i>	100 m by 2.0 m
<i>Orientation</i>	SSE/NNW
<i>Depth of Topsoil</i>	0.40 m
<i>Depth of Colluvium</i>	0.10 m
<i>Depth of Excavation</i>	0.50 m to 0.60 m

<i>Significant Features</i>	None
<i>Other Features</i>	Victorian dumped deposit underlying top-soil at 12.0 m to 30.0 m. Clay drains at 5.0 m intervals from 0.0 m E/W
<i>Subsoil</i>	Orange/brown sandy clay with gravel. Patches of clay with manganese. Occasional stone drags and plough scars
<i>Finds</i>	Occasional white ceramic throughout top-soil

Trench 5

<i>Dimensions</i>	100 m by 2.0 m
<i>Orientation</i>	NNW/ SSE
<i>Depth of Topsoil</i>	0.40 m to 0.50 m
<i>Depth of Colluvium</i>	0.10 m to 0.30 m
<i>Depth of Excavation</i>	0.60 m to 0.70 m
<i>Significant Features</i>	None
<i>Other Features</i>	Modern demolition pit at 15.0 m to 20.0 m. Dumped material at 70.0 m. Clay drains at 5.0 m intervals from 0.0 m E/W
<i>Subsoil</i>	Orange/brown sandy clay with gravel. Patches of clay with manganese. Occasional stone drags and plough scars
<i>Finds</i>	Occasional white ceramic throughout top-soil

Trench 6

<i>Dimensions</i>	100 m by 2.0 m
<i>Orientation</i>	E/ W
<i>Depth of Topsoil</i>	0.50 m
<i>Depth of Colluvium</i>	0.10 m
<i>Depth of Excavation</i>	0.60 m
<i>Significant Features</i>	None
<i>Other Features</i>	None
<i>Subsoil</i>	Orange/brown sandy clay with gravel. Patches of clay with manganese. Occasional stone drags and plough scars
<i>Finds</i>	Occasional white ceramic throughout top-soil

Trench 7

<i>Dimensions</i>	100 m by 2.0 m
<i>Orientation</i>	W/E
<i>Depth of Topsoil</i>	0.40 m
<i>Depth of Colluvium</i>	0.30 m
<i>Depth of Excavation</i>	0.70 m
<i>Significant Features</i>	None
<i>Other Features</i>	None
<i>Subsoil</i>	Orange/brown sandy clay with gravel. Patches of clay with manganese. Occasional stone drags and plough scars
<i>Finds</i>	Occasional white ceramic throughout top-soil

Trench 8

<i>Dimensions</i>	100 m by 2.0 m
<i>Orientation</i>	SW/NE
<i>Depth of Topsoil</i>	0.40 m
<i>Depth of Colluvium</i>	0.20 m
<i>Depth of Excavation</i>	0.50 m to 0.60 m
<i>Significant Features</i>	None
<i>Other Features</i>	None
<i>Subsoil</i>	Compact orange/brown sandy clay with gravel. Patches of clay with manganese. Occasional stone drags and plough scars
<i>Finds</i>	Occasional white ceramic throughout top-soil

Trench 9

<i>Dimensions</i>	100 m by 2.0 m
<i>Orientation</i>	E/ W
<i>Depth of Topsoil</i>	0.50 m
<i>Depth of Colluvium</i>	0.10 m
<i>Depth of Excavation</i>	0.60 m

<i>Significant Features</i>	None
<i>Other Features</i>	None
<i>Subsoil</i>	Orange/brown sandy clay with gravel. Patches of clay with manganese. Occasional stone drags and plough scars
<i>Finds</i>	Occasional white ceramic throughout top-soil

APPENDIX 2: Photographic Record

Camera 1

Frame	Field	Description	From
1	-	Registration shot	-
2	A	Post-excavation shot Trench 1	S
3	A	Post-excavation shot Trench 4	NW
4	A	Post-excavation shot Trench 6	SE
7	A	Post-excavation shot Trench 8	W
8	A	Post-excavation shot Trench 9	E
9	A	Post-excavation shot Trench 12	N
10	A	Post-excavation shot Trench 13	S
11	A	Post-excavation shot Trench 17	NW
12	A	Post-excavation shot Trench 16	SE
13	A	Post-excavation shot Trench 10	S
14	A	Post-excavation shot Trench 11	S
15	A	Post-excavation shot Trench 14	SE
16	A	Post-excavation shot Trench 15	SE
17	-	Void	-
18	-	Void	-
19	A	Post-excavation shot Trench 18	NE
20	A	Post-excavation shot Trench 28	NE
21	A	Post-excavation shot Trench 29	W
22	A	Post-excavation shot Trench 30	NW
23	A	Post-excavation shot Trench 31	NW
24	A	Post-excavation shot of linear cut [2601]	SE
25	A	SE facing section of linear cut [2601]	SE
26	A	Post-excavation shot of linear cut [2301]	SE
27	A	SE facing section of linear cut [2301]	SE
28	A	Post-excavation shot Trench 32	SE
29	A	Post-excavation shot Trench 33	SE
30	A	Post-excavation shot Trench 34	N
31	A	Post-excavation shot Trench 35	N
32	A	Post-excavation shot Trench 36	S
33	A	Post-excavation shot Trench 44	NE
34	A	Post-excavation shot Trench 43	NE
35	A	Post-excavation shot Trench 42	NE

**Land at West Edinburgh, known as Land East of Millburn Tower, Edinburgh:
Archaeological Evaluation Report**

36	A	Post-excavation shot Trench 40	NE
37	A	Post-excavation shot Trench 41	NE
38	-	Void	-
39	-	Void	-
40	A	Post-excavation shot Trench 39	NW
41	A	Post-excavation shot Trench 38	NW
42	A	Post-excavation shot Trench 50	SE
43	A	Post-excavation shot Trench 49	N
44	A	Post-excavation shot Trench 49 of trial pit through colluvial deposits	SE
45	A	Post-excavation shot Trench 48	S
46	A	Post-excavation shot Trench 45	E
47	A	Post-excavation shot Trench 46	NW
48	A	Post-excavation shot Trench 47	NW
49	A	Post-excavation shot Trench 61	NW
50	A	Post-excavation shot Trench 60	NW
51	A	Post-excavation shot Trench 59	NW
52	A	Post-excavation shot Trench 58	NW
53	A	Post-excavation shot Trench 67	S
54	A	Post-excavation shot Trench 68	S
55	A	Post-excavation shot Trench 64	S
56	A	Post-excavation shot Trench 65	S
57	A	Post-excavation shot Trench 57	S
58	A	SW facing section Trench 59	SW
59	A	NE facing section Trench 58 through quarry dump	NE
60	A	Post-excavation shot Trench 69	S
61	A	Post-excavation shot Trench 70	S
62	A	Post-excavation shot Trench 71	S
63	A	Post-excavation shot Trench 72	S
64	A	SE facing section through linear cut [5501]	SE
65	A	N facing section through linear cut [5101]	N
66	A	S facing through Pit cut [7101]	S
67	A	W facing section through Pit cut [7103]	W
68-69	A	SE facing section of Slot A through Ring-groove [8301]	SW
70-71	A	SE facing section of Slot A through Ring-groove [8301]	SW
72-74	A	S facing section of Slot B through Ring-groove [8301]	S
75	A	Slot B through Ring-groove [8301]	W
76	A	Slot B through Ring-groove [8301]	E

77-78	A	Slot C through Ring-groove [8301] N facing section	N
79	A	Slot C through Ring-groove [8301]	E
80	A	Slot C through Ring-groove [8301]	W
81-82	A	Slot D through Ring-groove [8301] SE facing section	SE
83-84	A	Slot D through Ring-groove [8301] showing ceramic drain cut	SW/S
85-87	A	Slot E through Ring-groove [8301] NE facing section	NE
88-89	A	Slot E through Ring-groove [8301]	E/W
90-93	A	General shots of Ring-groove [8301]	E
94	A	Slot B [8301] with stones removed	E
95	A	Slot C [8301] with stones removed	SE
96-100	A	Post excavation shots [8301]	var
101	A	Post-excavation shot Trench 84	NW
102	A	Post-excavation shot Trench 85	NW
103-104	A	Post excavation shots of linear ceramic drain cuts trenches 40-41	N

Camera 2

Frame	Field	Description	From
1	-	Registration shot	-
2	A	Post-excavation shot Trench 52	E
3	A	Post-excavation shot Trench 54	SE
4	A	Post-excavation shot Trench 55	NW
5	A	Post-excavation shot Trench 56	SE
6	A	Post-excavation shot Trench 57	NW
7	A	Post-excavation shot Trench 73	S
8	A	Post-excavation shot Trench 67	S
9	A	Post-excavation shot Trench 68	S
10	A	Post-excavation shot Trench 66	N
11	A	Post-excavation shot Trench 65	N
12	A	Post-excavation shot Trench 69	S
13	A	Post-excavation shot Trench 70	S
14	A	Post-excavation shot Trench 71	S
15	A	Post-excavation shot Trench 72	S
16	A	Post-excavation shot Trench 73	S
17	B	Post-excavation shot Trench 1	SSE
18	B	Post-excavation shot Trench 2	NNW
19	B	Post-excavation shot Trench 3	SSE
20	B	Post-excavation shot Trench 4	NNW

21	B	Post-excavation shot Trench 5	SSE
22	B	Post-excavation shot Trench 6	W
23	B	Post-excavation shot Trench 7	E
24	B	Post-excavation shot Trench 8	SW
25	B	Post-excavation shot Trench 9	NE

APPENDIX 3: CONTEXT REGISTER

Context No.	Description and Interpretation
[100]	Top-soil – medium grey brown clay loam
[101]	Fine well sorted red brown sandy silt Colluvium
[102]	Orange brown sandy clay with patches of gravel, sand and manganese. Contains occasional sub-rounded boulder. Natural
[2301]	Linear cut angled across Trench 23 NE/SW. Cut has moderately sloping sides and broad concave base. Dimensions; 1.0 m wide by 0.35 m in depth. Filled by (2302) Post medieval field boundary
(2302)	Grey brown sandy clay with occasional sub-rounded stone. Contains bottle glass SF01. Fill of [2301]
[2601]	Linear cut angled across Trench 23 NE/SW. Cut has moderately sloping sides and broad concave base. Dimensions; 1.0 m wide by 0.35 m in depth. Filled by (2602) Post medieval field boundary
(2602)	Grey brown sandy clay with occasional sub-rounded stone. Fill of [2601]
[5101]	Linear cut angled across Trench 51 N/S. Cut has moderately sloping sides and narrow flat base. Dimensions; 0.82 m wide by 0.35 m in depth. Filled by (5102) Possible field boundary of unknown date
(5102)	Grey brown sandy clay with occasional sub-rounded stone. Fill of [5101]
[5501]	Linear cut with rounded terminus aligned E/W. Cut has gently sloping sides and flat base. Dimensions; Observable within trench for 1.80 m by 0.90 m wide by 0.19 m in depth. Filled by (5502). Prehistoric ditch
(5502)	Moderately compact medium grey brown sandy silt with occasional small sub-rounded stones. Contains single flint flake SF 2. Fill of [5501]
[5801]	Large cut across Trench 58 NE/SW. Cut has gently sloping sides and flat base. Dimensions; 8.82 m wide by 1.68 m in depth. Filled by (5802) Probable infilled 19th century quarry scoop
(5802)	Dark brown sandy clay with occasional small stones throughout. Contains flowerpot and white ceramics SF 3. Fill of [5801]
[5901]	Linear cut angled across Trench 59 N/S. Cut has moderately sloping sides and rounded base. Dimensions; 0.72 m wide by 0.33 m in depth. Filled by (5902) Possible field boundary of unknown date
(5902)	Grey brown sandy clay with occasional sub-rounded stone. Fill of [5901]
[7101]	Sub-circular cut. Shallow with gently sloping sides and rounded base. Dimensions; 0.98 m by 0.88 m 0.13 m in depth. Filled by (7102). Prehistoric Pit
(7102)	Dark grey brown sandy clay. Contains numerous inclusions of cremated bone and small sub-rounded stones. Fill of [7101]
[7103]	Sub-circular cut, with almost vertically sloping sides and rounded base. Dimensions; 0.98 m by 1.00 m 0.38 m in depth. Filled by (7104). Prehistoric Pit
(7104)	Compact Dark grey brown sandy clay. Contains numerous inclusions of cremated bone and medium to large sub-rounded stones. Fill of [7103]
[8301]	Large sub-circular ditch cut measuring 7.20 m N/S by 6.82 m E/W. Five 2.0 m wide slots A-E were excavated revealing a cut 0.62 m to 1.10 m wide and with a depth ranging from 0.17 m to 0.35 m. The slots showed a generally steeply sloping sides with a flat base. Slot E appeared stepped along both the inner and outer edges. Filled by (8302) & (8303). Ring-groove structure/barrow of prehistoric date.
(8302)	Large sub-angular stones found throughout [8303] but concentrated within the base of Slots A & B
(8303)	Orange brown sandy clay containing (8302). Also contains occasional fragments of cremated bone. Fill of [8301]

APPENDIX 4: SampleRegister

Context	Litres
[2302]	20
[2602]	20
[5102]	10
[5502]	10
[5902]	10
[7102]	10
[7104]	10
[8303] A	20
[8303] B	20
[8303] C	10
[8303] D	10
[8303] E	20

APPENDIX 5: DRAWING REGISTER

Drawing No.	Details	Scale
1	Plan of Ring-ditch feature	1:20
2	SE facing section Slot A	1:10
3	S facing section Slot B	1:10
4	SE facing section Slot C	1:10
5	NW facing section Slot D	1:10
6	NE facing section Slot E	1:10
7	Plan of Pits [7101] & [7103]	1:20
8	S facing section of Pit [7101]	1:20
9	W facing section of Pit [7103]	1:20

APPENDIX 6: SMALL FINDS REGISTER

No.	Context	Details
1	[2602]	Glass bottle shards
2	[5502]	Flint flake
3	[5802]	Flower pot and white ceramics

APPENDIX 7: 'Discovery and Excavation in Scotland' Report

LOCAL AUTHORITY:	City of Edinburgh Council
PROJECT TITLE/SITE NAME	Land at West Edinburgh, known as Land East of Millburn Tower, Edinburgh: Archaeological Evaluation Report
PROJECT CODE:	AOC 22984
PARISH:	Costorphine
NAME OF CONTRIBUTOR:	Rob Engl & Stuart Wilson
NAME OF ORGANISATION:	AOC Archaeology Group
TYPE(S) OF PROJECT:	Archaeological Evaluation
NMRS NO(S)	None
SITE/MONUMENT TYPE(S):	None
SIGNIFICANT FINDS:	None
NGR (2 letters, 6 figures)	NT
START DATE (this season)	13/5/2015
END DATE (this season)	13/11/2015
PREVIOUS WORK (incl. DES ref.)	None
MAIN DESCRIPTION: (May include information from other fields)	<p>(NARRATIVE) <i>This report presents the results of an archaeological evaluation undertaken by AOC Archaeology Group on behalf of Murray Estates Lothian Limited ahead of the development of land at West Edinburgh, known as 'Land East of Millburn Tower'. The development area totalled 53.99 ha</i></p> <p><i>The evaluation consisted of the machine trenching of 14,700 m². The evaluation trenching was targeted upon anomalies uncovered through an earlier phase of geophysical survey undertaken by AOC in September 2015.</i></p> <p><i>The proposed development was situated in an area of undulating, improved agricultural land and substantial colluvial deposits were encountered within the lower lying areas.</i></p> <p><i>Significant archaeological features were encountered in the form of a ring-ditch/groove structure, two pit features and several linear field boundaries. The majority of these features were of probable late prehistoric date.</i></p>
PROPOSED FUTURE WORK:	None
CAPTION(S) FOR ILLUSTRS:	None
SPONSOR OR FUNDING BODY:	
ADDRESS OF MAIN CONTRIBUTOR:	AOC Archaeology Group
EMAIL ADDRESS:	Admin@aocarchaeology.com
ARCHIVE LOCATION (intended/deposited)	NMRS

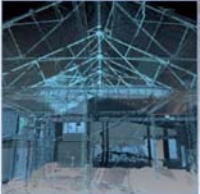

AOC Archaeology Group, Edgefield Industrial Estate, Edgefield Road, Loanhead EH20 9SY
tel: 0131 440 3593 | fax: 0131 440 3422 | e-mail: admin@aocarchoeology.com

www.aocarchoeology.com