

102 St Leonard's Street, Edinburgh: Archaeological Evaluation & Excavation Report

AOC 22968
8th March 2016



ARCHAEOLOGY

HERITAGE

CONSERVATION

102 St Leonard's Street, Edinburgh:

Archaeological Evaluation & Excavation Report

On Behalf of: GVA James Barr
Quayside House
127 Fountainbridge
Edinburgh
EH3 9QG

National Grid Reference (NGR): NT 26597 72652

AOC Project No: 22968

Planning Application No: 14/03643/FUL

OASIS No: 244590

Prepared by: Kevin Paton

Date of Fieldwork: 3rd February to 15th February 2016

Date of Report: 8th March 2016

This document has been prepared in accordance with AOC standard operating procedures.

Author: Kevin Paton

Date: 3rd March 2016

Approved by: Diana Sproat

Date: 8th March 2016

Draft/Final Report Stage: Draft

Date: 8th March 2016

Enquiries to: AOC Archaeology Group
Edgefield Industrial Estate
Edgefield Road
Loanhead
EH20 9SY

Tel. 0131 440 3593
Fax. 0131 440 3422
e-mail. edinburgh@aocarchaeology.com



Contents

	Page
List of Illustrations	2
List of Plates	2
List of Appendices.....	2
SUMMARY	3
1 INTRODUCTION	4
1.1 Project Background	4
1.2 Site Location	4
2 HISTORICAL BACKGROUND	4
3 OBJECTIVES	12
4 METHODOLOGY	12
5 RESULTS.....	13
5.1 Introduction	13
5.2 Evaluation	13
5.3 Excavation	14
6 DISCUSSION.....	18
7 CONCLUSION AND RECOMENDATIONS.....	19
8 REFERENCES	20
8.1 Bibliographic References	20
8.2 Cartographic References	20
APPENDIX 1: EVALUATION TRENCH DESCRIPTIONS	22
APPENDIX 2: CONTEXT REGISTERS	24
APPENDIX 3: PHOTOGRAPHIC REGISTER	35
APPENDIX 4: ' <i>DISCOVERY AND EXCAVATION IN SCOTLAND</i> ' (DES) REPORT	39

List of Illustrations

Figure 1: Site Location

Figure 2: Extract from Adair's map, 1682

Figure 3: Extract from Roy's Military Map of Scotland, ca 1747-55

Figure 4: Extract from Laurie's map, 1766

Figure 5: Extract from Laurie's map 1786

Figure 6: Extract from Ainslie's map, 1804

Figure 7: Extract from Kirkwood's map, 1817

Figure 8: Extract from Kay's map, 1836

Figure 9: Extract from Lancefield's map, 1851

Figure 10: Extract from Ordnance Survey map, 1852

Figure 11: Extract from Ordnance Survey map, 1877

Figure 12: Extract from Ordnance Survey map, 1893

Figure 13: Extract from Ordnance Survey map, 1948

Figure 14: Archive photograph of the Castle O'Clouts pub to the south corner of the development area in the 1960's © RCAHMS

Figure 15: Plan of site showing evaluation trench locations and excavation area

Figure 16: Detailed plan of excavation area

List of Plates

Plate 1: Trench 3, general view of floor surfaces and wall [301]

Plate 2: General view of Upper Level

Plate 3: General view of Lower Level

Plate 4: Upper Level, general view of Corridor 1

Plate 5: Upper Level, general view of Corridor 2

Plate 6: Upper Level, general view of Room 1

Plate 7: Upper Level, general view of Rooms 3 and 4

Plate 8: Upper Level, general view of Room 2

Plate 9: Upper Level, general view of Room 5

Plate 10: Upper Level, general view of Corridor 3 and Room 7

Plate 11: Lower Level, detail of blocked doorway [048]

Plate 12: Lower Level, general view of Rooms 22 and 21

Plate 13: Lower Level, detail of window [045]

Plate 14: Lower Level, detail of stairwell [071]

Plate 15: Lower Level, general view of Corridor 10 and Room 13

Plate 16: Lower Level, general view of Corridor 7

Plate 17: Lower Level, general view of Room 16

Plate 18: Lower Level, general view of Corridor 8 and Rooms 12, 14 and 15

Plate 19: Lower Level, detail of window [089]

Plate 20: Lower Level, detail of fireplace [087]

Plate 21: Lower Level, detail of staircase [095]

Plate 22: Lower Level, detail of ceramic tiles in Room 20

Plate 23: Lower Level, general view of Room 20

Plate 24: Lower Level, detail of window [093]

Plate 25: Lower Level, general view of Room 19

Plate 26: Lower Level, general view of Room 18

List of Appendices

Appendix 1: Evaluation Trench Descriptions

Appendix 2: Context Register

Appendix 3: Photographic Register

Appendix 4: Discovery and Excavation in Scotland Report

SUMMARY

This report presents the results of an archaeological evaluation and subsequent excavation undertaken by AOC Archaeology Group prior to the construction of a new residential and commercial development at 102 St Leonard's Street, Edinburgh.

The initial evaluation showed that a large part of the site had been truncated by the previous modern development. The earliest buildings depicted along the street frontage had all been removed and the site had clearly been reduced to below the 18th and 19th century ground levels. However, the central portion of the development area showed potential for the survival of subterranean structures. Therefore, after discussions with the CEC Archaeology Service, an area of additional excavation was undertaken measuring 30m by 20m within this area.

The excavations revealed the surviving walls and floors of 19th century warehouse cellars. The cellars were constructed on two levels with the 'Upper Level' consisting of sandstone walls with bitumen and wooden floors and the 'Lower Level' consisting of sandstone walls with sandstone flagstone flooring. In total, 23 rooms were identified, with ten linking corridors, a large stairwell, six light wells, five hearths or fireplaces and three external entrances.

Modern repairs and additions were visible throughout suggesting the buildings and rooms were altered and re-used, with some possibly blocked up and the floors removed for use elsewhere. With modern concrete used in the reparations it was not unusual that all of the material culture from the infilling deposits was modern in date.

1 INTRODUCTION

1.1 Project Background

1.1.1 An archaeological evaluation and subsequent excavation was required by GVA James Barr on behalf of their client prior to the development of a residential and commercial development at 102 St Leonard's Street, Edinburgh as part of a planning condition on the development (Planning Ref: 14/03643/FUL). The scope of the works was determined by the City of Edinburgh Council as advised on archaeological matters by the City of Edinburgh Council Archaeology Service (CECAS). The works were conducted according to the terms of a *Written Scheme of Investigation* (AOC 2015) and *Addendum to the Written Scheme of Investigation* (AOC 2016), approved on behalf of City of Edinburgh Council by CECAS and in accordance with *Scottish Planning Policy* (Scottish Government 2014) and *PAN 2/2011 Planning And Archaeology* (Scottish Government 2011).

1.2 Site Location

1.2.1 The site at 102 St Leonard's Street is located to the north-east of St Leonard's Street and was most recently occupied by the Homebase Store and its associated car park (Figure 1). The site is centred on NGR: NT 26597 72652 and is bounded to the south-east by St Leonard's Church, to the north-east by flats associated with Parkside Terrace and to the north-west by the flats associated with Parkside Street.

2 HISTORICAL BACKGROUND

2.1 Historic mapping evidence for the area is quite small scale prior to the mid-19th century. However, early maps do give an idea of the layout of the city and the development area from the late 17th century onwards. Although quite schematic, Adair's 1682 map shows there to be no expansion of the city southwards within the vicinity of the Dalkeith Road at this time (Figure 2). Some development appears to be edging southwards, although the Dalkeith Road here looks to be relatively less-defined in comparison with its neighbour to the west (what is now Clerk Street and Minto Street). Into the 18th century, there is some expansion of this main road towards Dalkeith as it becomes more well-used. For example, in Roy's Military Map of Scotland (ca. 1747 – 55) there are some buildings noted along the side of this road to the north of the development area, although in the site itself, there appears only to be cultivated land (Figure 3). Historic sources have identified the Castle O'Clouts pub as having been established in 1724 by William Hunter, a tailor burghess of Edinburgh (Internet Source 1 & 3; Harris 1996; Chambers 1825). Chambers notes in a footnote of his book 'Traditions of Edinburgh' '*...a goodly house of three storeys upon the Dalkeith Road, near the city, which was built about sixty years ago by one Hunter, a tailor... sneeringly denominated the Castle o' Clouts.*' (quoted in Internet Source 3). Apparently '*...Hunter was so proud of his achievement that he aimed at perpetuating it by having his likeness carved in stone on the back of his house. This memorial existed at the beginning of the present [19th] century, but whether it is still there the writer cannot say.*' (*ibid*). Hence if this information has been correctly sourced, then Roy's map must be too small scale to show the pub.

2.2 Laurie's maps of 1766 and 1786 respectively are a little larger in scale and do depict buildings within the development area, one of which may be the Castle O'Clouts (Figures 4 & 5). In the 20 year gap between the maps there has been some additional development, including tenement buildings to the north of the site. The Gibbet Toll is also marked, and was used for executions. Although not recorded on the earlier maps, this site is thought to have origins going back to the late 16th century. It was positioned at the corner of Dalkeith Road and Holyrood Park Road, between what are now the Scottish Widows building and the Royal Commonwealth Pool, to the south of the development area.

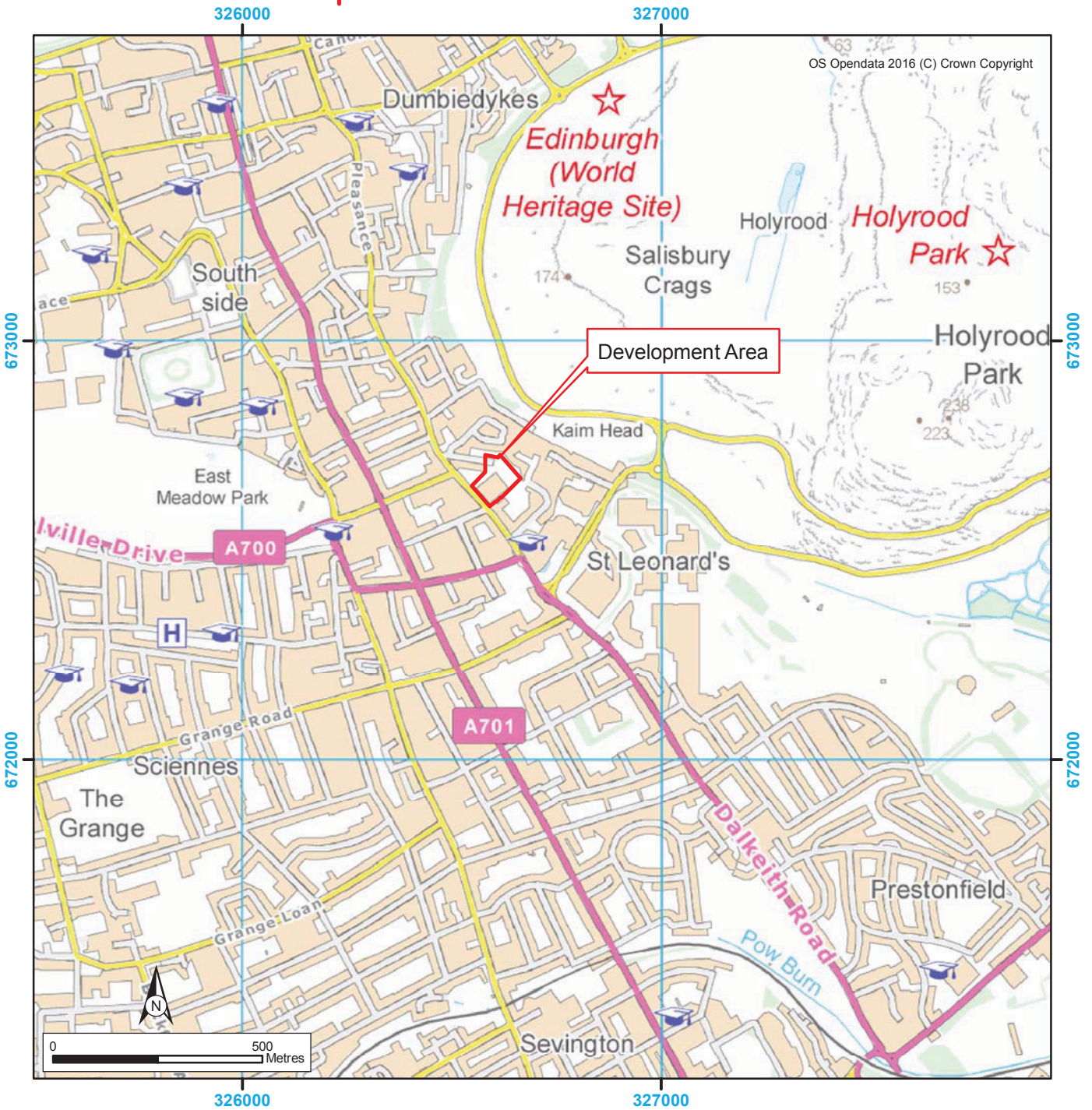
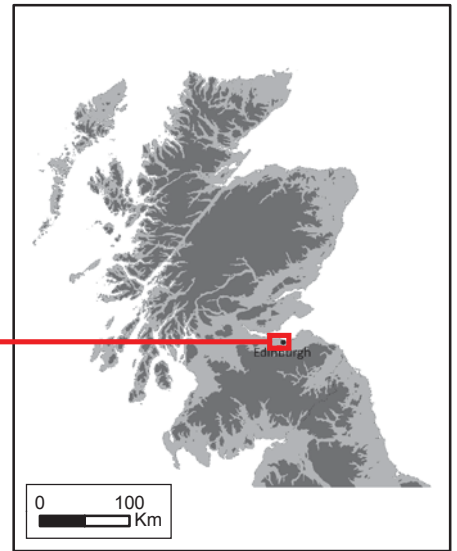
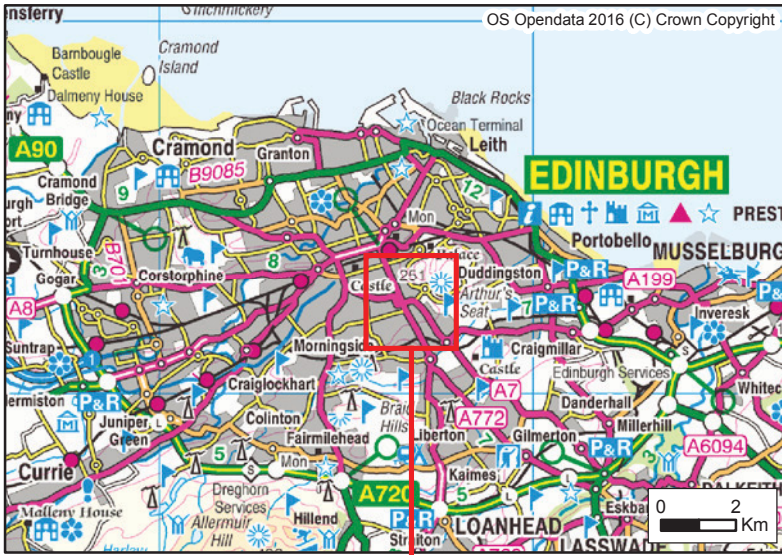

Figure 1: Site location plan



Figure 2: Extract from Adair's map, 1682



Figure 3: Extract from Roy's Military Map of Scotland, ca. 1747 - 1755



Figure 4: Extract from Laurie's map, 1766



Figure 5: Extract from Laurie's map, 1786

2.3 The earliest cartographic evidence for the development area and its environs in detail comes with the publication of John Ainslie's 1804 map (Figure 6). Here, the north-east/south-west angled boundary that marks the future position of Parkside Place can be seen bounding the north of 'Mrs Innes's Land'. The map then clearly shows a number of buildings on the north-east side of St Leonards Street, behind which is a large area of landscaped garden with a cross pathway. 13 years later, in Robert Kirkwood's 1817 map, there appears no change in the layout of the site, although Mrs Innes's Land is now annotated as belonging to 'Mr Bell' (Figure 7).



Figure 6: Extract from Ainslie's map, 1804



Figure 7: Extract from Kirkwood's map, 1817

2.4 By the 1830s, Kay's map (1836) identifies that the streets have become more formalised. Unfortunately only the northern part of the development area can be seen in this town plan, although Parkside Place has been established as has Henry Street (the north-east/south-west street to the west of the development area) (Figure 8). The tenements that comprise Nos 2 – 24 & 66 – 72 Parkside Place, 79A – 92 St Leonards Street and 94 St Leonards Street (now demolished) have also been established, as has a much larger expanse of buildings centred around the newly formed Henry Street to the east of this (also now demolished). Although not annotated on this map, it is thought that around 1838, the Castle O'Clouts pub got its present name, previously being referred to as Huntershell (Harris 1996). A much clearer picture of the area can then be seen in Lancefield's 1851 map (Figure 9). The tenements around Parkside Place are shown, as are those at Henry Street. In the south corner of the development area is the Castle O'Clouts pub, behind which is a range of two large buildings, possibly warehouses or storehouses. There is a house depicted to the north-west of the pub, which is a north-west/south-east orientated block with a wing to the north-east side. It is set in its own grounds.



Figure 8: Extract from Kay's map, 1836

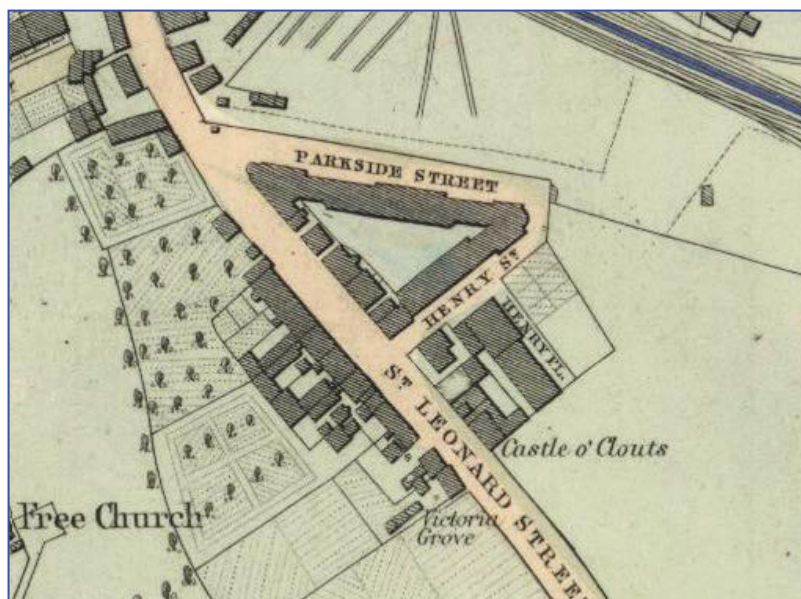

Figure 9: Extract from Lancefield's map, 1851

- 2.5 The detailed Town Plan Ordnance Survey map of 1852 shows a much clearer and more accurate picture of the development area and its environs in the mid-19th century (Figure 10). The Castle O' Clouts pub is depicted to the south of the site with a pend to its north-western side. This leads through a small yard to a range of buildings. The buildings to the rear of this are shown as a large warehouse to the south-east side and another to its north-west. There is a large stairway on the south-east side of the latter. Henry Place backs onto the rear of these buildings. The house can also be seen in much closer detail here with its own discreet gardens and a boundary wall, with some ancillary buildings to its north-east.

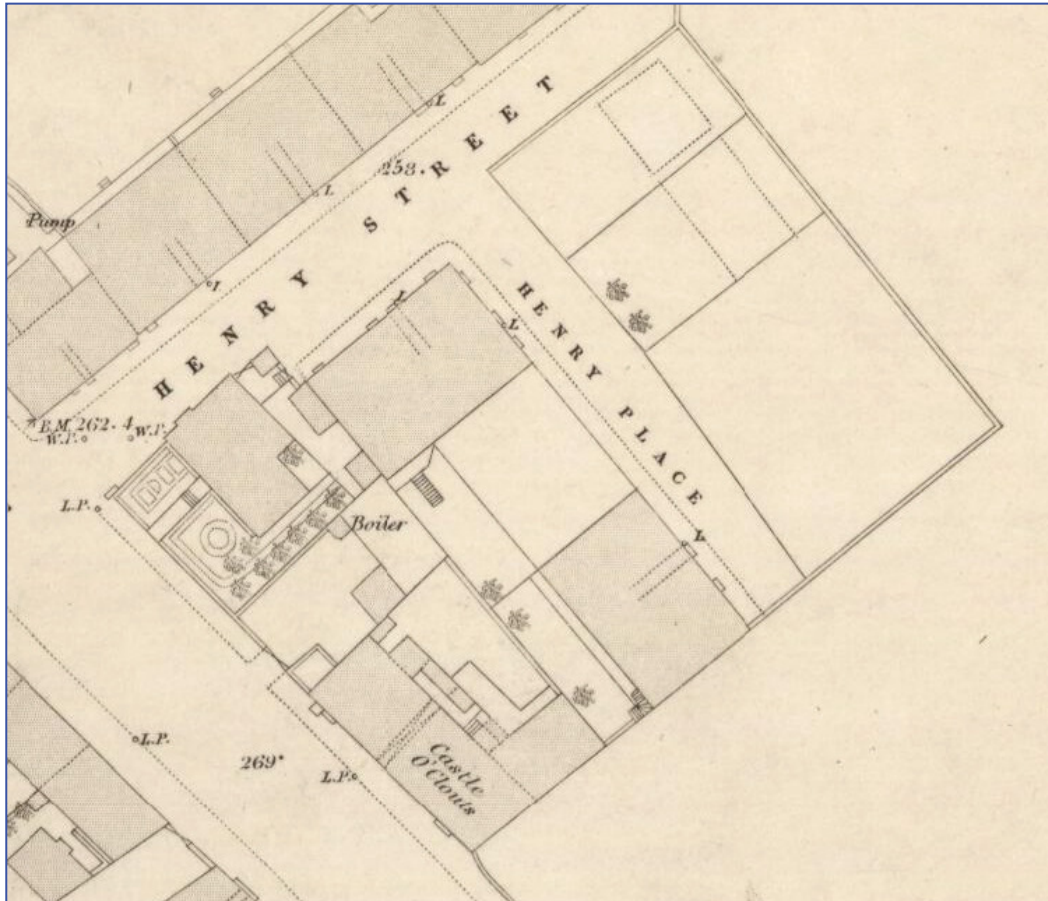

Figure 10: Extract from Ordnance Survey map, 1852

- 2.6 By the late 1870s there has been significant industrial expansion in the area, especially to the north and east of the site, as is depicted in the Town Plan of 1877 (Figure 11). The major expansions include the Parkside Brewery to the north-east of the development area and the St Leonards Station and Coal Depot. The Castle O' Clouts pub is still annotated, with its pend and additional buildings. However, the warehouses to the north-west of this have been expanded with another building constructed between the two that are depicted on the 1852 map. To the north-east side of Henry Place, a number of other - possibly industrial - units have been built, set within their own discreet boundary wall.
- 2.7 The later 19th century also saw further expansion of the area, as depicted in the 1894 Ordnance Survey map (Figure 12). St Leonard's Church has been established to the south-east of the development area and was constructed in 1880 for the congregation in Newington. There had also been major development to the south-east of this, with the establishment of Nelson's Parkside Printing Works and a large row of tenements between these Works and St Leonard's Church. Within the development area, little has changed since the 1870s, apart from some additional buildings to the north-west of the pub complex. The house also appears to now be connected to the warehouse buildings behind. The buildings to the rear of the development area (to

the north-east) are also as depicted in the 1877 map, and one of the larger buildings is now annotated as a smithy.

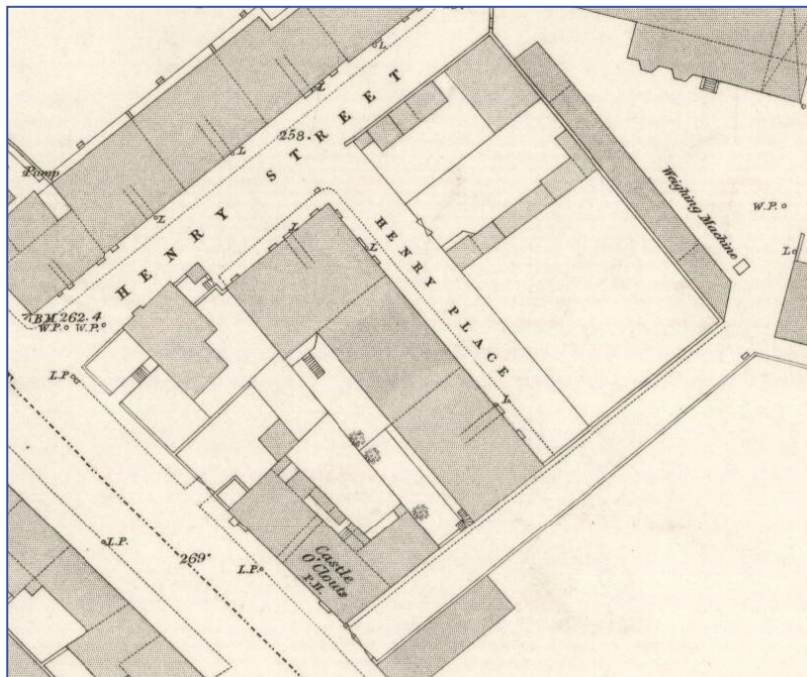

Figure 11: Extract from Ordnance Survey map, 1877



Figure 12: Extract from Ordnance Survey map, 1893

- 2.8 The 1948 Ordnance Survey map shows the development of the site up until the mid-20th century (Figure 13). Both the large industrial sites of the Brewery and the Printing Works, together with the railway, are still shown in operation, and the area is heavily built up with tenements at Parkside Street and Parkside Terrace. The development area itself, however, looks little changed from the earlier late 19th century map. Archive

photographs of the site from the 1960s depict the Castle O'Clouts pub and adjacent buildings (Internet Source 1 & 2; Figure 14). The pub is depicted at ground floor level of a four-storey building with an upper gable front to the centre two bays rising above the eaves of the sharply pitched slate roof with chimneys at each gable. Adjacent and abutting the building is another four-storey tenement of a different phase with a chimney to the front.

- 2.9 The 1976 Ordnance Survey map shows that the buildings to the front (south-west) of the site adjacent to the road - including the Castle O'Clouts pub and the adjacent house - have been demolished by this time; the Castle O'Clouts was demolished in 1969 (Internet Source 3). The Parkside Brewery has also been taken down and the railway is disused. The demolition of all the previous buildings within the development area made way for the present Homebase and its associated car park.

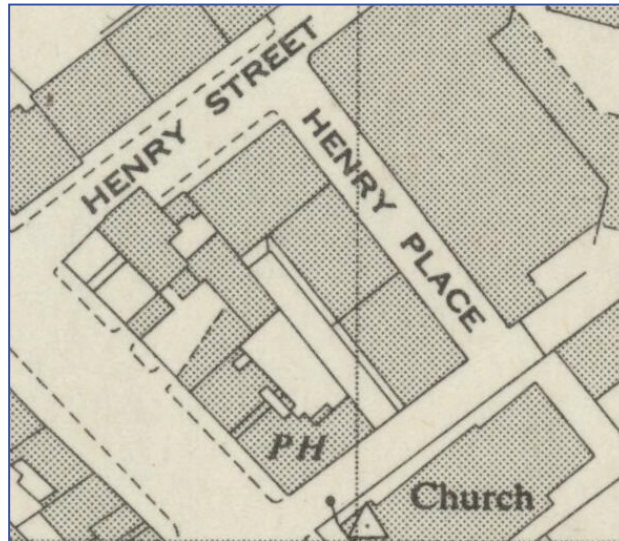

Figure 13: Extract from Ordnance Survey map, 1948

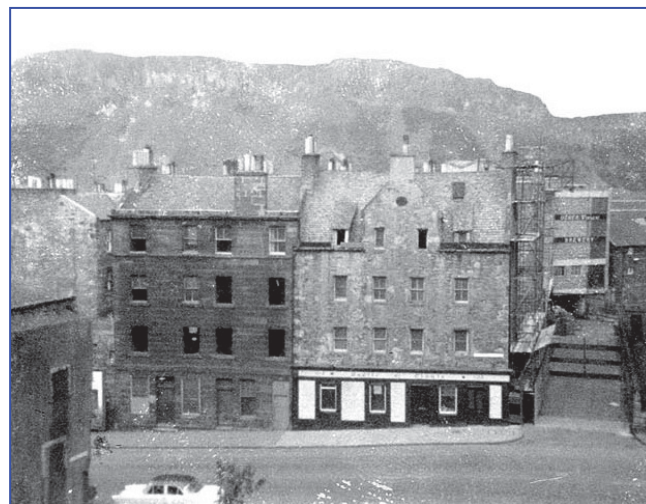

Figure 14: Archive photograph of the Castle O'Clouts pub to the south corner of the development area in the 1960s © RCAHMS

3 OBJECTIVES

3.1 The objectives of the archaeological evaluation were:

- i) to determine and assess the character, extent, condition, quality, date and significance of any buried archaeological remains within the proposed development area through evaluation trenching;
- ii) to advise and implement an appropriate form of mitigation, such as excavation, post-excavation analyses and publication, given the infeasibility of preserving the archaeological material *in situ*, should significant archaeological remains be encountered.

3.2 The objectives of the archaeological excavation were:

- i) To expose the surviving archaeology within the development footprint through the application of a controlled strip around the marked area, recording all significant archaeological features within the area;
- ii) To liaise with CECAS and the client in order to mitigate against possible damage to the archaeology if it cannot be preserved *in-situ*.

4 METHODOLOGY

4.1 The evaluation phase of works consisted of seven trenches excavated using a 30 tonne tracked excavator utilising a bladed ditching bucket operating under the constant supervision of an experienced field archaeologist. Each trench was recorded using AOC *pro forma* trench record sheets and any potential features investigated further to assess their character and date.

4.3 Due to the findings of the significant archaeology in a discreet area during the evaluation, a 30m by 20m excavation area was opened up, after discussions with the client and CECAS. The excavation area was stripped of overburden by a 30 tonne and 13 tonne excavator utilising a bladed ditching bucket and/or a narrow toothed bucket where required. All machine excavation was conducted under the constant supervision of an experienced field archaeologist. All features and structures revealed were then cleaned by hand before being recorded by digital photography, surveyed in detail and then a written record produced using AOC *pro forma* context sheets.

5 RESULTS

5.1 Introduction

5.1.1 All archaeological works were conducted between the 3rd February 2016 and the 15th February 2016. Weather conditions were generally fair throughout the course of the work and archaeological visibility was good.

5.1.2 The various data gathered from the evaluation and excavations are presented as a series of appendices:

Appendix 1: Evaluation trench descriptions

Appendix 2: Context Register;

Appendix 3: Photographic Register;

Appendix 4: *'Discovery and Excavation in Scotland'* (DES) entry

5.2 Evaluation

5.2.1 A total of seven trenches were excavated throughout the development area (Figure 15). The trenches largely showed that the site contained 0.3m to 0.7m of modern hardcore [001] throughout, used for levelling the site for the modern floor slab. This deposit directly overlay a pink boulder clay (natural) in Trenches 1, 2 and 6. Trenches 4, 5 and 7, however, revealed that layer [001] overlay a significantly deeper modern made ground up to 1m in depth. Trench 4 also revealed parts of the former Henry Street road with some areas of cobbled surface still surviving the modern drainage to the north-east end of the trench.

5.2.2 Trench 3, positioned to the south-east of Henry Street revealed a bitumen and wooden floor surface [301], with some sandstone flagstone [306] bounded by a north-east/south-west-aligned sandstone wall [302] (Plate 1). To the immediate N of this wall was a cellar area with wall [305] in the W edge of the trench, with another NW-SE aligned wall [304] at the northern end of the trench that had been excavated into the natural subsoil. Due to these findings an excavation around these features was required.



Plate 1: Trench 3, general view of floor surfaces and wall [301]

5.3 Excavation

5.3.1 The total area excavated was a 30m by 20m area that revealed two subterranean floor levels related to the early 19th century and later buildings that occupied the central part of the site (Figure 16; Plates 2 & 3). The features, walls and floors of the buildings were covered in a made ground deposit [002] consisting of re-deposited clay and demolition rubble that underlay the hardcore [001] related to the previous building level. Due to the differing nature of the buildings the site was split into two areas: 'Upper Level' and 'Lower Level'.

Upper Level

5.3.2 The Upper Level contained seven rooms that were contained by outer walls [044] and [007] to the north-east and south-west respectively (Figure 16). The south-east edge had been truncated by the previous development, and the north-west edge was bounded by wall [038], that also formed the south-east wall of the Lower Level. The total size of the remains of this level measured 15m by 11m with the walls surviving to 0.4m in height in some places, constructed into the natural clay subsoil.

5.3.3 The three main walls [007], [038] and [044] were all of sandstone construction and keyed into each other, measuring 0.65m to 0.75m wide. Along the south-west edge and aligned north-west/south-east, parallel to [007], another slightly narrower sandstone wall [003] was revealed containing entrance [005]. The gap between walls [003] and [007] formed a long corridor (Corridor 1, [004]) that was contained at the north-west end by wall [046]. The corridor measured 12m long by 1.15m wide and was floored by large, squared flagstones [006] (Plate 4). This corridor was accessed from outside the building via doorway [005] which in turn led into Corridor 2 [020], via doorway [030], which was also floored with similar flagstones [014]. This corridor was formed by sandstone wall [016] to the north-west and brick wall [013] to the south-east and would most likely have allowed access to Room 1 [019] to the south-east and Room 3 [023] to the north-east (Plate 5). Corridor 2, Room 1 and Room 3 had all been truncated to the north-east and south-east by the previous construction on the site.

5.3.4 Room 1 was bounded by outer wall [007] to the south-west and internal wall [013] to the north-west and contained a hearth or fireplace [015] in the western corner consisting of a large rectangular flagstone with a smaller trapezoidal flagstone at the back (Plate 6). There were also two recesses in wall [007] within this room. The room was floored by bitumen and timber surfaces [010] and [012] with a possible partition wall [011] between. Room 3 was floored with large, squared flagstones [024] that were truncated to the north-east and south-east (Plate 7). Narrow brick walls [025] and [027] divided Room 3 from Room 2 [021] to the south-west and Room 4 [028] to the north-west.

5.3.5 Access to these rooms was not obvious as there was no clear entrance from Corridor 2 or Corridor 1. It is assumed that access must have been from Corridor 1 through a doorway in wall [007] that was later truncated by a modern drain [018]. Room 2 was bounded by walls [007] to the south-west, [016] to the south-east, [025] to the north-east and [031] to the north-west and measured 3.3m by 3.4m (Plate 8). It also contained a hearth or fireplace [017] that was similar in construction to [015] and was set within wall [016] that divided the room from Corridor 2. This room was also floored by a bitumen and timber surface [022], and contained a recess within the north-west wall [007].

5.3.6 Doorway [026] allowed access from Room 2 into the L-shaped Room 4 to the north-east that functioned as a short corridor linking Room 2 and Room 5 [032], via doorway [036]. It also appeared to function as a storage space or utility room that contained a fragmented sandstone base [055] set within a repaired cement and flagstone floor [029] that showed signs of having large iron objects placed upon it (see Plate 7). This room was bounded by sandstone wall [040] to the north-west, [039] to the north-east, brick wall [027] to the south-east and sandstone wall [037]/ brick wall [025] to the south-west. It measured 3.4m by 2.1m and 4.1m by 1.5m.

5.3.7 Room 5 was the largest room set in the western corner of the Upper Level, bounded by walls [007] to the south-west, [038] to the north-west, [037] to the north-east, and [031] to the south-east, measuring 5.3m by

4m (Plate 9). Like Rooms 1 and 2 it was floored by bitumen and timber surface [033] and contained a hearth or fireplace [035] set within wall [038]. This room also contained one recess within north-west wall [007] that contained a square flagstone block [034] with ceramic pipes next to it that had truncated the original wall line indicating a later addition.

- 5.3.8 To the north-east of wall [037] from Room 5 and to the north-west of wall [040] from Room 4 there was a small room or cupboard (Room 6 [041]) that measured 2m by 1.8m. This small space no longer retained its floor but was bounded by [038] to the north-west and accessed through doorway [052], set within the north-east wall [039]. This wall also formed the south-west wall of a probable corridor (Corridor 3 [042]) that was floored with large flagstones [043] (Plate 10). The south-east end of this corridor was truncated, as was the probable north-east boundary wall that would have separated it from Room 7 [053]. This room contained no floor surface or other boundary wall other than the main outer wall [044] to the north-east.

Lower Level

- 5.3.9 Due to the increased depth at which this level was constructed, there was greater survival of the walls, which were up to 1m high in places, with plaster still adhering to the faces prior to removal of the made ground within the rooms. This level was bounded by Walls [038] and [051] to the south-east, Wall [049] to the south-west, Wall [094] to the north-west and Wall [067] to the north-east (Figure 16; see Plate 3). Walls [049], [094] and [067] were all sandstone walls measuring between 0.55m to 0.7m in width and were keyed into each other with the south-east ends of [049] and [067] abutting walls [051] and [038] respectively.
- 5.3.10 Access to this level was gained from three different locations. Firstly, an external corridor (Corridor 4 [050]) located outside the southern corner of the Lower Level would have provided access to rooms along the south-west edge. This corridor was formed by Walls [046] to the north-east, [047] to the south-west, [008] to the south-east, and [051] to the north-west. It measured 5.5m by 1.53m and no longer contained a floor surface. Doorway and stairs [048] were set within wall [051] to allow access from external Corridor 4 into internal Corridor 5 [056], but this was later blocked up with brick (Plate 11).
- 5.3.11 Corridor 5 was floored with large squared flagstone floor [064] and measured 7.2m by 1m and was bounded by wall [054] to the north-east for most of its length with the far north-west end forming a small narrow space defined by Wall [117] and abutment [115] to the south-west, Wall [118] and abutment [116] to the north-east, and end Wall [123] to the north-west. To the south-west of the corridor there were four narrow rectangular rooms - Room 8 [057], Room 9 [058], Room 22 [102] and Room 21 [103] - backing onto main Wall [049] and each measuring approximately 2.25m in length and 1.15m wide (Plate 12). Walls [059], [066] and [096] divided the rooms and each one was floored with irregularly-shaped and sized sandstone flagstone floors [060], [063], [098] and [100] respectively. Before the corridor reached the narrow end point there is a doorway [122] to the north-east that led into the central area of the Lower Level and Room 11 [083].
- 5.3.12 Room 11 contained light well [045] in the southern corner consisting of a large stone lintel placed between walls [007] and [051] (Plate 13). The stone lintel and the bay area below have been rendered in concrete in more recent times. Other evidence of modern repairs and re-use within this room is the removal of the floor [081], which only survives as two truncated flagstones abutting wall [038] in the eastern corner, and the presence of a concrete strap at the face of the base of Wall [054]. The north-east edge of the room appears to continue into Room 10 [082], although wall remnants [080] and [076] may have formed a now demolished north-east division. To the north-west edge of the room, the boundary wall is a curving sandstone wall that forms the outer edge of stairwell [071]. The other side of the stairwell is within Room 13 [085] that joins Room 11 in its western corner.
- 5.3.13 This is where the second access point to the Lower level would have been, via the central spiral stairwell [071] (Plate 14). The stairwell consists of curving sandstone outer wall [072] and inner sandstone and brick wall [073] that contained a rubble core [075]. The large stone steps [074] were laid upon this rubble core and the internal faces of the two walls, with only one step surviving intact. A large supporting wall [078] (now

mainly demolished) is present at the south-west end of the stairwell. The stairwell would have measured 1m wide internally and led from an upper floor level into the north-east edge of Hallway/Room 13 [085].

- 5.3.14 Room 13 was floored with large squared flagstones [077] and bounded by walls [079] to the north-east, stairwell [071] to the south-east, wall [120] to the north-west, and the north-west end of Room 11 and Corridor 10 [157] to the south-west (Plate 15). It measured 4.27m by 3.96m and would have acted as a hallway allowing access to all areas around the edges of the building via the other corridors and rooms. Within wall [120], which divides Room 13 and Room 18 [106], a direct access route through doorway [121] had been blocked with a sandstone wall, requiring a route through Corridor 10, and Corridor 6 [112] to access the room.
- 5.3.15 Corridor 10 was accessed via doorway/threshold [158] and formed by Walls [119] to the south-east and [118] to the south-west. It measured 3.7m by 1.1m and was floored with large squared flagstones [160] and joined to Corridor 6 [112] via doorway/threshold [159] to the north-west. Another Corridor leading from Room 13 is Corridor 7 [113], entered through doorway [135] between the north-east end of wall [120] and the south-west end of wall [155] (Plate 16). This corridor was formed by wall [128] to the south and wall [134] to the north-east and appeared to have been used latterly as a service corridor with ceramic pipes set into brick work [164] within a truncation of Wall [094] at the north-west end, and other pipes visible running under the made ground that constitutes the floor of the corridor, the original floor most likely having been removed.
- 5.3.16 From Corridor 7 it is possible to access Corridor 9 [137] through doorway [136], which was floored with large squared flagstones [138] and measured 2.35m by 0.95m from doorway [136] to doorway/threshold [139]. This corridor allowed access to Room 17 [107] to the north-west and Room 16 [108] to the north-east via doorways [140] and [139] respectively. Room 17 was a narrow rectangular room, similar to Rooms 8, 9, 22, and 21 and was also floored with irregular sandstone flagstones [141] that have been mainly replaced by concrete. The room measured 3.23m by 1.47m, and is bounded by Wall [134] to the south-west and Wall [142] to the north-east. Room 16 in contrast was a large square room in the northern corner of the building bounded by Walls [094] and [067] to the north-east and north-west, and Walls [155] and [142] to the south-east and south-west (Plate 17). It measured 3.55m by 4.26m and is floored with large, squared flagstones [143] and would have been lit by two windows, [091] on the north-west wall and [090] in the north-east wall. Both were of similar construction to window [045], with [091] having been similarly blocked by a concrete slab. Window [090] did not appear to have been blocked although only the window base lintel survives. Also within Room 16 was a small structure [144] in the eastern corner consisting of two sandstone blocks sitting either side of a small gap (1.32m by 0.44m) that could be interpreted as a small cupboard space or the supports for an unknown feature.
- 5.3.17 Within Wall [155] to the south-east of Room 16 there was access to Corridor 8 [114] through doorway [145]. This corridor divides Room 23 [111] to the north-east from Room 12 [084], Room 14 [110] and Room 15 [109] to the south-west. It also led into Room 10 [082] at its south-east end and was floored with large squared flagstones [152], measuring 3.97m by 1m (Plate 18). Room 23 to the north-east of Corridor 8 was accessed through doorway [153] within wall [154] that also forms the south-west boundary to the room. The other walls forming the room are [155] to the north-west, [068] to the SE and [067] to the north-east, the room dimensions measuring 3.6m by 2.51m. No floor surface survived within Room 23 although it would have been lit by window [089] which had survived intact and unblocked. The window was outside the main wall [067] and consisted of a rectangular space formed by thin sandstone walls consisting of rough-edged sandstone blocks and floored by small, square sandstone flagstones that sat approximately 0.05m below the window sill/lintel. The base of the well measured 1.15m by 0.46m, with a small hole within the corner of four of the flagstones in the floor to the south-east of centre that would have allowed for drainage of water within the well (Plate 19).
- 5.3.18 Across to the south-west of Corridor 8, the three rooms in this area are of varying sizes truncated by a large modern emplacement [148] (see Plate 18). The least truncated of the rooms is Room 12 to the south-east end of the corridor that is accessed via doorway [162] and contained an irregular flagstone floor surface

[069], measuring 1.7m by 1m. To the north-west - and divided by truncated wall [156] - is Room 14 that had some irregular flagstones [150] surviving but have been removed to the south-west end of the room. This room measured 1.7m by 0.74m and was accessed via doorway/threshold [151]. At the north-west end of the corridor, and divided from Room 14 by brick partition wall [149], was Room 15 that had little of its floor intact and was mainly filled with the modern concreted mass [148]. It would originally have measured 1.7m by 1.48m and was accessed via threshold [146].

- 5.3.19 Corridor 8 then led into Room 10 [082], through doorway [086] at the south-east end which was bounded by walls [038] to the south-east, [067] to the north-east, [068] to the north-west and [076]/[080] to the south-west, measuring 5.4m by 2.9m. The south-west edge of the room may have been a small cupboard space between walls [070] and [076]/[080] although truncation of the room below floor level makes this interpretation difficult. Within the room there is a blocked window [088] that was similar to windows [045] and [091]. There was also a fireplace [087] with a truncated hearth set within wall [038] (Plate 20). The hearth measured 0.7m by 0.35m and set between two upright sandstone slabs. The hearth stone was set on top of two courses of roughly laid brick and mortar.
- 5.3.20 The final and most recently constructed access to the Lower Level would have been via staircase [095] set within the north-west end of wall [049] (Plate 21). This staircase was constructed through Wall [049] with brick used to repair the truncation and the seven steps that survived made from poured concrete. The stairs were 0.98m wide and descended steeply from a height of 1.17m over a length of 1.4m. The steps entered into Room 20 [104] which contained a small remnant of flagstone floor [161] and was latterly used as a storage area containing stacks of ceramic tiles and slates (Plate 22). The room was a broad L-shape bounded by walls [123]/[097] to the south-east, [049] to the south-west, [094] to the north-west, and [124] to the north-east and measured 5.58m by 3.38m (Plate 23). It contained an intact window [093], set within wall [094] that was similar in size to window [089]. The construction of the window differed as the back wall had angled sandstone flagstones as the wall face and a ceramic tile drain in the base of it (Plate 24). Room 20 would formerly have been accessed via Corridor 6 through doorway [131] which is formed by the south-east end of wall [124] and wall [123]. This corridor was floored with large squared flagstones [130] and led into Rooms 19 [105] and 18 [106], as well as stairwell [071] within Room 13.
- 5.3.21 Room 19 was a narrow rectangular room formed by wall [094] to the north-west, [124] to the south-west, and [126] to the north-east, measuring 2.94m by 1.47m (Plate 25). It was accessed via doorway [133] at the south-east end of Walls [124] and [126] and was floored by irregular sandstone flagstones [125]. Room 18 was another large square-shaped space measuring 4.18m by 3.38m and formed by wall [120] to the SE, [094] to the NW, [126] to the SW and [128] to the NE (Plate 26). The room is accessed through doorway [132] between the south-east end of Wall [126] and Wall [120], and was floored by large squared flagstones [127] that had been truncated by concrete in the north-west half of the room.
- 5.3.22 This room contained window [092], which was set within wall [094], that was similar in size and construction to [093]. It also contained a fireplace [129] within Wall [128] that measured 0.72m by 0.26m with the same upright slabs on either side of the hearth as fireplace [087].

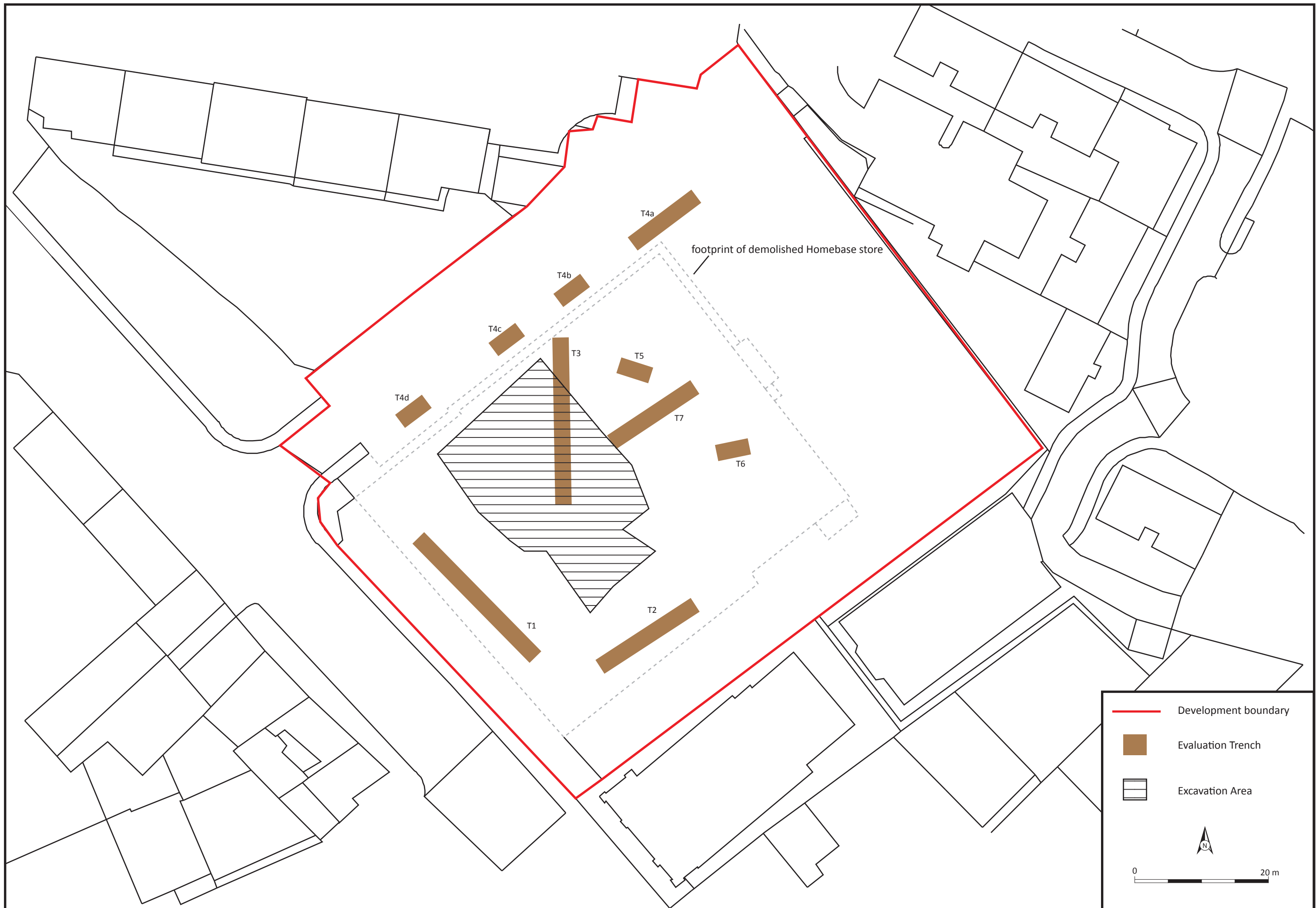

Figure 15: Site plan showing location of evaluation trenches and excavation area



KEY

- stone flagged flooring
- stone base of fireplace
- brick
- sandstone walling
- bitumen surface
- 77.930 ↗ Levels



Figure 16: Plan of excavation area **AOC** Archaeology Group



Plate 1: Trench 3, general view of floor surfaces and wall [301]



Plate 2: General view of Upper Level



Plate 3: General view of Lower Level



Plate 4: Upper Level, general view of Corridor 1



Plate 5: Upper Level, general view of Corridor 2



Plate 6: Upper Level, general view of Room 1



Plate 7: Upper Level, general view of Rooms 3 and 4



Plate 8: Upper Level, general view of Room 2



Plate 9: Upper Level, general view of Room 5



Plate 10: Upper Level, general view of Corridor 3 and Room 7



Plate 11: Lower Level, detail of blocked doorway [048]



Plate 12: Lower Level, general view of Rooms 22 and 21



Plate 13: Lower Level, detail of window [045]



Plate 14: Lower Level, detail of stairwell [071]



Plate 15: Lower Level, general view of Corridor 10 and Room 13



Plate 16: Lower Level, general view of Corridor 7



Plate 17: Lower Level, general view of Room 16



Plate 18: Lower Level, general view of Corridor 8 and Rooms 12, 14 and 15



Plate 19: Lower Level, detail of window [089]



Plate 20: Lower Level, detail of fireplace [087]



Plate 21: Lower Level, detail of staircase [095]



Plate 22: Lower Level, detail of ceramic tiles in Room 20



Plate 23: Lower Level, general view of Room 20



Plate 24: Lower Level, detail of window [093]



Plate 25: Lower Level, general view of Room 19



Plate 26: Lower Level, general view of Room 18

6 DISCUSSION

- 6.1 The archaeological evaluation and excavations completed at 102 St Leonard's Street have shown that the majority of the earliest buildings on the site – the Castle O'Clouts pub and the house in the western corner - have been entirely removed by the later Homebase construction on the site. Furthermore, the north-east edge of the development site has also been heavily truncated by the later construction works, with no evidence of Henry Place or the buildings beyond it.
- 6.2 The only building remains that have survived are those that formed cellars or sunken floors of the large warehouse structures depicted to the south-west of Henry Place. Looking at the cartographic evidence these buildings may have been constructed some time between Kirkwood's 1817 map (Figure 7) and Kay's 1836 map (Figure 8), but are not shown in detail until the Ordnance Survey of 1852 (Figure 18). At this point it appears that only the Lower Level building had been constructed as the Upper Level is depicted as a blank space between the Lower Level and a building that no longer exists to the south-east edge of the site. This is in contrast to Lancefield's 1851 map that depicts a row of joined buildings along the south-west edge of Henry Place. Lancefield's depiction is also evidenced by the excavation results as the Lower Level walls [067] and [049] clearly abuts the Upper Level Wall [038] implying that the Upper Level was constructed first.
- 6.3 The Ordnance Survey map shows the Lower Level set back from Henry Street with six windows revealed in the excavations along the north-west and north-east walls clearly marked on the map. The map also depicts a doorway in the north-west wall that would have been at a higher level than the surviving remains. Corridor 4 is also shown as an external corridor accessed via a set of stairs that were also at a higher level and did not survive. The light well in this corridor is not depicted and neither is Corridor 1 along the south-west edge of the Upper Level. It is not until the 1893 Ordnance Survey that this corridor forms part of the buildings, indicating it is a much later addition (Figure 12).
- 6.4 From the results of the excavation it is clear that these warehouses continued to be used into the late 20th century, evidenced by the concrete steps [095], the stacks of terracotta tiles and slates within Room 20, the amount of modern rubbish that filled the base of the light wells, and the presence of modern concrete floors patching some of the room surfaces. Furthermore, it appears that parts of the warehouse Lower Level may have been shut off with windows being blocked and floor surfaces being removed. The concrete straps at the base of the walls within Room 11 may also indicate the structure was becoming unsafe and in need of structural repairs.
- 6.5 From the size of the rooms and the elements within them it can be suggested that the Upper Level was used more for office space with the wooden floors and hearths in each room. In the Lower Level, the lack of windows along the south-west edge suggests this was the main storage area with access via Corridor 4. The other areas were more readily accessed via the central stairwell with Room 10 and Room 18 more likely to be office spaces with fireplaces and the larger rooms (Room 23, 16 and 11) being work spaces.

7 CONCLUSION AND RECOMENDATIONS

- 7.1 The archaeological excavations revealed the limited survival of the subterranean sections of the 19th Century warehouses within the development area, and have shown that the ealriest structures depicted on the site did not survive the late 20th century development.
- 7.2 The evaluation and excavations provided a safeguard for all archaeological remains on the site, which have now been excavated and recorded prior to their complete removal or truncation by the upcoming development.
- 7.3 It is not recommended that any further post-excavation works are conducted. This recommendation will require approval of the CEC Archaeology Service who advise the CEC on archaeological planning matters.

8 REFERENCES

8.1 Bibliographic References

Harris, S 1996 *Place Names of Edinburgh: Their Origin and History*. Gordon Wright: Edinburgh

HMSO 1979 *Ancient Monuments and Archaeological Areas Act 1979*.

HMSO 1997 *Town and Country Planning (Scotland) Act 1997*.

HMSO 1997 *Planning (Listed Buildings and Conservation Areas) (Scotland) Act 1997*.

HMSO 2011 *Historic Environment (Amendment)(Scotland) Act 2011*.

Historic Scotland 2011 SHEP *Scottish Historic Environment Policy*.

Scottish Government 2011 PAN2/2011 *Planning and Archaeology*.

Scottish Government 2014 *Scottish Planning Policy*.

8.2 Cartographic References

1682	John Adair	<i>Map of Midlothian</i>
ca.1747 – 55	William Roy	<i>Military Map of Scotland</i>
1766	John Laurie	<i>A Plan of Edinburgh and Country Adjacent</i>
1786	John Laurie	<i>A Plan of Edinburgh and Country Adjacent</i>
1804	John Ainslie	<i>Old and new Town of Edinburgh and Leith With Proposed Docks</i>
1817	Robert Kirkwood	<i>An Ancient Plan of the City of Edinburgh and its Environs</i>
1836	James Kay	<i>Kay's Plan of Edinburgh</i>
1851	Alfred Lancefield	<i>Johnstone's Plan of Edinburgh and Leith</i>
1852	Ordnance Survey	<i>Edinburgh Sheet 40</i>
1877	Ordnance Survey	<i>Edinburgh Sheet 40</i>
1893	Ordnance Survey	<i>Edinburgh Sheet III.12.2</i>
1948	Ordnance Survey	<i>Edinburgh Plan NT2672NE</i>
1965	Ordnance Survey	<i>Edinburgh Plan NT2672NE</i>

**102 St. Leonard's Street, Edinburgh:
Archaeological Evaluation & Excavation
Structure Report**

Section 2: Appendices

APPENDIX 1: EVALUATION TRENCH DESCRIPTIONS

Trench 1

<i>Dimensions</i>	25m by 2.2m
<i>Excavated Area</i>	55m ²
<i>Excavated Orientation</i>	NW to SE
<i>Soil make-up</i>	Hardcore – modern stone – 0.7m
<i>Natural Subsoil</i>	Pink and grey boulder clay
<i>Significant Features</i>	None
<i>Other Features</i>	Modern manhole at 3.4m to 7.2m
<i>Finds</i>	None

Trench 2

<i>Dimensions</i>	17m by 2.2m
<i>Excavated Area</i>	37.4m ²
<i>Excavated Orientation</i>	SW to NE
<i>Soil make-up</i>	Hardcore – modern stone – 0.3m
<i>Natural Subsoil</i>	Pink and grey boulder clay
<i>Significant Features</i>	None
<i>Other Features</i>	None
<i>Finds</i>	None

Trench 3

<i>Dimensions</i>	25m by 2.2m
<i>Excavated Area</i>	55m ²
<i>Excavated Orientation</i>	S to N
<i>Soil make-up</i>	Hardcore – modern stone – 0.5m; Made ground – quarry stone, demolition rubble and mortar - 0.2 m to 1 m
<i>Natural Subsoil</i>	Pink and grey boulder clay
<i>Significant Features</i>	Bitumen floor [301], Sandstone wall [302]; Made ground over bitumen floor [303]; L-shaped sandstone wall [304]; Wall with plaster [305]; Sandstone flagstones [306]; Made ground [307]
<i>Other Features</i>	Modern drain to immediate N of wall [304]
<i>Finds</i>	None

Trench 4

<i>Dimensions</i>	4a: 12m by 2.2m; 4b: 5m by 2.2m; 4c: 5m by 2.2m; 4d: 5m by 2.2m
<i>Excavated Area</i>	29.9m ²
<i>Excavated Orientation</i>	SW to NE
<i>Soil make-up</i>	Tarmac and type 1m – 0.3m; Made ground (similar to [307]) – demolition rubble and soil – 0.4m to 0.7m
<i>Natural Subsoil</i>	Pink and grey boulder clay
<i>Significant Features</i>	Remnants of cobbled surface of Henry Street
<i>Other Features</i>	Modern sewer
<i>Finds</i>	None

Trench 5

<i>Dimensions</i>	5m by 2.2m
<i>Excavated Area</i>	11m ²
<i>Excavated Orientation</i>	N to S
<i>Soil make-up</i>	Hardcore – modern stone – 0.5m; Made ground 1 – brick, sandstone and mortar rubble with cobbles – 0.4m Made ground 2 – black silty clay with frequent coal inclusions – 0.5m
<i>Natural Subsoil</i>	Pink and grey boulder clay
<i>Significant Features</i>	None
<i>Other Features</i>	None
<i>Finds</i>	None

Trench 6

<i>Dimensions</i>	5m by 2.2m
<i>Excavated Area</i>	11m ²
<i>Excavated Orientation</i>	E to W
<i>Soil make-up</i>	Hardcore – modern stone – 0.7m
<i>Natural Subsoil</i>	Pink and grey boulder clay
<i>Significant Features</i>	None
<i>Other Features</i>	None
<i>Finds</i>	None

Trench 7

<i>Dimensions</i>	15m by 2.2m
<i>Excavated Area</i>	33m ²
<i>Excavated Orientation</i>	SW to NE
<i>Soil make-up</i>	Hardcore – modern stone – 0.6m to 1.4m
<i>Natural Subsoil</i>	Pink and grey boulder clay
<i>Significant Features</i>	None
<i>Other Features</i>	None
<i>Finds</i>	None

APPENDIX 2: CONTEXT REGISTERS

Evaluation

Context No.	Area	Description and Interpretation
301	T3	Bitumen floor surface laid NE-SW in 0.45 m widths with remnants of wooden floor timbers on top. Partly covered by flagstones [306] next to wall [302]. Continues S, E, and W out with trench. Warehouse floor – same as [033]
302	T3	Sandstone wall aligned NE-SW measuring 2.5 m(+) by 0.6 m but continuing NE and SW out with trench. Abutted by made ground [303] to the N and floor [301] and [306] to the S. Warehouse wall – same as [038]
303	T3	Sandstone, brick and mortar rubble filling area between walls [302] and [305] with modern quarry stone to the N within probable cellar. Over 1 m thick. Demolition fill of cellar
304	T3	L-shaped wall aligned NW-SE with slight return to the SW. Measures 3 m by 0.7 m and return is 0.5 m wide and only 0.3 m long before truncation. Made ground [307] abuts it to the N. Wall of warehouse cellar – same as [067]
305	T3	Curving sandstone wall with only ESE face exposed along W edge of trench. Remnants of plaster on face suggesting internal wall. Wall of warehouse cellar – same as [072]
306	T3	Sandstone flagstones overlying NW edge of bitumen surface [301] measuring 0.5 m by 0.5 m. Remains of warehouse floor
307	T3	Mixture of re-deposited clay and rubble to N of wall [304]. Also seen in Trenches 4 and 5. Demolition and levelling layer for Homebase

Excavation

Context No.	Area	Description and Interpretation
001	N/A	Hardcore and stone up to 0.7 m thick covering entire excavation area. Levelling material for Homebase floor slab
002	N/A	Mixture of sandstone and brick rubble with re-deposited clay, blaes, whinstone cobbles, quarry stone and type 1 covering and infilling excavation area. Between 0.2 to 1.2 m thick. Demolition material from warehouse destruction
003	Upper	Sandstone wall aligned NW-SE consisting of irregular, roughly hewn sandstone blocks bonded with pale brown sand and lime mortar. Truncated at SE end and abuts to walls [008] and [046] at its NW end. Doorway [005] incorporated into it and abutted by floor [006]. Measures 12 m by 0.5 m. External wall of Corridor 1 and Upper Level
004	Upper	Long and narrow rectangular space along SW edge of Upper Level consisting of walls [003], [007] and [046], with entrance [005] to the SW and floor [006] and made ground [009] under the floor. Leads into Corridor 2 adjacent to [005] and may also lead into Room 2 via now demolished doorway. Measures 12 m by 1.15 m. Corridor 1
005	Upper	Large hewn stone step within wall [003] adjacent to doorway [030] into Corridor 2. Measures 1 m by 0.3 m. Probably one of two leading down into Corridor 1 from outside. Entrance/steps into Corridor 1
006	Upper	Hewn, straight edged and flat flagstones within Corridor 1 abutting and contained by walls [003], [007] and [046]. Sits upon made ground [009]. Only visible at SE and NW ends of the corridor with central part unexcavated or truncated. Largest is 0.9 m by 0.65 m. Floor of Corridor 1
007	Upper	Sandstone wall aligned NW-SE consisting of irregular, roughly hewn sandstone blocks bonded with pale brown sand and lime mortar. Abutted by wall [051] at NW end and keyed into wall [038] at NW end also. Also abutted by external wall [046] and internal walls [031], [016] and [013]. Forms the SW wall of Room 1, Room 2 and Room 5 and contains five recesses within its NE face. Also contains doorway [030]. Measures 14.5 m by 0.65 m by 0.3 m. Truncated by modern service cut [018]. Internal wall of Corridor 1
008	Upper	Sandstone wall aligned NE-SW consisting of irregular, roughly hewn sandstone blocks bonded with pale brown sand and lime mortar. Abuts SE end of outer wall [047] to the SW and abuts S end of wall [046] to the NE. Measures 3 m by 0.45 m by 0.3 m.

		Outer wall of Corridor 4
009	Upper	Dark brown gritty clay with frequent rubble and ash inclusions measuring 1.12 m wide between walls [003] and [007]. Underlies floor [006] and covers ceramic pipes leading into building. Made ground under floor [006]
010	Upper	Bitumen surface overlying a thin layer of crushed brick and mortar within Room 1. Surface is regularly undulating with each section 0.2 m to 0.5 m apart. Within each trough wooden beams have been laid for supporting perpendicular beams on top (no longer present). Beams are laid NE-SW. Floor truncated to the SE and NE. Possibly divided from floor [012] by [011] but may all be the same. Measures 3.1 m by 1.8 m abutting wall [007]. Floor of Room 1
011	Upper	Small truncated patch of cement between floor surfaces [010] and [012]. Abuts wall [007] to the SW and may be foundation or small partition wall similar to [013]. Measure 1 m by 0.3 m. Possible partition wall foundation
012	Upper	Bitumen surface overlying a thin layer of crushed brick and mortar within Room 1. Surface is regularly undulating with each section 0.2 m to 0.5 m apart. Within each trough wooden beams have been laid for supporting perpendicular beams on top (no longer present). Beams are laid NE-SW. Floor truncated to the SE and NE. Possibly divided from floor [010] by [011] but may all be the same. Measures 2 m by 1.8 m abutting walls [007] and [013]. Floor of Room 1
013	Upper	Narrow brick wall aligned SW-NE, truncated to the NE and abutting wall [007] to the SW. Divides Room 1 and Corridor 2. Abutted by floors [012] and [014]. Measures 1.7 m by 0.12 m. One course of brick wide. Dividing wall between Room 1 and Corridor 2
014	Upper	Hewn, straight edged and flat flagstones within Corridor 2 abutting and contained by walls [013] and [016]. Truncated to the NE and would have abutted floor [006] to the SW. Measures 2.4 m by 1.2 m. Modern concrete is used to repair part of the floor. Floor of Corridor 2
015	Upper	Large rectangular stone set into floor surface [012] with smaller trapezoidal stone abutting it to the W. Measures 0.85 m by 0.53 m by 0.06 m and smaller stone is 0.6 m to 0.35 m by 0.33 m. Base of fireplace in Room 1
016	Upper	Sandstone wall aligned NE-SW consisting of irregular, roughly hewn sandstone blocks bonded with pale brown sand and lime mortar. Abuts wall [025] to the NE and wall [007] to the SW. Measures 2.5 m by 0.68 m by 0.2 m. Abutted by floors [014] and [022] and contains fireplace [017] within NW face. Dividing wall between Corridor 2 and Room 2
017	Upper	Large rectangular stone set into floor surface [022] with smaller trapezoidal stone abutting it to the SE and set within wall [016]. Measures 1.8 m by 0.58 m and smaller stone is 0.87 m by 0.34 m. Base of fireplace in Room 2
018	Upper	Modern drainage cut aligned SW-NE filled with small gravels, truncating walls [003] and [007] as well as floors [006] and [022]. Measures 1.8 m by 1 m within Upper Level, continuing SW. Modern drainage cut
019	Upper	Heavily truncated rectangular space in southern corner of Upper Level consisting of walls [007] and [013] with floors [010] and [012] possibly partitioned by [011]. Two recesses within wall [007] suggesting window bays (?). Most likely accessed from Corridor 2 but no doorway survives. Contains fireplace [015]. Measures 5.4 m by 1.8 m with one area surviving to 5.3 m. Room 1
020	Upper	Long and narrow rectangular space between Room 1 and Room 2 of Upper Level consisting of walls [013] and [016], with entrance [030] from Corridor 1 to the SW and containing floor [014]. Probably leads into Room 1 but relationship no longer exists. Measures 2.4 m by 1.2 m. Corridor 2
021	Upper	Almost square shaped space between Corridor 2 and Room 5 of Upper Level consisting of walls [007], [016], [025] and [031] and floored by surface [022]. Contains fireplace [017] set within SE wall [016] and a recess within wall [007]. Room is truncated by modern cut [018]. Doorway [026] leads into Room 4 through wall [025] to the NE. Measures 3.3 m by 3.4 m. Room 2
022	Upper	Bitumen surface overlying a thin layer of crushed brick and mortar within Room 2. Surface is regularly undulating with each section 0.2 m to 0.5 m apart. Within each trough wooden beams have been laid for supporting perpendicular beams on top (no longer present). Beams are laid NE-SW. Floor truncated by modern cut [018]. Measures 3.4 m by 3.3 m.

		Floor of Room 2
023	Upper	Heavily truncated rectangular space to the NE of Room 2 of Upper Level consisting of walls [025] and [027] with floor [024]. Most likely accessed from Corridor 2 and may link with Room 4 but no doorways survive. Room is truncated to the NE and SE. Measures 4.18 m by 1.7 m. Flagstone floor may suggest it is a corridor rather than a room but width would suggest otherwise. Room 3
024	Upper	Hewn, straight edged and flat flagstones within Room 3 abutting and contained by walls [025] and [027]. Measures 4.18 m by 1.7 m. Floor of Room 3
025	Upper	Red brick wall aligned SW-NE consisting of one course of brick bonded with ash and lime mortar. Abuts NE end of wall [016] and the SE face of wall [031]. Contains doorway [026] and abutted by wall [027] to the NE, and floors [022] and [029]. Measures 2 m by 0.26 m. Dividing wall between Room 2 and Room 3/4
026	Upper	Formal gap within wall [025] measuring 0.97 m wide. Doorway from Room 2 to Room 4
027	Upper	Red brick wall aligned SW-NE consisting of one course of brick bonded with ash and lime mortar. Perpendicular to [025] and abuts [024]. Measures 2.9 m by 0.19 m. Divider wall between Rooms 3 and 4
028	Upper	L-shaped space between Rooms 2 and 5, abutting Room 3 and Corridor 3. Possible machine base [055] at NE end. Measures 3.4 m by 2.1 m and 4.1 m by 1.5 Room 4
029	Upper	Bitumen surface overlying a thin layer of crushed brick and mortar within Room 4. Surface is heavily truncated with areas of underlying brick exposed. Four sandstone flagstones present at S edge. Repaired floor of Room 4
030	Upper	Formal gap within wall [007] leading from Corridor 1 to Corridor 2, measuring 0.9 m wide. Doorway from Corridor 1 to Corridor 2
031	Upper	Sandstone wall aligned NE-SW consisting of irregular, roughly hewn sandstone blocks bonded with pale brown sand and lime mortar. Abuts wall [007] to SW. Measures 4.24 m by 0.38. Wall dividing Room 2 and Room 5
032	Upper	Rectangular space to the NW of Room 2 in the W corner of Upper Level consisting of walls [031], [007], [038] and [037] with doorway [036] and floor [033]. Accessed from Room 4. Measures 4 m by 5.3 m. Room 5
033	Upper	Bitumen surface overlying a thin layer of crushed brick and mortar within Room 2. Surface is regularly undulating with each section 0.2 m to 0.5 m apart. Within each trough wooden beams have been laid for supporting perpendicular beams on top. Beams are laid NE-SW. Measures 4 m by 5.3 m. Floor of Room 5
034	Upper	Rectangular stone set into recess in wall [007] in Room 5. Maybe related to a ceramic pipe under the flagstones of Corridor 1 and a break in wall [007]. Measures 0.6 m by 0.5 m by 0.05 m. Possible drain cover
035	Upper	Large rectangular stone set into floor [033] with smaller trapezoidal stone abutting it to the NW set into wall [038]. Measures 0.85 m by 0.53 m by 0.06 m and smaller stone is 0.6 m to 0.35 m by 0.33 m. Base of fireplace in Room 5
036	Upper	Formal gap within wall [031] and [037], Room 4 and 5 measuring 1 m wide. Doorway from Room 4 to Room 5
037	Upper	Sandstone wall aligned NW-SE consisting of irregular, roughly hewn sandstone blocks bonded with pale brown sand and lime mortar. Abuts wall [038] at NW end and abutted by wall [040] also. Measures 4 m by 0.4 m. Internal wall of Room 5
038	Upper	Sandstone wall aligned E-W consisting of irregular, roughly hewn sandstone blocks bonded with pale brown sand and lime mortar. Keyed into wall [007] at SW end and [044] to NE end. Abutted by wall [037] to the S face and continues into [051] to the SW. Measures 5.8 m by 0.3 m. Dividing wall between Upper and Lower Levels
039	Upper	Sandstone wall aligned NW-SE consisting of irregular, roughly hewn sandstone blocks bonded with pale brown sand and lime mortar. Abutted by wall [038] and [040]. Also abutted by doorway [052] between Room 6 and Corridor 3. Forms the SW wall of Room 1, Room 2 and Room 5 and contains five recesses within its NE face. Also contains doorway [030]. Measures 14.5 m by 0.65 m by 0.3 m. Truncated by modern service cut [018].

		Internal wall separating Corridors
040	Upper	Sandstone wall aligned NE-SW consisting of irregular, roughly hewn sandstone blocks bonded with pale brown sand and lime mortar. Abuts wall [039] at N end and wall [037] at S end also. Also edge forms doorway [052]. Separates Room 6 from Room 4. Measures 1.8 m by 0.3 m. Truncated by modern service cut [018]. Internal wall separating Rooms 4 and 6
041	Upper	Rectangular space off Corridor 3 of Upper Level consisting of walls [038], [039], [040], [037]. No floor discovered. Most likely accessed from Corridor 3 by Doorway [052]. Measures 2 m by 1.8 m. Room 6
042	Upper	Long and narrow rectangular space running NW-SE along NE end of Upper Level consisting of wall [039], with doorway [052] connecting it to Room 6 and containing floor [043]. Measures 5.3 m by 1.05 m. Corridor 3
043	Upper	Hewn, straight edged and flat flagstones within Corridor 3 abutting wall [039]. Truncated at both ends SE and NW. Measures 5.3 m by 1.05 m. Floor or Corridor 3
044	Upper	Sandstone wall aligned NW-SE consisting of irregular, roughly hewn sandstone blocks bonded with pale brown sand and lime mortar. Truncated at SE end. Abutted by wall [067] to the NW and keyed into wall [038] at NW.. Measures 8 m by 0.75 m by 0.5 m. External wall of Upper Level
045	Lower	Recess in wall [051], where it joins with [038]. Stone lintel set within the top of the recess which is overlain by truncated courses of brick used to block it up. Measures 0.92 m wide. Light well for Room 11 - blocked
046	Upper	Sandstone wall aligned N-S consisting of irregular, roughly hewn sandstone blocks bonded with pale brown sand and lime mortar. Abuts wall [007] to the N and walls [008] and [003] to the S. Measures 2.1 m by 0.26 m by 0.5 m. Wall of Corridor 4
047	Upper	Sandstone wall aligned SE-NW consisting of irregular, roughly hewn sandstone blocks bonded with pale brown sand and lime mortar. Abuts the SE end of wall [049] and abutted by wall [008] to the SE. Measures 1.88 m by 0.2 m. External wall of Corridor 4
048	Lower	Formal gap within wall [051] leading from Corridor 4 into Corridor 5. Measures 0.91 m wide. Contains stone lintel or step under later brick blockage. Doorway and Stairs from Corridor 4 into Corridor 5
049	Lower	Sandstone wall aligned NW-SE consisting of irregular, roughly hewn sandstone blocks bonded with pale brown sand and lime mortar. Keyed into wall [094] to the NW and wall [051] to the SE. Abutted by walls [047], [059], [066], [096] and [097]. Contains staircase [095]. Measures 12.8 m by 0.55 m by 1.05 m. External wall of Lower Level - SW
050	Upper	Narrow rectangular space immediately SE of Lower Level contained by walls [008] to SE and [051] to NW, wall [047] to SW and [046] to NE. No floor discovered. Measures 5.5 m by 1.53 m Corridor 4
051	Lower	Sandstone wall aligned SW-NE consisting of irregular, roughly hewn sandstone blocks bonded with pale brown sand and lime mortar. Keyed into wall [049] at SW end. Light well [045] and doorway [048] are contained within wall. Measures 2.9 m by 0.63 m by 0.6 m. Dividing wall between Corridor 4 and Corridor 5/Room 8
052	Upper	Formal gap in wall [039] measuring 1 m wide. Doorway between Room 6 and Corridor 3
053	Upper	Heavily truncated rectangular space in Upper Level consisting of walls [044], [038] and Corridor 3 [042]. Room is truncated to the SE end and no floor survives. Measures 5.3 m by 2.7 m. Room 7
054	Lower	Sandstone wall aligned NW-SE consisting of irregular, roughly hewn sandstone blocks bonded with pale brown sand and lime mortar. Abutting [051] to SE and floor [064]. Measures 4.35 m by 0.33 m. NE wall of Corridor 5
055	Upper	Sandstone, rectangular mortared plinth/buttress, measuring 0.6 m by 0.4 m. Plinth
056	Lower	Long and narrow rectangular space aligned NW-SE at SE end of Lower Level consisting of wall [054], [116], and [118] to NE, Doorway [048] at SE end, Rooms 8, 9, 22, and 21 as well as walls [115] and

		[117] to SW, and wall [123] to the NW. Flagstone floor [064] defines area. Measures 7.2 m by 1 m. Metal drain at NW end where walls [115] and [116] begin Corridor 5
057	Lower	Rectangular space to the SW of Corridor 5 contained by walls [059], [051] and [049] and consisting of flagstone floor [060]. Accessed via Doorway [062]. Measures 2.25 m by 1.15 m. Room 8
058	Lower	Rectangular space to the SW of Corridor 5 contained by walls [059], [066] and [049] and consisting of flagstone floor [063]. Accessed via Doorway [163]. Measures 2.45 m by 1.13 m. Room 9
059	Lower	Sandstone wall aligned NE-SW consisting of irregular, roughly hewn sandstone blocks bonded with pale brown sand and lime mortar. Abuts wall [049] to the SW. Measures 2.43 m by 0.36 m. Dividing wall between Room 8 and Room 9
060	Lower	Irregularly sized flagstones within Room 8 abutting walls [051], [059], [049], and [061]. Measures 1.1 m by 2.2 m. Floor of Room 8
061	Lower	Sandstone wall aligned NW-SE consisting of irregular, roughly hewn sandstone blocks bonded with pale brown sand and lime mortar. Abuts NW face of wall [051] to SW of doorway [048]. Measures 0.26 m by 0.26 m by 0.36 m. Doorjamb in Door [062]
062	Lower	Formal gap between walls [061] and [059] measuring 0.87 m by 0.17 m. Doorway into Room 8
063	Lower	Truncated, irregularly sized flagstones within Room 8 abutting walls [066] and [049]. Measures 2.3 m by 0.25 m by 0.75 m. Floor of Room 9
064	Lower	Hewn, straight edged and flat flagstones within Corridor 5 abutting walls [054], [115] and [116]. Metal drain at SE ends measuring 0.23 m by 0.23 m. Measures 7.2 m by 0.94 m. Floor of Corridor 5
065	Lower	Small concreted lump of mortar and ash abutting wall [049] within Room 9, measuring 0.36 m by 0.20 m by 0.12 m Concreted deposit
066	Lower	L-shaped Sandstone wall aligned NE-SW consisting of irregular, roughly hewn sandstone blocks bonded with pale brown sand and lime mortar. Abuts wall [049] to SW. Measures 2.1 m by 0.23 m by 0.85 m. Dividing wall between Room 9 and Room 22
067	Lower	Sandstone wall aligned NW-SE consisting of irregular, roughly hewn sandstone blocks bonded with pale brown sand and lime mortar. Keyed into wall [094] at NW end and abuts wall [038] at SE end. Abutted by wall [068] and [155] and contains three light wells [088], [089] and [090]. Measures 12.5 m by 0.7 m by 1.3 m. External wall of Lower Level - NE
068	Lower	Sandstone wall aligned SW-NE consisting of irregular, roughly hewn sandstone blocks bonded with pale brown sand and lime mortar. Abuts wall [067] to the NE and stairwell [071] to the SW. Contains Doorway [086]. Measures 6 m by 0.7 m by 0.3 m.. Dividing wall between Room 10 and Rooms 12 and 23
069	Lower	Irregularly sized flagstones within Room 12 abutting walls [068], [079], and [156]. Largest is 0.7 m by 0.5 m by 0.05 m. Measures 1.68 m by 1.04 m in total. Floor in Room 12
070	Lower	Truncated remains of sandstone wall aligned NW-SE consisting of irregular, roughly hewn sandstone blocks bonded with pale brown sand and lime mortar. Measures 2.9 m by 0.5 m. Dividing wall between Room 10 and Room 11
071	Lower	Internal spiral staircase within the Lower Level. Consists of outer sandstone wall [072] and inner brick wall [073] that contain a rubble core [075]. Stone steps [074] sit upon the rubble core with buttress wall [076]. Sits within Room 11 and Room 13. Abutted by floor [077] to the NW and wall [079] forms the NE wall abutting the N end of wall [072]. Spiral stairwell
072	Lower	Curving sandstone wall starting from W to E then curving to N, consisting of irregular, roughly hewn sandstone blocks bonded with pale brown sand and lime mortar. Plaster surface on SE face. Abutted

		by rubble core [075] on NW face. Keyed into wall [079] at N end and abuts wall [076] at SW end. Measures 3.9 m by 0.35 m by 1.4 m. Outer wall of Stairwell [071]
073	Lower	Tightly curving brick and sandstone wall with sandstone on inside abutted by rubble core [075] and brick on the outside all bonded with a pale brown sand and lime mortar. Diameter of 1.4 m by 0.3 m wide. Inner wall of Stairwell [071]
074	Lower	Large triangular shaped, hewn, sandstone steps, only one surviving in full and two others in broken fragments. Measure 1.2 m by 0.25 m to 0.45 m by 0.16 m. Sit upon internal faces of walls [072] and [073], and rubble core [075]. Steps of stairwell [071]
075	Lower	Deposit of sandstone and brick rubble mixed with mortar and ash measuring 1 m wide between walls [072] and [073]. Steps [074] sat on top. Rubble core of stairwell [071]
076	Lower	Truncated sandstone wall aligned SE-NW consisting of irregular, roughly hewn sandstone blocks bonded with pale brown sand and lime mortar. Abuts stairwell wall [072]. May have formed longer dividing wall with [080]. Measures 0.34 m wide and 1.4 m high. Buttress
077	Lower	Hewn, straight edged and flat flagstones within Room 13 abutting wall [079], [120] and [073]. Truncated in places and measuring 4.27 m by 3.96 m. Floor of Room 13
078	Lower	Truncated sandstone wall aligned SE-NW consisting of irregular, roughly hewn sandstone blocks bonded with pale brown sand and lime mortar. Abutted by stairwell wall [072] and rubble core [075]. Measures 1 m by 0.7 m by 0.4 m. Buttress wall for stairwell [071]
079	Lower	Sandstone wall aligned SE-NW consisting of irregular, roughly hewn sandstone blocks bonded with pale brown sand and lime mortar. Keyed into N end of stairwell wall [072] and abuts wall [158] at NW end. Measures 3.96 m by 0.3 m. Dividing wall between Room 13 and Rooms 12, 14 and 15
080	Lower	Truncated sandstone wall aligned SE-NW consisting of irregular, roughly hewn sandstone blocks bonded with pale brown sand and lime mortar. Abuts wall [038]. May have formed longer dividing wall with [076]. Measures 0.34 m wide and 0.8 m high. Buttress
081	Lower	Fragmentary remains of flagstone floor within Room 11, surviving next to buttress [080]. Measures 1 m by 0.4 m. Floor remains of Room 11
082	Lower	Rectangular space in the eastern corner of the Lower Level contained by walls [067], [068], [038] and [070]. No floor surviving. Light well [088] and fireplace [087] within the room. Accessed via Doorway [086] from Corridor 8. Measures 5.4 m by 2.9 m. Room 10
083	Lower	Rectangular space in the SE edge of the Lower Level contained by walls [070], [054], [038] and stairwell [071]. Floor remnant [081]. Light well [045] within the room and buttresses [076] and [080]. Accessed via Doorway [122] from Corridor 5 or directly from Room 13. Measures 7.2 m by 2.9 m. Room 11
084	Lower	Rectangular space to the NW of Room 10 contained by walls [068], [079] and [156]. Floored by flagstones [069]. Accessed via Doorway [162] from Corridor 8. Measures 1.7 m by 1 m. Room 12
085	Lower	Rectangular space in the centre of the Lower Level contained by walls [120], [079], and stairwell [071]. Floored by flagstones [077]. Accessed from upper levels now removed and leads into Corridor 7 and Corridor 10. Measures 4.27 m by 3.96 m. Room 13
086	Lower	Formal gap within wall [068] measuring 1 m wide. Doorway from Room 10 into Corridor 8
087	Lower	Recess in wall [038] within Room 10 measuring 1 m wide and 0.35 m deep. Sides of the recess are lined by upright sandstone lintel style blocks with a trapezoidal sandstone block at the base sitting upon a layer of brick and mortar. NW face of recess wall is stained with black soot. Fireplace within Room 10
088	Lower	Recess in wall [067] within Room 10. Probable rectangular external space to the NE has been

		removed by demolition. All that remains is similar to [045] with a stone lintel set within the top of the recess which is overlain by truncated courses of brick used to block it up. Measures 1.11 m wide and 0.36 m into wall. Light well for Room 10 - blocked
089	Lower	Recess in wall [067] within Room 23. Stone lintel at top of the recess with rectangular space to outside of wall formed by sandstone walls with a square cut flagstone floor at base of well measuring 1.15 m by 0.46 m. Floor has a small hole set within it for drainage. Light well for Room 23
090	Lower	Recess in wall [067] within Room 16. Probable rectangular external space to the NE has been removed by demolition. All that remains is similar to [088] with a stone lintel set within the top of the recess. Measures 1.2 m wide and 0.28 m into wall. Light well for Room 16
091	Lower	Recess in wall [094] within Room 16. Stone lintel at top of the recess with rectangular space to outside of wall formed by sandstone walls, filled with rubble and bounded by concrete slab on top of stone lintel. Measured 1.22 m wide. Light well for Room 16
092	Lower	Recess in wall [067] within Room 18. Stone lintel at top of the recess with rectangular space to outside of wall formed by sandstone walls with a square cut flagstone floor at base of well measuring 1.15 m by 0.46 m. Floor is truncated by metal drain with concrete surrounding. Back wall of well is clad with sloped flagstones. Light well for Room 18
093	Lower	Recess in wall [067] within Room 20. Stone lintel at top of the recess with rectangular space to outside of wall formed by sandstone walls with a truncated floor at base and ceramic pipe to SW edge. Space measures 1.13 m by 0.45 m. Back wall of well is clad with sloped flagstones. Light well for Room 20
094	Lower	Sandstone wall aligned NE-SW consisting of irregular, roughly hewn sandstone blocks bonded with pale brown sand and lime mortar. Contains light wells [091], [092], and [093], and is truncated by drainage feature [164]. Abutted by walls [124], [126], [128], [134], and [142]. External wall of Lower Level – NW
095	Lower	Set of concrete steps (seven) set within wall [049] near its NW end. Stairs measure 0.98 m wide with a course of bricks on either side of steps to repair the truncation through wall [049]. Staircase into Room 20
096	Lower	Sandstone wall aligned NE-SW consisting of irregular, roughly hewn sandstone blocks bonded with pale brown sand and lime mortar. Abuts wall [049] to the SW. Measures 2.1 m by 0.3 m by 1 m. Dividing wall between Room 21 and Room 22
097	Lower	Sandstone wall aligned NE-SW consisting of irregular, roughly hewn sandstone blocks bonded with pale brown sand and lime mortar. Abuts wall [049] to the SW and wall [117] to the NE. Measures 1.8 m by 0.24 m by 1 m. Dividing wall between Room 21 and Room 20
098	Lower	Irregularly sized flagstones within Room 22 abutting walls [066], [096], and [049]. Measures 2.2 m by 1.1 m. Floor of Room 22
099	Lower	Formal gap formed by wall [066] and wall [096] measuring 0.88 m wide. Doorway from Corridor 5 to Room 22
100	Lower	Irregularly sized flagstones within Room 21 abutting walls [096], [097], and [049]. Measures 1.1 m by 2.2 m. Floor of Room 21
101	Lower	Formal gap formed by walls [096] and [097] measuring 0.88 m wide. Doorway from Corridor 5 to Room 21
102	Lower	Rectangular space to the SW of Corridor 5 contained by walls [066], [096] and [049] and consisting of flagstone floor [098]. Accessed via Doorway [099]. Measures 2.2 m by 1.1 m. Room 22
103	Lower	Rectangular space to the SW of Corridor 5 contained by walls [097], [096] and [049] and consisting of flagstone floor [100]. Accessed via Doorway [101]. Measures 2.2 m by 1.1 m. Room 21
104	Lower	Rectangular space in the western corner of the Lower Level contained by walls [097], [117], [123], [124] and [094]. Floor remnant [161] surviving. Light well [093] and staircase [095] within the room. Accessed via staircase [095] and Corridor 6. Measures 5.58 m by 3.38 m.

		Room 20
105	Lower	Rectangular space between Room 20 and Room 18 contained by walls [124], [126], and [094]. Contains flagstone floor [125]. Accessed via Doorway [133] from Corridor 6. Measures 2.94 m by 1.47 m. Room 19
106	Lower	Rectangular space on the NW edge of the Lower Level contained by walls [126], [128], [120] and [094]. Contains truncated floor [127]. Light well [092] and fireplace [129] within the room. Accessed via Doorway [132] from Corridor 6. Measures 4.18 m by 3.38 m. Room 18
107	Lower	Rectangular space on the NW edge of the Lower Level contained by walls [134], [142], and [094]. Contains floor [141]. Accessed via Doorway [140] from Corridor 9. Measures 3.23 m by 1.47 m. Room 17
108	Lower	Rectangular space in the northern corner of the Lower Level contained by walls [142], [155], [067] and [094]. Contains floor [143]. Light wells [090] and [091] and possible storage [144] within the room. Accessed via Doorways [139] and [145] from Corridor 9 and Corridor 8. Measures 4.26 m by 3.52 m. Room 16
109	Lower	Rectangular space to the SW of Corridor 8 contained by walls [155], [149] and [079] and consisting of flagstone floor [147]. Accessed via Doorway [146]. Measures 1.7 m by 1.48 m. Room 15
110	Lower	Rectangular space to the SW of Corridor 8 contained by walls [156], [149] and [079] and consisting of flagstone floor [150]. Accessed via Doorway [151]. Measures 1.7 m by 0.74 m. Room 14
111	Lower	Rectangular space on the NE edge of the Lower Level contained by walls [067], [068], [154] and [155]. No floor surviving. Light well [089] within the room. Accessed via Doorway [153] from Corridor 8. Measures 3.6 m by 2.51 m. Room 23
112	Lower	Narrow rectangular space between Room 20 and Room 18 contained by Corridor 10, Room 20, 19 and 18. Contains floor [130]. Accessed via Doorways [131]-[133], and [159]. Measures 2.2 m by 0.91 m. Corridor 6
113	Lower	Narrow rectangular space between Room 18 and Room 17 contained by walls [128] and [134]. No floor survives. Accessed via Doorways [135]. Measures 4.55 m by 1.02 m. Corridor 7
114	Lower	Narrow rectangular space between Room 23 and Rooms 12, 14 and 15. Contains floor [152]. Accessed via Doorways [086] and [145], with other doorways [146], [151], [153], and [162] leading into Rooms on either side. Measures 3.97 m by 1 m. Corridor 8
115	Lower	Abutment to wall [117] at NW end of Corridor 5 formed by one large lintel like stone measuring 1.5 m by 0.22 m. Abutment to Wall [117]
116	Lower	Abutment to wall [118] at NW end of Corridor 5 formed by one large lintel like stone measuring 1.1 m by 0.22 m. Abutment to Wall [118]
117	Lower	Sandstone wall aligned NW-SE consisting of irregular, roughly hewn sandstone blocks bonded with pale brown sand and lime mortar. Abutted by [115] along NE face and abutted by walls [097] and [123]. Measures 1.9 m by 0.28 m. Dividing wall between Corridor 5 and Room 20
118	Lower	Sandstone wall aligned NW-SE consisting of irregular, roughly hewn sandstone blocks bonded with pale brown sand and lime mortar. Abutted by [116] along SW face and abuts walls [119] and [123]. Measures 1.1 m by 0.38 m. Dividing wall between Corridor 5 and Corridor 10
119	Lower	Sandstone wall aligned NE-SW consisting of irregular, roughly hewn sandstone blocks bonded with pale brown sand and lime mortar. Abutted by wall [118]. Measures 4.4 m by 0.32 m. Dividing wall between Corridor 10 and Room 11
120	Lower	Sandstone wall aligned NE-SW consisting of irregular, roughly hewn sandstone blocks bonded with pale brown sand and lime mortar. Keyed into wall [128]. Contains blocked doorway [121]. Measures

		4.37 m by 0.34 m by 0.84 m. Dividing wall between Room 13 and Room 18
121	Lower	Formal gap within wall [120] now blocked by sandstone similar to wall [120]. Measures 1.03 m by 0.34 m. Blocked doorway from Room 13 to Room 18
122	Lower	Formal gap formed by walls [054] and [119] measuring 1.02 m wide. Doorway from Corridor 5 into Room 13
123	Lower	Sandstone wall aligned NE-SW consisting of irregular, roughly hewn sandstone blocks bonded with pale brown sand and lime mortar. Abuts [117] and abutted by [115], [116] and [118] Measures 1.83 m by 0.32 m. End of Corridor 5
124	Lower	L-shaped sandstone wall aligned NW-SE consisting of irregular, roughly hewn sandstone blocks bonded with pale brown sand and lime mortar. Abuts wall [094] and measures 3.3 m by 0.33 m. Dividing wall between Room 20 and Room 19
125	Lower	Irregularly sized flagstones within Room 19 abutting walls [124], [126] and [094]. Measures 3.3 m by 1.5 m. Floor of Room 19
126	Lower	L-shaped sandstone wall aligned NW-SE consisting of irregular, roughly hewn sandstone blocks bonded with pale brown sand and lime mortar. Abuts wall [094] and measures 3.3 m by 0.33 m. Dividing wall between Room 19 and Room 18
127	Lower	Hewn, straight edged and flat flagstones within Room 18, truncated and replaced by concrete along NW edge. Abuts wall [120]. Measures 2.2 m by 1.4 m surviving. Floor of Room 18
128	Lower	Sandstone wall aligned NW-SE consisting of irregular, roughly hewn sandstone blocks bonded with pale brown sand and lime mortar. Contains fireplace [129] and keyed into wall [120] to the SE. Abuts wall [094] to the NW. Measures 4.18 m by 0.68 m. Dividing wall between Corridor 7 and Room 18
129	Lower	Recess in wall [128] within Room 18 measuring 1 m wide and 0.35 m deep. Sides of the recess are lined by upright sandstone lintel style blocks with a trapezoidal sandstone block (0.76 m by 0.26 m) at the base sitting upon a layer of brick and mortar. SW face of recess wall is stained with black soot. Fireplace within Room 18
130	Lower	Hewn, straight edged and flat flagstones within Corridor 6. Measures 1.98 m by 0.88 m. Floor of Corridor 6
131	Lower	Formal gap formed by walls [123] and [124] measuring 0.9 m wide. Doorway from Room 20 to Corridor 6
132	Lower	Formal gap formed by walls [126] and [120] measuring 0.9 m wide. Doorway from Corridor 6 to Room 18
133	Lower	Formal gap formed by walls [124] and [126] measuring 0.74 m wide. Doorway from Corridor 6 to Room 19
134	Lower	Sandstone wall aligned SE-NW consisting of irregular, roughly hewn sandstone blocks bonded with pale brown sand and lime mortar. Abuts wall [094] to the NW and measures 3.23 m by 0.29 m. Dividing wall between Room 17 and Corridor 7
135	Lower	Formal gap formed by walls [155] and [120] measuring 1.03 m wide. Doorway from Room 13 to Corridor 7
136	Lower	Formal gap formed by walls [134] and [155] measuring 0.95 m wide. Doorway from Corridor 7 to Corridor 9
137	Lower	Narrow rectangular space formed by wall [155] and Room 17. Contains doorways [136] and [139] and [140], and is floored by [138]. Measures 2.35 m by 0.95 m. Corridor 9
138	Lower	Hewn, straight edged and flat flagstones within Corridor 9 abutting wall [155] and measuring 2.35 m by 0.95 m. Floor of Corridor 9
139	Lower	Formal gap formed by wall [142] and [155] measuring 0.95 m wide. Doorway from Corridor 9 to Room 18
140	Lower	Formal gap formed by wall [142] and [134] measuring 1.4 m wide. Doorway from Corridor 9 to Room 17
141	Lower	Irregularly sized flagstones within Room 17 abutting walls [142], [134] and [094]. Measures 3.2 m by 1.4 m.

		Floor of Room 17
142	Lower	Sandstone wall aligned NW-SE consisting of irregular, roughly hewn sandstone blocks bonded with pale brown sand and lime mortar. Abuts wall [094] to the NW. Measures 3.2 m by 0.3 m. Dividing wall between Room 17 and Room 16
143	Lower	Hewn, straight edged and flat flagstones within Room 16 abutting. Measures 4.26 m by 3.52 m. Floor of Room 16
144	Lower	Small rectangular feature consisting of two sandstone blocks to the NE and SW of a gap measuring 1.32 m wide with wall [155] forming a back wall. NE sandstone block abuts wall [067]. Measures 1.32 m by 0.44 m. Small cupboard in Room 16
145	Lower	Formal gap within wall [155] measuring 0.91 m wide. Doorway from Corridor 8 to Room 16
146	Lower	Formal gap formed by wall [149] and [155] measuring 1.48 m wide. Doorway from Corridor 8 to Room 15
147	Lower	Irregularly sized flagstones within Room 15. Measures 1.7 m by 1.48 m. Floor of Room 15
148	Lower	Heavily mortared stone, brick and concrete that had contained a modern pipe. Some of the tone may have represented a wall forming part of the rooms but too truncated to determine exact extents. Truncates Room 14 and 15. Measures 2.3 m by 1 m. Modern disturbance
149	Lower	Brick wall aligned NE-SW and measuring 0.92 m by 0.12 m. Truncated by [148] at SW end. Dividing wall between Room 14 and Room 15
150	Lower	Irregularly sized flagstones within Room 14 truncated by [148] to SW. Measures 1.7 m by 0.74 m. Floor of Room 14
151	Lower	Formal gap formed by wall [149] and [156] measuring 0.74 m wide. Doorway from Corridor 8 to Room 14
152	Lower	Hewn, straight edged and flat flagstones within Corridor 8 abutting walls [154], [068] and [155]. Spotty linoleum still adhering to parts of the floor. Measures 3.97 m by 1 m. Floor of Corridor 8
153	Lower	Formal gap within wall [154] measuring 0.98 m wide. Doorway from Corridor 8 to Room 23
154	Lower	Brick wall aligned SE-NW and measuring 3.94 m by 0.24 m. Two courses wide and contains doorway [153]. Dividing wall between Corridor 8 and Room 23
155	Lower	Sandstone wall aligned NE-SW consisting of irregular, roughly hewn sandstone blocks bonded with pale brown sand and lime mortar. Abuts wall [067] to NE and SW end abutted by wall [079]. Contains doorway [145] and measures 5.98 m by 0.37 m. Dividing wall between Room 16/17 and Room 23/ 15
156	Lower	Completely truncated former wall aligned NE-SW measuring 1.7 m by 0.33 m. Dividing wall between Room 12 and Room 14
157	Lower	Narrow rectangular space formed by walls [119], [118], and [120]. Contains doorways [158] and [159]. and is floored by [160]. Measures 3.7 m by 1.1 m. Corridor 10
158	Lower	Formal gap formed by walls [119] and [120] measuring 1.1 m wide. Doorway from Corridor 10 to Room 13
159	Lower	Formal gap formed by wall [120] and [123] measuring 1 m wide. Doorway from Corridor 10 to Corridor 6
160	Lower	Hewn, straight edged and flat flagstones within Corridor 10 abutting walls [118]-[120]. Measures 3.7 m by 1.1 m. Floor of Corridor 10
161	Lower	Remnant of flagstone floor surface within Room 20, only surviving under light well [093]. Measures 0.8 m by 0.5 m. Remnant of Floor in Room 20
162	Lower	Formal gap formed by wall [156] and [068] measuring 1 m wide. Doorway from Corridor 8 to Room 12
163	Lower	Formal gap formed by wall [159] and [066] measuring 1.13 m wide. Doorway from Corridor 5 to Room 9

164	Lower	Truncation through outer wall [094] within Corridor 7 for the placement of additional drainage. Truncation repaired using red brick and measures 0.45 m. Later alteration for drainage
-----	-------	---

APPENDIX 3: PHOTOGRAPHIC REGISTER

Evaluation

Frame	Description	From	Date
1-4	General views of site	Var	3/2/16
5-7	View of subsoil level next to T1	N	3/2/16
8	T1 post-ex	SE	3/2/16
9	View of subsoil level next to T2	NW	3/2/16
10	T2 post-ex	NE	3/2/16
11	N end of T3 showing Homebase foundation to N and pipe to S	E	3/2/16
12	T3 post-ex	N	3/2/16
13-14	Wall [304] general view	SE/NW	3/2/16
15-17	Wall [302] and floor [301]	SW/S/NE	3/2/16
18	Flagstone floor [306]	SE	3/2/16
19-21	Plastered wall [305]	Var	3/2/16
22	View of possible cellar area	SE	3/2/16
23	T4a post-ex	SW	3/2/16
24	T4d post-ex	SW	3/2/16
25	T4c post ex	SW	3/2/16
26	T4b post-ex	SW	3/2/16
27	T5 post ex	NW	3/2/16
28	T6 post ex	NE	3/2/16

Excavation

Frame	Description	From	Date
1-11	Views of cellar area showing clay natural with no floor on top	Var	8/2/16
12	Trench 7 post ex	NE	10/2/16
13-18	General views of Upper area	E	10/2/16
19-20	General views of Upper area	NE	10/2/16
21-29	General views of Upper area	Var	10/2/16
30-31	View of Room 1	SE	10/2/16
32	Flagstones of [006] – SE end	SE	10/2/16
33-35	Wall [003]	SE	10/2/16
36	Wall [046]	S	10/2/16
37	Flagstones of [006] – NW end	S	10/2/16
38	Threshold [005]	SW	10/2/16
39	Wall [007] – SE end	SE	10/2/16
40	Hearth [015]	E	10/2/16
41	Hearth [015]	S	10/2/16
42	Recess 1 in wall [007]	NE	10/2/16
43	Recess 2 in wall [007]	NE	10/2/16
44	Doorway into Corridor 2 – [030]	NE	10/2/16
45-46	Pink sandstone framing [030]	SW	10/2/16
47	Dividing wall [013]	NE	10/2/16
48	Bitumen floor [012]	NE	10/2/16
49	Division or repair [011]	NE	10/2/16
50	Flagstone floor [014] – Corridor 2	NE	10/2/16
51	Corridor 2 and Room 1	N	10/2/16
52	Corridor 1	NW	10/2/16
53	Wall [07]	SE	10/2/16
54-55	Wall [007] – NW end	SE	10/2/16
56	Recess 3 in [007] – truncated	NE	10/2/16
57	Modern cut [018]	NE	10/2/16
58	Recess 4 in [007]	NE	10/2/16
59	Recess 5 in [007] and [034]	NE	10/2/16

102 St Leonard's Street, Edinburgh: Archaeological Evaluation & Excavation Report

60	Hearth [017]	NW	10/2/16
61	Hearth [017]	SW	10/2/16
62	Wall [016]	SW	10/2/16
63	Wall [025]	SE	10/2/16
64	Wall [025] and doorway [026]	NW	10/2/16
65	Room 2 general – floor [022]	N	10/2/16
66	Room 2 general – floor [022]	S	10/2/16
67	Wall [031]	SW	10/2/16
68	Doorway [026]	SW	10/2/16
69	Wall [031]	NE	10/2/16
70	Room 3 – [023] and floor [024]	NE	11/2/16
71	Room 3 – [023] and floor [024]	SW	11/2/16
72	Room 3 and Room 4	S	11/2/16
73	Room 4	N	11/2/16
74	Floor [029]	N	11/2/16
75	Doorway [036]	SE	11/2/16
76	Wall [037]	SE	11/2/16
77	Wall [039]	SE	11/2/16
78	Wall [040]	SE	11/2/16
79	Room 6 – [041]	E	11/2/16
80	Doorway [052]	NE	11/2/16
81	NW edge of wall [039]	NE	11/2/16
82	Corridor 3 – [042] and floor [043]	SE	11/2/16
83	Corridor 3 – [042] and floor [043]	E	11/2/16
84	Room 5 – [032] and floor [033]	E	11/2/16
85	Room 5 – [032] and floor [033]	NE	11/2/16
86	Hearth [035]	SE	11/2/16
87	Hearth [035]	NE	11/2/16
88-90	Outer wall [044]	Var	11/2/16
91	NE end of wall [008]	SW	11/2/16
92	SW end of wall [008] and wall [047]	NE	11/2/16
93	SW end of wall [008] and wall [047]	NW	11/2/16
94-95	View of Corridor 4 – [050]	Var	11/2/16
96-97	Plinth or column base in room 4 – [055]	Var	11/2/16
98	Doorway [045] from corridor 4	S	11/2/16
99	Doorway [048] from corridor 4	SE	11/2/16
100	Doorway [045] and [048]	S	11/2/16
101	Doorway [045] from Room 9	NW	11/2/16
102	Doorway [045] from Room 9	N	11/2/16
103-104	Doorway [048] from Room 8	NW	11/2/16
105-108	General views of Corridor 5 and Room 8 and Room 9	Var	11/2/16
109	SE end of corridor 5 from [048]	SE	11/2/16
110	Doorway [062] into Room 8	NE	11/2/16
111	View of room 8 and floor [060] and wall [061]	NE	11/2/16
112	View of room 9 and floor [063]	NE	11/2/16
113	SE face of wall [066] with plaster	E	11/2/16
114	Corridor 5 continuing NW	SE	11/2/16
115	Dividing wall [059]	NE	11/2/16
116-117	Tile stack in Room 20	Var	12/2/16
118-119	Progress shots at end of day	Var	12/2/16
120-121	Progress shots at end of day	Var	13/2/16
122-123	Views of wall [038]	N+NE	15/2/16
124-135	General views of lower area	Var	15/2/16
136	Room 22	NE	15/2/16
137	Wall [066]	SW	15/2/16
138	Wall [096]	SW	15/2/16

102 St Leonard's Street, Edinburgh: Archaeological Evaluation & Excavation Report

139	Wall [097]	SW	15/2/16
140	Room 21	SW	15/2/16
141	Room 21	NE	15/2/16
142	Corridor 5	SW	15/2/16
143	NW end of corridor 5	SE	15/2/16
144	Wall [054]	NW	15/2/16
145	Doorway [12]	SW	15/2/16
146	Drain in floor [064]	SE	15/2/16
147	Walls [115] and [117]	SE	15/2/16
148	Walls [116] and [118]	SE	15/2/16
149-150	Wall [119]	SW+NE	15/2/16
151	Corridor 10 and doorway [158]	NE	15/2/16
152	Doorway [159]	SE	15/2/16
153	Doorway [133]	SE	15/2/16
154	Doorway [131]	NE	15/2/16
155	Room 20	NW	15/2/16
156	Wall [123]	NW	15/2/16
157-159	Wall [049]	SE	15/2/16
160	Stairs [095]	NE	15/2/16
161	Light well 6 and floor [160]	SE	15/2/16
162	Light well 6 showing drain	SW	15/2/16
163-167	Wall [094]	Var	15/2/16
168-171	Wall [067]	Var	15/2/16
172	Wall [124]	SE	15/2/16
173	Wall [126]	SE	15/2/16
174	Room 19 and floor [125]	SE	15/2/16
175	Corridor 6	SW	15/2/16
176	Dorway [132]	SW	15/2/16
177	Room 18	NW	15/2/16
178	Light well 5	SE	15/2/16
179	Light well 5 showing drain	NE	15/2/16
180-181	Fireplace [129]	Var	15/2/16
182	Wall [128]	NW	15/2/16
183	Blocked doorway [121]	NW	15/2/16
184-185	Wall [120]	SW	15/2/16
186	Wall [142]	SE	15/2/16
187	Doorway [136]	SW	15/2/16
188	Wall [142]	SE	15/2/16
189	Wall [134]	SE	15/2/16
190	Corridor 7 and Room 17 – floor [141]	NW	15/2/16
191	Room 16 and floor [143]	W	15/2/16
192	Light well 4	SE	15/2/16
193	Light well 3	SW	15/2/16
194	Wall [155] – SW	SW	15/2/16
195	Doorway [145]	NW	15/2/16
196	Wall [155] – NE	SW	15/2/16
197	Cupboard [144]	NW	15/2/16
198	Light well 2	SW	15/2/16
199	Light well 2 showing floor and hole	NW	15/2/16
200	Doorway [086]	SE	15/2/16
201	Wall [068]	NE	15/2/16
202	Light well 1	SW	15/2/16
203	Room 23	E	15/2/16
204	Doorway [153]	NE	15/2/16
205	Room 12 and floor [069] and doorway [162]	NE	15/2/16
206	Room 14 and floor [150] and doorway [151]	NE	15/2/16

102 St Leonard's Street, Edinburgh: Archaeological Evaluation & Excavation Report

207	Room 15 and floor [147] and doorway [146]	NE	15/2/16
208	Rooms 12, 14 and 15 and Corridor 8	E	15/2/16
209	Concrete [148]	SE	15/2/16
210	Wall [149]	NE	15/2/16
211	Wall [156]	NE	15/2/16
212	Wall [079]	NW	15/2/16
213-215	Stairwell wall [073]	Var	15/2/16
216-217	Truncated NW end of stairwell [071]	NW	15/2/16
218	Step [074]	N	15/2/16
219	Wall [070]	NW	15/2/16
220	Buttress [076]	SE	15/2/16
221	Buttress [080]	NW	15/2/16
222	Wall [078] – SE end	SE	15/2/16
223	Floor remnant [081]	SW	15/2/16
224-225	Stairwell [071] and wall [072]	Var	15/2/16
226-227	Fireplace [087]	Var	15/2/16

APPENDIX 4: 'DISCOVERY AND EXCAVATION IN SCOTLAND' (DES) REPORT

LOCAL AUTHORITY:	City of Edinburgh Council
PROJECT TITLE/SITE NAME:	102 St Leonard's Street, Edinburgh
PROJECT CODE:	22968
PARISH:	Edinburgh
NAME OF CONTRIBUTOR:	Kevin Paton
NAME OF ORGANISATION:	AOC Archaeology Group
TYPE(S) OF PROJECT:	Evaluation and Excavation
NMRS NO(S):	N/A
SITE/MONUMENT TYPE(S):	N/A
SIGNIFICANT FINDS:	None
NGR (2 letters, 6 figures)	NT 26597 72652
START DATE (this season)	3 rd February 2016
END DATE (this season)	15 th February 2016
PREVIOUS WORK (inc DES)	None
MAIN (NARRATIVE) DESCRIPTION: (May include information from other fields)	<p>AOC Archaeology Group was commissioned to undertake an archaeological evaluation and subsequent excavation undertaken by AOC Archaeology Group prior to the construction of a new residential and commercial development at 102 St Leonard's Street, Edinburgh.</p> <p>The initial evaluation showed that a large part of the site had been truncated by the previous modern development. The earliest buildings depicted along the street frontage had all been removed and the site had clearly been reduced to below the 18th and 19th century ground levels. However, the central portion of the development area showed potential for the survival of subterranean structures. Therefore, after discussions with the CEC Archaeology Service, an area of additional excavation was undertaken measuring 30m by 20m within this area.</p> <p>The excavations revealed the surviving walls and floors of 19th century warehouse cellars. The cellars were constructed on two levels with the 'Upper Area' consisting of sandstone walls with bitumen and wooden floors and the 'Lower Area' consisting of sandstone walls with sandstone flagstone flooring. In total, 23 rooms were identified, with ten linking corridors, a large stairwell, six light wells, five hearths or fireplaces and three external entrances.</p> <p>Modern repairs and additions were visible throughout suggesting the buildings and rooms were altered and re-used, with some possibly blocked up and the floors removed for use elsewhere. With modern concrete used in the reparations it was not unusual that all of the material culture from the infilling deposits was modern in date.</p>
PROPOSED FUTURE WORK:	None
CAPTION(S) FOR ILLUSTRATIONS:	N/A
SPONSOR OR FUNDING BODY:	GVA James Barr
ADDRESS OF MAIN CONTRIBUTOR:	AOC Archaeology Group Edgefield Road Industrial Estate Loanhead, Midlothian, EH20 9SY
EMAIL ADDRESS:	admin@aocarchaeology.com
ARCHIVE LOCATION	Archive to be deposited in NMRS

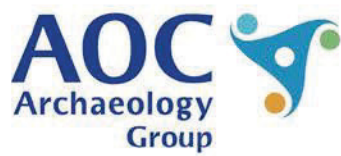
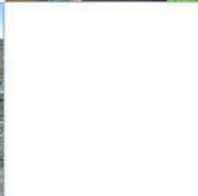
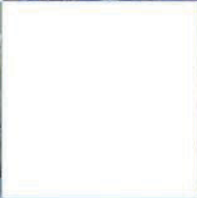

AOC Archaeology Group, Edgefield Industrial Estate, Edgefield Road, Loanhead EH20 9SY
tel: 0131 440 3593 | fax: 0131 440 3422 | e-mail: edinburgh@aocarchaeology.com

www.aocarchaeology.com