

**An Archaeological Evaluation at Westfield Park,  
Carnoustie:**

**Data Structure Report**

## 1 NON TECHNICAL SUMMARY

- 1.1 This report presents the results of an archaeological evaluation undertaken by AOC Archaeology Group at Westfield Park, Carnoustie, Angus. The programme of archaeological works was required by DJ Laing Homes Ltd in respect to a proposed housing development. The development area of approximately 4.3 ha currently encompasses open ground, a builders' yard and a scrap yard (Figure 1).
- 1.2 The proposed development area lies within the administrative area of Angus Council, which is advised on archaeological matters by Aberdeenshire Council Archaeology Service (ACAS). The archaeological works undertaken were in keeping with the policies outlined in PAN 42 and NPPG 5 in order to record the extent and significance of any archaeological remains which may be present within the development area.
- 1.3 The work was carried out during December 2007 and was initially conducted according to the terms of a *Written Scheme of Investigation* (AOC 2007) which was agreed by Mrs Moira Greig of ACAS, and approved by the planning authority. The evaluation was originally designed to comprise twenty-one trenches totalling 2,500 m<sup>2</sup> but, following discussion with Mrs Greig, its scope and scale were altered in the field due to the presence of deep refuse deposits and existing bund material.
- 1.4 Neither significant archaeological features nor artefacts were observed during the course of the evaluation.

## 2 INTRODUCTION

### 2.1 Planning background

- 2.1.1 The programme of works was designed fully to satisfy the requirements of Angus Council, as advised by Mrs. Moira Greig of the Aberdeenshire Council Archaeology Service and was in accordance with the principles inherent in NPPG 5 (SOEnd 1994), PAN 42 (SOEnd 1994a) and NPPG 18 (SODD 1999). The works comprised evaluation trenching and test-pitting.

### 2.2 Location

- 2.2.1 The land proposed for re-development (Figure 1) is located on the north of Carnoustie, to the north and west of Pitskelly Park (NGR: NO 547 346) and is bounded by Barrie Road to the south and agricultural land to the north. The application area amounts to some 4.3 ha, with a builders' yard and scrap yard occupying its greater part (Figure 1).

## 2.3 Archaeological background

- 2.3.1 There were no known archaeological sites within the application area, despite the area to the immediate north being rich in prehistoric settlement; Scheduled Ancient Monuments are situated at Pitskelly (*NMRS*: NO53SW17), Shanwell (*NMRS*: NO53NW29), Ravensby (*NMRS*: NO53NW28) and Greenlawhill (*NMRS*: NO53SW18).
- 2.3.2 Previous archaeological works completed in close proximity to the proposed development area produced large quantities of early to mid-20<sup>th</sup> century refuse material, indicating the presence of a probable rubbish tip or midden (Rees & Cameron 1998).

## 3 OBJECTIVES

- 3.1 The objectives of the archaeological evaluation were:
- i) to determine the character, extent, condition, quality, date and significance of any archaeological remains within the defined subject area;
  - ii) should significant archaeological deposits be discovered, to prepare a mitigation strategy compliant with NPPG 5 and PAN 42.

## 4 METHODOLOGY

- 4.1 In order to meet the curatorial requirements of ACAS, it was proposed that twenty-one trenches were excavated covering a total basal area of 2,150 m<sup>2</sup> representing a 5% sample of the development area. However, due to the presence of deep made ground derived from the dumping of refuse and existing bund material, the intrusive works were reduced to five trenches and thirteen machine excavated test-pits. This reduction was agreed in the field after consultation with Mrs Moira Greig.
- 4.2 The intrusive works were designed to establish the extent, condition, character, quality, date and significance of any archaeological features present within the development area. The trenches were of varying lengths and set on different orientations (Figure 1). Weather conditions during the evaluation were dry and cold, ideal for archaeological visibility.
- 4.3 Reduction of overburden was by means of a 360° tracked excavator equipped with a toothless ditching bucket approximately 2.0 m wide. Excavation was designed to be undertaken in shallow units/spits until the first significant archaeological horizon or natural subsoil was reached. All machine excavation was supervised by an experienced field archaeologist.
- 4.4 All trial trenching was undertaken according to AOC Archaeology Group's standard operating procedures.

## 5 RESULTS

- 5.1 The archaeological evaluation was undertaken between 17<sup>th</sup> and 19<sup>th</sup> December 2007. The following should be read together with the various data gathered from the evaluation presented in Appendices 1 and 2.
- 5.2 The topsoil across the site varied in depth from 0.20 to 0.30 m depending on the topography of the field, and was found to overlie a combination of yellow and orange sandy natural subsoil and a layer of made ground. No field drains were identified.
- 5.3 Upon excavation it was clear that the northern and southern portions of the proposed development area had differing histories. The southern land parcel contained only a thin layer of topsoil directly overlying the natural orange and yellow sand. No evidence was found for the football pitch and associated infrastructure that occupied the site prior to the evaluation commencing. In contrast, very little topsoil was found to overlie the northern land parcel. Instead, it appears that the area was stripped of both topsoil and, in some areas at least, the upper part of natural subsoil and was overlain by at least 1.80 m of made ground comprising 19<sup>th</sup> and 20<sup>th</sup> century rubbish comprising bottles, ceramics, plastic material and general detritus.
- 5.4 The evaluation supports the results of earlier work by Rees and Cameron (1998) suggesting that the general area may once have served as a large rubbish tip.
- 5.5 The archaeological evaluation identified neither significant features nor artefacts.

## 6 CONCLUSION

- 6.1 No features or artefacts of archaeological significance were identified. It is concluded that any significant material which may once have been present has been removed by the construction and usage of the rubbish dump in the north of the site. The shallow topsoil in the southern part of the site seems unlikely to have afforded much protection (eg from horizontal truncation by ploughing in the relatively recent past) to any notional archaeological features in this area.
- 6.2 No further archaeological works are considered necessary.

7 BIBLIOGRAPHY

AOC 2007 *Westfield Park-Wood, Carnoustie: Written Scheme of Investigation*, AOC unpublished client document.

Rees, A. and Cameron, K 1998, 'A92 road improvement: Dundee to Arbroath (Arbirlot; Barry; Carnoustie; Dundee; Montieth; Monikie; Panbride parishes), evaluation and excavation', *Discov Excav Scot*, 1998, 12

The Scottish Office Development Department 1994. *National Planning Policy Guideline NPPG5. Archaeology and Planning*. January 1994.

The Scottish Office Development Department 1999. *National Planning Policy Guideline NPPG18. Planning and the Historic Environment*. April 1999.

The Scottish Office Environment Department 1994. *Archaeology - the Planning Process and Scheduled Monument Procedures. Planning Advice Note PAN42*. January 1994.

## APPENDIX 1: TRENCH DESCRIPTIONS

### **Trench 1**

|                             |                    |
|-----------------------------|--------------------|
| <i>Dimensions</i>           | 50 m by 2 m        |
| <i>Orientation</i>          | North to south     |
| <i>Depth of Topsoil</i>     | 0.20 m             |
| <i>Depth of excavation</i>  | 0.30 m             |
| <i>Significant Features</i> | None               |
| <i>Subsoil</i>              | Yellow/orange sand |
| <i>Finds</i>                | None               |

### **Trench 2**

|                             |  |
|-----------------------------|--|
| <i>Dimensions</i>           | 50 m by 2 m                                      |
| <i>Orientation</i>          | East to west                                     |
| <i>Depth of Topsoil</i>     | 0.25 m   |
| <i>Depth of excavation</i>  | 0.30 m   |
| <i>Significant Features</i> | None   |
| <i>Subsoil</i>              | Yellow/orange sand                               |
| <i>Finds</i>                | Remnants of a 19/20 <sup>th</sup> century midden |

### **Trench 3**

|                             |                          |
|-----------------------------|--------------------------|
| <i>Dimensions</i>           | 50 m by 2 m              |
| <i>Orientation</i>          | North-east to south-west |
| <i>Depth of Topsoil</i>     | 0.25 m                   |
| <i>Depth of excavation</i>  | 0.30 m                   |
| <i>Significant Features</i> | None                     |
| <i>Subsoil</i>              | Yellow/orange sand       |
| <i>Finds</i>                | None                     |

### **Trench 4**

|                             |                          |
|-----------------------------|--------------------------|
| <i>Dimensions</i>           | 100 m by 2 m             |
| <i>Orientation</i>          | North-east to south-west |
| <i>Depth of Topsoil</i>     | 0.30 m                   |
| <i>Depth of excavation</i>  | 0.35 m                   |
| <i>Significant Features</i> | None                     |
| <i>Subsoil</i>              | Yellow/orange sand       |
| <i>Finds</i>                | None                     |

### **Trench 5**

|                             |                    |
|-----------------------------|--------------------|
| <i>Dimensions</i>           | 55 m by 2 m        |
| <i>Orientation</i>          | North to south     |
| <i>Depth of Topsoil</i>     | 0.30 m             |
| <i>Depth of excavation</i>  | 0.35 m             |
| <i>Significant Features</i> | None               |
| <i>Subsoil</i>              | Yellow/orange sand |
| <i>Finds</i>                | None               |

### **Test-Pit 1**

|                             |  |
|-----------------------------|--|
| <i>Dimensions</i>           | 5 m by 2 m   |
| <i>Orientation</i>          | North to south   |
| <i>Depth of Topsoil</i>     | 0.25 m   |
| <i>Depth of excavation</i>  | 2.20 m   |
| <i>Made Ground</i>          | 2.20 m of 19/20 <sup>th</sup> century midden material                          |
| <i>Significant Features</i> | None   |
| <i>Subsoil</i>              | Grey clay  |
| <i>Finds</i>                | Glass bottles, white ceramic and plastic detritus identified but not recovered |

## Westfield Park, Carnoustie Evaluation: Data Structure Report

### Test-Pit 2

|                             |  |
|-----------------------------|--|
| <i>Dimensions</i>           | 5 m by 2 m   |
| <i>Orientation</i>          | North to south   |
| <i>Depth of Topsoil</i>     | 0.25 m   |
| <i>Depth of excavation</i>  | 2.00 m   |
| <i>Made Ground</i>          | 2.00 m of 19/20 <sup>th</sup> century midden material                          |
| <i>Significant Features</i> | None   |
| <i>Subsoil</i>              | Grey clay  |
| <i>Finds</i>                | Glass bottles, white ceramic and plastic detritus identified but not recovered |

### Test-Pit 3

|                             |  |
|-----------------------------|--|
| <i>Dimensions</i>           | 5 m by 2 m   |
| <i>Orientation</i>          | North to south   |
| <i>Depth of Topsoil</i>     | 0.25 m   |
| <i>Depth of excavation</i>  | 2.20 m   |
| <i>Made Ground</i>          | 2.20 m of 19/20 <sup>th</sup> century midden material                          |
| <i>Significant Features</i> | None   |
| <i>Subsoil</i>              | Yellow sand  |
| <i>Finds</i>                | Glass bottles, white ceramic and plastic detritus identified but not recovered |

### Test-Pit 4

|                             |  |
|-----------------------------|--|
| <i>Dimensions</i>           | 5 m by 2 m   |
| <i>Orientation</i>          | North to south   |
| <i>Depth of Topsoil</i>     | 0.25 m   |
| <i>Depth of excavation</i>  | 2.20 m   |
| <i>Made Ground</i>          | 2.20 m of 19/20 <sup>th</sup> century midden material                          |
| <i>Significant Features</i> | None   |
| <i>Subsoil</i>              | Yellow/orange sand   |
| <i>Finds</i>                | Glass bottles, white ceramic and plastic detritus identified but not recovered |

### Test-Pit 5

|                             |  |
|-----------------------------|--|
| <i>Dimensions</i>           | 5 m by 2 m   |
| <i>Orientation</i>          | North to south   |
| <i>Depth of Topsoil</i>     | 0.25 m   |
| <i>Depth of excavation</i>  | 2.50 m   |
| <i>Made Ground</i>          | 2.50 m of 19/20 <sup>th</sup> century midden material                          |
| <i>Significant Features</i> | None   |
| <i>Subsoil</i>              | Orange sand  |
| <i>Finds</i>                | Glass bottles, white ceramic and plastic detritus identified but not recovered |

### Test-Pit 6

|                             |  |
|-----------------------------|--|
| <i>Dimensions</i>           | 5 m by 2 m   |
| <i>Orientation</i>          | North to south   |
| <i>Depth of Topsoil</i>     | 0.20 m   |
| <i>Depth of excavation</i>  | 2.80 m   |
| <i>Made Ground</i>          | 2.80 m of 19/20 <sup>th</sup> century midden material                          |
| <i>Significant Features</i> | None   |
| <i>Subsoil</i>              | Yellow/orange sand   |
| <i>Finds</i>                | Glass bottles, white ceramic and plastic detritus identified but not recovered |

### Test-Pit 7

|                            |                |
|----------------------------|----------------|
| <i>Dimensions</i>          | 5 m by 2 m     |
| <i>Orientation</i>         | North to south |
| <i>Depth of Topsoil</i>    | 0.25 m         |
| <i>Depth of excavation</i> | 3.00 m         |

## Westfield Park, Carnoustie Evaluation: Data Structure Report

|                             |  |
|-----------------------------|--|
| <i>Made Ground</i>          | 3.00 m of 19/20 <sup>th</sup> century midden material                          |
| <i>Significant Features</i> | None   |
| <i>Subsoil</i>              | Yellow/orange sand   |
| <i>Finds</i>                | Glass bottles, white ceramic and plastic detritus identified but not recovered |

### Test-Pit 8

|                             |  |
|-----------------------------|--|
| <i>Dimensions</i>           | 5 m by 2 m   |
| <i>Orientation</i>          | North to south   |
| <i>Depth of Topsoil</i>     | 0.25 m   |
| <i>Depth of excavation</i>  | 2.60 m   |
| <i>Made Ground</i>          | 2.60 m of 19/20 <sup>th</sup> century midden material                          |
| <i>Significant Features</i> | None   |
| <i>Subsoil</i>              | Yellow sand  |
| <i>Finds</i>                | Glass bottles, white ceramic and plastic detritus identified but not recovered |

### Test-Pit 9

|                             |  |
|-----------------------------|--|
| <i>Dimensions</i>           | 5 m by 2 m   |
| <i>Orientation</i>          | North to south   |
| <i>Depth of Topsoil</i>     | 0.25 m   |
| <i>Depth of excavation</i>  | 2.60 m   |
| <i>Made Ground</i>          | 2.60 m of 19/20 <sup>th</sup> century midden material                          |
| <i>Significant Features</i> | None   |
| <i>Subsoil</i>              | Yellow/orange sand below the water table                                       |
| <i>Finds</i>                | Glass bottles, white ceramic and plastic detritus identified but not recovered |

### Test-Pit 10

|                             |  |
|-----------------------------|--|
| <i>Dimensions</i>           | 5 m by 2 m   |
| <i>Orientation</i>          | North to south   |
| <i>Depth of Topsoil</i>     | 0.25 m   |
| <i>Depth of excavation</i>  | 2.00 m   |
| <i>Made Ground</i>          | 2.00 m of 19/20 <sup>th</sup> century midden material                          |
| <i>Significant Features</i> | None   |
| <i>Subsoil</i>              | Grey clay below the water table  |
| <i>Finds</i>                | Glass bottles, white ceramic and plastic detritus identified but not recovered |

### Test-Pit 11

|                             |  |
|-----------------------------|--|
| <i>Dimensions</i>           | 5 m by 2 m   |
| <i>Orientation</i>          | North to south   |
| <i>Depth of Topsoil</i>     | 0.25 m   |
| <i>Depth of excavation</i>  | 1.80 m   |
| <i>Made Ground</i>          | 1.80 m of 19/20 <sup>th</sup> century midden material                          |
| <i>Significant Features</i> | None   |
| <i>Subsoil</i>              | Yellow/orange sand   |
| <i>Finds</i>                | Glass bottles, white ceramic and plastic detritus identified but not recovered |

### Test-Pit 12

|                             |  |
|-----------------------------|--|
| <i>Dimensions</i>           | 5 m by 2 m   |
| <i>Orientation</i>          | East to west   |
| <i>Depth of Topsoil</i>     | 0.25 m   |
| <i>Depth of excavation</i>  | 1.80 m   |
| <i>Made Ground</i>          | 1.80 m of 19/20 <sup>th</sup> century midden material                          |
| <i>Significant Features</i> | None   |
| <i>Subsoil</i>              | Yellow/orange sand   |
| <i>Finds</i>                | Glass bottles, white ceramic and plastic detritus identified but not recovered |



**Test-Pit 13**

|                             |  |
|-----------------------------|--|
| <i>Dimensions</i>           | 5 m by 2 m   |
| <i>Orientation</i>          | North to south   |
| <i>Depth of Topsoil</i>     | 0.25 m   |
| <i>Depth of excavation</i>  | 1.60 m   |
| <i>Made Ground</i>          | 1.60 m of 19/20 <sup>th</sup> century midden material                          |
| <i>Significant Features</i> | None   |
| <i>Subsoil</i>              | Yellow/orange sand   |
| <i>Finds</i>                | Glass bottles, white ceramic and plastic detritus identified but not recovered |

APPENDIX 2: PHOTOGRAPHIC REGISTER

Evaluation Black & White Print and Colour Slide 1

| <b>Frame</b> | <b>Detail</b>                               | <b>From</b> |
|--------------|---|-------------|
| 1-2          | Registration                                |             |
| 3-4          | General post-excavation shot of Test-Pit 1  | S           |
| 5-6          | General post-excavation shot of Test-Pit 2  | N           |
| 7-8          | General post-excavation shot of Test-Pit 3  | N           |
| 9-10         | General post-excavation shot of Test-Pit 4  | N           |
| 11-12        | General post-excavation shot of Test-Pit 5  | N           |
| 13-14        | General post-excavation shot of Trench 5    | S           |
| 15-16        | General post-excavation shot of Test-Pit 6  | S           |
| 17-18        | General post-excavation shot of Test-Pit 11 | W           |

## APPENDIX 3: DISCOVERY AND EXCAVATION IN SCOTLAND REPORT

|   |  |
|---|--|
| <b>LOCAL AUTHORITY:</b>   | Angus Council  |
| <b>PROJECT TITLE/SITE NAME</b>  | Westfield Park, Carnoustie   |
| <b>PROJECT CODE:</b>  | AOC 20799  |
| <b>PARISH:</b>  | Barry  |
| <b>NAME OF CONTRIBUTOR:</b>   | Martin Cook  |
| <b>NAME OF ORGANISATION:</b>  | AOC Archaeology Group  |
| <b>TYPE(S) OF PROJECT:</b>  | Archaeological Evaluation  |
| <b>NMRS NO(S):</b>  | None   |
| <b>SITE/MONUMENT TYPE(S):</b>   | None   |
| <b>SIGNIFICANT FINDS:</b>   | None   |
| <b>NGR</b> (2 letters, 6 figures)   | NO 547 346   |
| <b>START DATE</b> (this season)   | 17 <sup>th</sup> December 2007   |
| <b>END DATE</b> (this season)   | 19 <sup>th</sup> December 2007   |
| <b>PREVIOUS WORK</b> (incl. <i>DES</i> ref.)  | None   |
| <b>MAIN (NARRATIVE) DESCRIPTION:</b><br>(May include information from other fields) | <p>An archaeological evaluation was carried out in advance of a proposed housing development at Westfield Park, Carnoustie, Angus. The evaluation comprised the excavation of five trenches and thirteen test-pits. The northern part of the development site was found to overlie a 19<sup>th</sup> / 20<sup>th</sup> century rubbish dump.</p> <p>Neither significant archaeological features nor artefacts were identified.</p> |
| <b>PROPOSED FUTURE WORK:</b>  | None   |
| <b>CAPTION(S) FOR ILLUSTRS:</b>   | --   |
| <b>SPONSOR OR FUNDING BODY:</b>   | DJ Laing Homes Ltd   |
| <b>ADDRESS OF MAIN CONTRIBUTOR:</b>   | Edgefield Road Industrial Estate, Loanhead, Midlothian, EH20 9SY   |
| <b>EMAIL ADDRESS:</b>   | <a href="mailto:martinc@aocscot.co.uk">martinc@aocscot.co.uk</a>   |
| <b>ARCHIVE LOCATION</b><br>(intended/deposited)                                     | Archive to be deposited in NMRS  |

**For:** DJ Laing  
Homes Ltd  
Panmure Industrial Estate  
Carnoustie  
DD7 7NP

**National Grid Reference (NGR):** NGR: NO 547 346

**AOC Archaeology Project No:** 20,799

**Prepared by:** Martin Cook

**Graphics** Graeme Carruthers

**Timing:** Fieldwork December 2007  
Report December 2007

**Enquiries to:** AOC Archaeology Group  
Edgefield Industrial Estate  
Edgefield Road  
Loanhead  
Midlothian  
EH20 9SY

*Tel.* 0131 440 3593  
*Fax.* 0131 440 3422  
*Email.* [admin@aocscot.co.uk](mailto:admin@aocscot.co.uk)

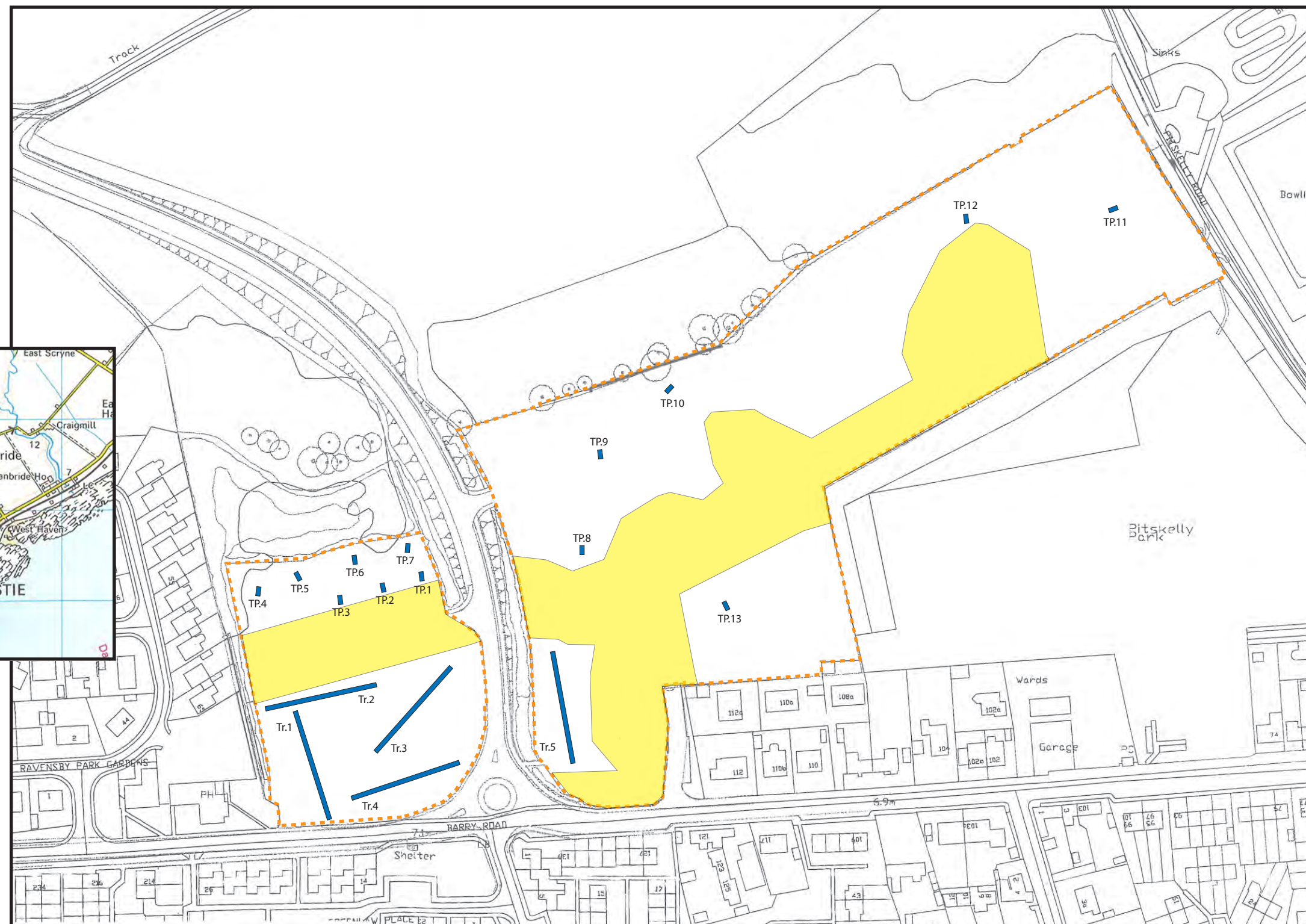
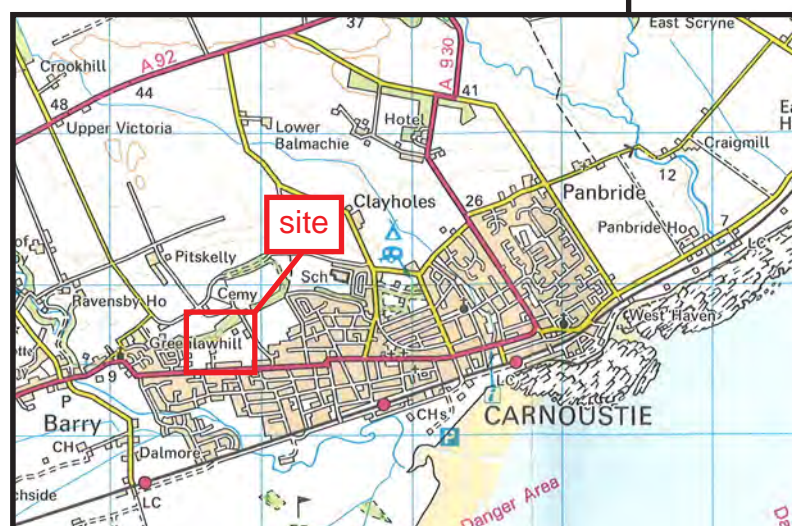
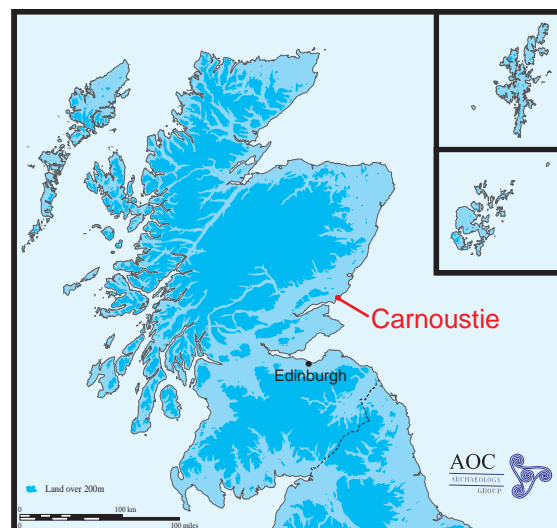

Figure 1: Site location and location of evaluation trenches and test pits

- ▬ proposed development area
- ▬ services buffer zone
- ▬ evaluation trenches and test pits

0 100m