

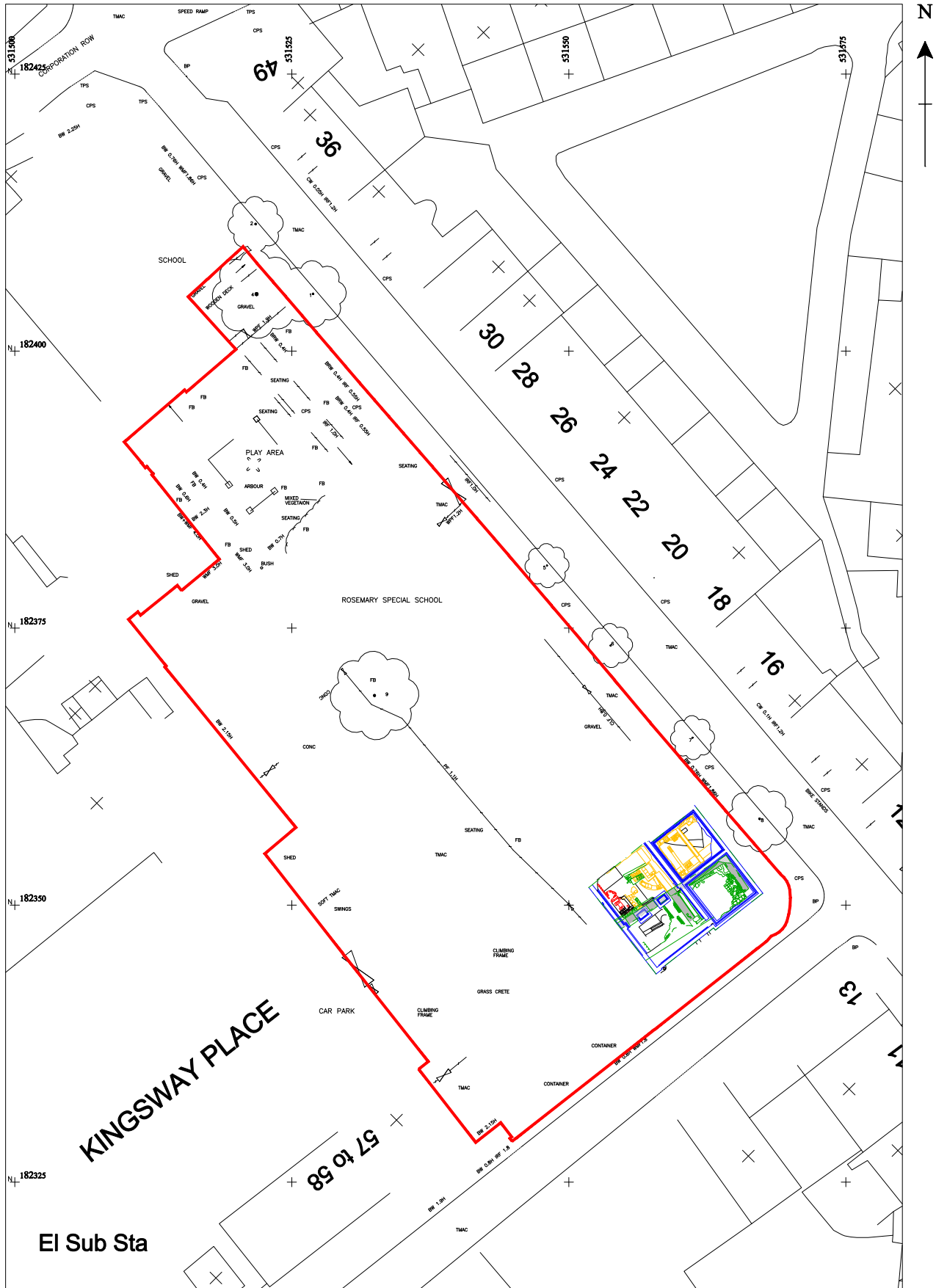

**ROSEMARY SCHOOL AND SENSORY GARDENS, 15 WOODBRIDGE STREET, LONDON BOROUGH OF ISLINGTON:  
A WRITTEN SCHEME OF INVESTIGATION FOR AN ARCHAEOLOGICAL EXCAVATION**



Based on the plans Provided by George Wimpey Homes

- Evaluation Trench
- Partially Excavated
- Stepped Open Area Excavation
- Sondage to be Excavated



**Figure 2: Detailed Site/Proposed Excavation Area Location Plan**

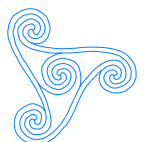

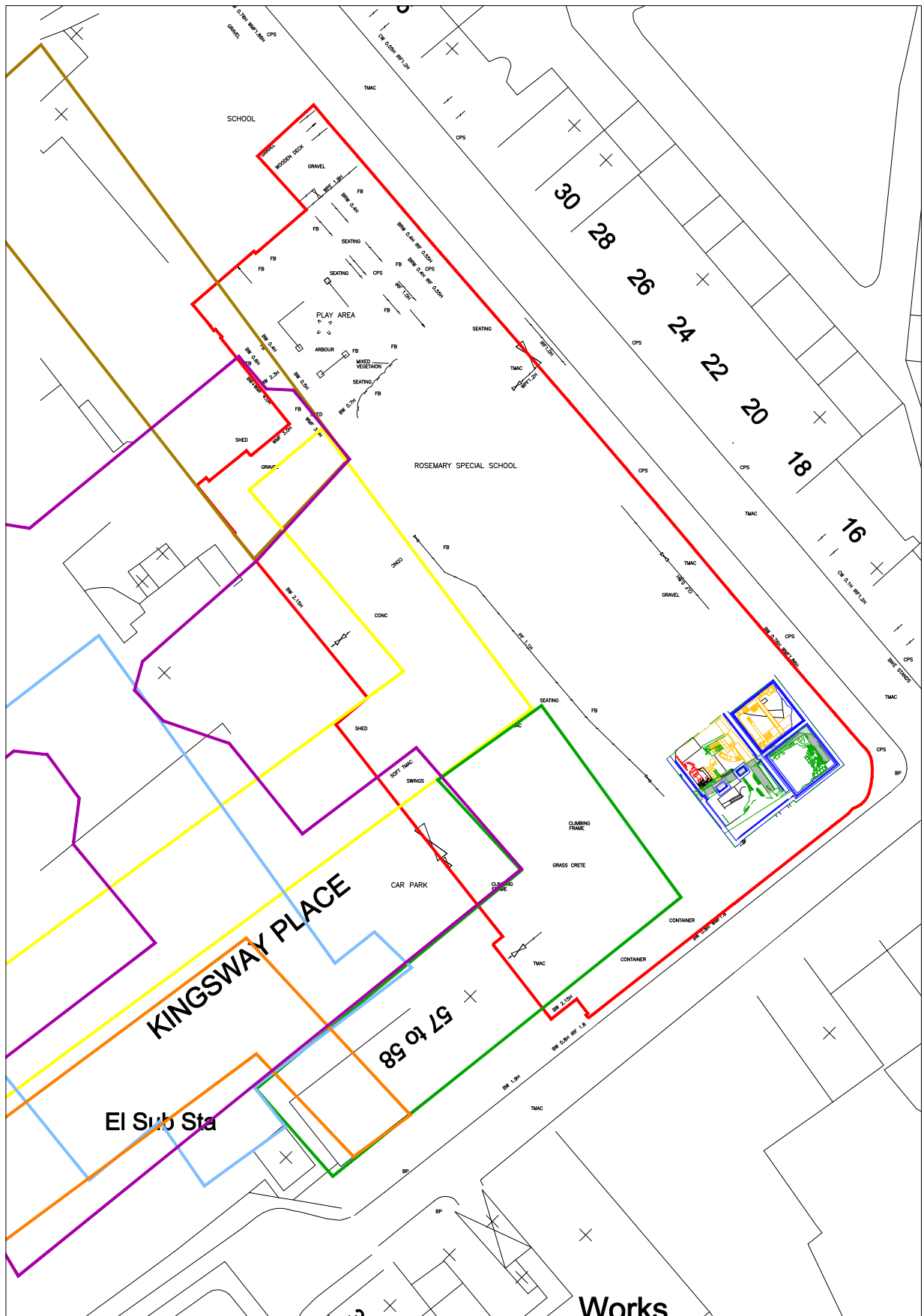

Based on the plans Provided by George Wimpey Homes

- |                         |                                      |
|-------------------------|--------------------------------------|
| Evaluation Trench       | Site Outline                         |
| Quaker Workhouse (1676) | New Prison (1746)                    |
| New Brideswell (1676)   | Old Brideswell and New Prison (1676) |
| New Prison (1676)       | House of Detention (C19th)           |

**Figure 2:** Detailed Site/Proposed Trench Location Plan

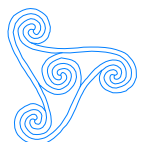

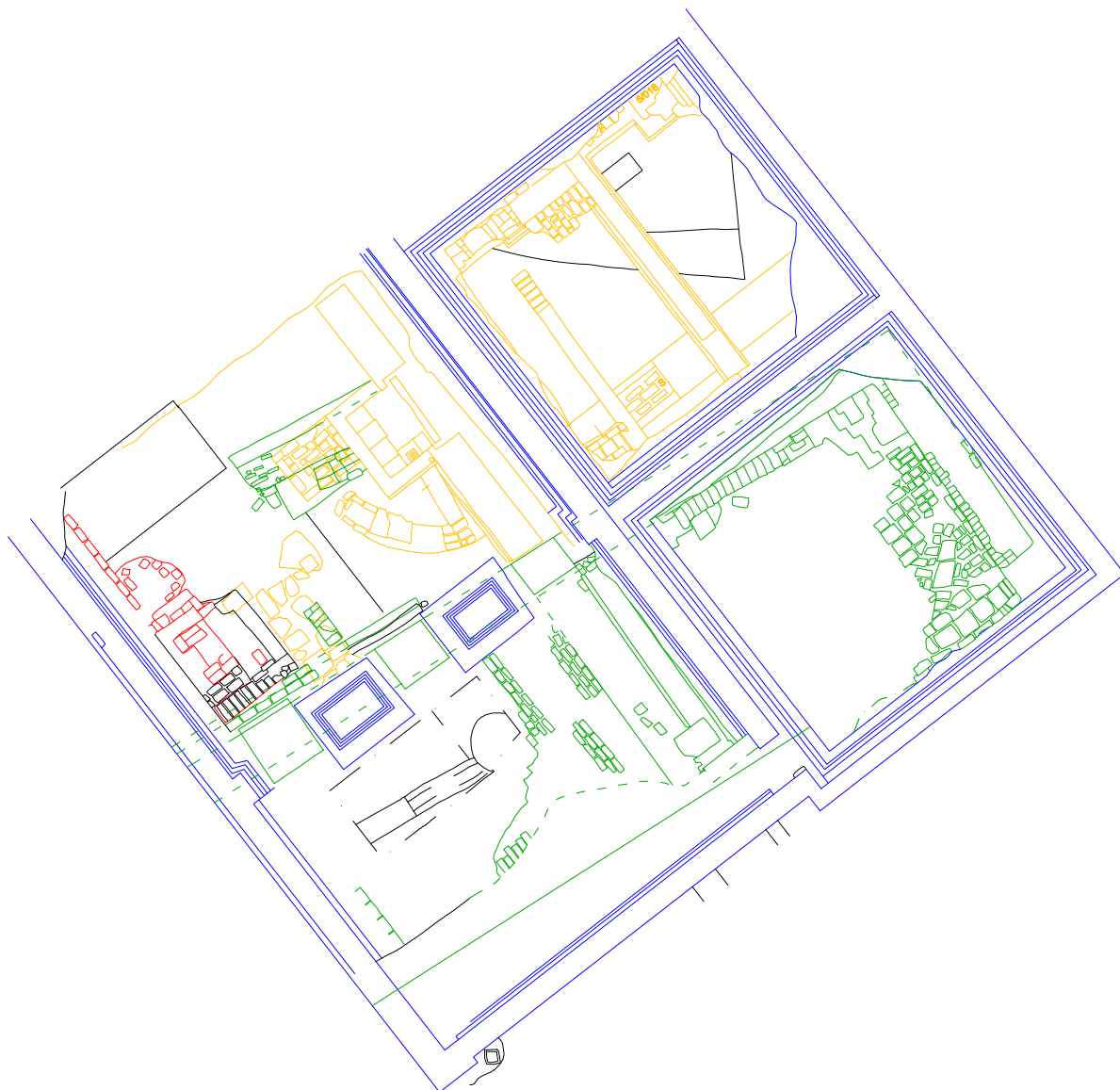
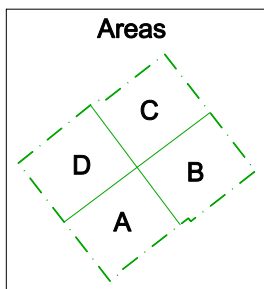

2.5m 0 5m

1:100

- Phase 2
- Phase 3, Building Phase 1
- Phase 3, Building Phase 2
- Phase 3, Building Phase 3
- Phase 3, Building Phase 4

**Figure 3:** Overall Plan of the Excavation Area

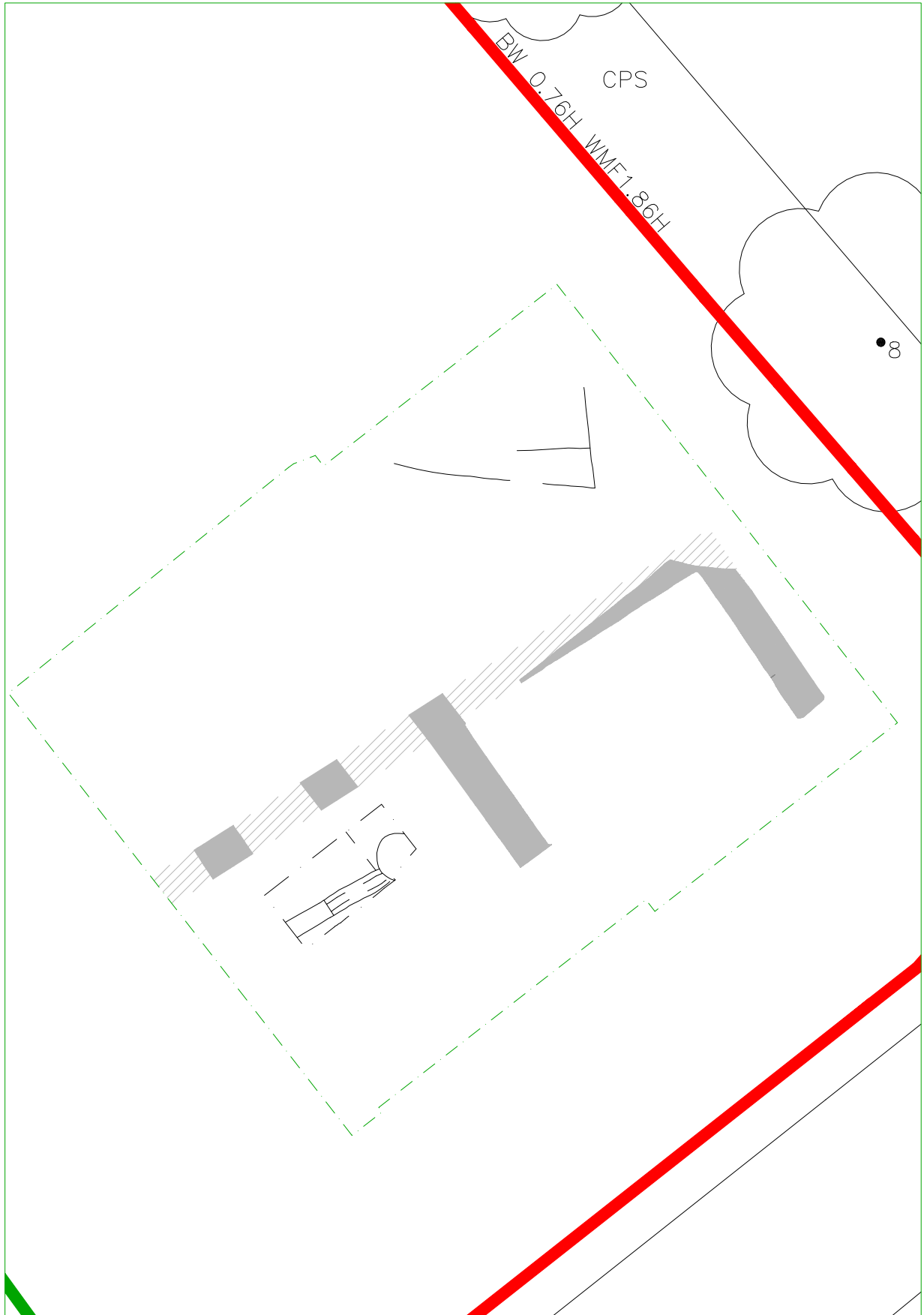



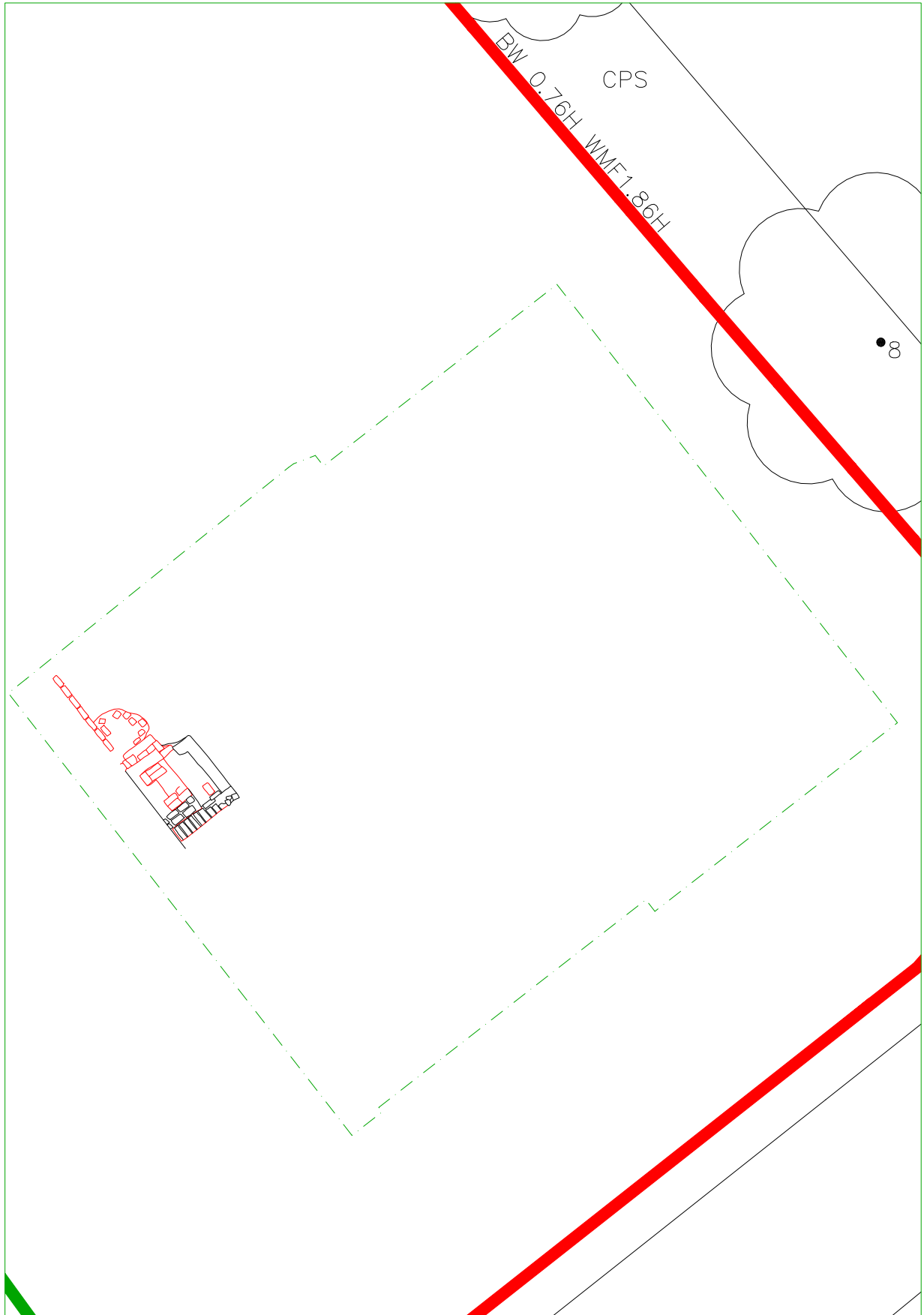

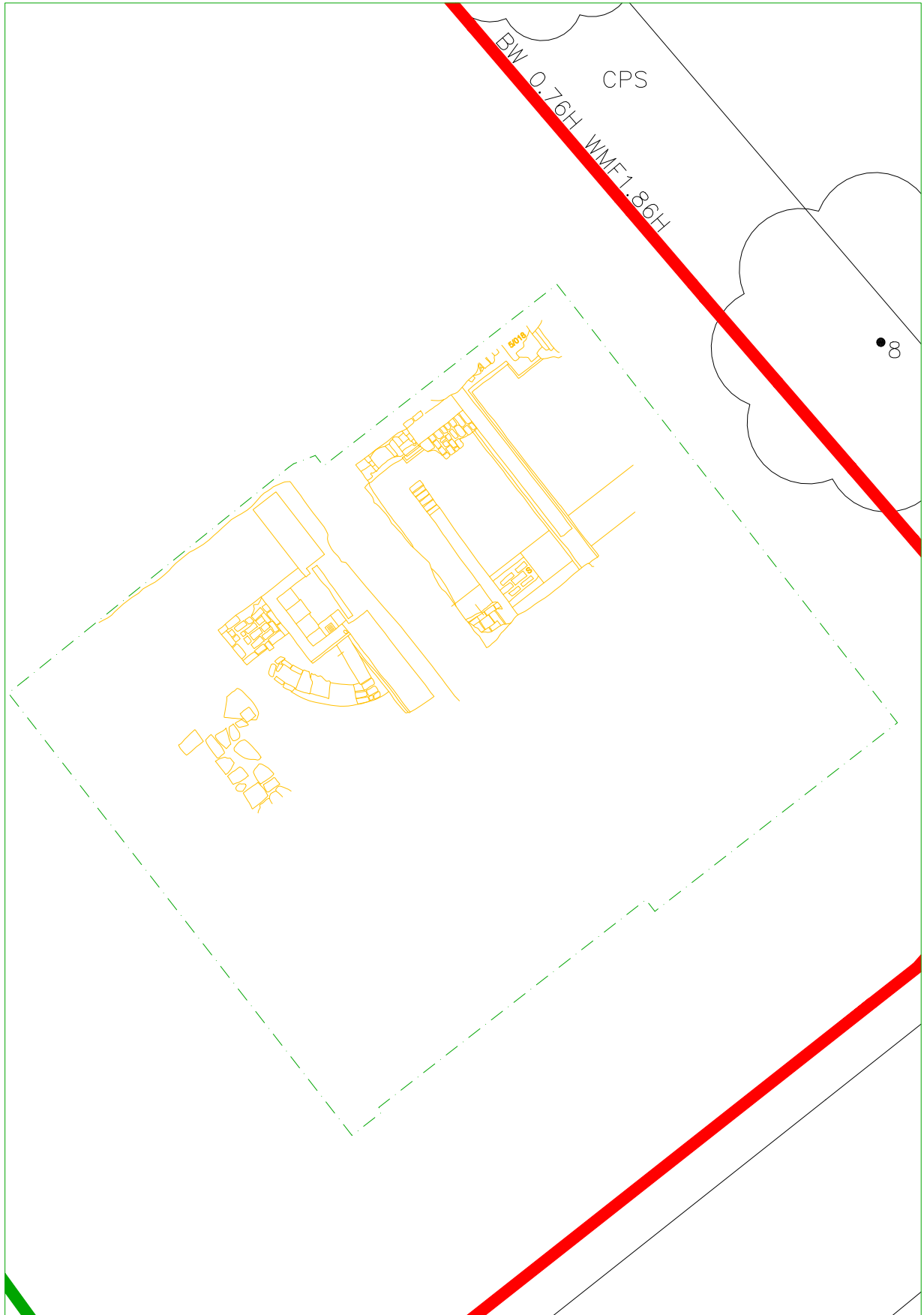



SCHOOL

CPS

IRRAWEL

WOODEN DECK

GRAVEL

WPF 1.9H

BRW 0.4H

FB

SEATING

BRW 0.4H IRF 0.55H

BRW 0.4H CPS

IRF 1.0H

PLAY AREA

ARBOUR

MIXED VEGETATION

SEATING

BUSH

SEATING

TMAC

IRF 1.0H

30

28

26

24

22

20

18

16

ROSEMARY SPECIAL SCHOOL

FB

9

CONC

CONC

BW 2.15H

PF 1.1H

SEATING

FB

TMAC

GRAVEL

FB 0.7H

7

CPS

BW 0.76H WPF 1.86H

CW 0.1H IRF 1.2H

8

SHED

SOFT TMAC

SWINGS

CAR PARK

CLIMBING FRAME

CLIMBING FRAME

GRASS CRETE

CONTAINER

BW 0.5H WPF 1.8

CONTAINER

TMAC

BW 2.15H

PF 1.8

SWAY PLACE

57

