

Ratho Park Golf Club, Edinburgh

Watching Brief Report

AOC 21423

30th October 2009

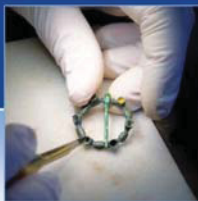

Ratho Park Golf Club, Edinburgh: Watching Brief Report

On Behalf of: **GVA Grimley**
Quayside House
127 Fountainbridge
Edinburgh
EH3 9QG

National Grid Reference (NGR): **NT 1478 7093**

AOC Project No: **21423**

Prepared by: **Martin Cook**

Illustration by: **Douglas Park**

Date of Fieldwork: **19th August to 18th September 2009**

Date of Report: **30th October 2009**

This document has been prepared in accordance with AOC standard operating procedures.

Author: Martin Cook

Date: 30th October 2009

Approved by: John Gooder

Date: 30th October 2009

Draft Report Stage: Draft

Date: 30th October 2009

Enquiries to: AOC Archaeology Group
Edgefield Industrial Estate
Edgefield Road
Loanhead
EH20 9SY

Tel. 0131 440 3593

Fax. 0131 440 3422

e-mail. admin@aocarchaeology.com

Contents

| | Page |
|--------------------------------------------------------------|-------------|
| List of illustrations | 4 |
| List of plates | 4 |
| Summary..... | 5 |
| 1 INTRODUCTION | 6 |
| 1.1 Project Background | 6 |
| 3 METHODOLOGY | 7 |
| 4 RESULTS | 8 |
| 5 CONCLUSION..... | 9 |
| 6 RECOMMENDATION..... | 9 |
| 7 BIBLIOGRAPHY | 9 |
| APPENDIX 1: Photographic Record | 11 |
| APPENDIX 2: Context Record | 11 |
| APPENDIX 3: Discovery and Excavation in Scotland Report..... | 12 |

List of illustrations

Figure 1: Site Location

Figure 2: Location of Watching Brief area

Figure 3: Plan of 19th Walled Garden

List of plates

Plate 1: Ratho House Estate (1st Edition OS Map 1853)

Plate 2: Detail of walled garden (1st Edition OS Map 1853)

Plate 3: Well [111]

Summary

This report represents the results of an archaeological watching brief undertaken by AOC Archaeology Group during groundworks associated with the construction of a groundskeeper's outbuilding at Ratho Golf Course, Edinburgh.

The archaeological work was required by a condition on planning consent (08/03213/FUL) in accordance with the policies set out in SPP23 (Scottish Government 2008) and PAN 42 (SOEnD 1994).

Evidence for the 19th century estate walled garden was identified and comprised stone built walls, red brick surfaces and a well. No further works are considered necessary.

1 INTRODUCTION

1.1 Project Background

1.1.1 AOC Archaeology Group was commissioned by GVA Grimley on behalf of their client, Ratho Golf Club, to undertake a watching brief during ground breaking works associated with the construction of green keeper's hut. The development area lies within the administrative jurisdiction of the City of Edinburgh Council (CEC). The Council is advised on archaeological matters by Mr. John Lawson of the City of Edinburgh Council Archaeology Service (CECAS). The archaeological works were required with regard to planning application 08/03213/FUL in accordance with SPP23 (Scottish Government 2008) and PAN 42 (SOEnD 1994).

1.2.2 A series of features associated with the 19th century Ratho House Estate were identified and recorded during the course of the works.

1.2 Archaeological Background

1.2.1 The development area lies within an historic landscape occupied since at least the medieval period. An estate at Ratho is documented as passing to Robert I in 1315 with a later charter (1563) mentioning the acquisition of the estate, complete with tower and manor, to an Alexander Foulis. The existing, A-listed, Ratho House dates to 1824, but an earlier residence (perhaps late 17th/early 18th century) is inferred by a 1713 inscription on the estate's doocot.



Plate 1: Ratho House Estate (1st Edition OS Map 1853)

1.2.2 The development area is situated immediately south and south-east of the estate's B-listed steading and stables (NMRS NT17SW 45; NGR: NT 1478 7093). The development area overlies the northern wall of an associated walled garden illustrated on the mid 19th century First Edition Ordnance Survey Map. A recent engineering test-pit revealed the wall to be constructed from sandstone ashlar masonry similar to that used in building Ratho House.



Plate 2: Detail of walled garden (1st Edition OS Map 1853)

- 1.2.3 It was anticipated that the watching brief may encounter further remnants of the walled garden boundary and other related 19th century features. There was also the possibility that entirely disassociated archaeological material from earlier periods may also have been unearthed by ground-breaking works.

2 AIMS

- 2.1 The archaeological works were in the form of a watching brief on ground breaking works associated with the construction of the green keeper's hut. The aims of the archaeological watching brief were:
- i) to safeguard the archaeological resource from any adverse impacts created by groundworks associated with the development;
 - ii) to liaise with CECAS and the client in the event of significant archaeological features and/or small finds being unearthed as to the most appropriate response in safeguarding these features either by preservation *in situ*, if at all feasible, or by archaeological recording;
 - iii) to report on the results of the watching brief.

3 METHODOLOGY

- 3.1 The Watching Brief adhered to the Written Scheme of Investigation (AOC 2009), prepared by AOC and agreed by CECAS on behalf of the planning authority. The strip of the overburden was by means of a 'back-actor' mechanical excavator equipped with a toothless ditching bucket. All machine excavation was supervised by an experienced field archaeologist (Watching Brief Officer). The archaeological works comprised the archaeological monitoring of topsoil/overburden stripping. A change in the design of the carpark (ground level here is now being raised) meant that the landscaping works associated with the overflow carpark development were not monitored.

3.2 All monitoring was undertaken according to AOC Archaeology Group's standard operating procedures (Appendix 21). The palaeoenvironmental sampling strategy is detailed in Appendix 7, Section 7.11.

4 RESULTS

4.1 The ground breaking works were undertaken intermittently between 19th August and 18th September 2009, in variable weather conditions. Archaeological visibility was good throughout.

4.2 The watching brief identified a series of mortar bonded sandstone walls, red brick surfaces and a red brick-built well or cistern within the footprint of the greenkeeper's hut, all associated with the 19th century walled garden and pavilion (Figure 3). All the features were founded on the natural subsoil.

4.3 The structures were generally extremely truncated, with only the lower foundations of each features surviving. In total the structure measured 28 m east to west by 3 m north to south. The main feature comprised an east to west aligned, mortar bonded sandstone wall [102], which ran parallel to two other sandstone walls ([105] and [106]). Walls [102] and [105] were adjoined by five north to south aligned sandstone walls ([103], [104], [107], [108] and [112]). The internal area between the walls was paved in part by both red brick [109] and sandstone [110] flooring, directly overlying the natural soil.



Plate 3: Well [111]

- 4.4 An oval, red brick-built setting [111] was identified within the internal area between walls [104] and [112]. The structure excavated at least 8 m into the natural subsoil, represents the remains of 19th century well or cistern. The well measured 3 m by 2 m in plan. The location of the well within the possible building, suggest that it may post-date the surrounding structures.
- 4.5 The groundbreaking works have removed all the features identified, apart from the well feature which was capped and reburied.
- 4.6 No other significant archaeological features no artefacts were identified.

5 CONCLUSION

- 5.1 The archaeological watching brief identified and recorded a series of features associated with the 19th century walled garden and pavilion, itself a feature of the Ratho House Estate. Prior to their removal, all the features were fully recorded.

6 RECOMMENDATION

- 5.2 No further works are considered necessary. The recommendation will require confirmation by CECAS acting on behalf of the planning authority.

7 BIBLIOGRAPHY

Edinburghshire, Sheet V, 1st Edition OS Map

Scottish Planning Policy SPP23. Archaeology and Planning. Scottish Government Nov.2008.

The Scottish Office Environment Department 1994 *Planning Advice Note 42. Archaeology – the Planning Process and Scheduled Ancient Monument Procedures.* January 1994.

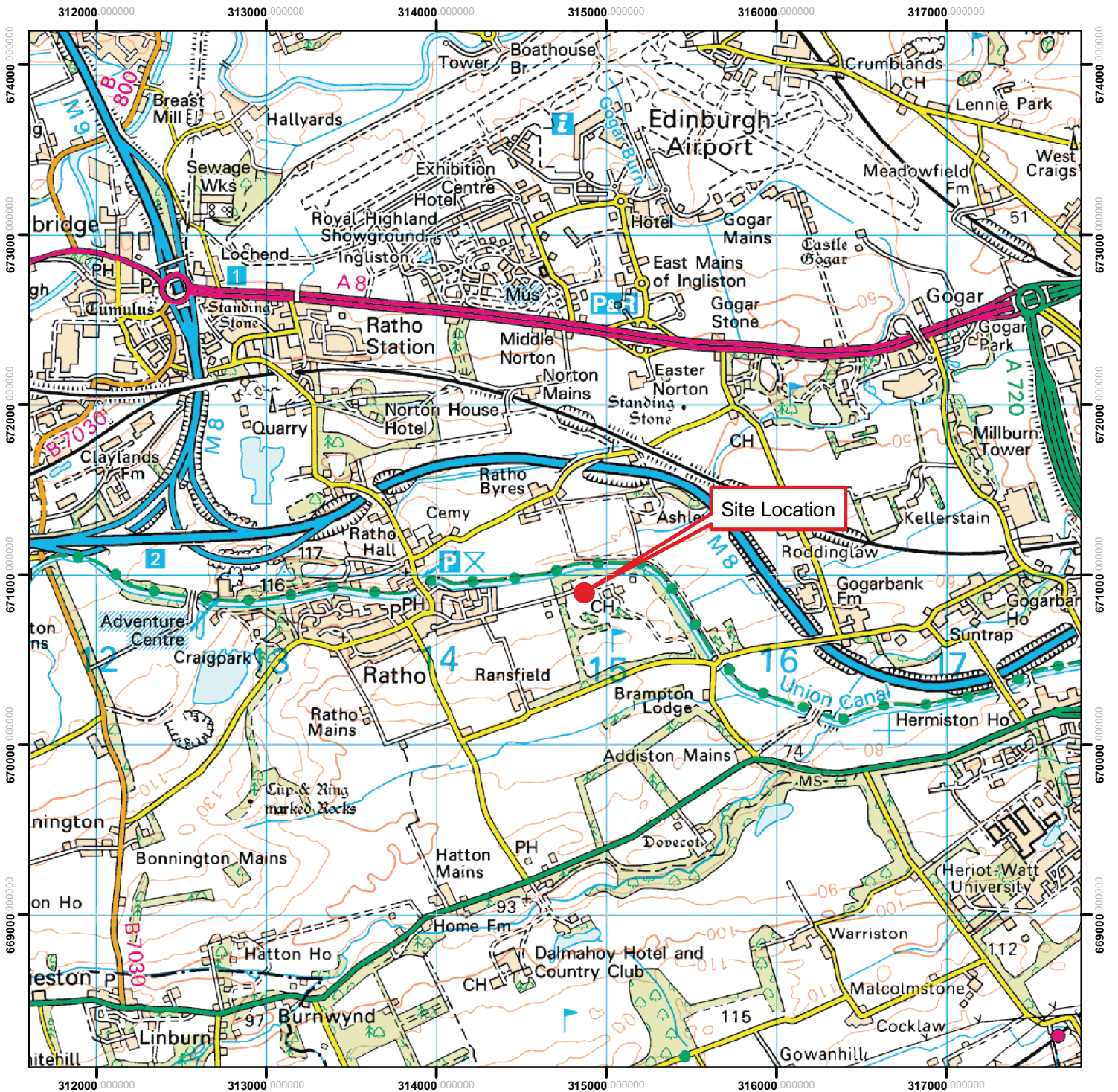
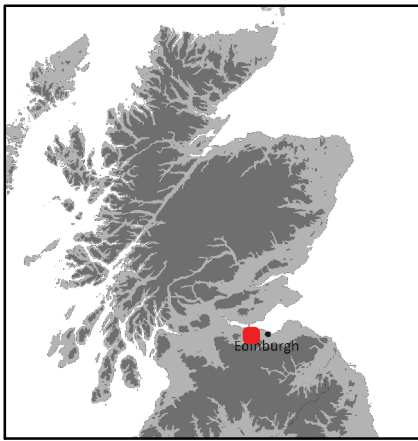

0 0.125 0.25 0.5 0.75 1 km

Figure 1: Site Location



© AOC Archaeology 2009

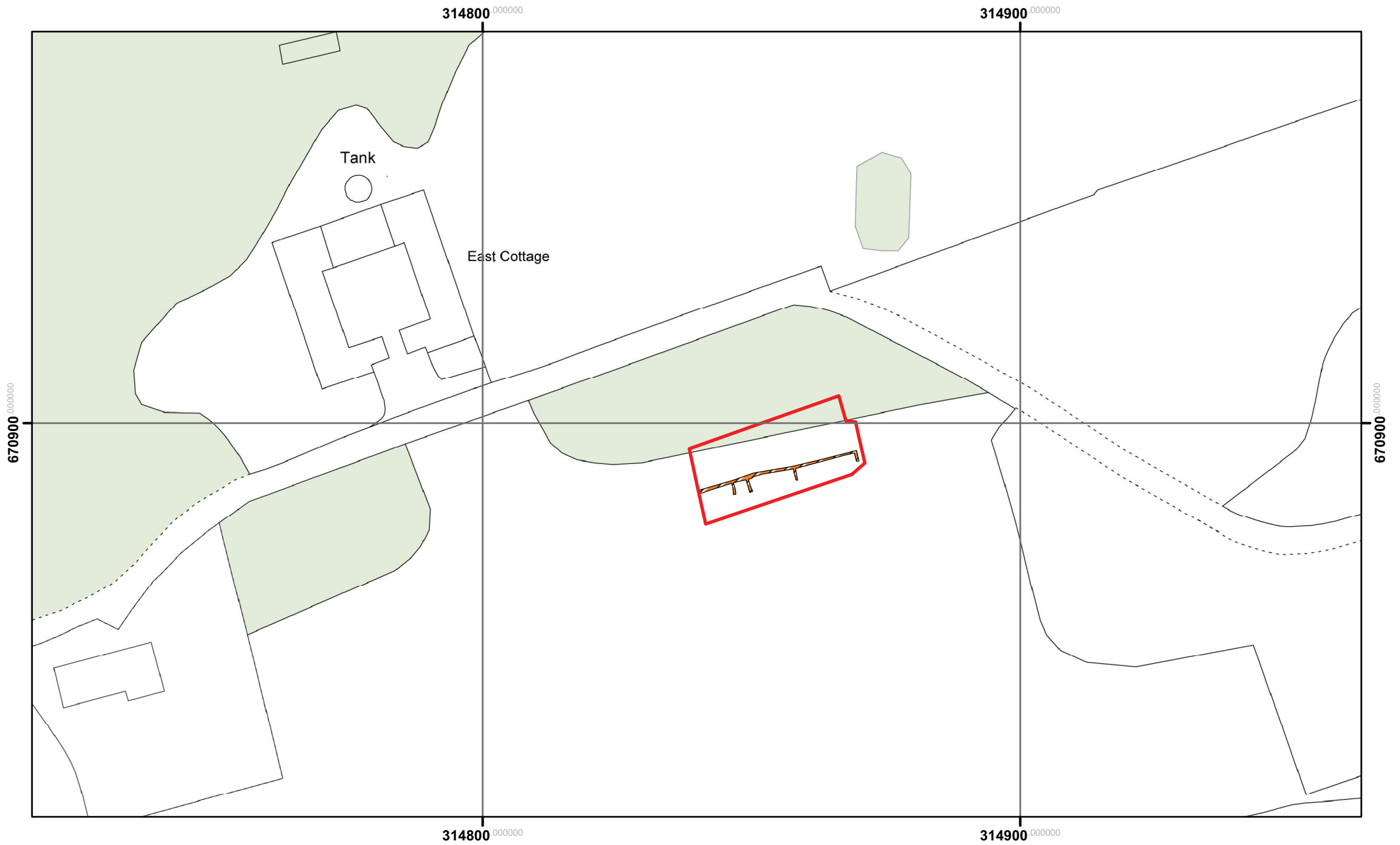



Figure 2: Location of Watching Brief area

-  Extent of Excavation
-  Walled Garden



0 2.5 5 10 15 20
Meters

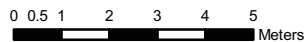
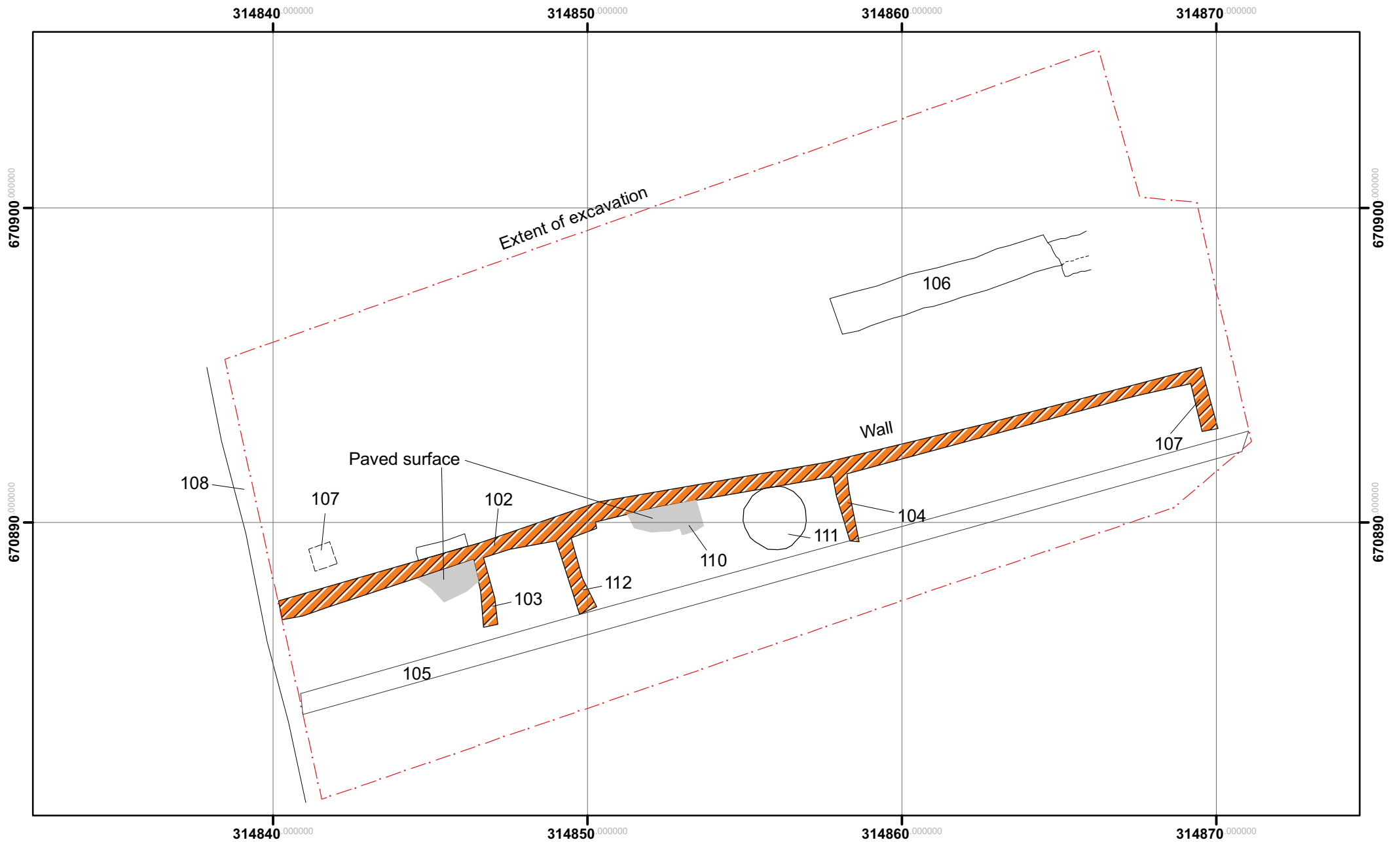





Figure 3: Plan of 19th c. Walled Garden

-  Paved Surface
-  Extent of Excavation
-  Walled Garden

Ratho Park Golf Course: Watching Brief Report

Section 2: Appendices

APPENDIX 1: Photographic Record

Black & White Print and Digital Film 1

| Frame | Description | From |
|-------|--------------------------------------------------------------|------|
| 1-2 | Registration shots | |
| 3-4 | Detail of well feature | N |
| 5-6 | Detail of well feature | N |
| 7-8 | Detail of well feature | E |
| 9-10 | Detail of well feature | S |
| 11-12 | General working shot of site | N |
| 13-14 | Detail of north to south aligned walled garden wall | E |
| 15-16 | Detail of north to south aligned walled garden wall | N |
| 17-18 | Detail of well feature | N |
| 19-20 | Pre-ex shot of area of greenkeeper's shed | E |
| 21-22 | General shot of walled garden and associated paving | E |
| 23 | Detail of stone paving to south of walled garden | W |
| 24 | Detail of brick well | S |
| 25-26 | Detail of brick surface and sandstone wall | W |
| 27 | General shot of (walled garden) east to west aligned wall | W |
| 28 | General shot of (walled garden) east to west aligned wall | E |
| 29 | Detail of north to south aligned wall abutting walled garden | S |
| 30 | Stone feature to north to walled garden | W |
| 31 | General shot of site | NW |
| 32 | General shot of site | E |
| 33 | North-facing section of walled garden wall | N |
| 34 | General working shot of site | NE |
| 35 | Detail of wall | E |
| 36 | Detail of wall | W |
| 37 | Detail of brick surface | S |

APPENDIX 2: Context Record

| Context | Description |
|---------|--------------------------------------------------------------------------------------------------------------------|
| 101 | General number assigned to a series of sandstone and red brick walls representing the remains of the walled garden |
| 102 | East to west aligned sandstone wall. |
| 103 | North to south aligned sandstone wall. |
| 104 | North to south aligned sandstone wall |
| 105 | East to west aligned sandstone wall |
| 106 | East to west aligned sandstone wall |
| 107 | Stone setting |
| 108 | North to south aligned sandstone wall |
| 109 | Red brick surface |
| 110 | Stone paving |
| 111 | Red brick built well |
| 112 | North to south aligned sandstone wall |

APPENDIX 3: Discovery and Excavation in Scotland Report

| | |
|-------------------------------------------------------------------------------------|----------------------------------------------------------------------------------------------------------------------------------------------------------------------------------------------------------------------------------------------------------------------------------------------------------------------------------------------------------------------------------------------------------------------------------------------------|
| LOCAL AUTHORITY: | City of Edinburgh |
| PROJECT TITLE/SITE NAME | Ratho Park Golf Course |
| PROJECT CODE: | AOC 21423 |
| PARISH: | Ratho |
| NAME OF CONTRIBUTOR: | Martin Cook |
| NAME OF ORGANISATION: | AOC Archaeology Group |
| TYPE(S) OF PROJECT: | Archaeological Watching Brief |
| NMRS NO(S) | NT17SE40.03 |
| SITE/MONUMENT TYPE(S): | 19 th century walled garden and pavilion |
| SIGNIFICANT FINDS: | None |
| NGR (2 letters, 6 figures) | NT 1478 7093 |
| START DATE (this season) | 18 th August 2009 |
| END DATE (this season) | 19 th September 2009 |
| PREVIOUS WORK (incl. DES ref.) | None |
| MAIN (NARRATIVE) DESCRIPTION: (May include information from other fields) | <p>An archaeological watching brief was undertaken on ground-breaking works associated with the construction of a greenkeeper's hut at Ratho Park Golf Course, Edinburgh.</p> <p>Remains comprising sandstone walls, red brick surface and a brick-built well or cistern were identified. Cartographic regression shows that these features are related to the 19th century walled garden and pavilion associated with Ratho House.</p> |
| PROPOSED FUTURE WORK: | None |
| CAPTION(S) FOR ILLUSTRS: | -- |
| SPONSOR OR FUNDING BODY: | GVA Grimley |
| ADDRESS OF MAIN CONTRIBUTOR: | Edgefield Road Industrial Estate, Loanhead, Midlothian, EH20 9SY |
| EMAIL ADDRESS: | admin@aocscot.co.uk |
| ARCHIVE LOCATION (intended/deposited) | Archive to be deposited in NMRS |

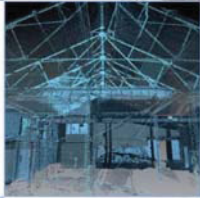

AOC Archaeology Group, Edgefield Industrial Estate, Edgefield Road, Loanhead EH20 9SY
tel: 0131 440 3593 | fax: 0131 440 3422 | e-mail: admin@aocarchaeology.com

www.aocarchaeology.com