

Ayton, Berwickshire: Evaluation Data Structure Report

AOC Project 21794
10th December 2010

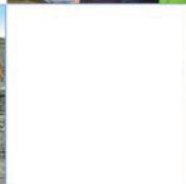
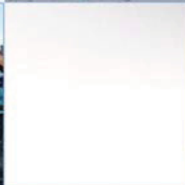
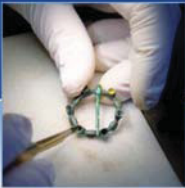

ARCHAEOLOGY

| HERITAGE

| CONSERVATION

Ayton, Berwickshire, Evaluation: Data Structure Report

On Behalf of: Fjordhus Construction Ltd
Langhaugh House
Langhaugh Industrial Estate
Galashiels
TD12AJ

National Grid Reference (NGR): NT 9197 6089

AOC Project No: 21794

OASIS Project No: aocarcha1-89170

Prepared by: Martin Cook

Illustration by: Stefan Sagrott

Date of Fieldwork: 9th December 2010

Date of Report: 10th December 2010

This document has been prepared in accordance with AOC standard operating procedures.

Author: Martin Cook

Date: 10th December 2010

Approved by: John Gooder

Date: 11th December 2010

Draft/Final Report Stage: Draft

Date: 11th December 2010

Enquiries to: AOC Archaeology Group
Edgefield Industrial Estate
Edgefield Road
Loanhead
EH20 9SY

Tel. 0131 440 3593
Fax. 0131 440 3422
e-mail. admin@aocarchaeology.com



Contents

	Page
List of illustrations.....	1
List of Plates.....	1
List of appendices	1
Abstract.....	2
1 INTRODUCTION.....	3
1.1 Background.....	3
1.2 Location	3
1.3 Archaeological background	3
2 OBJECTIVES.....	3
3 METHODOLOGY.....	4
4 RESULTS.....	4
5 CONCLUSION	6
6 RECOMMENDATIONS.....	6
7 BIBLIOGRAPHIC REFERENCES.....	6
APPENDIX 1: Trench Descriptions	8
APPENDIX 2: Photographic Record	9
APPENDIX 3: ' <i>Discovery and Excavation in Scotland</i> ' Report.....	10

List of illustrations

- Figure 1 Site Location
Figure 2 Location of evaluation trenches

List of Plates

- Plate 1 Post-excavation shot of Trench 1
Plate 2 Post-excavation shot of Trench 5

List of appendices

- Appendix 1 Trench Descriptions
Appendix 2 Photographic Record
Appendix 3 '*Discovery and Excavation in Scotland*' Report

Abstract

This report represents the results of an archaeological evaluation undertaken by AOC Archaeology Group on the site of three proposed residential dwellings at Beanburn, Ayton, Berwickshire.

The archaeological evaluation comprised a trenching sample in excess of 10%, and focussed on a linear cropmark comprising a pit alignment (NMRS: NT96SW 35).

The site was found to be archaeologically sterile, with only modern features such as field drains being identified.

1 INTRODUCTION

1.1 Background

- 1.1.1 AOC Archaeology Group was commissioned by Fjordhus Construction Ltd, on behalf of their client, to undertake an archaeological evaluation in advance of the construction of three residential dwellings at Beanburn, Ayton, Berwickshire (centred NGR: NT 9197 6089).
- 1.1.2 The proposed development lies within the administrative area of Scottish Borders Council, which is advised on archaeological matters by Dr Chris Bowles, Archaeology Officer. The archaeological works were carried out in accordance with *Scottish Planning Policy* (Scottish Government February 2010) and *Planning Advice Note 42* (SOEnd 1994) in determining the nature, extent, condition, date and significance of any archaeological remains within the proposed development area.
- 1.1.3 A *Written Scheme of Investigation* (AOC 2010) was agreed with Dr Bowles in advance of the evaluation being undertaken. The evaluation was designed around a 10% trenching sample, of each individual house plot, equating to 96 m² of evaluation trenching.
- 1.1.4 Neither significant archaeological features nor artefacts were identified.

1.2 Location

- 1.2.1 The proposed development area (NGR: NT 9197 6089) is located within former ploughed agricultural land on the south-eastern edge of Ayton, Berwickshire, Scottish Borders. The site is bounded by agricultural land to the north and west, an existing school to the east and the Old Town Road to the south.

1.3 Archaeological background

- 1.3.1 The three development plots lie within an archaeologically rich landscape, with a variety of Scheduled Ancient Monuments and cropmarks within the local vicinity. Specifically, a pit alignment (NMRS: NT96SW 35) is recorded running north-east from the Eye Water through Plot 3 and Plot 1A. The cropmark forms part of a larger cropmark complex with NMRS: NT96SW 43 and NMRS: NT96SW 69 as 'Bleachfield, settlement, enclosure, pit alignment. These two latter sites together form part of a Scheduled Ancient Monument (SAM: 12508).
- 1.3.2 A cropmark to the immediate north of the development area comprises a possible prehistoric roundhouse, a ring-ditch (NMRS: NT96SW 121) while an enclosure (NMRS: NT96SW 122) may form the remnants of a building or field system.

2 OBJECTIVES

- 2.1 The objectives of the archaeological evaluation were:
- i) to determine and assess the character, extent, condition, quality, date and significance of any buried archaeological remains within the proposed development area;

- ii) to advise and implement an appropriate form of mitigation, such as excavation, post-excavation analyses and publication, given the infeasibility of preserving the archaeological material *in situ*, should significant archaeological remains be encountered.

3 METHODOLOGY

- 3.1 The trenching was designed to establish the extent, condition, character, quality, significance and date of any archaeological features present within the site area. Specifically, the trenching was located to target the cropmark. The trenching comprised the excavation of seven trenches of varying size and orientation across the three house plots. The Written Scheme of Investigation (AOC 2010) required a minimum of 96 m² of evaluation trenching.
- 3.2 The evaluation was undertaken by means of a single 360 tracked excavator equipped with a 1.6 m wide toothless ditching bucket. Excavation was undertaken in shallow units/spits until the first significant archaeological horizon or natural subsoil was reached. All machine excavation was supervised by an experienced field archaeologist.
- 3.3 All trial trenching was undertaken according to AOC Archaeology Group's standard operating procedures. The trenches were backfilled on completion of the evaluation.

4 RESULTS

4.1 Introduction

- 4.1.1 The archaeological evaluation was undertaken on 9th December 2010. Overall weather conditions were good, but very cold, with snow covering the ground. The following should be read in conjunction with the data presented in Appendices 1-3 and Figure 1.
- 4.1.2 The excavation of the trenches revealed topsoil comprising soft, black/brown silty material. Very few modern finds were identified within the topsoil. Underlying the topsoil, natural subsoil varied between areas of compact sand and silt, and loose gravels.
- 4.1.3 Three trenches were excavated across House Plot 1A, all focussing on the cropmark (Figure 2; NMRS: NT96SW 35). The topsoil varied in depth between 0.20 m to 0.40 m. No significant archaeological features were identified.
- 4.1.4 Two trenches were excavated across House Plot 1B, in a T-shape across the location of the house. The topsoil varied between 0.25 and 0.30 m in depth. No significant archaeological features were identified.



Plate 1: Post-excitation shot of Trench 1

- 4.1.5 Two trenches were excavated across House Plot 3, all focussing on the cropmark (Figure 2; NMRS: NT96SW 35). The topsoil varied in depth between 0.30 m to 0.40 m. No significant archaeological features were identified.



Plate 2: Post-excitation shot of Trench 6

- 4.1.6 A single modern service was identified running across Trench 2, and a rubble drain was identified within Trench 3.

5 CONCLUSION

- 5.1 Despite the presence of cropmark evidence the archaeological evaluation identified neither significant archaeological features nor artefacts. The evaluation has raised questions regarding the lifetime of a cropmarks following initial observation where ground is still subjected to ploughing. It further highlights the confusing cropmark anomalies caused by slight variations in subsurface geology.

6 RECOMMENDATIONS

- 6.1 No further archaeological works are considered necessary. This recommendation will require confirmation by Dr Bowles on behalf of Scottish Borders Council.

7 BIBLIOGRAPHIC REFERENCES

AOC Archaeology 2010 Ayton, Berwickshire: *Written Scheme of Investigation*. Unpubl AOC Archive Document.

Scottish Government 2010 *Scottish Planning Policy* (February 2010)

SOEnd 1994 *Planning Advice Note 42. Archaeology – The Planning Process and Scheduled Ancient Monument Procedures*. The Scottish Office Environment Department.

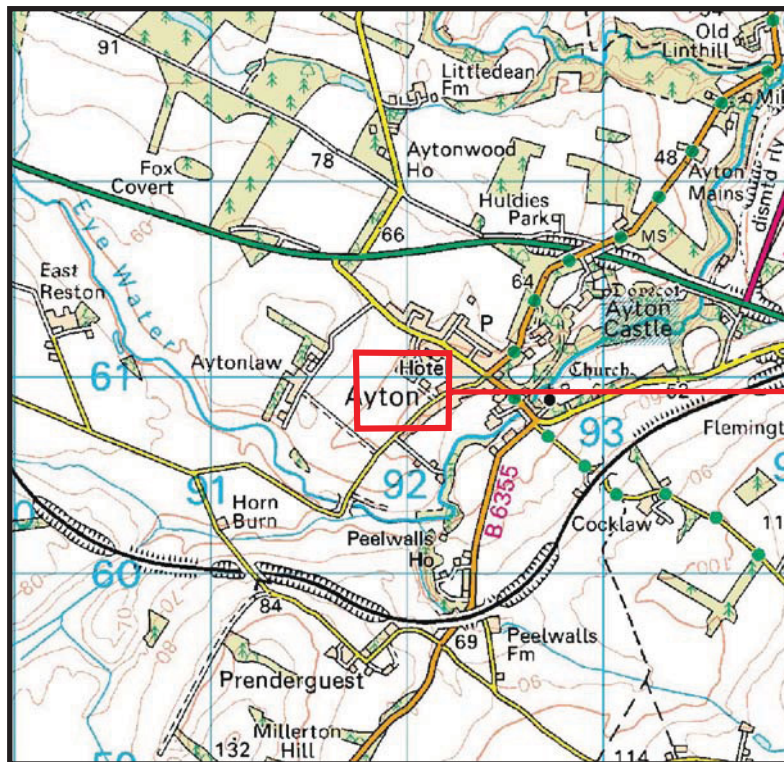
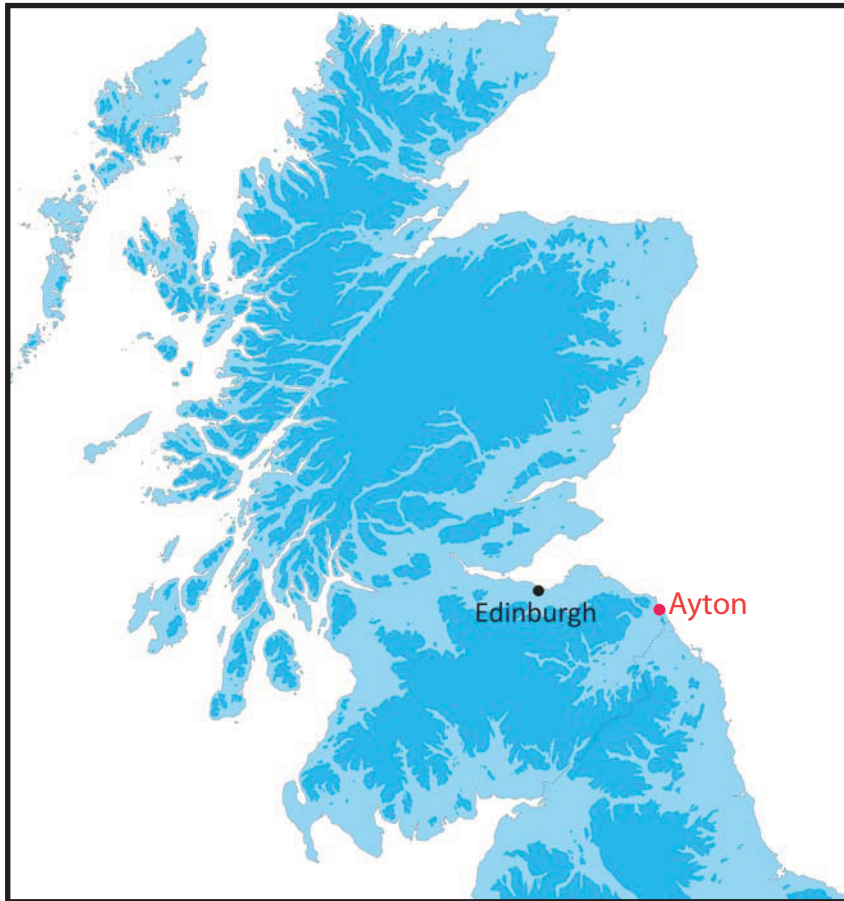

Site Area

Reproduced from the Ordnance Survey 1:50 000 scale map with the permission of the controller of Her Majesty's Stationary Officer. Crown Copyright.
AOC Archaeology Group, Edgefield Industrial Estate, Loanhead, Midlothian, EH20 9SY
OS License No.: 100016114

Figure 1: Location of the site at Ayton, Berwickshire

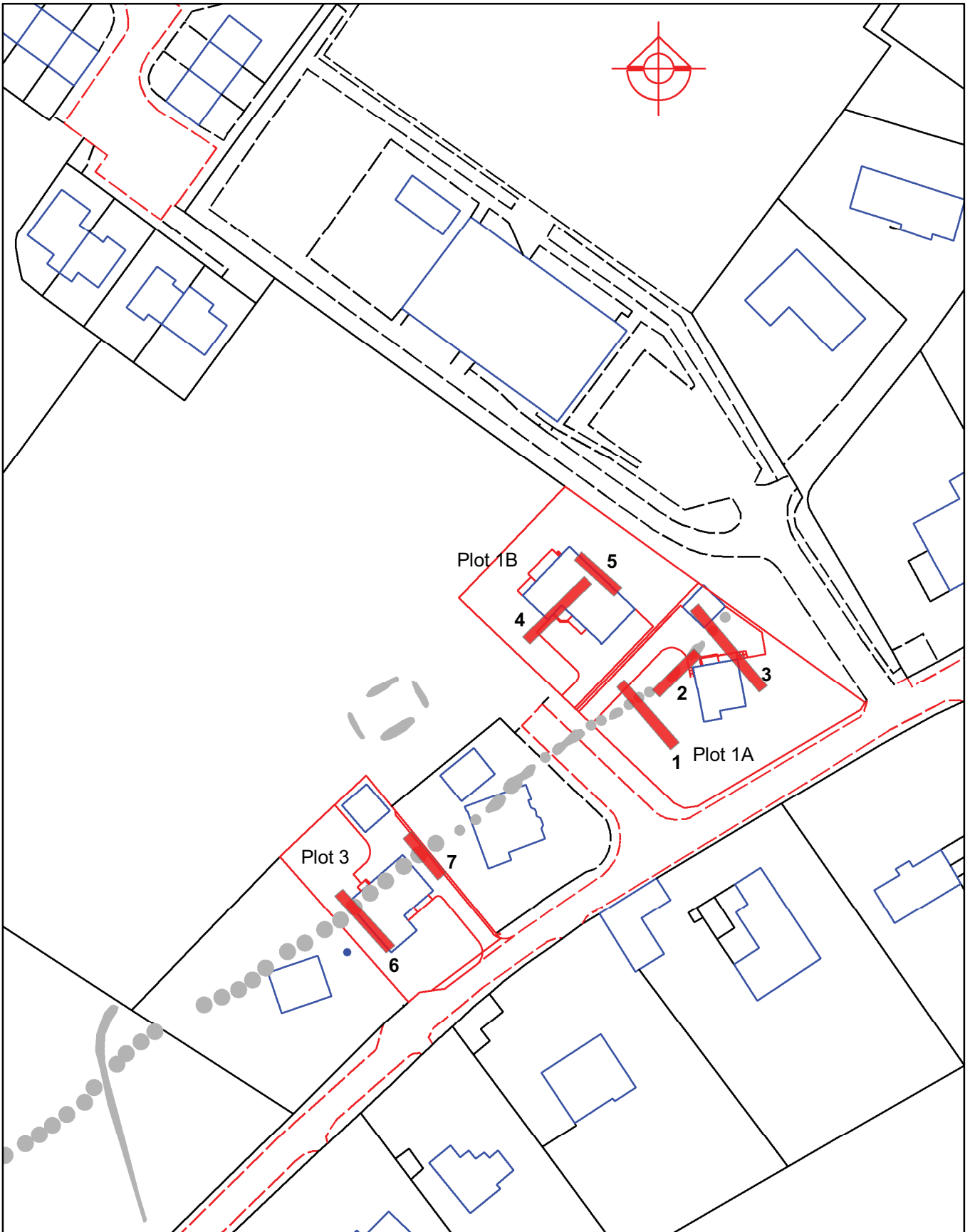

Figure 2: Ayton, Berwickshire: trench layout

Legend

- trench
- cropmark

Project No.: 21794

Date: 7/12/10

Scale at A4: 1:1,000



(c) AOC Archaeology 2010

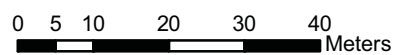

Cartographic data (C) Ordnance Survey 2008
License 00042300



Ayton, Berwickshire Evaluation: Evaluation Data Structure Report

Section 2: Appendices

APPENDIX 1: Trench Descriptions

Trench 1

<i>Dimensions</i>	15 m by 1.6 m
<i>Orientation</i>	NW-SE
<i>Depth of Topsoil</i>	0.30-0.40 m
<i>Significant Features</i>	None
<i>Other Features</i>	None
<i>Subsoil</i>	Gravel and sand
<i>Finds</i>	None

Trench 2

<i>Dimensions</i>	12 m by 1.6 m
<i>Orientation</i>	NE-SW
<i>Depth of Topsoil</i>	0.30-0.40 m
<i>Significant Features</i>	None
<i>Other Features</i>	Water pipe
<i>Subsoil</i>	Gravel and sand
<i>Finds</i>	None

Trench 3

<i>Dimensions</i>	19 m by 1.6 m
<i>Orientation</i>	NW-SE
<i>Depth of Topsoil</i>	0.40 m
<i>Significant Features</i>	None
<i>Other Features</i>	Rubble drain
<i>Subsoil</i>	Gravel and sand
<i>Finds</i>	None

Trench 4

<i>Dimensions</i>	16 m by 1.6 m
<i>Orientation</i>	NE-SW
<i>Depth of Topsoil</i>	0.30-0.40m
<i>Significant Features</i>	None
<i>Other Features</i>	None
<i>Subsoil</i>	Gravel and sand
<i>Finds</i>	None

Trench 5

<i>Dimensions</i>	10 m by 1.6 m
<i>Orientation</i>	NW-SE
<i>Depth of Topsoil</i>	0.40 m
<i>Significant Features</i>	None
<i>Other Features</i>	None
<i>Subsoil</i>	Gravel and sand
<i>Finds</i>	None

Trench 6

<i>Dimensions</i>	14 m by 1.6 m
<i>Orientation</i>	NW-SE
<i>Depth of Topsoil</i>	0.30 m
<i>Significant Features</i>	None
<i>Other Features</i>	None
<i>Subsoil</i>	Gravel and sand

Finds None

Trench 7

Dimensions 10 m by 1.6 m

Orientation NW-SE

Depth of Topsoil 0.40 m

Significant Features None

Other Features None

Subsoil Sand and sand

Finds None

APPENDIX 2: Photographic Record

Black & White Print/ /Digital Film 1

Frame	Trench	Description	From
1-2		Registration	
3-4	1	Post-excavation shot of trench	S
5-6	2	Post-excavation shot of trench	W
7-8	3	Post-excavation shot of trench	S
9-10	4	Post-excavation shot of trench	W
11-12	5	Post-excavation shot of trench	S
13-14	6	Post-excavation shot of trench	S
15-16	7	Post-excavation shot of trench	S

APPENDIX 3: 'Discovery and Excavation in Scotland' Report

LOCAL AUTHORITY:	Scottish Borders Council
PROJECT TITLE/SITE NAME	Ayton, Berwickshire
PROJECT CODE:	AOC 21794
PARISH:	Ayton
NAME OF CONTRIBUTOR:	Martin Cook
NAME OF ORGANISATION:	AOC Archaeology Group
TYPE(S) OF PROJECT:	Archaeological Evaluation
NMRS NO(S)	NT96SW 35
SITE/MONUMENT TYPE(S):	N/A
SIGNIFICANT FINDS:	None
NGR (2 letters, 6 figures)	NT 9197 6089
START DATE (this season)	9 th December 2010
END DATE (this season)	9 th December 2010
PREVIOUS WORK (incl. DES ref.)	N/A
MAIN DESCRIPTION: (May include information from other fields)	<p>An archaeological evaluation was undertaken prior to a proposed residential development of three residential dwellings at Beanburn, Ayton, Berwickshire, Scottish Borders.</p> <p>The archaeological evaluation comprised a trenching sample in excess of 10%, and focussed on a linear cropmark comprising a pit alignment (NMRS: NT96SW 35). However, despite the presence of cropmark evidence the archaeological evaluation identified neither significant archaeological features nor artefacts. The evaluation has raised questions regarding the lifetime of a cropmarks following initial observation where ground is still subjected to ploughing. It further highlights the confusing cropmark anomalies caused by slight variations in subsurface geology.</p> <p>The site was found to be archaeologically sterile, with only modern features such as field drains being identified.</p>
PROPOSED FUTURE WORK:	None
CAPTION(S) FOR ILLUSTRS:	---
SPONSOR OR FUNDING BODY:	Fjordhus Construction Ltd
ADDRESS OF MAIN CONTRIBUTOR:	Edgefield Road Industrial Estate, Loanhead, Midlothian, EH20 9SY
EMAIL ADDRESS:	admin@aocscot.co.uk
ARCHIVE LOCATION (intended/deposited)	Archive to be deposited in NMRS

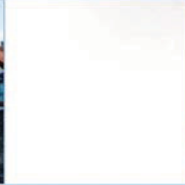

AOC Archaeology Group, Edgefield Industrial Estate, Edgefield Road, Loanhead EH20 9SY
tel: 0131 440 3593 | fax: 0131 440 3422 | e-mail: admin@aocarchaeology.com

www.aocarchaeology.com