

# RENDLESHAM – PUMPING MAIN REPLACEMENT

## RLM 033

### Archaeological Monitoring Report

**Planning Application No:** N/A

**Date of Fieldwork:** 28/09/05 and 30/09/05

**Grid reference:** TM 3385 5392 to 3431 5391

**Funding Body:** Anglian Water

### Introduction

Consultation was sought by Anglian Water in relation to the replacement/diversion of a Pumping Main at Rendlesham, just to the south of Rendlesham Hall Farm. The pipeline runs between NGR TM c. 3385 5392 and c. 3431 5391 along the northern edge of an extant development. The land it traverses is on level ground at c. 25m AOD.

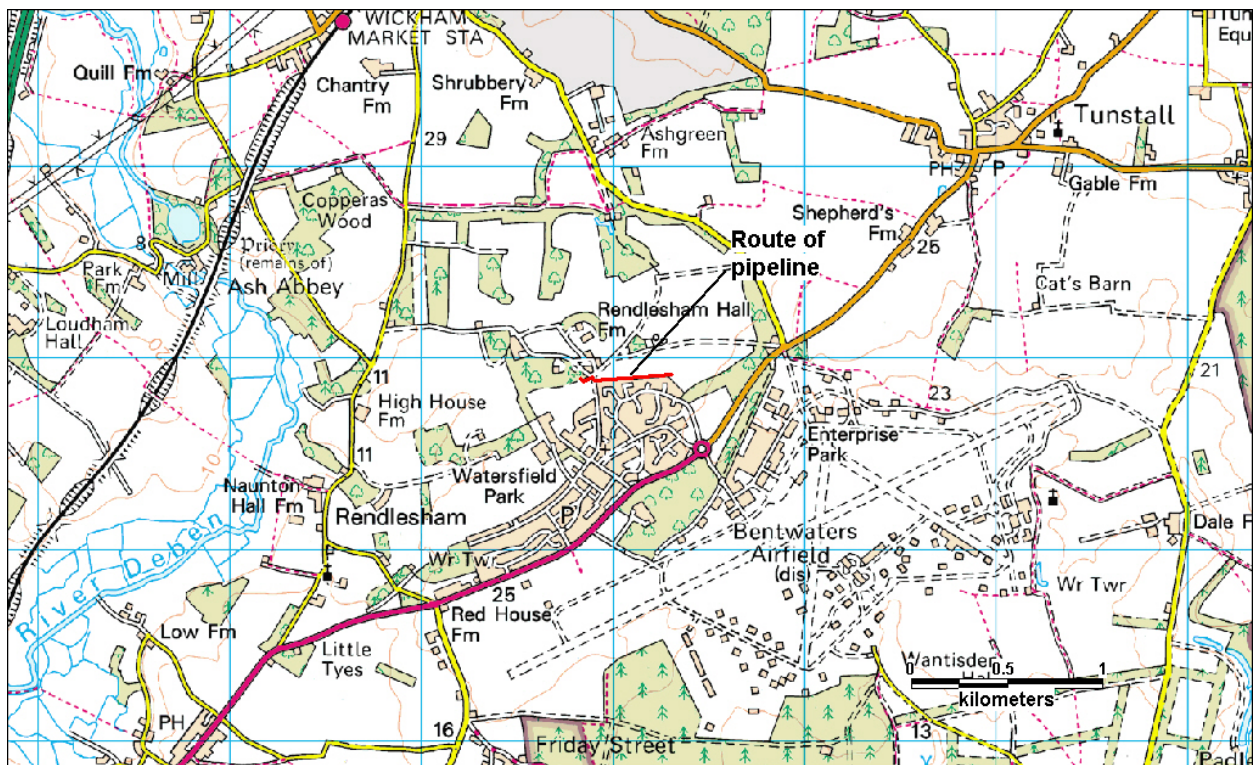

Figure 1. Site location

(© Crown Copyright. All rights reserved. Suffolk County Council Licence No. 100023395 2005)

The proposed route passes close to the site of Rendlesham Hall farm, thought to have been an early focus of occupation associated with Rendlesham Hall itself (the site of the former hall lies c. 150m beyond the western end of the pipeline). The proposal was examined by Robert Carr of the Suffolk County Council Archaeology Service (SCCAS hereafter) Conservation Team who highlighted the site's potential for the preservation of deposits of prehistoric and early medieval date. It was therefore suggested that a programme of archaeological monitoring of the topsoil strip should be carried out. Given Anglian Water's Code of Practice on Conservation, Access and Recreation the recommendation for monitoring was accepted and the SCCAS Field Team were subsequently commissioned to carry out the work.

## Methodology

Two visits were made on the 28<sup>th</sup> and 30<sup>th</sup> of September 2005 in order to observe the stripped surface along the entire length of the pipeline.

The stripping was carried out using a 360<sup>0</sup> tracked mechanical excavator (hymac) fitted with a flat bladed ditching bucket. The stripping had been carried out quite precisely to the top of the natural subsoil, resulting in ideal conditions for monitoring. The stripped area was c. 6.5m wide and some 500m long, resulting in a monitored area of c. 3250m<sup>2</sup>.

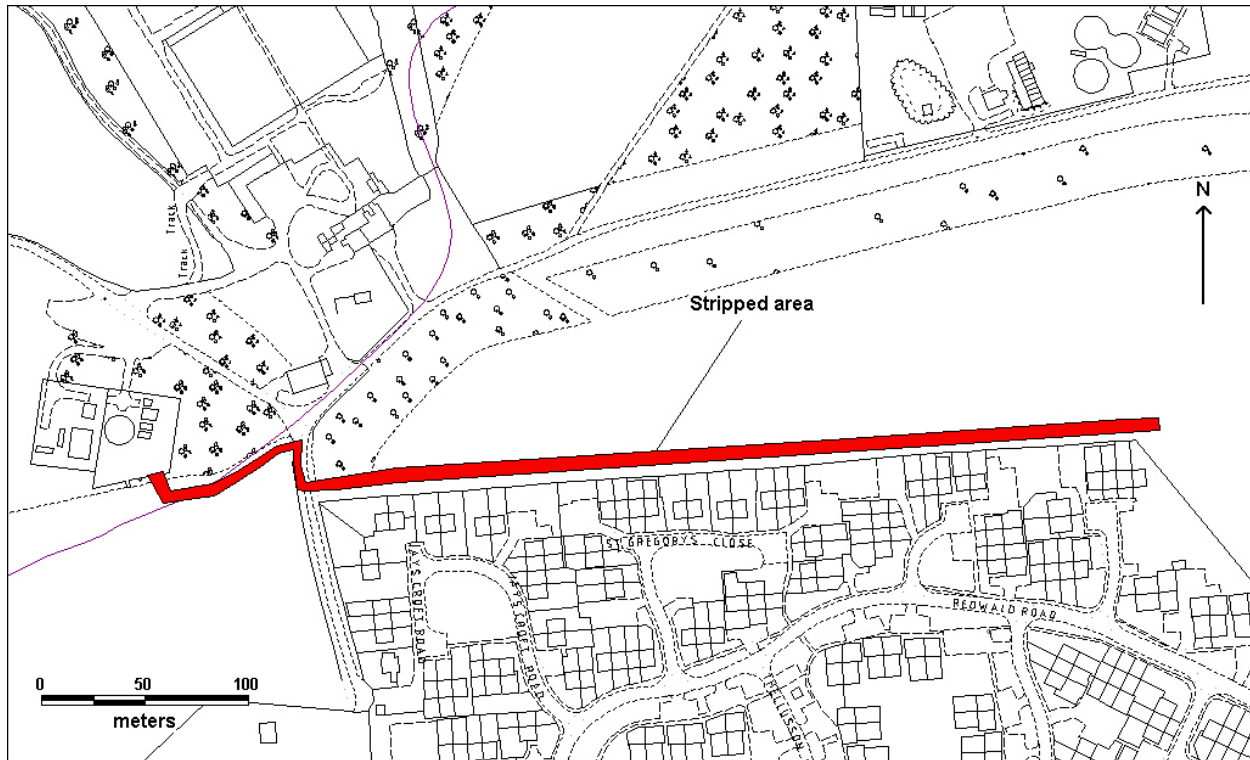

Figure 2. Detail of pipeline route

(© Crown Copyright. All rights reserved. Suffolk County Council Licence No. 100023395 2005)

The site was allocated the SMR number RLM 033 and observed archaeological features and deposits were allocated OP (observable phenomena) numbers and recorded on *pro forma* context sheets.

## Results

Only two deposits were recorded. Topsoil 0002 was a soft light brownish grey sandy clayey silt with rare small to medium sub-rounded to sub-angular flint pebbles. This overlay natural drift deposits (0003) – stiff mid yellowish brown slightly silty clay with moderate small to medium sub-rounded to sub-angular flint pebbles/cobbles.

No archaeological finds or features were observed.

## Conclusions

Despite its proximity to the former site of Rendlesham Hall no archaeological deposits were encountered.