

## **ARCHAEOLOGICAL FIELDWALKING SURVEY REPORT**

---

**SCCAS REPORT No. 2010/198**

# **Traveller's Hill, King's Forest, Wordwell WRW 050**

**J. A. Craven**  
© October 2010  
[www.suffolkcc.gov.uk/e-and-t/archaeology](http://www.suffolkcc.gov.uk/e-and-t/archaeology)



## HER Information

---

**Planning Application No:** N/A  
**Date of Fieldwork:** 22-23 March 2010  
**Grid Reference:** TL 842745  
**Funding Body:** Forest Enterprise  
**Curatorial Officer:** N/A  
**Project Officer:** J. A. Craven  
**Oasis Reference:** Suffolkc1-84918

Digital report submitted to Archaeological Data Service:  
<http://ads.ahds.ac.uk/catalogue/library/greylit>



# Contents

---

<b>Summary</b>	<b>Page</b>
1. Introduction	1
2. Geology and topography	1
3. Archaeological and historical background	1
4. Methodology	4
5. The Finds	6
5.1. Introduction	6
5.2. Pottery	6
5.3. Ceramic Building Material (CBM)	6
5.4. Stone	7
5.5. Glass	7
5.6. Worked flint	7
5.7. Burnt flint	13
5.8. Iron	13
5.9. Discussion of the finds evidence	14
6. Conclusion	16
7. Archive deposition	18
8. Contributors and acknowledgements	18
9. Bibliography	19

## List of Figures

1. Site location	2
2. Fieldwalk transect plan	3
3. Gridsquare numbering	5
4. Flint and burnt flint distribution	15

## **List of Tables**

1. Finds quantities	6
2. CBM descriptions by context	6
3. Flint summary	7
4. Summary of unmodified flake types and condition	8

## **List of Appendices**

1. Bulk finds quantities
2. Flint

## Summary

---

A fieldwalking survey of 13.9ha centered upon the Travellers Hill tumulus, King's Forest, Wordwell and two adjacent barrows was carried out after the felling of a forestry plantation and clearance of tree stumps. The survey collected a widespread scatter of prehistoric material, predominantly struck flint of late Neolithic/Early Bronze Age date, indicating flint working on the site broadly contemporary with the assumed date of the barrows.

Despite limitations to the survey, which meant that the immediate locations of the three barrows could not be examined, a distinct cluster of struck and burnt flint was identified in the possible location of a fourth barrow, which has been recorded from study of historic mapping.

Limited material of post-medieval date, likely deriving from the sites later use as arable farmland, was also collected.





## 1. Introduction

---

Following the felling of pine plantations and subsequent destumping on Forestry Commission land at King's Forest, Wordwell, Suffolk, there was a rare opportunity for a systematic program of fieldwalking of c.13.9ha around a prehistoric Scheduled Monument, the 'Travellers Hill' tumulus, Kings Forest, Wordwell (Fig. 1). The project was funded by Forest Enterprise and carried out by the Suffolk County Council Archaeological Service Field Team (SCCAS/FT).

The aim of the survey was to systematically locate, collect and record all archaeological material visible on the ground surface. Subsequent analysis of the data would then provide information on the intensity, location and nature of past activity on the site and would help inform any future decisions on the usage or protection of the site.

## 2. Geology and topography

---

The site lies on the eastern side of King's Forest, at a height between 45m - 50m AOD on a slight south-west facing slope. The site geology is of sandy soils over chalky drift (Ordnance Survey 1983).

## 3. Archaeological and historical background

---

The site, Coupe 135650, is of significant archaeological interest as it contains an important prehistoric funerary site (Fig. 2). The principal feature is a bowl barrow, known as 'Travellers Hill', which is a Scheduled Monument (No. 31085) and is recorded on the County Historic Environment Record as WRW 001. An adjacent smaller barrow is recorded as WRW 009 and a third barrow, WRW 047, together with four pits of probable post-medieval date, was observed in a rapid earthwork survey in 2009 following felling of the coupes but prior to destumping (Craven 2009). The site of a fourth, no longer extant barrow, WRW 008, has been recorded on the HER due to its depiction on the 1st Edition 1" Ordnance Survey of 1836. Recommendations were made in the 2009 report to leave tree stumps *in situ* across an area encompassing the four barrows.

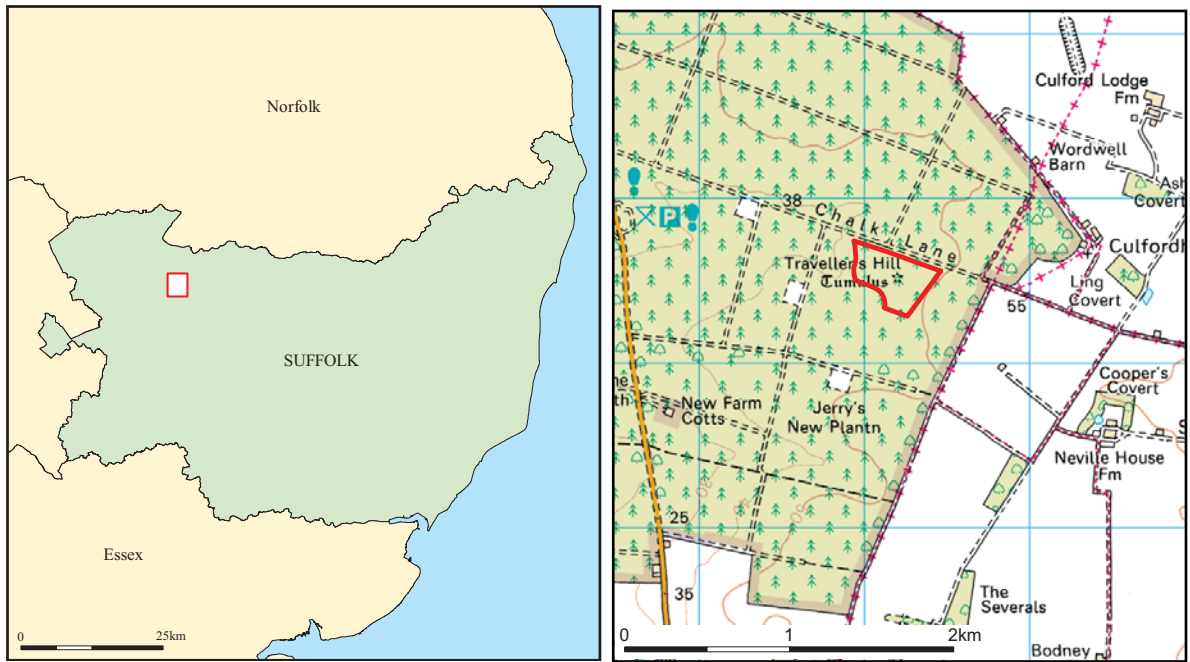

Figure 1. Site location plan

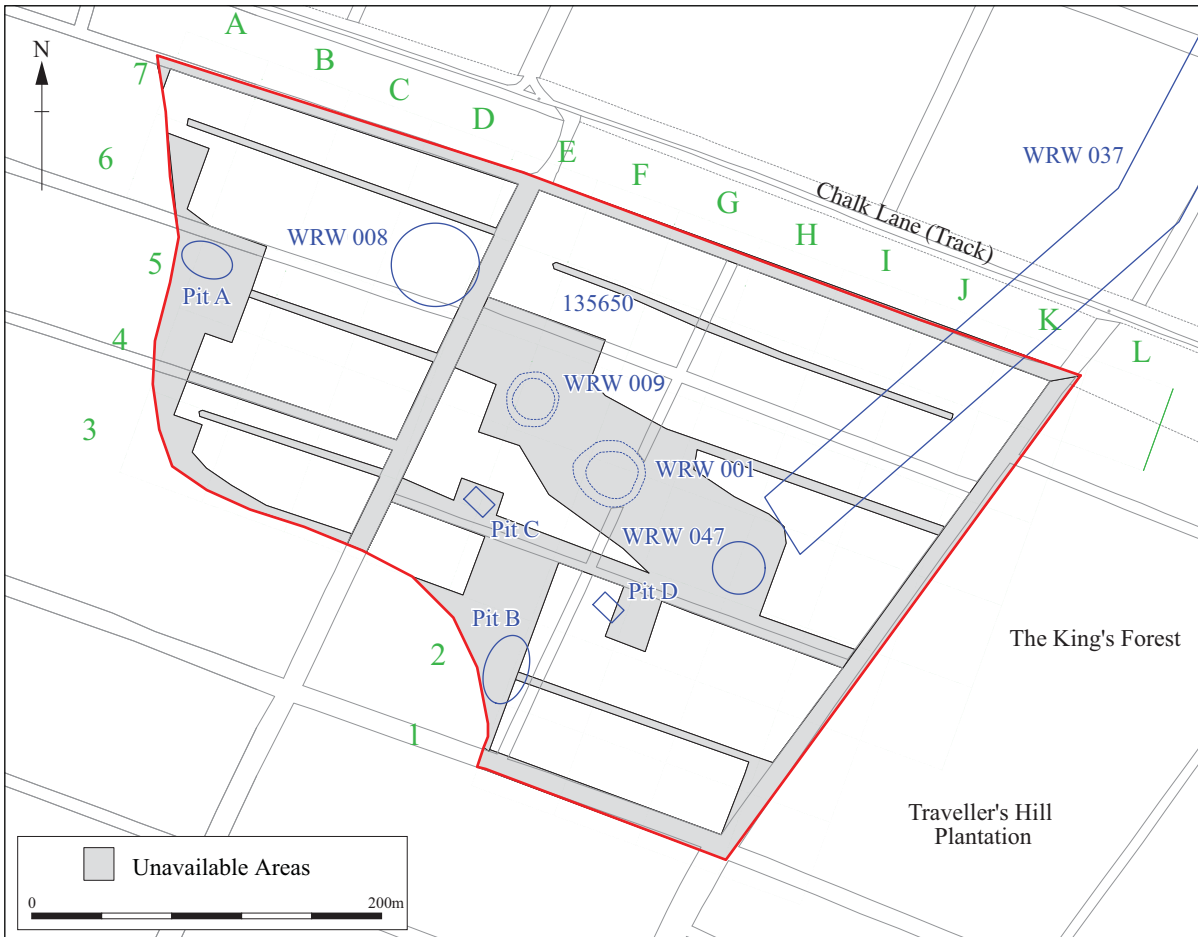

Figure 2. Fieldwalk transect plan

Following the destumping program, which left an open landscape similar to a ploughed field, there was a rare opportunity for further non-intrusive investigation before the replanting of trees or natural development of undergrowth, following which the area would be undercover for another c.40 years . At the request of English Heritage and the Suffolk County Council HER Officer Colin Pendleton, Forest Enterprise commissioned SCCAS/FT to carry out a fieldwalking survey of the exposed ground surface.

## 4. Methodology

---

A 50m by 50m square grid was plotted across the site using an RTK GPS (Fig. 2). The grid was aligned north-east to south-west, parallel to the dominant layout of the existing plantation tracks and rows of piled treestumps, to simplify the fieldwalking.

Each gridsquare was then surveyed by walking transects at 5m intervals apart. Each transect was split in two at the halfway point giving up to 20 contexts per gridsquare to which any archaeological material seen was allocated. These contexts were given a 4 digit number, consisting of the gridsquare reference and a value between 01-20, the pattern of which remained consistent throughout each square, as shown in Figure 3 below.

The ground conditions were of a bare topsoil, frequently churned and disturbed by the destumping processes, giving a similar appearance to a ploughed field. Although no vegetation was present there was frequent scattered debris of wood and bark which may have had a minor-moderate detrimental effect on the survey, possibly masking the presence of smaller fragments of material such as pottery. Many areas across the site were unavailable for survey, such as a band across the centre, where tree stumps and vegetation had been left *in situ* to protect the various barrows, a series of c.5m wide rows across the site where the uprooted tree stumps had been piled, and across some of the former trackways.

Site data has been input onto an MS Access database and recorded using the County HER code WRW 055. Bulk finds were washed, marked and quantified, and then allocated to a new series of context numbers, 0001 – 0302 (see Appendix 1).

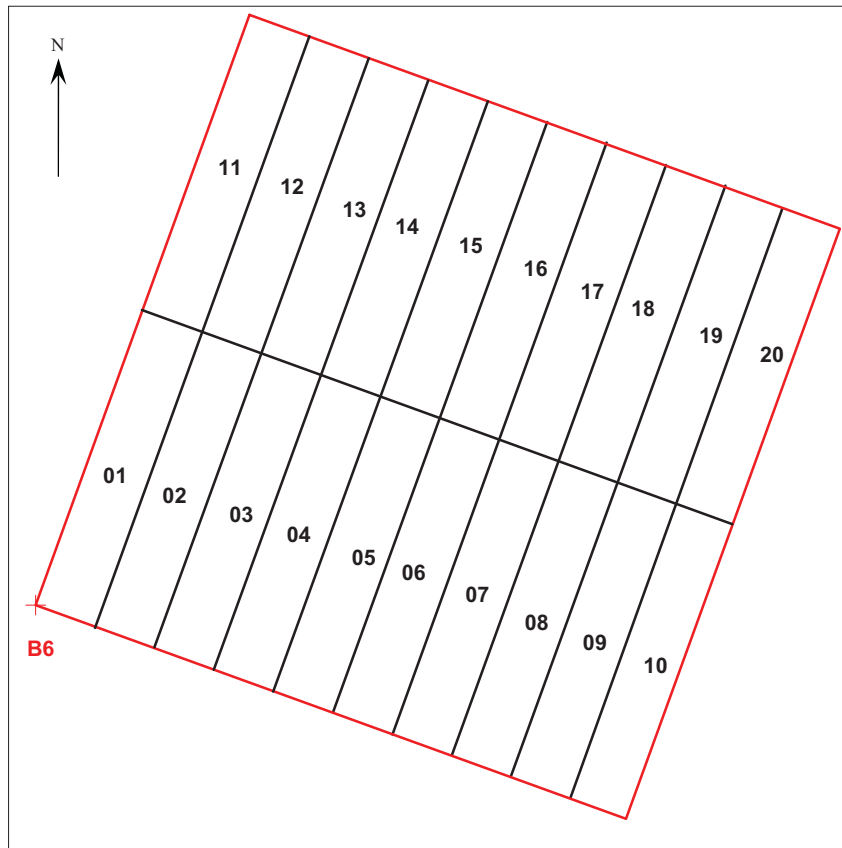

Figure 3. Gridsquare numbering

An OASIS form has been completed for the project (reference no. suffolkc1-84918) and a digital copy of the report submitted for inclusion on the Archaeology Data Service database (<http://ads.ahds.ac.uk/catalogue/library/greylit>).

The site archive is kept in the main store of Suffolk County Council Archaeological Service at Bury St Edmunds under HER No. WRW 050.

## 5. The Finds

Cathy Tester

### 5.1 Introduction

Table 1 shows the quantities of finds collected during the fieldwalking survey. A full quantification by context is included as Appendix 1.

Find type	No.	Wt/g
Pottery	4	16
CBM	7	391
Stone	5	74
Glass	1	4
Worked flint	466	6346
Burnt flint	46	979
Iron	2	116

Table 1. Finds quantities.

### 5.2 Pottery

Four sherds of pottery (16g) were collected from four contexts. The first is a small abraded bodysherd of hand-made flint tempered pottery from context 0002 which is prehistoric but not closely datable. Three sherds of wheel-made pottery were collected from contexts 0136, 0246 and 0257. All are small non-diagnostic bodysherds of probable post-medieval date whose fabrics cannot be closely identified or dated.

### 5.3 Ceramic Building Material (CBM)

A total of seven fragments of CBM weighing 391g was collected from six contexts. The CBM was quantified by context, fabric and form type using fragment count and weight in grams. Thicknesses were recorded and general fabric codes were assigned from the Suffolk CBM fabric types which is based on the coarseness of the matrix and by the main inclusions. The list by context is shown below.

Ctxt	Fabric	Type	No	Wt/g	Thick	Notes	Date
0062	mscp	RT	1	59	15mm	Medium sandy poorly mixed w clay streaks	PMed
0162	ms	RT	1	3	c 65mm	Medium sandy few other inclusions	PMed
0165	fsfe	B	1	231		Light orange and buff fine sandy w ferrous inclusions. battered.	Early PMed
0179	msfe	RT	1	45	14mm	Medium sandy w ferrous inclusions	PMed
0206	msfe	RT	1	21	15mm	Medium sandy w ferrous inclusions, w cream-white mortar adhering	PMed
0210	mscp	RT	1	22	13mm	Medium sandy w red clay pellets	PMed
	msfe	RT	1	10	-	Medium sandy w ferrous inclusions	PMed

Table 2. CBM descriptions by context

Six small fragments of post-medieval roof tile (RT) in red-orange medium sandy fabrics and one early post-medieval brick (B) were identified. None of the material is particularly diagnostic and its presence in the topsoil is probably due to low level activity.

## 5.4 Stone

Five small fragments of ironstone weighing 74g collected from five contexts are probably natural.

## 5.5 Glass

A fragment of post-medieval window glass was collected from context 0240.

## 5.6 Worked flint

by Sarah Bates

### *Introduction*

A total of 466 pieces of struck or shattered flint were recovered during the fieldwalking survey. The struck flint ranges in colour from light to dark grey with patchy mottling being fairly common. Cortex where present is most often fairly thick and creamish or off-white in colour. The use of already patinated flint for knapping is demonstrated by the presence of patinated cortex or former surfaces on many pieces. Large numbers of pieces exhibit post-depositional patination – some have a lightly patinated 'misted' appearance and some are more heavily patinated to an opaque, very pale, greyish white. The assemblage is summarised in Table 3 and listed by context in Appendix 2.

<u>Type</u>	<u>No.</u>
Multi platform blade core	1
Single platform flake core	1
Core fragment	1
Tested piece	2
Core trimming flake	3
Struck fragment	5
Shatter	8
Flake	333
Blade-like flake	21
Blade	4
Spall	14
Chip	9
Scraper	5
Side scraper	5
Thumbnail scraper	2
End scraper	1
Piercer	3
Spurred piece	2
Awl	1
Knife	2
Denticulate	2
?Arrowhead	1
Flaked piece	1
Notched flake	8
Notched blade	1
Retouched blade	1
Retouched flake	19
Utilised flake	10
<b>Total</b>	<b>466</b>

Table 3. Flint summary



## **Methodology**

Each piece of flint was examined and recorded by context in an Access database table. The material was classified by *category* and *type* and was quantified by count. Numbers of complete, corticated, patinated and hinge fractured pieces were recorded, as well as platform type and the condition of the flint. Additional descriptive comments were made as necessary.

## **The assemblage**

Two cores are present. One is an irregular but quite chunky piece of smooth grey slightly patinated flint from context 0077. Flakes and some blade-like pieces have been struck from various platforms. The other is a single platform core from 0011 with jagged overhangs to the platform edge. It has very small squat flake scars. There is also a possible blade core fragment from 0105 and two tested pieces, one on a cortical knob-like fragment (0296) and the other on a fragment from an abraded pebble from 0129.

Another fragment from the edge of a core platform is present in 0260 and two flakes from 0014 and 0034 have part of a former platform edge on one side showing that they have been struck from a multi platform core where a new platform was selected from the existing surfaces by rotating the core rather than by deliberate preparation (Butler 2005, 157).

Five irregular struck fragments and eight shatter pieces were found. It is possible that some of the shattered flint might have been formed accidentally, but all had at least one surface that could have fractured during the initial breaking of flint nodules for knapping.

A total of 333 unmodified flakes are present. The recorded numbers of flake types and conditions and the proportion (%) of the total unmodified flakes which they represent are summarised in Table 4.

Type or condition of flake	No	%
Complete	266	80
Cortical	253	76
Primary flake	11	5
Cortical platform	43	13
Prepared platform	10	3
Hinge fracture	10	3
Patinated	103	31

Table 4. Summary of unmodified flake types and condition



The flakes vary, with many irregular but some neater pieces. They are predominantly squat, often with wide and thick hard hammer struck platforms. Some of these are quite notably regular in nature and it appears that some care went into the use of the cores as many were worked in a controlled manner rather than just being haphazardly struck. The majority of the flakes are complete cortical pieces and their unbroken nature may reflect their thickness and/or suggest that they might not have suffered greatly from post-depositional disturbance. This is also suggested by the fact that most of the flakes are sharp or quite sharp although some pieces are edge damaged. Quite a few flakes have cortical and/or patinated platforms showing that platforms were generally unprepared. A small number of flakes have some evidence of platform modification and although a few have abraded platforms, several others have more irregular batter or slight faceting which may represent repeated striking of a platform or scars from a previous platform rather than deliberate careful preparation of cores.

A large number of flakes are patinated. Patination varies from very slight to a heavier white colour (see above). It may reflect soil conditions at the site or be due to the fact that the flint is from topsoil contexts and has been exposed to weathering.

Twenty-one blade-like flakes were found. Most of them are cortical and although some of the flakes are slightly edge-damaged, most are sharp or quite sharp. Two pieces have slightly abraded platforms. Only four blades are present. Three are small and one is an irregular thickish piece. Fourteen spalls and nine small chips (some tiny) are also present.

Thirteen scrapers were found. They include an end scraper on a small thin ovate flake from 0243 and five side scrapers, three of them on squat or irregular flakes (0025, 0141 and 0189) and one on a larger broad blade-like flake (0287) which may be a reused flake as the retouch post-dates its patina. Another irregular flake (0227) has steep retouch forming a scraper-like edge on its almost straight left side which is heavily damaged on its ventral face, probably through use. There are also two slightly irregular thumbnail type scrapers, one on a squat sub-circular flake which is slightly larger than the 'classic' thumbnail type with neat retouch around its distal part (0247) and one on an irregular small squat flake with neat retouch around all but its wide proximal side (0050). The others scrapers are miscellaneous types. One is roughly ovate with retouch around its distal end and extending about halfway down each side (0095) and the rest are small

squat or irregular flakes with retouch of distal and parts of other edges (0140, 0160, 0203 and 0089).

Three probable piercers include a blade with slight retouch or use damage to its cortical distal end (0088), a small cortical flake with wear of its distal point (0221) and an irregular flake with a retouched or utilised distal point (0223). There is also a spurred piece (0232), the left distal edge of which has been retouched to a short scraper-like edge and forms an obtuse point with the unretouched thermal surface at the right distal edge. A possible awl from 0163 has very slight retouch from opposite edges at its point.

Two pieces have been classified as knives. A broad hard hammer struck flake (0217) with thick cortex along its distal edge has neat semi-abrupt retouch of its straight right edge. A slightly irregular 'D'-shaped flake (0031) has slight abrupt retouch of most of its convex right side and reverse retouch which is slightly shallower and more extensive along its left edge.

Two flakes (0147 and 0025), one of them incomplete, are retouched to irregular denticulates.

Eight flakes and a blade have notches in their sides. The blade (0234), which is a slightly irregular hard hammer struck piece, has two notches, one in either side towards its distal end (although the end is missing). The position of these notches suggests that they were probably deliberately formed. The 'notches' on some of the flakes, however, might be accidental; formed by plough damage although several, especially a few with wider, more shallow notches (0150, 0164, 0239 and 0250), do appear 'genuine'.

A small thin flake (0184) has bifacial flaking and retouch of its edges. It is squat with its rounded proximal end thinned by retouch of its dorsal face. It has convex sides and right distal edge with a slight scooped concave area at the left distal edge. It is possible that this piece could be an irregular and possibly unfinished arrowhead.

A small thick ovate cortical piece with plano-convex profile (0293) has steep retouch around most sides of its cortical face and slight flaking from the edges on the other face. It could have been used as a crude scraper-like tool.

Nineteen other flakes and a blade appear to be miscellaneously retouched and ten flakes have been utilised.

One fragment from a fairly large regular flake (0017) may represent the reuse of earlier material. The nature of the flake suggests that it could be of earlier Neolithic date and the retouch, of its left side, post-dates a yellowish staining or patina. Possible retouch of its broken distal edge forms two slight spurs. The other retouched flakes are mostly irregular but one or two blade-like pieces are present. The flakes have varying degrees of retouch to their edges. Despite the topsoil context of the flint, edge damage is mainly quite limited and only in a few cases does this obscure or confuse the identification of the edge modification. The small medial part of a tapering blade (0142) has retouch to both its sides.

The utilised flakes all have signs of use of their edges and, again, there is little obvious edge damage although one or two pieces have damage that might be confused with evidence for use.

### ***Discussion of the struck flint assemblage***

The character of the flint assemblage with mostly squat and hard hammer struck flakes suggests a later Neolithic or later date for most of the assemblage. Only a small number of pieces may be earlier. These include some flakes with abraded platforms and a retouched piece that appears to be a re-used earlier flake. The fieldwalking context of the flint inevitably means that material from many periods may be present and only a small part of the entire assemblage has been recovered. The deposition, accumulation and dispersal of lithic scatters has occurred over many centuries of landscape use (Spikins 1995, 95) and it has been suggested that perhaps as little as 1-5% of a ploughsoil assemblage will appear on the surface at one time (English Heritage 2000).

There is a general absence of diagnostically earlier material such as core preparation pieces or of any Mesolithic or earlier Neolithic tools and there is little evidence for the careful preparation of cores which is characteristic of those periods. The majority of the flint has cortex and, in many cases, cortex occurs over much of the dorsal surface.

There are also a fair number of pieces with cortical or patinated platforms showing that flakes were being struck from unprepared cores. There is however, evidence that the cores were being used in a controlled way and not simply struck from one platform and

discarded. They appear to have been rotated and other suitable platforms selected for use. The working of cores in this way would result in the occasional occurrence of faceted butts and battered former platforms' edges on dorsal ridges. Both of these features were noted in the assemblage and have been seen as characteristic of later Neolithic or Early Bronze Age assemblages (Healy 1988, 46, Butler 2005, 157). Similarly, the low incidence of blades, with those that are present being hard hammer struck or irregular, also points to a later Neolithic or Early Bronze Age date.

Most of the retouched tools are not very diagnostic or closely datable. As is generally true for most prehistoric periods, scrapers are the most common tool type (Butler 2005 49, 116, 182) and they are usually interpreted as representing occupation (English Heritage 2000). Two small scrapers have been classified as thumbnail types although both are somewhat irregular examples and these are generally considered to be of Early Bronze Age date. Other scrapers and retouched tools are more irregular and as such, are likely to be of later Neolithic or later date. The cortical nature of much of both the debitage and of retouched and utilised pieces also supports a later Neolithic or later date for the material as the proportion of cortical pieces has been seen to increase during this period (Butler 2005 195). 76% of flakes and 59% of retouched or utilised pieces have cortex.

The presence of cores, core fragments and unmodified debitage shows that flint was being worked at the site and the fact that much of the material is fairly sharp suggests that it has not suffered a great deal of post-depositional disturbance. The recovery of retouched and utilised pieces indicates that flint was not just being knapped but was also being used at the site.

A summary consideration of the distribution of the flint (by 50m grid square, Fig. 3) shows a definite concentration of material in and around the area of WRW 008 and to a lesser extent, around WRW 047. However, around WRW 047 and in the area of the other recorded barrows, numbers of collected finds will have been affected by the ground surface conditions which made those areas unavailable for survey. Taking into account the fact that the barrow would have been a significant feature in the landscape for some time, it seems very likely that the flint in the vicinity of WRW 008 represents activity associated with that site or at least derives from later activity focussed on the site.

The other main concentration of flint occurs along the north-eastern edge of the site and is harder to explain; it seems to be consistently concentrated in Grid Row 7 which is at the *top* of a slight slope. It is possible that this concentration represents other subsoil features to the north of the barrows. Alternatively, some kind of land management/cultivation practise may have caused the concentration of material along the edge of a plantation (see below) or there may have been a possible collection bias resulting from ground or weather conditions or, perhaps, individual fieldwalkers.

The potential contribution of surface survey in the interpretation of known but unexcavated sites and some of the possible problems involved are considered by Haselgrove (1985). He discusses the origin and derivation of ploughsoil assemblages, citing studies which suggest that where slope is not a significant factor, the displacement of artefacts from their original position is often minimal. In other cases however, finds have been seen to have been dispersed or sometimes concentrated, for example, along field headlands by repeated ploughing and other agricultural processes (Oxford Archaeology 2002, 20-21). Pendleton also highlights the apparent dispersal by ploughing of lithic scatters at sites in Suffolk (Pendleton 1999, 64). Such movement and redeposition of material will have been affected by the type and frequency of cultivation at the site.

In the surveyed areas in the southern part of the site, numbers of recovered flints are generally low and do not appear to form any significant pattern.

## **5.7 Burnt flint**

Forty-six fragments of burnt flint weighing 979g were collected from 27 contexts. The material is blue grey to white and fire crackled and most probably represents pot-boiler debris which is often an indication of prehistoric activity. The distribution of the burnt flint (Fig. 4) shows a broad correlation with that of the worked flint (Fig. 3).

## **5.8 Iron**

A broken and irregular flat fragment of iron 70mm long, 22mm wide and 17mm thick, was recovered from context 0009. A smaller fragment (8g) was collected from 0096. Neither are identifiable or dateable.

## **5.9 Discussion of the finds evidence**

The fieldwalking survey produced relatively abundant evidence of prehistoric activity in the area surveyed.

Most notable is the struck flint assemblage which demonstrates that flint was being worked and used on the site with particular concentrations noted in the area of WRW 008 and WRW 047. The condition of the material suggests that it had not suffered serious post-depositional disturbance and it has characteristics that suggest a later Neolithic or early Bronze Age date for most of the assemblage.

A single sherd of prehistoric pottery and a small amount of burnt flint pot-boiler debris are also evidence of prehistoric activity on the site.

Later finds are negligible, only a few post-medieval artefacts were recovered. Post medieval brick and roof tile fragments, a few sherds of non diagnostic pottery, window glass, and iron probably owe their presence in the topsoil to low level activity (such as manuring).

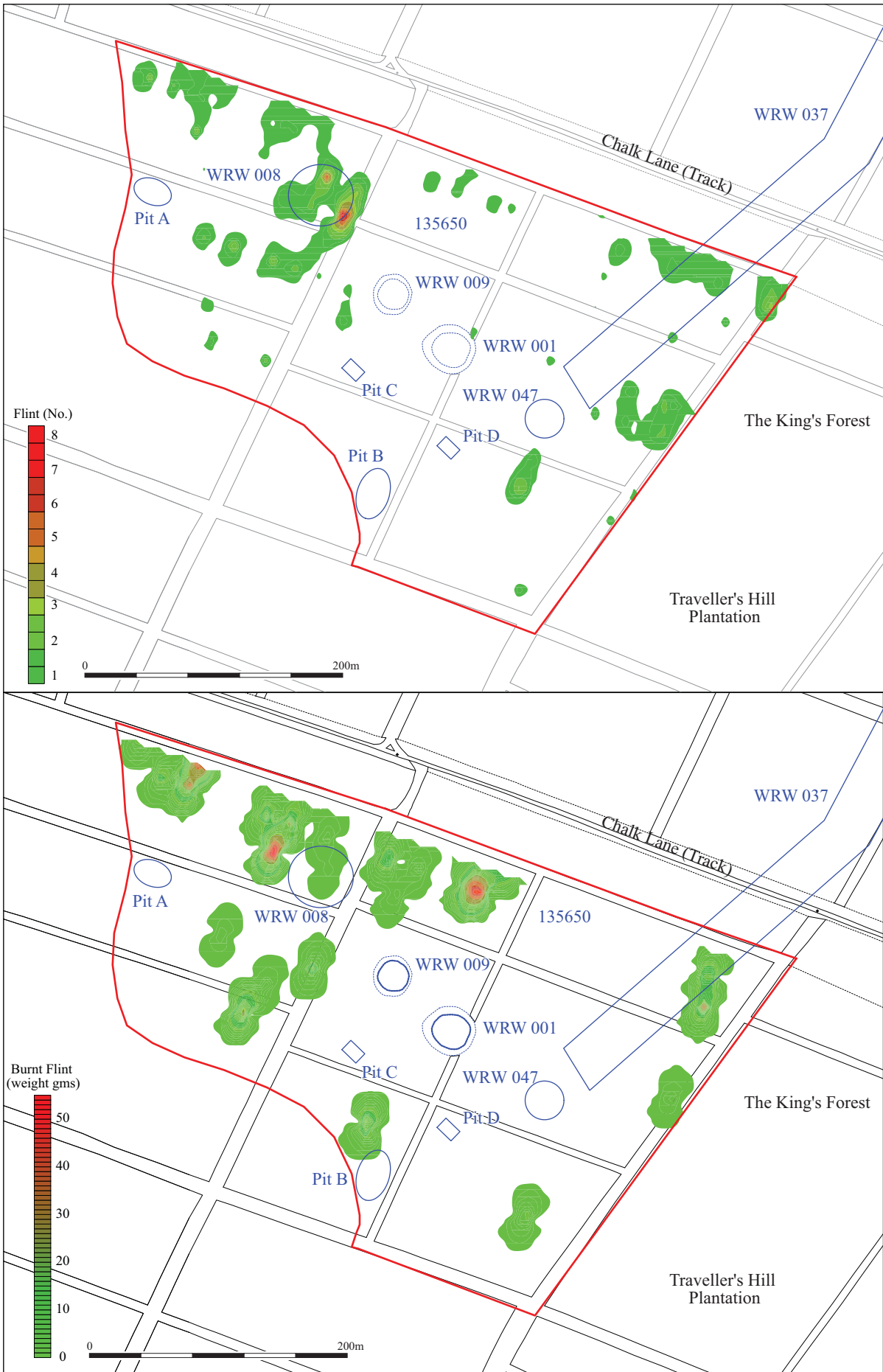

Figure 4. Flint and burnt flint distribution



## 6. Conclusion

---

The fieldwalking has identified a widespread scatter of prehistoric material, predominantly struck flint of late Neolithic/Early Bronze Age date, indicating flint working on the site broadly contemporary with the assumed date of the barrows. This material was generally widely dispersed with over a third of the flint assemblage being recovered as individual pieces in each 5mx25m context.

While the fieldwalking was centred upon the area of the three extant barrows, the conservation program for the monuments had left the tree stumps and other ground covering vegetation, *in situ* on the barrows themselves. This meant that a swathe of land across the site encompassing the actual barrows could not be properly fieldwalked although any soil exposed or brought to the surface by animal disturbance was looked at.

This has meant that it was not possible to determine whether these monuments were focuses of any prehistoric material. However the one relatively dense cluster of struck flint, together with one of the clusters of burnt flint, is of particular interest as it appears to correspond with the location of the possible barrow, WRW 008, which is shown on the 1st Edition 1" Ordnance Survey of 1836.

The 1836 map shows three barrows which, combined with grid references recorded by the Ordnance Survey in the mid 20th century and held by the Suffolk HER, has been interpreted as showing WRW 001, 009 and the now lost WRW 008. It is possible however that this map simply shows the three currently visible barrows and that the location of WRW 008 is erroneous.

The cluster in the finds assemblage however suggests that there is indeed a 4th barrow, rather than an error in the historic mapping or its interpretation, and that the material is either contemporary with its construction or indicates activity centred upon the monuments in their later history.

The general positive bias of material towards the north may be partially explained by the order in which the fieldwalking proceeded. Over the two day project the rows were walked in reverse sequence (from 7 to 1) so it is possible, particularly in Rows 1 and 2



when time was running out at the end of the project, that there may have been a negative bias to the identification and collection of material. This could explain the slightly odd distribution pattern where more material was collected along the top of the slight natural slope than towards its base where a greater density would normally be expected because of natural post-depositional processes such as soil creep (although this is a process significantly affected by agriculture which, in poor soils such as this, has probably been of limited duration).

The quality of the flint, which suggests limited post-depositional disturbance, may be explained by the sites recent land-use as a forestry plantation which has meant that the site has not been subjected to regular mechanised ploughing in the late 20th/early 21st century. Although shown on the 1st Edition Ordnance Survey of 1882 as open farmland, agricultural activity on the site may have been relatively slight during the post-medieval and earlier periods. Many areas nearby in the late 19th century were still uncultivated heathland and this is likely to have been the sites predominant historic landuse since the prehistoric period.

Post-prehistoric finds were limited, with a small quantity of CBM and other material dating to the post-medieval period and the sites use as arable farmland.

The fieldwalking project, combined with the previous earthwork survey (Craven 2009), has established that the Scheduled Monument, Travellers Hill Tumulus, is part of a significant group of three, possibly four, barrows, which require protection from any forestry activities. As recommended in the earthwork survey report Forest Enterprise has already left an area encompassing the barrows out of the destumping and logging program and future tree planting should also be avoided in this area to avoid further disturbance and allow the barrows to be visible as a group. Also, as previously recommended, the Scheduled area should be extended to encompass the four barrows, thereby ensuring their long term protection.

## **7. Archive deposition**

---

Paper and photographic archive: SCCAS Bury St Edmunds

Digital archive: SCCAS Bury St Edmunds T:arc\archive field proj\wordwell\WRW 050

Finds and environmental archive: SCCAS Bury St Edmunds.

## **8. List of contributors and acknowledgements**

---

The fieldwalking survey was carried out by a number of archaeological staff (Bill Brooks, Andrew Beverton, John Craven, Steve Manthorpe and Simon Picard) from Suffolk County Council Archaeological Service, Field Team and Rachel Riley plus colleagues from Forest Enterprise.

The project was directed by and managed by John Craven. The post-excavation was managed by Richenda Goffin. Finds processing was carried out by Mike Feider and Jonathan Van Jennians, and the specialist finds report was written by Cathy Tester and Sarah Bates (freelance). The production of site digital plans and illustrations was carried out by Crane Begg. The report was checked by Richenda Goffin.

## 9. Bibliography

---

- Butler, C., 2005, Prehistoric Flintwork (Tempus).
- Craven, J. A., 2009, *Rapid Earthwork Identification Survey of Forestry Commission land, Norfolk & Suffolk*. SCCAS Report No. 2009/115.
- English Heritage, 2000 Managing Lithic Scatters, Archaeological guidance for planning authorities and developers 2000 01.
- Haselgrove, C., 1985, 'Inference from Ploughsoil Artefact Samples' in eds Haselgrove, C., Millett, M. and Smith, I., *Archaeology from the Ploughsoil*, Department of Archaeology and Prehistory University of Sheffield
- Healy, F., 1988, *The Anglo-Saxon Cemetery at Spong Hill, North Elmham, Part VI: Occupation during the Seventh to Second Millennia*, E. Anglian Archaeol. 39.
- Ordnance Survey, 1983, 'Soils of England and Wales': *Soil survey of England and Wales, sheet 4 Eastern England 1:250,000*. Harpenden.
- Oxford Archaeology, 2002, *The Management of Archaeological Sites in Arable Landscapes BD1701*, Final Project Report Supporting Documentation, Appendix F: Case Studies of Archaeological Damage from Arable Activities (unpublished).
- Pendleton, C., 1999, *Bronze Age metalwork in northern East Anglia, a study of its distribution and interpretation*, BAR British series 279.
- Spikins, P., 1995, 'Virtual landscapes' – GIS and lithic scatters' in Schofield, A.J., 1995, *Lithics in Context Suggestions for the future direction of Lithic Studies*, Lithic Studies Society Occasional Paper No. 5, 95-104.

## Appendix 1. Bulk finds quantities

Context	Location	Flint		Burnt flint		Miscellaneous
		No	Wt/g	No	Wt/g	
0001	A703	3	36			
0002	A705	5	68			Pottery 1-4g
0003	A709	4	37			
0004	A716	1	16	2	29	
0005	A719	3	14			
0006	B104	1	55			
0007	B602	1	3			
0008	B604	1	17			
0009	B608	2	34			Iron 1-109g
0010	B610	1	5			
0011	B615	4	64			
0012	B701	1	19	1	23	
0013	B702	2	32			
0014	B703	1	16			
0015	B704	2	34			
0016	B705	1	20	3	59	
0017	B707	2	48			
0018	B708	1	9			
0019	B710	1	5			
0020	B711	2	47			
0021	B712	2	154			
0022	B713	2	7	1	11	
0023	B714	2	10			
0024	B716			14	143	
0025	B717	6	101			
0027	B720	1	3			
0028	C318	4	62			Stone 1-20g
0029	C404	1	23			
0030	C405	1	6			
0031	C406	2	27			
0032	C410	1	4			
0033	C415	1	6			
0034	C416	1	32			
0035	C420	1	27			
0036	C501	5	43			
0037	C503	2	34			
0038	C506	5	73			
0039	C507	1	8			
0040	C508	1	16	1	7	
0041	C509	1	31			
0042	C510	1	11			
0043	C520	1	5			
0044	C605	1	7			
0045	C606	1	27			
0046	C610	2	38			
0047	C610	2	53			
0048	C615	1	8			
0049	C616	2	39			
0050	C703	1	23			
0051	C704	1	10			
0052	C705	2	28			
0053	C707	3	12			
0054	C708	1	14	1	31	
0055	C709	2	62			
0056	C710	1	13			
0057	C713	1	4			
0058	C715	2	51			
0059	C716	2	31			
0060	C719	2	59			
0061	C720	2	12			
0062	D312					CBM 1-59g
0063	D317	3	44			
0064	D405			1	58	
0065	D411	1	22			

Context	Location	Flint		Burnt flint		Miscellaneous
		No	Wt/g	No	Wt/g	
0066	D412	1	32			
0067	D417			1	8	
0068	D419	1	13			
0069	D502	2	34			
0070	D503	3	36			
0071	D504	1	49			
0072	D505	1	9			
0073	D506	3	45			
0074	D507	2	16			
0075	D508	1	11			
0076	D510	2	48			
0077	D511	1	93			
0078	D513	1	9			
0079	D518	3	26			
0080	D520	2	5			
0081	D601	2	21			
0082	D602	2	17			
0083	D603	2	13			Stone 1-9g
0084	D604	1	8			
0085	D605	3	20			
0086	D606	2	8			
0087	D608	1	7			
0088	D609	1	5			
0089	D610	1	10			Stone 1-5g
0090	D611			4	126	
0091	D612	1	12			
0092	D616	7	58			
0093	D616	1	13			
0094	D617	3	50			
0095	D619	1	44			
0096	D620	2	18	1	3	Iron 1-8g
0097	D702			1	34	
0098	D703	1	15			
0099	D704	3	23			
0100	D708			1	9	
0101	D710					
0102	D711	2	7	1	8	
0103	D712	2	33			
0104	D713	1	6	1	8	
0105	D715	2	70			
0106	D716	1	7			
0107	D719	1	22			
0108	E313	1	39			
0109	E316	1	4			
0110	E401	1	10			
0111	E408	1	4			
0112	E410	1	3			
0113	E415	1	19			
0114	E416	2	15			
0115	E417	2	22			
0116	E502	1	10			
0117	E503	1	14	1	21	
0118	E505	2	15			
0119	E506	1	7			
0121	E601	16	167			
0122	E608	1	10			
0123	E609	1	9			
0124	E611	1	10			
0125	E612	5	42			
0126	E617	1	20			
0127	E707			1	32	
0128	E709					Stone 1-20g
0129	E710	2	29			
0130	E712	1	7			
0131	E713	1	6			
0132	E717	1	6			
0133	F309			1	47	
0135	F413	1	30			

Context	Location	Flint		Burnt flint		Miscellaneous
		No	Wt/g	No	Wt/g	
0136	F414					Pottery 1-5g
0137	F608	1	9			
0138	F611	1	66	1	9	
0139	F614	1	4			
0140	F702	2	21			
0141	F703	1	18	1	10	
0142	F705	1	4			
0143	F705	2	24			
0144	F706	2	14			
0145	F707	1	18			
0146	F714	2	22			
0147	F716	1	6			
0148	F717	1	18			
0149	F718	2	43			
0150	F719	2	11			
0151	G115	1	21			
0152	G208	1	11			
0153	G304	1	8			
0154	G305	1	4			
0155	G310	1	6			
0156	G313	1	4			
0157	G317	1	19			
0158	G320	1	4			
0159	G404	1	20			
0160	G406	1	10			
0161	G506	3	28			
0162	G515					CBM 1-3g
0163	G517	1	9			
0164	G618	2	22			
0165	G701	1	5	1	44	
0166	G702	3	17			CBM 1-231g
0167	G703			1	116	Stone 1-23g
0168	G704	1	3			
0169	G705	2	20			
0170	G707	1	11			
0171	G709	1	6			
0172	G710	1	35			
0173	G716	1	18	1	47	
0174	G718	1	16			
0175	G720	2	8			
0176	H111	1	11			
0177	H116	1	13			
0178	H218	1	16			
0179	H303					CBM 1-45g
0180	H309	1	15			
0181	H310	3	32			
0182	H312	1	30			
0183	H320	1	20			
0184	H404	2	9			
0185	H503	1	24			
0186	H505	1	7			
0187	H508	1	15			
0188	H509	2	6			
0189	H602	2	22			
0190	H608	1	24			
0191	H609	1	4			
0192	H611	1	3			
0193	H613	1	8			
0194	H615	1	3			
0195	H617	1	13			
0196	H618	1	6			
0197	H619	1	8			
0198	H701	1	14			
0199	H707	1	47			
0200	H716	1	24			
0201	H717	1	35			
0202	H718	1	18			
0203	H719	2	15			

Context	Location	Flint		Burnt flint		Miscellaneous
		No	Wt/g	No	Wt/g	
0204	H720	1	5			
0205	I112	1	11			
0206	I115					CBM 1-21g
0207	I116	2	8			
0208	I117	1	15			
0209	I118	1	20			
0210	I120					CBM 2-32g
0211	I203	1	11			
0212	I207	1	21			
0213	I217	1	19	1	18	
0214	I301	3	16			
0215	I302	2	25			
0216	I305	1	21			
0217	I309	1	15			
0218	I311	2	36			
0219	I312	2	19			
0220	I316	1	9			
0221	I318	2	21			
0222	I410	1	8			
0223	I418	3	38			
0224	I419					
0225	I420	1	8			
0226	I501	1	16			
0227	I502	1	29			
0228	I508	1	17			
0229	I510	1	15			
0230	I602	2	32			
0231	I605	1	7			
0232	I612	2	22			
0233	I616	1	18			
0234	I701	1	10			
0235	I702	1	24			
0236	I703	3	16			
0237	I704	1	6			
0238	I705	1	3			
0239	I707	1	21			
0240	I708	1	3			Glass 1-4g
0241	I709	1	7			
0242	I710	1	24			
0243	I717	3	84			
0244	I720	3	13			
0245	J111	1	3			
0246	J120					Pottery 1-4g
0247	J301	1	14			
0248	J304	1	25			
0249	J306	2	12			
0250	J312	1	10			
0251	J315	1	7			
0252	J318	3	110			
0253	J404	2	31			
0254	J406	1	12			
0255	J412	2	21			
0256	J413	2	29			
0257	J414	1	12			Pottery 1-3g
0258	J414	2	5			
0259	J416	3	61			
0260	J418	3	7			
0261	J419	2	22			
0262	J420	2	16			
0263	J501	1	11			
0264	J502	3	10			
0265	J504	1	7			
0266	J507	2	52			
0267	J508	4	36			
0268	J510	3	33			
0269	J605	2	10			
0270	J606	1	5			
0271	J608	1	23			

Context	Location	Flint		Burnt flint		Miscellaneous
		No	Wt/g	No	Wt/g	
0272	J612	1	12			
0273	J701	2	38			
0274	J702	2	12			
0275	J703	1	7			
0276	J704	1	5			
0277	J705	2	8			
0278	J707	2	58			
0279	J708	1	5			
0280	J709	2	9			
0281	J710	2	6			
0282	J711	1	24			
0283	J712	1	13			
0284	J714	1	4			
0285	J715	2	55			
0286	J716	2	44			
0287	J717	1	56			
0288	J719	1	4			
0289	J720	1	14			
0290	K502	2	51	1	7	
0291	K601	2	57			
0292	K607	1	20			
0293	K612	2	60	1	38	
0294	K701			1	33	
0295	K703	1	4			
0296	K706	3	172			
0297	K707	1	9			
0298	K708	6	27			
0299	K711	1	14			
0300	K712	1	4			
0301	K715	4	5			
0302	K718	4	26			



## Appendix 2. Flint

Ctxt	Type	No	Notes
0001	flake	3	Two irregular flakes could be from same platform as distinctive patinated cortex; 1 broad w wide hard hammer platform but appears regular
0002	flake	4	Hard hammer, 2 w thick cortex, 1 v thick, 2 squat more irregular frags
	shatter	1	Angular fragment with one patinated thermal surface & quite thick patinated white cortex one edge
0003	blade-like flake	1	Irregular
	flake	3	Irregular, thick rough cream cortex, gen sharp but w some slight edge damage
0004	flake	1	Primary flake, distal edge is damaged
0005	flake	3	Small irregular, thickish hard hammer, patinated white cortex
0006	shatter	1	Irregular cortical shatter – could be thermal
0007	burnt fragment	1	One v small, both heavily fractured
	flake	1	Small frag
0008	flake	1	Hard hammer cortical w blade-like scars could poss. be initial flake from blade core
0009	flake	2	One thin; 1 thick hard hammer, w thick rough off white cortex, sm pat. cortex
0010	flake	1	Quite small, thin and sharp, hard hammer
0011	single platform flake core	1	Small w wide pat platform and irregular jagged overhangs to plat edge, v sm squat flake scars
	flake	3	Two with thick rough cream cortex, 1 thin distal fragment
0012	burnt fragment	1	Small cortical burnt fragment
0013	retouched flake	2	One blade-like piece w v irregular prob retouch left side; 1 pat qu squat but regular fl w reg blade-like scars, plat has battered/abr edge
0014	core trimming flake	1	Has part of former platform edge on one side - incl'g worn/abr plat edge
0015	flake	2	One relatively large reg slightly blade-like fl on smooth grey flint; other v sm
0016	flake	1	Thick proximal part of cortical hard hammer flake - has v sm blade-like scars from dorsal face but mostly cortical
0017	retouched flake	1	Poss. broken across dist edge prior to retouch, proximal part of rel large flake, smooth mid grey, regular, w ret/steep flaking left side w shallower sm flakes from dorsal proximal face. Yellowish staining of dorsal face prior to flaking/ret, dist
0018	flake	1	Sharp, broad hard hammer, thickish orangey brown cortex
0019	flake	1	Small proximal hard hammer frag
0020	spall	1	Tiny
	retouched flake	2	One hard hammer w thick irregular white chalky cortex and irregular ret forming slight denticular edge, 1 frag - poss. therm fl w neat slight ret around a rounded pat. edge. Most of dorsal face = thin brown cortex
0021	flake	2	One small sharp hard hammer, 1 thick near primary hard hammer with thickish rough creamy brown cortex
	shatter	1	Very irregular shatter, prob from a struck piece, rough cream brown cortex
0022	flake	2	Both small
0023	flake	2	One small thin frag - prob blade-like, 1 prim with pat cortical plat
0025	denticulate	1	Squat - similar to scraper from same ctxt, irregular ret left edge forms irregular edge
	flake	4	All quite small, 1 thin with fractured dist end, others more irregular
0025	side scraper	1	Squat flake, smooth w grey mottles, ret left side - similar size and flint to dent from ctxt
0027	spall	1	
0028	flake	4	One quite thin regular hard hammer, others more irregular
0029	retouched flake	1	Squat quite thin sub circ fl with v slight utilised right side
0030	flake	1	Small thickish with slightly pat therm surface at plat
0031	flake	1	Small hard hammer with thick coarse cream cortex and pat white plat
	knife	1	Slightly irreg. D-shaped qu sm hard hammer flake, v slight abrupt retouch of most convex right side, reverse retouch left edge, sli more irreg. & extensive
0032	flake	1	Small, thin broad fl
0033	flake	1	Thin quite small
0034	core trimming flake	1	Irregular, one edge is from the plat edge - multi plat core
0035	notched flake	1	Hard hammer, with incipient cones on plat, dist edge has a v slight ret notch
0036	flake	4	Irregular, 2 v sm
	notched flake	1	Irregular, fairly sm, has ret forming v slight ?notch in left side
0037	flake	2	Both with partly pat cortex and cortical platforms
0038	flake	4	One thin frag; 1 w thick coarse cream cortex & pat white plat; 1 reg fl w wide plat; 1 poss. w some thermal surface –might be a split or frag. flake
0039	flake	1	Small area of pat white cortex

Ctxt	Type	No	Notes
0040	flake	1	Has v thick coarse cortex and pat white plat
0041	flake	1	Hard hammer , has pat white cortex over most of dorsal face
0042	flake	1	Quite small cortex is mostly pat white
0043	flake	1	Very small squat, has thin pat on cortex and dist edge
0044	flake	1	Small squat, mostly thick cream cortex
0045	flake	1	Hard hammer fl, its dist edge appears to have a thickish irregular burin-like point to it – poss. from former platform tho, rather than deliberate?
0046	flake	1	Irregular hard hammer thickish
0046	retouched flake	1	Hard hammer, some ret of edges but also edge damaged
0047	flake	2	One v sm with slight chip, 1 larger thick cortical plat
0048	flake	1	Small thick hard hammer
0049	flake	2	Both have med thick coarse cortex around edges, one around entire edges
0050	thumbnail scraper	1	Very small irregular squat flake 25mm wide, 20mm long, has neat ret around convex dist prt - semi-circle
	utilised flake	1	Quite neat hard hammer fl, has v slight but clear util. of most left lat
0051	flake	1	Small
0052	flake	1	Cortical
	shatter	1	Small thickish frag - coarse pale grey flint
0053	flake	1	Small thin fl - broken in 2
	retouched flake	1	Quite small irreg triang fl, white pat on plat, has rev ret on left side and prox part of right
0054	flake	1	Hard hammer
0055	flake	2	Onesm sharp dist frag, 1 larger cortical (darkish cream, sm area pat) qu thick hard hammer plat w some edge damage
0056	flake	1	Sharp fl with slight pat and post pat edge 'ret' - prob plough damage
0057	flake	1	Small squat
0058	flake	1	Very small broad with thick plat
	shatter	1	Irregular frag, has been struck in couple of place - v sm areas...?
0059	flake	2	Fairly thin flakes
0060	flake	2	One w much thick dark cream cortex - both hard hammer
0061	chip	1	Tiny
	flake	1	Quite small, near prim, thickish irreg cortex with white inner
0063	flake	3	One burnt flint frag; 2 squat flakes, 1 w some slight edge util. tho also damaged
0065	flake	1	Hard hammer
0066	flake	1	Hard hammer with overhangs to plat edge
0068	flake	1	Hard hammer, thickish chip like frag, slight opaque patina - dark grey
0069	flake	2	One primary, 1 thick shatter/chip like w wide irreg hard hammer platform
0070	flake	3	Hard hammer, all longish flakes, w qu thick cortex, diff pale and dark cream
0071	shatter	1	Irregular, thick dark cream cortex w inner white rind
0072	retouched flake	1	Small with slight retouch distal edge
0073	blade-like flake	1	
	flake	1	Hard hammer
	retouched flake	1	Quite squat thin flake - fairly large, slight ret of right edge
0074	flake	2	One qu regular tert flake; 1 squat with pat. cortical platform
0075	flake	1	
0076	flake	2	Thickish dark cream cortex
0077	multi platform blade core	1	Irregular but qu chunky core, smooth grey flint, slight pat, various plats, some blade scars
0078	flake	1	Has battered former platform edge on one side, quite small
0079	flake	3	Various irreg hard hammer
0080	chip	1	Very small, has battered edge
	flake	1	Very small, thin
0081	flake	2	One thick cortical, 1 thin both qu sm
0082	blade-like flake	2	Irregular
0083	flake	2	Both small, 1 squat with batter along edge of the plat
0084	flake	1	Quite small and thin, has white pat plat and dist edge
0085	flake	3	Small irregular hard hammer
0086	flake	2	Small, both broken
0087	notched flake	1	Small, has small notch in right side, could be accidental?
0088	piercer	1	?Blade w cortex at dist tip and v slight prob util. of edges close to tip, a tiny narrow chip/bladelet has come off from this tip - perhaps during use
0089	scraper	1	Small irregular flake w ret of slightly concave dist edge and around rounded dist/left end
0091	flake	1	Small qu neat fl with abr plat
0092	flake	5	Various
0092	spall	1	
	retouched flake	1	Small frag from edge of ret fl
0093	retouched flake	1	Irregular pat fakel w prox part of right edge retouched

Ctxt	Type	No	Notes
0094	flake	1	Hard hammer with squat broad hard hammer fl with notch in dist edge - less glossy - prob accidental??
	utilised flake	2	Hard hammer, 1 broad and short, both have slight util. edges
0095	scraper	1	Roughly ovate with retouch around distal end and extending approx halfway along both sides
0096	chip	1	Very small
	flake	1	Very small
0098	flake	1	Thick squat hard hammer, dark cream cortex with another face white pat
0099	blade-like flake	1	Thick hard hammer, cortical
	flake	2	Irregular
0102	flake	2	One sm thin sharp slightly curving and w abr plat, other sm pat. frag
0103	flake	2	Hard hammer, 1 thick and cortical, other smaller, burnt with fractured edges
0104	flake	1	Small irregular frag
0105	core fragment	1	Quite small- has been hit at both ends and resembles bl core but some faces prob thermal
0105	utilised flake	1	Hard hammer
0106	flake	1	Small broad quite thick
0107	flake	1	Hard hammer
0108	flake	1	Part of large flake - smooth slightly pat grey flint, some incipient cones
0109	utilised flake	1	Small thin asymm qu broad fl, very slight ut edges
0110	flake	1	Small squat with much cort and pat white plat
0111	flake	1	Very small, prox missing
0112	flake	1	Small fragment
0113	flake	1	Broad thick hard hammer with qu thick cortex along dist edge
0114	flake	1	Hard hammer broad primary flake
	shatter	1	Small frag - therm pat surface with one 'fresh' face
0115	flake	2	One irreg prim flake; 1 sm w pat white cortex on part of edge inclg plat
0116	flake	1	Quite small irreg
0117	flake	1	Squat hard hammer, qu regular
0118	notched flake	1	Slightly blade-like, has notch in left side - cld this be accidental?
	retouched flake	1	Slight rev ret part of a broken edge
0119	flake	1	Quite small thin pat'd
0121	burnt fragment	1	Shattered sm frag
	flake	15	Mostly irregular, various cort, mainly thickish or white patina, several cortex plats, 1 more regular fl has battered or abraded plat edge
0122	flake	1	Small hard hammer squat
0123	flake	1	Small squat hard hammer
0124	blade-like flake	1	With pat white cortex along righth and dist edges
0125	blade-like flake	2	Irregular, 1 almost primary with some pat cortex
	flake	3	One sm thick, 1 qu sm w pat white dorsal; 1 w battered area on a former platform edge - multi plat core
0126	flake	1	Quite thick cortex over more than half, some pat white
0129	tested piece	1	Small rounded frag from abr. pebble, 1 side has few fls from battered edge
	flake	1	Very small
0130	flake	1	Small squat hard hammer, white pat cortex around dist side
0131	blade-like flake	1	Small thin with slight abr plat
0132	blade-like flake	1	Small and curving
0135	flake	1	Squat hard hammer fl with pat cortex plat and irreg thick cortex dist edge
0137	retouched flake	1	Slight ret part of dist/right edge, some thick cortex
0138	struck fragment	1	Some pat surface and coarse cream cortex
0139	flake	1	Small
0140	blade-like flake	1	
	scraper	1	Small qu thick w pat white thick plat, retouch of dist and dist part right edge
0141	side scraper	1	Irregular hard hammer flake, broad w straight left side and therm dorsal face with fl from plat/prox face, ventral face has ret of right side, convex to dist
0142	retouched blade	1	Small medial frag of /tapering blade, edge ret both sides - part of tool of some type
0143	flake	1	Irregular. distal broken
	spurred piece	1	Small irregular, 2 slight notches on right side forming small spur - probably accidental damage
0144	flake	2	1 sm squat and thin, 1 slightly blade-like with white pat plat and part of dorsal face
0145	flake	1	Hard hammer squat/broad, sharp
0146	flake	2	1 squat - , 1 sharp
0147	denticulate	1	Proximal part of fl with v slight prob ut one side and ?ret forming irreg dent other edeg
0148	flake	1	Has thick white cort, damage on left edge prob accidental
0149	flake	1	Quite thick
	utilised flake	1	Very slight ?util edge

Ctxt	Type	No	Notes
0150	spall	1	
0150	notched flake	1	Very irregular flake with poss notch one side
0151	flake	1	Quite small but regular
0152	flake	1	Irregular broad
0153	flake	1	Quite small
0154	flake	1	Quite regular hard hammer tert fl
0155	flake	1	Quite small
0156	flake	1	Quite neat sm fl, has pat white cort
0157	flake	1	Quite neat squat fl with pat white cortical plat
0158	blade-like flake	1	Small thin
0159	flake	1	Hard hammer, squat, plat edge with protruding overhangs - trimming plat edge
0160	scraper	1	Broad v short fl with wide dist edge ret to scr-like, cortical plat and battered/abraded/poss damaged plat edge
0161	flake	3	Hard hammer and sharp
0163	awl	1	Hard hammer blade w reverse retouch on central part of right side and slight retouch on opposite sides at distal tip. Awl type?
0164	flake	1	Quite small
	notched flake	1	Quite irregular flake with reverse retouch on left side forming shallow but long 'notch'
0165	flake	1	Hard hammer, qu thin neat fl
0166	flake	3	2 sm unpat, 1 qu thin tert fl w dist. missing and plat w abr on top surface
0168	spall	1	
0169	flake	2	1 squat, 1 longish but thick - pat white
0170	blade-like flake	1	
0171	flake	1	Small hard hammer
0172	chip	1	Very small
0173	flake	1	Prob sh, qu thin, qu abraded with thick cort at dist end
0174	flake	1	Hard hammer cortical, iron stain patches on pat whitish cortex
0175	flake	2	Small
0176	flake	1	Frag
0177	utilised flake	1	Thin slightly curving, reg, from poss bl core, with abr plt, has edge damage but prob slight ut part of edge
0178	flake	1	Quite small, thick dark cream rought cortex
0180	flake	1	Proximal frag of qu reg fl, pat whitish grey
0181	flake	3	Irregular, some pat white cortex
0182	flake	1	Proximal part of poss qu large regular broad fl
0183	utilised flake	1	Prox. part of regular smooth flake, slight util./ v slight ret on remaining part of right edge
0184	flake	1	Very small
	arrowhead	1	Very thin squat flake, mottled grey white patinated, w bifacial flaking, mainly on dorsal face but some around prox/left side of ventral, irreg concavity in distal edge to left side, type ? could be a v irreg leaf arrowhead, possibly unfinished.
0185	blade-like flake	1	Sharp tho with some chips in edge, slightly abr plat
0186	flake	1	Small squat thin, slight facetting on plat
0187	flake	1	Hard hammer cortical, near primary
0188	flake	2	Both v small
0189	blade-like flake	1	Patinated white cortex along left side and on right at dist pointed end
	side scraper	1	Squat hard hammer fl with ret of convex right edge
0190	flake	1	Hard hammer, cortical
0191	spall	1	
0192	spall	1	
0193	flake	1	Sharp irreg and mostly cortical
0194	flake	1	Small thin with pat plat
0195	blade	1	Irregular with asymmet triang section
0196	flake	1	Small squat hard hammer, qu reg rect shape
0197	flake	1	Small sharp cortical, hard hammer
0198	flake	1	Small qu chunky, hard hammer
0199	retouched flake	1	Large flake w narrow protruding prox end w pat. plat, main area of flake 'leaf-shaped', pat'd, v sligh ret on 1 side, bl-like scars. From large blade-type core? irreg shape but qu regular broadish and tapering hard hammer plat, pat'd
0200	flake	1	Quite large mottled grey to white w light pat, irreg edges due to damage, qu thick flat plat
0201	flake	1	Quite large mottled grey to white w light pat, irreg edges due to damage, qu thick flat plat
0202	flake	1	Squat hard hammer - almost primary, rough off white cortex, some pat cortex
0203	flake	1	Small, slightly blade-like
	scraper	1	Small squat pat flake with retouch around dist part
0204	flake	1	Very small thick flake - chip-like
0205	flake	1	Small squat hard hammer
0207	flake	1	Small broad primary flake
0207	spall	1	

Ctxt	Type	No	Notes
0208	flake	1	Quite regular squat hard hammer fl with fractured edge
0209	flake	1	Hard hammer, broad irregular
0211	flake	1	Hard hammer qu sm squat but regular
0212	flake	1	Irregular jagged with wide hard hammer plat, some protrudin overhangs to plat edge, v sharp and irreg ventral face with percussion type 'bulbs'
0213	flake	1	Irregular, squat
0214	flake	3	2 thin and sharp, 1 has poss ret at prox point ?piercer - but this could be accidental damage
0215	flake	2	Both qu thin and regular pat fls, 1 sm
0216	flake	1	Thickish hard hammer
0217	knife	1	Broad hard hammer fl with thickish cort along dist edge and straight right edge neatly ret - semi abrupt edge ret along its length
0218	flake	1	Quite small frag
	shatter	1	Chunky
0219	flake	2	1 primary frag, 1 - qu thin slight br plat
0220	flake	1	Proximal frag hard hammer
0220	spall	1	
0221	piercer	1	Quite small cortical fl with pointed dist worn on one side
0221	retouched flake	1	Squat with thick hard hammer plat, pat mottled grey white, slight ret left side
0222	utilised flake	1	Quite small pointed fl with v slight ut part of left edge
0223	flake	2	Hard hammer irreg, 1 qu thick and jagged with pronounced bulbs
	piercer	1	Irregular fl w thick cortex along right edge, slight prob ret at dist tip, from use?
0225	flake	1	Small thick with thick rough whitish cortex
0226	flake	1	Sharp qu squat, qu regular, one facet on plat
0227	side scraper	1	Irregular fl with pat plat and mostly cortical dorsal, left edge ret and damaged ?use and irreg dist cortical edge has notch prob damage
0228	flake	1	Irregular sharp, rough cortex with some pat cor
0229	flake	1	Squat sharp withpat plat - qu regular
0230	blade-like flake	1	Thick cortex along right side
0230	flake	1	Patinated irregular fl with pat white cortex
0231	flake	1	Broad
0232	flake	1	Small
	spurred piece	1	Quite neat hard hammer pat fl - irreg as has ret on ventral face along sloping left side of a dist point, forms qu a neat blunt point
0233	flake	1	
0234	notched blade	1	Hard hammer blade with notches, 1 in each side close to broken off distal end - prob real due to position etc
0235	flake	1	Very thick cort around right side, plat pat white, hard hammer
0236	flake	3	all sm, 1 thick chip like and pat, 1 with pat white plat
0237	flake	1	Patinated white, incomplete
0238	flake	1	Tiny irregular primary frag, irreg triangular, apparent ret of two side to a blunt squared point...? - but I don't thin this is ret now - just edge damage
0239	notched flake	1	Irregular cortical flake, concave edge to prox/right edge retouched in a shallow open notch
0240	spall	1	
0241	flake	1	Small, pat white plat
0242	retouched flake	1	Irregular fl w cort at dist edge and sl. irreg ret of left edge - other sl. damage
0243	flake	2	1 v thick cortical - from side of core, 1 thin , both hard hammer
0243	end scraper	1	Very small qu thin ovate fl withpat plat and qu slight re around dist end
0244	chip	1	Tiny
	flake	2	1 sm and broken, 1 qu sm thin and slightly curving with irreg step on ventral face, plat is abraded along one edge of its surface - from a former plat edge
0245	flake	1	Very small thin
0247	thumbnail scraper	1	Slightly squat subcircular, patinated, mottled grey/white. Neat retouch around most of edges apart from proximal side
0248	flake	1	Thin slightly curving regular flake
0249	blade-like flake	1	Quite small and thin, cortical
	flake	1	Small hard hammer
0250	notched flake	1	Quite small irreg cortical fl, pat'd, wih ret shallow notch or indent in right side to dist end
0251	flake	1	Small, slightly blade-like tert fl
0252	burnt fragment	1	Fractured lump, cortical surface has fractured off over much of area, other thermally fractured surface has crystalline inclusion
	flake	2	Both small broad, 1 with cortical plat
0253	blade-like flake	1	Small
	flake	1	Broad irreg with wide hard hammer plat, pat. w a thicker white pat on dorsal face
0254	flake	1	Small squat, hard hammer, qu regular
0255	blade-like flake	1	



Ctxt	Type	No	Notes
0255	flake	1	Primary flake
0256	flake	2	1 broad irreg pat white, 1 sm pointed and thin
0257	flake	1	
0258	flake	1	Very small
	spall	1	
0259	flake	3	Various irreg, 1 with pat plat
0260	core fragment	1	Very small thin frag/fl from plat edge of a core
	flake	1	Small irregular
	spall	1	
0261	flake	2	Both cortical, v similar - cld be from same core..
0262	flake	2	both thin, slight pat'd, 1 tapering qu sm with abr plat
0263	flake	1	Hard hammer, qu regular thin and sharp, squat bl-like with hinge dist
0264	flake	2	Both small thin, squat and sharp, both have pat white smooth cortex
0265	blade	1	Very small prox missing
	flake	1	Small -shattered edge
0266	flake	1	Quite broad hard hammer
	flake	1	Small fl/frag w abr type/fls from plat edge but also on opp. face.Could be trimmed as working edge-both sides of narrw 'plat' edge struck
0267	flake	3	Various, irreg 1 broad with pat white palt
	spall	1	
0268	flake	3	Hard hammer, 2 sm, 1 of thes with v thick cortex
0269	flake	2	1 tiny frag, 1 qu neat sm fl pat white and with facetted plat - from previously worked face
0270	flake	1	Small hard hammer
0271	blade-like flake	1	Cortex, partly pat/abraded
0272	flake	1	
0273	flake	2	Both pat mottled white and grey wih cream cortex
0274	flake	2	1 pat with cortical platform, 1 sm hard hammer plat
0275	flake	1	Small thick and sharp hard hammer
0276	flake	1	Small thick hard hammer sharp
0277	flake	2	1 v sm broad with hinge, 1 qu small hard hammer
0278	flake	1	Small sharp almost prim
	struck fragment	1	Cortical prim therm frag - one edge struck
0279	flake	1	Small - incomplete
0280	flake	2	Very smallirreg
0281	chip	1	Very tiny
	flake	1	V small sharp flake w notch/ret end prob damage.Sharpness suggests unused.
0282	burnt fragment	1	
0283	flake	1	Quite small ovate , patinated white
	utilised flake	1	Small with v slight ut edge
0284	chip	1	Small sharp
0285	flake	1	Small
	struck fragment	1	1 face has some cortex and flaking, other face shattered
0286	flake	2	1 small hard hammer, dorsal face slight pat, 1 - larger irreg cortical, pat white
0287	side scraper	1	Fairly large patinated flake, long and broad bl-like, left side, cortical, has been fla - post patina - to a crude scraper-like edge
0288	flake	1	Very small patinated white
0289	struck fragment	1	Quite small long frag
0290	flake	3	Irregular, 1 qu large cortical and patinated fragment
0291	blade-like flake	1	Small irregular
	struck fragment	1	Shattered frag - one side has been flaked/ret - poss tested ...?
0292	retouched flake	1	Possible v slight ret edge
0293	flake	1	Small squarish, thick plat
	flaked piece	1	Small ovate thick piece w cortex on central and 1 side of 1 convex face and steeply ret/flakes around most sides, other face almost flat, w some flaking from edges, could be sm tool - crude scraper-like. Part of edge qu battered
0295	flake	1	Small broad irreg
0296	tested piece	1	Cortical knob-like with pat broken end and a few bl-like removals from this
	flake	1	Small hard hammer slightly blade-like
	retouched flake	1	Wide plat/thick prox end, pat'd, slight rev ret prox end left side
0297	flake	1	Cortical hard hammer
0298	blade	2	Both v small
	flake	4	all qu sm squat, 2 pat'd, 1almost white, 1 with battered plat edge
0299	flake	1	Patinated white plat, thickish cortex , slight edge damage but generally sharp
0300	flake	1	Very small
0301	chip	2	Both v small and jagged
	flake	1	Very small and sharp
0301	spall	1	
0302	flake	4	Various