



# University of Leicester

## Archaeological Services

**An Archaeological Evaluation  
at The Cottage, Hall Lane  
Ashby Magna, Leicestershire  
(SP 5634 9059)**

**by Gerwyn Richards**



ULAS Report No 2011-071  
©2011

**An Archaeological Evaluation at  
The Cottage, Hall Lane  
Ashby Magna,  
Leicestershire.**

**(NGR SP 5634 9059)**

**Gerwyn Richards**

Planning Permission: P.A.10/01183/FUL

**For:** Mr SR Johnson

Checked by:

**Signed:**



**Date:** 13.05.2011

**Name:** Patrick Clay

**University of Leicester**

Archaeological Services

University Rd., Leicester, LE1 7RH

Tel: (0116) 2522848 Fax: (0116) 2522614

**ULAS Report Number 2011-071**

**©2011**

**X.A67.2011**

**An Archaeological Evaluation at The Cottage, Hall Lane, Ashby Magna,  
Leicestershire (NGR SP 5634 9059).**

**Contents**

Summary	1
1. Introduction	1
2. Background	2
3. Aims and Methodology	4
4. Results of Trial Trench Evaluation	4
5. Conclusion	4
6. Archive & Publication	5
7. References	5
OASIS	6

**Figures**

Figure 1	Site location.	2
Figure 2	Proposed development area; with proposed trench location in red.	3
Figure 3	Trench location plan (retained buildings in black, grey proposed building).	7
Figure 4	Trench post-excavation, looking south.	8
Figure 5	Trench post-excavation, looking west.	8

**An Archaeological Evaluation at The Cottage, Hall Lane, Ashby Magna,  
Leicestershire (NGR SP 5634 9059).**

**Gerwyn Richards**

**Summary**

*University of Leicester Archaeological Services were commissioned Mr S R Johnson to undertake an archaeological evaluation of The Cottage, Hall Lane, Ashby Magna, Leicestershire, in advance of the construction of a new residential unit. The proposed development area had been identified as being an area of archaeological potential.*

*A single evaluation trench was machine excavated and recorded as close to the proposed footprint of the new building as possible. No evidence of archaeological deposits or artefacts was observed within the trench.*

*The archive for the archaeological work will be held by Leicestershire County Council, under the accession number X.A67.2011.*

**1. Introduction**

University of Leicester Archaeological Services were commissioned by Mr S R Johnson to undertake an archaeological evaluation in advance of the proposed development at The Cottage, Hall Lane, Ashby Magna, Leicestershire (SP 5634 9059; Fig. 1). The proposed development involves the construction of a single residential unit which will incorporate retained elements of existing outbuildings, associated garaging, hardstanding and landscaping on a site of approximately 0.46 hectares which is currently a garden. The proposed development is within the curtilage of a Listed Building. No previous intrusive archaeological work has been carried out within the proposed development area.

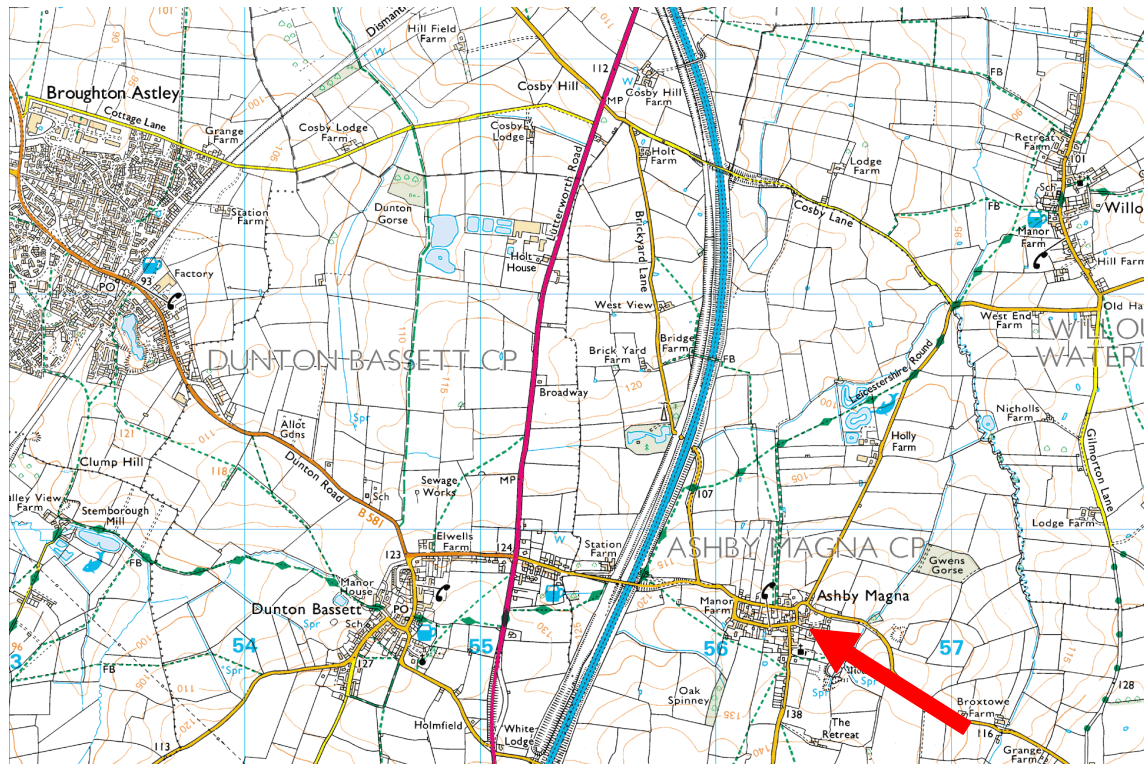

Figure 1: Site location Scale 1:25000

By permission of Ordnance Survey on behalf of The Controller of Her Majesty's Stationery Office. © Crown Copyright 1996. All rights reserved. Licence number AL 100029495.

## 2. Background

Archaeological evaluation of the site by trial trenching was requested by Leicestershire County Council Historic and Natural Environment Team (LCC HNET) on behalf of Harborough District Council.

The Ordnance Survey Geological Survey of Great Britain, Sheet 170 indicates that the underlying geology is likely to consist of Boulder Clay.

The proposed development area lies towards the western extent of the historic settlement core Ashby Magna. An examination of the Historic Environment Record for Leicestershire & Rutland (HER) indicates a number of known archaeological sites within the vicinity of the proposed development area, including the medieval and post medieval village core of Ashby Magna (HER Ref MLE9432).

In addition, various archaeological remains and sites have been located within the vicinity of the proposed development area including a fragment of medieval floor tile, and a number of sherds of early medieval pottery in the field east of the church (HER Ref MLE15768), to the south, there is medieval moated site (HER Ref MLE1203), which is a scheduled ancient monument (Scheduled Monument 17040). A ditch containing medieval pottery was recorded during an archaeological evaluation and watching brief at number 4, Old Forge Road (HER Ref MLE9773) and a number of medieval earthworks can be seen within the village (HER Refs MLE1199, 1204 and 10492). The Church of St. Mary, south of the proposed development area has 13th century origins (HER Ref MLE11018).

The Cottage itself is Grade II Listed, the listing description is as follows (<http://www.heritagegateway.org.uk>):

*Cottage. Early C18. Rendered probably over brickwork with thatched roof now covered in corrugated sheeting. One and a half storeyed, 3 unit plan, with one bay to left of doorway, and 3 windows to its right. All the windows are 3-light casements with flat wood lintels, but the right hand one is a renewal. The windows to either side of the doorway have panelled shutters. There is a single 3-light window in eyebrow dormer above. Gable end and axial stack between the two right hand bays.*

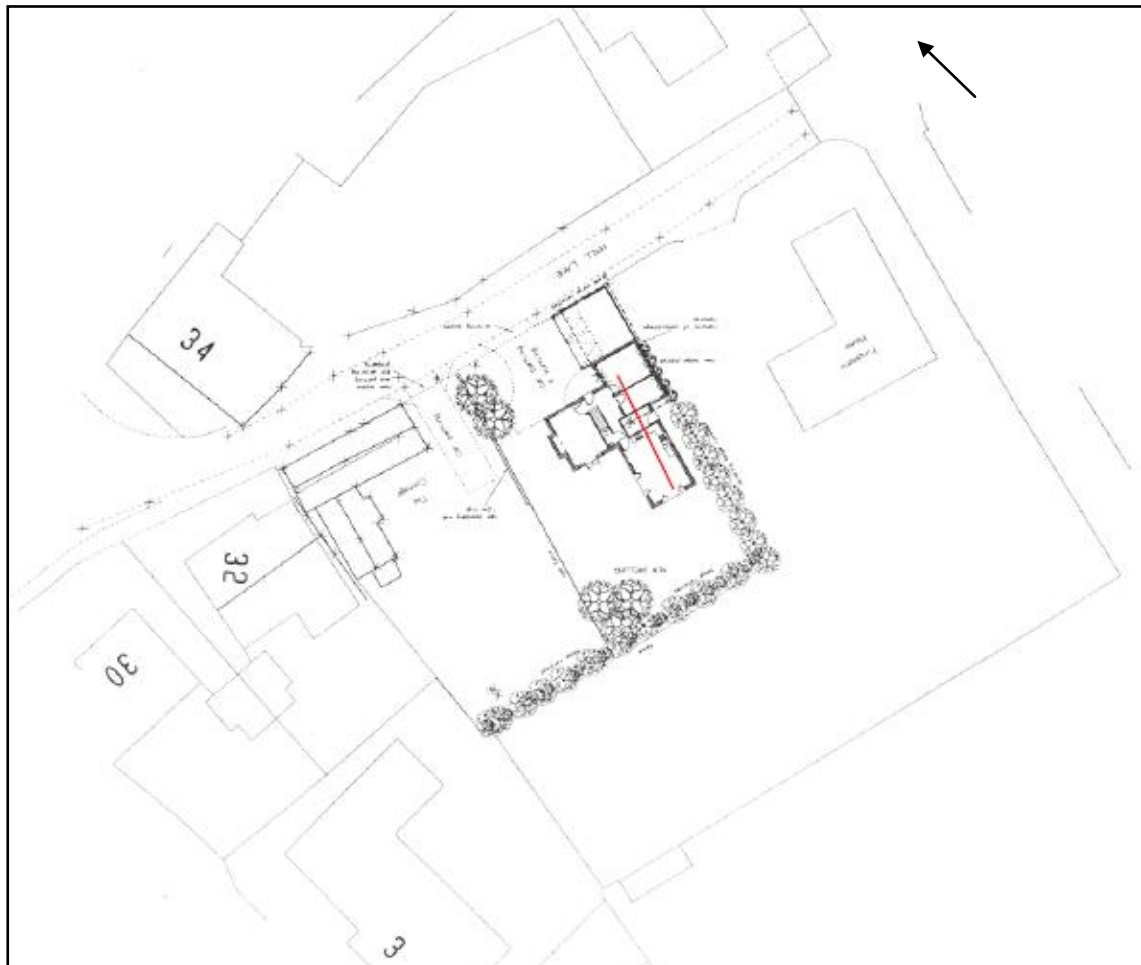

**Figure 2:**  
Proposed development area; with proposed trench location in red  
Drawing supplied by client, not to scale, north arrowed.

### **3. Aims and Methodology**

The main objectives of the evaluation were through archaeological trial trenching:

- To identify the presence/absence of any archaeological deposits in areas to be affected by the development.
- To provide information on the extent, character, condition and date range of archaeological deposits within the application area.
- To assess the potential impact of the proposed development on any archaeological remains.
- To produce an archive and report of any results.

The LCC Planning Archaeologist requested an evaluation of the impact of proposed development with the excavation of a single 15m x 1.6m trench (*Fig. 2*) targeting the proposed footprint of the new build. In view of intention to retain elements of the existing buildings, these buildings were still standing during this evaluation, necessitating the revision of the position of the evaluation trench. An 'L' shaped trench was excavated sampling the southern and westernmost areas of the proposed footprint. The evaluation took place on May 11th 2011 and the trenches were excavated by a 3 tonne mini digger using a ditching bucket.

The archaeological work addressed the requirements detailed in *Brief for Archaeological Evaluation at The Cottage, Hall Lane, Ashby Magna, Leicestershire, Leicestershire/Rutland* (LCC HNET 28.10.2010) and *Design Specification for archaeological work* (ULAS 11-562).

### **4. Results of Trial Trench Evaluation**

Machining initially began to the south of the existing buildings and was positioned to avoid a sunken area. The trench was located, adjacent to the gable and the easternmost boundary and continued on an east to west alignment for 6 metres before turning to the south and continuing towards the Hall Lane frontage for 10metres (*Figure 3*). The trench was 16m long and 1.6m wide.

Approximately 0.3m to 0.6m of garden soil was excavated, which in places contained large amounts of rubble, exposing undulating layer silty sand subsoil. Beneath the subsoil a horizon of the natural substratum comprising orange-brown silty sands and gravels was exposed. Excavation ceased at this level, approximately 0.5m to 0.6m below the existing ground level. A number of modern pits, containing rubble and 20th century domestic waste were observed within south-westernmost part of the evaluation trench.

No remains of archaeological significance were found within the trench and it was recorded and released for backfilling.

### **5. Conclusion**

The proposed development area occupied a promising location within a rich archaeological landscape on the western edge of the historic settlement core of Ashby Magna, but no evidence of archaeological deposits or artefacts were encountered

during the course of this evaluation. Extensive recent disturbance was encountered within the proposed development area, but the underlying substrata appeared largely undisturbed, suggesting that the area has always been undeveloped.

## 6. Archive & Publication

The site archive consists of:

- 1 A3 permagraph sheet showing trench location plan
- 1 A3 paper trench location plan
- CD containing 9 digital images
- 1 A4 contact sheet
- 9 Black & White negatives and contact prints
- 1 A4 trench recording sheets
- Unbound copy of this report (ULAS Report Number 2011-071)

The archive will be held at Leicestershire County Council Museums under the Accession Number X.A67.2011

A version of the summary (above) will be submitted to the editor of the local journal *Transactions of Leicestershire Archaeological and Historical Society* for inclusion in the next edition.

## 7. References

IfA, 2008 *Code of Conduct*

IfA, 2008 *Standard and Guidance for Archaeological Field Evaluation*

ULAS 2011 *Design Specification for archaeological work at The Cottage, Hall Lane, Ashby Magna, Leicestershire NGR SP 5634 9059.*

Gerwyn Richards  
ULAS  
University of Leicester  
University Road  
Leicester LE1 7RHs

[gr42@le.ac.uk](mailto:gr42@le.ac.uk)

T: 0116 252 2848

F: 0116 252 2614

12.05.2011



<b>ID</b>	<b>OASIS entry summary</b>
Project Name	The Cottage, Ashby Magna
Summary	The evaluation revealed no evidence of archaeological remains
Project Type	Evaluation
Project Manager	Patrick Clay
Project Supervisor	Gerwyn Richards
Previous/Future work	Previous: None. / Future: unknown
Current Land Use	Garden
Development Type	Residential
Reason for Investigation	PPS5
Position in the Planning Process	Unknown
Site Co ordinates	SP 5634 9059
Start/end dates of field work	11/05/2011
Archive Recipient	Leicestershire County Museum
Study Area	0.46ha
Associated project reference codes	LCC Museum accession No. XA67.2011

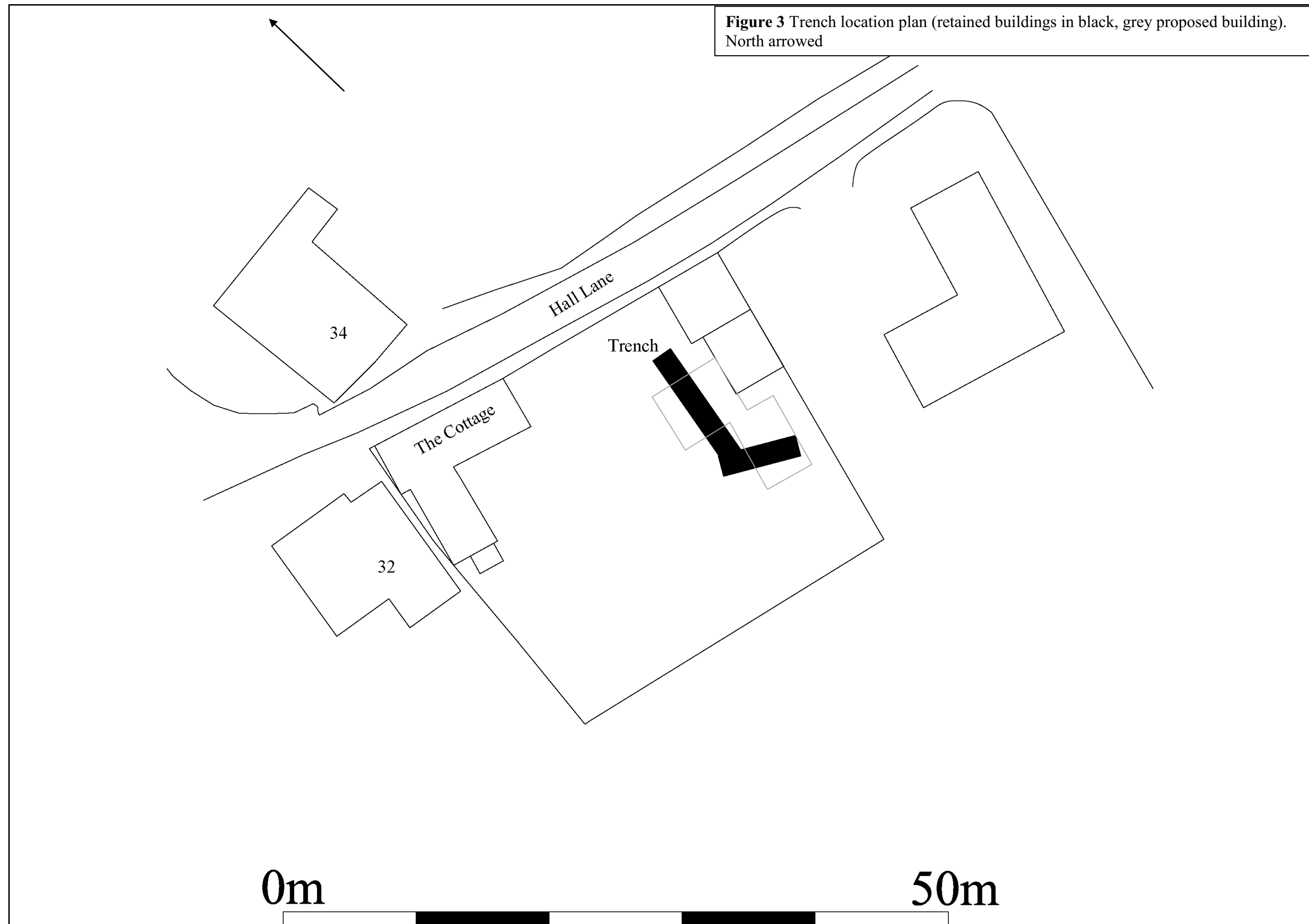

**Figure 3** Trench location plan (retained buildings in black, grey proposed building).  
North arrowed



**Figure 4**  
Post excavation, looking south.



**Figure 5**  
Post excavation, looking west.

## Contact Details

Richard Buckley or Patrick Clay  
University of Leicester Archaeological  
Services (ULAS)  
University of Leicester,  
University Road,  
Leicester LE1 7RH

**T:** +44 (0)116 252 2848

**F:** +44 (0)116 252 2614

**E:** [ulas@le.ac.uk](mailto:ulas@le.ac.uk)

**w:** [www.le.ac.uk/ulas](http://www.le.ac.uk/ulas)

