



University of Leicester

Archaeological Services

**An Archaeological Watching Brief
at 8 Church Street,
Rothley,
Leicestershire
(SK 585 126)**

Gerwyn Richards



ULAS Report No 2011-141
©2011

**An Archaeological Watching Brief
at 8 Church Street,
Rothley, Leicestershire.
(NGR SP 585 126)**

Gerwyn Richards

Planning Application: P/11/1012/2

For: Mr M. Jones.

Checked by



Signed:

Date: 14.09.2011

Name: Jennifer Browning

University of Leicester
Archaeological Services
University Rd., Leicester, LE1 7RH
Tel: (0116) 252 2848 Fax: (0116) 252 2614
www.le.ac.uk/ulas

**An Archaeological Watching Brief carried out at 8 Church Street, Rothley,
Leicestershire (SK 585 126)**

Contents

Summary	1
1. Introduction	1
2. Aims and Methodology	2
3. Results	4
4. Conclusion	4
5. Archive & Publication	4
6. References	4
Appendix OASIS	8

Figures

Figure 1	Site Location	2
Figure 2	Proposed development area in detail.	3
Figure 3	Area of archaeological watching brief, existing footings in red and location of trial hole in black.	6
Figure 4	Made ground exposed behind retaining wall (looking north).	7
Figure 5	Existing footings & trial hole in foreground (looking east).	7

An Archaeological Watching Brief carried out at 8 Church Street, Rothley, Leicestershire (SK 585 126)

Gerwyn Richards

Summary

University of Leicester Archaeological Services (ULAS) was commissioned by Mr M. Jones to undertake an archaeological watching brief during groundworks in advance of the construction of an extension to the rear of number 8 Church Street, Rothley, Leicestershire.

The proposed development area had been identified as being of archaeological potential, located within the historic settlement core of the village, adjacent to the medieval church of St. Mary the Virgin & St. John the Baptist as well as other sites of known archaeological significance. No evidence of archaeological deposits or artefacts was encountered during the course of the watching brief.

The archive will be held by Leicestershire County Council, under the accession number X.A125. 2011.

1. Introduction

University of Leicester Archaeological Services was commissioned by Mr M. Jones to undertake an archaeological watching brief during groundworks for the construction of an extension to number 8 Church Street, Rothley (SK 585 126; *Figures 1 & 2*). The proposed development area was located to the rear (the north east) of the house which fronts Church Street to the south west. The groundworks consisted of ground reduction and the excavation of foundation trenches.

The Leicestershire and Rutland Historic Environment Record (HER) indicates that the proposed development area lies in an area of archaeological interest, located within the medieval and post-medieval historic settlement core of the village of Rothley (HER Ref MLE910). Other sites of archaeological significance nearby include the scheduled remains of the Rothley villa, a high status Roman settlement site (SM ref. LE159; HER Ref MLE891), in addition an Anglo Saxon inhumation cemetery has also been recorded (HER Ref MLE880). More immediate to the proposed development area is the Church of Saint Mary the Virgin & Saint John the Baptist (HER Ref MLE13258), which is 13th century in origin. Immediately to the north west is April Cottage (no 10 Church Street), a 16th or 17th century Listed cruck frame cottage.

Charnwood Borough Council advised that the proposed works may have an impact upon buried archaeological remains. In view of this a programme of archaeological attendance was approved. This consisted of a watching brief carried out during the groundworks undertaken by the client's contractors. This work followed Planning

Policy Statement 5 (*Planning and the Historic Environment*) (Department for Communities and Local Government March 2010).

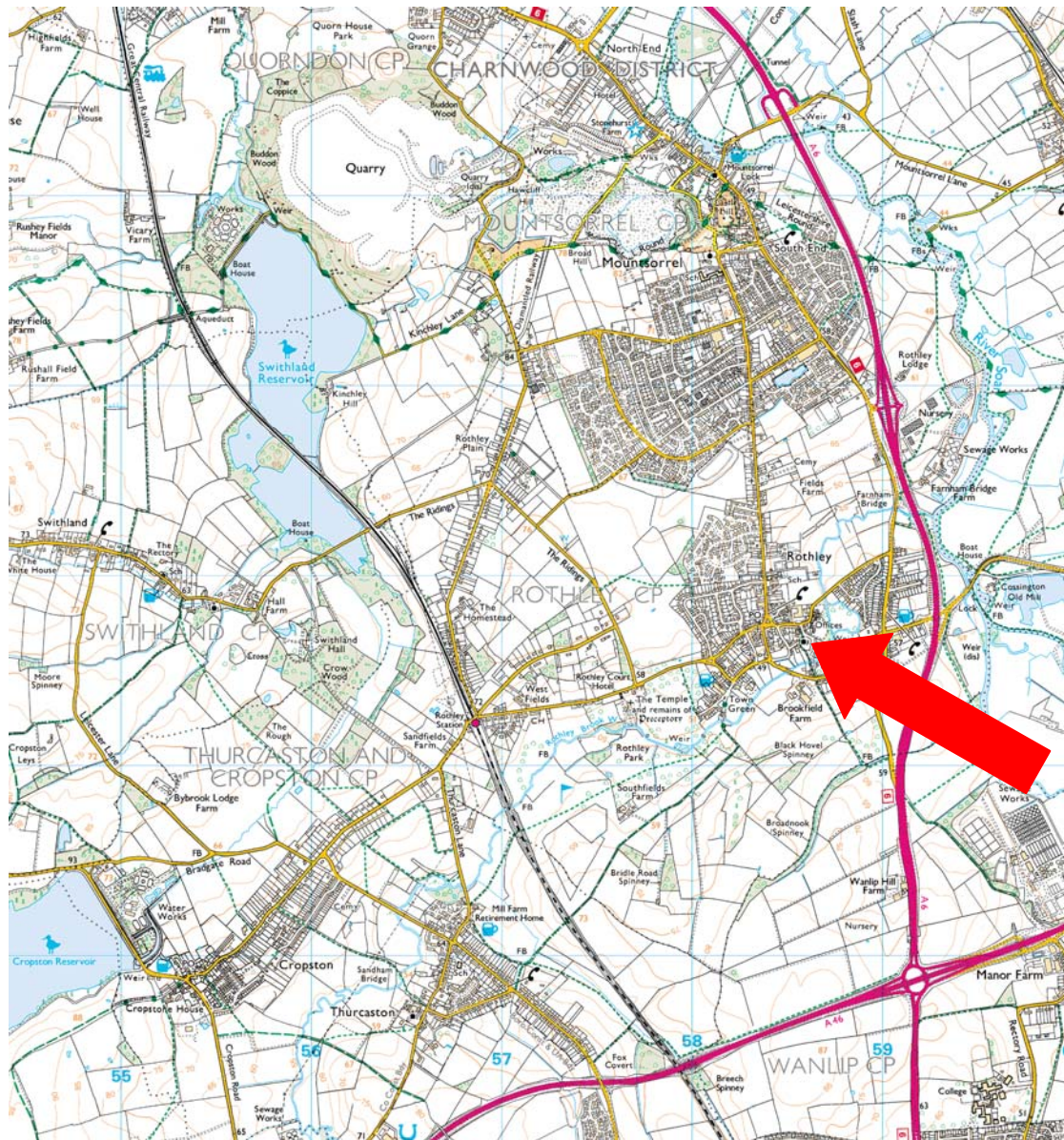

Figure 1. Site location

By permission of Ordnance Survey on behalf of The Controller of Her Majesty's Stationery Office. © Crown Copyright 1996. All rights reserved. Licence number AL 100029495.

2. Aims and Methodology

The aims of the archaeological work, through archaeological inspection and recording of groundworks by the client's contractors, were:

- To identify the presence/absence of archaeological deposits.
- To establish the character, extent and date range for any archaeological deposits to be affected by the proposed groundworks.
- To record any archaeological deposits to be affected by the groundworks.
- To produce an archive and report of any results

The work followed the Institute for Archaeologists (IfA) *Code of Conduct* (2010) and *Standard and Guidance for Archaeological Watching Briefs* (2008), the *Guidelines for Archaeological Work in Leicestershire and Rutland* (LMARS). The archaeological work addressed the requirements detailed in *Design Specification for archaeological work* (ULAS 12-317) and adhered to the University's Health and Safety policy.

All groundworks were hand-dug under archaeological supervision. The exposed substratum was observed and the spoil searched for finds. A number of trial holes were also hand dug by the author. The watching brief took place on September 12th 2011.

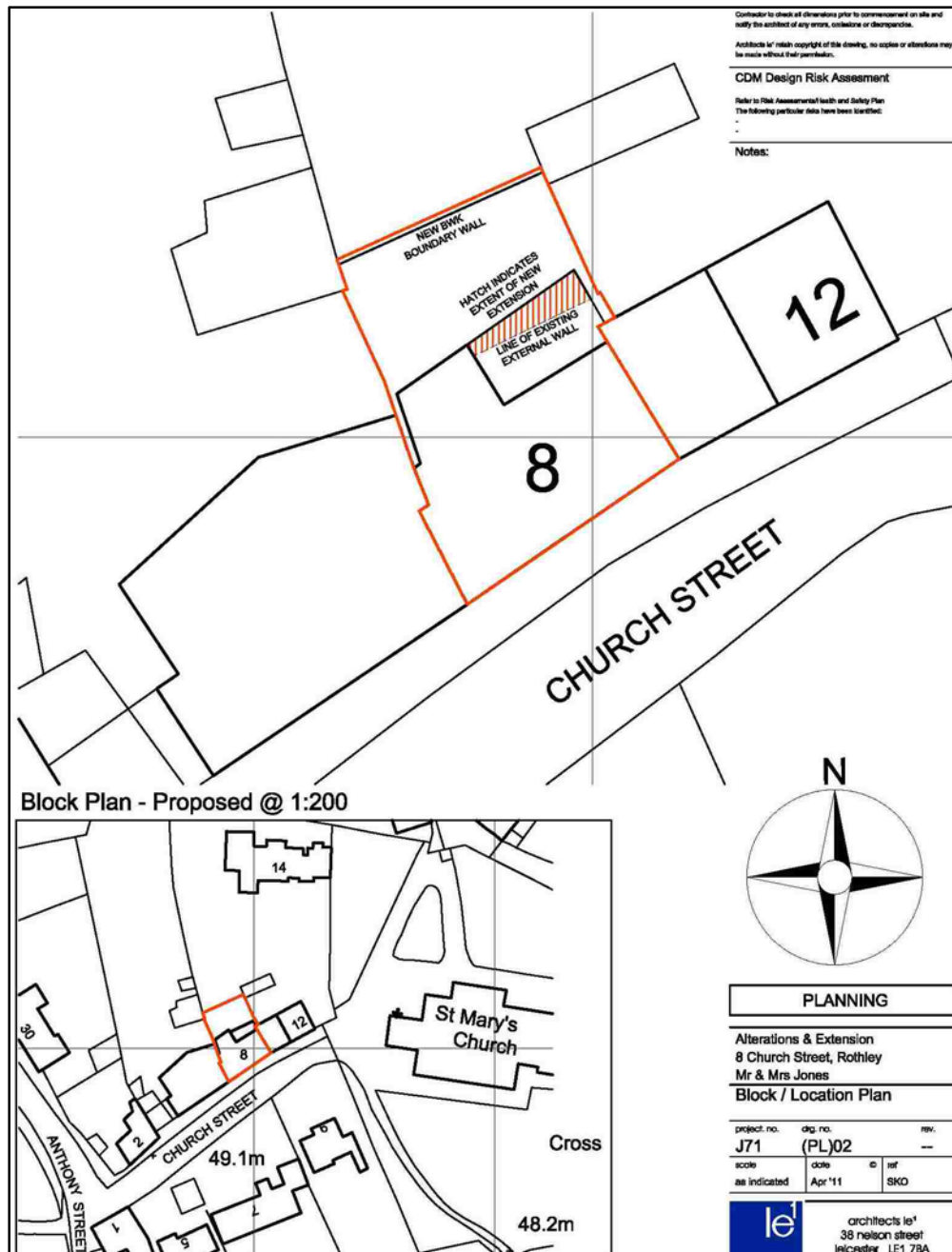

Figure 2 Proposed development area in detail.
(Not to scale, supplied by client)

3. Results

The proposed development area is located abutting the north east facing elevation of the property, (*Figures 2 & 3*). A 20th century extension had been demolished prior to the site visit leaving only the floor slab. A garden retaining wall had also been removed, exposing approximately 0.75m of 20th century rubble. A single footing trench was to be excavated at the northern side of the new extension; on the eastern side the footing was following the line on an existing 19th or early 20th brick footing which had truncated any potential archaeological remains. A more recent foundation had also been dug to the west, again truncating any potential archaeological remains. An area of approximately 1.5m appeared to be relatively un-disturbed. A 1m x 0.45m trial hole was excavated archaeologically within this area. Excavation revealed approximately 0.2m of disturbed garden soil and build-up overlaying undisturbed sandy clay substrata.

No remains of archaeological importance were observed during the watching brief nor were any finds of archaeological significance recovered.

4. Conclusion

The proposed development area occupied a promising location within a rich archaeological landscape within the medieval village of Rothley, but no evidence of archaeological deposits or artefacts were encountered during the course of this watching brief.

5. Archive & Publication

The site archive consists of:

- 9 Black & White negatives and contact prints
- CD containing 9 digital images
- 1 A4 contact sheet
- 1 A4 watching brief sheet
- Unbound copy of this report (ULAS Report Number 2011-141)

The archive will be held by Leicestershire County Council under the Accession Number X.A125. 2011.

A version of the summary (above) will be published in *Transactions of Leicestershire Historical & Archaeological Society* in due course and placed on the Oasis database.

6. References

Department for Communities and Local Government March 2010, *Planning Policy Statement 5 (Planning and the Historic Environment)*

IfA, 2008 *Standard and Guidance for Archaeological Watching Briefs*

IfA, 2010 *Code of Conduct*

ULAS 2011 *Written Scheme of Investigation for archaeological attendance, inspection and recording (watching brief) Land adjacent to 8 Church Street, Rothley, Leicestershire, LE7 7PD*

Gerwyn Richards
ULAS
University of Leicester
University Road
Leicester LE1 7RH

Tel: 0116 252 2848
Fax: 0116 252 2614

www.le.ac.uk/ulas

© ULAS 13/09/2011

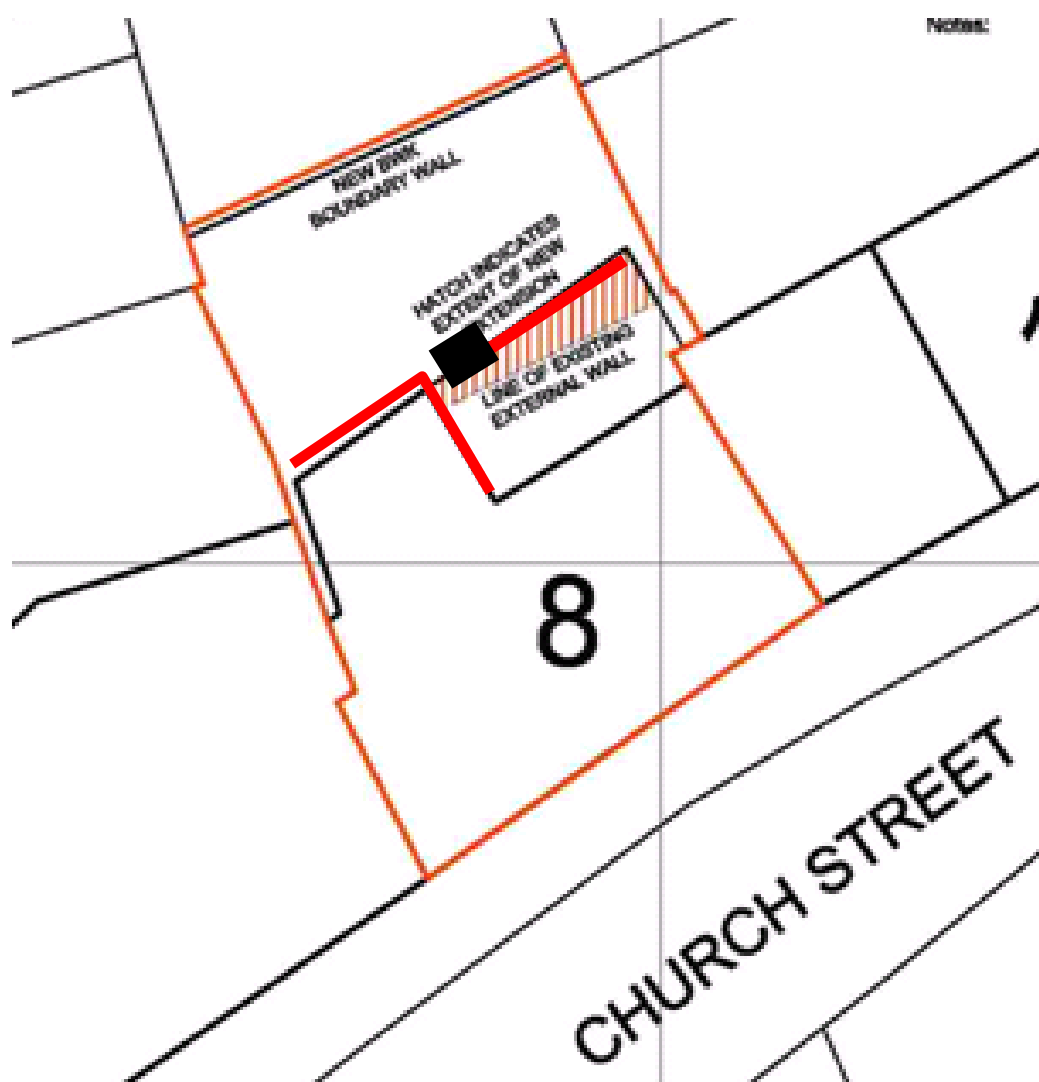

Figure 3

Area of archaeological watching brief, existing footings in red and location of trial hole in black.



Figure 4 Made ground exposed behind retaining wall (looking north).



Figure 5 Existing footings & trial hole in foreground (looking east).

Appendix: Oasis Record

INFORMATION REQUIRED	EXAMPLE
Project Name	Church Street
Project Type	Watching Brief
Project Manager	Jennifer Browning
Project Supervisor	Gerwyn Richards
Previous/Future work	Previous: None. Future: None
Current Land Use	Garden
Development Type	Residential
Reason for Investigation	PPS5
Position in the Planning Process	As a condition
Site Co ordinates	SK 585 126
Start/end dates of field work	Sept 2011
Archive Recipient	LMARS
Height min/max	49mOD
Study Area	N/A
Finds	None

Contact Details

Richard Buckley or Patrick Clay
University of Leicester Archaeological
Services (ULAS)
University of Leicester,
University Road,
Leicester LE1 7RH

T: +44 (0)116 252 2848

F: +44 (0)116 252 2614

E: ulas@le.ac.uk

w: www.le.ac.uk/ulas

