



University of Leicester

Archaeological Services

**An Archaeological Watching Brief
at 45 Main Street,
Newtown Linford,
Leicestershire
(SK 517 100)**

Gerwyn Richards



ULAS Report No 2011-138
©2011

**An Archaeological Watching Brief
at 45 Main Street,
Newtown Linford, Leicestershire.
(NGR SK 517 100)**

Gerwyn Richards

Planning Application: P/11/1791/2

For: Michael Collins Architects and Mr. and Mrs. G. Richardson

Checked by



Signed:

Date: 14.09.2011

Name: Jennifer Browning

University of Leicester
Archaeological Services
University Rd., Leicester, LE1 7RH
Tel: (0116) 252 2848 Fax: (0116) 252 2614
www.le.ac.uk/ulas

**An Archaeological Watching Brief carried out at 45 Main Street, Newtown
Linford, Leicestershire (SK 517 100)**

Contents

Summary	1
1. Introduction	1
2. Aims and Methodology	3
3. Results	4
4. Conclusion	4
5. Archive & Publication	5
6. References	5
Appendix OASIS	8

Figures

Figure 1	Site Location	2
Figure 2	Newtown Linford village centre in detail.	3
Figure 3	Representative section in northernmost trench (looking north east).	6
Figure 4	Area of watching brief	7

An Archaeological Watching Brief carried out at 45 Main Street, Newtown Linford, Leicestershire (SK 517 100)

Gerwyn Richards

Summary

University of Leicester Archaeological Services (ULAS) was commissioned by Michael Collins Architects and Mr & Mrs. G. Richardson to undertake an archaeological watching brief during groundworks in advance of the construction of an extension to the side of Thatched Roofs, Main Street, Newtown Linford, Leicestershire.

The proposed development area had been identified as being of archaeological potential, located within the historic settlement core of the village and within the curtilage of a Listed Building as well as other sites of known archaeological significance. No evidence of archaeological deposits or artefacts was encountered during the course of the watching brief.

The archive will be held by Leicestershire County Council, under the accession number X.A122. 2011.

1. Introduction

University of Leicester Archaeological Services was commissioned by Michael Collins Architect & Design Consultant and Mr. And Mr. G. Richardson to undertake an archaeological watching brief during groundworks for the construction of an extension to Thatched Roofs, 45 Main Street, Newtown Linford (SK 517 100; *Figures 1 & 2*). The proposed development area was located to the south eastern gable of the house which fronts Main Street to the south west. The groundworks consisted of the excavation of foundation trenches.

The Leicestershire and Rutland Historic Environment Record (HER) indicates that the proposed development area lies in an area of archaeological interest, located within the medieval and post-medieval historic settlement core of the village of Newtown Linford (HER Ref MLE734). Other known archaeological sites within the vicinity of the proposed development area include a possible Bronze Age round barrow (HER Ref MLE2765) to the south. To the east is Bradgate Park, a 13th century deer park (HER Ref MLE 749). Other archaeologically significant sites include Roman (HER Ref MLE7756), Saxon (HER Ref MLE6107), and a number of medieval sites (HER Refs MLE732, MLE748, MLE2785, MLE9139 & MLE10194). Thatched Roofs, itself is a Grade II Listed building, the listing description is as follows (<http://www.heritagegateway.org.uk>):

Cottage of C17/C18. Granite and slate rubble stone with thatch roof. Rebuilt bridge ridge stack behind centre left door and similar right end stack. 1 ½ storeys, casements, with two eyebrow dormers of 3-lights. On ground floor, smallpaned C20 bay to left, part glazed door and two

3-light casements, single-light casement on left end and two similar on right end. Beams and inglenook inside.

Charnwood Borough Council advised that the proposed works may have an impact upon buried archaeological remains. In view of this a programme of archaeological attendance was approved. This consisted of a watching brief carried out during the groundworks undertaken by the client's contractors. This work followed Planning Policy Statement 5 (*Planning and the Historic Environment*) (Department for Communities and Local Government March 2010).

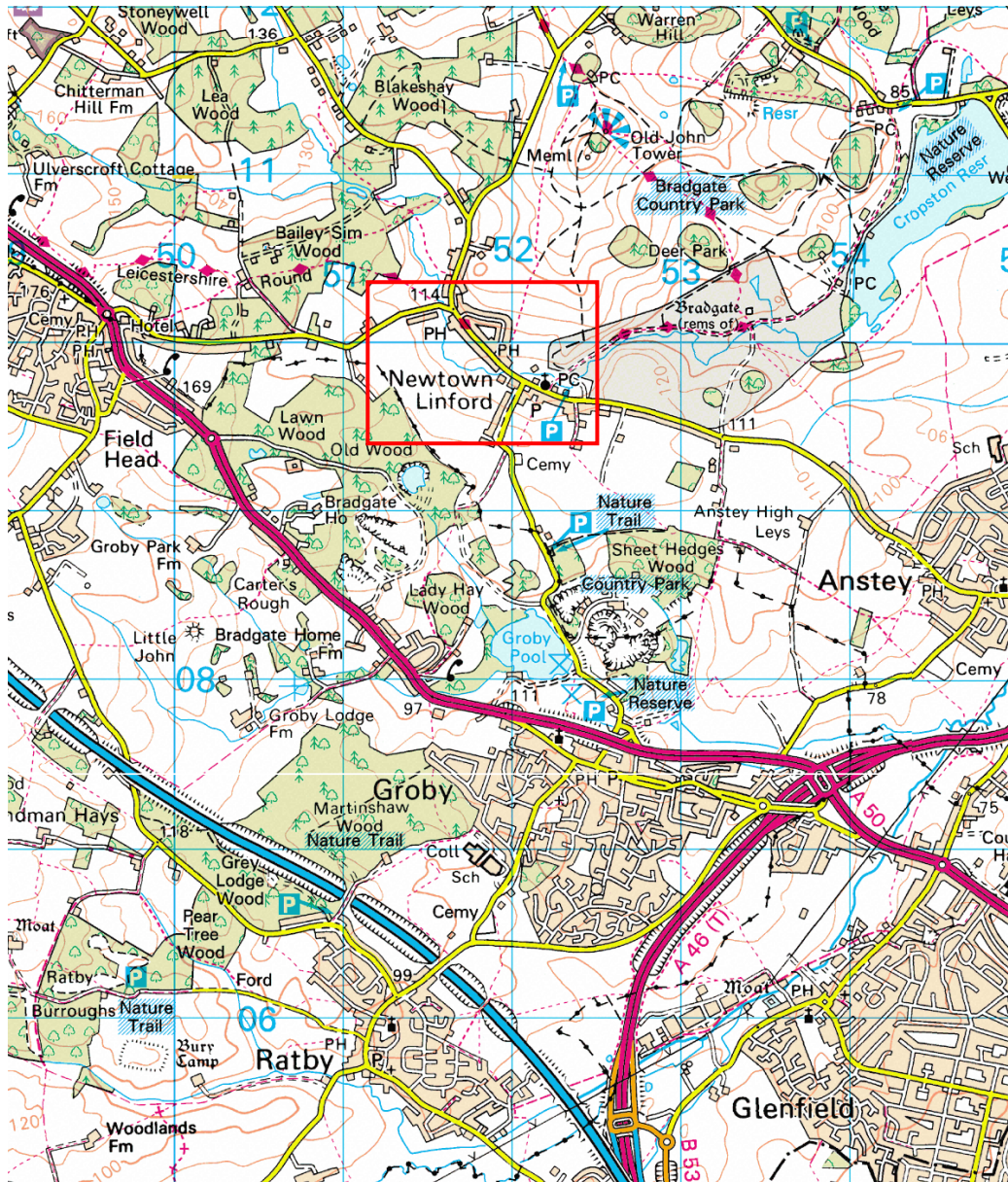

Figure 1. Site location

By permission of Ordnance Survey on behalf of The Controller of Her Majesty's Stationery Office. © Crown Copyright 1996. All rights reserved. Licence number AL 100029495.

2. Aims and Methodology

The aims of the archaeological work, through archaeological inspection and recording of groundworks by the client's contractors, were:

- To identify the presence/absence of archaeological deposits.
- To establish the character, extent and date range for any archaeological deposits to be affected by the proposed ground works.
- To record any archaeological deposits to be affected by the ground works.
- To produce an archive and report of any results

The work followed the Institute for Archaeologists (IfA) *Code of Conduct* (2010) and *Standard and Guidance for Archaeological Watching Briefs* (2008), the *Guidelines for Archaeological Work in Leicestershire and Rutland* (LMARS) and adhered to the University's Health and Safety policy.

All groundworks were carried out by a 1.5 tonne mini digger fitted with a toothed bucket and an 8.5 tonne back actor, also with a toothed bucket, under continuous archaeological supervision. The exposed substratum was observed and the spoil searched for finds. The watching brief took place on September 6th 2011.



Figure 2

Proposed development area in detail, showing approximate area of watching brief in green.

3. Results

The proposed development area is located abutting the south easternmost gable of the property, (*Figures 2 & 4*). A total of three footing trenches were excavated, all 0.45m wide and approximately 1m deep. There was approximately 0.45m of garden soil overlying the undisturbed orange-brown clay substrata (*Figure 3*). All the trenches uncovered the same undisturbed substrata. The north eastern and south easternmost trenches followed the line of an existing service trench.

No remains of archaeological importance were observed within any of the trenches nor were any finds of archaeological significance recovered.

4. Conclusion

The proposed development area occupied a promising location within a rich archaeological landscape within the medieval village of Newtown Linford, but no evidence of archaeological deposits or artefacts were encountered during the course of this watching brief.

5. Archive & Publication

The site archive consists of:

- 9 Black & White negatives and contact prints
- CD containing 9 digital images
- 1 A4 contact sheet
- 1 A4 watching brief sheet
- 1 A4 paper location plan
- 1 A3 paper building plan with elevations of existing building
- Unbound copy of this report (ULAS Report Number 2011-138)

The archive will be held by Leicestershire County Council under the Accession Number X.A122. 2011.

A version of the summary (above) will be published in *Transactions of Leicestershire Historical & Archaeological Society* in due course and placed on the Oasis database.

6. References

Department for Communities and Local Government March 2010, *Planning Policy Statement 5 (Planning and the Historic Environment)*

IfA, 2008 *Standard and Guidance for Archaeological Watching Briefs*

IfA, 2010 *Code of Conduct*

Gerwyn Richards
ULAS
University of Leicester
University Road
Leicester LE1 7RH

Tel: 0116 252 2848
Fax: 0116 252 2614

www.le.ac.uk/ulas

© ULAS 09/09/2011



Figure 3 Representative section in northernmost trench (looking north east).

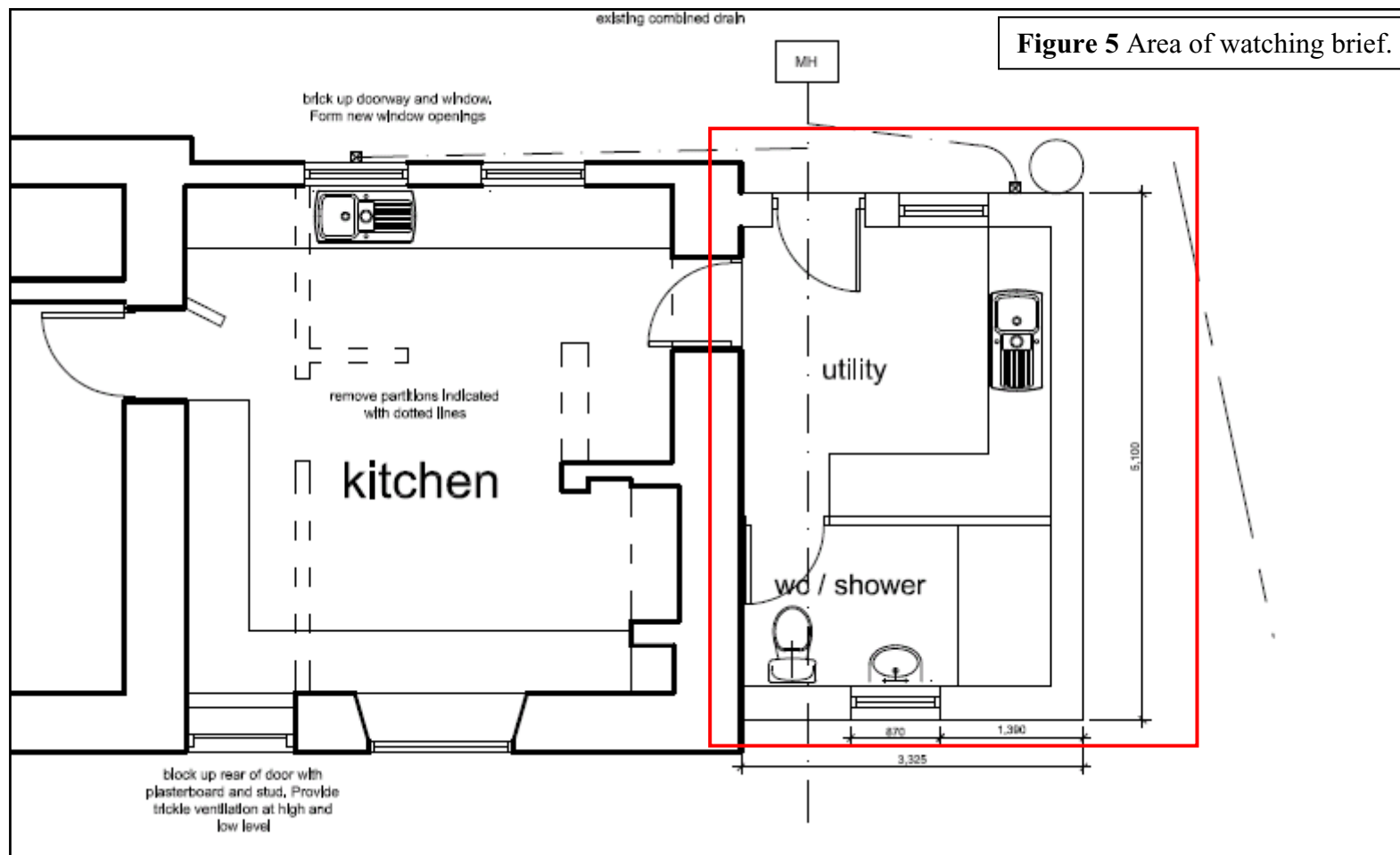

Appendix: Oasis Record

INFORMATION REQUIRED	EXAMPLE
Project Name	Thatched Roofs
Project Type	Watching Brief
Project Manager	Vicki Score
Project Supervisor	Gerwyn Richards
Previous/Future work	Previous: None. Future: None
Current Land Use	Garden
Development Type	Residential
Reason for Investigation	PPS5
Position in the Planning Process	As a condition
Site Co ordinates	SK 517 100
Start/end dates of field work	Sept 2011
Archive Recipient	LMARS
Height min/max	100mOD
Study Area	N/A
Finds	None

Contact Details

Richard Buckley or Patrick Clay
University of Leicester Archaeological
Services (ULAS)
University of Leicester,
University Road,
Leicester LE1 7RH

T: +44 (0)116 252 2848

F: +44 (0)116 252 2614

E: ulas@le.ac.uk

w: www.le.ac.uk/ulas

