



**University of
Leicester**

Archaeological Services

**A photographic survey of stables at
Home Farm, Billesdon Coplow, Tilton
Lane, Billesdon, Leicestershire
NGR: SK 7078 0423**

Sophie Clarke



ULAS Report No 2012-039.
©2012

**A photographic survey of
stables at Home Farm,
Billesdon Copelow, Tilton Lane,
Billesdon, Leicestershire**

NGR: SK 7078 0423

Sophie Clarke

For: Mr and Mrs Bridgewood

Checked by

Signed:  **Date:** 1 March 2012

Name: Richard Buckley

University of Leicester

Archaeological Services

University Rd., Leicester, LE1 7RH

Tel: (0116) 2522848 Fax: (0116) 2522614

ULAS Report Number 2012-039

X.A32.2012 ©2012

CONTENTS

Summary	2
Background	2
Methods.....	3
Results	4
Selected photographs from the archive	6
Archive.....	13
Publication.....	14
Acknowledgements	14
Bibliography.....	14
Appendix 1: Oasis Record	15

FIGURES

Figure 1. Site location, Billesdon Coplow, Leicestershire.....	2
Figure 2. Site plan (supplied by Staniforth Architects; not to scale)	3
Figure 3. Plan of Billesdon Coplow stables in 1886 (not to scale).....	4
Figure 4. Floor plans of stable block, derived from plans supplied by Staniforth Architects Ltd.	6
Figure 5. Stable- block, frontage range, looking south-east.	7
Figure 6. 1911 datestone located above the cart-entrance into the livery yard. Looking south-east.	7
Figure 7. External façade of south-western range of stables. Looking east.....	8
Figure 8. Livery yard. Looking south-east.....	8
Figure 9. North-eastern stable range, looking north.	9
Figure 10. Rear elevation of north-eastern stable range, looking west.	9
Figure 11. Stables, looking north-west towards livery yard.	10
Figure 12. Apple store, looking north.	10
Figure 13. Iron-stone wall to rear of apple store. Looking south-west.	11
Figure 14. Glazed brick and ceramic feeding trough, stamped Oates and Green Ltd, Halifax. Looking north-east.	11
Figure 15. Ledged and braced door to loose-box, with cast-iron post. Looking south-east.....	12
Figure 16. Stair ladder to upper hay-loft. Looking south.....	12
Figure 17. Upper hay loft, with timber ventilation shafts. Looking north-west.	13
Figure 18. Principal roof truss with king-bolt, in hayloft looking east.	13

A photographic survey of stables at Home Farm, Billesdon Coplow, Tilton Lane, Billesdon, Leicestershire SK 7078 0423

Summary

An English Heritage Level 2 photographic survey was carried out on the 20th of February 2012 by ULAS for Mr and Mrs Bridgewood, in advance of the residential conversion of mid to late Victorian stables located at Home Farm, associated with the Billesdon Coplow estate, Tilton Lane, Billesdon, Leicestershire SK 7078 0423. The archive will be deposited with LMARS under the accession number X.A32.2012.

Background

The stables at Home Farm, Billesdon Coplow have been identified by Leicestershire County Council Historic and Natural Environment Team as being of historic significance. Historic farm buildings are recognised as a rapidly diminishing resource in rural Leicestershire: in response to the submission of a planning application (09/008890/FUL) for the conversion of stables, garage and store to form four new dwellings, it was therefore recommended by the Senior Planning Archaeologist at Leicestershire County Council that a photographic survey be undertaken to provide a permanent record prior to development.

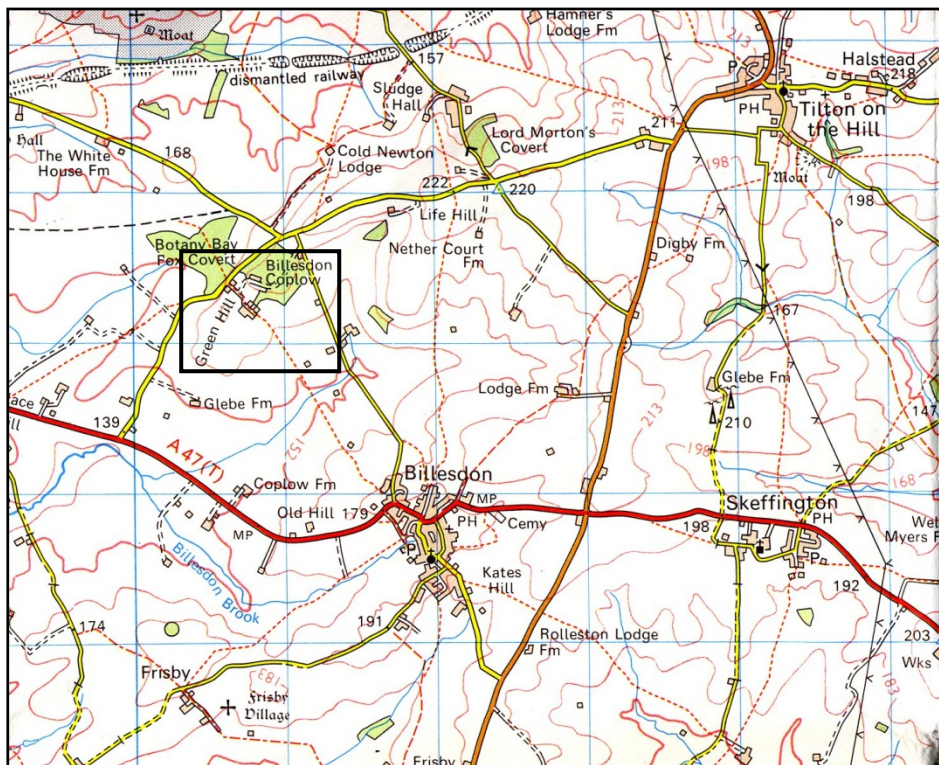

Figure 1. Site location, Billesdon Coplow, Leicestershire

Reproduced from OS Landranger 1:50,000 scale maps by permission of Ordnance Survey® on behalf of The Controller of Her Majesty's Stationery Office. © Crown copyright. All rights reserved. Licence number AL 100029495

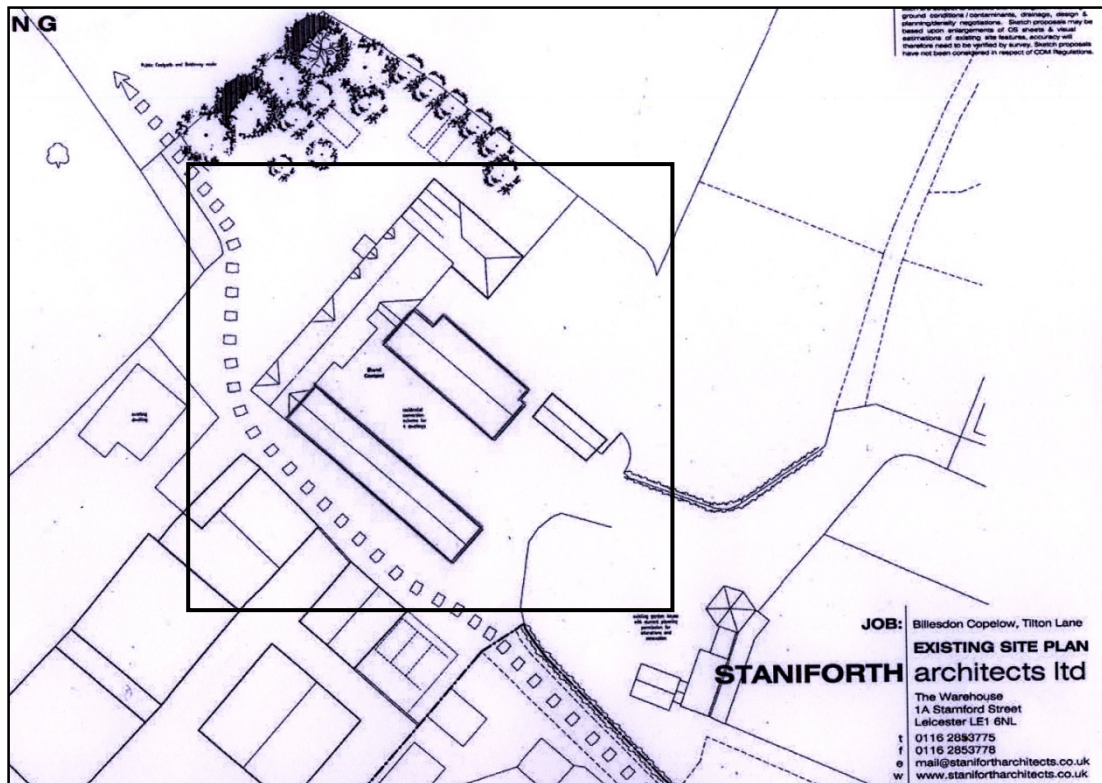

Figure 2. Site plan (supplied by Staniforth Architects; not to scale)

Methods

The photographic record approximated to Level 2 of English Heritage's 'Understanding Historic Buildings' (2006). It included:

Item 1: General view or views of the exterior of the building.

Item 2: The overall appearance of principal rooms and circulation areas.

Item 3: Detailed coverage of the building's exterior appearance.

Item 4: Any external detail, structural or decorative, which is relevant to the building's design, development and use and which does not show adequately on general photographs.

Item 5: The building's relationship to its setting, to other buildings, or to a significant viewpoint.

Item 6: Internal detail, structural and decorative, which is relevant to the building's design, development and use, and which does not show adequately on general photographs.

A summary of the building's type or purpose, historically and at present, its materials and possible date (s).

All work followed the Institute for Archaeologists (IfA) *Code of Conduct* (rev. 2010) and adhered to their *Standard and Guidance for Archaeological Investigation and Recording of Standing buildings or Structures* (2008). In addition, Leicestershire County Council's *Guidelines and Procedures for Archaeological Work in Leicestershire* was adhered to.

The buildings were photographed using a Pentax K-7 digital camera and Pentax P30 35mm film camera. The film used was Ilford HP5 rated at 400asa. Digital images were shot in proprietary RAW format and converted into TIFFs for the archive. Some parts of the complex were occupied by private tenants and were not accessible during the site visit: on the basis of advice given by the client, it is understood that the occupied areas of the site will not be affected by the proposed redevelopment.

Results

The Billesdon Coplow estate is located approximately 2km to the north-west of Billesdon village. The house is grade II listed and dates back to the late 18th century (Pevsner 1996, 102). The unlisted buildings of Home Farm are located approximately 200m to the south of the main house. Of these, the U-shaped stable range appears to be the earliest element: Pevsner (1996, 102) suggests that these were rebuilt in 1911, as indicated by a datestone set into the wall above the cart-entrance into the livery yard (fig 6). However, the first edition Ordnance survey map XXXII.15 of 1886 shows the stable block to be laid in more or less the same form as it appears today; it is more likely therefore that the 1911 datestone represents an episode of refurbishment and that the buildings themselves were built in the second half of the 19th century, constructed of red brick and capped in Welsh slate roof tiles.

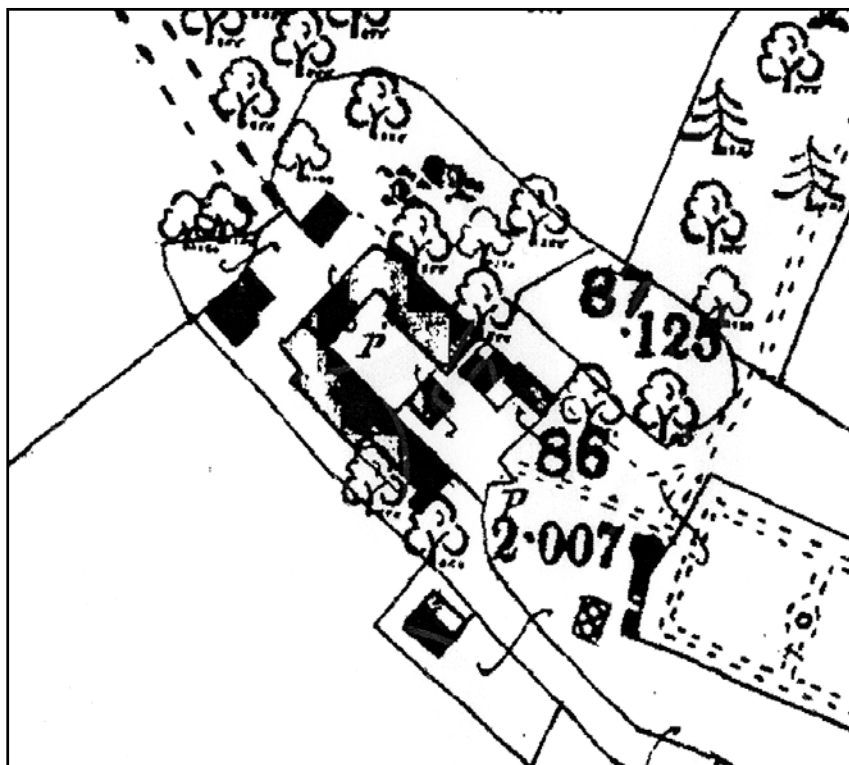

Figure 3. Plan of Billesdon Coplow stables in 1886 (not to scale)
Taken from 1886 Ordnance Survey map XXXII.15

The frontage range of the stable block, located on the north-western side of the complex, is of one and a half stories height with Stable Cottage located at the north-eastern end (fig 5). This is now a privately-occupied house with modern uPVC windows suggesting relatively recent refurbishment, perhaps of former groom's quarters. The cart-entrance into the livery yard is located towards the south-western end of the range, with a privately-occupied block located beyond this. To the rear of the frontage range, flanking the central livery yard are a pair of linear stable blocks, which project towards the south-east (figs 8 and 11).

The block to the north-east is of a single storey in height, with a continuous and unbroken roofline (fig 9). The interruption of the dentilated eaves course to the brickwork of the rear elevation (fig 10), indicates that the range may have been constructed in two phases. In all, the block provides accommodation for five horses, as indicated by the five louvred ventilation towers projecting from the ridgeline of the roof. At the south-eastern end, there are three separate stables divided by brick partition walls, while a larger bay at the north-western end is subdivided into two loose-boxes by earlier timber partitions supported by cast-iron posts (fig 15). Stable doors are of timber and reinforced with steel, with timber-framed window lights above. Window and door openings on the frontage have flat-arch-headed openings: to the rear, window openings have cambered arch-heads. Within each of the stables are glazed brick and earthenware corner troughs (fig 14), stamped with the makers' mark 'Oates & Green Ltd, Halifax'. This company appears to have been established by 1881, as the manufacturers of brick, tile, earthenware, sanitary and ceramics products, before being bought out by the Leeds Fireclay Company in 1908.

<http://freepages.history.rootsweb.ancestry.com/~calderdalecompanion/o.html>
(28/02/2012).

The block to the south-west is of one and a half stories and appears also to have been constructed in two phases, as indicated by the break in the ridge-line of the roof and the variation in the brickwork to the eaves. There are six ventilation towers projecting from the roof and stabling for six horses, with a tack-room located in the centre of the range. Window-frames and doors along the yard frontage are of timber; windows to the rear have been replaced in uPVC. Glazed brick and earthenware corner troughs in each stable are also made by Oates and Green Ltd, dating from 1881-1908. At the south-eastern end of the range, a stair ladder from a store-room provides access into the hayloft (fig 16). This consists of three bays, defined by three timber principal roof trusses, which are supported by a collar and held in place by an iron king-bolt and paired rods. The common rafters are carried on a single order of purlins which are cleated to the backs of the principals. Within each of the bays are the timber ventilation shafts leading from the stables to the towers on the roof (figs 17 and 18). The hayloft over the north-western end of the range was not accessible during the site visit.

To the east of the stables is a detached store, identified by the owner as an apple store (fig 12). This is constructed of red brick, with a dentilated eaves course to the front and back elevations and an arch-headed window opening to both gable-end wall. The rear wall is constructed of iron-stone (fig 13) and the roof is capped in Welsh slate. The building was not accessible during the site visit.

Selected photographs from the archive

The following photographs have been selected from the site archive to illustrate the above account and are located on the plan below.

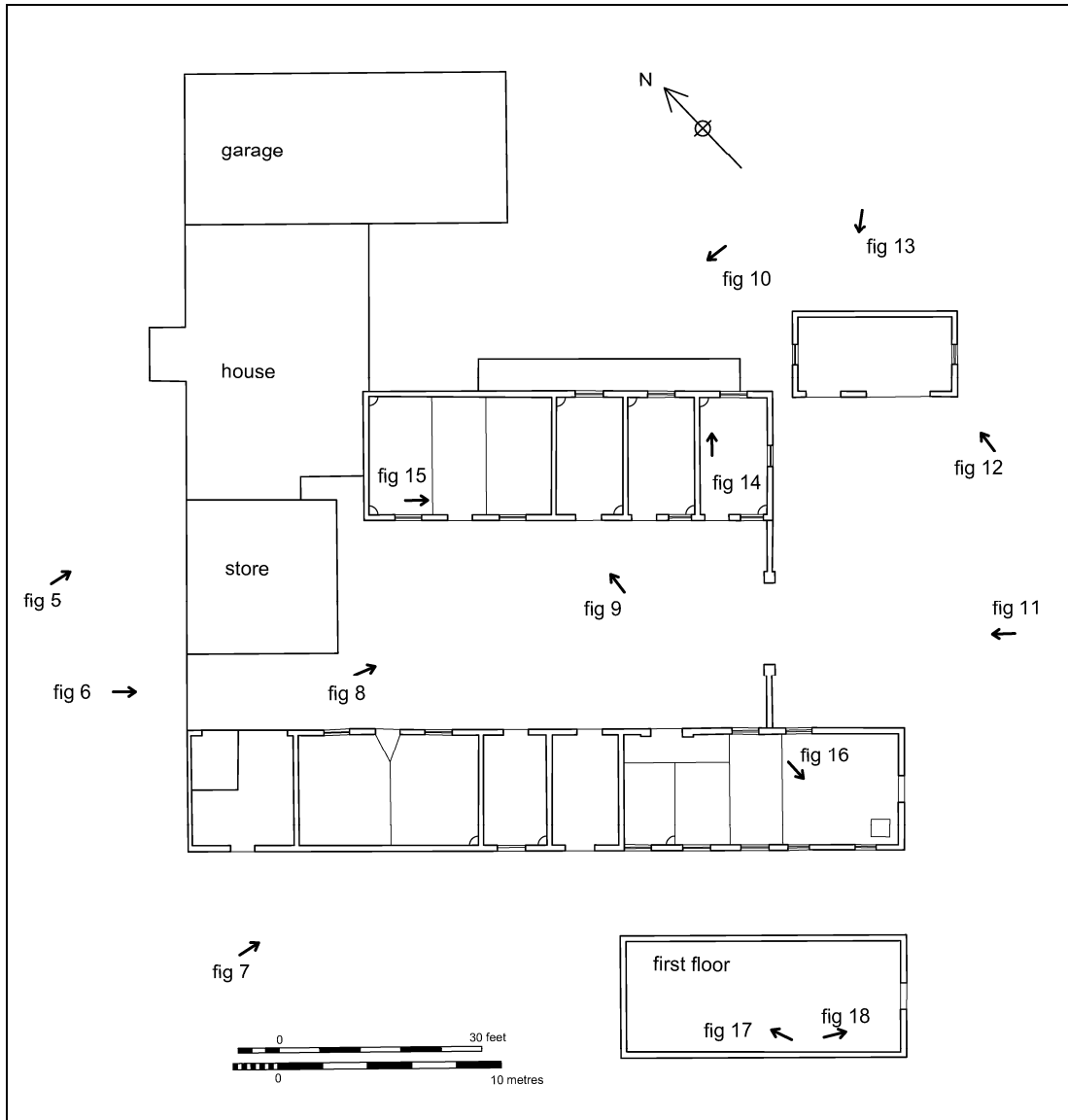

Figure 4. Floor plans of stable block, derived from plans supplied by Staniforth Architects Ltd.



Figure 5. Stable- block, frontage range, looking south-east.



Figure 6. 1911 datestone located above the cart-entrance into the livery yard.
Looking south-east.



Figure 7. External façade of south-western range of stables. Looking east.



Figure 8. Livery yard. Looking south-east.



Figure 9. North-eastern stable range, looking north.



Figure 10. Rear elevation of north-eastern stable range, looking west.



Figure 11. Stables, looking north-west towards livery yard.



Figure 12. Apple store, looking north.



Figure 13. Iron-stone wall to rear of apple store. Looking south-west.



Figure 14. Glazed brick and ceramic feeding trough, stamped Oates and Green Ltd, Halifax. Looking north-east.



Figure 15. Ledged and braced door to loose-box, with cast-iron post. Looking south-east.



Figure 16. Stair ladder to upper hay-loft. Looking south.



Figure 17. Upper hay loft, with timber ventilation shafts. Looking north-west.



Figure 18. Principal roof truss with king-bolt, in hayloft looking east.

Archive

The archive consists of the digital image files on DVD, digital contact sheets, monochrome film and associated contact prints, and a plan of the building showing position and direction of all photographs taken. It will be deposited with LMARS under the accession number X.A32.2012.

Publication

A version of the summary will appear in *Transactions of the Leicestershire Archaeological and Historical Society* in due course. The report will be added to the Archaeology Data Service's (ADS) Online Access to the Index of Archaeological Investigations (OASIS) database.

Acknowledgements

The project was managed by Richard Buckley and carried out by Sophie Clarke of ULAS. ULAS would like to thank Mrs Bridgewood of Billesdon Coplow and Matthew Staton for their help during the course of this project.

Bibliography

IfA, 2010 *Code of Conduct*.

IfA, 2008 *Standard and Guidance for Archaeological Investigation and Recording of Standing buildings or Structures*.

Leicestershire County Council, *Guidelines and Procedures for Archaeological Work in Leicestershire*.

Pevsner, N. and Williamson, E. 2003. *The Buildings of England: Leicestershire and Rutland*. Yale University Press: London and New Haven.

Appendix 1: Oasis Record

INFORMATION REQUIRED	EXAMPLE
Project Name	Home Farm, Billesdon Coplow
Project Type	Building survey
Project Manager	Richard Buckley
Project Supervisor	Sophie Clarke
Previous/Future work	-
Current Land Use	Agricultural
Development Type	Residential
Reason for Investigation	PPS5
Position in the Planning Process	As a condition
Site Co ordinates	SK 7078 0423
Start/end dates of field work	20th February 2011
Archive Recipient	LMARS
Height min/max	not known
Study Area *	0.5 ha
Finds	None

Contact Details

Richard Buckley or Patrick Clay
University of Leicester Archaeological
Services (ULAS)
University of Leicester,
University Road,
Leicester LE1 7RH

T: +44 (0)116 252 2848

F: +44 (0)116 252 2614

E: ulas@le.ac.uk

w: www.le.ac.uk/ulas



INVESTOR IN PEOPLE

