

**Husbands Bosworth
Quarry Extension (SK463282)
Interim Note
on Archaeological Watching Brief**

(December 2003 – August 2004)

P.A. 98/0329/3

Matthew Beamish

**For
Lafarge Aggregates**

Checked by Project Manager

Signed:.....Date:.....

Name.....

**University of Leicester
Archaeological Services**

University Road, Leicester LE1 7RH
Tel: 0116 2522848 Fax: 0116 2522614

Table of Contents

SUMMARY	2
INTRODUCTION	2
SITE LOCATION	3
AIMS AND METHODS	4
THE RESULTS	4
CONCLUSIONS	5
BIBLIOGRAPHY	5
THE ARCHIVE	6
ACKNOWLEDGEMENTS	6

List of Illustrations

Figure 1: Location of quarry, and scheduled area.	3
Figure 2: Area of quarry extension and areas of watching brief in 2002, 2003 and 2004, and unstripped areas.	7

Husbands Bosworth Quarry Extension: Interim Note on Archaeological Watching Brief, 2002-4 (SK6382)

Summary

A watching brief has been maintained at the request of Lafarge Aggregates, in the Quarry Extension, Husbands Bosworth, Leicestershire. Work has been undertaken in areas to the south, south-west, west, north-west and north of a Neolithic causewayed enclosure (SAM 30089) which occupies part of the area and is excluded from the gravel extraction.

Archaeological features have been very dispersed with few concentrations of activity or even dateable deposits.

Introduction

This document provides an overview of the results of three pieces of archaeological work carried in December 2003, and May and August 2004 in connection with an extension of gravel extraction by Lafarge Aggregates at Husbands Bosworth, Leicestershire. The development site is located west of Wheler Lodge Farm, Welford Road, Husbands Bosworth, Leicestershire (SP 635 840; Fig. 1). The area was allocated for sand and gravel extensions to existing quarries in the Leicestershire Minerals Local Plan Review (5.1997; p 33).

The area has been the subject of various archaeological surveys and evaluations to date including a desk-top assessment and fieldwalking, by Leicestershire Museums (LMARS AST Rep No. 96/14), and geophysical survey, evaluation trenching and watching-brief by University of Leicester Archaeological Services (ULAS; Rep No. 98/129; 99/05; 99/48; 2000/109;2000/148; Interim report 7.2000; 2002/011).

Work carried out between July 2002 and November 2003 (which included the notable findings of a probable Neolithic burial pit in 2002 (Beamish 2003, p138), and an Anglo-Saxon sunken featured building with associated deposits, and an isolated corn drier type feature (Beamish and Higgins forthcoming) will be reported separately.

Interpretation and dating herein are provisional, as full analysis is yet to be undertaken. The work was directed by James Harvey and Steven Jones. The work followed the draft Scheme of Archaeological Works (OAA 4.8.2000 hereinafter SAW). Finds and archive will be deposited with Leicestershire Museums, Art Galleries and Records Service under accession code X.A83.1998.

Site Location

The quarry extension is located to the south of Husbands Bosworth, on the northern side of the River Avon which also forms the county boundary with Northamptonshire.

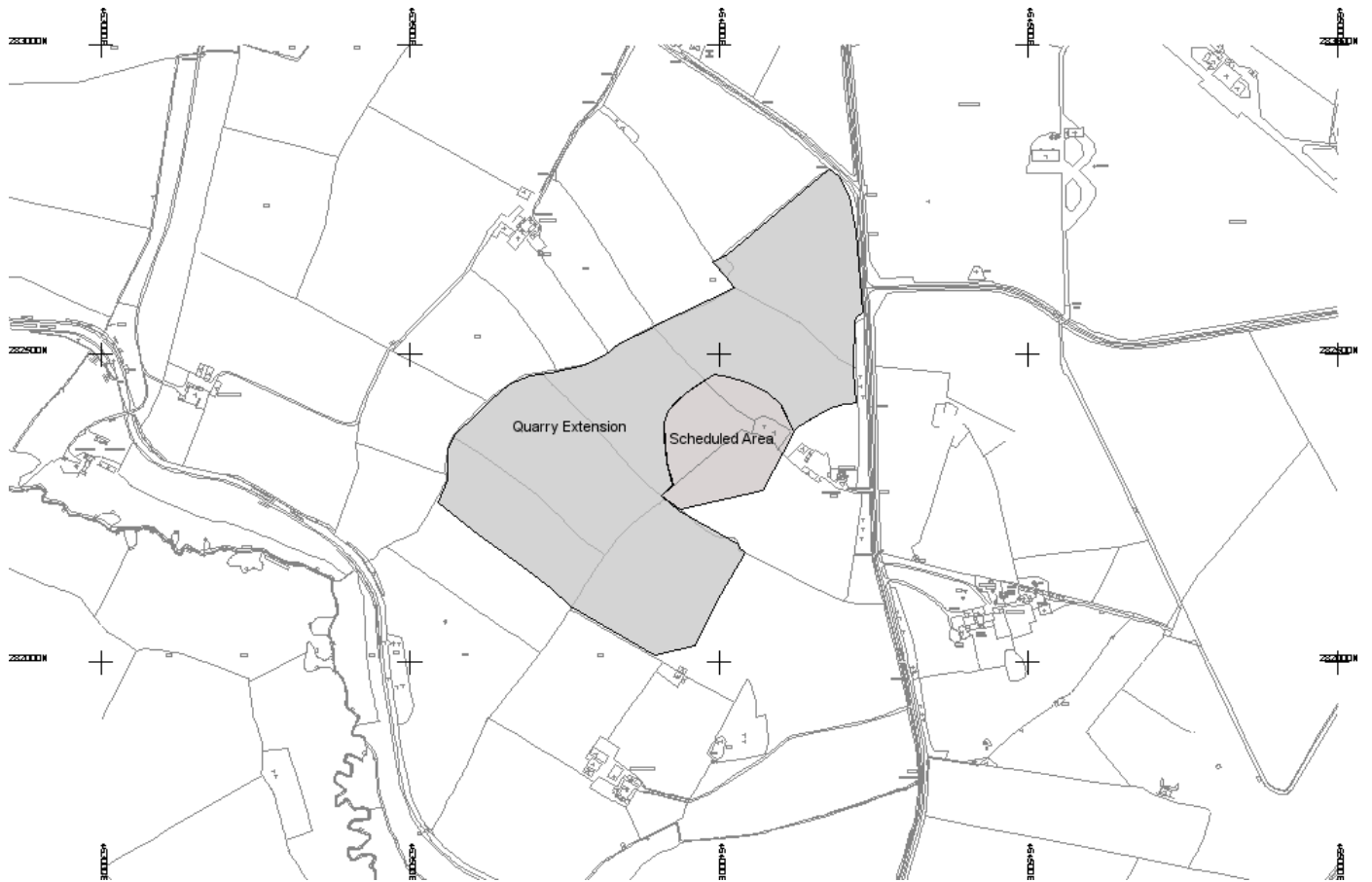

Figure 1: Location of quarry, and scheduled area.

Aims and Methods

The watching brief comprised archaeological examination of topsoil removal by the contractors using hymax 360's with ditching buckets. This was followed by archaeological control and supervision of subsoil interface levels to horizons where archaeological deposits were revealed (SAW 7). Following archaeological recording or verification that remains were not present the areas were released to the contractors for subsoil removal by hymaxes.

Monitoring of all but the final area (the ditch cut on the east side of Field 6) was carried out by the County Planning Archaeologist along with Dr. Simon Collcutt (OAA) and Matthew Beamish (ULAS).

The Results

1. December 2003: Field 5/6. An area 60m x 15m was recorded. This area straddled the field boundary that had separated Field 5 from Field 6.

Four possible pit features were recorded. No dating or diagnostic material was recovered. This area was to the immediate south of a small square enclosure believed to be of Iron Age date, recorded in 2001 and 2002.

2601 (S210.1) Possible pit. 0.80m diameter. No finds. Field 6

2603 (S210.3) Possible post-hole. 0.60 x 0.40m. No finds. Field 6

2604 (S210.5) Possible pit. 0.80m diameter. No finds. Field 6

2607 (S210.7) Possible pit. 0.50m diameter. No finds. Field 6.

2. Two areas were stripped in May 2004.

The first area in Field 6 extended along the field boundary with Field 5 on the south side, and measured 115m x 8m. Three anomalies were recorded, of which one was a probable treethrow. None produced any dating, or diagnostic material.

2700 (S210.09) Possible feature. 0.70m diameter. No finds. Field 6

2702 (S210.11) Possible feature. 0.60m diameter. No finds. Field 6

2704 (S210.13) Probable treethrow pit. 2.2m x 1m. No finds. Field 6.

The second area was in Field 5, and measured 92m x 12m. It lay below the power cables that once passed southwest to northeast above the quarry, to the south of the causewayed enclosure prior to their removal in 2003.

The area had suffered some stripping in the past and was damaged on the southern side. Four features were recorded. One of these was probably a treethrow pit, and none produced any dating, or diagnostic material. However one was a clear linear feature. This was found to be in direct alignment with a

ploughed out boundary visible on the 1st edition Ordnance Survey maps and was most probably of nineteenth Century date.

2706 (S210.15) Possible pit. 0.60 x 0.40m. No finds. Field 5

2708 (S210.18) Possible feature. 0.80m. No finds. Field 5.

2711 (S21019) Ditch boundary. 2(+) x 0.60m. No finds. Field 5

2714 (S210.21) Probable treethrow pit. 2.20 x 0.80m No finds. Field 5.

3. In August 2004, an drainage ditch was cut along the quarry boundary on the east side of Field 6. This measured approximately 100m x 2m, and was stripped archaeologically in the first instance. No features or finds were recorded or made.

Conclusions

The last phases of watching brief have been essentially negative. This has been consistent with the preceding phases of work, which show that activity around the causewayed enclosure is increasingly dispersed at distance from the core site. Evidence of Iron Age and Anglo-Saxon activity would also look to be concentrated in only one area, even though the areas recently examined would clearly have formed part of the land and fieldscape around the settlements that we know to have existed in these periods.

Bibliography

- | | | |
|-------------------------------|-------------|---|
| Beamish, M.G., | 2003 | <i>Husbands Bosworth</i> in Archaeology in Leicestershire and Rutland, Trans. Leics. Archaeol. Hist. Soc. Vol 77 |
| Beamish M.G. and Higgins, T. | forthcoming | <i>Husbands Bosworth</i> in Archaeology in Leicestershire and Rutland, Trans. Leics. Archaeol. Hist. Soc. Vol 778 |
| Butler, A., | 2000a | <i>A Geophysical Survey for the Husbands Bosworth Quarry Extension, Leicestershire, (SK 63 82)</i> ULAS Rep 2000/109 |
| Butler, A., | 2000b | <i>A Geophysical Survey for the Husbands Bosworth Quarry Extension Field 6, Leicestershire, (SK 63 82)</i> ULAS Rep 2000/148 |
| Coward, J., | 2001a | <i>Interim Summary on Archaeological Evaluation and Excavation (August – December 2000) at the Extension to the Lafarge Gravel Quarry, Husbands Bosworth, Leicestershire (SK 63 82)</i> ULAS Rep 2001/108 |
| Coward, J., | 2001b | <i>Interim Summary on Archaeological Evaluation and Excavation (March – June 2001) at the Extension to the Lafarge Gravel Quarry Husbands Bosworth, Leicestershire (SK 63 82)</i> ULAS Rep 2001/126 |
| Guilbert, G., and Elliott, L. | 1999 | Post-Ring Round-House at Swarkestone Lowes, <i>Derbyshire Archaeological Journal</i> , 119 |

The Archive

The archive for this phase of work comprises 10 multi context record sheets, 1 drawing index, 1 A2 permagraph drawing sheet, 3 survey files (which have been incorporated into the master site survey).

Acknowledgements

We would like to thank Pat Finnegan of Lafarge Redland Aggregates and their Consultant, Dr. Simon Collcutt of Oxford Archaeological Associates for their help and co-operation. Records will be deposited with Heritage Services, Leics County Council, accession number XA83.1998.

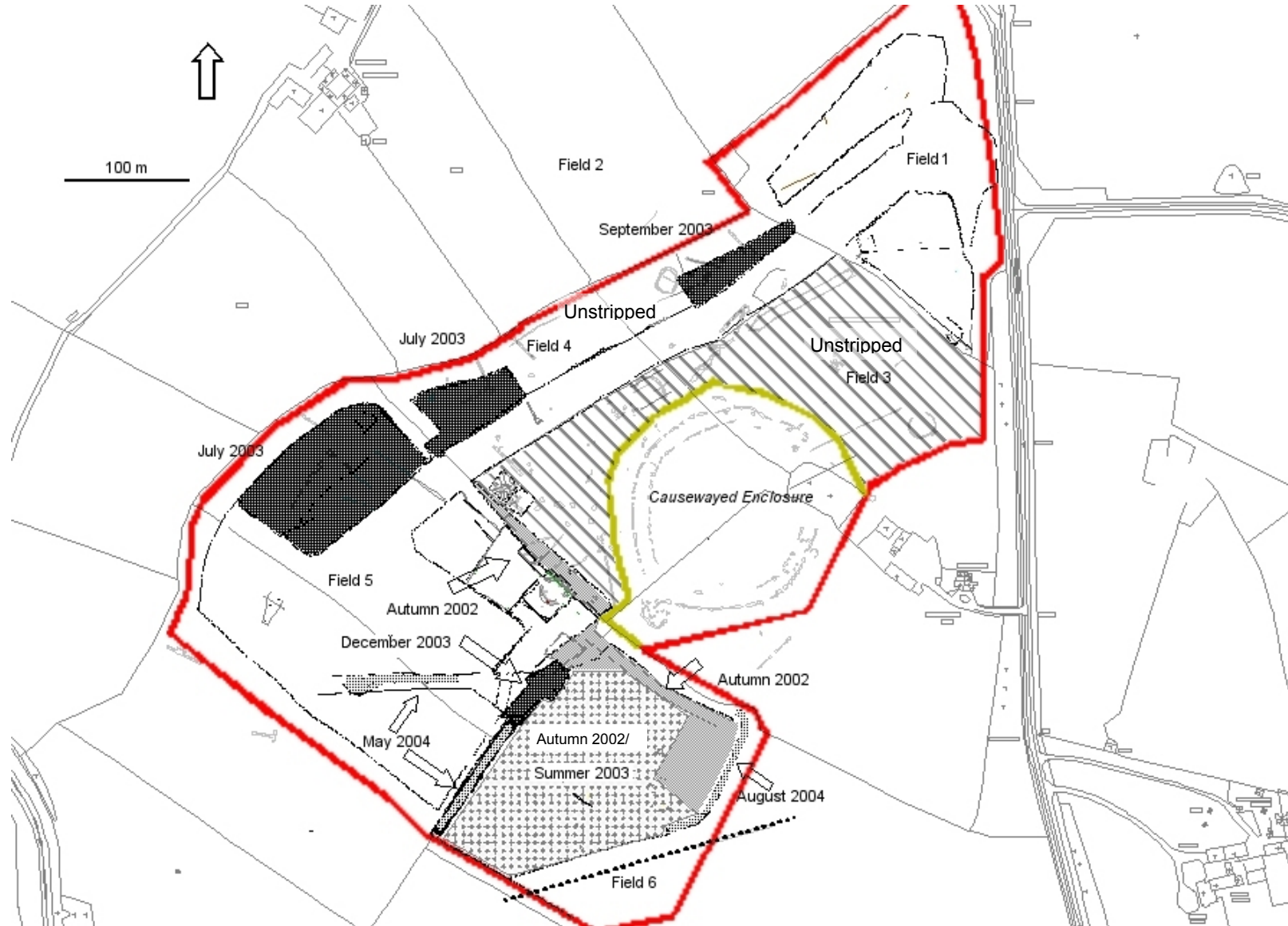

Figure 2: Area of quarry extension and areas of watching brief in 2002, 2003 and 2004, and unstripped areas.